



litter robot B0932CC9ZB Ramp Adapter Installation Guide

[Home](#) » [Litter-Robot](#) » litter robot B0932CC9ZB Ramp Adapter Installation Guide 

Contents

- [1 litter robot B0932CC9ZB Ramp Adapter](#)
- [2 How to install](#)
- [3 Documents / Resources](#)
- [4 Related Posts](#)

litter•robot

litter robot B0932CC9ZB Ramp Adapter



Litter-Robot 4 (with step or handle) can be equipped with the Litter-Robot 3 Ramp using an adapter bracket. No tools are required for installation.

How to install

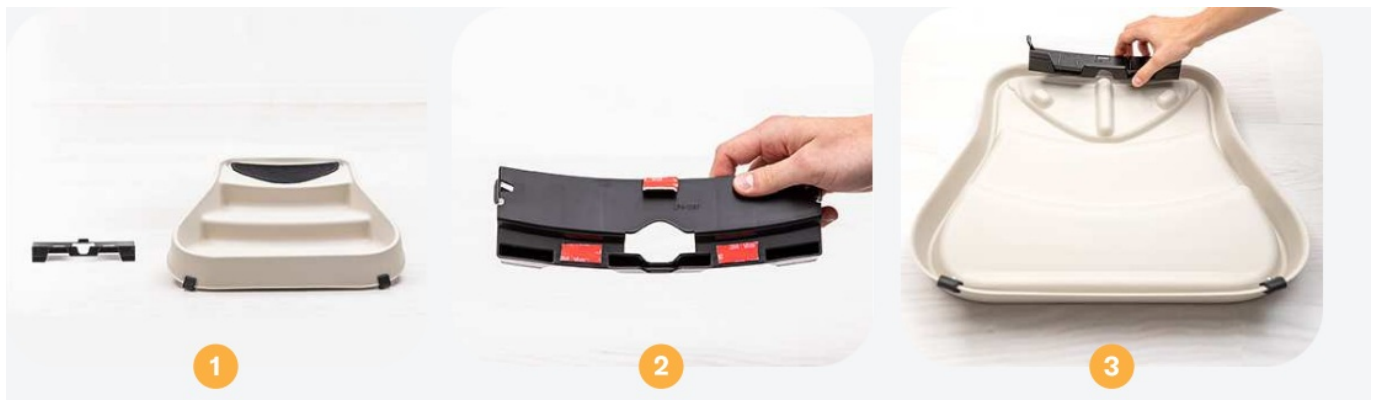

1. Gather the Litter Robot 3 Ramp and adapter bracket.
2. Notice the bracket has three adhesive pads. It's recommended that you practice installing the bracket onto the ramp before removing the protective red tape on the adhesive pad.
3. Peel the red protective tape off the adhesive pads and install the bracket onto the ramp as shown. If your Litter-Robot 4 has a step, proceed to Step 4. If your Litter-Robot 4 has a handle, proceed to Step 5.

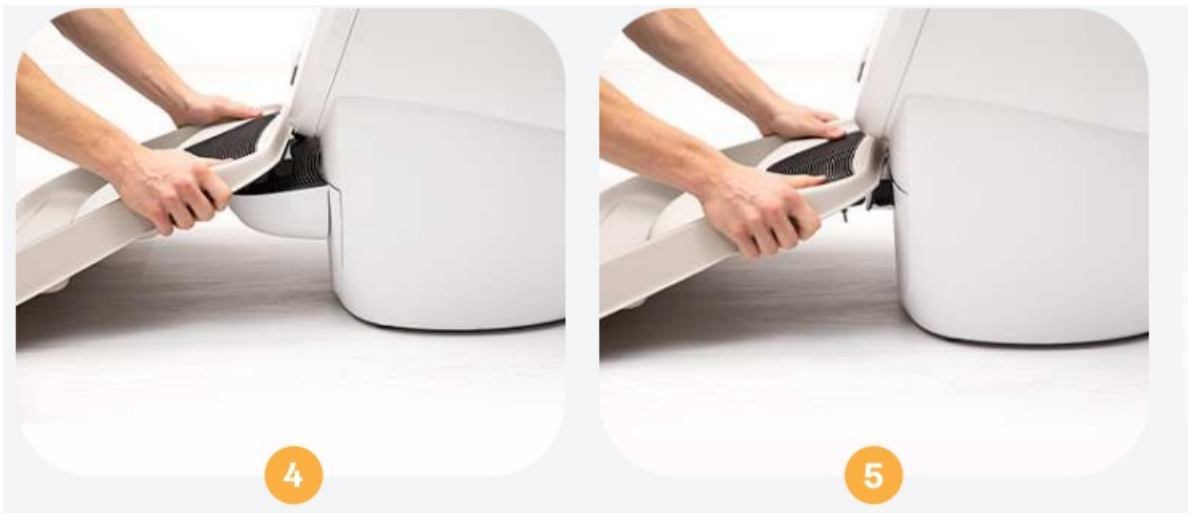

4. Place the ramp above the step and install the ramp by inserting the bracket into the grate of the step as shown. Your installation is now complete. Note: To access the waste drawer, simply lift the ramp off the step and set aside.
5. Slide the ramp forward onto the handle as shown. Gently push the bracket onto the handle until you hear a snap. Your installation is now complete. Note: To access the waste drawer, simply pull the ramp off the handle and set aside.

Questions? Visit whiskersupport.com

Documents / Resources

	<p>litter robot B0932CC9ZB Ramp Adapter [pdf] Installation Guide B0932CC9ZB Ramp Adapter, B0932CC9ZB, Ramp Adapter, Adapter</p>
--	---