

**LITHEAUDIO**  
5.1 Wireless In  
Ceiling Surround  
Sound Hub



# LITHEAUDIO 5.1 Wireless In Ceiling Surround Sound Hub User Guide

[Home](#) » [LITHEAUDIO](#) » LITHEAUDIO 5.1 Wireless In Ceiling Surround Sound Hub User Guide 

## Contents

- [1 LITHEAUDIO 5.1 Wireless In Ceiling Surround Sound Hub](#)
- [2 Introduction](#)
- [3 Surround Hub Overview](#)
- [4 How to set up](#)
- [5 How to use](#)
- [6 Troubleshooting](#)
- [7 Safety & Warnings](#)
- [8 Documents / Resources](#)
  - [8.1 References](#)
- [9 Related Posts](#)

**LITHEAUDIO**

**LITHEAUDIO 5.1 Wireless In Ceiling Surround Sound Hub**



## Introduction

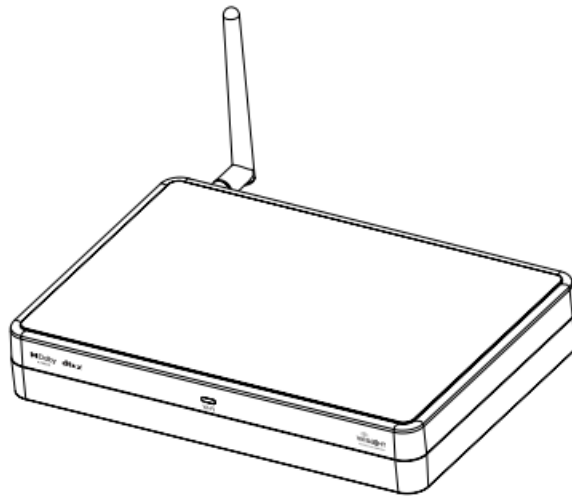

Thank you for buying the Surround Hub. We hope you will enjoy it!

## Features

- **Audio streaming:**  
Stream wireless audio from a wide variety of services.
- **HDMI switching with eARC:**  
Easy switching between multiple HDMI sources and forwarding to the TV screen with ARC or eARC(audio return channel).
- **Audio decoding:**  
Advanced multichannel immersive audio decoding for Dolby Atmos.
- **Bass management system:**

Configurable bass management system to freely set up cross-overs, distances, and levels.

## Surround Hub Overview

### Included in the box

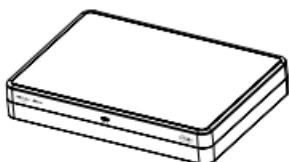

1x Surround Hub



1x Antenna



1x Power adapter (with EU/US/UK plug)



1x Remote



2x AAA Batteries



1x Allen key



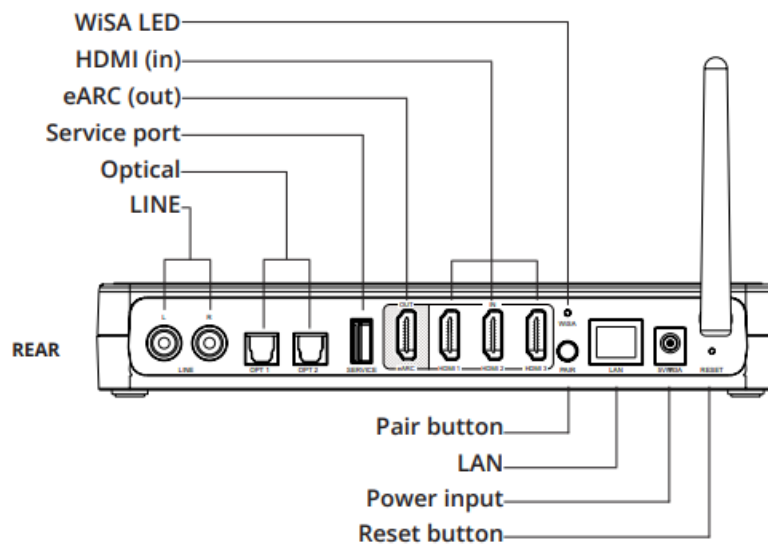
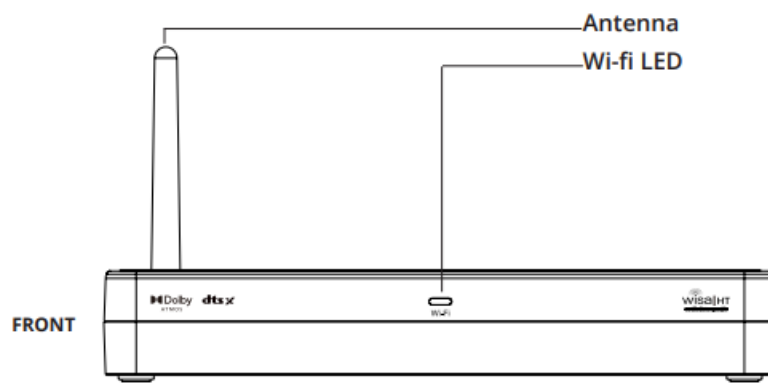

### Surround Hub Layout

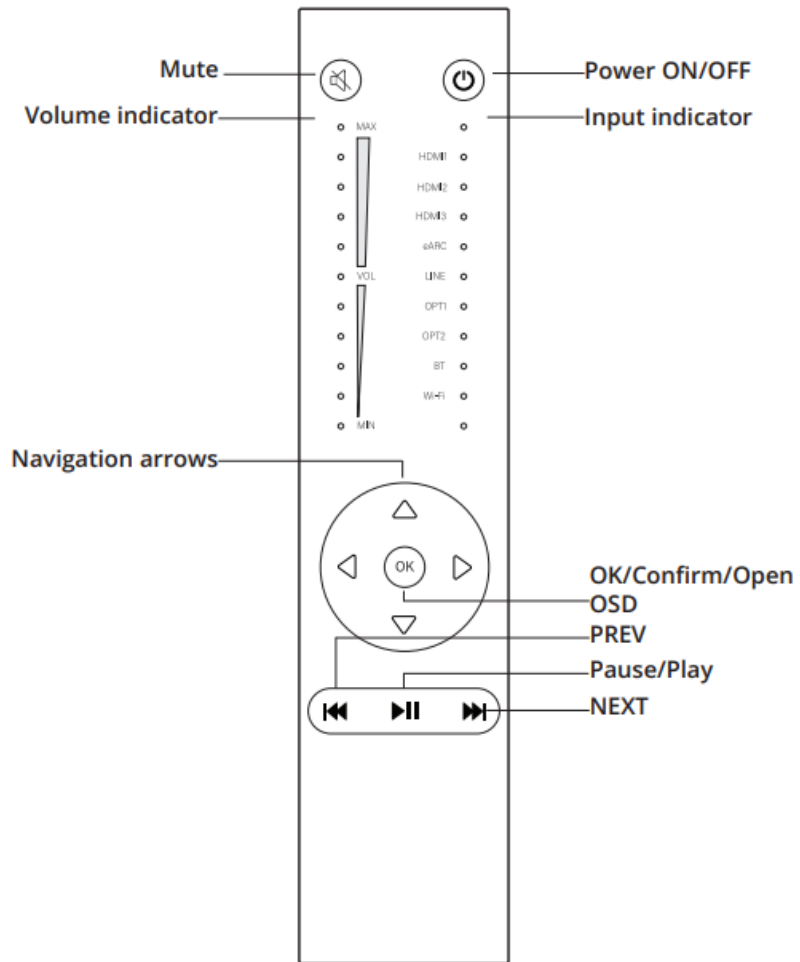

## Remote Layout

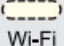

## Wi-Fi LED indications

	<b>Solid white:</b> Connected to network
	<b>White (slow blinking):</b> Booting
	<b>White (rapid blinking):</b> Wi-Fi configuration mode
	<b>White (Irregular blinking):</b> Updating software
	<b>Solid green:</b> Spotify streaming

## How to set up

### Setting up the Surround Hub

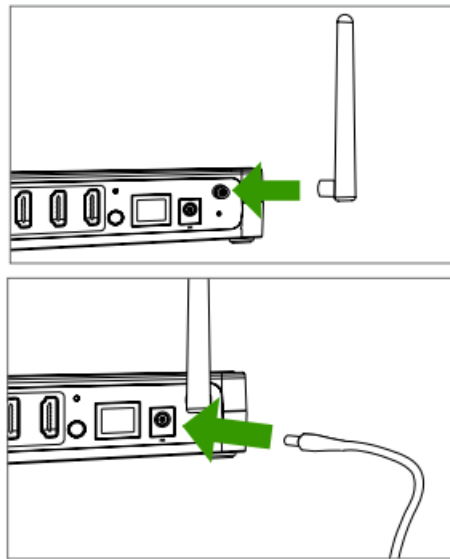

1. Connect the antenna to the back
  - Screw the included Wi-Fi antenna onto the back plate of the Surround Hub.
2. Connect power supply
  - Plug the included power adapter into the Surround Hub.

### Pairing the remote

Pair the remote before proceeding to the next step. Make sure your Hub is on before starting.

### Insert batteries

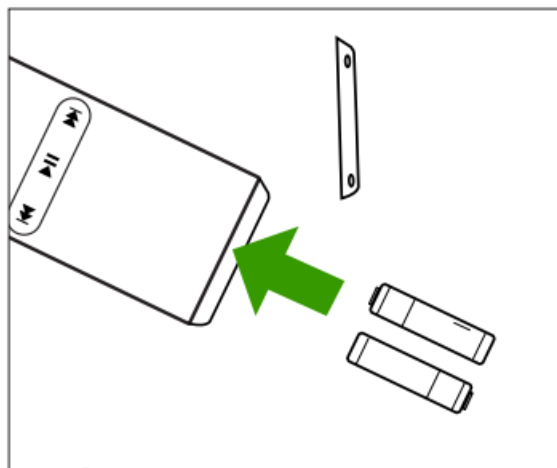

- Unscrew the bottom plate of the remote using the included Allen key.
- Insert batteries into your remote.
- Make sure the batteries have the correct direction, as indicated on the inside of the remote.

### Press and hold the pair

- Press and hold the 'Pair' button on the Surround Hub for 3 seconds until the WiSA LED on the REAR of the

Surround Hub starts blinking rapidly.

### Press any button on the remote

- Press any button on the remote, if the pairing is successful, the 'WiSA LED' on the rear of the hub will stop blinking.
- When pressing any button on the remote, the 'WiSA LED' should blink once.

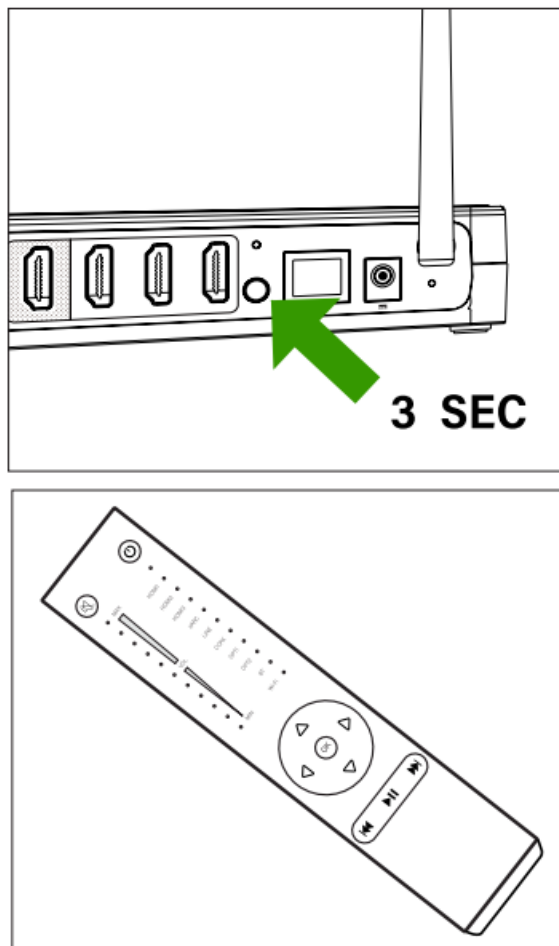

### Connecting the Hub to the home network

#### Download the “Google Home” App

Scan the QR code below to get direct access to the app from the Apple Store or the Google Play store.



IOS



Android

### Power on the Surround Hub

The Surround Hub is ready for the next step when the 'Wi-Fi LED' starts flashing rapidly, meaning it has entered 'Wi-Fi Configuration' mode.

### **Open the Google Home app and follow the instructions**

You will be guided through each step in the app.

### **Wait for the LED to turn solid white**

After finishing the setup in the Google Home app, the 'Wi-Fi LED' should turn solid white, signifying that the Hub is connected to the Wi-Fi and ready to stream.

## **Connecting Surround Hub to TV**

### **Connect to TV**

- Connect Surround Hub's HDMI output to your TV's HDMI ARC/ eARC input, using a compliant HDMI cable

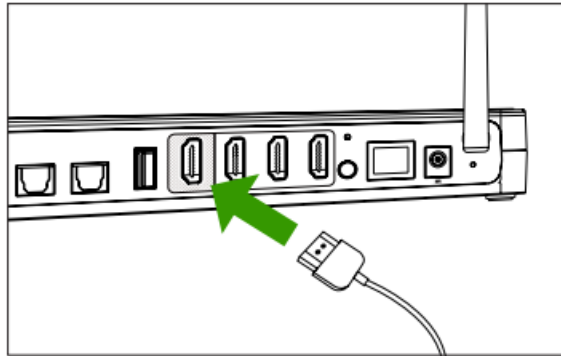

### **NB:**

- IF TV HAS eARC: HDMI cable must support 4k video and HDR with ethernet.
- IF TV HAS ARC ONLY: HDMI version 1.4 or newer is enough.

### **Check your TV's audio output settings**

- Make sure the Surround Hub is powered ON.
- Set output to HDMI ARC/eARC in the TV's menu

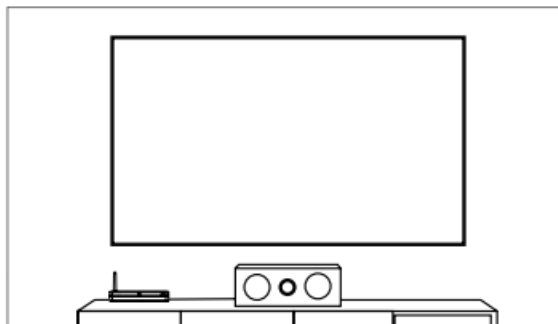

- Set the TV's digital output to bitstream or automatic
- Activate CEC controls if available

### **Switch to eARC input**

- Set input on Surround Hub to eARC using the remote to hear the TV's audio.



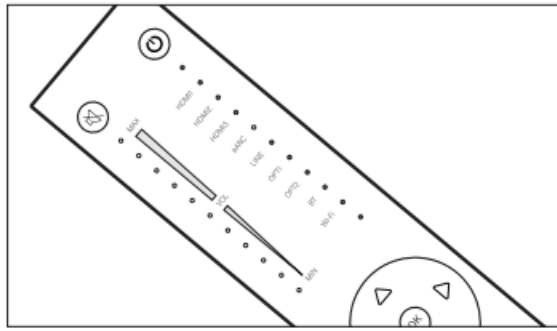

## Pairing speakers using WiSA

The Surround Hub can easily be paired with any WiSA-certified speakers.

### Prepare speakers

- Make sure all speakers are correctly positioned, powered ON and their pairing or associate mode is activated.

### Press pair

- To pair the speakers with the Surround Hub, press the pairing button on REAR once and await slow blinking in WiSA LED while connecting. This function can also be accessed via the product's on-screen-display menu.

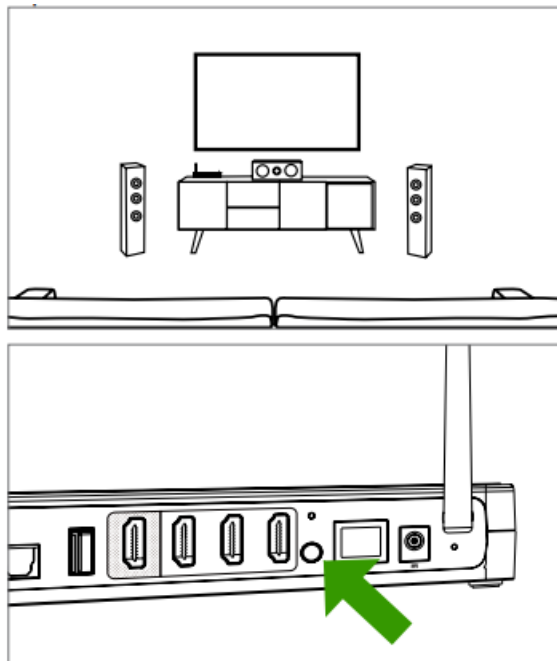

### Access the on-screen display menu

The Surround Hub has a built-in on-screen display. It can be seen by choosing the HDMI port on the TV corresponding to the port the Surround Hub HDMI output is connected to. When the TV has that port selected, press the 'OK' button on the remote and the OSD menu will open. From here the system's settings can be managed.

### Select speaker layout

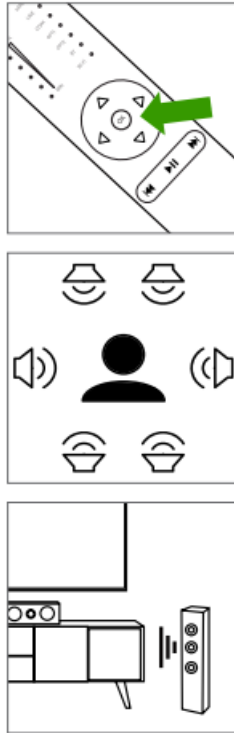

## Setup speaker channels

- To set your speaker's channels, browse the OSD menu: "speaker setup" → "speaker layout"

## Select layout type

- Select "Layout" and scroll left or right until you reach your desired layout type.
- Press 'OK/Confirm' to confirm.

## Check speaker assignment

- Assuming all your speakers are already paired with the system, you can now assign the channels for each speaker.
- Jump down through the list of all the channels required by the chosen speaker layout. You should hear a 'ping' noise from the speakers assigned to each channel.
- Should a channel not be correctly assigned, you can open it by pressing "OK/Confirm" and choosing 'Assign new'.
- Now you can 'ping' all the paired speakers and assign the correct speaker to this channel.
- Do this operation for all channels until all speakers are correctly assigned.

## How to use

### Using the remote

#### Power Surround Hub ON/OFF

The Surround Hub can be turned ON or OFF using the 'ON/OFF' button.



### Changing volume

Volume can be adjusted on the remote using the up and down 'Navigation' buttons when the OSD menu is not open.

### Mute

The audio can be muted using the 'Mute' button. Press once to mute, and press again to unmute.



### SKIP/Play/Pause

The audio stream can be started, paused, and tracks skipped, using the bottom three buttons. This is only available for Bluetooth and Wi-Fi inputs.

HDMI3 ☐

eARC ☐

LINE ☐

OPT1 ☐

OPT2 ☐

BT ☐

Wi-Fi ☐

### Input selection

Input can be changed using the remote by pressing left/right, when not in the OSD menu. You can see the current input on the screen or the 'Input Indicator' LED on the remote.



### Hide Bluetooth visibility

- Hold the PREV button for 3 seconds. When input LED blinks, Bluetooth is hidden and no new units can be paired.
- Hold the EXT button for 3 seconds. When the input LED blinks, Bluetooth is visible for pairing new units.



### Lock volume for specific input

A volume can be locked for specific inputs.

- Select the input and volume you want to lock.
- Press and hold mute for 5 seconds until the input indicator blinks once.

**NB:** To unlock, choose the input you want to unlock and press and hold mute again for 5 seconds

## Audio Playback

### HDMI

- Connect your Surround Hub to an HDMI source using HDMI cable from the 'HDMI (in)' ports on the REAR of the Surround Hub to the correct port on the HDMI source using a HDMI cable 1.4 or newer.
- Set input to "HDMI" using the remote.

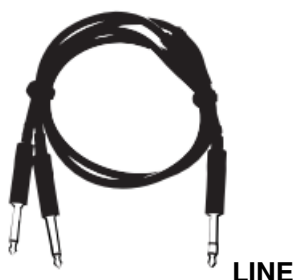

- Any analog source with LINE out can be connected to the Surround Hub through the LINE port on the REAR of the Hub.
- Switch audio input to "LINE" using the remote to playback audio.

**NB:** LINE can only support up to 2,5V rms



- Any source with optical SPDIF output can be connected to your Surround Hub through the two optical ports on the REAR of the Hub
- Switch audio input to the chosen Optical port. using the remote.

### Bluetooth

- The Surround Hub is by default visible and ready for Bluetooth pairing. Find and select the Surround Hub in the Bluetooth Settings on the device you want to connect, the name should be something like "Surround Hub\_XXXXXX".
- When the connection is established, the input will change automatically to "BT", making it ready to start playback.
- If a new device needs to be connected, disconnect the current device before starting the new connection process.

## Spotify Connect

- Open the Spotify Connect app and make sure your device and the Surround Hub are on the same network.
- Find your Surround Hub in the app and select it as a playback device.
- The input will automatically switch to “Wi-Fi”. This can be seen on the ‘Input indicator’ on the remote.
- If a new input is selected, playback will be paused. Resuming playback will change the input back to “Wi-Fi”.

## Apple AirPlay

- Make sure the device you want to play from and the Surround Hub is on the same network.
- Find the “AirPlay” icon on the device you want to play from. Tap it and select your Surround Hub from the list.
- The input will automatically switch to “Wi-Fi”. This can be seen on the ‘Input indicator’ on the remote.
- If a new input is selected, AirPlay will disconnect and will need to be reconnected as described above.

## Google Chromecast

- Make sure the device you want to play from and the Surround Hub is on the same network.
- Find the “Chromecast” icon on the device you want to play from. Tap it and select your Surround Hub from the list.
- The input will automatically switch to “Wi-Fi”. This can be seen on the ‘Input indicator’ on the remote.
- If a new input is selected, Chromecast will be paused. Resuming the casting will change the input back to “Wi-Fi”.

## DLNA

- Open your designated DLNA app and make sure your device and the Surround Hub are on the same network.
- Find your Surround Hub in the app and select it as a playback device.
- The input will automatically switch to “Wi-Fi”. This can be seen on the ‘Input indicator’ on the remote.
- If a new input is selected, playback will be paused. Resuming playback will change the input back to “Wi-Fi”.

## Automatic Standby

The Surround Hub will enter Automatic Standby mode after 20 minutes without an audio signal. The Hub will become active again automatically when it receives a signal.

**NB:** When Surround Hub goes to standby from the LINE or Optical inputs, it is only able to wake up again from the input it was using before it went into standby

## Manual Crossover

Manual crossover can be adjusted from the OSD menu.

Select “Speaker setup”  or “Crossover setup”

- The speaker setup can be accessed from the main OSD menu.

**Select the speaker(s) you want to adjust**

- Press 'OK' on the remote to select and navigation arrows to go through the options.
- When a crossover frequency has been selected, press "OK" again to confirm.

## **Troubleshooting**

If you are experiencing problems that are not described in this guide, please visit our FAQ at:

<https://platinaudio.com/>

### **Drop-outs in only one speaker**

If only one speaker loses input (as opposed to all speakers in your setup losing their input at the same time), it indicates that there may be signals interfering with the WiSA connection. Please follow these guidelines carefully, to troubleshoot this:

#### **Check if the location of your Surround Hub is optimal**

- Make sure there are at least 3 meters between the router (Or other wireless equipment) and the Surround Hub.
- Avoid having walls between the Surround Hub and the speakers.
- Avoid having the router placed in between the Surround Hub and the speakers.

#### **Check Wi-Fi settings**

- Try to avoid MESH networks.
- Instead, try to connect to a 2.4GHz Wi-Fi network.
- Try to avoid having a too high bandwidth, aim for 20MHz or 40MHz if possible.

### **Power cycling**

Sometimes after a software update, it can be a good idea to power cycle the unit:

1. Turn off the unit.
2. Wait for 30 seconds before returning power to the unit.

### **Factory reset**

If you for some reason need to factory reset the Surround Hub, it can be done in two ways:

- Select 'System reset' from the OSD menu
- Press the pinhole button on the REAR of the Surround Hub.

## **Safety & Warnings**

### **Important Safety Instructions**

1. Read these instructions.
2. Keep these instructions.
3. Heed all warnings.
4. Follow all instructions.

5. Do not use this apparatus near water.
6. Clean only with a dry cloth.
7. Do not block any ventilation openings. Install by the manufacturer's instructions.
8. Do not install near any heat sources such as radiators, heat registers, stoves, or other apparatus (including amplifiers) that produce heat.
9. Do not defeat the purpose of the safety purpose of the polarized or grounding-type plug. A polarized plug has two blades one wider than the other. A grounding type plug has two blades and a grounding plug. The wide blade or the third plug is provided for your safety. If the provided plug does not fit into our outlet, consult an electrician for replacement of the obsolete outlet.
10. Protect the power cord from being walked on or pinched, particularly plugs, convenience receptacles, and the point where they exit from the apparatus.
11. Only use attachments/accessories specified by the manufacturer.
12. Use only with the cart, stand, tripod, bracket, or table specified by the manufacturer, or sold with the apparatus.  
When a cart is used, use caution when moving the cart/apparatus combination to avoid injury from tip-over.
13. Unplug this apparatus during lightning storms or when unused for a long period of time.
14. Refer all servicing to qualified service personnel. Servicing is required when the apparatus has been damaged in any way, such as power supply is cold or the plug is damaged, liquid has been spilled or an object has fallen into the apparatus, the apparatus has been exposed to rain or moisture, does not operate normally, or has been dropped.

### Warning

To reduce the risk of fire or electric shock, do not expose this apparatus to rain or moisture. The apparatus shall not be exposed to dripping or splashing, and no objects filled with liquids, such as vases, shall be placed on the apparatus.

This symbol is intended to alert the user to the presence of important operating and maintenance instructions in the literature accompanying this product.

### Legal information



Chromecast built-in is a trademark of Google LLC. The Spotify software is subject to third-party licenses found here: <http://developer.spotify.com/esdk-third-party-licenses/>. The Bluetooth word mark and logos are registered trademarks owned by Bluetooth SIG, Inc., and any use of such marks by Lithe is under license. Other trademarks and trade names are those of their respective owners.

- **Company Information:** Lithe Audio Ltd Unit 4 iO Centre Salfords Surrey RH15GJ United Kingdom
- **For documentation and other information see:** <https://support.litheaudio.com/>

### Documents / Resources

	<p><a href="#">LITHEAUDIO 5.1 Wireless In Ceiling Surround Sound Hub</a> [pdf] User Guide  5.1 Wireless In Ceiling Surround Sound Hub, Wireless In Ceiling Surround Sound Hub, In Ceiling Surround Sound Hub, Surround Sound Hub, Sound Hub, Hub</p>
---	--

## References

-  [Platin Audio](#)
-  [support.litheaudio.com/](https://support.litheaudio.com/)
- [User Manual](#)

### Manuals+, Privacy Policy

This website is an independent publication and is neither affiliated with nor endorsed by any of the trademark owners. The "Bluetooth®" word mark and logos are registered trademarks owned by Bluetooth SIG, Inc. The "Wi-Fi®" word mark and logos are registered trademarks owned by the Wi-Fi Alliance. Any use of these marks on this website does not imply any affiliation with or endorsement.