



SCR054 Remote Control for Commissioning Litetronics IR-Enabled Sensor User Guide

[Home](#) » [Litetronics](#) » SCR054 Remote Control for Commissioning Litetronics IR-Enabled Sensor User Guide 

SCR054 Remote Control for Commissioning Litetronics IR-Enabled Sensor User Guide



REMOTE CONTROL FOR COMMISSIONING LITETRONICS “NEXT GENERATION” LITESMART IR-ENABLED SENSOR

Ordering Code: SCR054

Compatible with LifeSmart IR sensor products (Specified Pre-Installed Panels & Kits) and Pluggable High Bay Sensor SC008

DESCRIPTION

The SCR054 is a wireless, hand-held configuration tool, compatible with Pre-Installed Bluetooth Sensors on Litetronics LifeSmart Panels and Retrofit Kits, and Pluggable IR High Bay Sensor SC008. The tool enables device modifications to be made within the building, easily programming and commissioning fixtures with LifeSmart Bluetooth sensors.

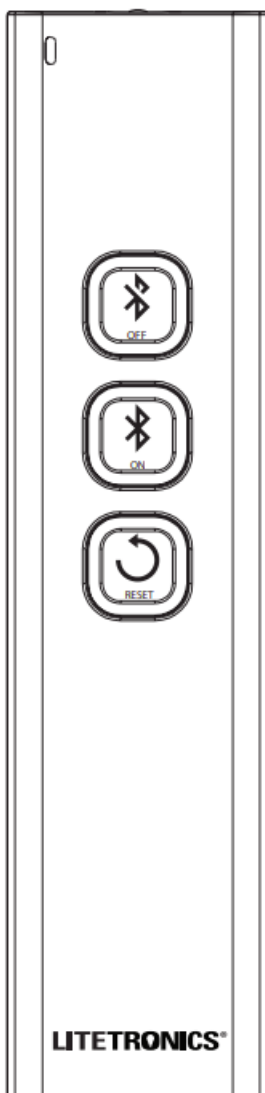

Contents

- [1 SPECIFICATIONS](#)
- [2 BLUETOOTH OFF BUTTON](#)
- [3 BLUETOOTH ON/ADD FIXTURE BUTTON](#)
- [4 RESET BUTTON](#)
- [5 Documents / Resources](#)
- [6 Related Posts](#)

SPECIFICATIONS

- **Power supply:** 2 AAA 1.5V batteries. Alkaline.
- **Dimensions:** 1.18" x 4.92" x 59"

IN THE BOX

Remote Control (SCR054) Batteries Not Included

SCR054 REMOTE CONTROL OPERATION GUIDE

BLUETOOTH OFF BUTTON

Use this to disable Bluetooth signal manually and temporarily.

Application

Once the fixture installation process has been completed, pushing this button will disable the Bluetooth functionality of the fixture or network of fixtures in one area. All fixtures will not be listed in the "Add fixture" page on the LiteSmart app **see figure 1.1 and figure 1.2.**

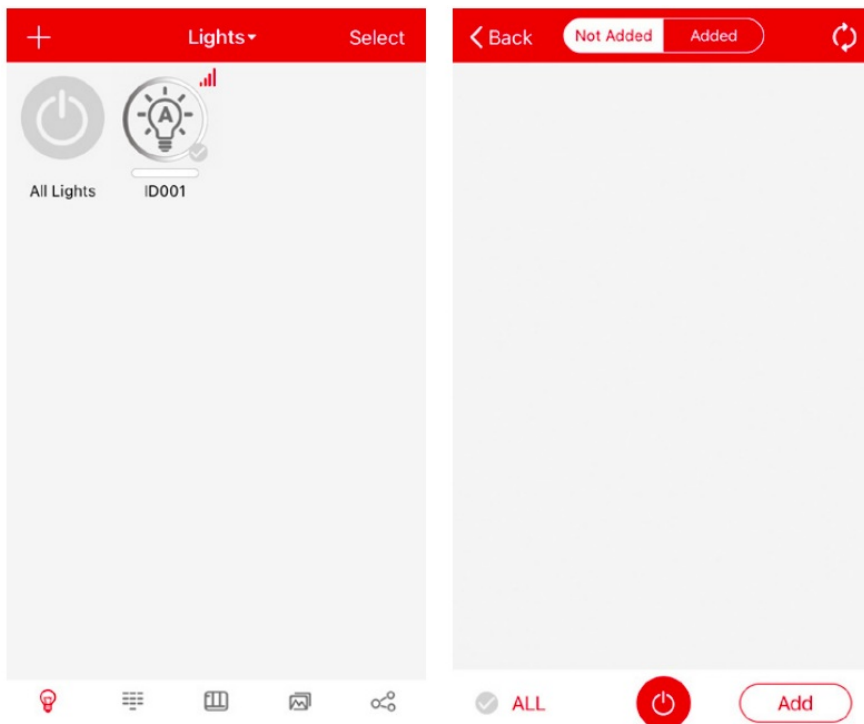

To disable Bluetooth signal (assure that fixtures are energized), do the following:

1. Directly point remote towards IR sensor
2. Press the Bluetooth "Off" button.
3. Wait for fixture to flash three (3) times for confirmation.

Note: Disabling the Bluetooth signal is not possible if the fixtures have already been added to a network via app. The fixture(s) must be Reset first and then disable the Bluetooth signal. See Reset Button details below.

BLUETOOTH ON/ADD FIXTURE BUTTON

Use this to manually enable and add fixtures via IR signal and Bluetooth signal.

Application

Having disabled the Bluetooth signal by pressing the “Bluetooth Off” button, point the IR remote to a specific fixture. Pushing the “Bluetooth ON” button will now enable the Bluetooth signal of that specific fixture. In the LiteSmart app, go to the “Add” fixtures page where the fixture will be listed **see figure 1.3**

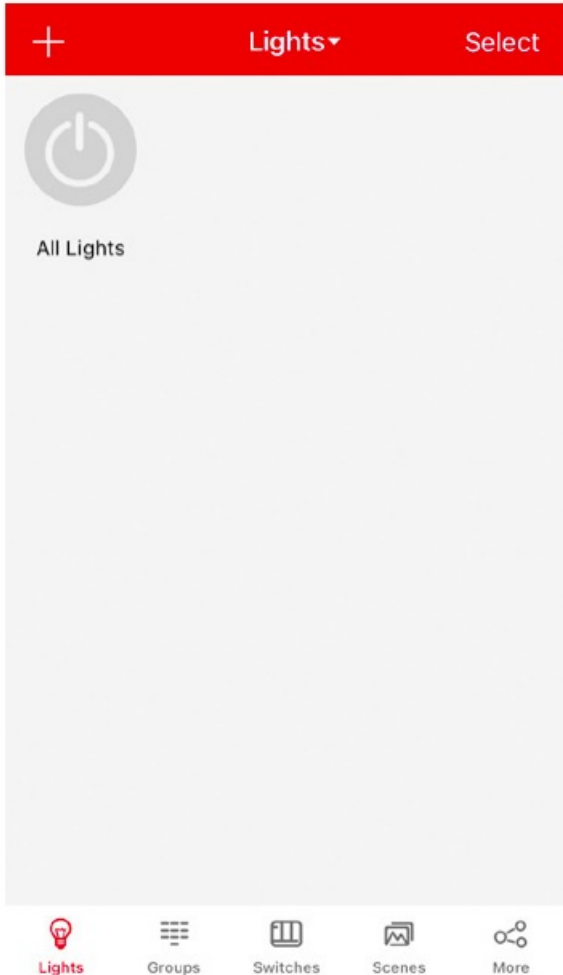

To add fixtures one by one, (assure that the fixtures are energized), do the following:

1. Directly point remote towards IR sensor of the chosen fixture.
2. Press the Bluetooth “On” button.
3. Wait for fixture to flash three (3) times for confirmation.
4. On the LiteSmart app, check to make sure fixture has been added by tapping the “+” on the top left-hand corner on the fixtures page **see figure 1.4**.

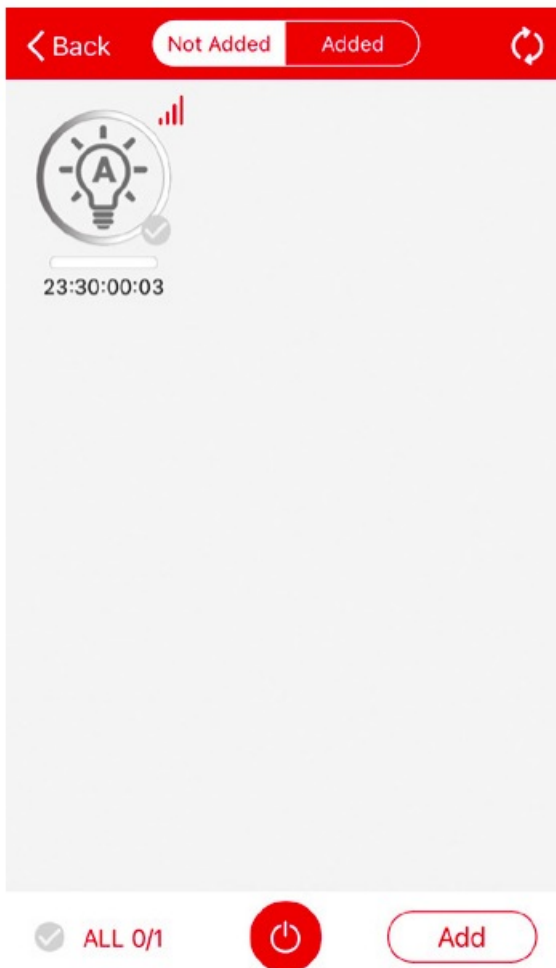

5. To confirm fixture enablement in the LiteSmart app, tap the check box icon to select the fixture (turns red when selected) then tap “Add” button at the bottom right corner of the screen see **figure 1.5**. The fixture will flash once (1), and a “Fixture Added” confirmation message will appear **see figure 1.6**.

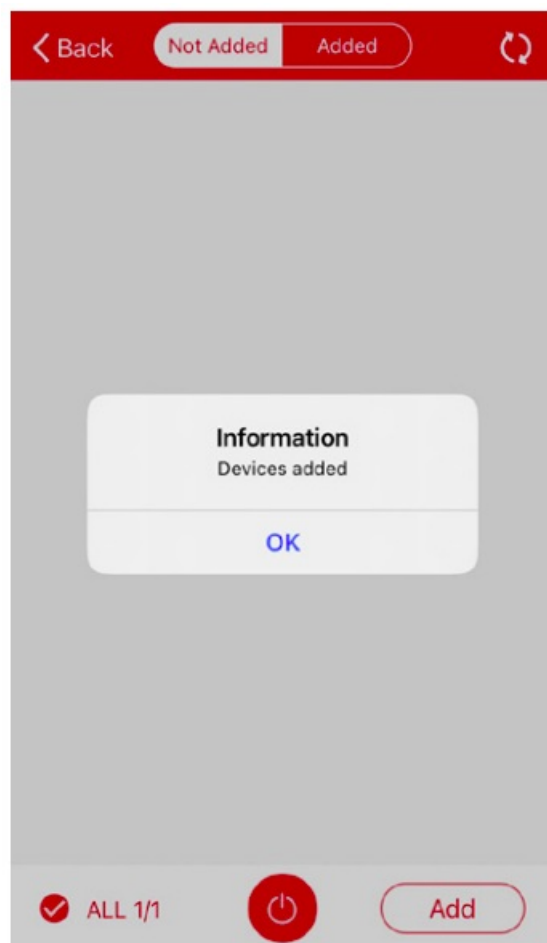
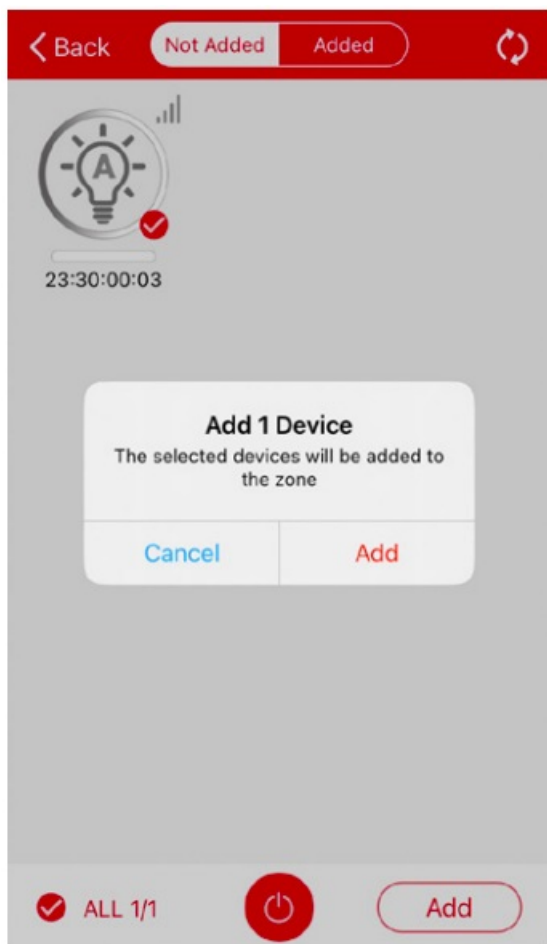

RESET BUTTON

Use this to manually reset, or when a fixture has been previously commissioned and needs to be reset the fixture(s) to its factory default settings.

Application

If a specific fixture MAC ID address has been lost, or the fixture is unsearchable on the LiteSmart app “add” page **see figure 1.7**, a reset is required. To reset a fixture, do the following:

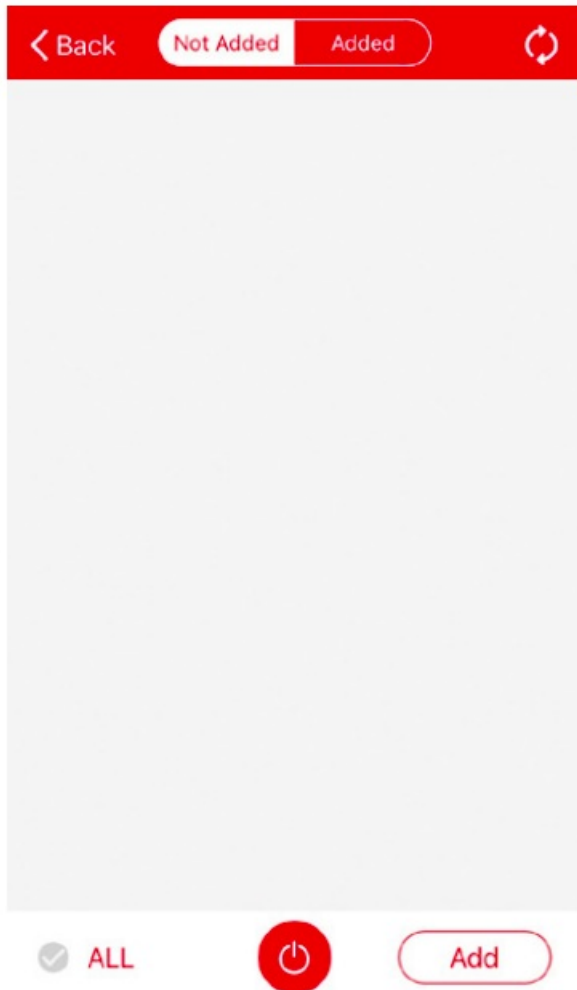

1. Point the remote to that fixture, hold down the RESET button for five (5) seconds.
2. Fixture will flash three (3) times for confirmation.
3. The fixture should now be found and added in the LiteSmart app “add fixture” page **see figure 1.8**. Refer to Bluetooth ON Button instructions above.

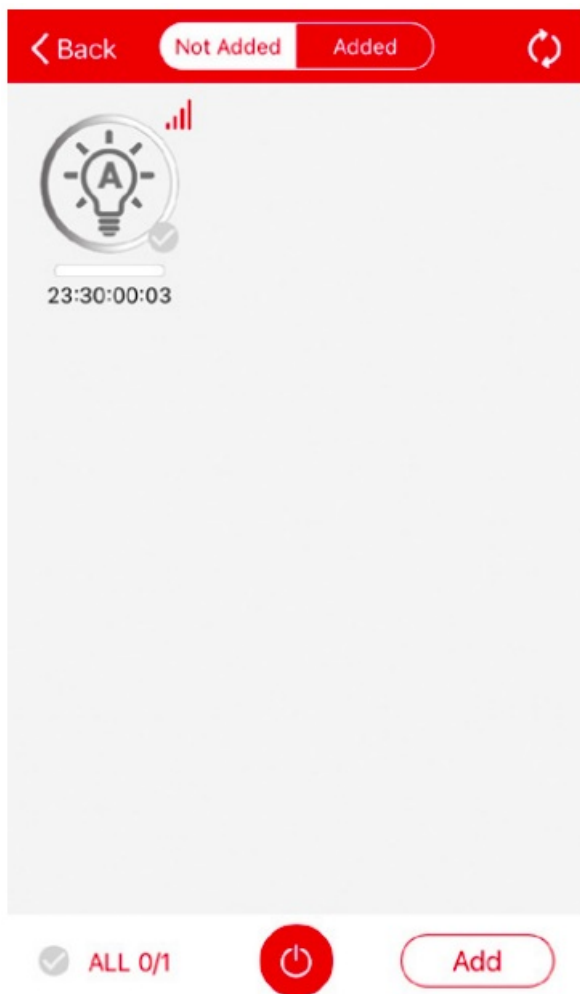

Thank you for choosing
6969 W. 73rd Street
Bedford Park, IL 60638
WWW.LITETRONICS.COM
CustomerService@Litetronics.com or
1-800-860-3392



LITETRONICS®

Documents / Resources

	<p>LITETRONICS SCR054 Remote Control for Commissioning Litetronics IR-Enabled Sensor [pdf] User Guide SCR054, SC008, SCR054 Remote Control for Commissioning Litetronics IR-Enabled Sensor, Remote Control for Commissioning Litetronics IR-Enabled Sensor, Commissioning Litetronics IR-Enabled Sensor, IR-Enabled Sensor, Sensor</p>
--	--

