



## LITETRONICS SC010 Plug In Bluetooth PIR Sensor with IR Instruction Manual

[Home](#) » [Litetronics](#) » LITETRONICS SC010 Plug In Bluetooth PIR Sensor with IR Instruction Manual 

### LITETRONICS SC010 Plug In Bluetooth PIR Sensor with IR Instruction Manual



#### For use with:

- Light Panel (PT\*S)
- Light Panel Retrofit (PRT\*S)
- Strip Fixture (SFS\*)

## Contents

- 1 Installation Instructions
- 2 PANEL INSTALLATION – PT\*S
- 3 STRIP FIXTURES INSTALLATION – SFS\*
- 4 PANEL RETROFIT INSTALLATION – PRT\*S
- 5 SENSOR COVERAGE
- 6 SENSOR DEFAULT SETTINGS
- 7 Documents / Resources
  - 7.1 References

## Installation Instructions

The SC010 plug-in PIR sensor enables wireless control of fixtures, or groups of fixtures, through the Lite Smart mobile app.



Lite Smart\* offers complete control over your fixtures; includes occupancy sensing, daylight harvesting, dimming, grouping, time schedule programming and scene creation.

Lite Smart is available in the app store for download to either IOS or Android devices.



**These Bluetooth control and switches offer control of your fixtures wirelessly.**

Bluetooth Control and Switches – Available for purchase from Litetronics under parts # SCR054, BCS03 or BCS05.

\* A detailed user guide for LiteSmart can be viewed or downloaded from [www.litetronics.com/resources/downloads/litesmart-mobile-app-user-guide](http://www.litetronics.com/resources/downloads/litesmart-mobile-app-user-guide)

## PANEL INSTALLATION – PT\*S

Installing the SC010 sensor is quick and simple.

- Before installation, always turn off the power from main circuit first!

1. To remove sensor cover, use a flat screw driver at sensor COVER notch and gently pull out cover from frame (Figure 1).

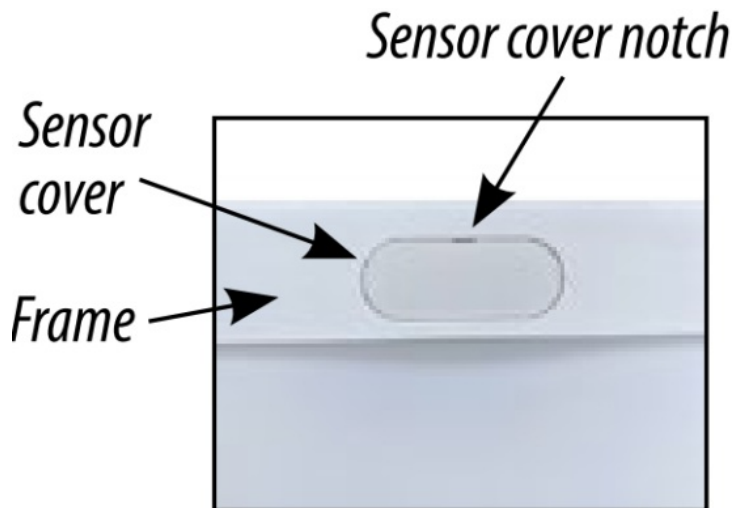

2. Pull out wires with quick connector from frame and connect sensor (Figure 2).

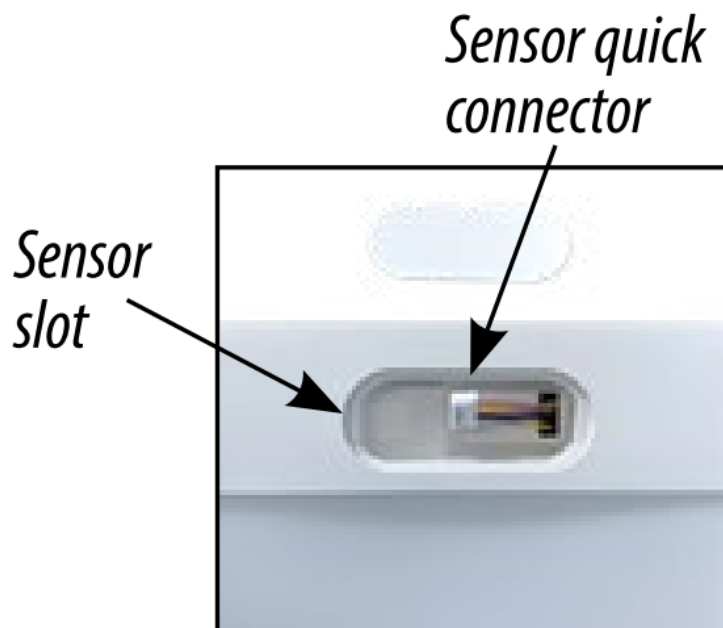

3. Clip sensor into sensor slot and snap into frame (Figure 3).



4. Restore power, your installation is complete.

## STRIP FIXTURES INSTALLATION – SFS\*

For strip fixture SFS\* sensor installation, follow sensor box SFASB1 (sold separately) for instructions.

## PANEL RETROFIT INSTALLATION – PRT\*S

Installing the SC010 sensor is quick and simple.

- Before installation, **always turn off the power from main circuit first !**
1. To remove sensor cover, on front of panel press on center of the cover, and gently push out cover until it clears the frame (**Figure 1**).

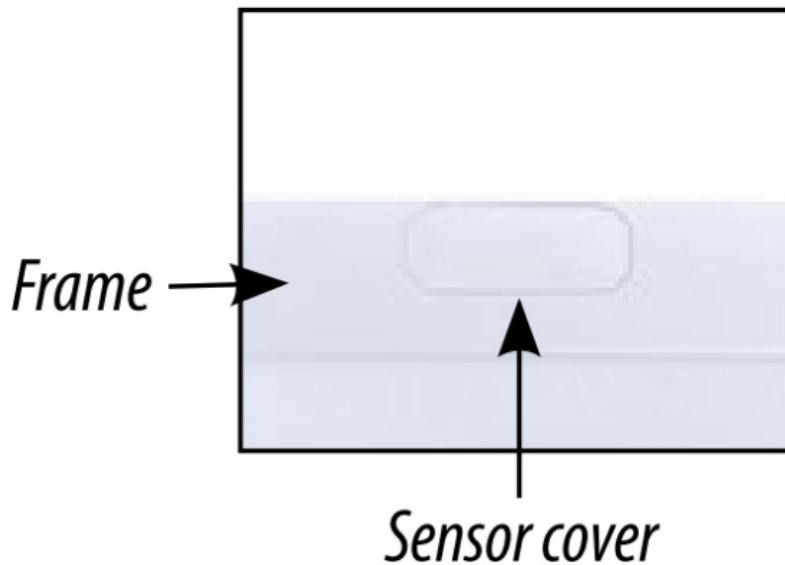

2. Pull wires with quick connector from driver and connect sensor (**Figure 2**).

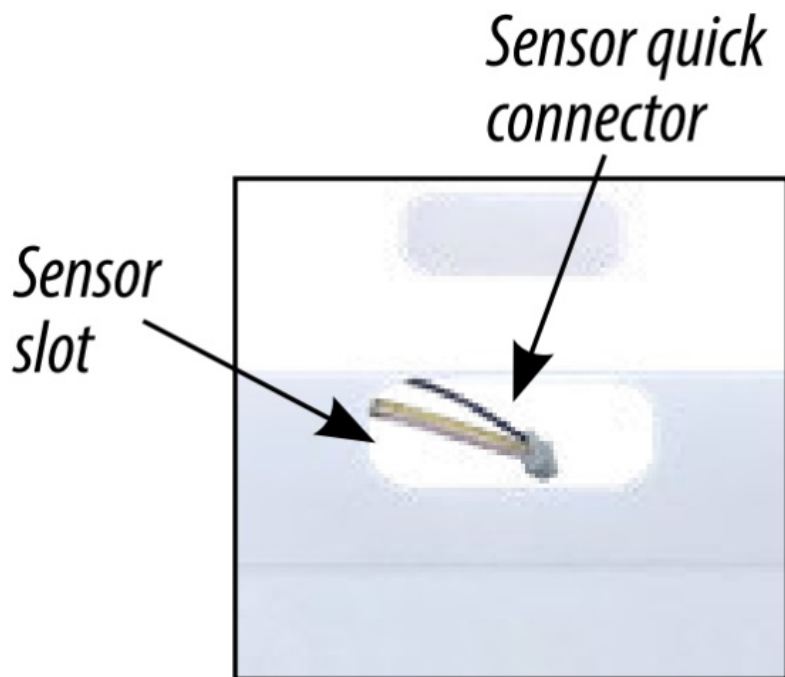

3. Clip sensor into sensor slot and snap into frame (**Figure 3**).



4. Restore power, your installation is complete.

For sensor coverage and default settings, see reverse side.

**SENSOR COVERAGE**

**Coverage Side View**

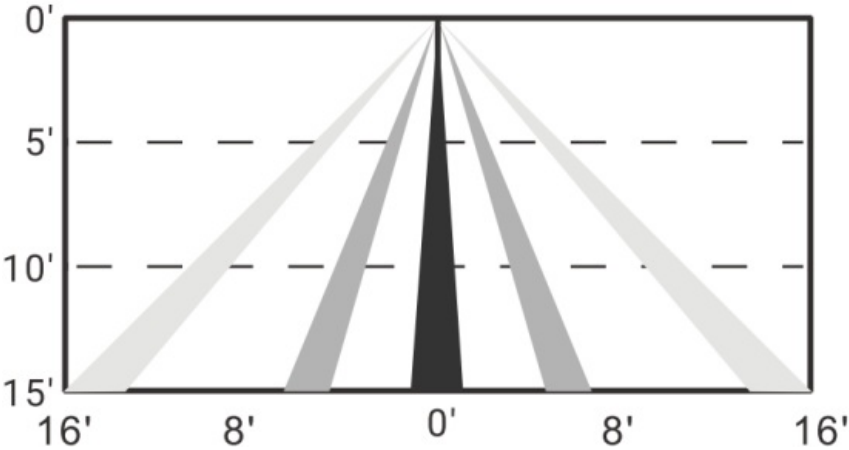

**Coverage Top View**

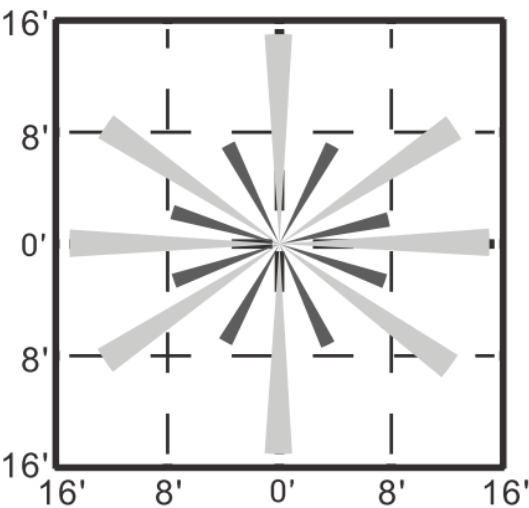

**SENSOR DEFAULT SETTINGS**

ON/OFF	1ST TIME DELAY	2ND TIME DELAY	DIM LEVEL %
On	20 minutes	1 minute	50%

Thank you for choosing.

**LITETRONICS®**

6969 W. 73rd Street  
Bedford Park, IL 60638

[WWW.LITETRONICS.COM](http://WWW.LITETRONICS.COM)

[CustomerService@Litetronics.com](mailto:CustomerService@Litetronics.com) or 1-800-860-3392



The information and product specifications contained in these instructions are based upon data believed to be accurate at the time of printing. This information is subject to change without notice and without incurring liability. If you have questions regarding specific product details, please contact us at [800-860-3392](tel:800-860-3392) or via email at [customerservice@litetronics.com](mailto:customerservice@litetronics.com). To check for an updated version of these instructions, please visit [www.litetronics.com](http://www.litetronics.com).

**LITETRONICS®**

## Documents / Resources

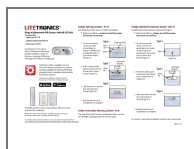

[LITETRONICS SC010 Plug In Bluetooth PIR Sensor with IR](#) [pdf] Instruction Manual  
SC010, SFASB1, SC010 Plug In Bluetooth PIR Sensor with IR, SC010, Plug In Bluetooth PIR Sensor with IR, Bluetooth PIR Sensor with IR, PIR Sensor with IR, Sensor with IR, IR

## References

- [Commercial Lighting Company | LED Lighting Solutions](#)
- [User Manual](#)

[Manuals+](#), [Privacy Policy](#)

This website is an independent publication and is neither affiliated with nor endorsed by any of the trademark owners. The "Bluetooth®" word mark and logos are registered trademarks owned by Bluetooth SIG, Inc. The "Wi-Fi®" word mark and logos are registered trademarks owned by the Wi-Fi Alliance. Any use of these marks on this website does not imply any affiliation with or endorsement.