



Liteline SLMT6-13W Series 6 13W Slim LED MULTI Color Selectable Downlight User Guide

[Home](#) » [Liteline](#) » Liteline SLMT6-13W Series 6 13W Slim LED MULTI Color Selectable Downlight User Guide 

Contents

- [1 Liteline SLMT6-13W Series 6 13W Slim LED MULTI Color Selectable Downlight](#)
- [2 Product Usage Instructions](#)
- [3 INCLUDED COMPONENTS](#)
- [4 REQUIRED COMPONENTS](#)
- [5 INSTALLATION INSTRUCTIONS](#)
- [6 Documents / Resources](#)
 - [6.1 References](#)



Liteline SLMT6-13W Series 6 13W Slim LED MULTI Color Selectable Downlight



Product Information

The SLIMLED MULTI 6 (SLMT6-13W Series) is a slim LED fixture designed for various lighting applications. It is

suitable for retrofit installation and can be used with compatible recessed housings. The product comes with a lifetime warranty and is manufactured by Liteline, a reputable lighting company.

Product Features:

- Energy-efficient LED technology
- Slim design for easy installation
- Compatible with 3.5 / 4 junction boxes
- Twist-and-lock trim ring for secure attachment
- Butterfly clips for securing the luminaire
- Medium base adaptor for recessed housing compatibility
- Quick connector for easy wire installation
- Ground wire for safety

Safety Precautions:

Before installing or attempting any maintenance on the fixture, make sure to read and understand all the instructions provided in the user manual. To ensure safety, the fixture must be wired according to local electrical codes and ordinances, and all work should be done by a qualified electrician. Always turn off the power from the electrical panel before starting any installation or maintenance.

Product Usage Instructions

Installation Instructions:

1. Attach the metal mounting plate onto the junction box using the provided screws.
2. Secure the butterfly clips to the luminaire using the two screws provided.
3. Insert the wires from the SLMT6 luminaire into the quick connector.
4. Connect the white wire (Fil blanc) from the luminaire to the white wire in the junction box.
5. Connect the black wire (Fil noir) from the luminaire to the black wire in the junction box.
6. Connect the yellow-green wire (Fil jaune-vert) from the luminaire to the ground wire in the junction box.
7. Secure the medium base adaptor into the socket in the recessed housing.
8. Attach the twist-and-lock trim ring onto the luminaire for a secure fit.

Note: The installation instructions provided are general guidelines. Always refer to the specific instructions provided with your product for accurate and detailed installation steps.

SEMI-RECESSED-MOUNT (JUNCTION BOX)

IMPORTANT: Read all instructions before installing fixtures.
Retain for future reference.

SAFETY: For your safety, this fixture must be wired in accordance to local electrical codes and ordinances. All work should be done by a qualified electrician.

WARNING: Make certain power is OFF from the electrical panel before starting installation or attempting any maintenance.

INCLUDED COMPONENTS

- 1 × SlimLED 6" Multi fi xture
- 1 × Trim ring
- 1 × Metal mounting plate
- 2 × 8-32 screws with silicone washer
- 3 × Wire connectors

INSTALLATION INSTRUCTIONS (3.5 / 4" JUNCTION BOX):

1. Attach the metal mounting plate onto the junction box with appropriate 8/32" bolts.

NOTE: Ensure proper orientation of mounting plate. One side is labelled "This side facing the room". Make the electrical connections. Connect the ground wires (yellow-green/green).

Connect the neutral wires (white). Connect the live wires (black) [Fig. 1 and Fig. 2].

2. Attach the fi xture to the metal mounting plate by centering the fixture onto the mounting plate and pressing fi rmly so that the spring clips latch [Fig. 2].
3. Select desired color temperature using the selector button at the side of the fi xture (preset to 2700 K).
4. Install the selected trim ring . Install by twist-and-lock [Fig. 3].
5. Turn on the power for testing.

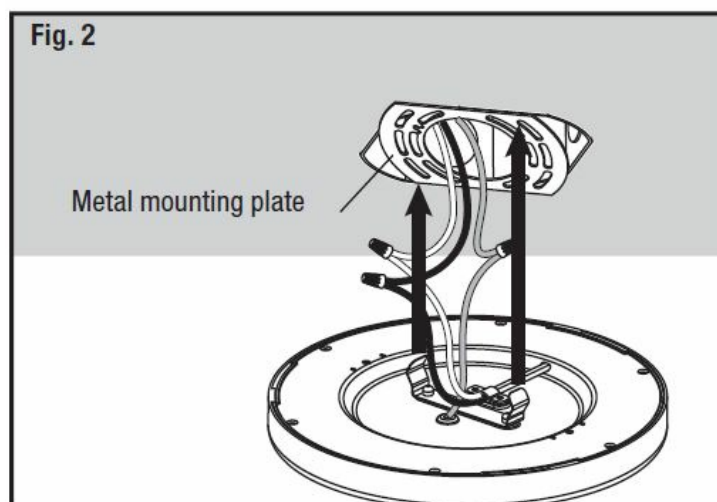
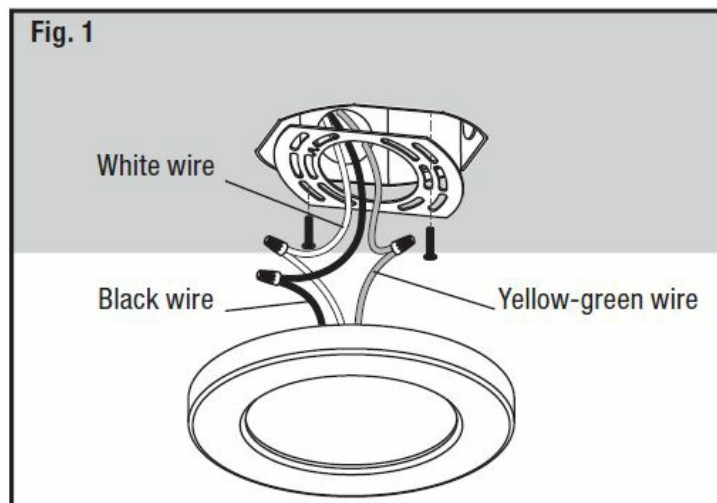

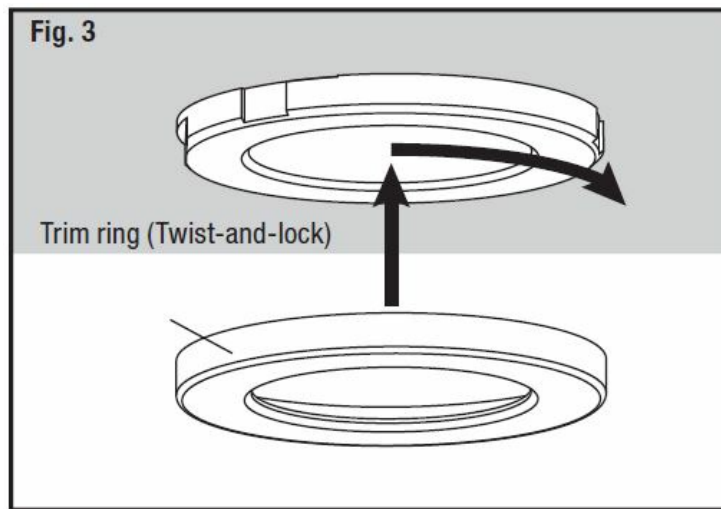

RECESSED CAN RETROFIT MOUNT (REQUIRES RETROFIT INSTALLATION KIT, P/N: P-SLMT6-6CAN)

IMPORTANT: Read all instructions before installing fixtures. Retain for future reference.

WARNING: Make certain power is OFF from the electrical panel before starting installation or attempting any maintenance.

WARNING – RISK OF FIRE OR ELECTRIC SHOCK

- LUMINAIRE WIRING, POWER SUPPLY, OR OTHER ELECTRICAL PARTS MAY BE DAMAGED WHEN DRILLING FOR INSTALLATION OF RETROFIT KIT HARDWARE. INSPECT WIRING AND COMPONENTS FOR DAMAGE. TO PREVENT WIRING DAMAGE OR ABRASION, DO NOT EXPOSE WIRING TO EDGES OF SHEET METAL OR OTHER SHARP OBJECTS.
- INSTALLATION OF THIS RETROFIT KIT REQUIRES A PERSON FAMILIAR WITH THE CONSTRUCTION AND OPERATION OF THE LUMINAIRE'S ELECTRICAL SYSTEM AND THE HAZARD INVOLVED. IF NOT QUALIFIED, DO NOT ATTEMPT INSTALLATION. CONTACT A QUALIFIED ELECTRICIAN.
- INSTALL THIS KIT ONLY IN THE LUMINAIRE THAT HAS THE CONSTRUCTION FEATURES AND DIMENSIONS SHOWN IN THE PHOTOGRAPHS AND/OR DRAWINGS AND WHERE THE INPUT RATING OF THE RETROFIT KIT DOES NOT EXCEED THE INPUT RATING OF THE LUMINAIRE. ONLY THOSE OPEN HOLES INDICATED IN THE PHOTOGRAPHS AND/OR DRAWINGS MAY BE MADE OR ALTERED AS A RESULT OF KIT INSTALLATION. DO NOT LEAVE ANY OTHER OPEN HOLES IN AN ENCLOSURE OF WIRING OR ELECTRICAL COMPONENTS.

THE RETROFIT KIT IS ACCEPTED AS A COMPONENT OF A LUMINAIRE WHERE THE SUITABILITY OF THE COMBINATION SHALL BE DETERMINED BY AUTHORITIES HAVING JURISDICTION. PRODUCT MUST BE INSTALLED BY A QUALIFIED ELECTRICIAN IN ACCORDANCE WITH THE APPLICABLE AND APPROPRIATE ELECTRICAL CODES. THE INSTALLATION GUIDE DOES NOT SUPERSEDE LOCAL OR NATIONAL REGULATIONS FOR ELECTRICAL INSTALLATIONS.

ATTENTION: MUST ASSEMBLE WITH KIT P-SLMT6-6CAN FOR RETROFIT INSTALLATION.

FITS MOST 6" HOUSINGS, MINIMUM 5½" DEEP. COMPATIBLE WITH 6" LITELINE HOUSINGS (RF601ICAT, RF602ICAT).

REQUIRED COMPONENTS

SLMT6 Luminaire, P/N: SLMT6-13W

Retrofit Installation Kit, P/N: P-SLMT6-6CAN, containing:

- 1 × Medium base adapter with quick connector
- 1 × Quick connector
- 2 × Butterfly spring clips
- 2 × Butterfly spring clip screws
- 1 × Terminal ring with 6" lead wire
- 1 × Wire connector

INSTALLATION INSTRUCTIONS

1. Secure the butterfly clips to the luminaire with the two screws provided [Fig. 4].
2. Secure the medium based adaptor into socket in recessed housing [Fig. 5].
3. Insert the wires from the SLMT6 luminaire to the quick connector. Connect the live (black) wire to the marked slot of the quick connector [Fig. 6].
4. Connect the ground wire to the included terminal ring with 6" lead wire with wire connector. Secure the terminal ring to the recessed housing using the provided self-tapping screw. Use 1/8" drill bit to drill the hole on the recessed housing for the self-tapping screw. (Hook up the light with the medium base adapter by the quick connectors) [Fig. 6 and Fig. 7].
5. Squeeze spring clips and install the luminaire in recessed housing. Make sure the luminaire is centered in recessed housing [Fig. 7].
6. Select desired color temperature using the selector button at the back of the fixture (preset to 2700 K) [Fig. 2].
7. Install the selected trim ring by twist-and-lock [Fig. 8].
8. Turn on the power for testing.

Fig. 4

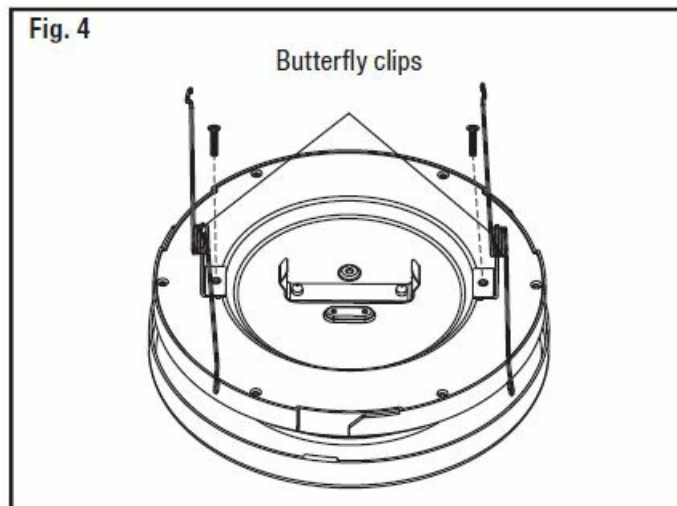
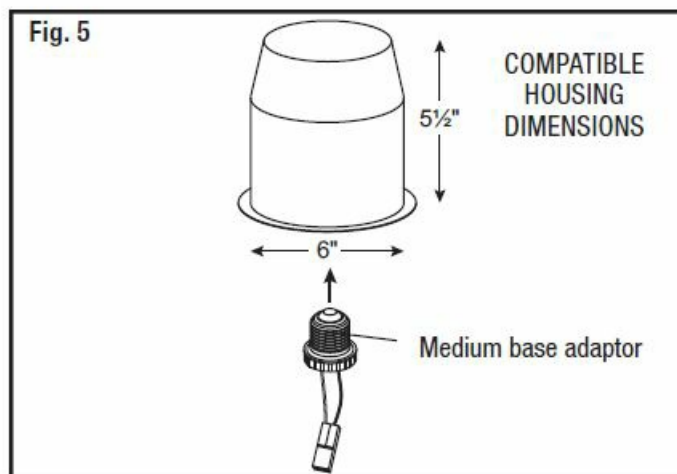
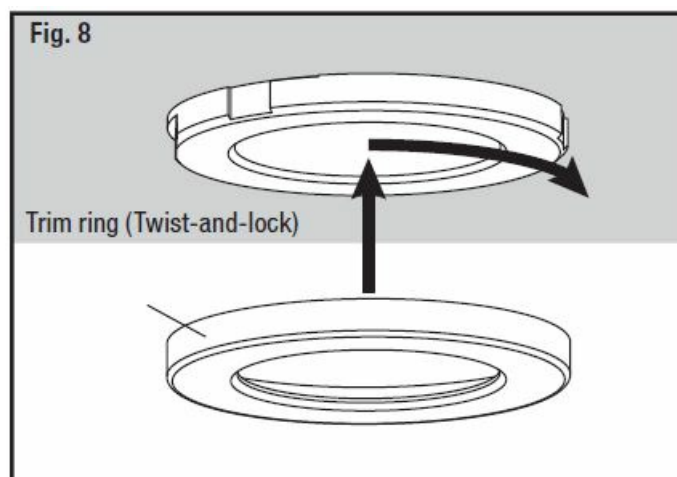
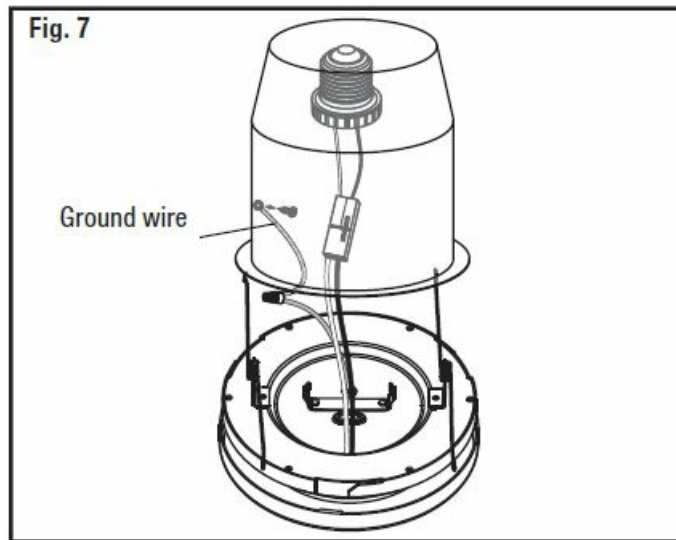
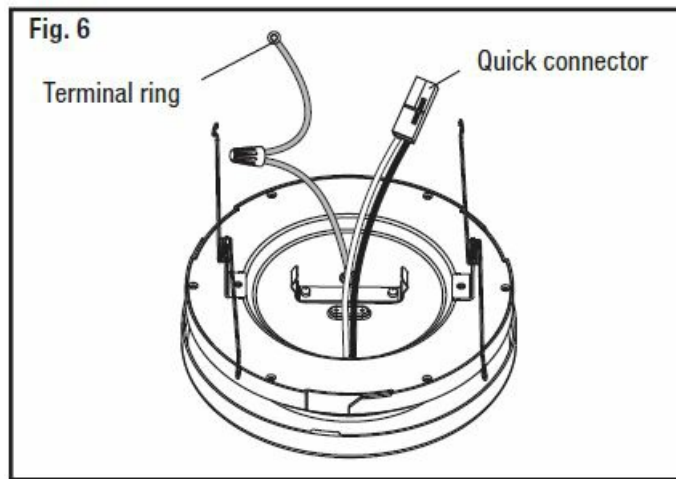

Fig. 5





The following importer is the responsible party:
LLC Sales, Inc. DBA Liteline USA
1209 Orange Street, Wilmington, DE, 19801
liteline.com/contact-us

This device complies with part 15 of the FCC Rules. Operation is subject to the following two conditions: (1) This device may not cause harmful interference, and (2) this device must accept any interference received, including interference that may cause undesired operation.

Note: This equipment has been tested to comply with the limits for a Class B digital device, pursuant to part 15 of the FCC Rules. These limits are designed to provide reasonable protection against harmful interference in a

residential installation. This equipment generates, uses and can radiate radio frequency energy and, if not installed and used in accordance with the instructions, may cause harmful interference to radio communications. However, there is no guarantee that interference will not occur in a particular installation. If this equipment does cause harmful interference to radio or television reception, which can be determined by turning the equipment off and on, the user is encouraged to try to correct the interference by one or more of the following measures: (1) reorient or relocate the receiving antenna; (2) increase the separation between the equipment and receiver; (3) connect the equipment into an outlet on a circuit different from that to which the receiver is connected; consult the dealer or an experienced radio/TV technician for help.

Changes or modifications not expressly approved by the responsible party could void the user's authority to operate the equipment.

For more information on our lifetime warranty, please visit www.liteline.com/goldlabel

Liteline Corporation
Copyright © 2022
All rights reserved.

Telephone
416.996.1856
1.866.730.7704

Fax
905.709.5255
1.888.738.9736

LITELINE.COM

Documents / Resources

	<p>Liteline SLMT6-13W Series 6 13W Slim LED MULTI Color Selectable Downlight [pdf] User Guide</p> <p>SLMT6-13W Series 6 13W Slim LED MULTI Color Selectable Downlight, SLMT6-13W Series, 6 13W Slim LED MULTI Color Selectable Downlight, Slim LED MULTI Color Selectable Downlight, LED MULTI Color Selectable Downlight, Color Selectable Downlight, Selectable Downlight</p>
---	---

References

- [Liteline - Contact Us for help with your lighting needs.](#)
- [Liteline - Description of our product Warranty](#)