



LIT by CARDI LUPAL06 LED Panel Instruction Manual

[Home](#) » [LIT by CARDI](#) » LIT by CARDI LUPAL06 LED Panel Instruction Manual 

Contents

- [1 LIT by CARDI LUPAL06 LED Panel](#)
- [2 Product Information](#)
- [3 Product Usage Instructions](#)
- [4 FEATURED](#)
- [5 INSTRUCTION MANUAL](#)
- [6 Manufacturer Information](#)
- [7 Documents / Resources](#)
 - [7.1 References](#)



LIT by CARDI LUPAL06 LED Panel



Product Information

- **Model:** LUPAL06
- **Manufacturer:** Sonepar Global Sourcing SA
- **Size:** 295*1195*32mm
- **Color Temperature:** 3000K/4000K
- **Power:** 32W
- **Color Rendering Index (CRI):** >80
- **Lumen Output:** 3600lm
- **Unified Glare Rating (UGR):** 19
- **Life Time:** 50000H
- **Input Voltage:** 220-240V~
- **Frequency:** 50/60Hz
- **Ingress Protection Rating:** IP20

Product Usage Instructions

1. Ensure the power switch of the panel is set to “OFF”.
2. Connect the user side wiring to the appropriate terminals on Panel-1 and Panel-2. The wiring should be done following the specified Alue/Faixa.
3. Turn on the power switch of the panel by setting it to “ON”.
4. The panel has two modes, indicated by the ON/OFF switch. Set the switch to “ON” for mode 1 and “OFF” for mode 2.
5. The color temperature can be selected using the provided options: 3000K or 4000K.
6. The panel can be mounted using the specified dimensions of 650mm x 2. Ensure proper installation and secure mounting.
7. Observe the manufacturer’s warnings and instructions regarding electrical safety and usage.

FEATURED



INSTRUCTION MANUAL

PANEL

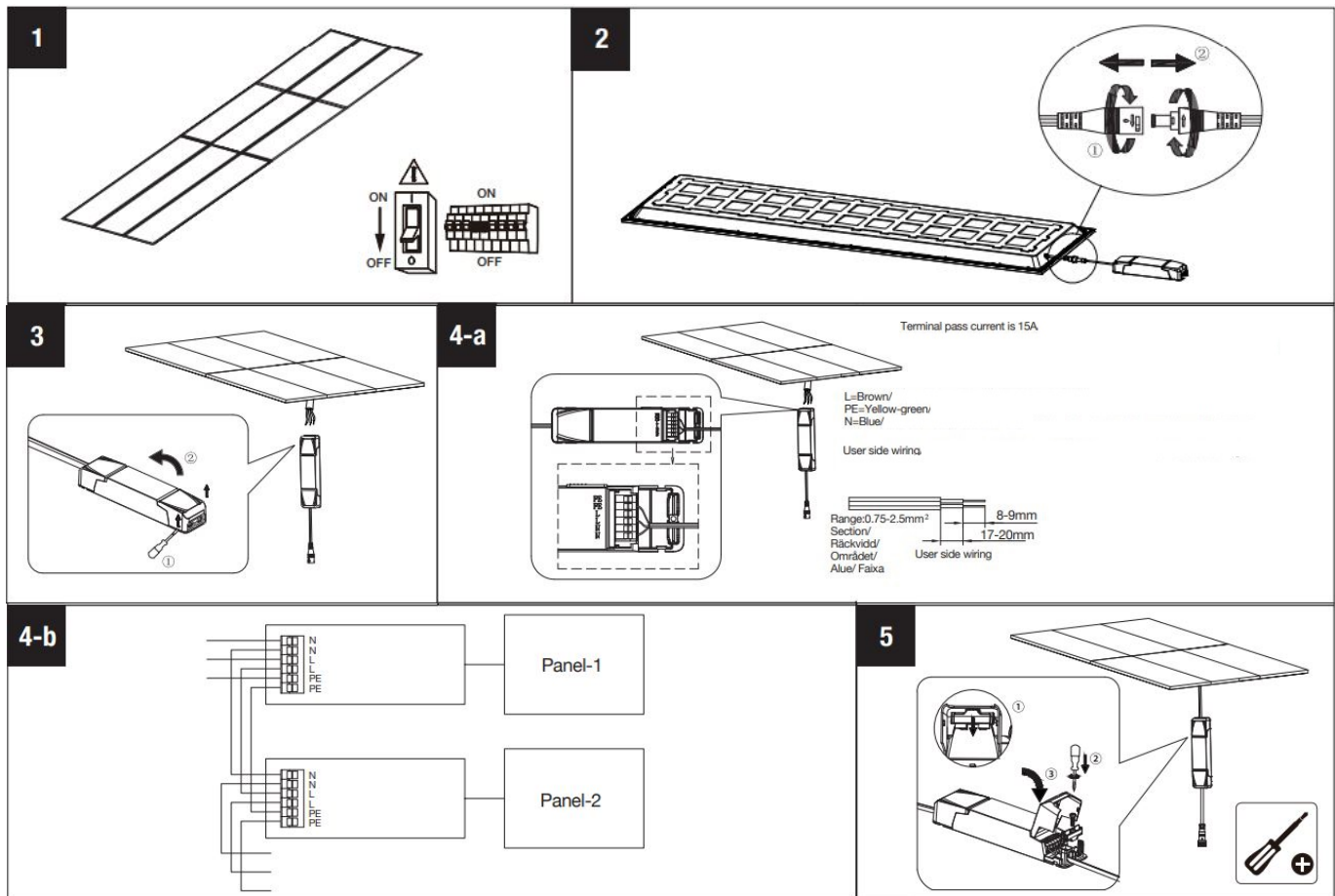

6

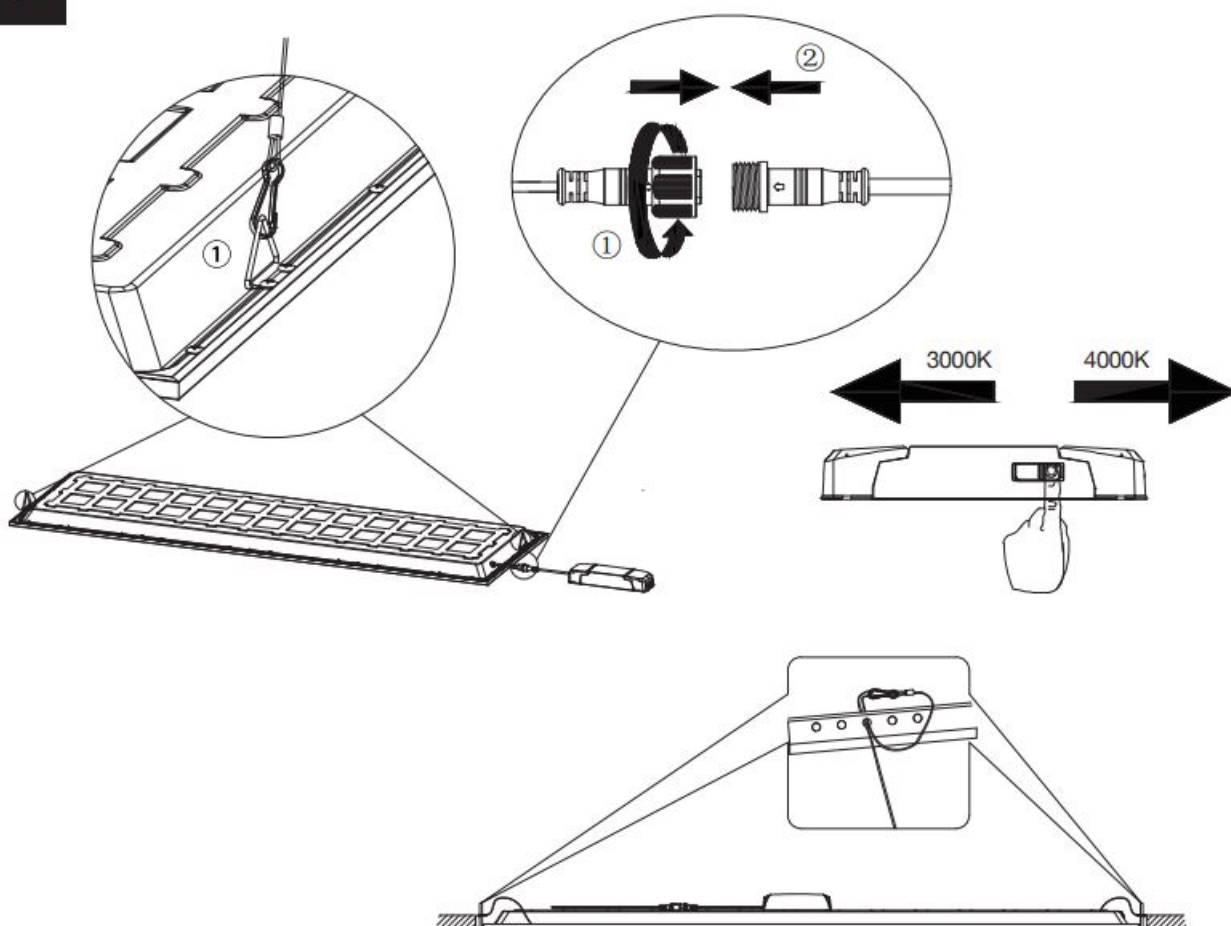

7

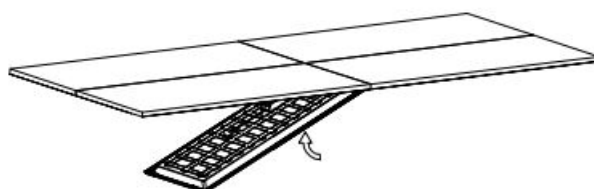

8

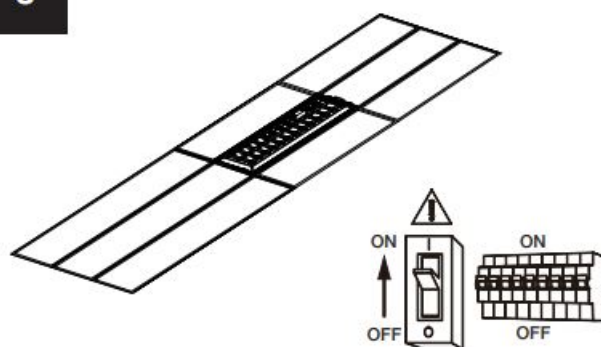

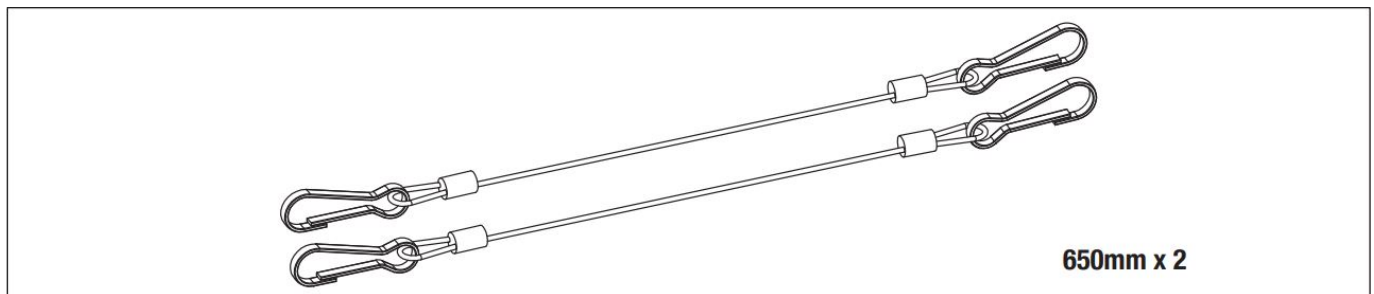

* Model	SGSO S ku	* Size	* CCT	* Powe r	* CRI	Lumen	UGR	* Life ti me	* BA
LUPAL06	00289201 30	295*1195*32m m	3000K/4000 K	32W	>80	3600lm	19	50000H	90°

- Model
- Size
- Size
- Power
- CRI
- Life time
- BA

WARNING

1. This luminaire is linkable, the maximum link power must be less than 800W.
2. Ensure that the main electrical supply is switched off before installing the luminaire.
3. This product has LED build-in, the light source of this luminaire is not replaceable; when the light source reaches its end of life the whole luminaire shall be replaced.
4. USER WIRING STANDARD: 60227 IEC 52.
5. This product contains a light source of energy efficiency class E.
6. Lamps are not suitable to be covered with insulation material.
7. This marking indicates that this product should not be disposed with other household wastes. To prevent possible harm to the environment or human health from uncontrolled waste disposal, recycle it responsibly to promote the sustainable reuse of material resources. To return your used device, please see the return and collection systems or contact the retailer where the product was purchased. They can take this product for environmental safe recycling.

Manufacturer Information

Manufacturer: Sonepar Global Sourcing SA

Address: Geneva Business Centre, Avenue des Morgines 12, CH-1213 Petit Lancy, Switzerland

Importers: www.litbycardi.com/home/where

Contact: Sonepar France Interservices, 18-20 Quai Du Point Du Jour, 92100 Boulogne-Billancourt, France

Model Number: IM-LP-BL-NDIM-DS-02-EU-V03

Documents / Resources

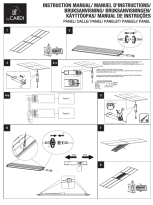

[LIT by CARDI LUPAL06 LED Panel](#) [pdf] Instruction Manual
LUPAL06 LED Panel, LUPAL06, LED Panel, Panel

References

- [Iwhere](#)