



Lionel RTPGTXV3 Ready-to-Play Train Set Addendum Instruction Manual

[Home](#) » [Lionel](#) » Lionel RTPGTXV3 Ready-to-Play Train Set Addendum Instruction Manual 

Lionel RTPGTXV3 Ready-to-Play Train Set Addendum



Contents

- [1 Adding water to your locomotive](#)
- [2 Having Trouble?](#)
- [3 FCC Statements](#)
 - [3.1 RSS Statements](#)
- [4 Documents / Resources](#)
- [5 Related Posts](#)

Adding water to your locomotive

Water can be added to your locomotive's smokestack to create a water vapor smoke effect. Follow the instructions below.

Note! The water vapor effect only works with the General engine. Do not put water in your Berkshire, thomas, 4-6-0, or Diesel locomotives.

1. Locate the water dropper included with your train set.
2. Fill your dropper with water. Be sure to secure the cap when not in use to avoid a spill.
3. Locate the black plug positioned on the top of your engine's smokestack. **Avoid adding water to any other location on your engine's smokestack to avoid operational issues.**
4. Remove the black plug and begin by squeezing 10 drops of water out of your dropper into the smokestack. Add this black plug back to its appropriate position when your train set is not in use. Refer to figure 1.

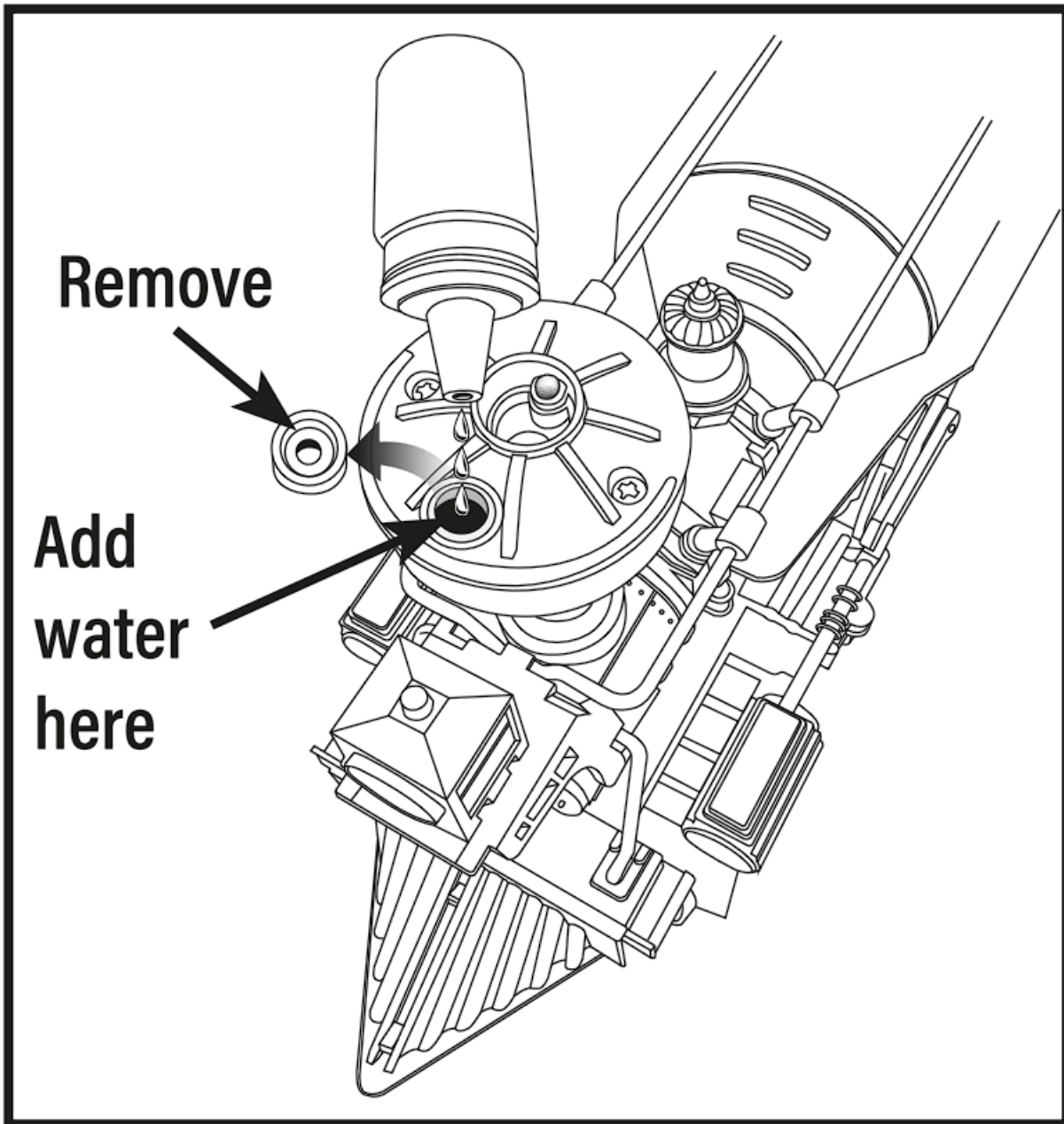

Figure 1. Add water to stack

5. Turn on your engine as shown in figure 2.

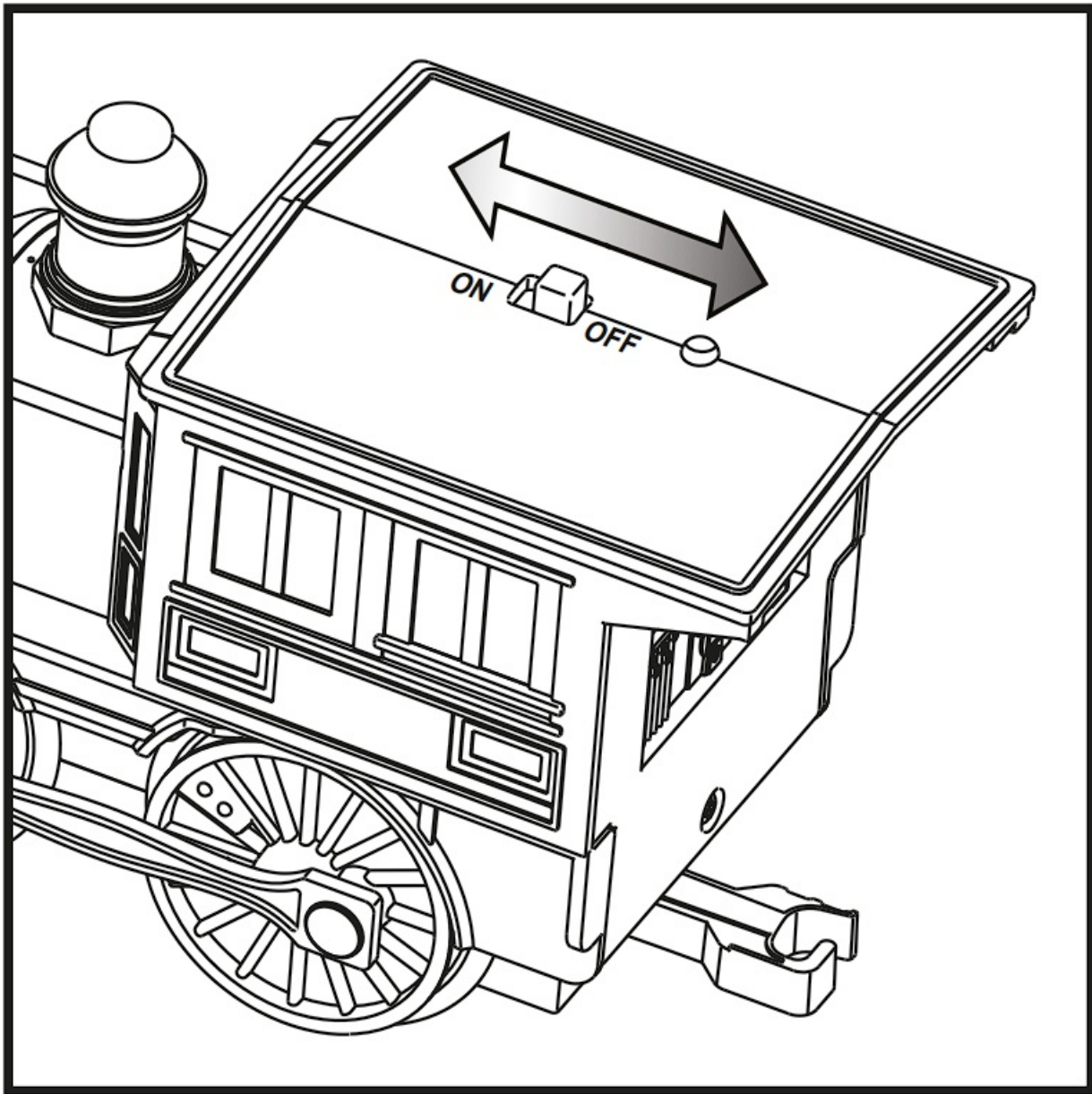

Figure 2. On/Off switch

6. Locate the remote controller included in your set. Use the switch on the right side of the remote to turn it “on”.
7. Turn the dial to the Forward position and allow the train to move around your track layout.
8. Activate the whistle button located on your remote controller. See figure 3. You should begin to see a water vapor smoke effect appear!

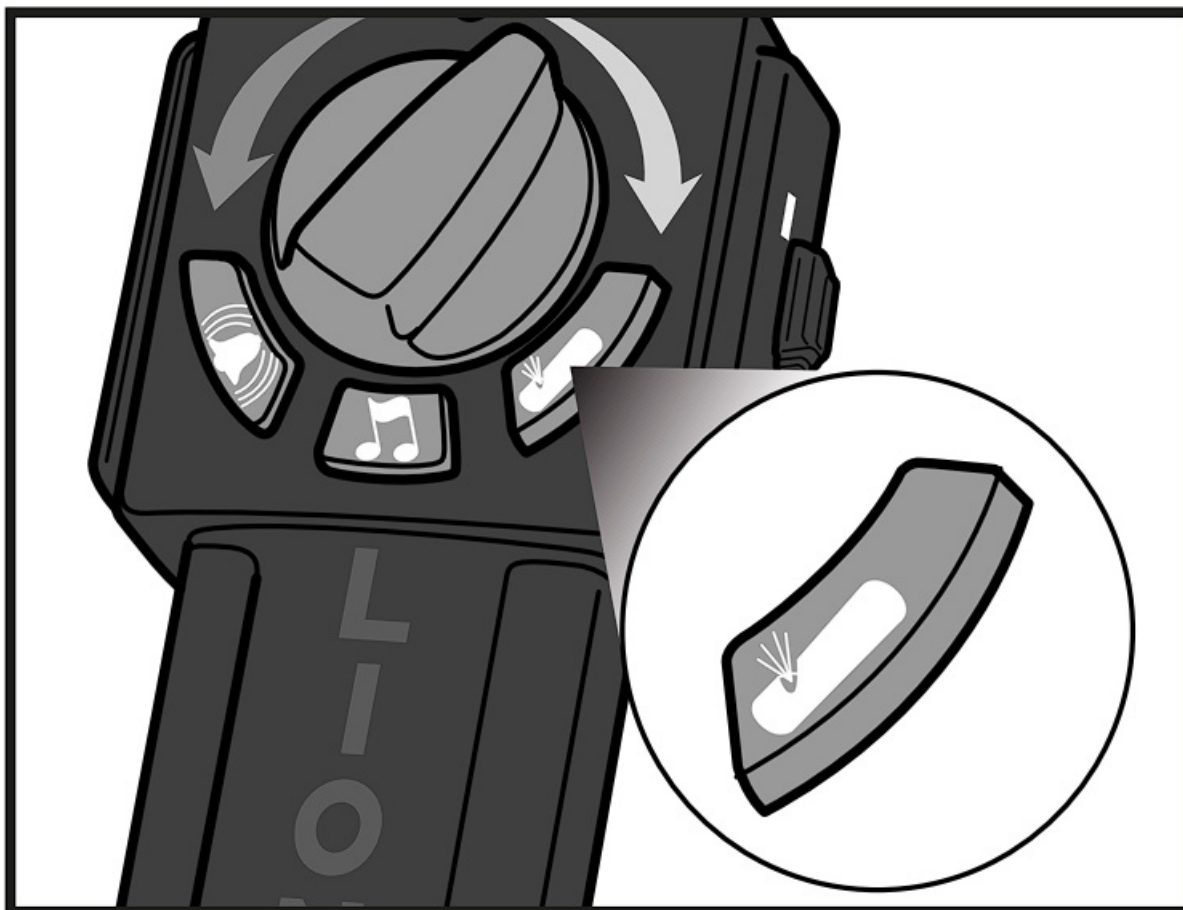

Figure 3. Whistle button

Having Trouble?

1. There may be an air bubble in the smokestack. Try gently blowing into the stack to clear out air which may be trapped inside.
2. Your engine may need more water. Try adding 3-5 drops of water at a time until you begin to see a smoke effect appear.
3. The smoke effect is generated as your engine moves around your track layout, and is driven by vibration, not heat. If you continue to experience issues activating this feature, try running your train around the track for 30 seconds and re-activating the smoke effect.
4. Be sure the batteries in your engine and remote are new and inserted in the proper direction.
5. If this issue persists, reach out to our customer care line at 1-800-4-LIONEL (454 6635) for assistance.

Available Monday through Friday 9AM to 6PM EDT.



©2022 LIONEL L.L.C.
6301 Performance Dr., CONCORD, NC 28027
UNITED STATES OF AMERICA
PRINTED IN CHINA

The following Lionel marks are used throughout this Owner's Manual and are protected under law. All rights

FCC Statements

Warning: Changes or modifications to this unit not expressly approved by the party responsible for compliance could void the user's authority to operate the equipment.

NOTE: This equipment has been tested and found to comply with the limits for a Class B digital device, pursuant to Part 15 of the FCC Rules. These limits are designed to provide reasonable protection against harmful interference in a residential installation. equipment generates, uses and can radiate radio frequency energy and, if not installed and used in accordance with the instructions, may cause harmful interference to radio communications.

However, there is no guarantee that interference will not occur in a particular installation.

If this equipment does cause harmful interference to radio or television reception, which can be determined by turning the equipment off and on, the user is encouraged try to correct the interference by one or more of the following measures:

- Reorient or relocate the receiving antenna.
- Increase the separation between the equipment and receiver.
- Consult the dealer or an experienced radio/TV technician for help.

This device complies with Part 15 of the FCC Rules. Operation is subject to the following two conditions: (1) this device may not cause harmful interference, and (2) this device must accept any interference received, including interference that may cause undesired operation.

Model Numbers:
Berkshire: 712110
General: 712112
Thomas: 712114
Diesel: 712111
4-6-0: 712113
Remote: 712115

RSS Statements

This device contains licence-exempt transmitter(s)/receiver(s) that comply with Innovation, Science and Economic Development Canada's licence-exempt RSS(s). Operation is subject to the following two conditions: (1) This device may not cause interference. (2) This device must accept any interference, including interference that may cause undesired operation of the device.

- Do not mix alkaline, standard (carbon-zinc), or rechargeable (nickle-cadmium) batteries.
- Different types of batteries or new and used batteries are not to be mixed.
- Only batteries of the same or equivalent type as recommended are to be used.
- Batteries are to be inserted with correct polarity.
- Exhausted batteries are to be removed from the toy.
- The supply terminals are not to be shortcircuited.
- Dispose of battery(ies) safely.
- Do not dispose of this product in a fire. The batteries inside may explode or leak.
- Non-rechargeable batteries are not to be recharged.

- Rechargeable batteries are to be removed from the toy before being charged.
- Rechargeable batteries are only to be used under adult supervision.



WARNING:

Not for children under 3 years.

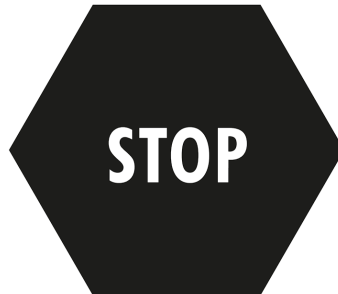

DO NOT RETURN TO STORE

For help with assembly or warranty service call our toll free number:

1-800-4-LIONEL (454-6635)

Monday through Friday

9AM to 6PM

Language Spoken: English

This product is covered by a ONE year limited warranty effective from the date of purchase against defects in materials and workmanship.

AUSTRALIA: Our goods come with guarantees that cannot be excluded under the Australian Consumer Law. You are entitled to a replacement or refund for a major failure and for compensation for any other reasonably foreseeable loss or damage. You are also entitled to have the goods repaired or replaced if the goods fail to be of acceptable quality and the failure does not amount to a major failure.

The following Lionel marks are used throughout this Owner's Manual and are protected under law. All rights reserved. Lionel®, Ready-to-Play®



©2022 LIONEL L.L.C., CONCORD, NC 28027
UNITED STATES OF AMERICA
PRINTED IN CHINA



[Lionel RTPGTXV3 Ready-to-Play Train Set Addendum](#) [pdf] Instruction Manual
RTPGTXV3, LIV-RTPGTXV3, LIVRTPGTXV3, RTPGTXV3 Ready-to-Play Train Set Addendum,
RTPGTXV3, Ready-to-Play Train Set Addendum