



LINOCELL 22938 iPad Keyboard and Case with Touchpad Instruction Manual

[Home](#) » [Linocell](#) » LINOCELL 22938 iPad Keyboard and Case with Touchpad Instruction Manual 

LINOCELL[®]
PREMIUM

iPad keyboard and case / with touchpad
Item: 22938



Contents

- [1 Overview](#)
- [2 Specifications](#)
- [3 Use](#)
- [4 Safety information](#)
- [5 Documents / Resources](#)
 - [5.1 References](#)

Overview

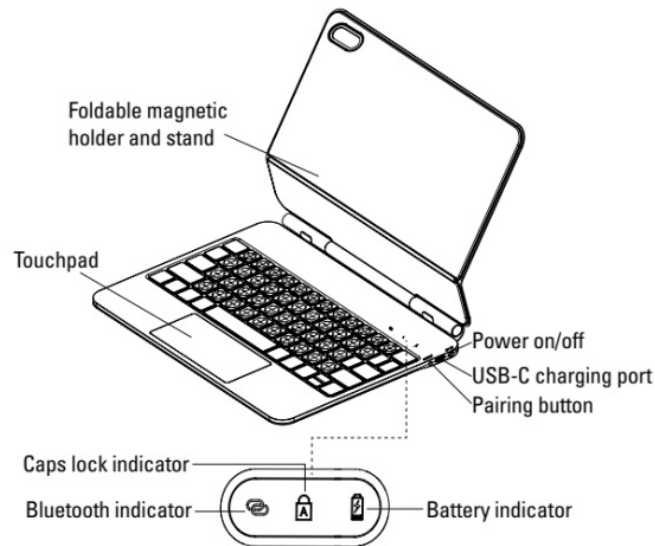

Specifications

Compatibility: iPad 10.9" gen. 10
 Keyboard layout: Nordic
 Bluetooth version: BT 5.3 (up to 10 m)
 Supported OS: iPad OS
 Charging time: Up to 3 h
 Standby time: 100 days
 Working time: Up to 80 h
 Size: 249x194x16 mm (excl. iPad)
 Weight: 540 g
 Wireless frequency: 2402–2480 MHz
 Max. radiated power: 20 mW (Max.)
 Included: Keyboard case, USB-A to USB-C charging cable, manual

Use

Charging

Connect the included USB-C cable between the keyboard's charging port and a USB power adapter (sold separately). Connect the USB power adapter to a wall socket. The Battery indicator lights up red during charging and turns green when the battery is fully charged. The Battery indicator flashes red when the battery level is low.

Power on/off

Turn the keyboard on by sliding the Power on/off switch to "ON". Slide the switch to "OFF" to turn it off. Press your tablet to the Foldable magnetic holder and stand to attach it to the keyboard case.

Bluetooth pairing

Press and hold the Pairing button for 2 seconds to enter Bluetooth pairing mode. The Bluetooth indicator starts flashing. Open the Bluetooth settings on your smart device. Look for "Linocell BTK14" and connect. Pairing occurs automatically the next time you turn on the keyboard.

Standby

The keyboard enters standby mode after 10 minutes of inactivity to save battery power. Press any key to wake it.

Function keys

There are functions or shortcuts assigned to some of the other keys.



Language and keyboard



Backlight brightness.

Press the right-most Option key on the keyboard along with this function button multiple times to cycle between the 3 available backlight brightness modes.

Touch pad gestures

When using the keyboard with iOS and iPad OS (14.5 and higher), extra functionality is added to the touch pad.

Gestures using one finger:



Press with one finger:
left mouse click.



Swipe down past the bottom of the screen with one finger: open "Dock".



Swipe down past the bottom of the screen with one finger. When the Dock appears, swipe down again: return to the Home screen.

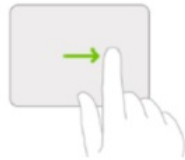

Swipe right past the right edge of the screen with one finger: show/hide "Slide Over".



Swipe diagonally to the top right-hand corner and press with one finger: open "Control center".



Swipe diagonally to the top left-hand corner and press with one finger: open "Notification center".

Gestures using two fingers:

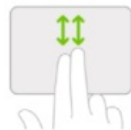

Slide up and down with two fingers: vertical scroll.



Slide side to side with two fingers: horizontal scroll.



Spread or pinch two fingers: zoom in and out.



Slide right with two fingers: open "Today view".



Slide down with two fingers: open Search from the Home Screen.



Press and hold with two fingers: right click.

Gestures using three fingers:



Slide up with three fingers: return to the Home screen.



Slide side to side with three fingers: switch between open apps.



Slide up and pause three fingers: open the "App switcher".

Safety information

This product contains a rechargeable Li-ion battery that cannot be replaced. Do not disassemble the product.

Simplified EU Declaration of Conformity

Kjell & Company hereby declares that this device is in compliance with the essential requirements and other relevant provisions of Directive 2014/53/EU. Full text of the EU declaration of conformity is available at

www.kjell.com/22938

Recommended power adapter

To ensure optimal and safe performance, use a CE-certified adapter with these specifications:

- Minimum charging power: 0.1 Watts
- Maximum charging power: 2.5 Watts (for full speed)

Only use adapters meeting these specifications to avoid performance issues or safety risks.

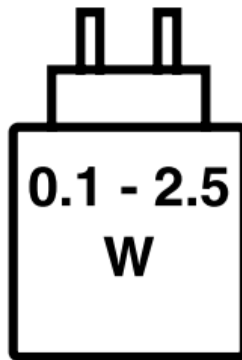

Symbol description



WEEE – Waste Electrical and Electronic Equipment.

This symbol indicates that the product should not be disposed of with household waste within the EU. To protect the environment and human health from potential risks associated with improper disposal, the product should be recycled. Please take the product to an approved e-waste collection point or contact the retailer to ensure responsible handling and recycling.

CE This product carries the CE mark in compliance with the requirements the Radio Equipment Directive 2014/53/EU and ROHS (2015/863/EU that updated 2011/65/EU).

www.linocell.com

Box 50435, 202 14

Malmö, Sweden

2024-12-18



Documents / Resources

	<p>LINOCELL 22938 iPad Keyboard and Case with Touchpad [pdf] Instruction Manual 22938, 22938 iPad Keyboard and Case with Touchpad, 22938, iPad Keyboard and Case with Touchpad, Keyboard and Case with Touchpad, Case with Touchpad, Touchpad</p>
--	---

References

- [Linocell Premium Magnetiskt Tangentbordsfodral för iPad 10,9" \(Gen. 10\) - Tangentbord för iPad | Kjell.com](#)
- [Linocell | Kjell.com](#)
- [User Manual](#)

[Manuals+](#), [Privacy Policy](#)

This website is an independent publication and is neither affiliated with nor endorsed by any of the trademark owners. The "Bluetooth®" word mark and logos are registered trademarks owned by Bluetooth SIG, Inc. The "Wi-Fi®" word mark and logos are registered trademarks owned by the Wi-Fi Alliance. Any use of these marks on this website does not imply any affiliation with or endorsement.