



LINKVIL W610D Portable DECT Phone User Guide

[Home](#) » [LINKVIL](#) » LINKVIL W610D Portable DECT Phone User Guide 

LINKVIL

V1.0

Portable DECT Phone
Quick Start Guide



W610D

Contents

- 1 Packing list
- 2 Handset
- 3 Install the battery
- 4 Replacement battery
- 5 Connect the charging base
- 6 Install the belt clip
- 7 Connecting W610D to the Network
- 8 Language setting
- 9 Voice message
- 10 Bluetooth
- 11 Warning
- 12 Documents / Resources
- 12.1 References

Packing list



Portable
dect Phone

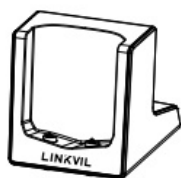

Charging Base

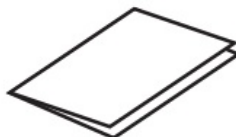

Quick Start Guide



Power Adapter

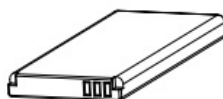

Rechargeable Battery

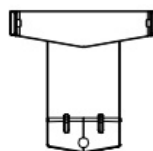

Belt Clip

Handset

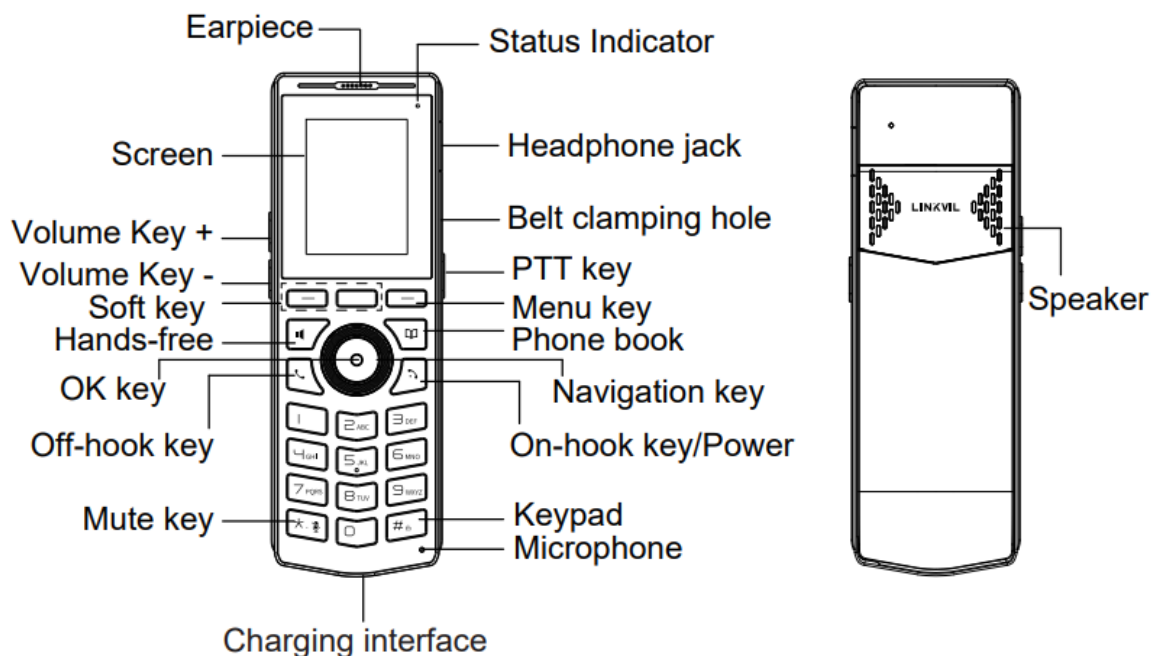

Install the battery

1. Remove the rear case: Remove the rear case of the whole machine with a little force from the handle position A of the rear case of the main unit.
2. Install the battery: Take out the battery from the packaging box, with the battery with the notch facing up, put the battery C at the battery compartment C.
3. Install the battery cover: Align the back cover with the buckle on the back of the main unit, press your hands along the edge of the main unit from top to bottom (there will be a “click” sound during the process), and ensure that there is no gap, it means that the back cover is fastened.

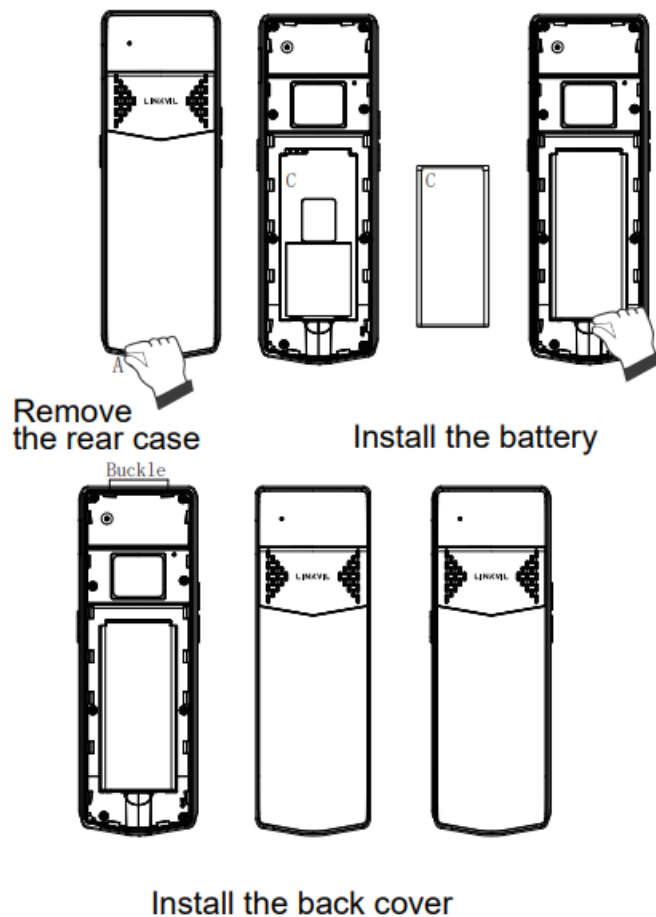

Replacement battery

1. Remove the rear case: Remove the rear case of the whole machine with a little force from the handle position A of the rear case of the main unit.
2. Remove the old battery: Push up at B to remove the old battery.
3. Install the new battery: Take out the battery from the packaging box, with the battery with the notch facing up, put the battery C at the battery compartment C.
4. Install the back cover: Align the back cover with the buckle on the back of the main unit, press your hands along the edge of the main unit from top to bottom (there will be a “click” sound during the process), and ensure that there is no gap, it means that the back cover is fastened.

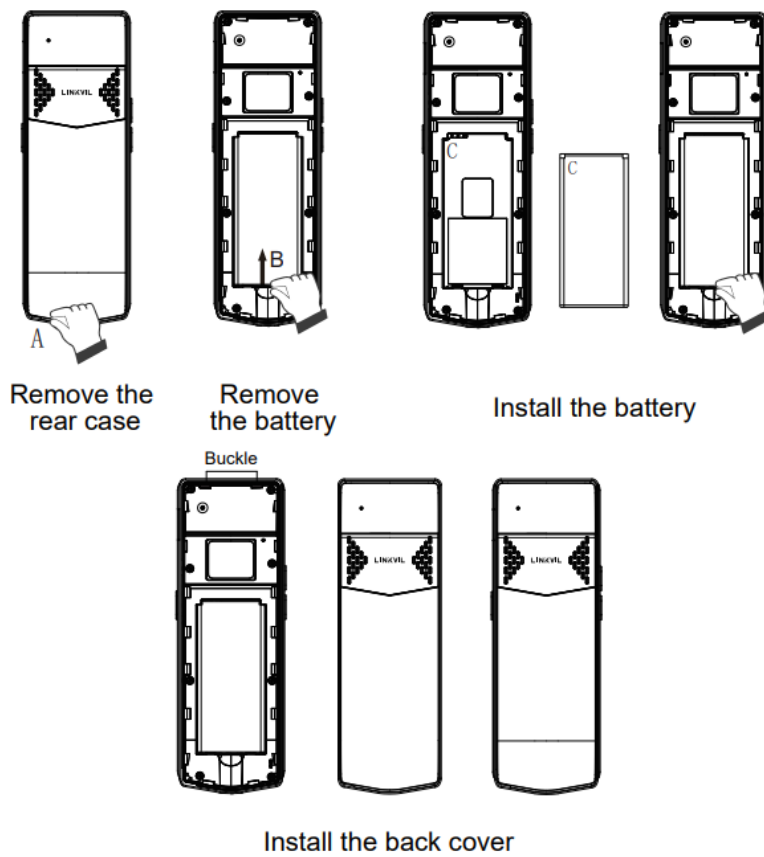

Connect the charging base

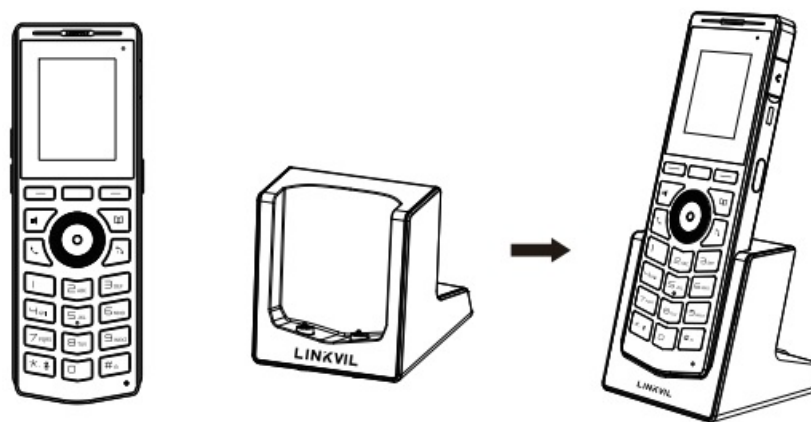

Note

1. Use original factory supplied power adapter (5V/2A). A third-party power adapter may damage the handset.
2. Check the charging status on the top-right corner of the LCD screen.

Install the belt clip

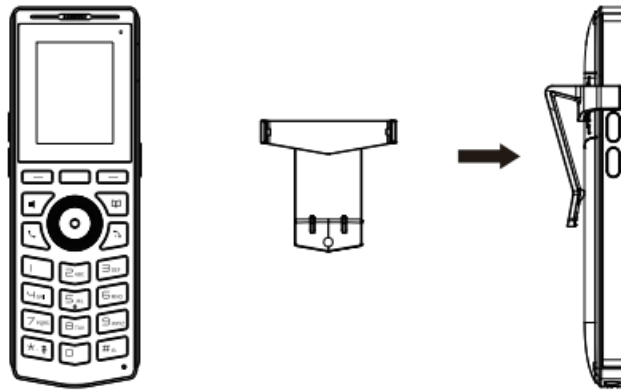

Connecting W610D to the Network

To use the communication function of W610D, the device must first be connected to the network. The specific steps are as follows:

1. The system administrator needs to first enter the IPUI address of the device into the system on the paired Manager and authorize the device to access.
2. Terminal connects the network
 - 2.1 Boot up the W610D device and select the the corresponding country, access Menu > WLAN > Available Networks. Select the Manager's RFPI , click "Connect," and enter the password to establish a successful connection.
 - 2.3 After a successful connection, the terminal automatically obtains configuration settings (SIP account and internal extension) and can perform call operations.

Language setting

1. Press Menu key > Basic > Language.
2. Select the desired language and press OK softkey.

Country/Region setting

1. Press Menu key > Network> Country/Region.
2. Select the desired area and press OK softkey.

Note that the Country/Region of W610D and Base must be consistent so that W610D can search and connect to Base.

Making a call

1. Pre-dialing: enter the phone number and press Handfree/Off-Hook/Softkey-Dial key.
2. Direct dialing: press Handfree/Off-Hook key and enter the phone number, then press “#”/Handfree/Off-Hook key to call out the number.
3. Headset: Insert headphones, enter the number, and press the off hook button.
4. Designated line: press Handfree/Off-Hook key, or enter the phone number directly, then press Navigation Key-

Up key to select line.

Accepting a call

1. With the handset: press the Off-Hook key.
2. With a headset: when the headphone inserted, press the Off-Hook key.
3. With the handsfree: press Handfree key.

Putting a call on hold

1. Press the softkey-More > Hold, caller is put on hold.
2. To retrieve the call press the softkey-More > Resume.

Note: with more than one active call, select desired call with the navigator keys and use the corresponding softkey to hold or resume.

3-party conference

1. Once in line with 1st caller, press softkey-More > Conference, 1st caller is put on hold.
2. Then call the 2nd number. After, 2nd call is established, press softkey-More > Conference to set up the conference.

Call transfer

Attended transfer:

1. Press softkey-More > Xfer during the active conversation, the call is put on hold.
2. Dial the second telephone number.
3. When the call is answered, then press softkey-More > Xfer to complete the operation.

Blind transfer:

1. Press softkey-More > Xfer during the active conversation, the call will be on hold.
2. Then enter the 2nd telephone number and press softkey-More > Xfer.

Call forward

1. Press Menu > Features > Call Forward.
2. Select the line, the type of forward, enter the destination number and status and press OK.

Call Mute

1. Long Press "*" key to Mute the microphone during the call.
2. Long Press "*" key again to un-mute the conversation.

Call list

1. Press Navigation keys – Up or Menu > Call Log > Local Call Logs.
2. Scroll through the list using navigation keys.
3. To dial an entry, press Softkey- Option > Dial or Handfree/Off-Hook key.

Phonebook

Access phonebook:

1. Press Physical buttons > PhoneBook or Menu > PhoneBook > Local Contacts.
2. Select All Contacts or other group.
3. To dial an entry, press Softkey- Option > Dial or Handfree/Off-Hook key.

Add new entry:

1. Press Menu > PhoneBook > Local Contacts, Press All Contacts or other group > Press Add.
2. Enter name and number and press OK soft key.

Programmable keys

DSSkey

Press Navigation keys – Left or Navigation keys -Right, select among the configurable items, and select your desired type and value, press OK key.

PTT key

Press the PTT key on the side of the device, select your desired type and value, press OK key.

Redial

Press Handfree/Off-Hook key and then press Softkey-Redial.

Do not disturb

1. Press Menu > Features > DND.
2. Select the Mode, and press OK soft key.

Voice message

1. To access your voice mailbox, press Menu > Message > Voice Message, number of messages will be indicated if provided by your server or PBX.
2. Select the line and press Play to call.

Bluetooth

1. Press Menu > Basic > Bluetooth
2. Press ok to enter the bluetooth open interface. After opening, press scan to display the list of bluetooth scanned. Select any device and press connect.

Warning

Used below 35°C in the state of charge

– Please dispose of lifeless battery under guidance.

– Recycle your device.

– Replacement of a battery with an incorrect type that can defeat a safeguard (for example, in the case of some lithium battery types).

- Disposal of a battery into fire or a hot oven, or mechanically crushing or cutting of a battery, that can result in an explosion.
- Leaving a battery in an extremely high temperature surrounding environment that can result in an explosion or the leakage of flammable liquid or gas.
- A battery subjected to extremely low air pressure that may result in an explosion or the leakage of flammable liquid or gas.



NOTE: This equipment has been tested and found to comply with the limits for a Class B digital device, pursuant to part 15 of the FCC Rules. These limits are designed to provide reasonable protection against harmful interference in a residential installation. This equipment generates uses and can radiate radio frequency energy and, if not installed and used in accordance with the instructions, may cause harmful interference to radio communications.

However, there is no guarantee that interference will not occur in a particular installation. If this equipment does cause harmful interference to radio or television reception, which can be determined by turning the equipment off and on, the user is encouraged to try to correct the interference by one or more of the following measures:

- Reorient or relocate the receiving antenna.
- Increase the separation between the equipment and receiver.
- Connect the equipment into an outlet on a circuit different from that to which the receiver is connected.
- Consult the dealer or an experienced radio/TV technician for help

Changes or modifications not expressly approved by the party responsible for compliance could void the user's authority to operate the equipment.

This device complies with Part 15 of the FCC Rules. Operation is subject to the following two conditions:

(1) this device may not cause harmful interference, and (2) this device must accept any interference received, including interference that may cause undesired operation.

RF Exposure Information:

FCC RF Exposure requirements: The highest SAR value reported under this standard during product certification for use next to the head and body with the minimum separation distance of 0mm. This transmitter must not be collocated or operating in conjunction with any other antenna or transmitter. This product is compliance to FCC RF Exposure requirements and refers to FCC website <https://apps.fcc.gov/oetcf/eas/reports/GenericSearch.cfm> search for FCC ID: 2BCUQ-W610D

This equipment complies with Part 68 of the FCC rules and the requirements adopted by the ACTA. On the bottom of this equipment is a label that contains. among other information, a product identifier in the format US:FVLIPNANW610D. If requested, this number must be provided to the telephone company.

LINKVIL

Documents / Resources

	<p>LINKVIL W610D Portable DECT Phone [pdf] User Guide W610D, W610D Portable DECT Phone, Portable DECT Phone, DECT Phone, Phone</p>
---	--

References

- [User Manual](#)

This website is an independent publication and is neither affiliated with nor endorsed by any of the trademark owners. The "Bluetooth®" word mark and logos are registered trademarks owned by Bluetooth SIG, Inc. The "Wi-Fi®" word mark and logos are registered trademarks owned by the Wi-Fi Alliance. Any use of these marks on this website does not imply any affiliation with or endorsement.