

Linksys MX2002 Atlas 6 WiFi 6 Dual Band Mesh Router



Linksys MX2002 Atlas 6 WiFi 6 Dual Band Mesh Router User Guide

[Home](#) » [Linksys](#) » Linksys MX2002 Atlas 6 WiFi 6 Dual Band Mesh Router User Guide 

Contents

- [1 Linksys MX2002 Atlas 6 WiFi 6 Dual Band Mesh Router](#)
- [2 Product Overview](#)
- [3 Help](#)
- [4 Set Up](#)
- [5 Atlas 6 System Settings](#)
- [6 Notifications](#)
- [7 Advanced Settings](#)
- [8 My Account](#)
- [9 Connect Directly To Linksys Atlas 6](#)
- [10 How to restore factory defaults](#)
- [11 Specifications](#)
- [12 Documents / Resources](#)
 - [12.1 References](#)
- [13 Related Posts](#)

Linksys

Linksys MX2002 Atlas 6 WiFi 6 Dual Band Mesh Router



Product Overview

Front/top

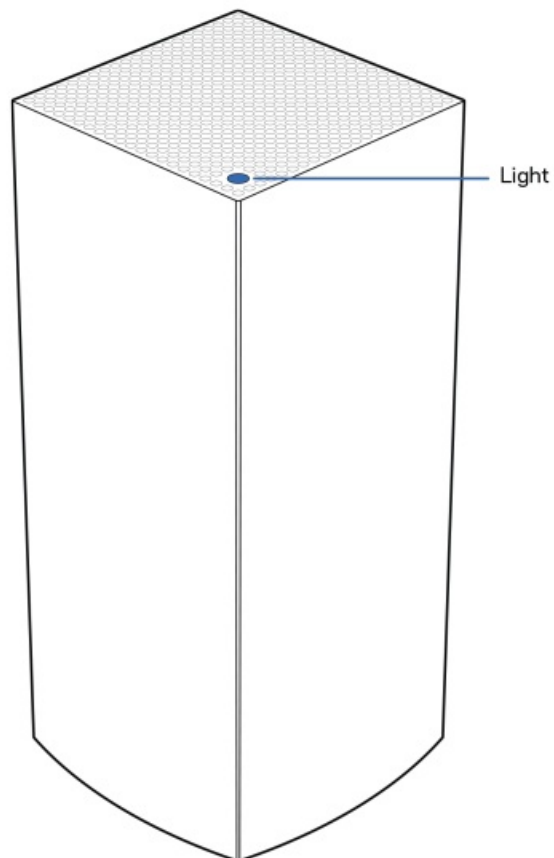

The light on the top of your node gives you information about the node's operation.

Light description	Status
Blinking blue	Starting up
Solid blue	Connected
Blinking purple	Setup in progress
Solid purple	Ready for setup
Blinking red	Disconnected <ul style="list-style-type: none"> Child node: too far Parent node: unplugged from modem
Solid red	No internet from the modem
Solid yellow	Weak connection <ul style="list-style-type: none"> Child node only

Back

-

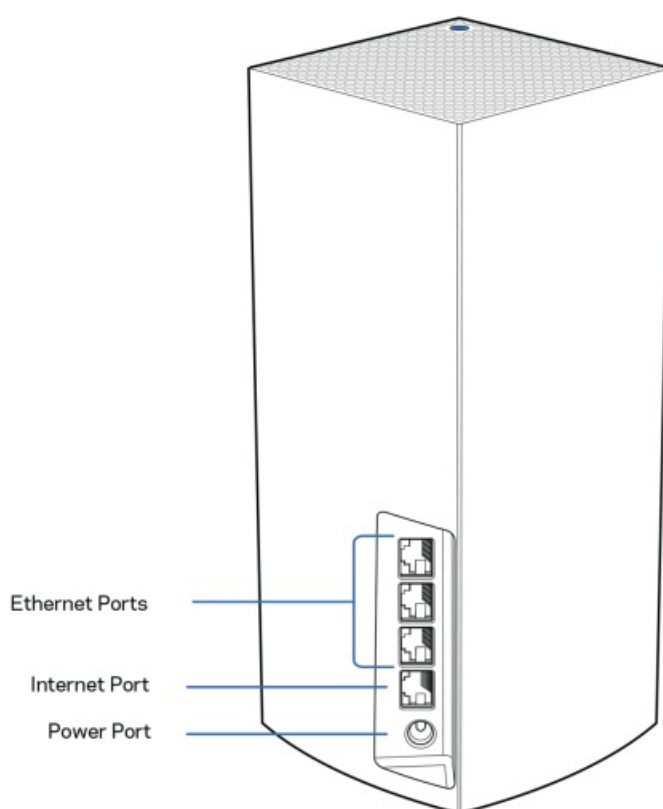

Ethernet ports—Connect ethernet cables to these Gigabit ethernet (10/100/1000) ports and to other wired devices on your network. If you have more than one node in your mesh system, use one of these ports to connect to your modem or modem router.

- **Note**—For best performance, use a CAT5e or higher rated cable on the Ethernet port.
- **Internet port**—Connect an ethernet cable to the yellow gigabit (10/100/1000) port, and to a broadband internet

cable/DSL or fiber modem. If you are using this router as a child node in a mesh WiFi system, you can use this port to create a wired connection to another node.

- **Power port**—Connect the included AC power adapter to this port.

Bottom

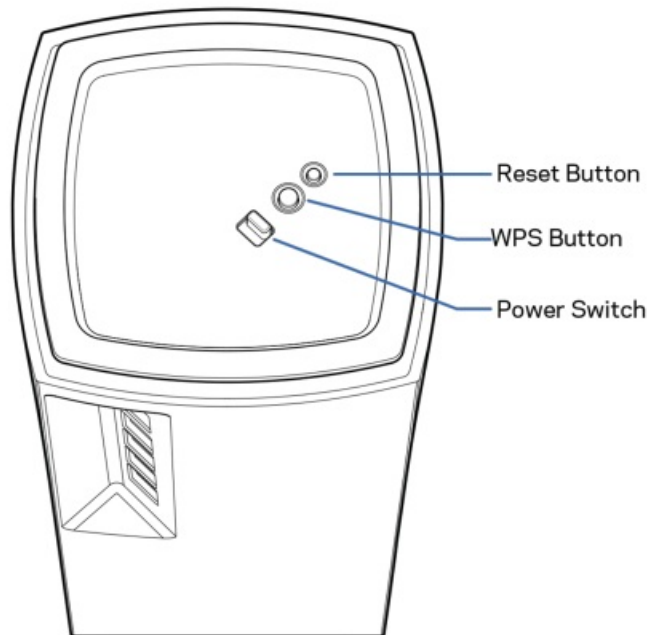

- **Reset button**—Press and hold until the light on top of the node turns red, fades and flashes bright red again to reset the node to its factory defaults.
- **WiFi Protected Setup button**—Press to connect WPS-enabled network devices.
- **Power switch**—Slide to | (on) to power on the node.

Help

Where to find more help

- [Linksys.com/support/Atlas6](https://linksys.com/support/Atlas6)
- Linksys app help (launch the app and click Help in the main navigation menu)

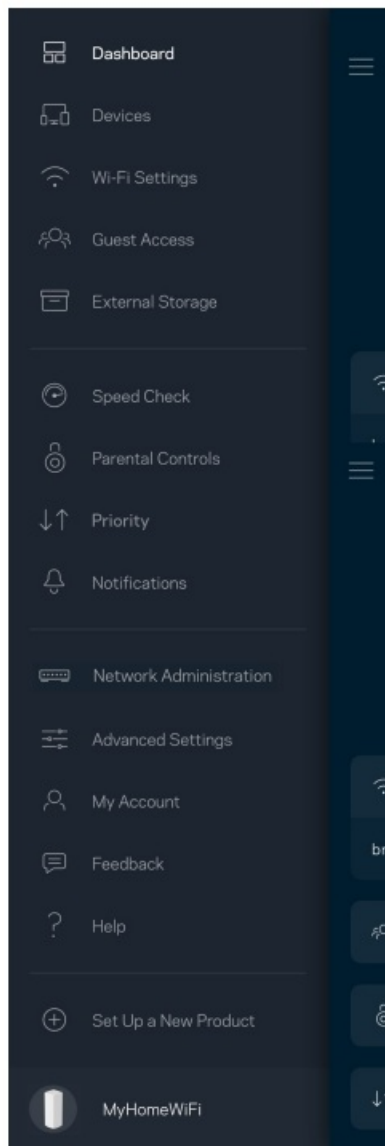

Note— Licenses and notices for third-party software used in this product may be viewed at <http://support.linksys.com/en-us/license>. Please contact <http://support.linksys.com/en-us/gplcodecenter> for questions or GPL source code requests.

Set Up

IMPORTANT— Atlas 6 nodes can be set up as primary nodes or child nodes. A primary node must be connected with an ethernet cable to your modem or modem router. Once set up wirelessly, secondary nodes can be connected to another node wirelessly or with ethernet cables. If you are adding this new node as a parent node to an existing Linksys whole home mesh WiFi system, factory reset all nodes and add them to the system after the new node is set up and working. Download the Linksys app. You need this app to set up your Linksys Atlas 6.Go



to the app store for your device and search for Linksys.

Install the app, open it and follow the instructions.

Note —The app works with iOS 14.1 and later, and Android 6 and later. You will create a Linksys Smart WiFi account so you can use the app to view or change your mesh system settings from anywhere you have an internet connection. Among the many things you can do with Linksys Smart WiFi:

- Change your WiFi name and password

- Set up guest access
- Connect devices to WiFi with WPS
- Block internet with parental controls
- Test your internet connection speed

Note— During setup we'll send a verification email. From your home network, click the link in the email.

Other than plugging in the power and the ethernet cable, the app-based setup process does the work for you. Once connected, use the app to personalize your WiFi by giving it a name and password. You also can give nodes names based on where they are so you can identify them in the rare case where things need attention. Print this page, then record your WiFi and account settings in the table as a reference. Store your notes in a safe place.

WiFi Name	
WiFi Password	
Router Password	
Guest Access Name	
Guest Access Password	
Linksys App Login Email	
Linksys App Password	

Atlas 6 System Settings

Using your Linksys app, you can view or change Atlas 6 settings to make your WiFi more secure or to work better with a device or game. You can access settings from anywhere in the world if you have an internet connection. You can also access settings using your router password when connected to your home network even if you do not have an internet connection.

Log in to the Linksys app

1. Open the Linksys app.

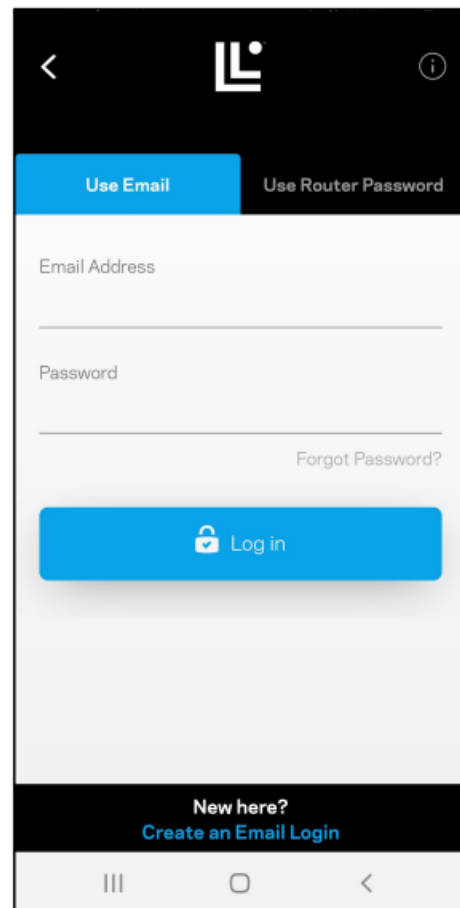
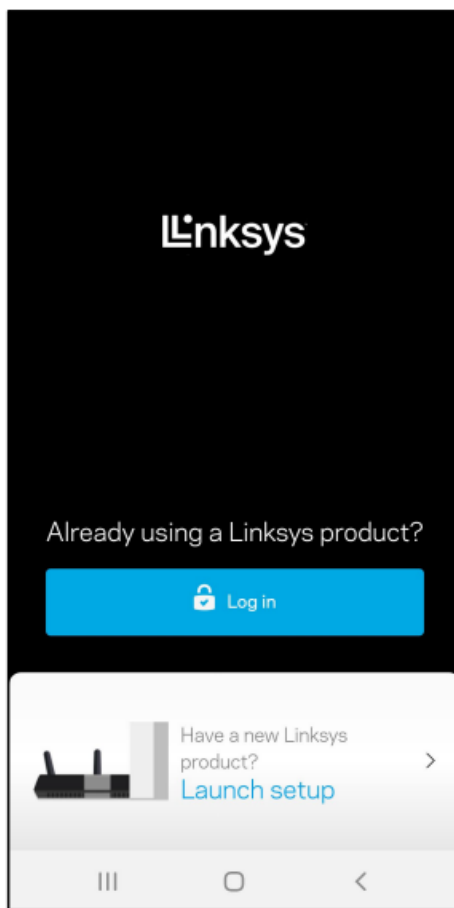

2. Enter the email address you used when creating your account.
3. Enter your account password.
4. Tap Log in.

Dashboard

The dashboard is a snapshot of your WiFi. See how many devices are connected to your mesh system. Share your WiFi password and allow guest access to your WiFi. The dashboard also shows you if any devices have parental controls on them or have been prioritized for WiFi access.

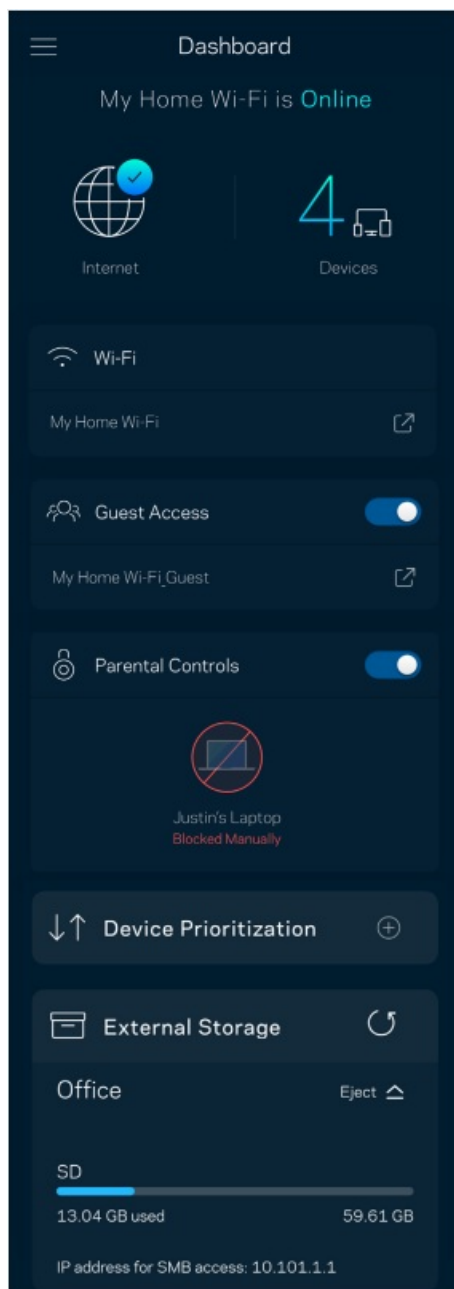

Devices

View and change details for all devices connected to your WiFi. You can view devices on your main network and your guest network, or display information about each device.

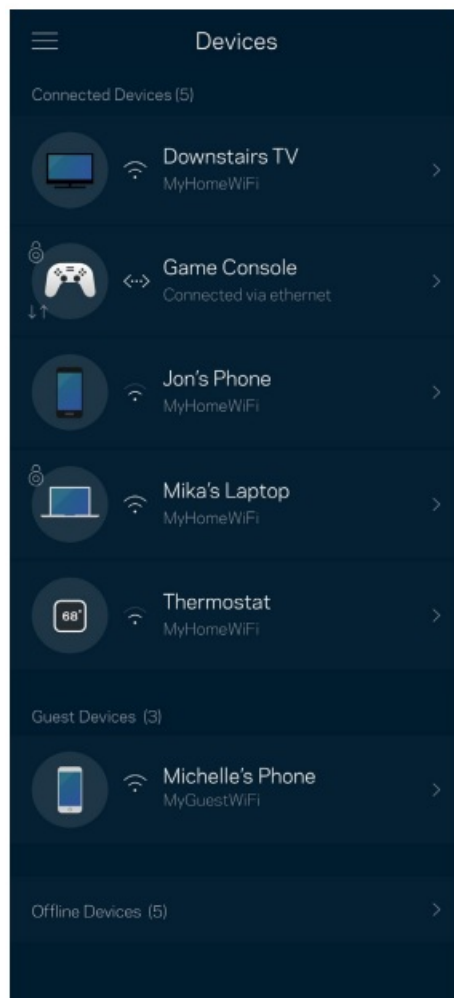

To view or change device details

From the Devices screen you can edit device names and change the device icons. You also can prioritize devices, set parental controls, and see WiFi details. Tap on any device to see details.

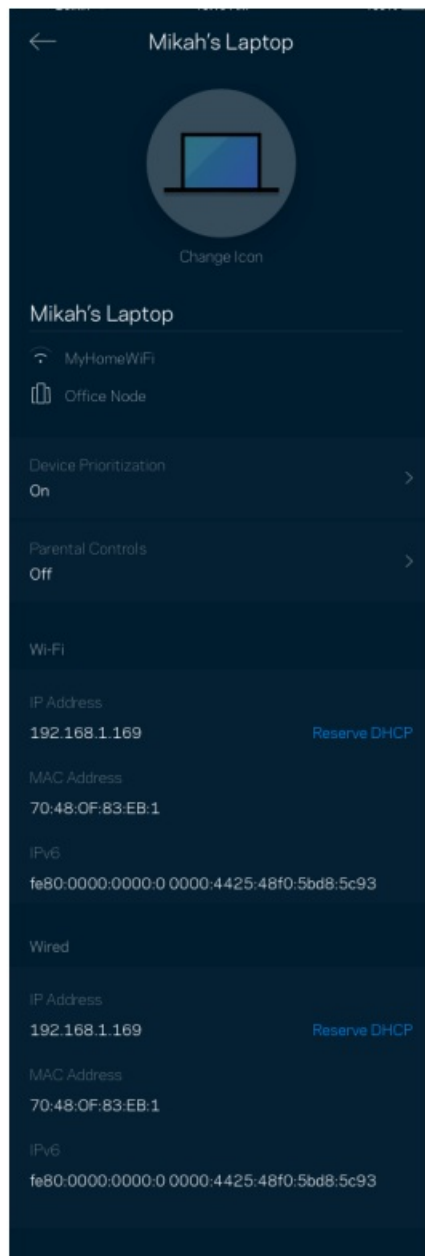

WiFi Settings

View or change your WiFi name and password and connect devices using WiFi Protected Setup™.

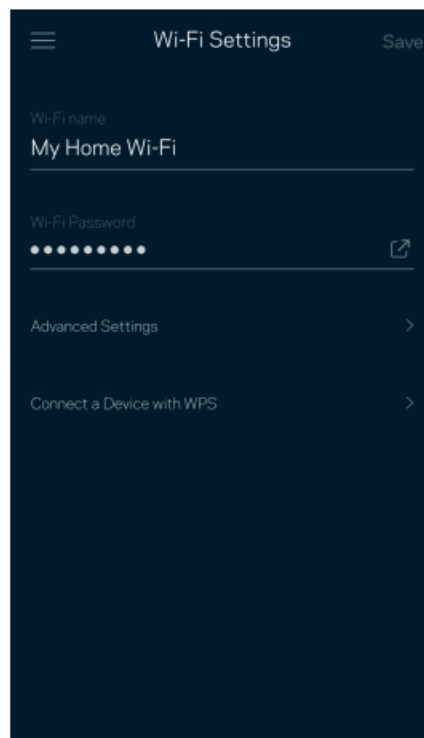

Advanced Settings

Advanced users can change the default security type and WiFi mode. Do not change these unless you have a lot of experience with WiFi networks. Channel Finder will search for the most open WiFi channels in your area to ensure you get the best performance from your mesh system. If you have more than one node in your mesh system, Channel Finder will find the best channel for each node.

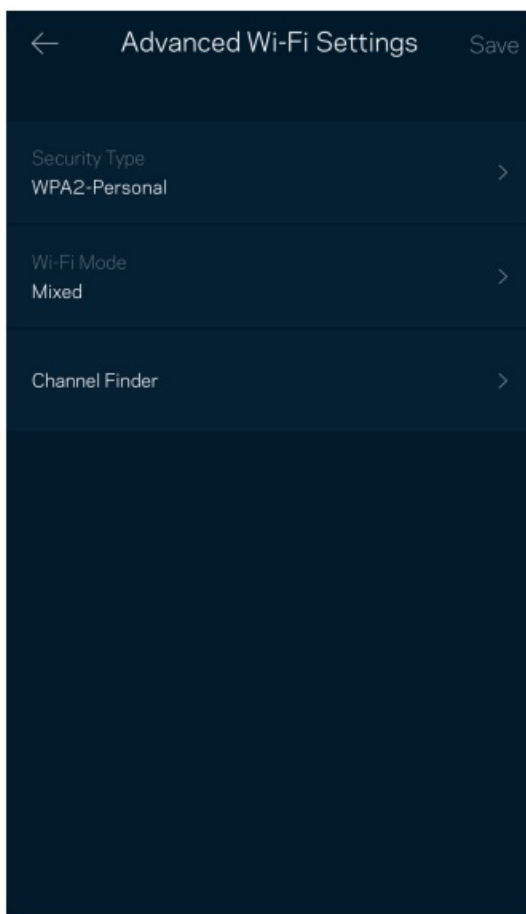

Connect a Device with WPS

WiFi Protected Setup allows you to easily connect wireless devices to your WiFi without manually entering security settings.

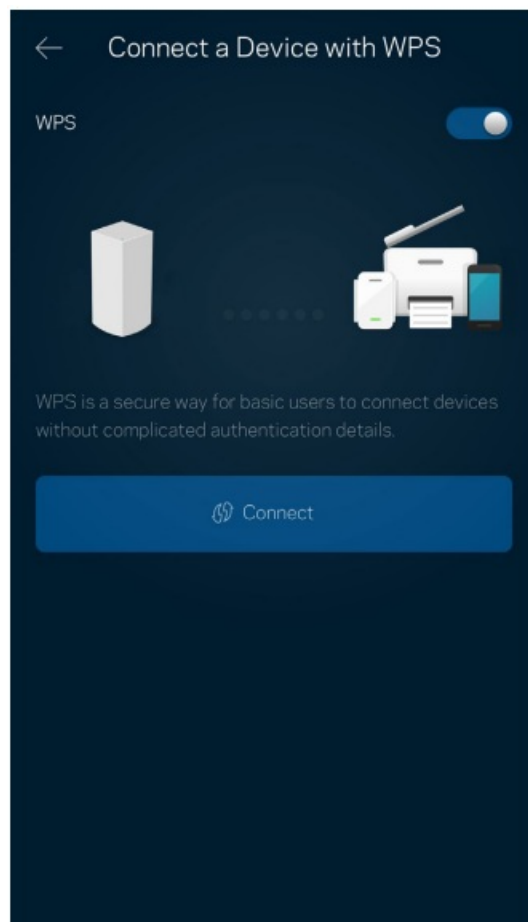

Guest Access

Use your Guest Access to allow guests to get online while restricting their access to other resources connected to your WiFi. Send the password by text message or email.

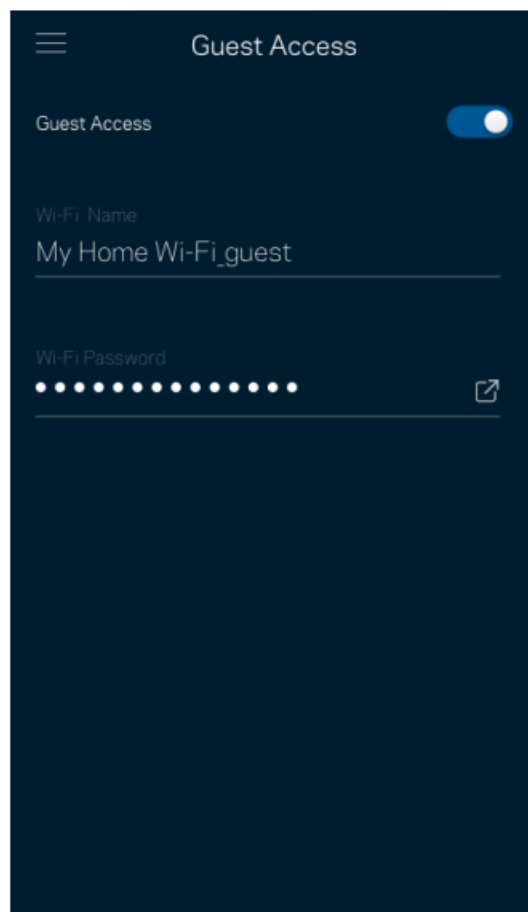

Speed Check

Run a speed check to make sure you are getting the speeds you are paying for. Speed check also helps in Device Prioritization because results determine how WiFi is distributed to the prioritized devices.

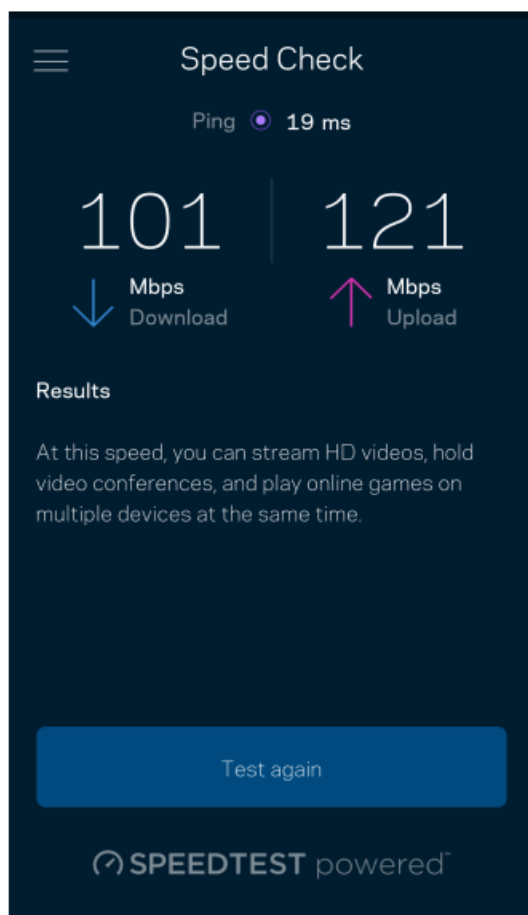

- Download speed is the rate at which internet content is transferred to your mesh system.
- Upload speed is the rate at which you can upload content to the internet.

Note— Internet connection speeds are determined by a variety of factors, including ISP account type, local and worldwide internet traffic, and the number of devices in your home that are sharing the internet connection.

Parental Controls

Parental controls allow you to control when your kids are online and what they're doing there. Pause the internet to specific devices, or block specific websites.

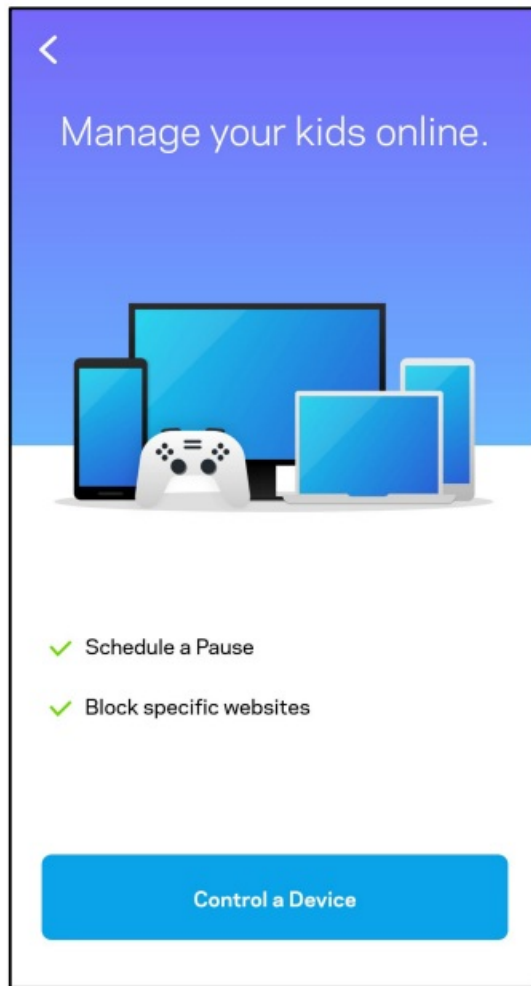

Priority

Choose up to three devices for priority usage of your internet connection. Those devices – wired and/or wireless – always will have the best access when connected. Atlas 6 runs a speed check to determine how to best distribute WiFi to prioritized devices. Other devices will share the leftover capacity. Prioritized devices appear on the Dashboard.

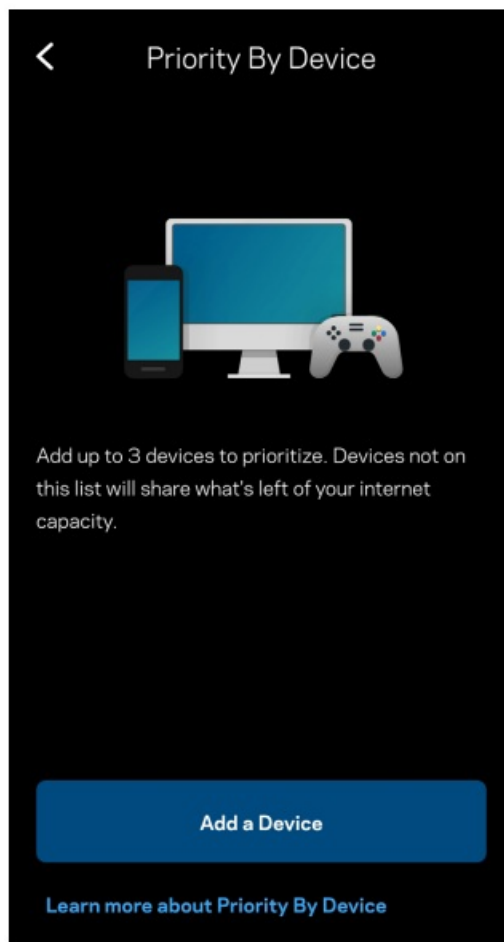

Notifications

If you have more than one node, Linksys can notify you when secondary nodes in your system go offline. Secondary nodes are any that are not wired to your modem. You have to turn on notifications in your mobile device settings to allow Linksys to notify you.

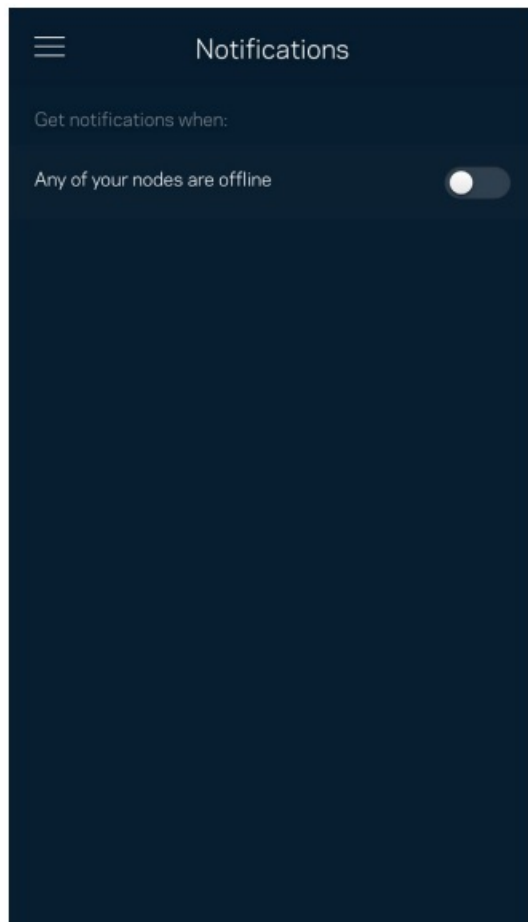

Network Administration

Use the Router Administration screen to change the admin password and hint, and check various identifiers (model number, serial number, and IP details) for all nodes in your WiFi.

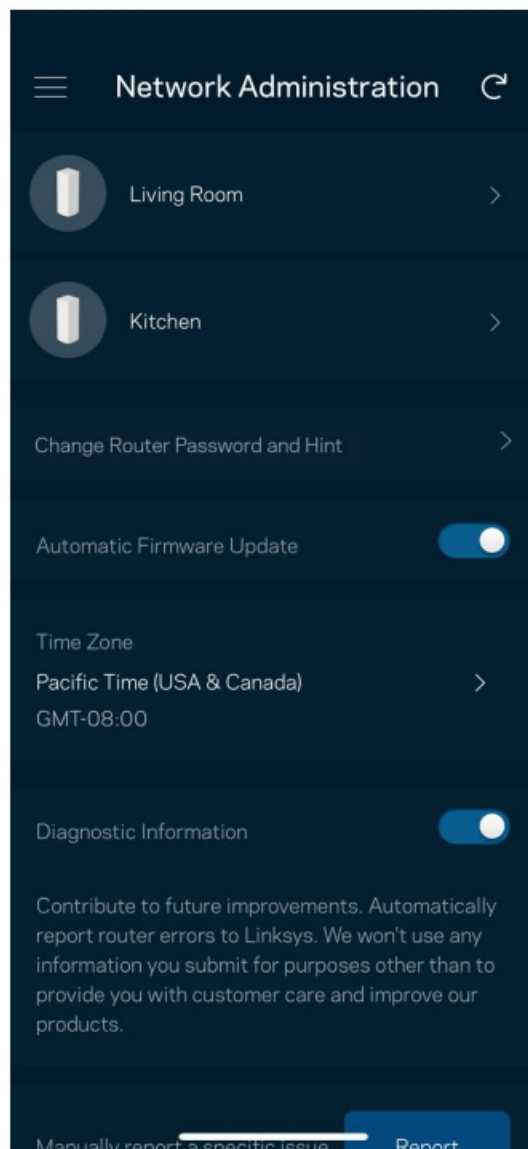

Opt in to automatically report crashes to Linksys and contribute to improving the WiFi experience. You also can manually report specific issues to Linksys. The following information will be sent with your description of the issue:

- App version
- Login Type (cloud: show email address associated, local: display “Router admin”)
- Device model
- WAN Connection type (display WiFi or ethernet)
- Device OS version
- Time: date (mo/day/year, time, time zone)

Advanced Settings

Internet Settings

You can choose how your mesh system connects to the internet. The default is Automatic Configuration – DHCP. Other connection types depend on your internet service provider or how you plan to use your mesh system. Advanced users can use Additional Settings to clone MAC addresses and set MTU (maximum transmission unit).

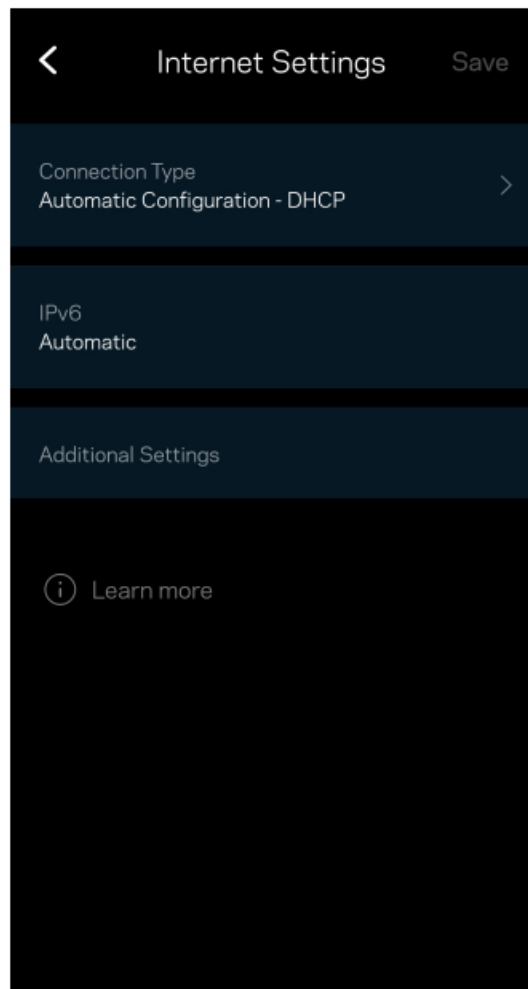

Port Settings

Port forwarding—for a single port, multiple ports or a range of ports—sends traffic inbound on a specific port or ports to a specific device or port on your WiFi. In port range triggering, your router watches outgoing data for specific port numbers. Your router remembers the IP address of the device that requests the data so that when the requested data returns, it is routed back to the proper device.

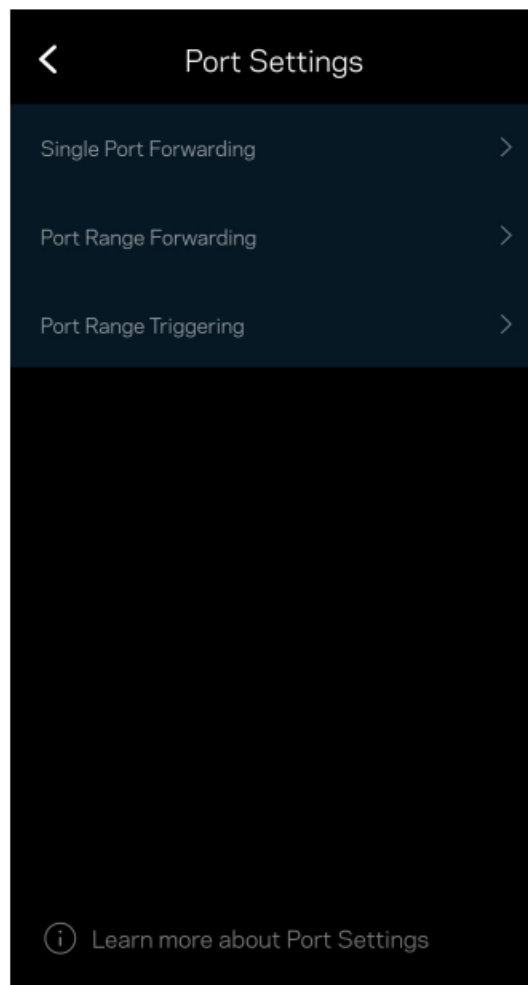

WiFi MAC Filters

Every network device has a unique 12-digit MAC (media access control) address. You can create a list of MAC addresses and regulate how devices use your WiFi.

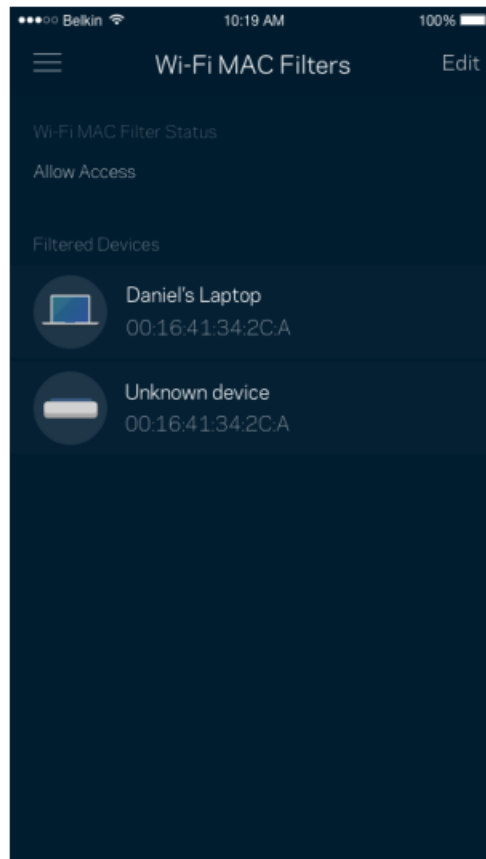

Local Network Settings

Details about the router and its connection status.

<

Local Network Settings

Save

Router Details

IP address
10.110.1.1

Subnet Mask
255.255.255.0

DHCP Server

Start IP address
10.110.1.10

Maximum number of users
245
Enter a number between 1 and 245

IP address range
10.110.1.10 to 10.110.1.254

Client lease time (minutes)
1440

DNS Settings

Auto >

My Account

Change your Linksys app password and opt in to receive the latest news and deals from Linksys.

My Account

Save

Your Info

Email

user@linkysys.com

Password

••••••••••

Phone Number

+1 555 555 5555

>

Security

2-Step Verification

On

>

Marketing

Newsletter

Be the first to know about exclusive deals & news.

Log Out

Close Account

Feedback

Here's your chance to tell us what you think. Rate the app at your app store, send us a suggestion, or report an issue that's keeping you from a great experience.

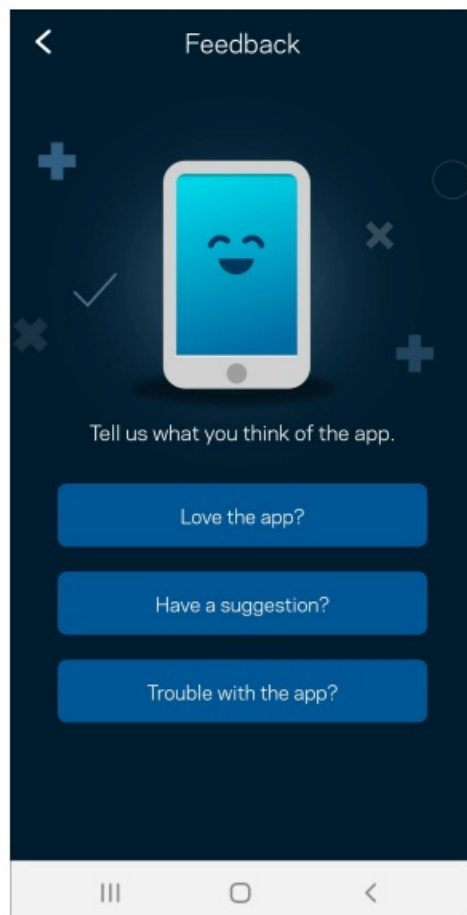

Help

Having trouble with the app? Just need a little more information about a feature? Tap Help for an explanation.

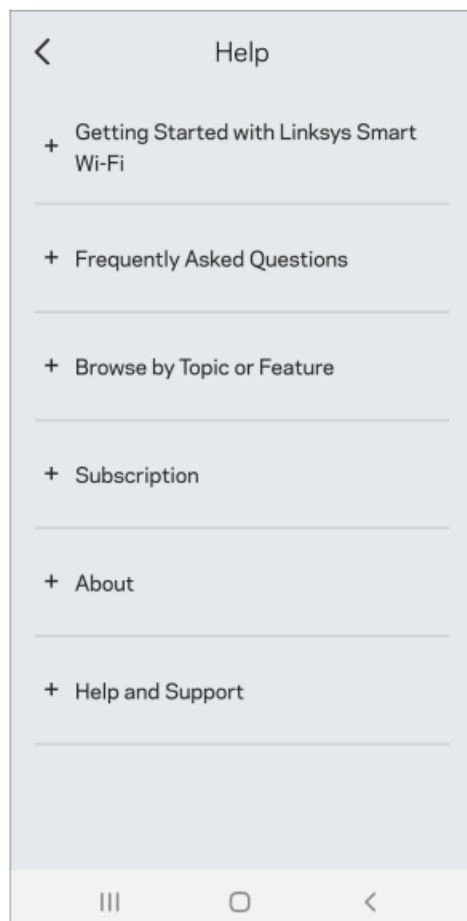

Connect Directly To Linksys Atlas 6

If you are not connected to the internet you still can access your mesh system. Connect to your WiFi name, launch the Linksys app and tap Use Router Password. You will not be able to access your Linksys WiFi account when not online.

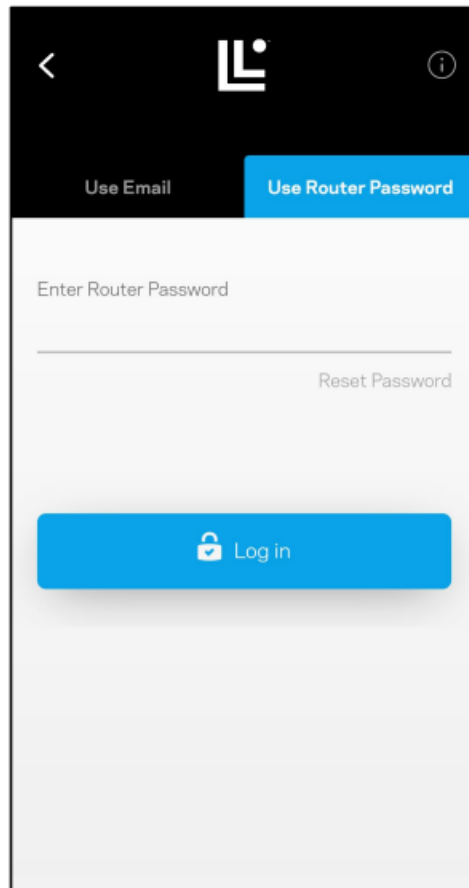

The screenshot shows the Linksys app interface. At the top, there is a navigation bar with a back arrow, the Linksys logo, and an information icon. Below the navigation bar, there are two tabs: 'Use Email' and 'Use Router Password'. The 'Use Router Password' tab is selected and highlighted in blue. Below the tabs, there is a text input field labeled 'Enter Router Password'. To the right of the input field, there is a link that says 'Reset Password'. At the bottom of the screen, there is a large blue button with a lock icon and the text 'Log in'.

Router password

We created a secure router password during setup. This is not the same as the WiFi password you created to connect to your mesh system. To change the router password, tap Network Administration and Change Router Password and Hint.

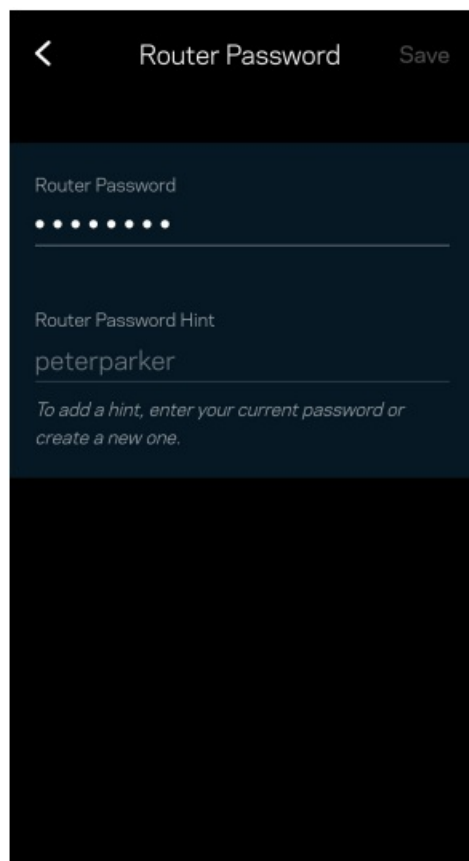

The screenshot shows the 'Router Password' settings screen. At the top, there is a navigation bar with a back arrow, the title 'Router Password', and a 'Save' button. Below the navigation bar, there are two sections. The first section is labeled 'Router Password' and contains a text input field with a masked password represented by seven dots. The second section is labeled 'Router Password Hint' and contains a text input field with the hint 'peterparker'. Below the hint input field, there is a small text note that says 'To add a hint, enter your current password or create a new one.'

To keep your Linksys mesh system secure, we'll send you an email if someone changes the router password.



How to restore factory defaults

You should never need to factory reset your Atlas 6—a very disruptive process. A factory reset restores your router to the state it was when you took it out of its box, requiring you to go through the setup process again. All settings you have customized in setup and since – things such as WiFi name, passwords, security type – will be erased. All wireless devices will disconnect from your WiFi.

To reset your Atlas 6

- With your node connected to power and turned on, press and hold the Reset button on the bottom. The light on top of the node will turn red and fade in pulses. Do not release the button until the light goes out and then turns bright red.

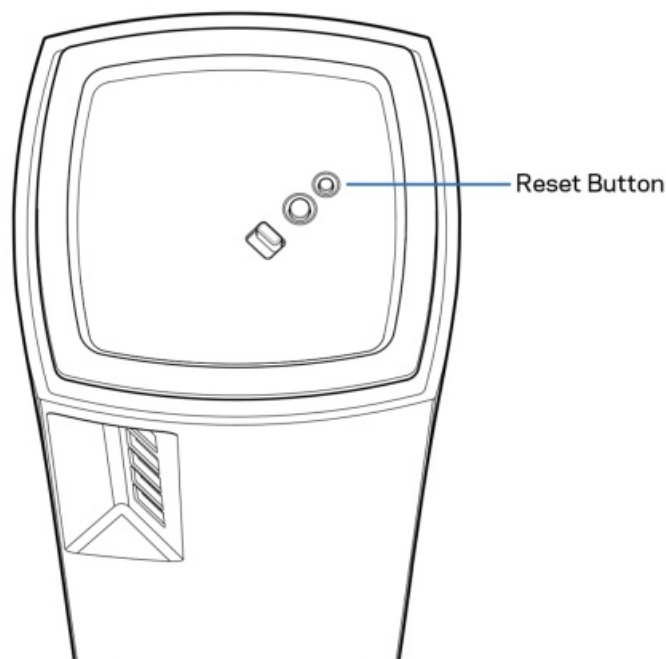

Specifications

Linksys Atlas 6

- **Model Name**
 - Atlas 6 AX3000 WiFi 6 System
- **Model Number**
 - MX2000 series

- **Switch Port Speed**
 - 10/100/1000 Mbps
- **Radio Frequency**
 - 2.4 GHz and 5 GHz
- **# of Antennas**
 - 3 (internal)
- **Ports**
 - Ethernet, Internet, Power
- **Buttons**
 - Power switch, WPS, reset
- **Light**
 - One, multicolored light for power and status
- **Security Features**
 - WPA2-Personal, WPA3-Personal
- **Security Key Bits**
 - Up to 128-bit encryption

Environmental

- **Dimensions**
 - 3.4 inches x 3.4 inches x 7.3 inches
- **Unit Weight**
 - 1.16lb
- **Power**
 - 12V, 1.5A
- **Certifications**
 - FCC, IC, CE, WiFi (IEEE 802.11a/b/g/n/ac, draft 802.11ax)
- **Operating Temp.**
 - 32° to 104° F (0 to 40° C)
- **Storage Temp.**
 - -4° to 140° F (-20 to 60° C)
- **Operating Humidity**
 - 10% to 80% relative humidity, non-condensing
- **Storage Humidity**
 - 5% to 90% non-condensing

Notes: For regulatory, warranty, and safety information, go to [Linksys.com/support/Atlas6](https://linksys.com/support/Atlas6). Specifications are subject to change without notice. Maximum performance derived from IEEE Standard 802.11 specifications. Actual performance can vary, including lower wireless network capacity, data throughput rate, range, and coverage. Performance depends on many factors, conditions, and variables, including distance from the access point, volume of network traffic, building materials and construction, operating system used, mix of wireless products used, interference, and other adverse conditions. Visit linksys.com/support/Atlas6 for award-winning technical support. LINKSYS, Hydra, Atlas, and many product names and logos are trademarks of Linksys Holdings, Inc. and/or its affiliates. Third-party trademarks mentioned are the property of their respective owners. © 2022 Linksys Holdings Inc. and/or its affiliates. All rights reserved.

Documents / Resources

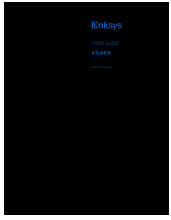

[Linksys MX2002 Atlas 6 WiFi 6 Dual Band Mesh Router](#) [pdf] User Guide
MX2002, MX2000, MX2002 Atlas 6 WiFi 6 Dual Band Mesh Router, MX2002, Atlas 6 WiFi 6 Dual Band Mesh Router, 6 Dual Band Mesh Router, Band Mesh Router, Mesh Router

References

- [User Manual](#)

[Manuals+](#), [Privacy Policy](#)

This website is an independent publication and is neither affiliated with nor endorsed by any of the trademark owners. The "Bluetooth®" word mark and logos are registered trademarks owned by Bluetooth SIG, Inc. The "Wi-Fi®" word mark and logos are registered trademarks owned by the Wi-Fi Alliance. Any use of these marks on this website does not imply any affiliation with or endorsement.