

**Link
tech**
LPH-TW38
True Wireless
Earhook



Link tech LPH-TW38 True Wireless Earhook User Manual

[Home](#) » [LINK TECH](#) » Link tech LPH-TW38 True Wireless Earhook User Manual 

Contents

- 1 Link tech LPH-TW38 True Wireless Earhook
- 2 Product Usage Instructions
- 3 Product Structure
- 4 Technical Specifications
- 5 Wireless pairing
- 6 Power on/off
- 7 Call usage
- 8 Music use
- 9 Charging indicator light
- 10 Safety
- 11 FAQs
- 12 Documents / Resources
 - 12.1 References



Link tech LPH-TW38 True Wireless Earhook



Product Usage Instructions

Wireless Pairing

1. Open the charging compartment and remove the earbuds. The earbuds will automatically turn on or press and hold the multifunction button for 2 seconds, and the indicator light for the earbuds will light up.
2. After connecting the earbuds of the device, it will automatically enter pairing mode upon startup (and try to connect back to the last connected phone); Open the wireless interface of the phone, search for Link-TW38 and click pairing. The connection is successful and accompanied by a prompt tone.

Power On/Off

- **Power on:** Open the charging compartment, and take out the earbuds, and the earbuds will automatically turn on. Press and hold the multifunction button for 2 seconds to turn on the device.
- **Shut down:** Place the L/R earbuds into the charging compartment, close the cover, turn off the earbuds, and start charging. Press and hold the multifunction button for 5 seconds to turn off the devices.

Call Usage

- **Answer:** Click the multifunction touch key.
- **Hang up:** Click the multifunction touch key.
- **Reject:** Press and hold the multifunction key touch area for 2 seconds.

Music Use

Wake-up voice assistant function:

In the music playing or pause state, triple-click the multifunction touch key to start or close the voice assistant function.

Charging Indicator Light

1. Charge the charging case by cable.
2. When the earphones into the charging case, they will be charged automatically.
3. Charging case button: When the earphones are in the charging case, click the button once to display the power of the charging case. Long press the charging case button for six seconds to restore the factory setting; please delete BT pairing information before restoring the factory settings.

FAQs

- **How do I reset the earbuds to factory settings?**

To reset to factory settings, long press the charging case button for six seconds. Remember to delete Bluetooth pairing information before restoring factory settings.

- **How can I activate the voice assistant function?**

In the music playing or pause state, triple-click the multifunction touch key to start or close the voice assistant function.

Please carefully read this Manual before using this product for the very first time and well keep it for further reference.

Dear Link Tech User,

Thank you for choosing Link Tech product. Your choice is crucial for us, which means Link Tech has added a new user. Hope that we will bring you a good experience through our products and services. Also hope you will put forward good advice and suggestions by the official customer hotline, WhatsApp, and Bp in the process of product experience, which can help Link Tech to constantly improve products and service. If you encounter any problems in using this product, please refer to the service process. Your support is our strongest power, also your recognition and evaluation are a great encouragement to Link Tech. Thank you!

Product Structure

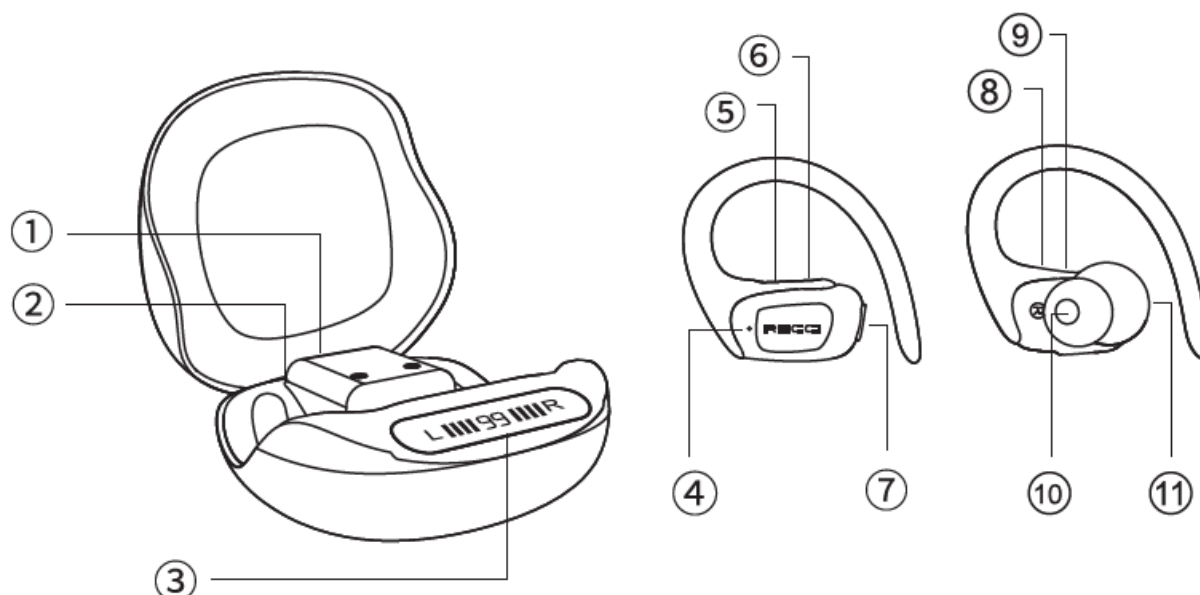

1. Type-C charging interface
2. Charging box button
3. Charging box digital display
4. Earbud indicator light
5. Left ear volume decrease
6. Left ear volume increase
7. Left ear multi-function key
8. Right ear volume decrease
9. Right ear volume increase
- 10- Earbud speaker
10. Right ear multi-function key

Technical Specifications

Wireless Version	V5.3
Transmission Range	10m
Charging Box Capacity	400mAh
Earphone Capacity	50mAh
Charging Port	Type-C
Charging Voltage	DC 5V
Music Time	Around 6hrs(80% volume)
Talk Time	Around 3.5hrs(80% volume)
Charging Time	Around 1.5hrs

Wireless pairing

1. Open the charging compartment and remove the earbuds. The earbuds will automatically turn on or press and hold the multifunction button for 2 seconds, and the indicator light for the earbuds will light up.
2. After connecting the earbuds of the device, it will automatically enter pairing mode upon startup (and try to connect back to the last connected phone); Open the wireless interface of the phone, search for “Link-TW38” and click pairing. The connection is successful and accompanied by a prompt tone.

Power on/off

- **Power on:** Open the charging compartment, and take out the earbuds, the earbuds will automatically turn on, and the earbuds will automatically pair and wait for connection.
Press and hold the multifunction button for 2 seconds to turn on the device.
- **Shut down:** Place the L/R earbuds into the charging compartment, close the cover, turn off the earbuds, and start charging (any L/R)
Press and hold the multifunction button for 5 seconds to turn off the devices. When the earbuds are turned on and the device is not connected, they will automatically turn off after 5 minutes.

Call usage

When using the call function, the L / R earbud can perform the following operations:

- **Answer:** click the multi-function touch key.
- **Hang up:** click the multi-function touch key.
- **Reject:** press and hold the multi-function key touch area for 2 seconds

Wake up voice assistant function (if your phone supports this function)

In the music playing or pause state, triple-click the multi-function touch key to start or close the voice assistant function (Siri).

Music use

- **Music pause/play:** click the left/right ear multi-function touch area (left ear L/right ear R).
- **Previous song:** when music is playing, press and hold the left ear multifunction button for 2 seconds (left ear L).
- **Next song:** when music is playing, press and hold the right ear multifunction button for 2 seconds (right ear R).
- **Volume up:** when music is playing, click the left/right ear volume + button (left ear L/right ear R).
- **Volume down:** when music is playing, click the left/right ear volume-button (left ear L right ear R).

Charging indicator light

1. Charge the charging case by cable

When charging the charging case: The digital LED displays the charging When charging the case fully: The digital LED displays 100.

2. When the earphones into the charging case, they will be charged automatically. The digital LED displays “L “, the left earphone on the charging, and extinguishes when charging fully. The digital LED displays “R “, right earphone on charging, and extinguishes when charging fully.
3. **Charging case button:** When the earphones are in the charging case, click the button once to display the power of the charging case. Long press the charging case button for six seconds to restore the factory setting, please delete the BT pairing information before restoring the factory settings.

Safety

Attention

1. The main ear serves as a bridge between the secondary phone and the mobile phone without interruption, and it is normal for the power consumption to be better than that of the secondary unit.
2. iPhone displays the battery power in real-time.
3. The wearing method is very important to avoid the signal antenna being blocked by the inside of the ear, please wear according to the introduction page wearing method.
4. In the binaural mode, any one-side earphone will block a signal by hand. Currently, this type of technology earphone has this situation, because The equivalent of blocking the signal connection between the two earphones by hand.

5. In the binaural mode, it is not allowed to have too many disturbing obstacles between the earphone and the main earphone (earphone R), and ensure that the distance between them won't affect signal transmission.
6. In binaural mode, if the secondary earphone (L earphone) has an occasional disconnection problem It is a normal phenomenon, after all, wireless is a wireless signal transmission, Like the WiFi network, sometimes instability is normal. At this point, just the signal transmission is disturbed, please wait a moment or move to another place.

Warning

- Do not use corrosive cleaners to clean the product.
- Do not allow this product to be heated or near a fire source.
- Do not expose the product to direct sunlight for a long time.
- Do not discard the product in the fire to avoid an explosion.
- Do not make any modifications to try to disassemble this product because it does not contain any modifiable components.
- Do not use this product in the rain.
- If you have not used this product for a long time, please store it in a dry environment and charge the headset at least once a month to prolong its service life and avoid extreme temperatures and dust.
- You must choose a regular charger from a qualified manufacturer to charge the earphones. This device complies with Part 15 of FCC Rules. Operation is subject to the following two conditions: (1) This device may not cause harmful interference, and (2) This device must accept any interference received, including interference that may cause undesired operation.

FAQs

Earphones cannot be used normally	Put the earphone into the charging box, delete the wireless pairing name in the mobile phone, and turn off the wireless function; after 5 seconds, reopen the battery compartment cover to connect the earphone.
No sound out from earphones	<ol style="list-style-type: none"> 1. Check the wireless device and the current volume of the earphone, make sure it is set on the proper volume. 2. Make sure the earphones pair with the correct device. 3. Keep your earphone and wireless device at an effective distance within 10 meters. 4. Make sure your wireless audio output is on.
Earphone disconnection	<ol style="list-style-type: none"> 1. Check the earphone if it is searching or pairing. Select the correct device, or try to restart it. 2. If there are multiple wireless devices around, please turn them off to avoid connecting interference. 3. If the earphone has been connected to another device, please disconnect it first, restart it, and try it again. 4. If the earphone is low power, charge it.
Sound distortion and sound broken	<ol style="list-style-type: none"> 1. The quality of the audio file of the device is poor, change it to a high-quality audio file. 2. Check the volume level and reduce it if necessary. 3. Check whether the device is out of power, charge it first. 4. The distance between the earphone and the device is beyond the effective distance, or there is an obstacle between them.
Wireless connected keyboard unavailable	<p>Please click the exclamation point on the right side of the wireless connection.</p> <p>Turn off the input device connection.</p>

Manufacturer Company

- **LINK-TECH TRADING COMPANY LIMITED**

FLAT 609A,6/F. FOOK CHONG BUILDING 63 HOL YUEN ROAD, KWUN TONG.KOWLOON.HONG KONG

- **TEL: 3114 7567**

Documents / Resources

 <p>Hello!</p> <p>MODEL: LPH-TW38 TRUE WIRELESS EARHOOK USER MANUAL</p> <p><small>Please read the User Manual carefully before using the product. The product is not to be used in the presence of flammable or explosive materials. © 2019 Link Tech Co., Ltd.</small></p>	<p>Link tech LPH-TW38 True Wireless Earhook [pdf] User Manual</p> <p>LPH-TW38 True Wireless Earhook, LPH-TW38, True Wireless Earhook, Wireless Earhook, Earhook</p>
---	---

References

- [User Manual](#)

[Manuals+.](#) [Privacy Policy](#)

This website is an independent publication and is neither affiliated with nor endorsed by any of the trademark owners. The "Bluetooth®" word mark and logos are registered trademarks owned by Bluetooth SIG, Inc. The "Wi-Fi®" word mark and logos are registered trademarks owned by the Wi-Fi Alliance. Any use of these marks on this website does not imply any affiliation with or endorsement.