

**LINGAN**

D06 Pro Multi  
Functional Ring  
Mouse

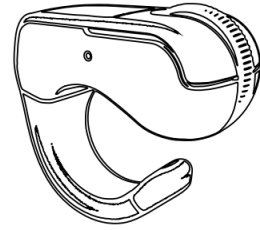

# LINGAN D06 Pro Multi Functional Ring Mouse User Manual

[Home](#) » [Lingan](#) » LINGAN D06 Pro Multi Functional Ring Mouse User Manual 

## Contents

- [1 LINGAN D06 Pro Multi-Functional Ring Mouse](#)
- [2 Product Introduction](#)
- [3 Packing List](#)
- [4 How to Switch the Working Mode](#)
- [5 Power Off](#)
- [6 Charging](#)
- [7 Specifications](#)
- [8 Documents / Resources](#)
  - [8.1 References](#)
- [9 Related Posts](#)

**LINGAN**

**LINGAN D06 Pro Multi-Functional Ring Mouse**

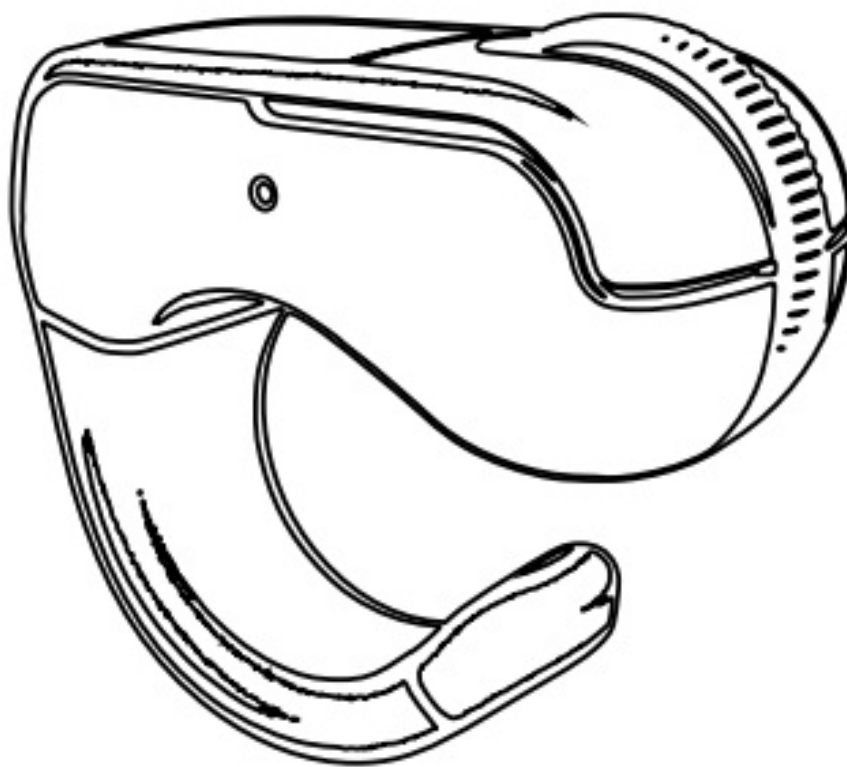

## Product Introduction

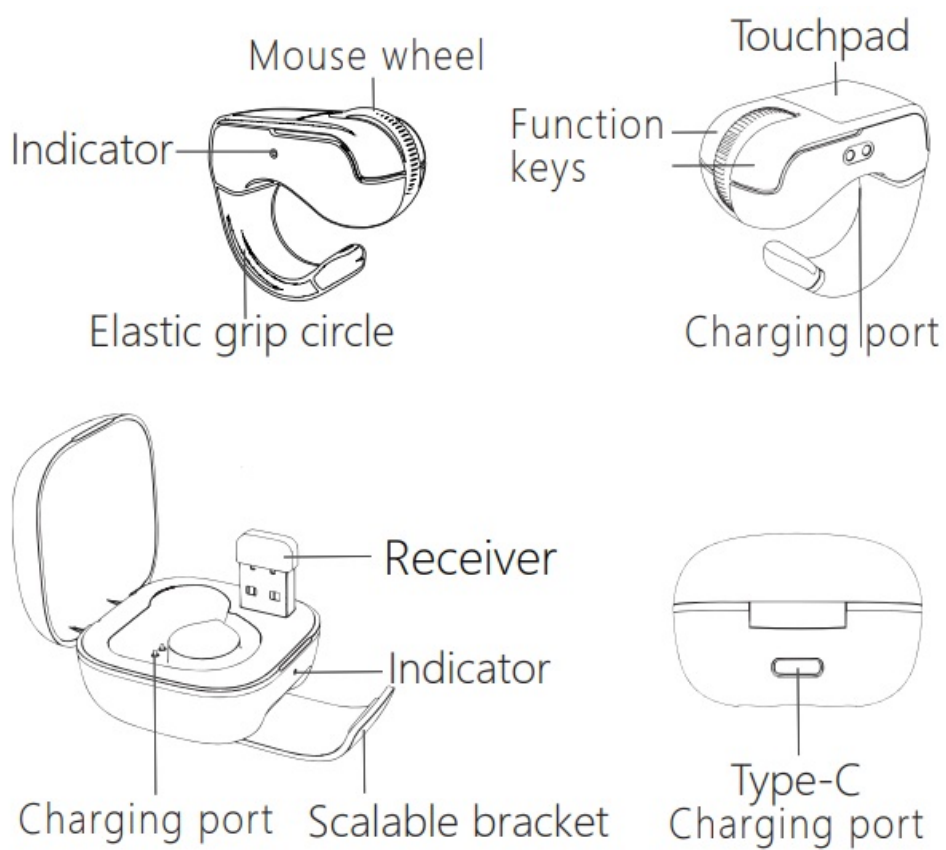

## Packing List

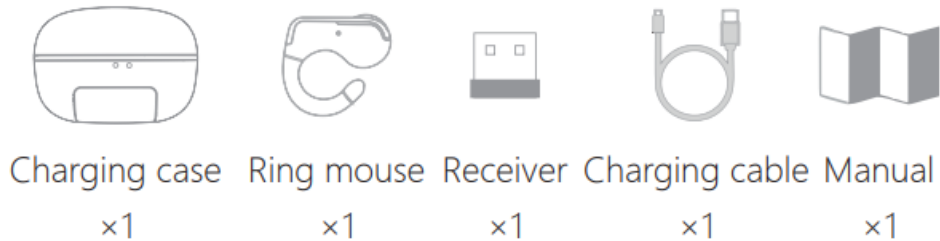

## Using Phones/iPads/Tablets

- Step 1. Make sure that the Apple phone or iPad system software (iOS) is higher than 14.8. Turn on “AssistiveTouch” if using an iOS device. Android devices do not need to do this step; They can be used by connecting to Bluetooth directly.

### iOS Devices

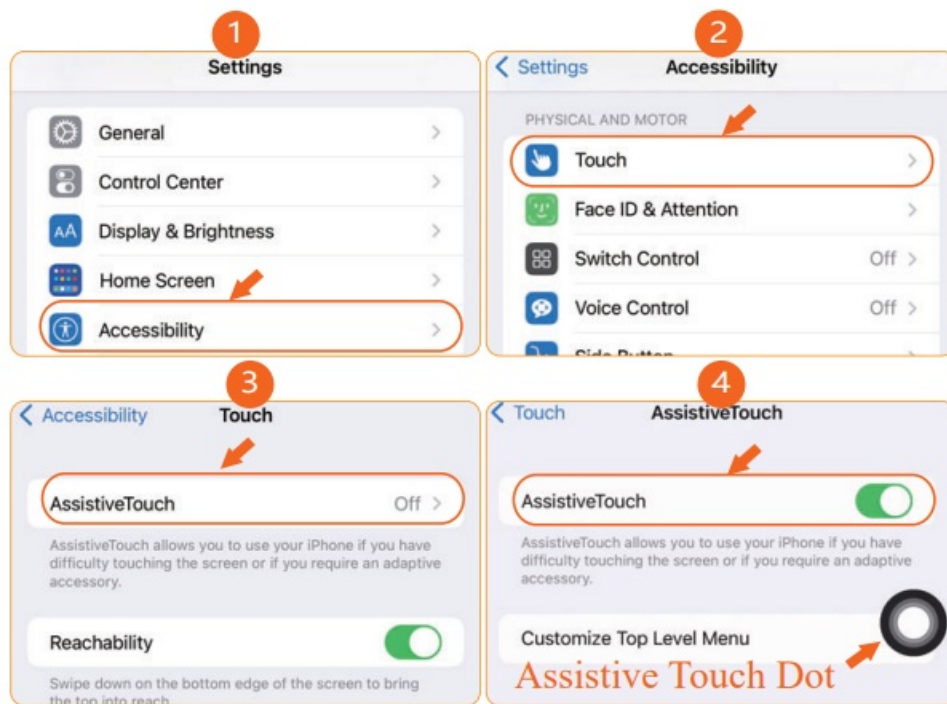

- Step 2. Turn on the ring mouse. Press and hold the mouse wheel for 1 second until the blue light flashes quickly. If the indicator light is flashing red and blue at the same time, it needs to be switched to bluetooth mode

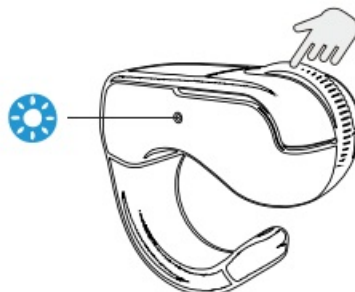

- Step 3. Pair the Bluetooth D06 Pro. Enable Bluetooth and connect to the D06 Pro. Note: When the ring mouse is turned on again, it automatically connects to the last device.

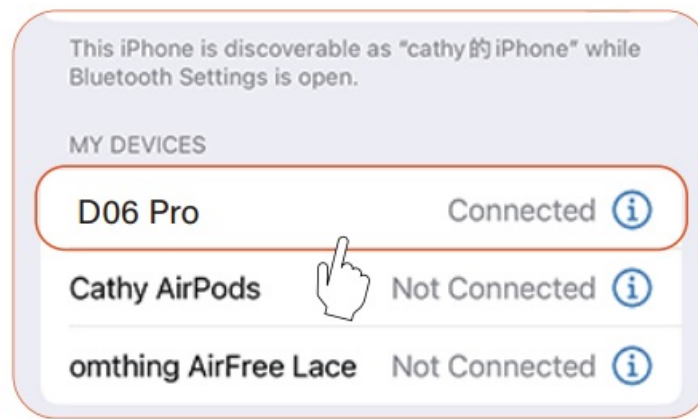

## Key Functions in Phones/iPads/Tablets

In short video or camera application

- **Scroll up:** Next video
- **Scroll down:** Previous video
- **Click:** Return to Desktop

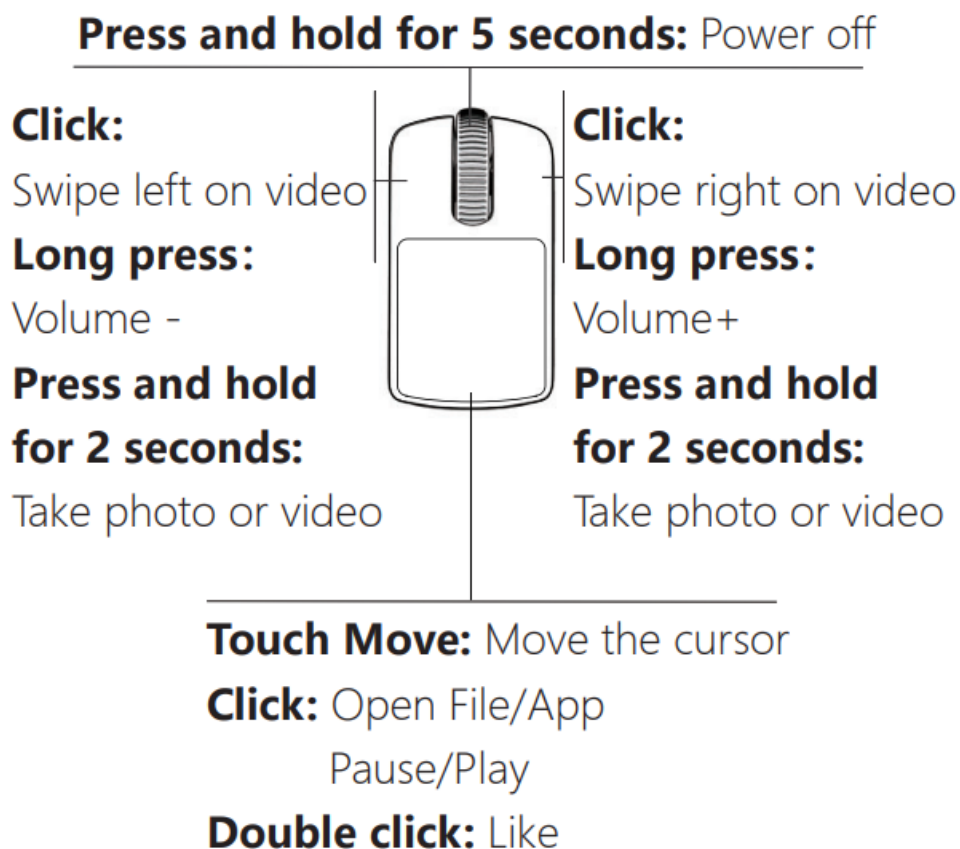

## How to Switch the Working Mode

The mouse has two modes:

- **Bluetooth Mode:** Connect a phone, computer, or tablet via Bluetooth.
- **2.4G Mode:** Connect computers and other devices that can use the MicroUSB interface through a USB

receiver.

- The factory mode of the mouse is Bluetooth Mode. When the mouse is powered on, switch mode operation as shown in the following figure:

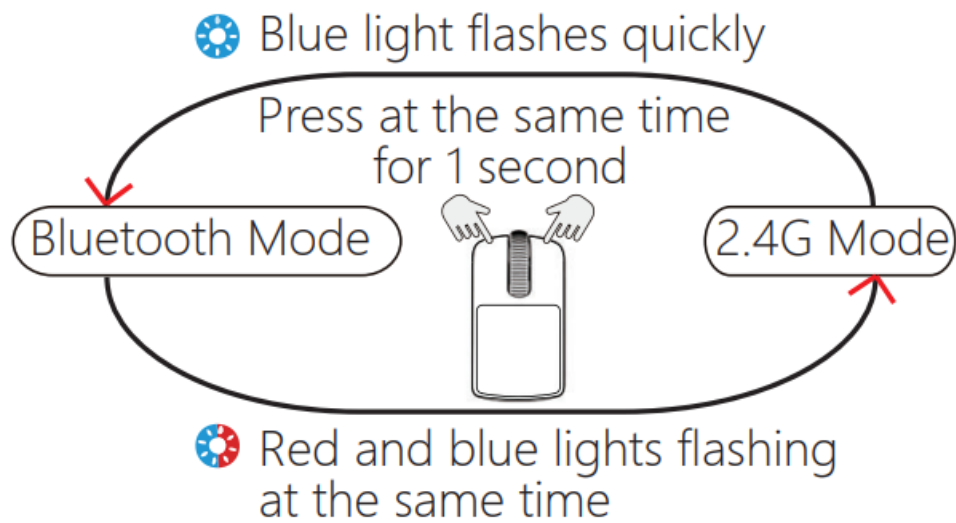

### Using in Computer

Using in 2.4G mode:

- Step 1: Insert the USB receiver into the Micro USB interface of the device.

Notebook computer

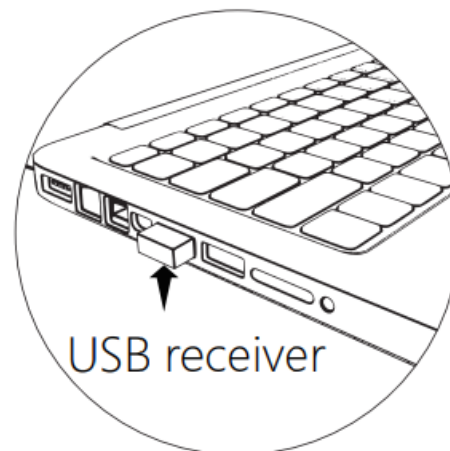

Desktop computer

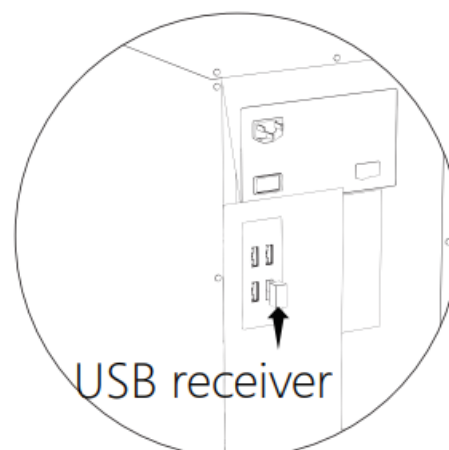

- Step 2: Long press the mouse scroll wheel on the ring for 1 second to turn on the device. The indicator lights will flash red and blue alternately. When the mouse indicator lights do not flash, they are successfully

connected.

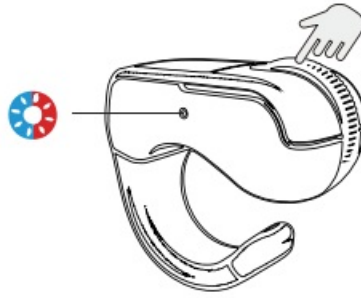

If the blue indicator light flashes quickly, it needs to be switched to 2.4G mode (see page 5). If unsuccessful, unplug the USB receiver and reinsert it, then reconnect until successful.

### Using bluetooth mode:

- Step 1: Long press the ring mouse wheel for 1 second to turn on the device, and the blue indicator light will flash quickly. If the indicator light is flashing red and blue at the same time, it needs to be switched to bluetooth mode (see page 5).

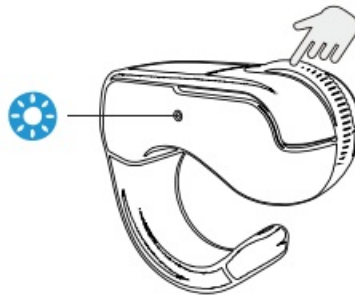

- Step 2: For users of Windows 10 (After you've checked that your Windows PC supports Bluetooth, you'll need to turn it on) or above and Apple Mac systems, open the Bluetooth settings menu, search for and add a device with the Bluetooth name "D06 Pro", and follow the system pop-up prompt to complete the connection( Taking Windows system as an example).

### Turn on Bluetooth

After you've checked that your Windows PC supports Bluetooth, you'll need to turn it on. Here's how: Select Start> Settings> Bluetooth & devices, and then turn on Bluetooth.

### To pair a Bluetooth device

1. Turn on your Bluetooth device and make it discoverable. The way you make it discoverable depends on the device. Check the device or visit the manufacturer's website to learn how.
2. On your PC, select the Network ,Sound, or Battery icons next to the time and date on the right side of your taskbar.
3. Select Manage Bluetooth devices on the Bluetooth quick setting, then select your device under New devices. Follow additional instructions if they appear, then select Done.

In PPT/Short videos/Web pages/ DOC documents, etc.

- **Scroll up:** Previous Video/PPT Previous Page/

- Web Document Scroll Up
- **Scroll down:** Next Video/PPT Next Page/ Web Document Scroll Down
- (Apple Mac system cannot use the scroll wheel in PPT)

## Press and hold for 5 seconds: Pown off

### Click:

Pause/Play/  
PPT Next Page

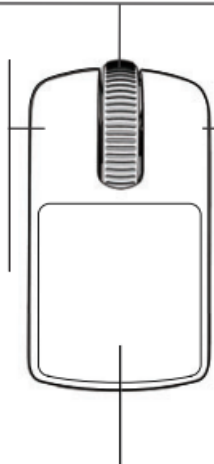

### Click:

Right-click menu  
Click on the pre-  
vious page in the  
Mac system's PPT

**Touch Move:** Move the cursor

**Click:** Pause/Play/PPT Next Page

**Double click:** Open File/App/Like

## Power Off

- – Press and hold the mouse wheel for 5 seconds and the red light flashes twice, or put it in the charging case.

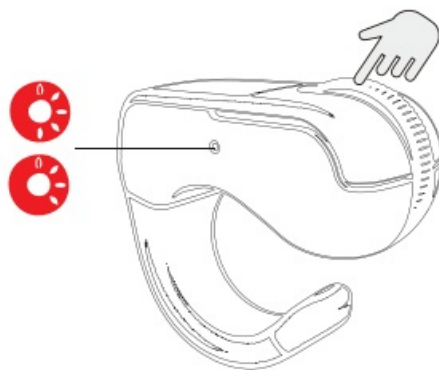

- – Automatic power off after 5 minutes without connection.
- Automatic power off after 30 minutes without operation.

## Charging



**Charging Fully Charged**

## Low Power Warning

The red light of the ring mouse flashes slowly, and the blue light of the charging case flashes slowly, indicating low

power.

## **Charging**

Only charge the charging case

- Red light flashes slowly
- Steady red light

Charging case with ring mouse plug charging cable (closed cover)

- Red light flashes slowly
- Steady red light

Charging case with ring mouse without charging cable (closed cover)

- Steady blue light
- Blue light off

## **Specifications**

### **Ring mouse**

- Connection Method: Bluetooth 5.3/3.0, Wireless 2.4GHz
- Transmission Power: Class II (-6dBm~+4dBm)
- Frequency (Hz): 2.40GHz~2.48GHz
- Bluetooth Name: D06 Pro
- Communication Distance: 10 meters:
- Battery Capacity: 40mAh
- Charging Time : About 1.5 hours

### **Charging Case**

- Battery Capacity: 250mAh
- Charging Time: About 1.5 hours
- Charging Interface: Type-C
- Input 5V 0.5A

### **Warning:**

Patented products, counterfeiting must be investigated

## **Documents / Resources**





**[LINGAN D06 Pro Multi Functional Ring Mouse](#)** [pdf] User Manual  
D06 Pro, D06 Pro Multi Functional Ring Mouse, Multi Functional Ring Mouse, Functional Ring Mouse, Ring Mouse, Mouse

## References

- [User Manual](#)

[Manuals+](#), [Privacy Policy](#)

This website is an independent publication and is neither affiliated with nor endorsed by any of the trademark owners. The "Bluetooth®" word mark and logos are registered trademarks owned by Bluetooth SIG, Inc. The "Wi-Fi®" word mark and logos are registered trademarks owned by the Wi-Fi Alliance. Any use of these marks on this website does not imply any affiliation with or endorsement.