

LILIN
P2P Pro Adding NVR
Standalone Network
Video Recorder



LILIN P2P Pro Adding NVR Standalone Network Video Recorder User Manual

[Home](#) » [LILIN](#) » LILIN P2P Pro Adding NVR Standalone Network Video Recorder User Manual 

Contents

- [1 LILIN P2P Pro Adding NVR Standalone Network Video Recorder](#)
- [2 Product Information](#)
- [3 Product Usage Instructions](#)
- [4 FAQ](#)
- [5 Usage Instructions](#)
- [6 Documents / Resources](#)
 - [6.1 References](#)



LILIN P2P Pro Adding NVR Standalone Network Video Recorder



Product Information

Specifications:

- **Product:** LILIN NVR
- **Remote Access:** P2P support using LILINPro app

Product Usage Instructions

Enabling P2P on NVR

1. Access the NVR menu.
2. Navigate to `Network` and select `Advance`.
3. Under `Advance`, choose `P2P`.
4. Turn the dropdown option labeled `Enable` to `On` and click `Apply`.

Adding NVR to LILINPro using P2P

1. Download LILINPro from the app store.
2. Run the LILINPro app and select `Add/Change Devices`.
3. Select `Scan QR code` and scan the QR code displayed on the NVR.
4. Enter your Username, Password, and Device Name as per your site's specifications.
5. Press `Step 1` to verify the entered details.
6. Press `Step 2` to connect to NVR and display cameras.

FAQ

Q: What should I do if the app does not connect to the cameras after Step 2?

A: Close the app and reopen it. The app should then display the cameras correctly.

Usage Instructions

- LILIN NVR range supports P2P as the standard for remote access using the LILINPro app.
- Although the NVR has the P2P license already added to the NVR the feature may need to be enabled before use.
- Enter the NVR menu, then navigate to `Network` from the menu bar on the left, and then select `Advance` from the tabs at the top of the Network screen. Under the Advance menu, select `P2P` from the bar to the left.

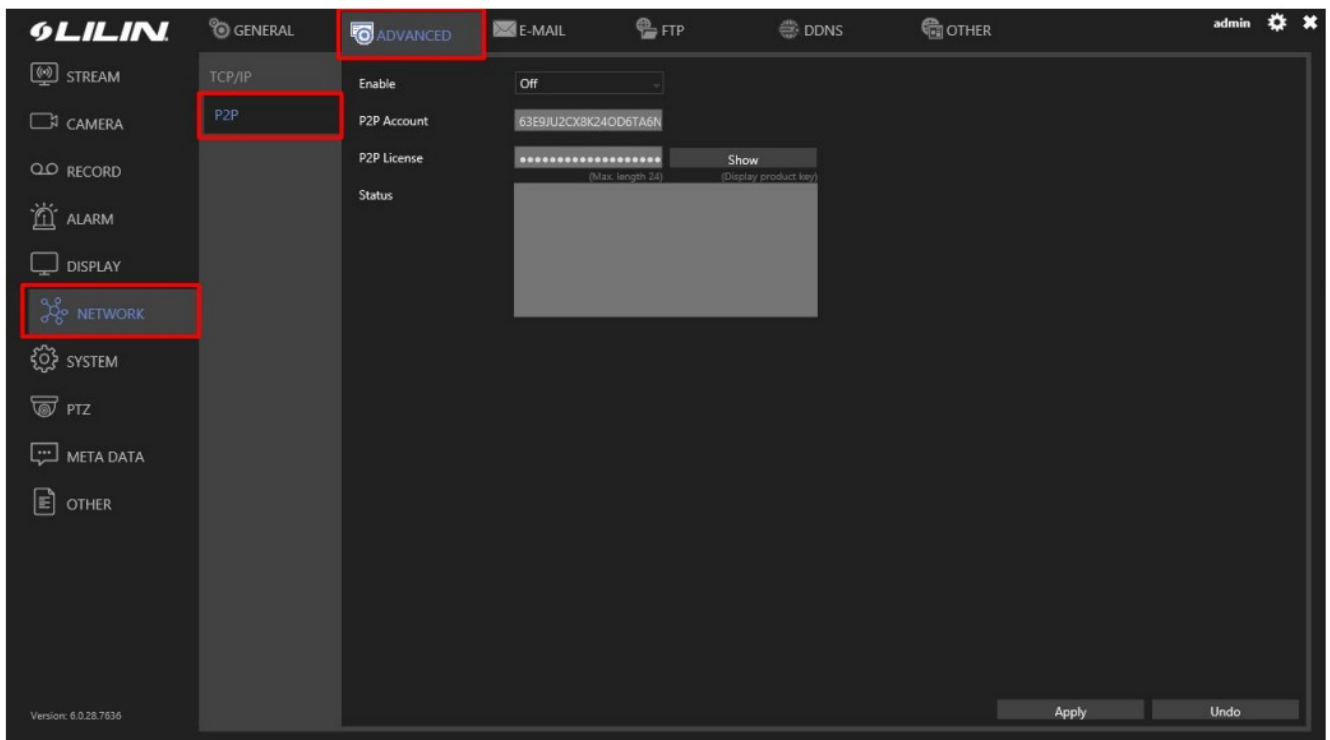

- You will see a dropdown option labeled 'Enable', turn this option to 'On' and click 'Apply'.



- The NVR will now generate a unique QR code which is displayed below the license status box with the correct information based on the license key entered.

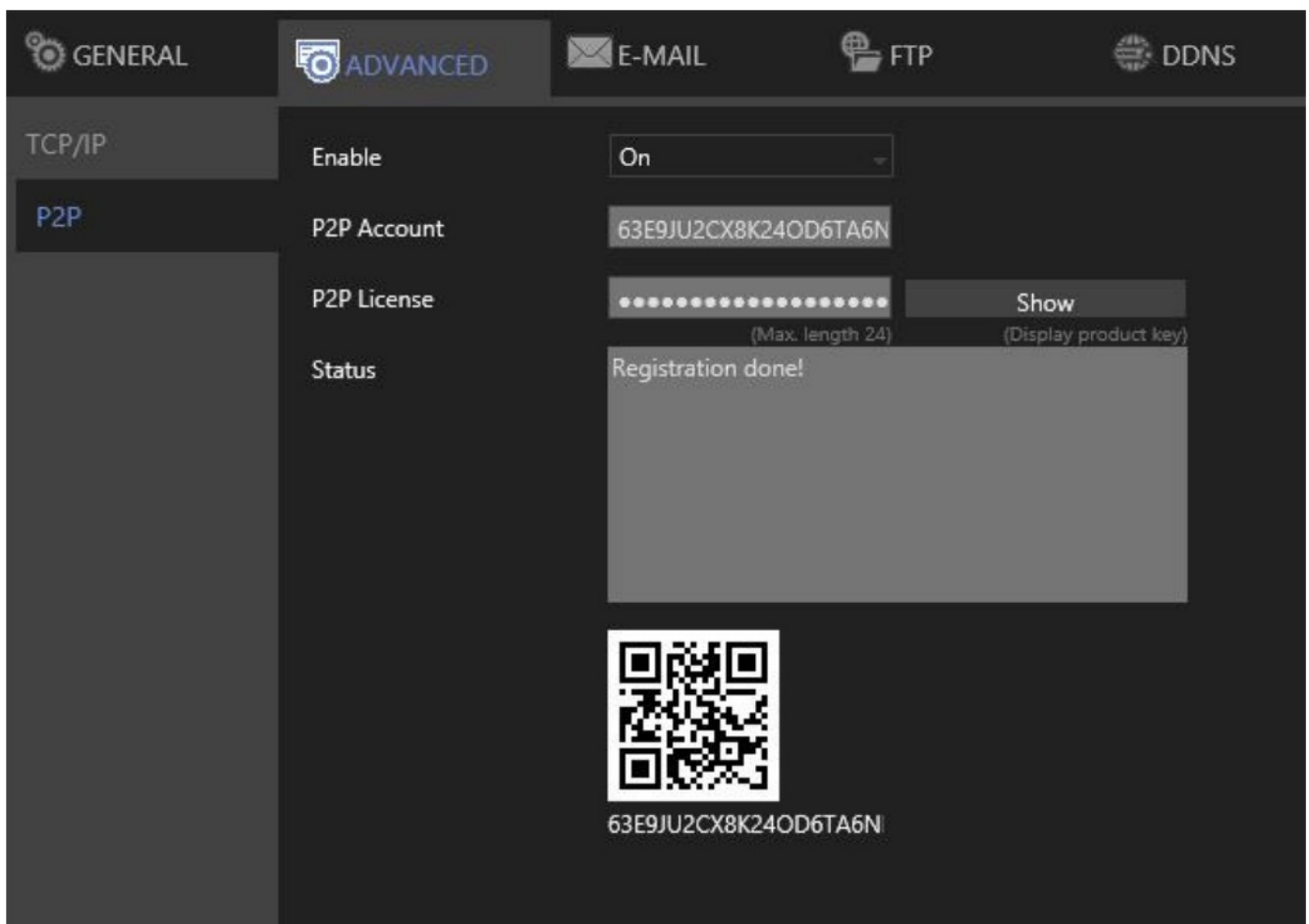

- Now the QR code is configured on the NVR the next step will be to add the NVR to the LILIN Viewer app.

Adding an NVR to LILINPro using P2P

- Download LILINPro from the relevant app store applicable to your mobile device.
- Once downloaded, run the LILINPro app on your mobile device.
- When the app opens, select 'Add/Change Devices' from the menu bar.

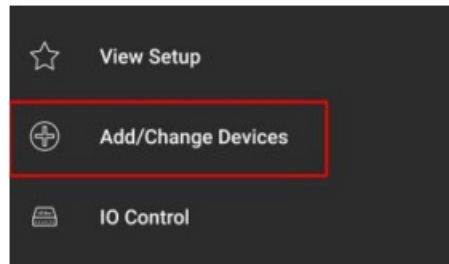

- Now select the 'Scan QR code' option as shown below.

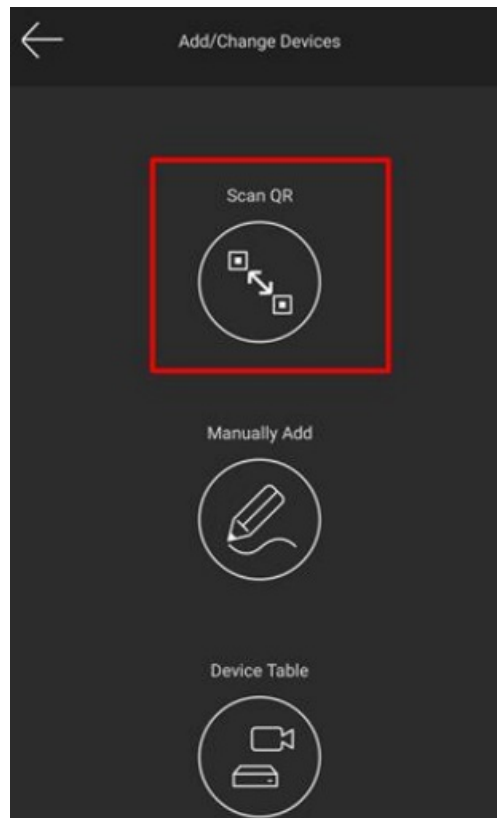

- You will now need to scan the QR code being displayed on the NVR. Once scanned this will take you to a configuration screen where you will need to amend a few details specific to your site.

Please amend the following:

- Username
- Password
- Device Name

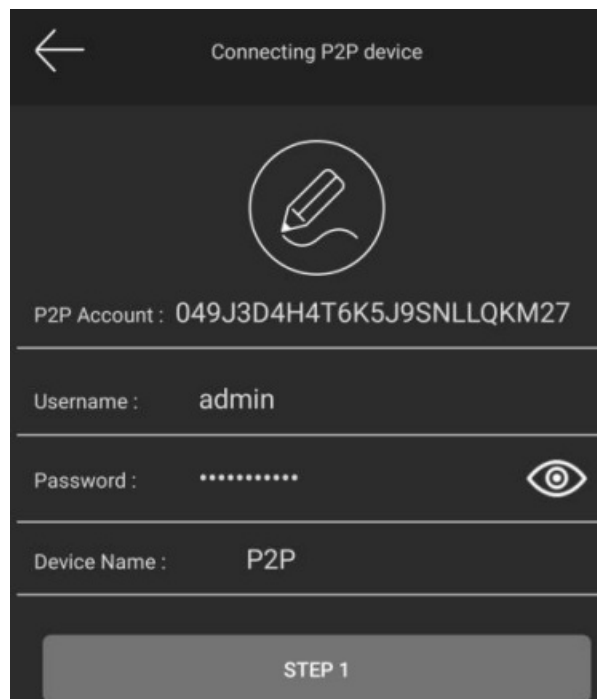

Connecting P2P device

P2P Account : 049J3D4H4T6K5J9SNLLQKM27

Username : admin

Password : 

Device Name : P2P

STEP 1

- The username and password you will need to enter are the authentication details for the NVR.
- Once the required details have been entered press 'Step 1' from the bar at the bottom of the app.
- The App will now check the information in Step 1 is correct.

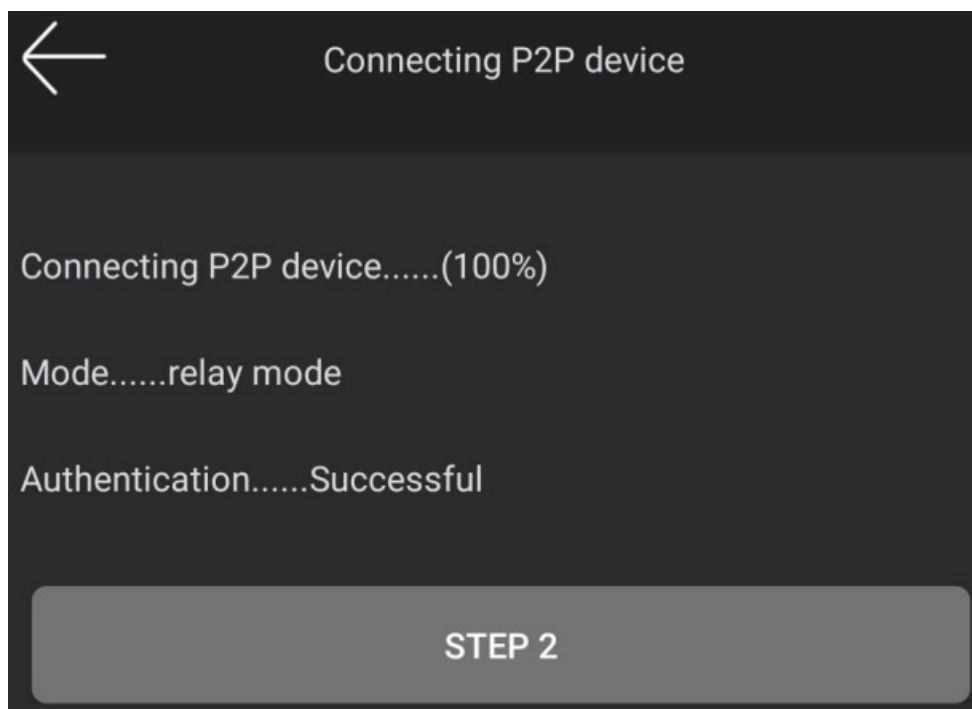

Connecting P2P device

Connecting P2P device.....(100%)

Mode.....relay mode

Authentication.....Successful

STEP 2

- Now press Step 2 and the app should start to connect to your NVR and display cameras.

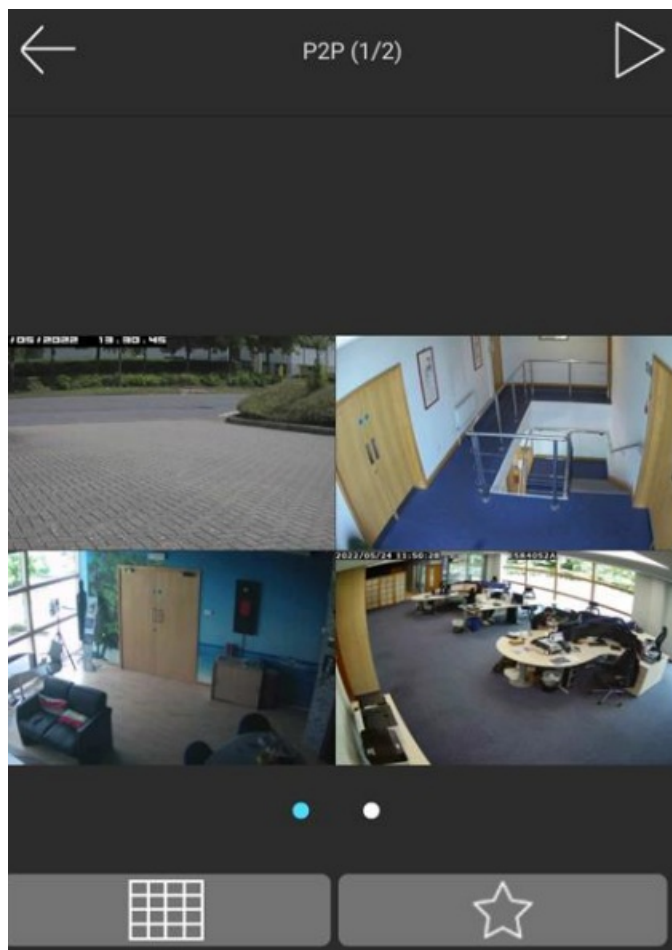

- If you find the app does not connect to the cameras after step 2 has been completed, it is recommended to close the app down and re-open it once again and the app should then display the cameras correctly.

Documents / Resources

	<p>LILIN P2P Pro Adding NVR Standalone Network Video Recorder [pdf] User Manual P2P Pro Adding NVR Standalone Network Video Recorder, Adding NVR Standalone Network Vi deo Recorder, NVR Standalone Network Video Recorder, Standalone Network Video Recorder, Network Video Recorder, Video Recorder, Recorder</p>
--	--

References

- [User Manual](#)

[Manuals+](#), [Privacy Policy](#)

This website is an independent publication and is neither affiliated with nor endorsed by any of the trademark owners. The "Bluetooth®" word mark and logos are registered trademarks owned by Bluetooth SIG, Inc. The "Wi-Fi®" word mark and logos are registered trademarks owned by the Wi-Fi Alliance. Any use of these marks on this website does not imply any affiliation with or endorsement.