



LIGHTPRO Oberon DL 192P Post Light User Manual

[Home](#) » [LiGHTPRO](#) » LIGHTPRO Oberon DL 192P Post Light User Manual 

Contents

- 1 LIGHTPRO Oberon DL 192P Post Light
- 2 The system
- 3 PRODUCT DESCRIPTION
- 4 SPECIFICATIONS
- 5 PACKAGING CONTENT
- 6 INSTALLATION
 - 6.1 OPTION 2: INSTALLATION ON SOLID GROUND
- 7 SETTING THE DIMMER
- 8 SETTING THE LIGHT PATTERN
- 9 INSTALLATION OF THE LIGHTS
- 10 SAFETY
- 11 Documents / Resources
 - 11.1 References
- 12 Related Posts



LIGHTPRO Oberon DL 192P Post Light



The system

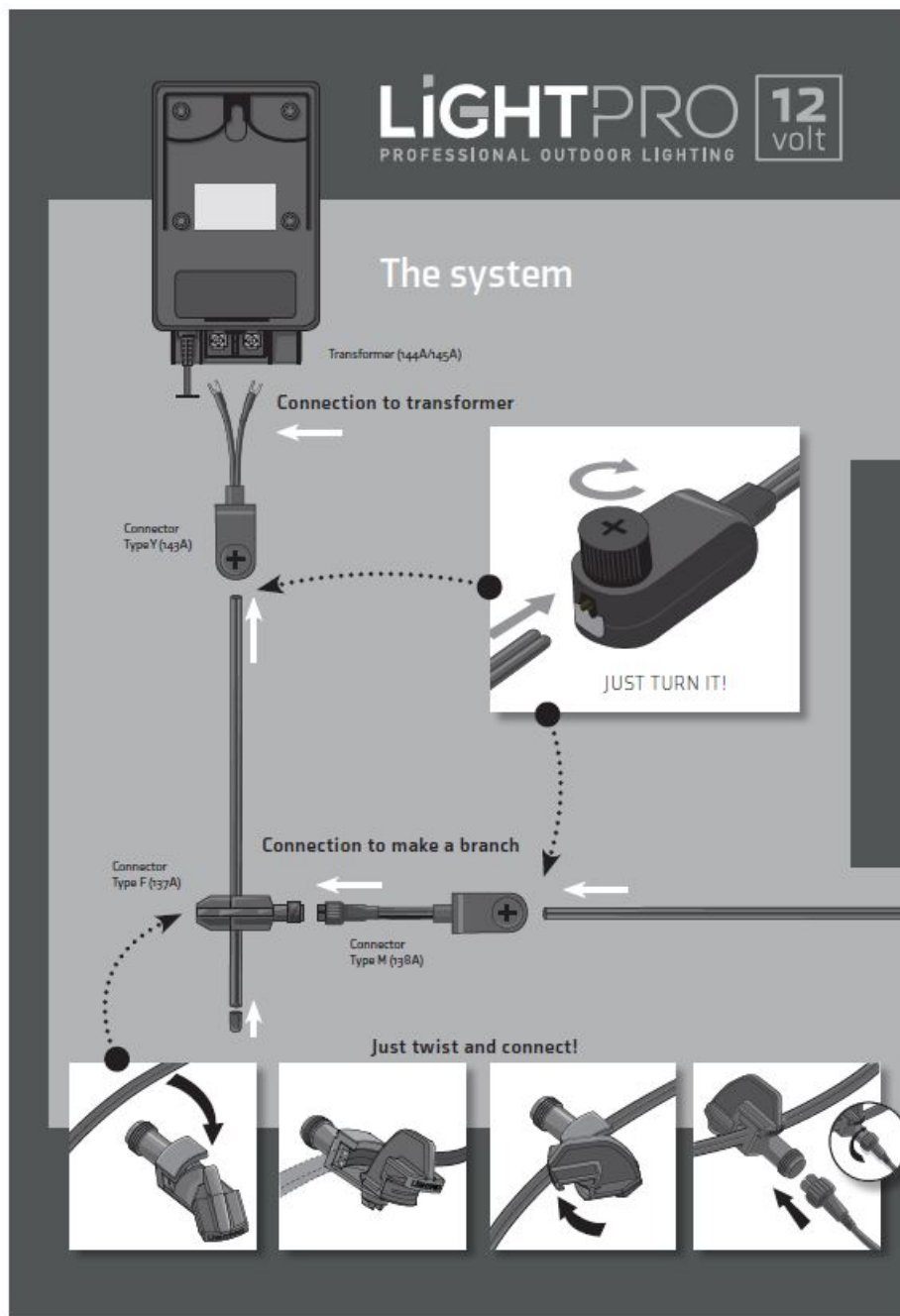

Oberon DL User manual

Thank you for purchasing the Lightpro Oberon DL.

This document contains the required information for correct, efficient and safe use of the product. Consult the user manual of your transformer for more information about the installation and connection of your lighting plan or visit our website www.lightpro.nl

Read the information in this manual carefully before using the product. Keep this manual near the product for consultation in the future.

PRODUCT DESCRIPTION

The Lightpro Oberon is a standing LED lamp for outdoor use. The fixture can be mounted on a solid surface or placed in the ground with the supplied spikes.

This product may only be used as outdoor lighting in combination with the Lightpro 12-volt system. Any alterations made to the product may have consequences for the safety, guarantee and correct functioning of the product and/or other parts of the system.

SPECIFICATIONS

- Product Lightpro Oberon DL
- Article number 192P
- Light source LED 9W AC/DC 12V
- Power (max.) 9W
- Luminous flux (max) 750 lm
- Light colour 3.000K
- Dimensions (H x D x W) 600 x 110 x 63 mm
- Protection class IP44
- Ambient temperature -20°C to 50°C
- Cable length 1m
- Dimmable Yes. Adjustable to 6 levels
- Light source Not replaceable

PACKAGING CONTENT

[Figure A]

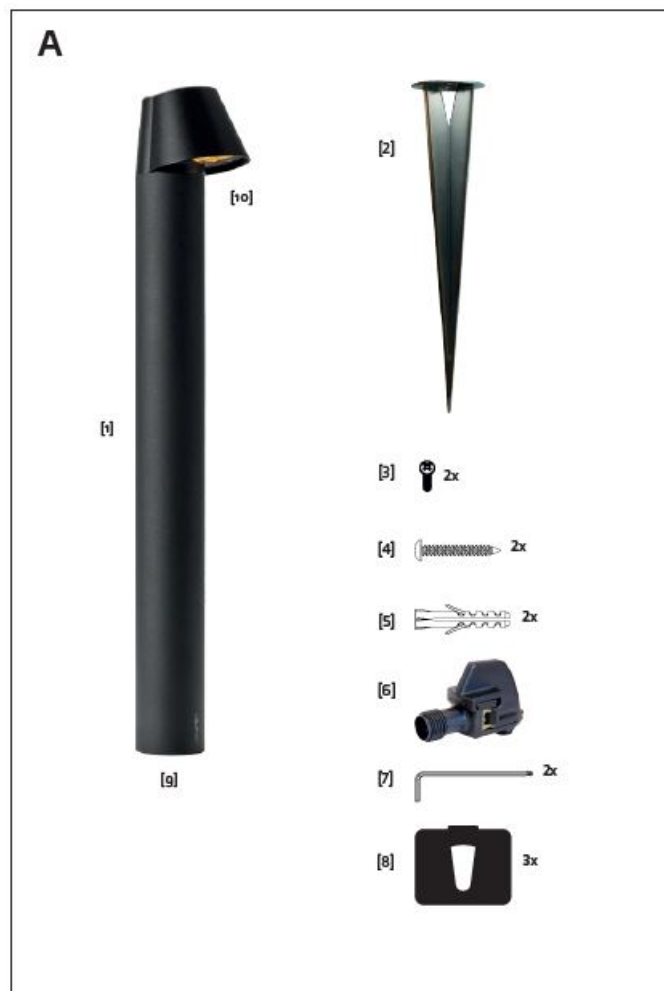

1. Oberon DL fixture
2. Ground spike
3. Screws
4. Screws
5. Plugs

6. Lightpro F-connector
7. Hex key
8. Insert template for light angle

Check if all parts are present in the packaging.

For questions about parts, service, and any complaints or other remarks, you can always contact us. E-mail: info@lightpro.nl

INSTALLATION

OPTION 1: INSTALLATION IN THE GROUND.

[Figure B]

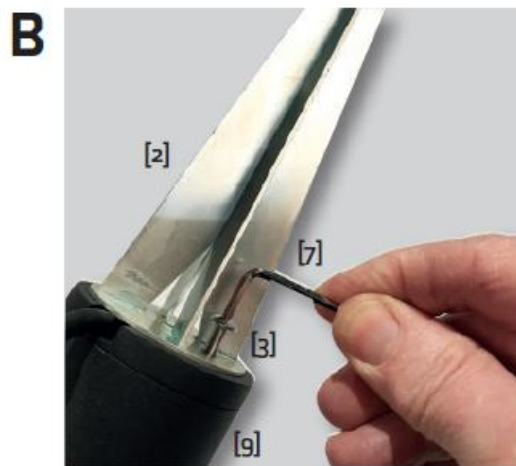

Secure the spike [2] to the base [9] with the supplied screws [3] using the hex key provided [7].

OPTION 2: INSTALLATION ON SOLID GROUND

[Figure C, D, E]

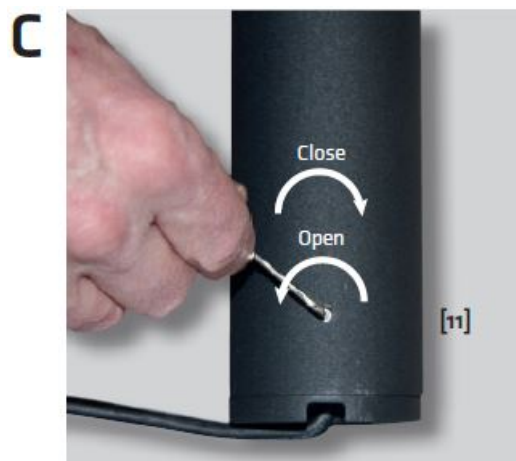

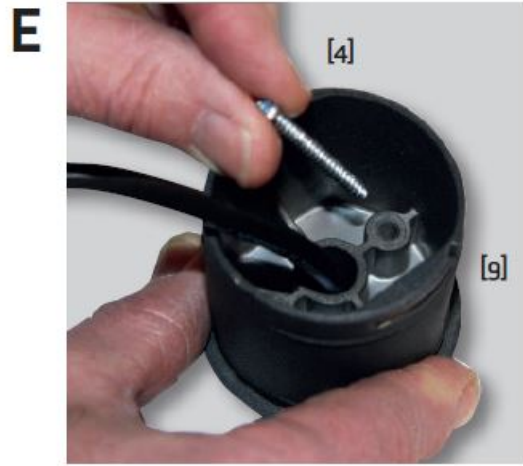
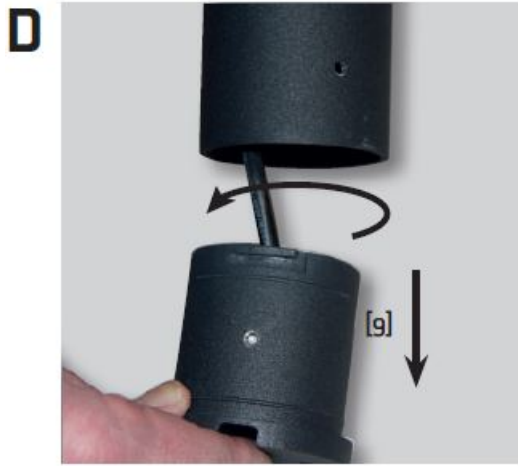

1. Remove the screw [11] from the fixture [1] using the hex key provided [7].
 2. Turn the base [9] anti-clockwise, as far as it will go. Then, remove the base.
 3. Secure the base [9] to the ground using the screws [4].
 4. Place the fixture [1] onto the base [9].
 5. Turn the fixture clockwise (seen from above), as far as it will go.
 6. Using the hex key [7], secure the screw [11] to the fixture [1] and base [9].
- NB: Pre-drill holes if necessary and use the plugs provided [5].

SETTING THE DIMMER

The Oberon DL comes with a dimmer that can be set to 6 different pre-programmed levels.

[Figure F, G]

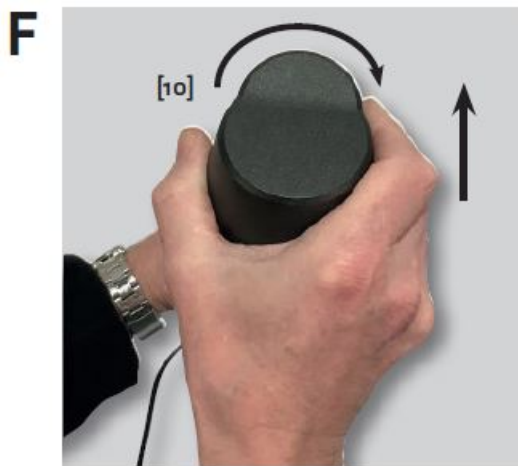

1. Turn the lamp holder [10] clockwise (seen from above), as far as it will go.
2. Then, carefully pull the lamp holder [10] out of the fixture using a gentle twisting motion.
3. Set the desired brightness using the push button. Light can be set to six levels.

NB: Thanks to the memory function, the dimmer will retain the set level when the light is switched off. retain the set level.

4. Install the lamp holder [10] into the fixture, in reverse order.
5. Check that the lamp holder is in the correct position.

SETTING THE LIGHT PATTERN

With the Oberon DL, you can change the light angle using three different insert templates [8], which are included as standard.

[Figure H, I]

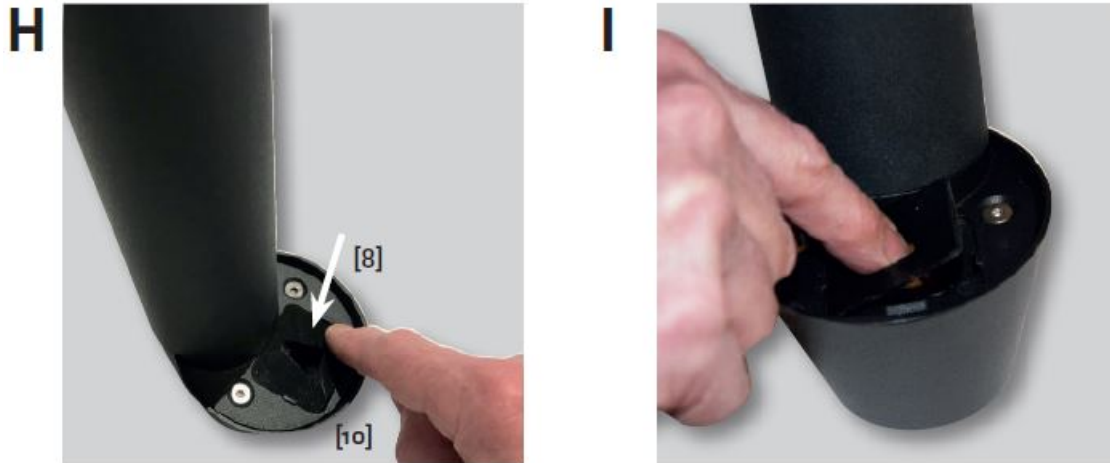

1. Choose the desired plate [8].
2. Insert the template [8] into the corresponding slot in the lamp holder.
3. Press the template into the correct position manually, until it clicks in place.
4. To change the template, simply remove the current plate manually and replace it with the desired template.

INSTALLATION OF THE LIGHTS

- Install the products in the desired position and lay the cables so they can be comfortably connected to the transformer or main cable.
- If products are provided with a drain hole for water, this hole must be pointing downwards.
- Use non-corrosive fixing materials (supplied as standard) if you want to bolt the products down.
- Connect the lights to the main cable by using the connector as shown in figure on page 5.
- Consult the manual of your transformer for more information.

SAFETY

- Always fit this product so that it can still be accessed for servicing or maintenance. This product must not be permanently embedded or bricked in.
- Turn off the system by pulling the plug of the transformer from the socket for maintenance.
- Regularly clean the product with a soft, clean cloth. Avoid abrasives that can damage the surface.
- Clean products with stainless steel parts with a stainless steel cleaning agent once per six months.
- Do not use a high pressure washer or aggressive chemical cleaning agents when cleaning the product. This can cause irreparable damage.
- Protection class III: this product may only be connected to safety extra-low voltage up to a maximum of 12 Volt.
- This product is suitable for outside temperatures of:
 - 20 to 50 °C.

- Do not use this product in areas where combustible gases, fumes or liquids may be stored.

This product meets the EU standards for health, safety and environmental protection.

For questions about parts, service, any complaints or other matters, you can contact us at any time. E-mail: info@lightpro.nl

Discarded electrical equipment must not be put in the household waste. If possible, take it to a recycling company. For details of recycling, contact a municipal waste processing company or your dealer.

5 year warranty – visit our website at lightpro.nl for warranty conditions.

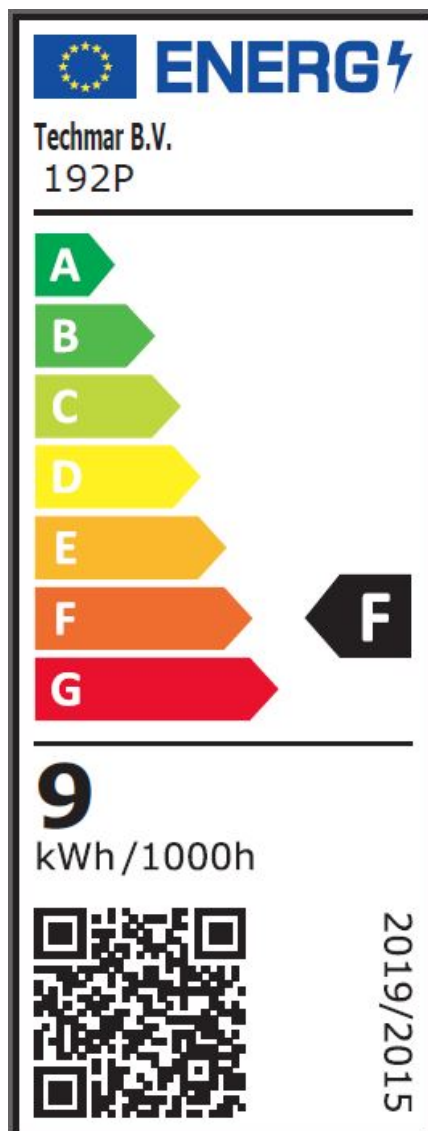

TECHMAR B.V. | CHOPINSTRAAT 10 | 7557 EH HENGELO | THE NETHERLANDS | WWW.LIGHTPRO.NL



UK Authorised Representative (for authorities only) ProductIP (UK) Ltd.

Documents / Resources

	<p>LIGHTPRO Oberon DL 192P Post Light [pdf] User Manual Oberon DL 192P Post Light, Oberon DL 192P, Post Light, Light</p>
---	--

References

-  [Lightpro](#)
-  [Lightpro](#)