



LIGHTPRO Nodin 128P 3W Post Light Instructions

[Home](#) » [LiGHTPRO](#) » LIGHTPRO Nodin 128P 3W Post Light Instructions 

Contents

- [1 LIGHTPRO Nodin 128P 3W Post Light](#)
- [2 TECHNICAL DATA](#)
- [3 ASSEMBLY INSTRUCTION](#)
- [4 SAFETY](#)
- [5 INSTALLATION OF THE LIGHTS](#)
- [6 REPLACEABLE LIGHTSOURCE](#)
- [7 CONDITIONS OF GUARANTEE](#)
- [8 DISPOSAL](#)
- [9 Documents / Resources](#)
 - [9.1 References](#)
- [10 Related Posts](#)



LIGHTPRO Nodin 128P 3W Post Light



TECHNICAL DATA

- 3 Watt – LED
- 190 Lumen
- 3000 Kelvin
- 20.000 Hours
- On/Off 10.000
- Non dimmable
- Instant full light
- Power factor > 0,5
- Failure < 5% after 1000h
- Failure < 10% after 6000h
- Flux > 80% after 6000h
- CRI > 65

ASSEMBLY INSTRUCTION

ASSEMBLY OF THE LIGHTS MUST BE AFFECTED AS SHOWN IN THE PHOTO'S BELOW.

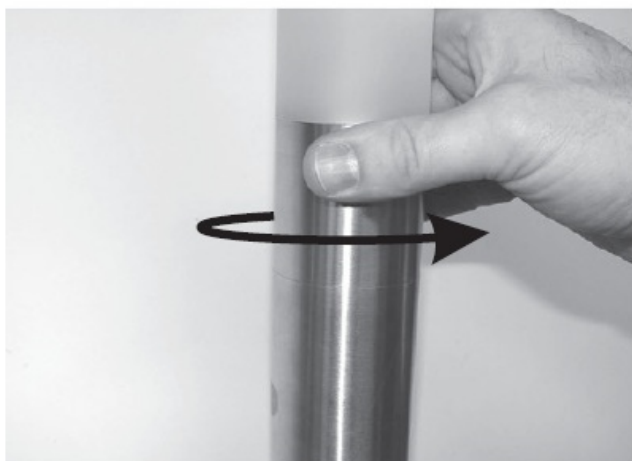
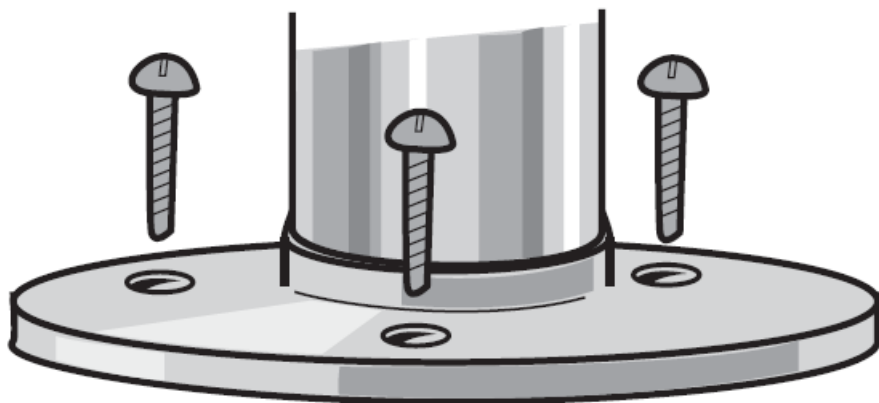

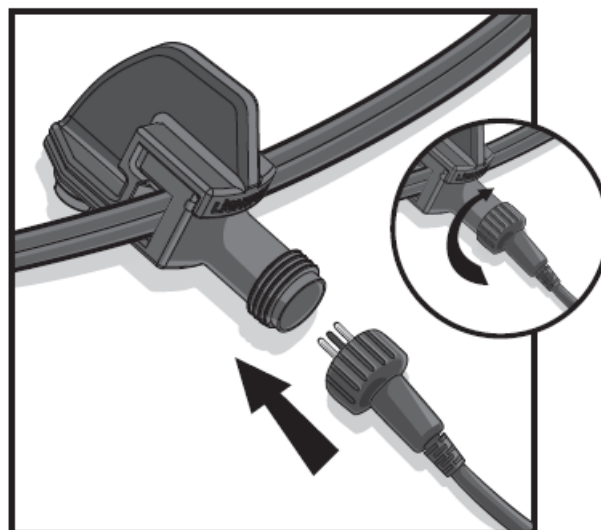
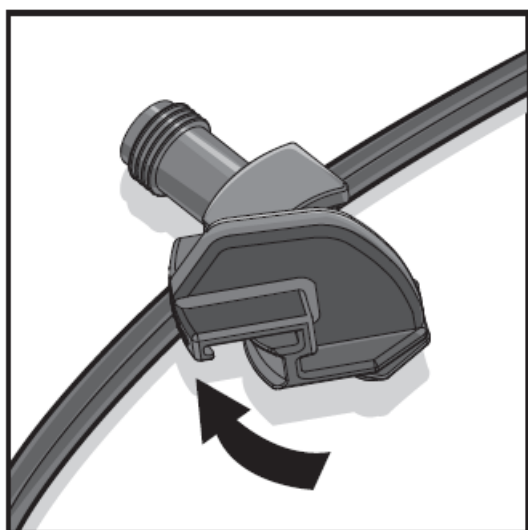
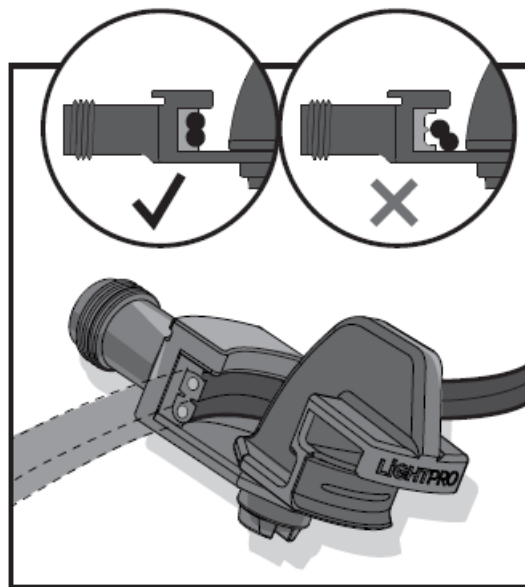
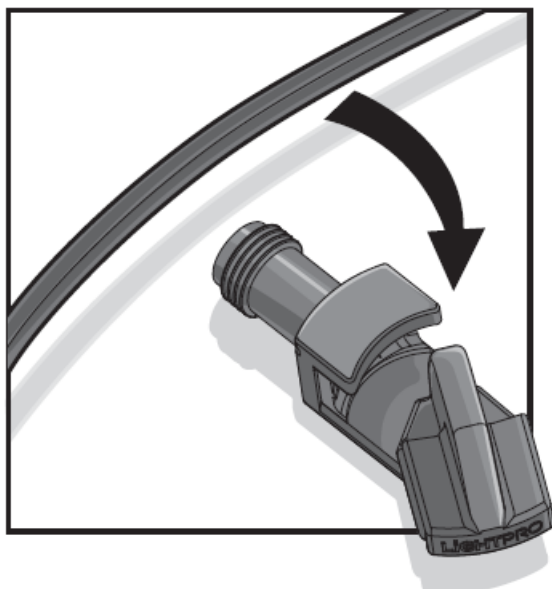

For questions about parts, service, any complaints or other matters, you can contact us at any time. E-mail: info@lightpro.info

Read the safety instructions carefully and follow the advice. Keep these instructions in case you need them later. The product you just have bought complies to all european and national qualifications with respect to the specified LVD (Low Voltage Directive) and Electro Magnetic Compatibility (EMC) (89/336/EEG)

SAFETY

- Do not use this product in areas where combustible gases, fumes or liquids may be stored. Install the product a safe distance away from highly flammable materials.
- Always fit this product so that it can still be accessed for servicing or maintenance. This product must never be permanently embedded or bricked in.
- This product is suitable for outdoor use (IP44/IP67, splash-water-proof).
- This product is suitable for outside temperatures of: -20oC till 50oC.
- If the protective glass is broken, it must be replaced before the product is used again!
- The distance away from the surfaces to be illuminated by the product must be a minimum of 0.5 m.
- Protection class III: this product may only be connected to safety extra-low voltage up to a maximum of 12

Volts.

- Use the correct type of light source and ensure that the maximum wattage is not exceeded. The correct light source is indicated on the (label of the) bracket by a symbol and is the maximum wattage shown.

INSTALLATION OF THE LIGHTS

1. Install the products in the desired position and lay the cables so that they can be comfortably connected to the transformer or cables.
2. If products are provided with a drain hole for water, this hole must be pointing downwards.
3. Use non-corrosive fixing materials (supplied as standard) if you want to bolt the products down.
4. Connect the lights to the main cable by using the connector as shown on page 5.
5. Plug the plug of the transformer into the wall socket (230 Volt 50 Hz).

REPLACEABLE LIGHTSOURCE

Proceed as follows in order to install or change the light source:

1. Turn the power off.
2. Let the light source cool down for at least 5 minutes.
3. Replace the light source, bearing the following points in mind:
 - Only replace the light source by an identical model with the same specifications.
 - When (re)assembling, ensure that the parts are dry and clean.
4. Turn the power back on.

Proceed as follows if the lamps do not light after you have followed the above instructions:

1. Turn the power off.
2. Check whether all plugs have been connected properly.
3. Check the light source(s) and replace them if necessary.
4. Check the transformer and the fuse (if applicable, and have them circuit-tested if necessary).
5. Check whether cables have been damaged.
6. Turn the power back on.

CONDITIONS OF GUARANTEE

We guarantee the perfect condition and function of this appliance. The guarantee is valid for 5 years beginning from the date of sale to the end user. We will rectify all faults arising from defective materials or manufacturing. The guarantee covers repair or replacement of the defective parts, subject to our approval. The guarantee does not apply to damage to parts which are subject to wear and tear nor damage or defects caused by improper use or incorrect maintenance. The guarantee only applies if the purchase receipt is sent to the dealer together with the appliance. This guarantee does not affect your statutory rights.

DISPOSAL

Discarded electrical equipment must not be put in the household waste. If possible, take it to a recycling company. For details of recycling, contact a municipal waste processing company or your dealer.

Documents / Resources

	<p>LIGHTPRO Nodin 128P 3W Post Light [pdf] Instructions Nodin 128P 3W Post Light, Nodin 128P, 3W Post Light, Light</p>
---	--

References

- lightpro.info