



## Lightcloud LCCONTROL Mini Controller User Manual

[Home](#) » [Lightcloud](#) » Lightcloud LCCONTROL Mini Controller User Manual 



**Lightcloud**<sup>®</sup>  
LCCONTROL Mini Controller  
User Manual



Controller Mini  
LCCONTROL/MINI  
WE' RE HERE TO HELP:  
1 (844) LIGHTCLOUD  
1 (844) 544-4825  
[support@lightcloud.com](mailto:support@lightcloud.com)

## Contents

- [1 LCCONTROL Mini Controller](#)
- [2 Product Features](#)
- [3 Contents](#)
- [4 Specifications](#)
- [5 What You Need](#)
- [6 Setup & Installation](#)
- [7 Functionality](#)
- [8 Operating Modes](#)
- [9 FCC Information:](#)
- [10 Documents / Resources](#)
- [11 Related Posts](#)

## LCCONTROL Mini Controller

Hello

The Lightcloud Controller Mini is a remotely controlled switch and 0-10V dimming device.

## Product Features

Wireless Control & Configuration  
Switching up to 4.2A  
0-10V Dimming  
Power Monitoring  
Patent Pending

## Contents

Lightcloud Controller

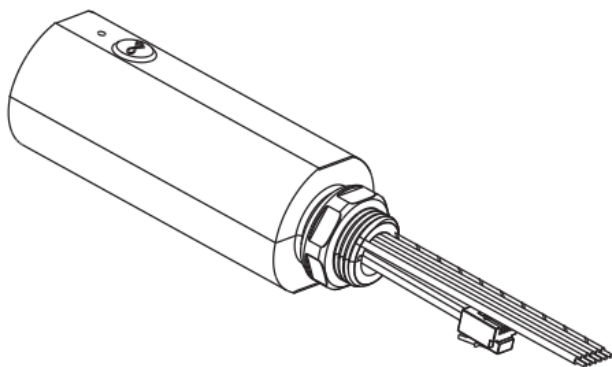

Lock Nut



O-ring



Instruction Manual

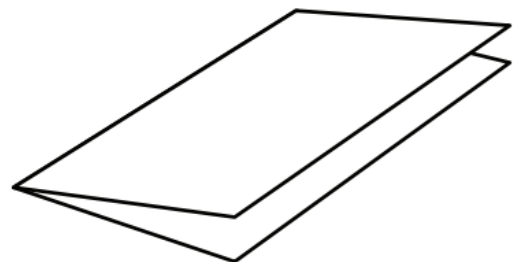

Wire Nuts



x 3



x 3

## Specifications

**PART NUMBER**

LCCONTROL/MINI

**INPUT**

120V-277VAC, 60Hz

&lt;0.8W (Standby and Active)

**MAXIMUM SWITCHED LOAD RATINGS**

For Control of Electronic Ballast (LED)

and Magnetic Ballast

Electronic/Tungsten: 4.2A @120VAC

Inductive/Resistive: 4.2A @120VAC, 1.8A @277VAC

**OPERATING TEMPERATURE**

-35°C to +60°C

**OVERALL DIMENSIONS**

1.6" diameter, 3.8" length

1/2" NPT Mount, Male

18AWG pigtails

22AWG pigtails

**WIRELESS RANGE**

Line-of-Sight: 1000 feet

Obstructions: 100 feet

Class 2

IP66 Rated

Indoor and Outdoor Rated

Wet and Damp Location

Plenum Rated

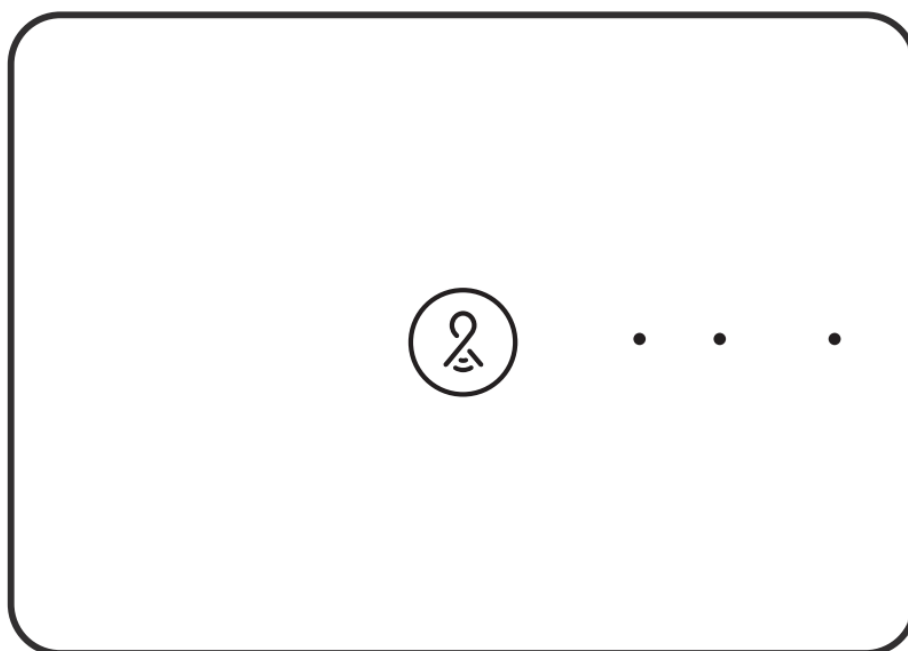
**What You Need****Lightcloud Gateway**

A Lightcloud installation requires at least one Lightcloud Gateway to manage your devices.

**WE' RE HERE TO HELP:**

1 (844) LIGHTCLOUD

or 1 (844) 544-4825

[support@lightcloud.com](mailto:support@lightcloud.com)**Wiring**

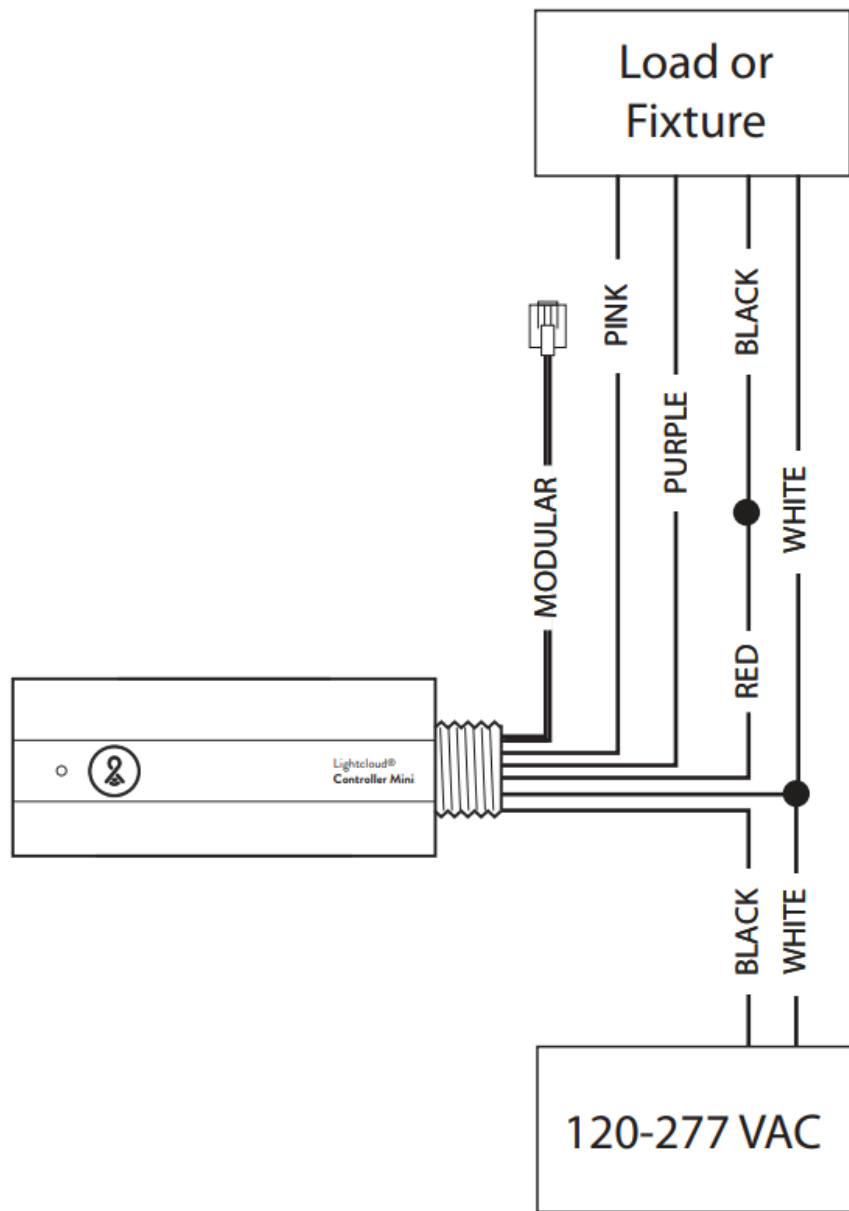

## Setup & Installation

Turn Off Power

 **WARNING**

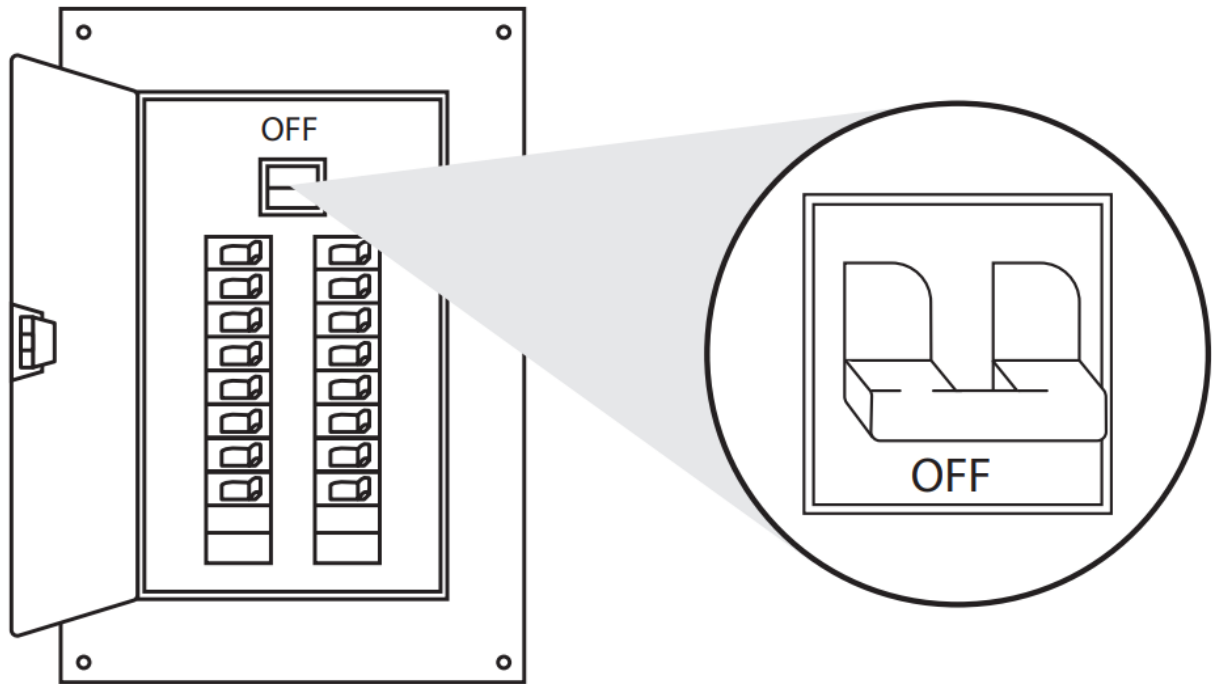

### 1a Find a Suitable Location

Use these guidelines when installing devices:

- If there is a clear line of sight between two Lightcloud devices, they can be placed up to 1000 feet apart.
- If the two devices are separated by ordinary drywall construction, try to keep them within 100 ft. of each other.
- Brick, concrete and steel construction may require additional Lightcloud devices to go around the obstruction.

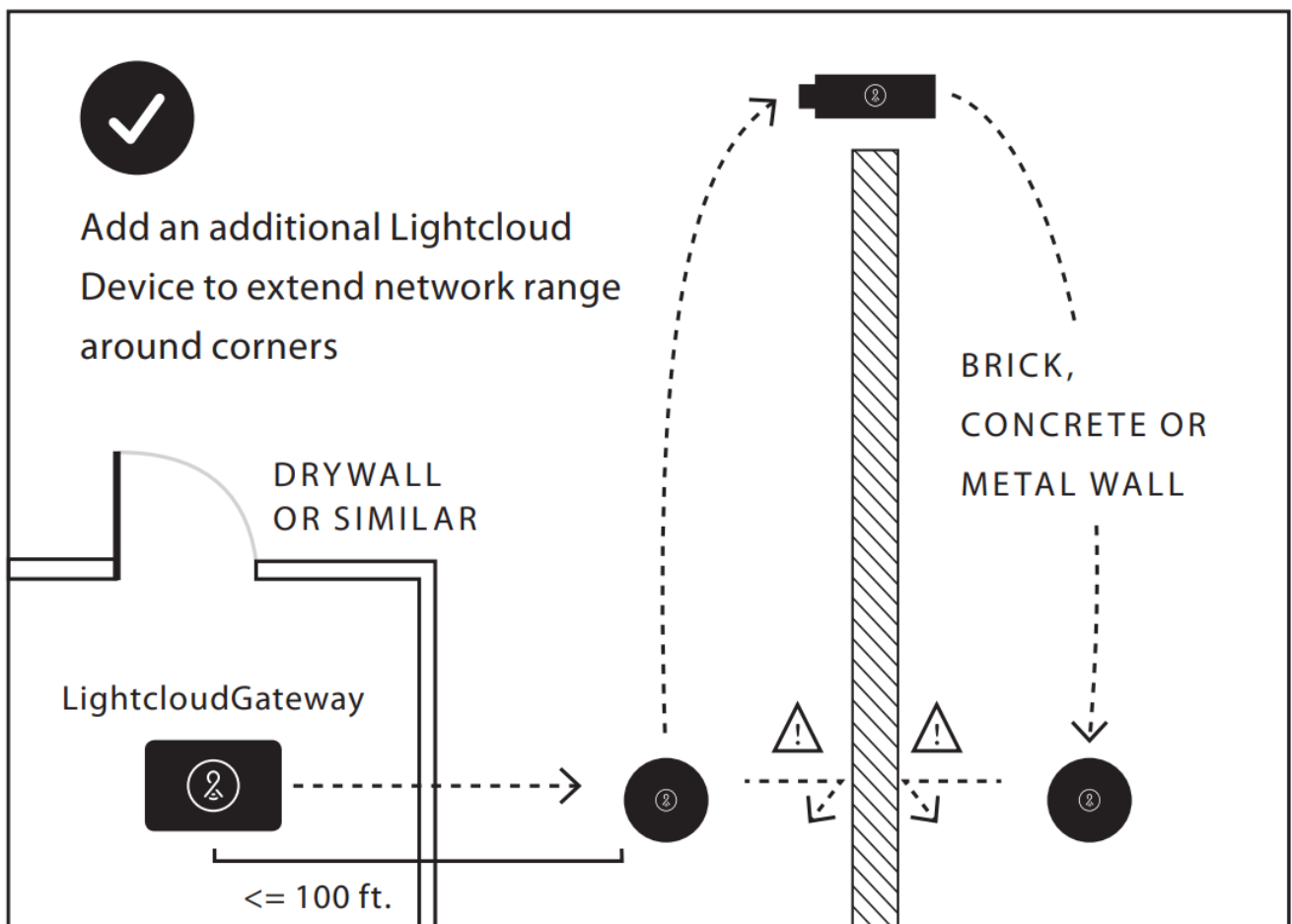

## Install your Lightcloud Controller

### 2a Install at a Junction Box (Indoor/Outdoor)

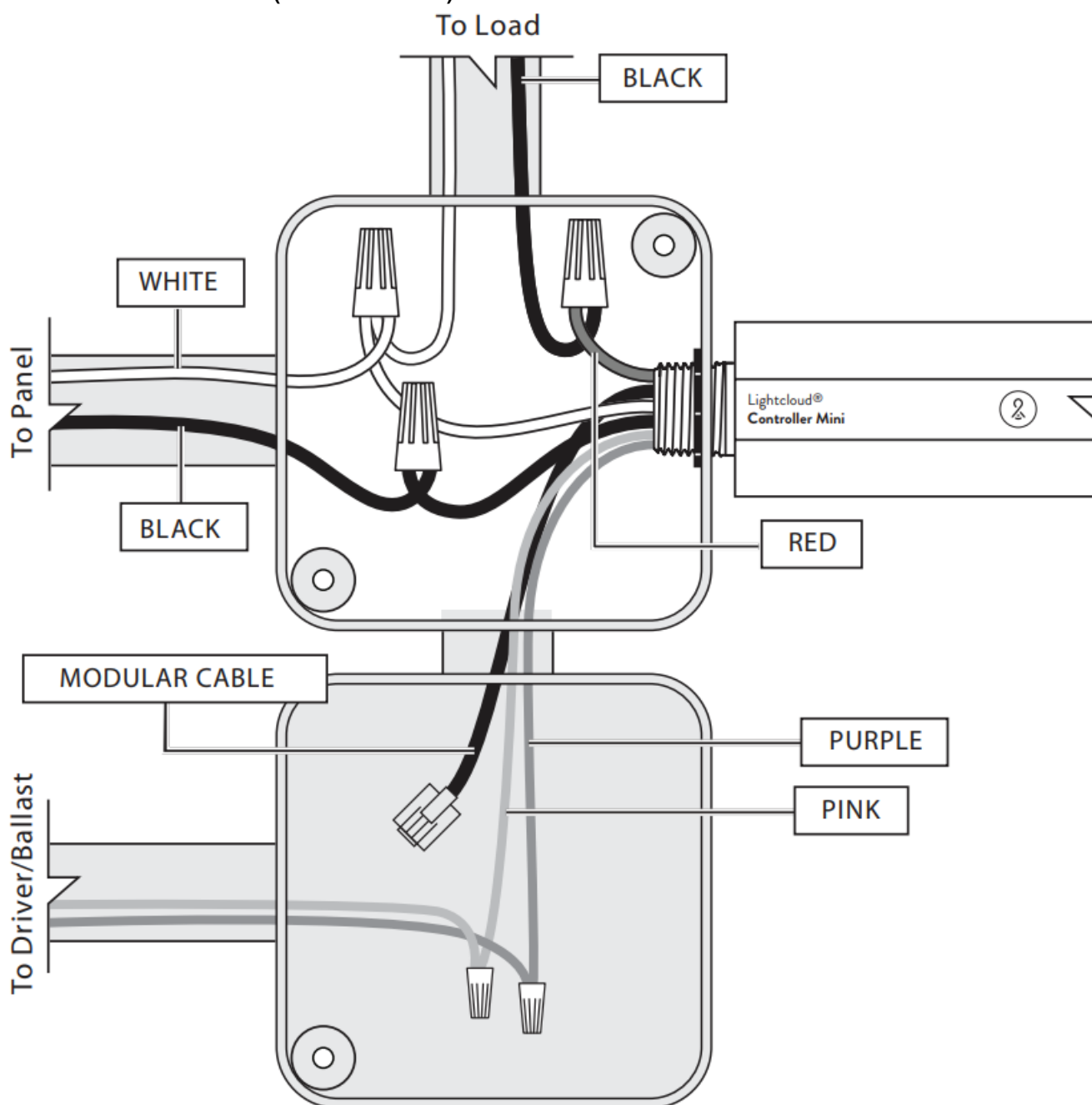

### 0-10V DIMMING

0-10V is a common method of low-voltage control of dimmable drivers and ballasts. Purple: 0-10V positive | Pink: 0-10V common

**NOTE:** The National Electrical Code requires that low-voltage wiring used in the same enclosure as high-voltage wiring have an equal or better insulation rating. You may need to complete your low-voltage wiring in another enclosure or use a partition.

### 2b Install at Lighting Panel or Trough

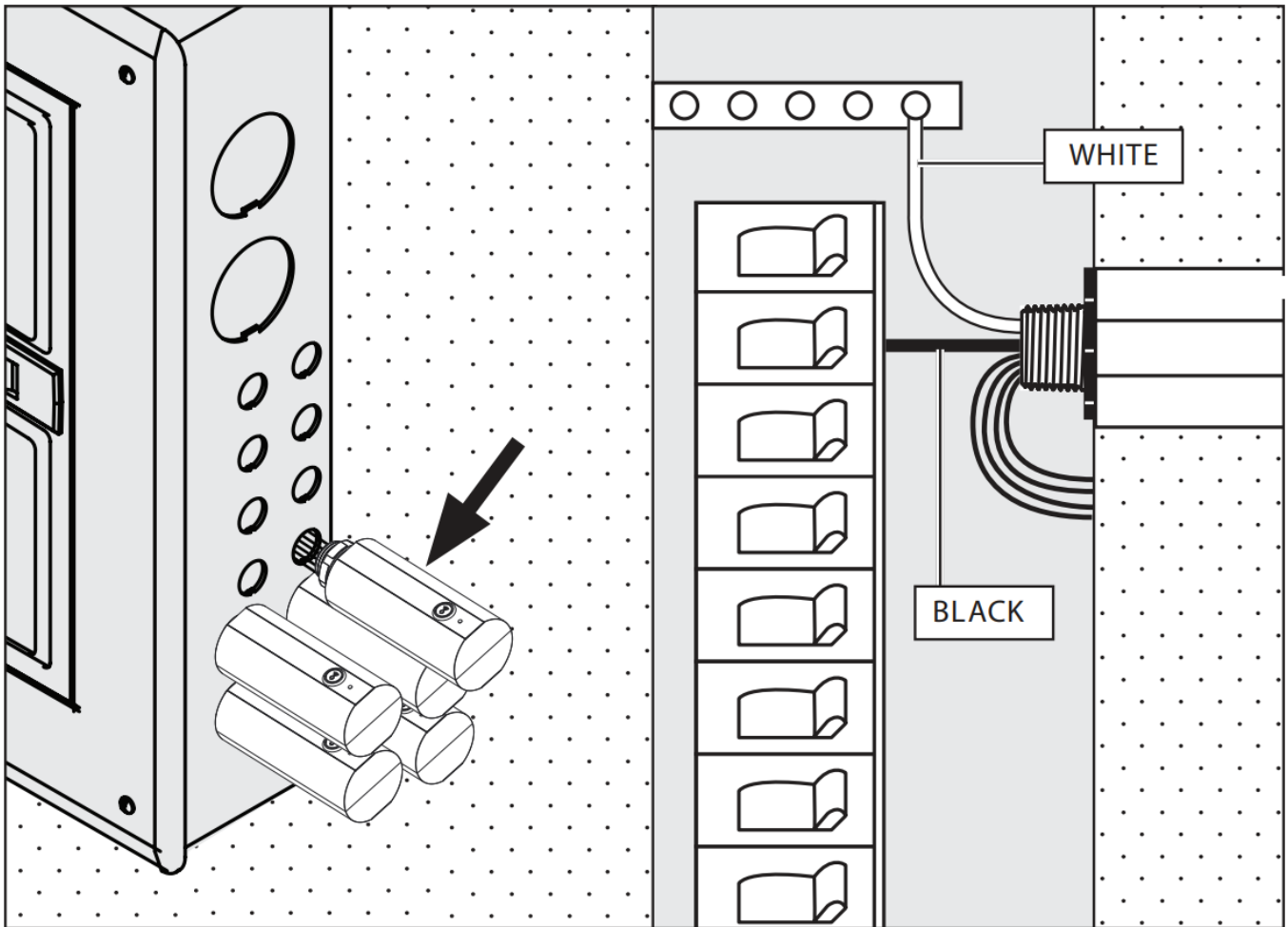

Space and code allowing, you may install Lightcloud devices directly in your breaker box or lighting panel. Alternatively, break out lighting circuits and install Lightcloud devices in a separate trough.

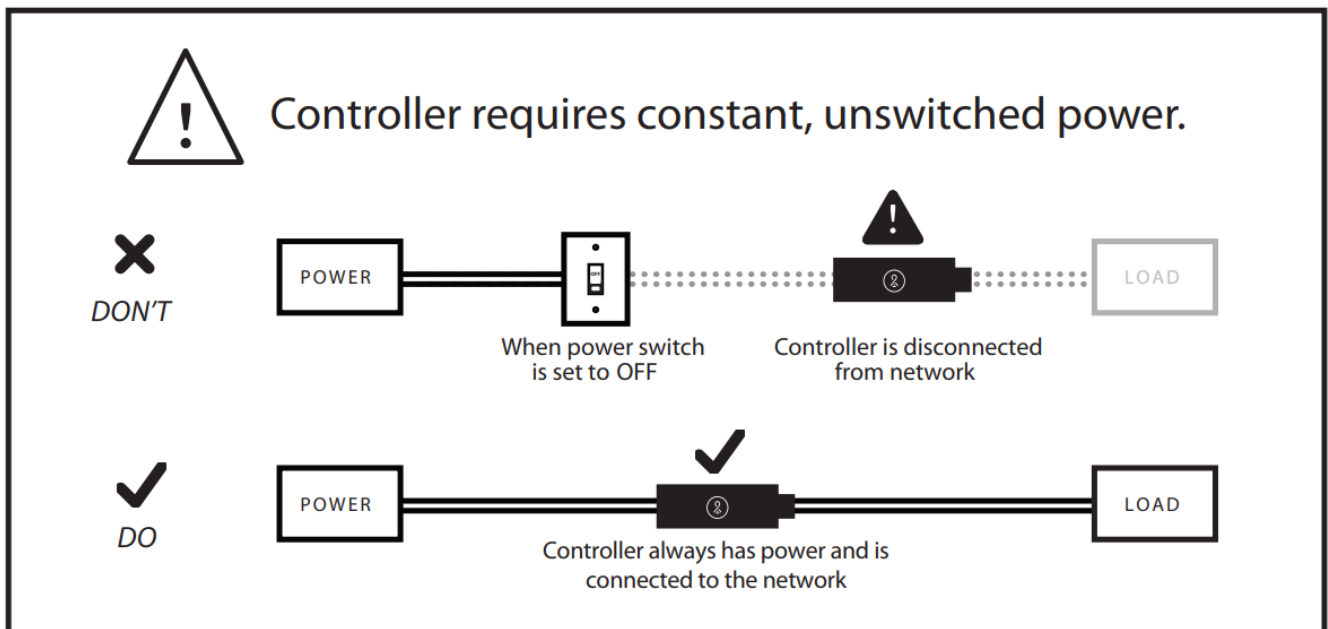

### Labeling Your device

When installing devices, it's important to keep track of their Device IDs, installation locations, panel/circuit #s, dimming function, and any additional notes. To organize this information, use the Lightcloud Installer Application (A) or Device Table (B).

### 3a Lightcloud Installer Application

Install the LC Installer Application: LC Installer is available for iOS and Android.

Scan & Install Lightcloud Devices: Scan each device and assign to a room. It's recommended that each device is scanned just before or just after being wired so no devices are missed. The more notes that are given, the easier

it is to commission the system.

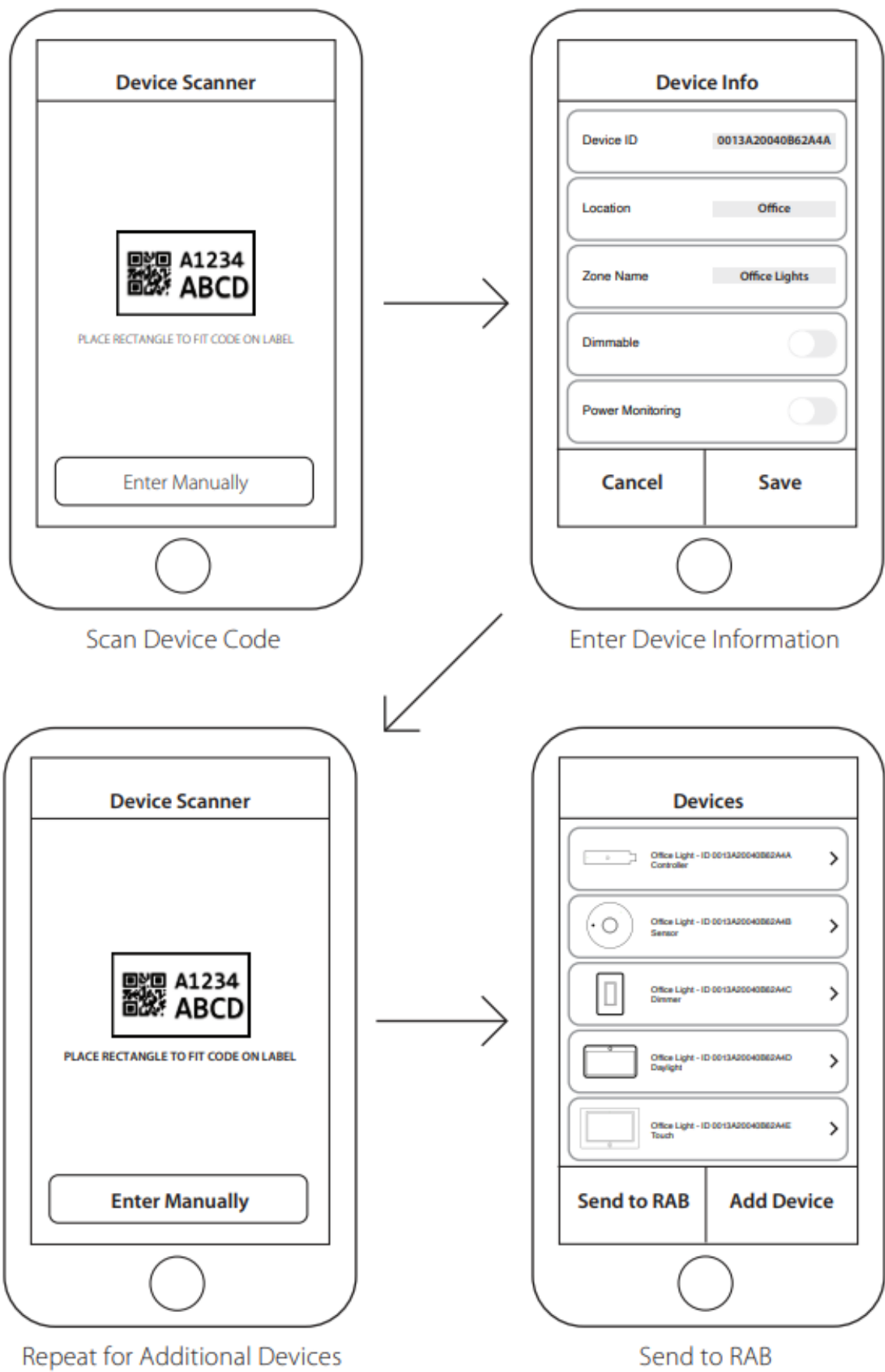



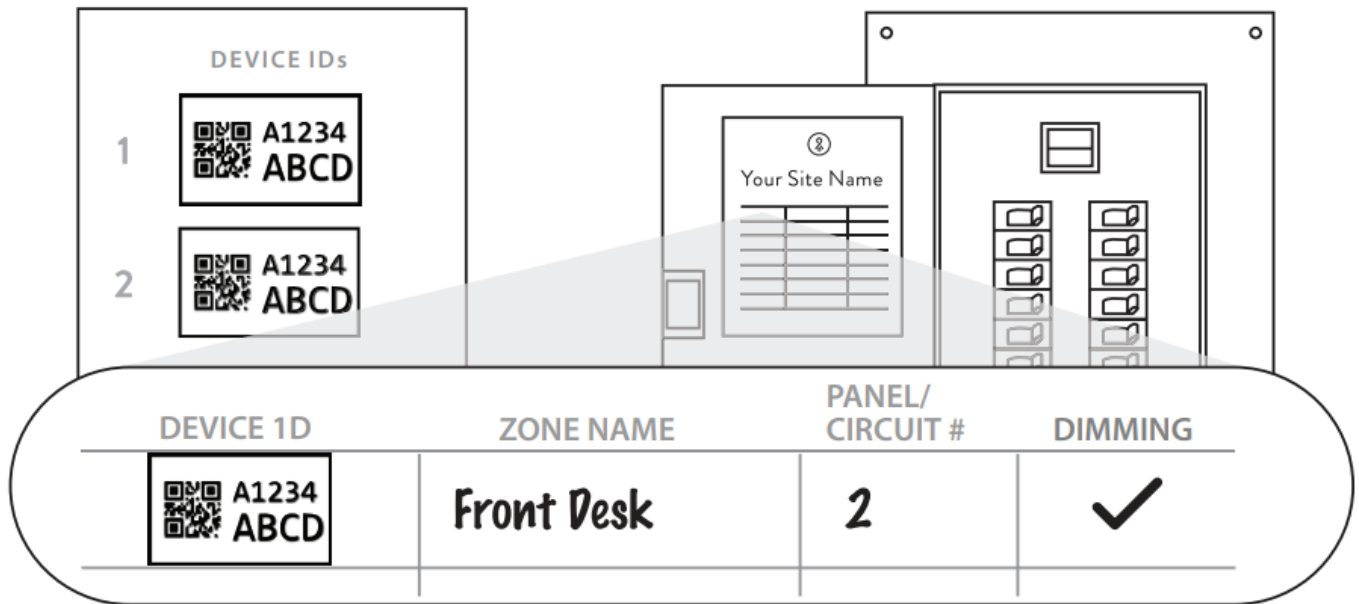

For setup and maintenance, we provide two Lightcloud Device Tables with the Gateway: one that you can attach to your panel and one to hand off to a building manager. Attach the Device Identification stickers included with each device to a row, then write in additional information, such as Zone name, Panel/Circuit Number, and whether or not a zone uses dimming.

Send to RAB: Once all of the devices have been added and organized, submit the information for commissioning.

#### **Power up**

To add new devices to your Lightcloud network, call RAB at 1 (844) LIGHTCLOUD, or email us at [support@lightcloud.com](mailto:support@lightcloud.com).

#### **Confirm Device Connectivity**

Confirm Status Indicator is Solid Green (see details below)

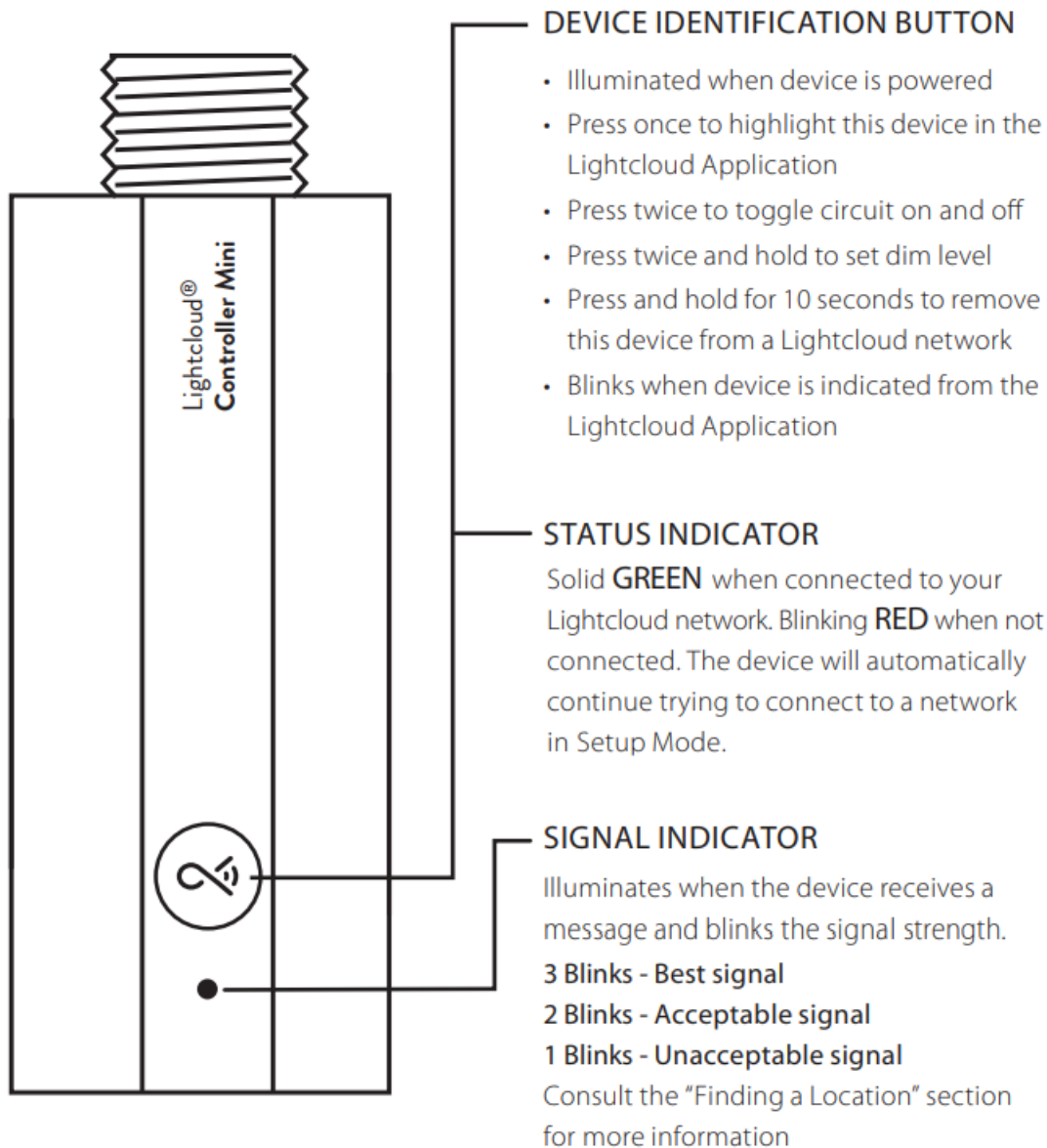

### Commission your devices

Log on to [www.lightcloud.com](http://www.lightcloud.com) or call 1 (844) LIGHTCLOUD

### Functionality

#### Configuration

To configure Lightcloud products, use the Web Application ([control.lightcloud.com](http://control.lightcloud.com)) or call 1(844)LIGHTCLOUD.

WE' RE HERE TO HELP:

1 (844) LIGHTCLOUD

or 1 (844) 544-4825

[support@lightcloud.com](mailto:support@lightcloud.com)

### Operating Modes

**CONTROLLER:** Provides switching and dimming for a single zone.

**REPEATER:** Extends the Lightcloud mesh network without controlling a load.

**SENSOR (REQUIRES OPTIONAL SENSOR MODULE):** Provides occupancy, vacancy, and daylight harvesting.

**POWER MEASUREMENT:** The Lightcloud Controller is capable of measuring the power usage of the attached circuit.

**POWER LOSS DETECTION:** If mains power to the Controller is lost, the device will detect this and alert the Lightcloud application.

**EMERGENCY DEFAULT:** If communication is lost, the Controller may optionally fall back to a specific state, such

as turning the attached circuit on.



Controller requires constant, unswitched power. Any wires not in use must be capped off or otherwise insulated. This product should only be installed by a qualified electrician and in compliance with local and national electrical codes.

### FCC Information:

This device complies with Part 15 of the FCC Rules. Operation is subject to the following two conditions:

1. This device may not cause harmful interference, and
2. This device must accept any interference received, including interference that may cause undesired operation.

**Note:** This device has been tested and found to comply with the limits for Class A digital devices pursuant to Part 15A Subpart B, of the FCC rules. These limits are designed to provide reasonable protection against harmful interference in a residential environment. This equipment generates, uses, and can radiate radio frequency energy, and if not installed and used in accordance with the instruction manual, may cause harmful interference to radio communications. However, there is no guarantee that interference will not occur in a particular installation. If this equipment does cause harmful interference to radio or television reception, which can be determined by turning the equipment off and on, the user is encouraged to try and correct the interference by one or more of the following measures:

- Reorient or relocate the receiving antenna.
- Increase the separation between the equipment and receiver.
- Connect the equipment into an outlet on a circuit different from that to which the receiver is connected.
- Consult the dealer or an experienced radio/TV technician for help.

To comply with the FCC's RF exposure limits for general population / uncontrolled exposure, this transmitter must be installed to provide a separation distance of at least 20 cm from all persons and must not be co-located or operating in conjunction with any other antenna or transmitter.

**CAUTION:** Changes or modifications to this equipment not expressly approved by RAB Lighting may void the user's authority to operate this equipment.



Lightcloud®

**Lightcloud is a commercial wireless lighting control system.**

It's powerful and flexible, yet easy to use and install.

Learn more at [lightcloud.com](https://lightcloud.com) 1 (844) LIGHTCLOUD

1 (844) 544-4825

[support@lightcloud.com](mailto:support@lightcloud.com)

**RAB®**

© 2022 RAB Lighting, Inc



[Lightcloud LCCONTROL Mini Controller](#) [pdf] User Manual  
LCCONTROL Mini Controller, LCCONTROL, Mini Controller, Controller