

[Skip to content](#)

Manuals+

User Manuals Simplified.



LightCloud LCBLUEREMOTE/W Remote User Guide

[Home](#) » [Lightcloud](#) » LightCloud LCBLUEREMOTE/W Remote User Guide



Lightcloud

LCBLUEREMOTE/W Remote User Guide



Ste gto ea ae
1(844) LIGHTCLOUD
1(844) 544-4825

Contents [hide](#)

[1 LCBLUEREMOTE/W Remote](#)

[2 Product Features](#)

[3 Specifications](#)

[4 What's in the Box](#)

[5 Function](#)

[6 Installing or changing battery](#)

[7 Wall Mounting](#)

[8 Reset](#)

[9 Functionality](#)

[10 FCC Information:](#)

[11 Documents / Resources](#)

[12 Related Posts](#)

LCBLUEREMOTE/W Remote

Welcome Hello

The Lightcloud Blue Remote lets you control your Lightcloud Blue-enabled lighting from anywhere onsite. Manage on/off switching, dimming, color temperature tuning, and set programmable buttons for custom scenes. The Remote can be mounted to a single-gang wall box or directly to a wall.

Product Features



Wireless Control & Color Tuni Configuration



Dimming



Color Tuning



Decorator Wall Plate

Specifications

Catalog Number:

LCBLUEREMOTE/W

Specifications:

Voltage: 3V

Amps: 10mA

Range: 60ft

Battery type: CR2032

Battery life : 2 years

Warranty: 2 year limited

What's in the Box

- (1) Lightcloud Blue Remote*
- (1) Faceplate bracket
- (4) Mounting screws
- (1) Installation guide
- (1) Backplate
- (1) Faceplate

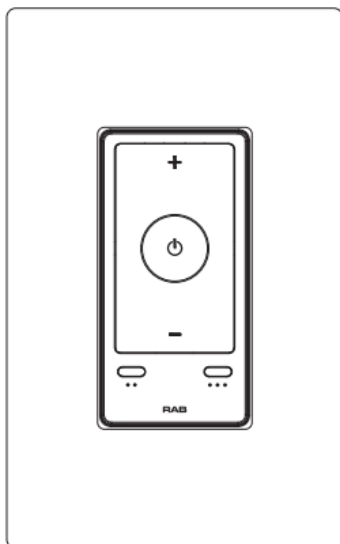

*(*battery included)*

Quick Setup

1. Confirm your device is powered on.
2. Download the Lightcloud Blue app from the Apple® App Store or Google® Play store.



3. Launch the App and create an account.



4. Tap the “add device” icon in the app to start connecting devices.

5. Follow the remaining steps in the app. Create Areas, Groups, and Scenes to organize and control your devices.

6. You're all set!

Function

Remote button functions:

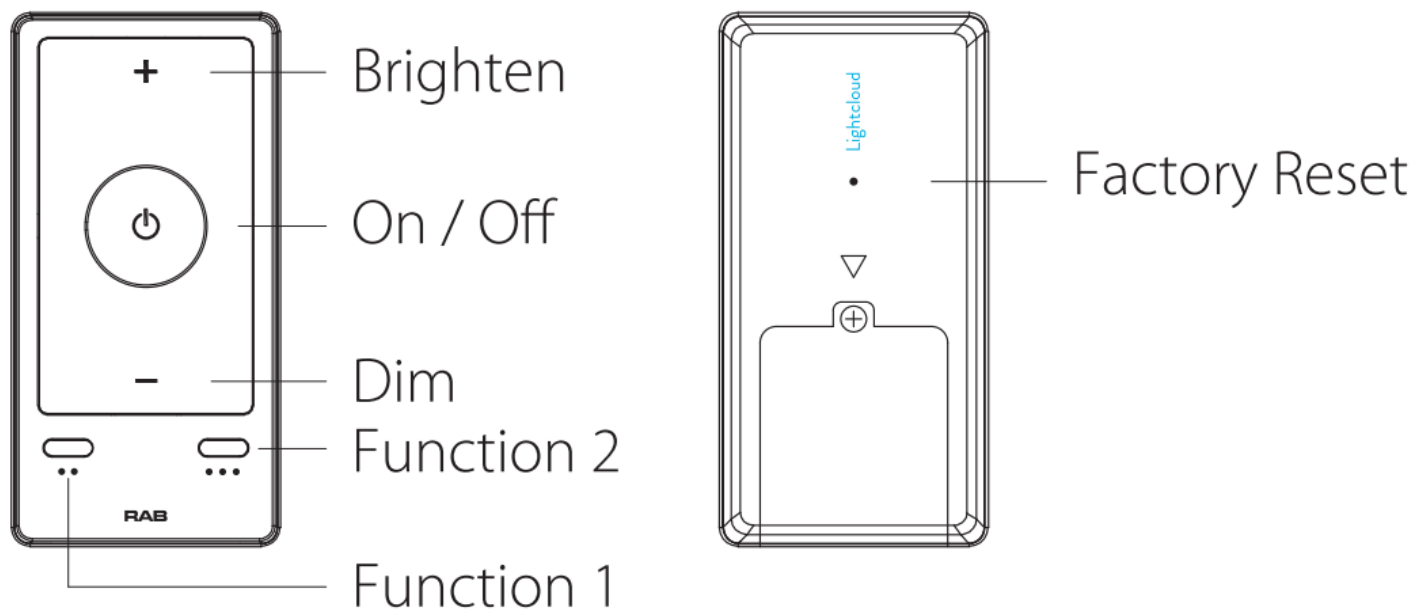

Installing or changing battery

1. Remove the cover on the back

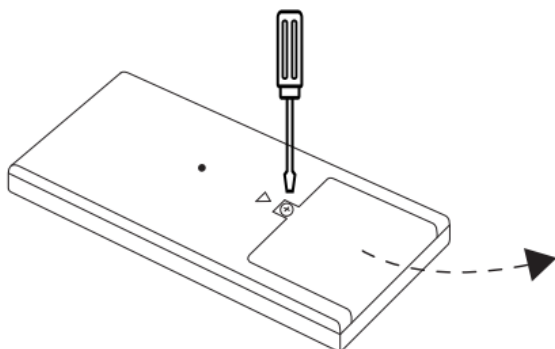

2. Install CR2032 battery in the compartment positive (+) side up

3. Replace back cover

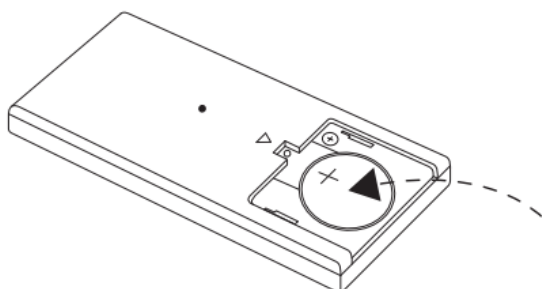

Wall Mounting

1

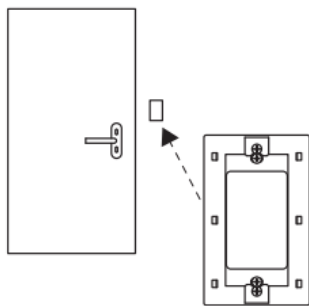

Screw backplate
to the wall

2

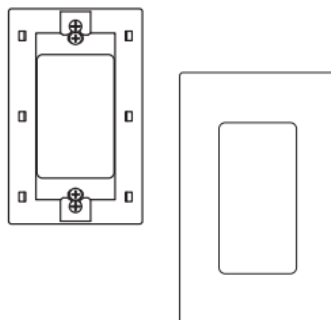

Snap the faceplate
onto backplate

3

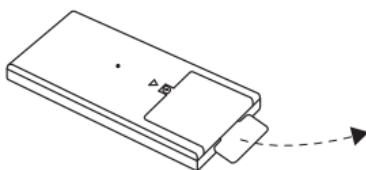

Remove the battery
spacer

4

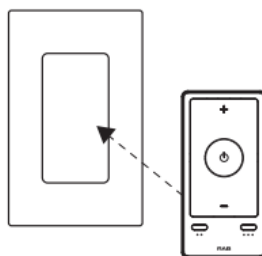

Attach remote
to the faceplate

Reset

1. Method 1: Press and hold the *RESET* button for 3s. A red indicator light will appear in the top left corner of the face of the remote when reset is complete.
2. Method 2: Press and hold the "ON/OFF" and "Function 1" (..) buttons together for 5s. A red indicator light will appear in the top left corner of the face of the remote when reset is complete.

Functionality

Configuration

All configuration of Lightcloud Blue products may be performed using the Lightcloud Blue app.

WE'RE HERE TO HELP:

1 (844) LIGHTCLOUD

1 (844) 544-4825

support@lightcloud.com

FCC Information:

This device complies with Part 15 of the FCC Rules. Operation is subject to the following two conditions: 1. This device may not cause harmful interference, and 2. This device must accept any interference received, including interference that may cause undesired operation.

Note: This device has been tested and found to comply with the limits for Class B digital devices pursuant to Part 15 Subpart B, of the FCC rules. These limits are designed to provide reasonable protection against harmful interference in a residential environment. This equipment generates, uses, and can radiate radio frequency energy, and if not installed and used in accordance with the instruction manual, may cause harmful interference to radio communications. However, there is no guarantee that interference will not occur in a particular installation. If this equipment does cause harmful interference to radio or television reception, which can be determined by turning the equipment off and on, the user is encouraged to try and correct the interference by one or more of the following measures:

- Reorient or relocate the receiving antenna.
- Increase the separation between the equipment and receiver.
- Connect the equipment into an outlet on a circuit different from that to which the receiver is connected.
- Consult the dealer or an experienced radio/TV technician for help.

Lightcloud Blue is a Bluetooth mesh wireless lighting control system that allows you to control RAB's various compatible devices. With RAB's patent-pending Rapid Provisioning technology, devices can be quickly and easily commissioned for residential and large commercial applications using the Lightcloud Blue mobile app.

Learn more at www.rablighting.com

1(844) LIGHTCLOUD 1(844) 544-4825



©2022 RAB LIGHTING Inc.

Made in China.

Pat. rablighting.com/ip

Documents / Resources

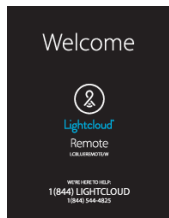

[LightCloud LCBLUEREMOTE/W Remote](#) [pdf] User Guide

LCBLUEREMOTE W Remote, LCBLUEREMOTE W, LCBLUEREMOTE, LCBLUEREMOTE Remote, Remote, Remote

[Manuals+](#),

- [home](#)
- [privacy](#)