



Lightcloud LCBLUECONTROL/W Blue Controller Installation Guide

[Home](#) » [Lightcloud](#) » Lightcloud LCBLUECONTROL/W Blue Controller Installation Guide

Light cloud LCBLUECONTROL/W Blue Controller Installation Guide



Contents [[hide](#)]

- [1 Hello](#)
- [2 Product Features](#)
- [3 Contents](#)
- [4 Specifications & Ratings](#)
- [5 Setup & Installation](#)
- [6 Functionality](#)
- [7 FCC Information](#)
- [8 Documents / Resources](#)
 - [8.1 References](#)
- [9 Related Posts](#)

Hello

The Light cloud Blue Controller is a remotely controlled device used to enable switching and dimming. The Controller converts any standard 0-10V LED fixture to a Light cloud Blue-enabled fixture which can be configured and controlled using the Light cloud Blue mobile app.

Product Features

Wireless Control & Configuration Switching up to 3.3A 0-10V Dimming Power Monitoring

Contents

- Light cloud Blue Controller

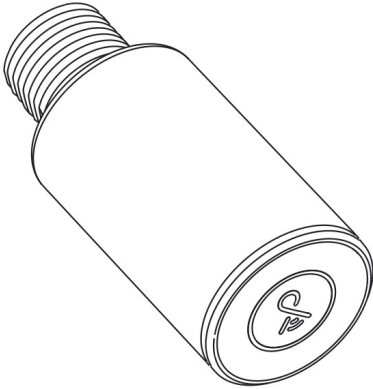

- NPT Nut



(Outside)

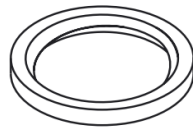

(Inside)

- Wire Nuts



x 4



x 2

- Installation Guide

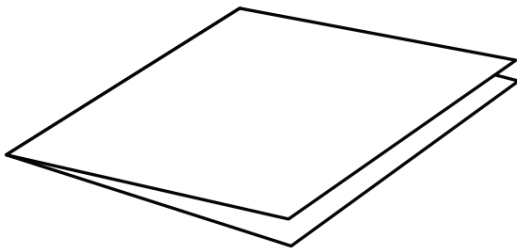

Specifications & Ratings

PART NUMBER LCBLUECONTROL/W

Power Consumption <0.6W(Standby)–1W(Active)

LOAD SWITCHING CAPACITY

- **LED:** Incandescent
- **120V~400W:** 120V~3.3A/400W
- **277V~400W:** 277V~1.5A/400W

INPUT 120 277VAC, 50/60Hz

DIMENSIONS: 1.3" (D) x 2.5"(L)

WIRELESS RANGE 60 ft.

RATINGS: IP20 Indoor

Setup & Installation

WARNING

1. Turn off power

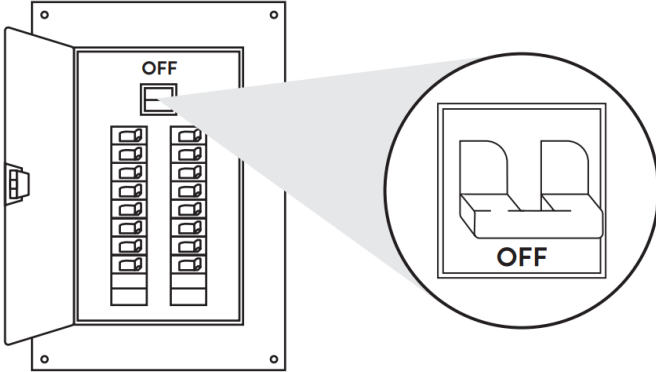

1a Find a suitable location

- Light cloud Blue devices should be positioned within 60 ft. of each other.
- Building materials such as brick, concrete and steel construction may require additional Light cloud Blue devices to extend around an obstruction.

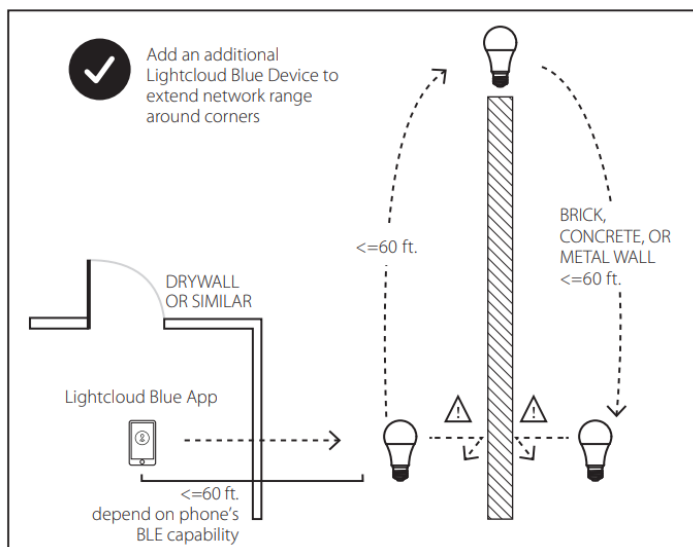

2. Install the Light cloud Blue Controller in junction box

The Light cloud Blue Controller can be mounted into a junction box, with the radio module always outside any metal enclosure. If no sensor is used, then the second modular cable can be tied off and placed inside the fixture or box.

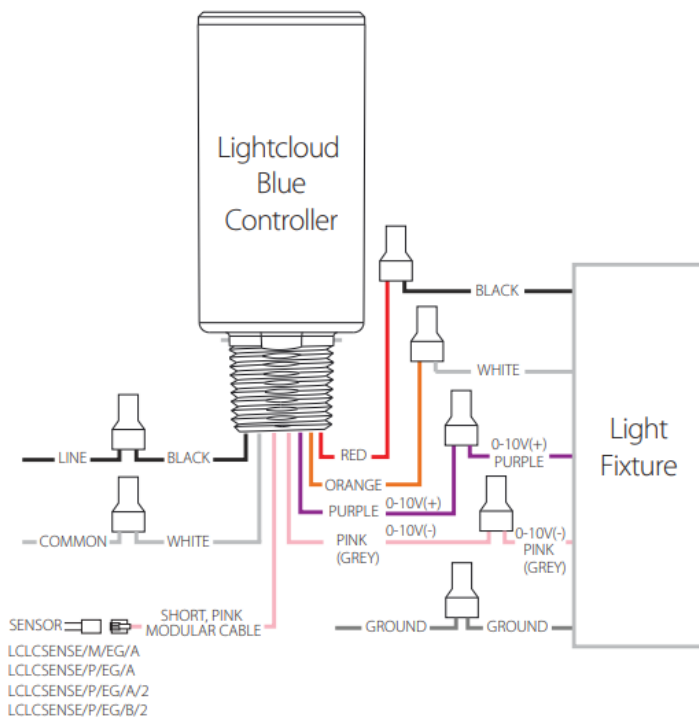

3. Install luminaire

Install the fixture with integrated Light cloud Blue Controller to a constant power source.

Do not place Light cloud Blue-controlled fixtures down circuit from any other switching devices such as switches, sensors, or time clocks.

4. Turn power on

5. Verify power and local control

Confirm Status Indicator is blinking red. Confirm local control using the Device Identification Button.

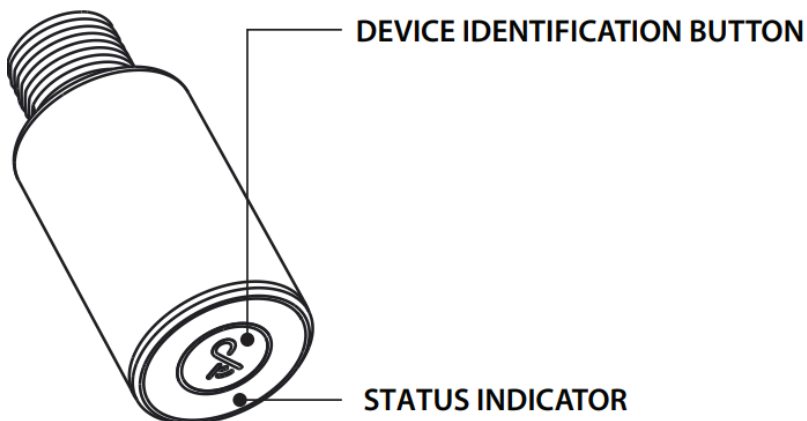

DEVICE IDENTIFICATION BUTTON

- Press once to rapid identify this device in the Light cloud Blue Application when provisioned
- Press twice to toggle circuit on and off
- Press twice and hold to set dim level
- Press and hold for 10s to reset the device to factory settings and into pairing mode

STATUS INDICATOR

Solid GREEN when connected to your Light cloud Blue network. Blinking RED when unprovisioned.

6. Enable Device Pairing Mode

Press and hold for 10s to reset the device to factory settings and into pairing mode

6a Commission

1. Download Light cloud Blue App from Apple® App store or Google® Play.

2. Tap the '+ Add Devices' button in the Light cloud Blue App to add the Controller while it is in pairing mode.
7. Use the App to configure settings.

Functionality

Configuration

All configuration of Light cloud Blue products may be performed using the Light cloud Blue app.

Emergency default

If communication is lost, the Controller may optionally fall back to a specific state, such as turning the attached luminaire on. [Warning: Any wires not in use must be capped or otherwise insulated.]

WE'RE HERE TO HELP: 1 (844) LIGHTCLOUD 1 (844) 544-4825

support@lightcloud.com

FCC Information

This device complies with Part 15 of the FCC Rules. Operation is subject to the following two conditions:

1. This device may not cause harmful interference, and
2. This device must accept any interference received, including interference that may cause undesired operation.

Note: This device has been tested and found to comply with the limits for Class B digital devices pursuant to Part 15 Subpart B, of the FCC rules. These limits are designed to provide reasonable protection against harmful interference in a residential environment. This equipment generates, uses, and can radiate radio frequency energy, and if not installed and used in accordance with the instruction manual, may cause harmful interference to radio communications. However, there is no guarantee that interference will not occur in a particular installation. If this equipment does cause harmful interference to radio or television reception, which can be determined by turning the equipment of and on, the user is encouraged to try and correct the interference by one or more of the following measures:

- Reorient or relocate the receiving antenna.
- Increase the separation between the equipment and receiver.
- Connect the equipment into an outlet on a circuit different from that to which the receiver is connected.
- Consult the dealer or an experienced radio/TV technician for help

To comply with the FCC's RF exposure limits for general population / uncontrolled exposure, this transmitter must be installed to provide a separation distance of at least 20 cm from all persons and must not be co-located or operating in conjunction with any other antenna or transmitter.

CAUTION: Changes or modifications to this equipment not expressly approved by RAB Lighting may void the user's authority to operate this equipment.

Light cloud Blue is a Bluetooth mesh wireless lighting control system that allows you to control RAB's various compatible devices. With RAB's patent-pending Rapid Provisioning technology, devices can be quickly and easily commissioned for residential and large commercial applications using the Light cloud Blue mobile app. Each device in a system can communicate with any other device, eliminating the need for a Gateway or Hub and maximizing the control system's reach. Learn more at www.rablighting.com





Documents / Resources

The cover of the 'Lightcloud Controller' PDF manual. It features the Lightcloud logo, the word 'Controller', and the text 'LCBLUECONTROL W'. At the bottom, it says 'WE'RE HERE TO HELP! 1 (844) LIGHTCLOUD 1 (844) 544-2623'.	<p>Lightcloud LCBLUECONTROL/W Blue Controller [pdf] Installation Guide LCBLUECONTROL W, Blue Controller, LCBLUECONTROL W Blue Controller, Controller</p>
--	--

References

- [R Welcome to RAB](#)