

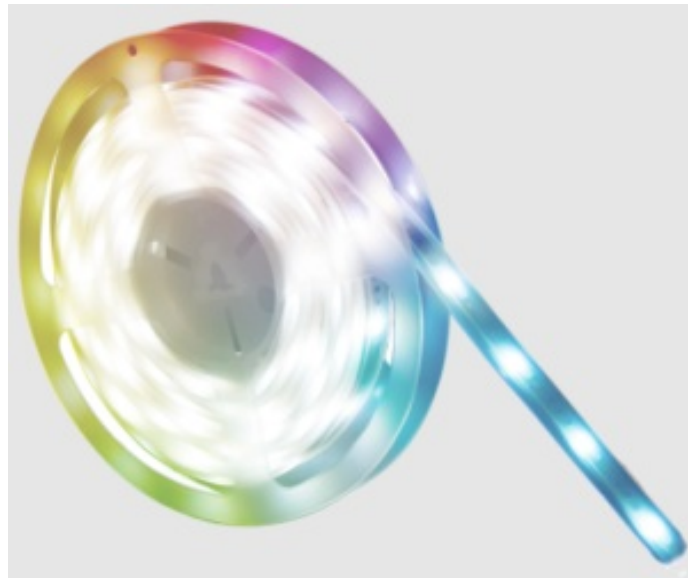

Light Strips SF1202WE1DP Wi-Fi Smart Led Strip Light User Manual

[Home](#) » [Light Strips](#) » Light Strips SF1202WE1DP Wi-Fi Smart Led Strip Light User Manual 

Light Strips SF1202WE1DP Wi-Fi Smart Led Strip Light User Manual



Warning

1. IP65 water-proof Led strips can be installed indoor and outdoor area, but can't be under water! IP20 non water-proof Led strips can be installed indoor only.
2. All installation are required to cut off power.
3. The voltage of this Led strip is DC12V, please use the related power supply, but not use AC220V to run it directly.
4. Make sure to cut at the correct position if you need to cut the strip light, the min cut length is 50mm (every 3leds as a group). The most important is, the cutting point not touch water otherwise there will be short circuit when light up.

Contents

- [1 Installation Instruction](#)
- [2 Warranty](#)
- [3 Download and Install APP](#)
- [4 Registration and login](#)
- [5 Add device – Normal mode](#)
 - [5.1 Normal mode](#)
- [6 Add device – AP mode](#)
 - [6.1 Add device – Normal mode](#)
- [7 Add device – AP mode](#)
- [8 Control device](#)
- [9 Specification](#)
- [10 Documents / Resources](#)
- [11 Related Posts](#)

Installation Instruction

1. Ensuring the clean installation surface before installing this product.
2. Non-waterproof smart Led strip:
Uncovering the 3M tape on the back of Led strip light, but not rip it all off at once.
Fixing the Led strip light on the surface where you would like, avoid to press the Led chips.
 1. Waterproof smart Led strip:
Use the mounting clips to firm Led strip according to your requirement.
3. Connect the black wire of strip light to the positive pole, and the red/green/blue and white wire to the corresponding color of the smart controller.
4. Connect the power supply to the smart controller, and light up the strip light.

Fault Checking

1. Please check if the positive and negative of power cord is wrongly connected.
2. Please check if the connection of power cord is secure and poorly connected.
3. Please check if the adapter is consistent with the voltage of strip light.

Warranty

SSLUCE Lighting warranty applies to manufacturing defects affecting its products which existed at the time of the purchase of the product, that are non-apparent, and are unknown to the buyer, for a period of 3 years. this warranty applies to the product only and does not cover the installation of the product. The warranty does not apply to material, economic and/or physical damages or losses caused by the product. This warranty will not apply to any damages and/or losses caused by an incorrect use, installation or maintenance of the product. The manufacturer is therefore not liable for damages to the product or material, economic and/or physical damages or losses caused by an incorrect use, installation or maintenance of the product. If the buyer considers that the product is affected by a defect, the buyer should return the product to the point of purchase or send an email to sales01([@SSLUCE.com](mailto:sales01@SSLUCE.com) Should the buyer decide to send an email to sales01@ssluce.com, a description of the alleged problem should be included in the email and a proof of purchase as well as the picture clearly illustrating the alleged defect should be attached to the email. The buyer should also return the product to SSLUCE Lighting at his/her own expense. After product inspection, if the warranty applies, SSLUCE Lighting will repair or replace the product free of charge.

1. Uncovering the 3M tape on the back of smart Led strip light

For non-waterproof smart Led strip light, there is 3M tape for installation.



1. Fixing the smart Led strip light

Fixing the Led strip light on the surface where you would like, avoid to press the Led chips.



2. Use the mounting clips to fix the smart Led strip light

For waterproof smart Led strip light, please find out the mounting clips and screws from the box, and use these accessories for installation.

5M Led strip light includes 10clips + 20screws, 2clip + 4screws per meter.

2M Led strip light includes 4clips + 8screws, 2clip + 4screws per meter.

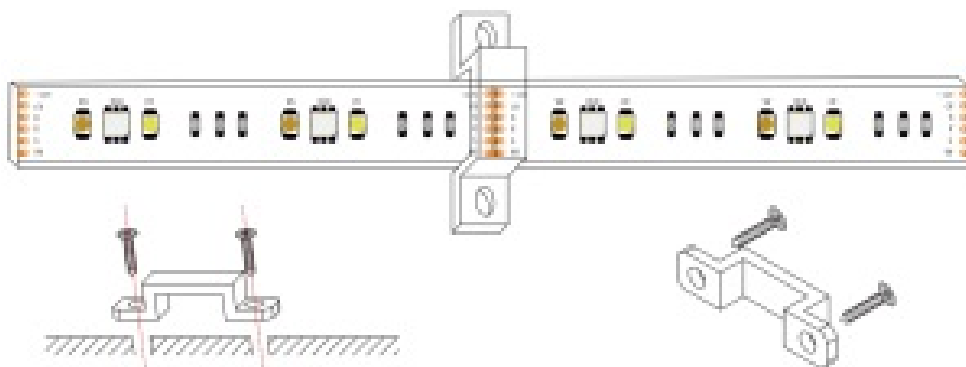

3. Connect the smart Led strip to the smart controller and power supply

No matter non-waterproof or waterproof smart Led strip, please find out the smart controller and power supply from the box, and connect them according to this diagram.

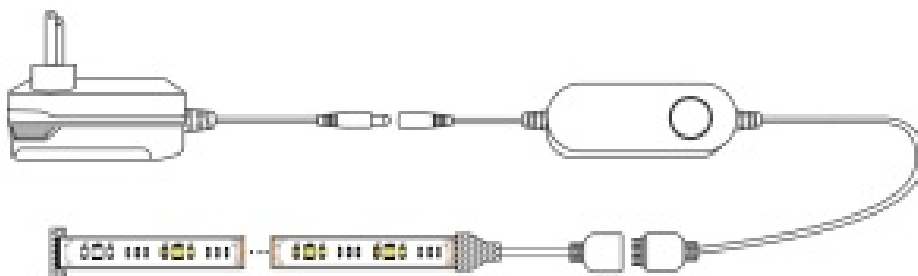

Download and Install APP

Use your phone to scan the QR code above or search “Smart Life” in application market to download and install the App



This App is compatible with mobile devices IOS 8.0 and above and Android 4.0 and above.

Wireless Encryption	WEP / WPA / WPA2 Encryption
Wireless Type	2.4GHz
Wireless Stondord	802.11 b/g/n
Wireless Ronge	45M

Registration and login

If you don't have an App account, register an account or sign in with verification code by SMS.

This page describes the registration process.

1. Tap to enter registration page.
2. The system automatically recognises your country/area. You can also select your country code.
Enter the mobile number / E-mail and tap "Next", as shown in the picture 1.
3. If you enter the mobile number, then enter the verification code in the message, as shown in the picture 2 , and enter the password, tap "Confirm" to finish your registration.
4. If you enter the E-mail, enter the password as shown in the picture 3 , and, tap "Confirm" to finish your registration.
5. Then sign in with username and password or sign in with verification code via SMS.

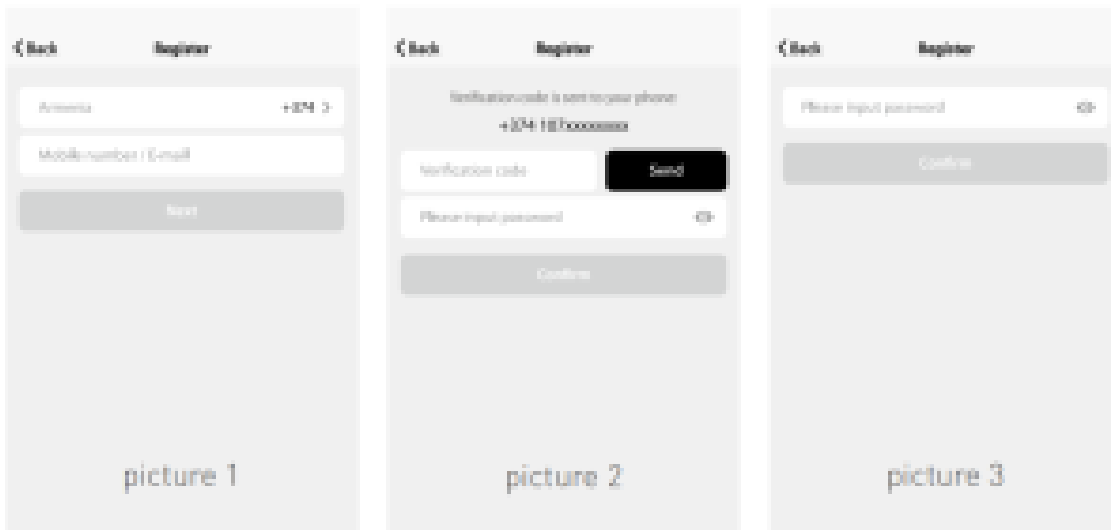

Remarks:

1. Or you can register through other communication Apps which show on the bottom of the page, such as Facebook, Wechat.
2. It is recommended to register by email or mobile number if you need to use Amazon Alexa and Google Home for voice control.

Add device – Normal mode

Normal mode

1. Enter the App, tap "+" in the upper right of the page to enter network connection page, as shown in the picture.
2. There are two network connection methods (Normal mode and AP mode).
Normal mode is default. Users could tap the upper right corner to switch the connection method to AP mode.
3. For normal mode, please make sure the light rapidly flashes (2 times per second), tap to go on to the next step.
4. If light is not rapidly flashing, tap "how to set light as rapid flashes" to view operation processes.

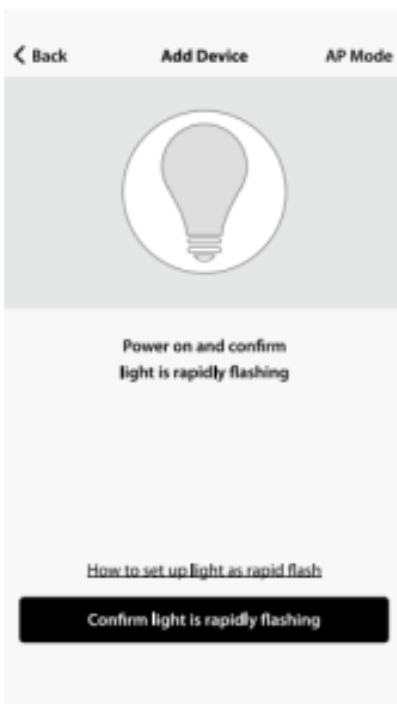

Notes: How to set light as rapid flashing

1. Power on device.—Power off after 10s and then power on.
2. Turn on-off-on-off-on. (Keep time interval not too short, turn off after light is on).
3. Confirm light bulb is now rapidly flashing. (2 time per second).

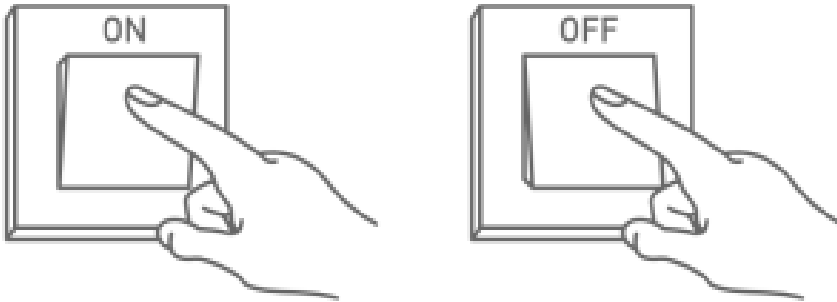

Add device – AP mode

AP mode

1. For AP mode, please make sure the device's light slowly flashes (1 time every 3 seconds), tap to go on to the next step.
2. If light is slowly flashing, tap “how to set light as slow flashes” to view operation processes.

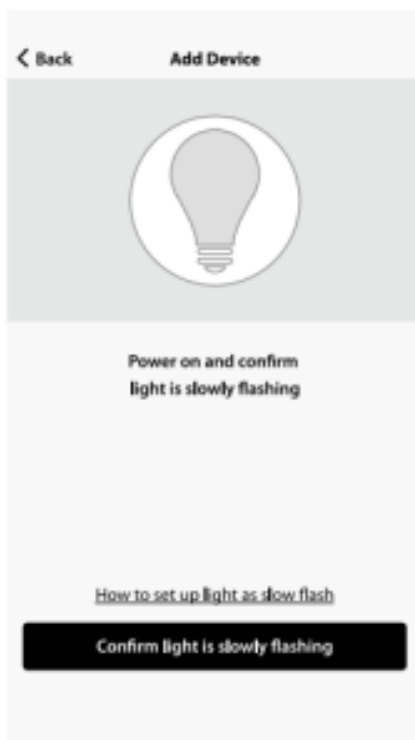

Notes: How to set light as slowly flashing

1. Power on device.—Power off after 10s and then power on.
2. Turn on-off-on-off-on. (Keep time interval not too short, turn off after light is on)
3. Confirm light bulb is now rapidly flashing. (2 time per second)
4. Operate again—Turn on-off-on-off-on until light is slowly flashing. (1 time per 3 second)

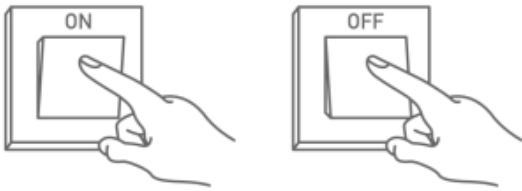

Add device – Normal mode

Enter Wi-Fi password

1. Select the Wi-Fi under which device is working,
2. enter password and tap “Confirm” to enter network connection process, as shown in the picture below.

Before connecting, please make sure your smart phone is connected to your home WIFI and to the internet, and power on the smart device.



Normal mode-Network connection process

1. If you select normal mode to connect device to the network, the App goes through the processes as shown in the picture .
2. After the network connection is successfully, the App page will be shown in the picture .

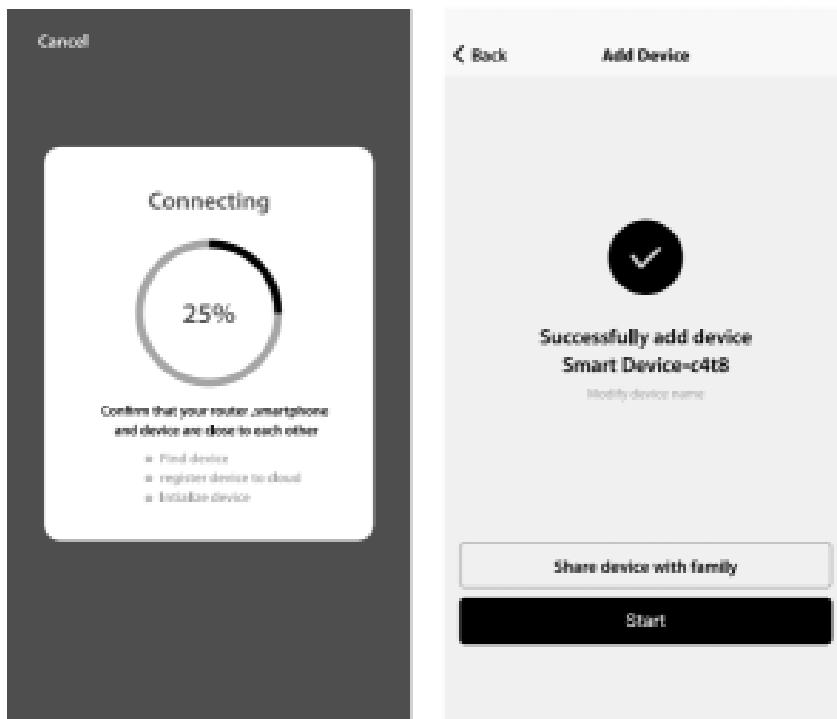

Add device – AP mode

Enter Wi-Fi password

For AP mode, connect to the Wi-Fi hotspot named “SmartLife”, as shown in the picture.

Notes: Some devices might have different hotspot names.



AP mode-Network connection process

After connecting with the hotspot, back to the network connection page to enter network connection process. The App goes through as shown in the picture .

Picture 2 shows the App page when the network connection is successful.

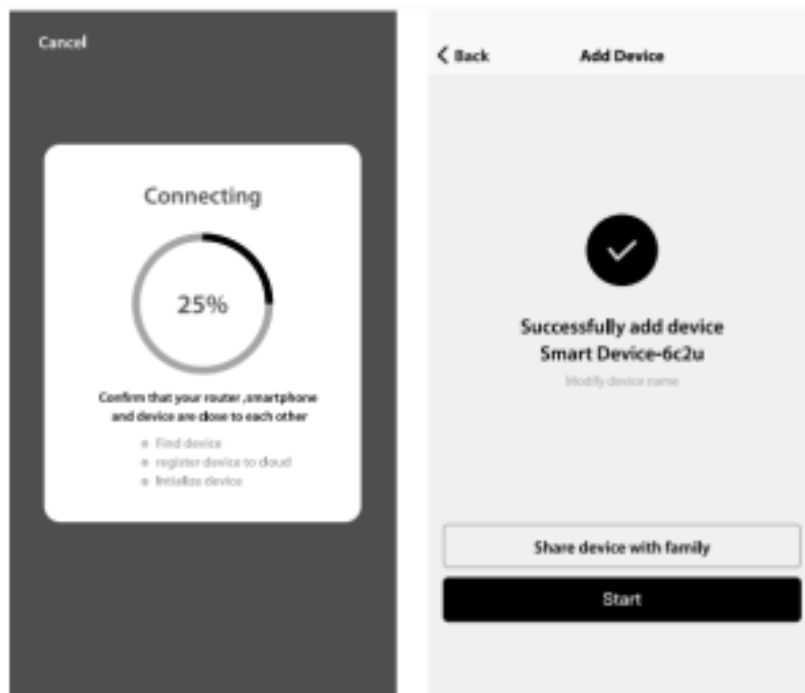

Control device

After successfully configuring the devices, the smart device will be shown on the home page. Tap to enter its control page.

Note:

1. When device is online, it support short-cut operations.
2. When device is offline, it displays “Offline” and can be controlled.

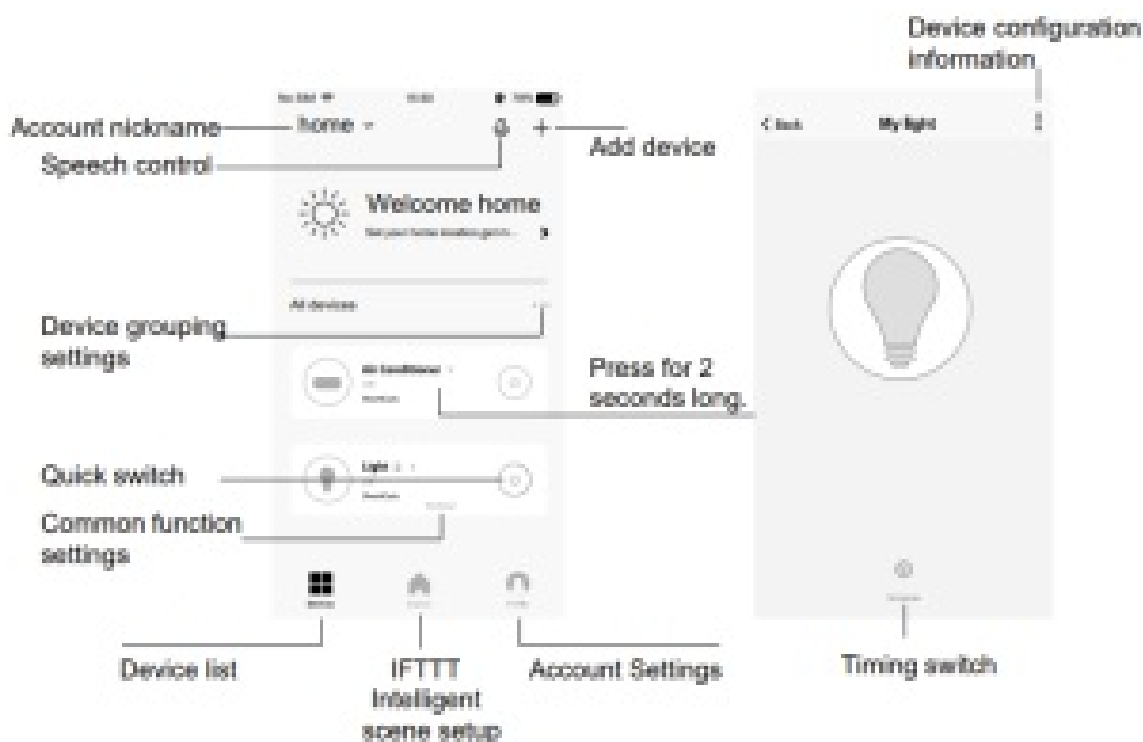

Control device

The device modification menu is shown in the figure.

1. **Change basic information:** You can change the name and location of a device.
2. **Shared devices:** You can share any individual device with others by entering their mobile phone numbers.
(Note: Their mobile phone numbers must be registered with Tuya app accounts.)
3. **Create group:** Click and the page will automatically show all devices that have been added and have the same model number. A group cannot be created for devices with different model numbers.
4. **Device information:** Check here for: device ID, Wi-Fi signal strength, IP address, Mac address, and device time zone.
5. **Feedback:** You can submit feedback here on problems encountered during usage.
6. **Check for firmware upgrades:** You can check here for firmware updates.
7. **Remove device:** Delete a previously added device from the list of devices.
8. **Factory reset:** Remove devices and clear all data.

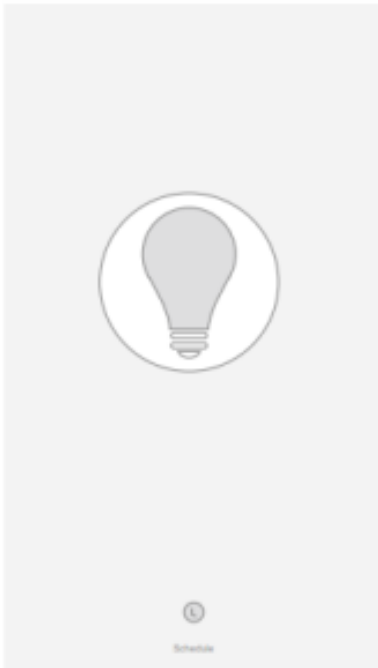

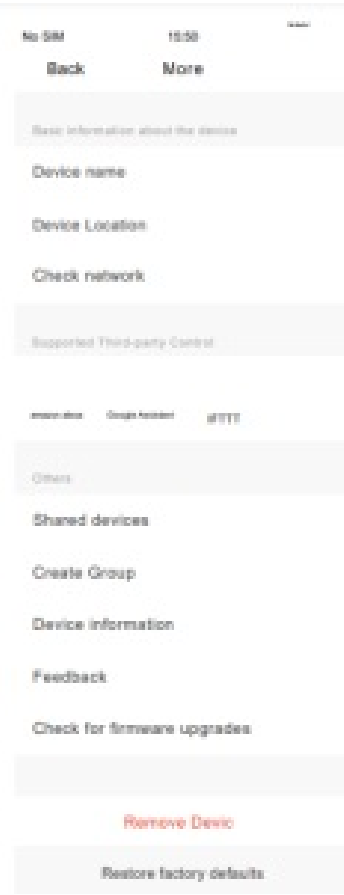

Specification

Model:	SF1202WE1DP-8
Length:	2M/Roll
Power:	8W
IP Grade:	IP64 (Slim PU glue potted)
Voltage:	DC12V
Power Supply:	Insert wall type, input AC90-240V/0.6A; output DC12V/1A
Luminous Flux:	500lm

Emitting Color:	RGB+2700K-6500K
LED QTY:	5050 (60pcs); 2835 (120pcs)
CRI:	>80Ra
FPC Width:	12mm
Protocol:	Wi-Fi
App Control:	SMART LIFE
Voice Control:	Amazon Alexa/ Google Home
Auto Conatrol:	IFTTT
Certificates:	ETL/CE/FCC



Thank You

For more information's please visit: www.ssluce.com



Documents / Resources

	<p>Light Strips SF1202WE1DP Wi-Fi Smart Led Strip Light [pdf] User Manual SF1202WE1DP, Wi-Fi Smart Led Strip Light</p>
---	--

[Manuals+](#)