



LIGHT IT 20072-401 MultiFlex LED Floor Magnifier Lamp Instruction Manual

[Home](#) » [LIGHT-IT](#) » LIGHT IT 20072-401 MultiFlex LED Floor Magnifier Lamp Instruction Manual 

Contents

- [1 LIGHT IT 20072-401 MultiFlex LED Floor Magnifier Lamp](#)
- [2 Product Information](#)
- [3 Product Usage Instructions](#)
- [4 ASSEMBLING THE MAGNIFIER](#)
- [5 What's in the box](#)
- [6 INSERTING BATTERIES](#)
- [7 SPECIFICATIONS](#)
- [8 USING THE AC ADAPTER](#)
- [9 Care & Maintenance](#)
- [10 Operation](#)
- [11 Documents / Resources](#)
 - [11.1 References](#)
- [12 Related Posts](#)



LIGHT IT 20072-401 MultiFlex LED Floor Magnifier Lamp



Product Information

Specifications

- COB LED x 2 (6000K)
- 200 – 20 LM
- 500 – 50 LM Variable memory setting
- D Cell x3 (not included)
- **ETL#:** 5003784
- AC100 – 240 V, 50 – 60 HZ
- 5V DC, 2A
- **Lens Material:** Acrylic
- **Magnification:** X2.5, X6, 6×4, 11x9x53
- **Weight:** 8.5 lb

Product Usage Instructions

Assembling the Magnifier

Step 1: Remove protective washers from the poles.

Step 2:

1. Screw the lower (long) pole clockwise into the base until fully tightened and securely attached.

2. Slide the wire through the threaded metal pole connector and hand-tighten it. Note: Multiple rotations are required.

Step 3:

1. Thread the power cord through the upper (short) pole and insert the flexible arm (Do not fasten! See step 4).
2. Next, lay the head assembly on a chair or couch next to the base and connect the power cables.

Step 4:

1. Position the head assembly onto the base pole, inserting the excess power cord into either pole.
2. Holding the upper pole in place, lift the flexible arm slightly (no more than 1 inch) with your other hand and rotate the pole clockwise until it is securely attached (the head should not turn). Align the magnifier head to face in the same direction as the base.
3. Push the flexible arm back into the upper metal pole and screw the threaded joint clockwise back into the upper metal pole until it is tightened.

Inserting Batteries

Alternatively, you may plug in the supplied AC adapter instead of using batteries. The lamp is now ready to use.

Care & Maintenance

- Clean the magnifier with a soft, dry microfiber cleaning cloth.
- If necessary, use an approved acrylic eyeglass cleaner.
- Do not expose the lens to direct sunlight (fire hazard!).
- Do not look directly into the light.
- Indoor use only.
- Do not mix battery types and use new batteries.

FAQ

1. Q: Can I use different types of batteries?

A: No, do not mix battery types. Use new D Cell batteries.

2. Q: How do I clean the magnifier?

A: Clean the magnifier with a soft, dry microfiber cleaning cloth. If necessary, use an approved acrylic eyeglass cleaner.

3. Q: Can I use the magnifier outdoors?

A: No, the magnifier is for indoor use only.

4. Q: Can I look directly into the light?

A: No, do not look directly into the light.

5. Q: How can I contact customer support?

A: You can contact us at info@lighthitted.com or by phone at (503) 274-1227.

ASSEMBLING THE MAGNIFIER

• Step 1

Remove protective washers from the poles.

• Step 2

- Screw the lower (long) pole clockwise into the base until fully tightened and securely attached.
- Slide the wire through the threaded metal pole connector and hand-tighten it.

• Step 3

- Thread the power cord through the upper (short) pole and insert the flexible arm (Do not fasten! See step 4).
- Next, lay the head assembly on a chair or couch next to the base and connect the power cables (see inset).

• Step 4

- Position the head assembly onto the base pole, inserting the excess power cord into either pole.
- Holding the upper pole in place, lift the flexible arm slightly (no more than 1") with your other hand and rotate the pole clockwise until it is securely attached (the head should not turn).
- Align the magnifier head to face in the same direction as the base.
- Push the flexible arm back into the upper metal pole and screw the threaded joint clockwise back into the upper metal pole until it is tightened.

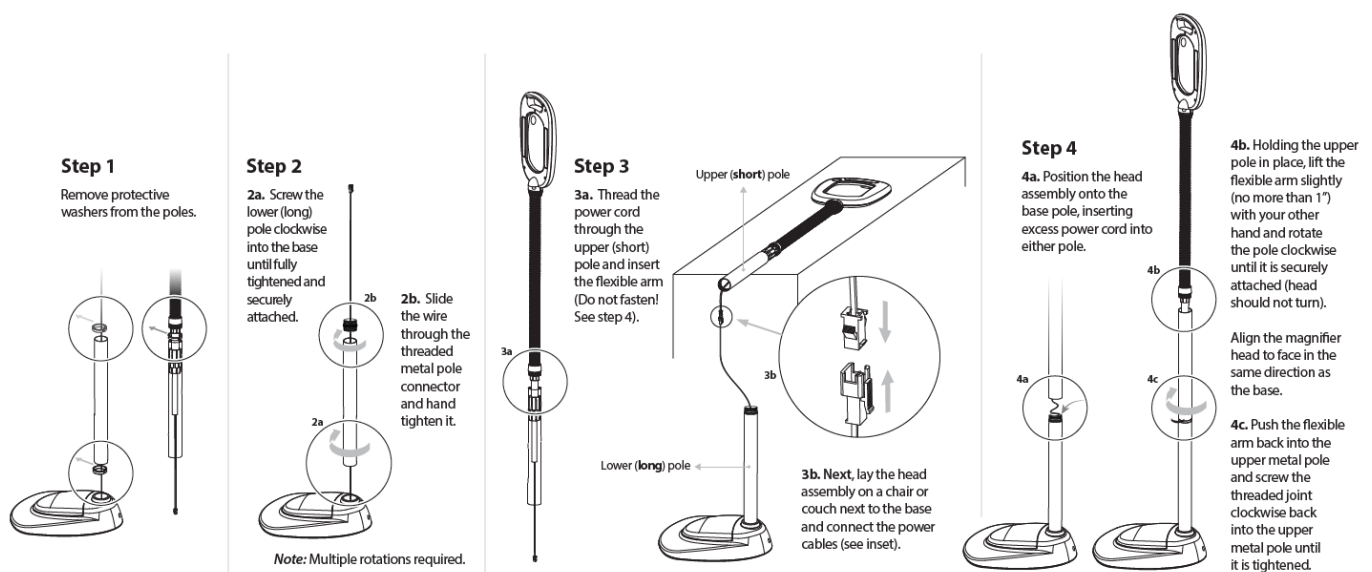

What's in the box

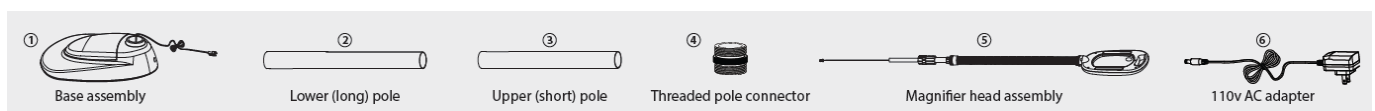

INSERTING BATTERIES

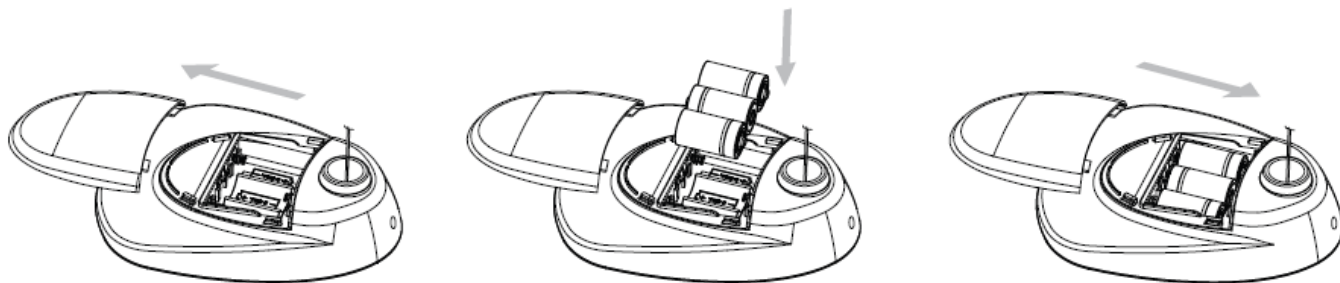

SPECIFICATIONS

Lamp	COB LED x 2 (6000K)	Lens Material	Acrylic
Lumens (high/low) – battery mode	200 - 20 LM	Magnification	
Lumens – 110v adapter	500 - 50 LM	• Lens	X2.5
Smart Dimmer	Variable memory setting	• Inset	X6
Battery Type	D Cell x3 (not incl)	Lens Dimensions	6" x 4"
AC Adapter	ETL#: 5003784	Magnifier Dimensions	11" x 9" x 53"
• Input	AC100 - 240 V, 50 - 60 HZ	Magnifier Weight	8.5 lb
• Output	5V DC, 2A		

USING THE AC ADAPTER

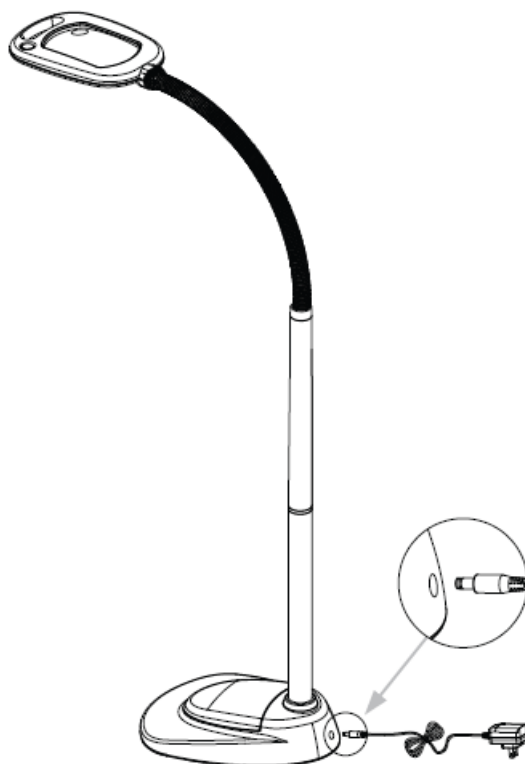

Care & Maintenance

- Clean the magnifier with a soft, dry microfiber cleaning cloth
- If necessary, use an approved acrylic eyeglass cleaner
- Do not expose the lens to direct sunlight (fire hazard!)
- Do not look directly into the light.
- Indoor Use Only

- Do not mix battery types and use new batteries

Note: Using harsh chemicals or dirty cloths may scratch the lens.

No tools required

Operation

- Press the power button to turn the lamp on and off

Smart Dimmer

- Press and hold the power button
- Light will flash once at the highest setting and again at the lowest
- Release the power button at the desired illumination level
- The smart dimmer will remember the light level until it is reset

Assembly

Please review the instructions carefully before assembling the magnifier. To avoid damage, perform all work on a carpeted or padded surface. If you have questions or need assistance, please contact us at:

- **Email:** info@lighthit.com or
- **Phone:** (503) 274-1227
- **Note:** Remove all protective washers before installing the poles.

Scan for easy 3D instructions

Tap. Zoom. Rotate with official interactive instructions on the BILT app.



Documents / Resources

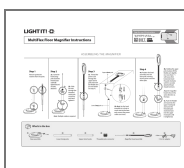

[LIGHT IT 20072-401 MultiFlex LED Floor Magnifier Lamp](#) [pdf] Instruction Manual
20072-401 MultiFlex LED Floor Magnifier Lamp, 20072-401, MultiFlex LED Floor Magnifier Lamp, LED Floor Magnifier Lamp, Floor Magnifier Lamp, Magnifier Lamp, Lamp

References

- [User Manual](#)

[Manuals+](#), [Privacy Policy](#)