

LIGHT IT 20072-401 LED Floor Magnifier Lamp



LIGHT IT 20072-401 LED Floor Magnifier Lamp Instruction Manual

[Home](#) » [LIGHT IT](#) » LIGHT IT 20072-401 LED Floor Magnifier Lamp Instruction Manual 

Contents

- [1 LIGHT IT 20072-401 LED Floor Magnifier Lamp](#)
- [2 ASSEMBLING THE MAGNIFIER](#)
- [3 What's in the box](#)
- [4 SPECIFICATIONS](#)
- [5 USING THE AC ADAPTER](#)
- [6 Assembly](#)
- [7 Care & Maintenance](#)
- [8 FREQUENTLY ASKED QUESTIONS](#)
- [9 VIDEO – PRODUCT OVERVIEW](#)
- [10 References](#)

LIGHT IT! 

LIGHT IT 20072-401 LED Floor Magnifier Lamp



ASSEMBLING THE MAGNIFIER

- **Step 1** Remove protective washers from the poles.

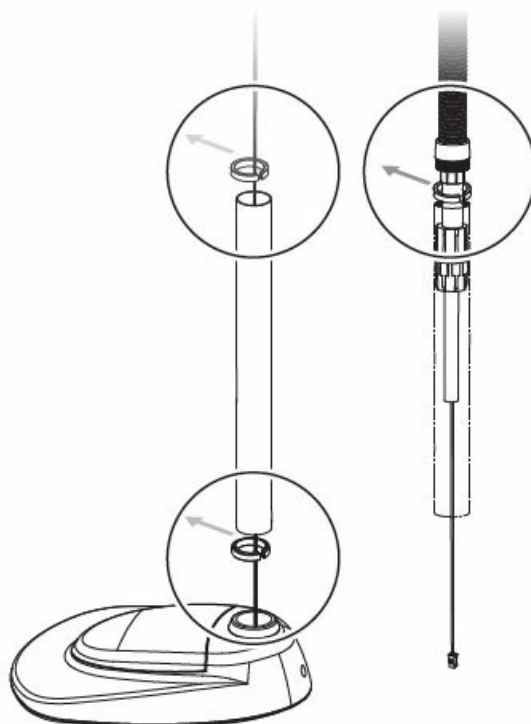

- **Step 2**

- 2a. Screw the lower (long) pole clockwise into the base until fully tightened and securely attached.
- 2b. Slide the wire through the threaded metal pole connector and hand tighten it.

Note: Multiple rotations are required.

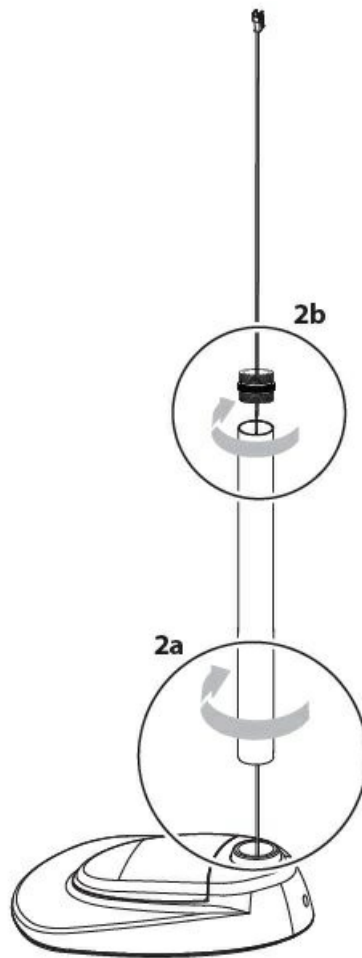

- **Step 3**

- 3a. Thread the power cord through the upper (short) pole and insert the flexible arm (Do not fasten! See step 4).
- 3b. Next, lay the head assembly on a chair or couch next to the base and connect the power cables (see inset).

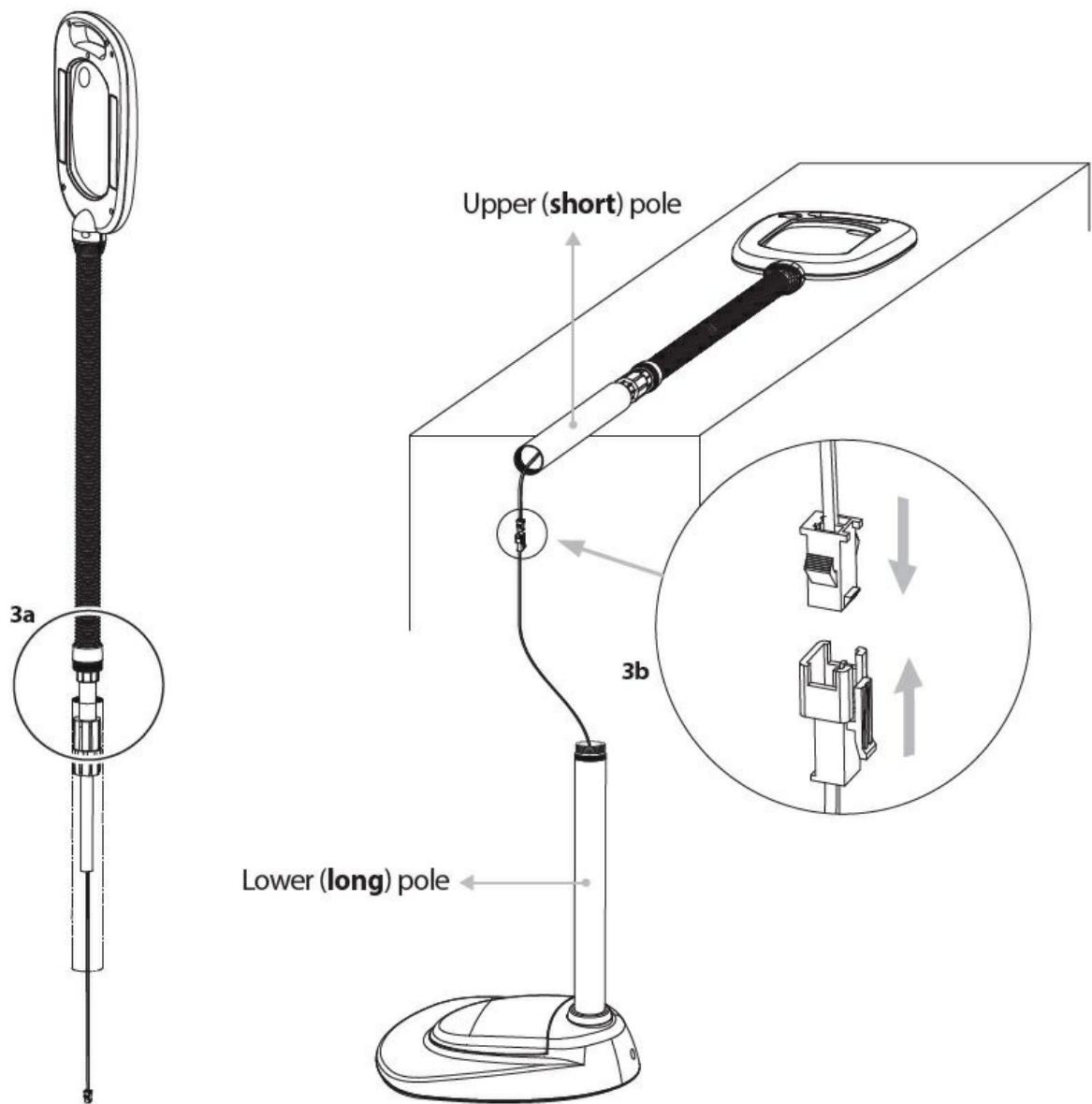

• Step 4

- 4a. Position the head assembly onto the base pole, inserting the excess power cord into either pole.
- 4b. Holding the upper pole in place, lift the flexible arm slightly (no more than 1") with your other hand and rotate the pole clockwise until it is securely attached (the head should not turn). Align the magnifier head to face in the same direction as the base.
- 4c. Push the flexible arm back into the upper metal pole and screw the threaded joint clockwise back into the upper metal pole until it is tightened.

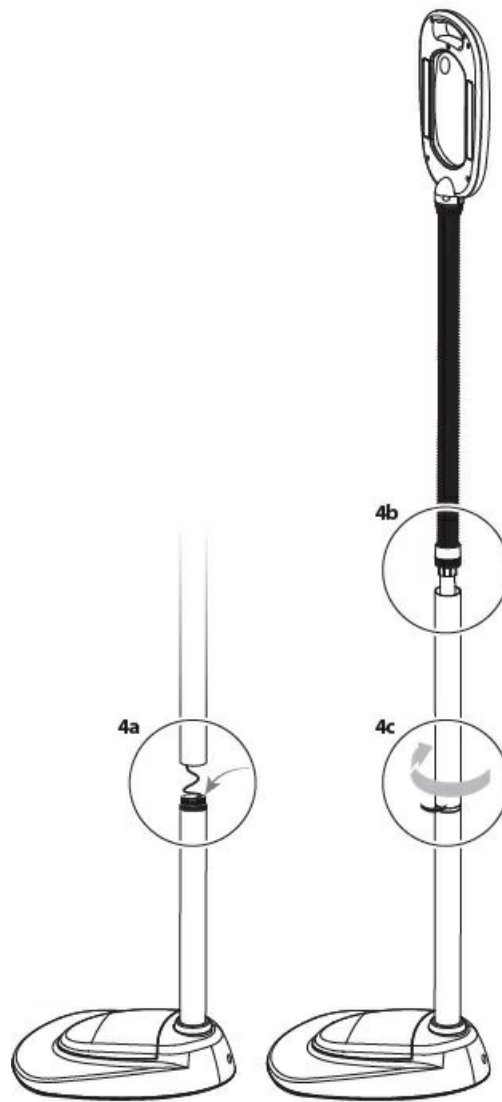

What's in the box

- Base assembly
- Lower (long) pole
- Upper (short) pole
- Threaded pole connector
- Magnifier head assembly
- 110V AC adapter

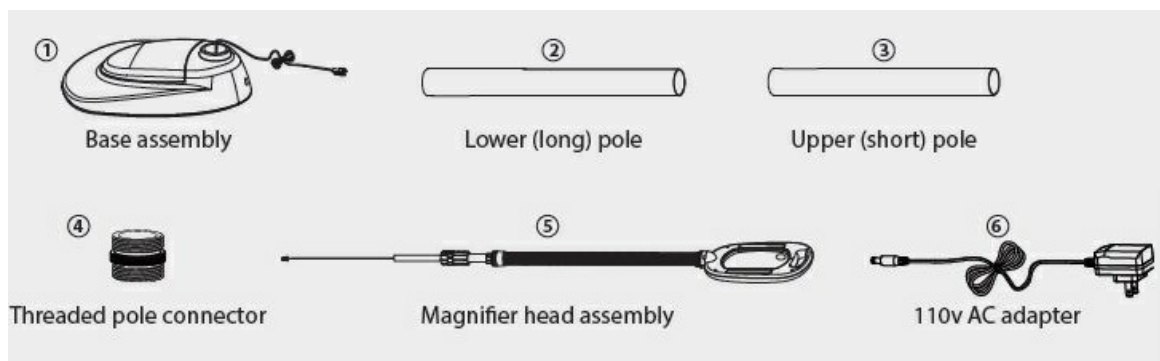

INSERTING BATTERIES

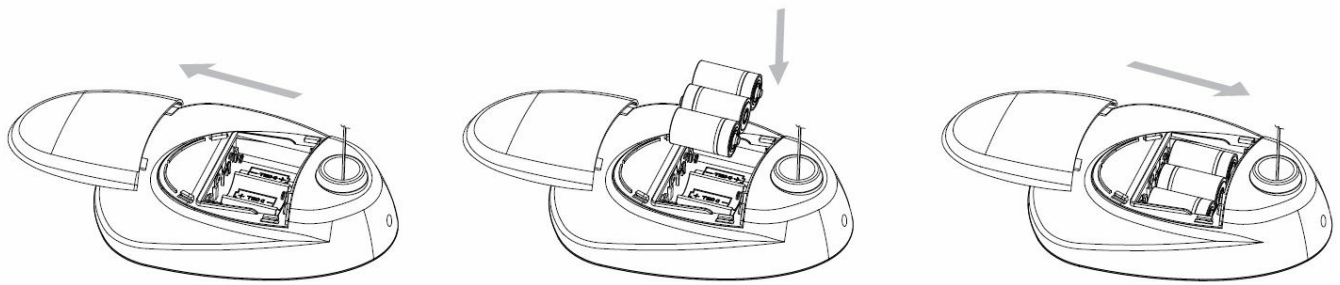

SPECIFICATIONS

- **Lamp:** COB LED x 2 (6000K)
- **Lumens (high/low) – battery mode:** 200 – 20 LM
- **Lumens – 110v adapter:** 500 – 50 LM
- **Smart Dimmer:** Variable memory setting
- **Battery Type:** D Cell x3 (not included)
- **AC Adapter:** ETL#: 5003784
- **Input:** AC100 – 240 V, 50 – 60 HZ
- **Output:** 5V DC, 2A
- **Lens Material:** Acrylic
- **Magnification:**
 - **Lens:** X2.5
 - **Inset:** X6 Lens
- **Dimensions:** 6" x 4"
- **Magnifier Dimensions:** 11" x 9" x 53"
- **Magnifier Weight:** 8.5 lb

USING THE AC ADAPTER

Alternatively, you may plug in the supplied AC adapter instead of using batteries. The lamp is now ready to use.

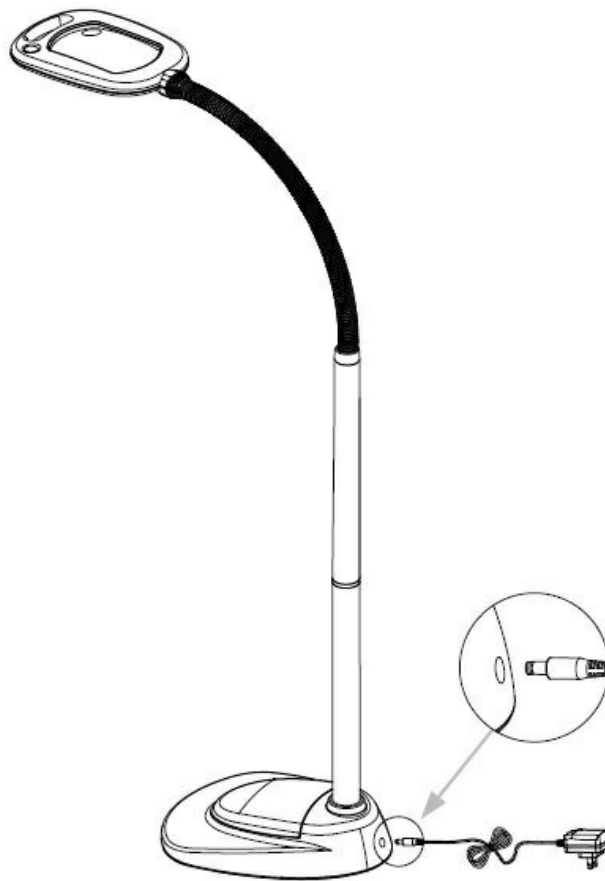

No tools required

Operation

- Press the power button to turn the lamp on and off

Smart Dimmer

- Press and hold the power button
- Light will flash once at the highest setting and again at lowest Release the power button at the desired illumination level
- The smart dimmer will remember the light level until it is reset

Assembly

Please review the instructions carefully before assembling the magnifier. To avoid damage, perform all work on a carpeted or padded surface. If you have questions or need assistance, please contact us at:

- **Email:** info@lighthited.com or
- **Phone:** (503) 274-1227

Note: Remove all protective washers before installing the poles.

Care & Maintenance

- Clean the magnifier with a soft, dry microfiber cleaning cloth
- If necessary, use an approved acrylic eyeglass cleaner
- Do not expose the lens to direct sunlight (fire hazard!)
- Do not look directly into the light.
- Indoor Use only
- Do not mix battery types and use new batteries

Note: Using harsh chemicals or dirty clothes may scratch the lens.

Scan for easy 3D instructions



Tap. Zoom. Rotate with official interactive instructions on the BILT app.

FREQUENTLY ASKED QUESTIONS

What is the brand of the LED Floor Magnifier Lamp with model number 20072-401?

The LED Floor Magnifier Lamp is branded as LIGHT IT.

What is the item weight of the LIGHT IT 20072-401 LED Floor Magnifier Lamp?

The LIGHT IT 20072-401 LED Floor Magnifier Lamp weighs 8.5 pounds, providing stability and sturdiness.

What is the lens material used in the LIGHT IT 20072-401 LED Floor Magnifier Lamp?

The LIGHT IT 20072-401 LED Floor Magnifier Lamp uses optical grade acrylic for its lens material, ensuring clarity and durability.

What are the product dimensions of the LIGHT IT 20072-401 LED Floor Magnifier Lamp?

The product dimensions of the LIGHT IT 20072-401 LED Floor Magnifier Lamp are 11 inches in length and 9 inches in width, providing ample coverage for magnification tasks.

What is the magnification strength of the LIGHT IT 20072-401 LED Floor Magnifier Lamp?

The LIGHT IT 20072-401 LED Floor Magnifier Lamp has a magnification strength of 6 diopters, offering enhanced visibility for detailed tasks.

Who is the manufacturer of the LIGHT IT 20072-401 LED Floor Magnifier Lamp?

The LIGHT IT 20072-401 LED Floor Magnifier Lamp is manufactured by Fulcrum, ensuring quality and reliability.

What material is used in the construction of the LIGHT IT 20072-401 LED Floor Magnifier Lamp?

The LIGHT IT 20072-401 LED Floor Magnifier Lamp is constructed using ABS with steel poles, providing durability and stability.

How many lights does the LIGHT IT 20072-401 LED Floor Magnifier Lamp have?

The LIGHT IT 20072-401 LED Floor Magnifier Lamp has 500 lights, ensuring bright and uniform illumination.

What are the power source options for the LIGHT IT 20072-401 LED Floor Magnifier Lamp?

The LIGHT IT 20072-401 LED Floor Magnifier Lamp can be powered using either an AC adapter or 3 D batteries, offering flexibility in usage.

What is the switch style of the LIGHT IT 20072-401 LED Floor Magnifier Lamp?

The LIGHT IT 20072-401 LED Floor Magnifier Lamp features a push-on and off switch style, providing convenient operation.

What is the luminous flux of the LIGHT IT 20072-401 LED Floor Magnifier Lamp with the 110v adapter?

The LIGHT IT 20072-401 LED Floor Magnifier Lamp has a luminous flux of 500 lumens when used with the 110v adapter, ensuring bright and efficient illumination.

What is the wattage of the LIGHT IT 20072-401 LED Floor Magnifier Lamp?

The LIGHT IT 20072-401 LED Floor Magnifier Lamp has a wattage of 4 watts, offering energy-efficient operation.

What is the color temperature of the light emitted by the LIGHT IT 20072-401 LED Floor Magnifier Lamp?

The LIGHT IT 20072-401 LED Floor Magnifier Lamp emits light at a color temperature of 6000 Kelvin, providing a cool and bright illumination.

What is the Color Rendering Index (CRI) of the LIGHT IT 20072-401 LED Floor Magnifier Lamp?

The Color Rendering Index (CRI) of the LIGHT IT 20072-401 LED Floor Magnifier Lamp is 90, indicating excellent color rendering capabilities.

What are some common applications or uses for the LIGHT IT 20072-401 LED Floor Magnifier Lamp?

The LIGHT IT 20072-401 LED Floor Magnifier Lamp is commonly used for tasks requiring detailed magnification, such as reading, crafting, and intricate work in various industries.

VIDEO – PRODUCT OVERVIEW



[Download the PDF link: LIGHT IT 20072-401 LED Floor Magnifier Lamp Instruction Manual Floor-Magnifier-Lamp-Instruction-Manual.mp4](#)

REFERENCE: [LIGHT IT 20072-401 LED Floor Magnifier Lamp Instruction Manual-Device.Report](#)



References

- [User Manual](#)

[Manuals+](#), [Privacy Policy](#)

This website is an independent publication and is neither affiliated with nor endorsed by any of the trademark owners. The "Bluetooth®" word mark and logos are registered trademarks owned by Bluetooth SIG, Inc. The "Wi-Fi®" word mark and logos are registered trademarks owned by the Wi-Fi Alliance. Any use of these marks on this website does not imply any affiliation with or endorsement.