

LiftMaster 811LM Gate Key Remote Controls



LiftMaster 811LM Gate Key Remote Controls Owner's Manual

[Home](#) » [LiftMaster](#) » LiftMaster 811LM Gate Key Remote Controls Owner's Manual 

Contents

- [1 LiftMaster 811LM Gate Key Remote Controls](#)
- [2 Product Information](#)
- [3 Product Usage Instructions](#)
- [4 Introduction](#)
- [5 Set the Dip Switches](#)
- [6 Programming](#)
- [7 The Remote Control Battery](#)
- [8 Replacement Parts](#)
- [9 Documents / Resources](#)
 - [9.1 References](#)
- [10 Related Posts](#)

LiftMaster®

LiftMaster 811LM Gate Key Remote Controls



Product Information

Specifications

- **Models:** 811LM and 813LM
- **Compatible with models:** 850LM and 811LM
- **Battery:** Lithium battery (3V CR2032)
- **Battery Life:** Up to 3 years

Introduction

The Gate Key Remote Controls Models 811LM and 813LM are designed for use with models 850LM and 811LM. It is important to follow the instructions carefully to prevent any possible injuries or accidents.

Product Usage Instructions

Set the Dip Switches

1. Slide the cover open to access the dip switches in the remote control.
2. Use a pen or screwdriver to slide the dip switches to any position you want (ON or OFF).

Programming

1. Press and release the Learn button for the selected channel on the receiver. The corresponding LED will glow continuously for 30 seconds.
2. Within 30 seconds, press and hold the button on the remote control that you wish to program to the receiver.
3. Release the remote control button when the LED on the receiver blinks, and then turns off. Programming is complete.

Repeat the steps above for each remote control you would like to program. If you would like to program an 813LM as an OPEN, CLOSE, STOP, refer to the 850LM receiver manual.

The Remote Control Battery

The Lithium battery should produce power for up to 3 years. To replace the battery:

1. Open the remote control.
2. Replace the old battery with a new 3V CR2032 Lithium battery.

FAQs

- **Q: What is the battery life of the remote control?**

A: The Lithium battery should last up to 3 years.

- **Q: Can I program multiple remote controls to the receiver?**

A: Yes, you can program multiple remote controls by following the programming instructions.

- **Q: Where can I find the receiver manual for programming an 813LM as OPEN, CLOSE, STOP?**

A: You can refer to the 850LM receiver manual for instructions on programming an 813LM as OPEN, CLOSE, STOP.

- **Q: Are there any user-serviceable parts in the remote control?**

A: No, there are no user-serviceable parts in the remote control. Any adjustments or modifications are prohibited.

- **Q: How can I contact customer support?**

A: You can call 1-800-528-9131 or visit LiftMaster's website at <https://www.liftmaster.com/> for further assistance.

Introduction

This product is for use with models 850LM and 860LM universal receivers as well as any Security+ 2.0® compatible LiftMaster gate operators. Depending on the receiver channel, you may program up to 20 or 50 remote control dip switch configurations to your receiver. To exceed the 20/50 limit, match the dip switches in the new remote control to the dip switches in an existing remote control.



811LM

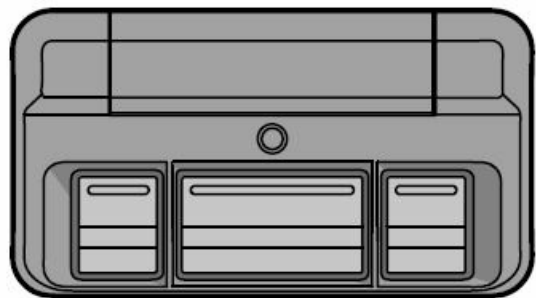

813LM

WARNING

To prevent possible SERIOUS INJURY or DEATH from a moving gate or garage door:

- ALWAYS keep remote controls out of reach of children. NEVER permit children to operate, or play with remote control transmitters.
- Activate the gate or door ONLY when it can be seen clearly, is properly adjusted, and there are no obstructions to door travel.
- ALWAYS keep the gate or garage door in sight until completely closed. NEVER permit anyone to cross the path

of a moving gate or door.

WARNING:

This product can expose you to chemicals including lead, which are known to the State of California to cause cancer birth defects or other reproductive harm. For more information go to www.P65Warnings.ca.gov.

Set the Dip Switches

1. Slide the cover open to access the dip switches in the remote control.
2. Use a pen or screwdriver to slide the dip switches to any position you want (ON or OFF).

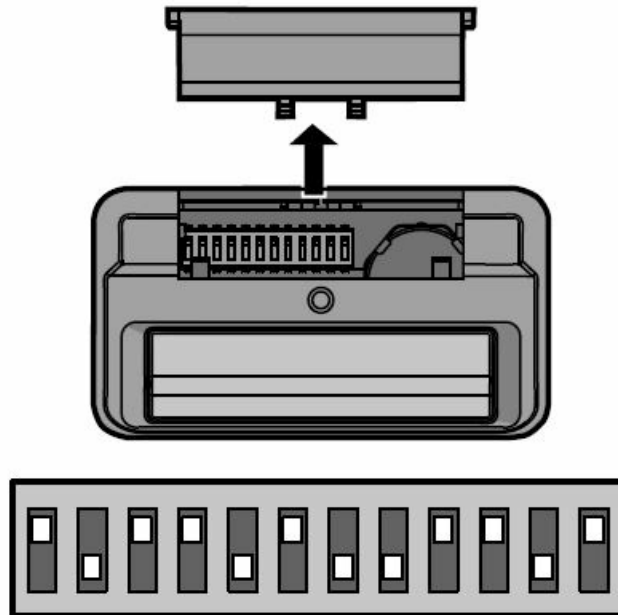

Programming

1. Press and release the Learn button for the selected channel on the receiver. The corresponding LED will glow steadily for 30 seconds.
2. Within 30 seconds press and hold the button on the remote control that you wish to program to the receiver.
3. Release the remote control button when the LED on the receiver blinks, then turns off. Programming is complete.

Repeat the steps above for each remote control you would like to program. If you would like to program an 813LM as an OPEN, CLOSE, STOP, refer to the 850LM receiver manual.

For programming to the 860LM receiver or to a Security+ 2.0® compatible gate operator, please refer to the receiver/operator instructions manual for the location of the learn button(s).

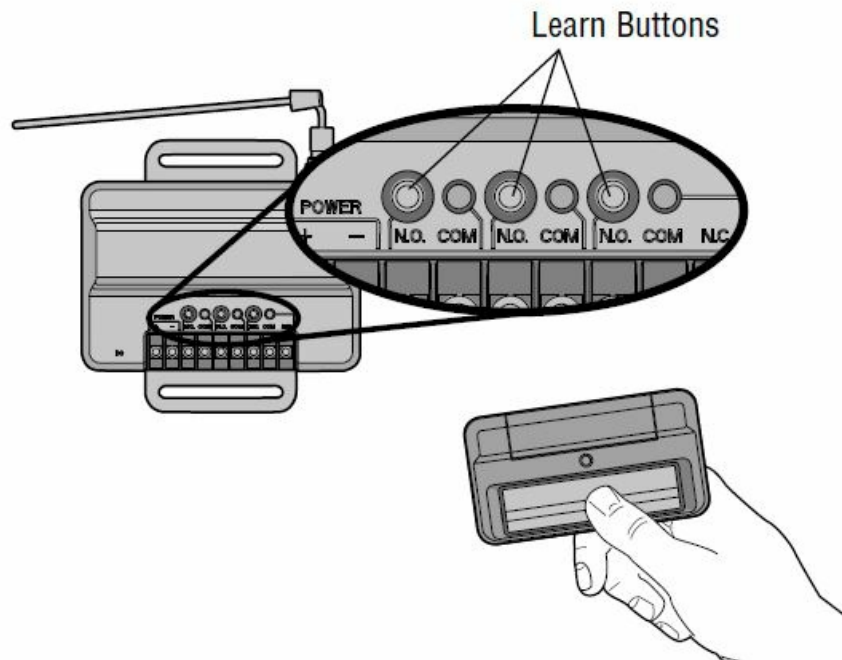

The Remote Control Battery

The Lithium battery should produce power for up to 3 years. To replace the battery:

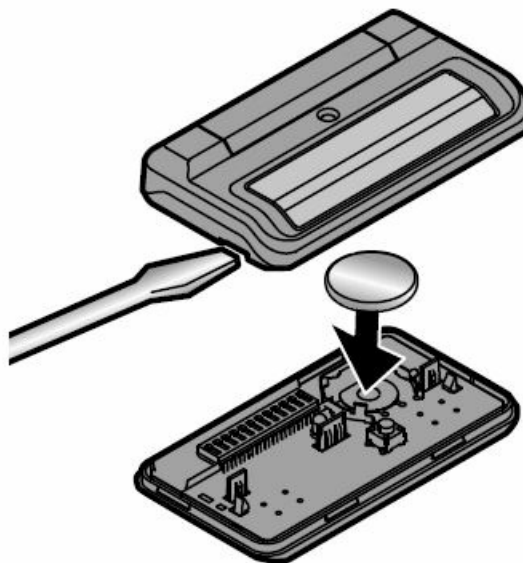

WARNING:

To prevent possible **SERIOUS INJURY** or **DEATH**:

- NEVER allow small children near batteries.
- If the battery is swallowed, immediately notify the doctor.

To reduce the risk of fire, explosion or chemical burn:

- Replace **ONLY** with 3V CR2032 coin batteries.
- **DO NOT** recharge, disassemble, heat above 212°F (100°C) or incinerate.

NOTICE:

To comply with FCC and/or Industry Canada (IC) rules, adjustments or modifications of this transceiver are prohibited. THERE ARE NO USER-SERVICEABLE PARTS.

This device complies with Part 15 of the FCC rules and IC RSS-210. Operation is subject to the following two conditions: (1) this device may not cause harmful interference, and (2) this device must accept any interference received, including interference that may cause undesired operation.

Replacement Parts

- Visor Clip29C137
- 3V CR2032 Lithium Battery10A20

FOR TECHNICAL SUPPORT DIAL OUR TOLL-FREE NUMBER:

- 1-800-528-9131
- LiftMaster.com.

© 2014 LiftMaster All Rights Reserved.

Documents / Resources

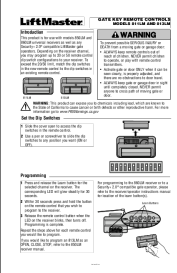
	<p>LiftMaster 811LM Gate Key Remote Controls [pdf] Owner's Manual 811LM Gate Key Remote Controls, 811LM, Gate Key Remote Controls, Key Remote Controls, Remote Controls, Controls</p>
---	---

References

-  [LiftMaster | Garage Door Openers, Remotes & Accessories](#)
-  [P65Warnings.ca.gov](#)
-  [Manual-Hub.com - Free PDF manuals!](#)
- [User Manual](#)

[Manuals+.](#) [Privacy Policy](#)

This website is an independent publication and is neither affiliated with nor endorsed by any of the trademark owners. The "Bluetooth®" word mark and logos are registered trademarks owned by Bluetooth SIG, Inc. The "Wi-Fi®" word mark and logos are registered trademarks owned by the Wi-Fi Alliance. Any use of these marks on this website does not imply any affiliation with or endorsement.