

# life smart Infrared Quartz Heater Multi Function Tower User Manual

[Home](#) » [Life Smart](#) » life smart Infrared Quartz Heater Multi Function Tower User Manual

life smart Infrared Quartz Heater Multi Function

Tower User Manual



lifesmart® is a registered trademark  
of Supply Chain Sources, LLC., All Rights Reserved.

## INFRARED QUARTZ HEATER & MULTIFUNCTION TOWER

Customer number:  
XXAC3004US, XXAC3012US

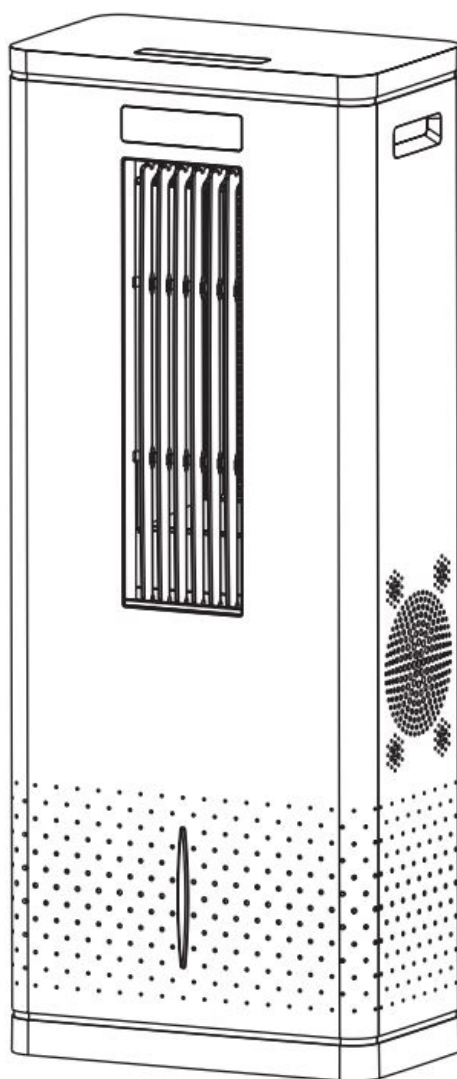

### ATTACH YOUR RECEIPT HERE

Purchase Date \_\_\_\_\_ Serial Number (located on back of unit) \_\_\_\_\_



**Questions, problems, missing parts?** Contact technical support department at  
**657-341-0362, 9:00 a.m. - 5 p.m., PST, Monday - Friday** or visit us online at  
[www.lifesmartcomfort.com](http://www.lifesmartcomfort.com)  
Please have your model and serial number ready



## Contents [ [hide](#) ]

- 1 PACKAGE CONTENTS
- 2 SAFETY INFORMATION
- 3 FREQUENTLY ASKED QUESTIONS
- 4 PREPARATION
- 5 TROUBLESHOOTING
- 6 CONTROL PANEL
- 7 REMOTE CONTROL
- 8 OPERATING INSTRUCTIONS
- 9 CARE AND MAINTENANCE
- 10 ONE-YEAR LIMITED WARRANTY
- 11 REPLACEMENT PARTS LIST
- 12 Documents / Resources
  - 12.1 References
- 13 Related Posts

## PACKAGE CONTENTS

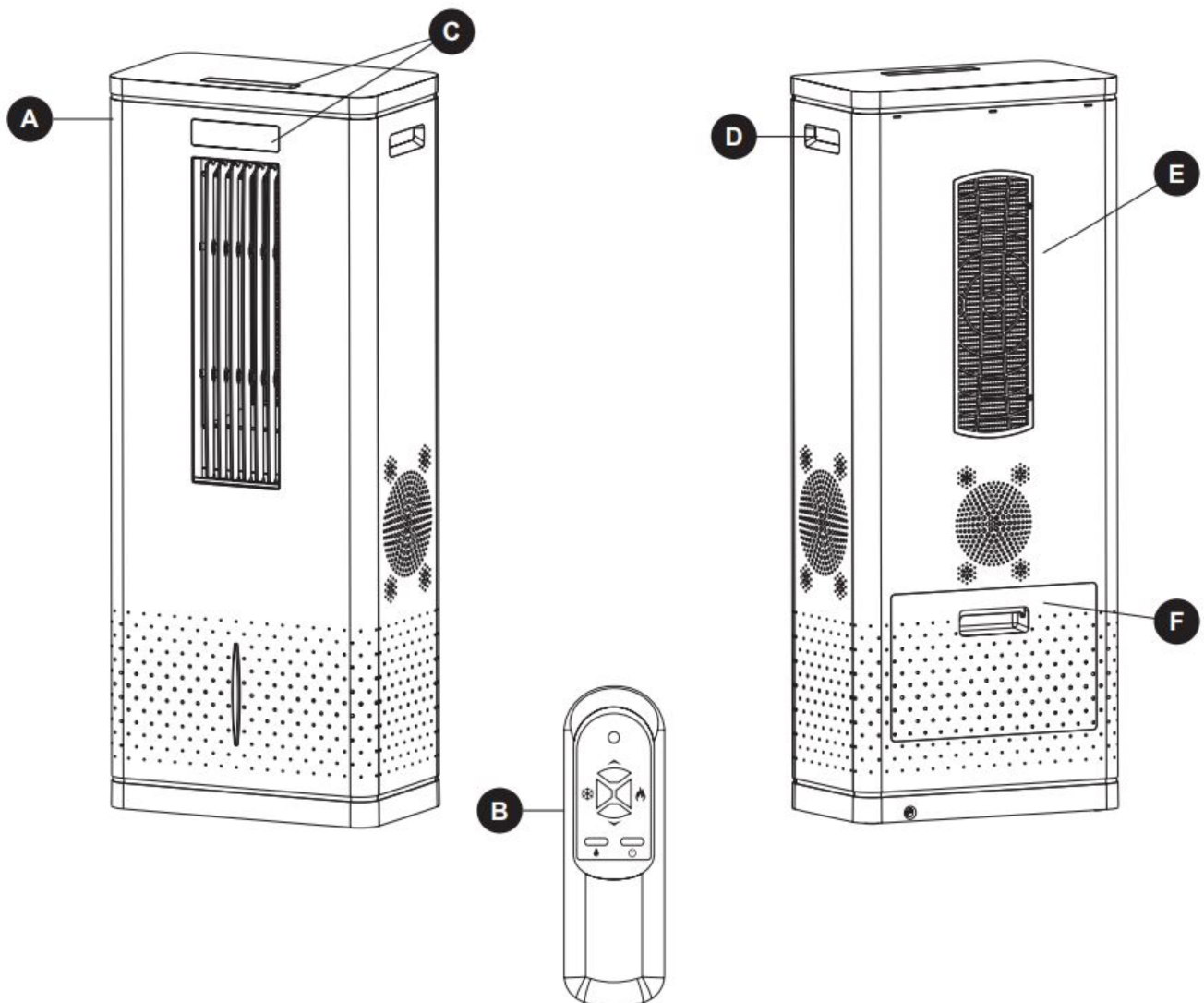

PART	DESCRIPTION	QUANTITY
A	Infrared Heater/Cooler/Humidifier	1
B	Remote Control	1
C	Control Panel (preassembled to Infrared Heater (A))	1
D	Easy Carry Handle (preassembled to Infrared Heater (A))	2
E	Filter Cover (preassembled to Infrared Heater (A))	1
F	Humidifier Chamber (preassembled to Infrared Heater (A))	1

## SAFETY INFORMATION

Please read and understand this entire manual before attempting to assemble, operate, or install the product .

### IMPORTANT SAFETY INSTRUCTIONS

 **WARNING:** POTENTIAL ELECTRICAL HAZARD IF NOT ADHERED TO . When using electrical appliances, basic precautions should always be followed to reduce the risk of fire, electric shock, and injury to persons, including the following:

- This heater must be plugged into a 120 V, 15 amp (or more) circuit of its own . Do not plug anything else into the same circuit . If unsure if your home meets this specification, consult a certified electrician prior to use .  
**Risk of fire, overheating, malfunction, property damage, injury, or even death may result if not adhered to!**
- Connect to a properly grounded, 3-prong outlet only . Do not connect the heater to extension cords, surge protectors, timers, direct breakers, or an outlet with other appliances connected to the same outlet . **Risk of fire, overheating, malfunction, property damage, injury, or even death may result if not adhered to!**
- This heater is hot when in use . To avoid burns, do not let bare skin touch hot surfaces . Use handles (certain models) or wheels to move this heater .
- Keep combustible materials, such as furniture, pillows, bedding, papers, clothes, and curtains at least 3 ft. (0 .9 m) from the front of the heater and keep them away from the sides and rear of the heater .
- Extreme caution is necessary when any heater is used by or near children, invalids, pets, or when the heater is left operating unattended .
- Always unplug the heater when not in use .
- Do not operate any heater with a damaged cord or plug or after the heater malfunctions, has been dropped, or damaged in any manner . Contact the manufacturer for resolution options .
- Do not use outdoors . Exposure to outdoor elements such as rain, snow, sun, wind, or extreme temperatures may cause the heater to become a safety hazard .
- This heater is not intended for use in bathrooms, laundry areas, and similar indoor locations, nor any locations that use GFCI outlets .
- Never place the heater where it may fall into a bathtub or other water receptacles .
- Do not run the cord under carpet . Do not cover the cord with throw rugs, runners, or similar coverings . Arrange the cord away from traffic areas and where it will not be tripped over
- The heater must be plugged into a wall outlet that is a dedicated circuit with a minimum 15 amp rating on that

individual circuit .

- To disconnect the heater, first turn the power button to the OFF position and then remove the plug from the wall outlet .
- Do not allow foreign objects to enter or block any ventilation or exhaust opening as this may cause electric shock, fire, or damage the heater .
- Allow at least 3 ft. of unobstructed space to the front and rear of the heater to allow for maximum heat, air, and ventilation flow .
- A heater has hot and arcing or sparking parts inside . Do not use it in areas where gasoline, paint, or flammable liquids are used or stored, nor use flammable solvents to clean the heater . Keep the heater dry at all times .
- Use this heater only as described in this manual . Any other use not recommended by the manufacturer may cause fire, electric shock, or injury to persons .
- Do not use abrasive solvents to clean the heater as it may cause damage to the finish or casing .
- To prevent a possible fire, do not block air intakes or exhaust in any manner . Do not use on soft surfaces, like a bed, where opening may become blocked .
- Always plug heaters directly into a wall outlet/receptacle . Never use with an extension cord or relocatable power tap (outlet/power strip) .

### **SAVE THESE INSTRUCTIONS**

#### **Tip-Over Safety Feature**

This heater is equipped with a tip-over safety feature . Once the heater is tipped over, an internal switch will automatically shut the heater off . Once the heater is restored to an upright position, the heater will reset . To continue operation, turn on the heater using the control panel or supplied remote control (if provided) on the heater .

#### **Overheat Safety Feature**

This heater is equipped with an overheat safety feature . When the internal components of the heater reach a certain temperature that could cause overheating or possible fire, the heater will automatically shut off . If the unit has been overheated, you will need to unplug the unit from the wall and replug it in to use the heater again .

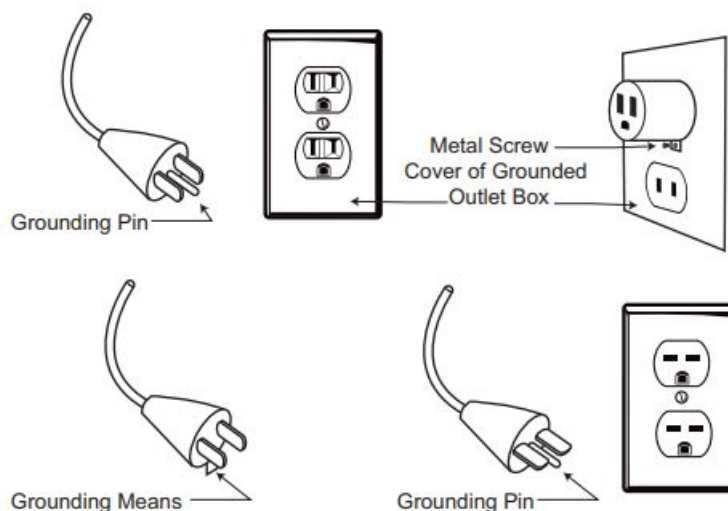

#### **⚠ WARNING:**

This heater has a voltage rating of 120 volts . The cord has a three blade, grounding type plug . An adapter is

available for connecting three-blade grounding-type plugs to two-slot receptacles . The grounding lug extending from the adapter must be connected to a permanent ground such as a properly grounded outlet box . The adapter should not be used if a three-slot grounded receptacle is available .

DO NOT DEFEAT THE SAFETY PURPOSE OF THE GROUNDED PLUG .

**⚠️WARNING:** It is normal for the power cord to feel warm to the touch . However, a loose fit between the outlet and the plug may cause overheating of the plug . If this occurs, try inserting the plug into a different outlet . Contact a qualified electrician to inspect the original outlet for damage .

## Specifications

Voltage Rating— 120 V (60 Hz)

Power Consumption —1,500 W

Unit Size —13 .5 in . (W) x 7 .8 in . (D) x 33 .8 in . (H)

Unit Weight —25 .5 lbs.

## FREQUENTLY ASKED QUESTIONS

Please review these frequently asked questions on the next few pages prior to using your heater .

### **Q. My unit emits a strange odor when I first open the box and when I turn it on for the first time. Why is this happening?**

**A .** This is normal . This unit is treated with a special heat safe/resistant coating . This odor will sometimes be present when the box is opened . When the coating is exposed to heat, it produces this particular odor during the first few hours of operation . This will dissipate after the break-in period . If you are sensitive to odors, you may want to pre-burn the unit in a garage with the door open until the initial odor dissipates .

### **Q. If my unit runs on its max wattage setting, how many BTUs is that?**

**A.** This unit is intended to be used as supplemental heat in areas most needed . It may take several minutes to several hours to heat your area, depending on various factors . The below chart provides BTU translations for different wattages .

#### **WATTAGE**

1,500

1,000

750

500

#### **BTUS**

5,118

3,412

2,559

1,706

### **Q. Can the heating elements be replaced?**

**A.** Replacement heating elements can be obtained from the manufacturer . All parts may be purchased through the manufacturer if your product is out of warranty . If you feel that the elements are definitely faulty right out of the box, contact Customer Support . A representative can then direct you to the next step .

### **Q. Once I plug the unit in and turn it on, how long will it take to heat my room?**

**A.** The heating process in the heater begins immediately upon powering on and setting the desired temperature above the ambient temperature . A noticeable change in the ambient temperature of the room will vary due to variables such as the location of the heater (in the home), floor plan and size of the room, how well the room is insulated, how many doors/windows, how much bare concrete (acts as a heat sink with any type of heating), the

opening and closing of an exterior door, long hallways, high ceilings, etc . Customers with smaller rooms experience quick heat changes . Rooms with larger and open floor plans can expect up to 24 hours to completely heat up .

**Q. I do not have a grounded outlet. Can I use adapters, a 2-prong power strip, or remove the ground prong from the cord?**

**A.** NO! If you do not have a grounded outlet, contact a certified electrician for advice . Removing or altering any part of the heater's original design or intent (including the power cord) will void the warranty and make you liable for any unexpected or hazardous results .

**Q. The temperature on my unit does not match the temperature display on my wall, or external thermostat. Why?**

**A.** This is completely normal . The temperature display on your unit may vary from the temperature display on another thermostat (like the one mounted to your wall or a purchased external thermostat) . This is because the temperature sensor on the unit reads the temperature directly around the unit . With the unit near the cold floor (and heat rising), any readings on elevated or external thermostats will differ in readings on the unit . The best way to operate your unit is to set the unit on High and dial up to a temperature that feels comfortable to you . Then, leave it at that temperature, regardless of the mismatch . The unit will cycle off when the set temperature is met or exceeded slightly .

**Q. Can I use more than one heater at a time? Can I use the heater and another appliance at the same time?**

**A.** Yes, but make sure they are not plugged into the same circuit . Each heater requires its own minimum 15amp circuit with no other items plugged into that circuit or outlet . This is because heaters are considered appliances and draw out high amperage . If you are unsure your circuit meets these requirements, verify with a certified electrician .

 **WARNING:** Risk of fire, damage to property, or injury may result if requirements are not met .

**Q. Why does my units fan continue to run after the set temperature is reached or the power is turned off?**

**A.** This is normal . The heater's fan will continue to run even after the unit automatically cycles down . The fan continues to run so that every last bit of heat is blown out of the heat chamber while allowing the unit to continue filtering your air . Once the internal box/components cool completely, the fan should then shut off on its own . In this case, allow a few minutes after the heat cycles off (with power on) . The fan will shut off faster when the power is turned off .

**Q. My units power cord gets warm. My cord is showing signs of heat or melting at the outlet. Is this normal?**

**A.** A warm power cord is normal . These power cords are rated safe for up to 105°C/ 221°F by the UL, CSA, or ETL . The exception is, if you detect heat, smoke, or signs of melting at the contact point of the wall outlet, it may be due to loose or worn wall contacts (or arcing) . Please stop using the heater immediately, contact warranty support for a replacement power cord, and have a certified electrician replace the wall outlet as soon as possible .

**Q. What kind of water should I use to fill my humidifier?**

**A:** Use only potable (drinkable) water . Distilled or de-mineralized water is best as it has less mineral content than regular tap water . When used, these water types make your humidifier less likely to expel white mineral dust into your indoor air and less likely for that dust to invade your lungs . This will also help reduce the amount of mineral build up on the front of the unit .

**Q. There is an unpleasant odor coming from the humidifier. How do I condition the water?**

**A:** If an unpleasant odor is detected, a quick conditioning of the water tank should correct the issue . With the unit off and unplugged, completely drain the water tank (see Care & Maintenance section) . Fill the tank with 1 gallon of drinkable water and add 3 to 5 drops of unscented chlorine bleach to the full water tank .



**Q. Can the unit be left outdoors?**

**A.** It is not recommended to leave your unit outside when it is not being used . (Think of it like a portable stereo – you can use it outdoors, but not recommended to leave outdoors .)

**Q. Does ice water make it colder?**

**A.** Water temperature does not noticeably impact the cooling performance .

**Q. What happens if the unit runs out of water?**

**A.** If the unit runs out of water, the misting icon on the control panel will blink, and the unit will simply stop humidifying the water . No harm will be done by operating the unit without water .

**Q. Should there be a certain amount of space around the unit?**

**A.** Yes, there should be 3 feet of space in front of the port .

**PREPARATION**

Place the unit on a firm, level surface and plug into a grounded 120 V, 60 Hz power outlet . Only operate the unit in upright position . Insert two AAA batteries into the remote control before using (batteries not included) . \*(Not all products will include a remote control .)

Please note that infrared heaters do not heat like a traditional space heater . You should not expect infrared heaters to blow hot air like a traditional space heater . Infrared heaters heat objects not air . Infrared heaters are intended to supplement an already heated, insulated room . Square footage specifications assume a single enclosed room not an entire home . Infrared heaters do not heat through walls, floors, and are not intended to replace a main heat source . Infrared heat can take at least 24 hours to warm a room but operate much more efficiently to maintain the desired temperature . Infrared heaters will not work well in uninsulated unheated spaces like screened in porches, RV's, garages, unheated basements, etc.

**TROUBLESHOOTING**



PROBLEM	POSSIBLE CAUSE	CORRECTIVE ACTION
The unit does not turn on.	<ol style="list-style-type: none"> <li>1. The power cord is not plugged in.</li> <li>2. The electricity at the main fuse box is not working.</li> <li>3. The battery in the remote control is dead.</li> <li>4. The thermostat on the heater is set lower than the room temperature.</li> </ol>	<ol style="list-style-type: none"> <li>1. Plug the power cord into an electrical outlet.</li> <li>2. Check the electricity at the main fuse box.</li> <li>3. Replace the batteries in the remote control.</li> <li>4. Increase the thermostat temperature on the heater for a higher heat setting.</li> </ol>
The unit displays an error code "E1"	<ol style="list-style-type: none"> <li>1. The heater has overheated.</li> <li>2. Insufficient power to the unit</li> <li>3. The air filter is clogged.</li> <li>4. Insufficient air flow to the heater.</li> </ol>	<ol style="list-style-type: none"> <li>1. Unplug the heater from the wall and sides, wait a few seconds then plug the power cord back in.</li> <li>2. Make sure the unit is plugged into a dedicated 3-prong outlet, with no extension cords or surge protectors.</li> <li>3. Clean the air filter located on the back of the unit. see page 13.</li> <li>4. Move the unit at least 3ft from the wall.</li> </ol>
The unit displays an error code "E2"	<ol style="list-style-type: none"> <li>1. Temperature sensor not functioning properly.</li> </ol>	<ol style="list-style-type: none"> <li>1. Please contact technical support.</li> </ol>
The units won't mist and mist indicator light is flashing	<ol style="list-style-type: none"> <li>1. Water tank is empty or not enough water in the water tank</li> </ol>	<ol style="list-style-type: none"> <li>1. Add additional water to the tank.</li> </ol>

## CONTROL PANEL

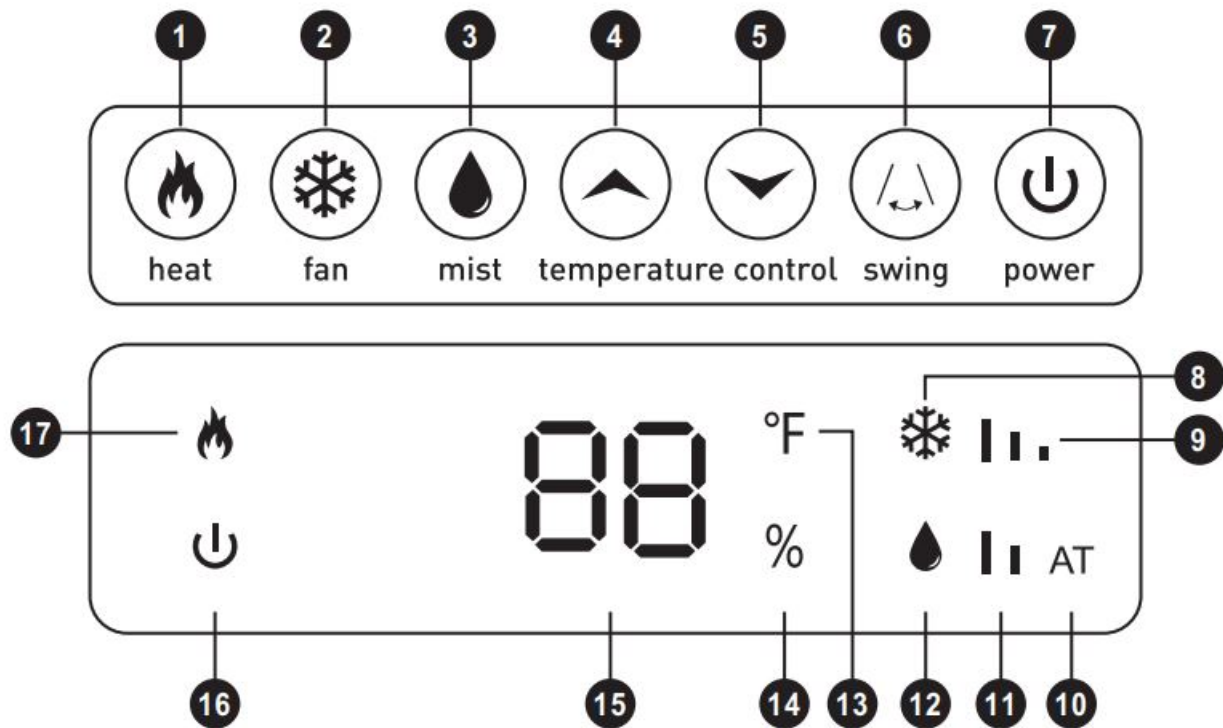

PART	NAME	DESCRIPTION
1	Heat Button	Engages the heating function
2	Fan Button	Cycles the Fan function between High/Medium/Low mode
3	Mist Button	Cycles the mist function between High/Low/Auto mode
4	Temp-Up Button	Increase the set temperature
5	Temp-Down Button	Decrease the set temperature
6	Swing Button	Activate/Deactivate oscillation function
7	Power Switch Button	Powers the unit ON or OFF
8	Fan Indicator	Indicates when the fan function is engaged
9	Fan Mode Indicator	Indicates fan speed setting between High/Medium/Low modes
10	Auto Mist Mode	Indicates when the misting mode is set to Auto
11	Mist Mode Indicator	Indicates when the misting mode is High/Low
12	Mist Indicator	Indicates when the misting function is engaged
13	Set Degree Indicator	Indicates temperature in Fahrenheit
14	Temp/Humidity Indicator	Indicates the set temp and room humidity in turn
15	Digital Display	Readout of the set room temperature or humidity value
16	Power Indicator	Indicates when the unit is receiving power from the wall outlet
17	Heating Indicator	Indicates when the heating function is engaged

REMOTE CONTROL

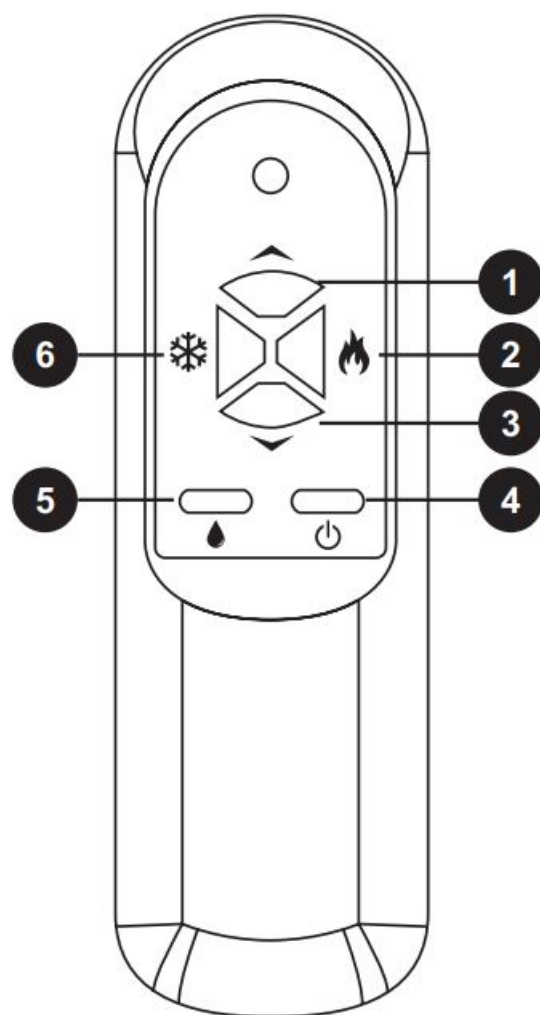

PART	NAME	DESCRIPTION
1	Temp Up Button	Increases the set temperature value
2	Heat Mode Button	Engages the heating function
3	Temp Down Button	Decreases the set temperature value
4	Power Button	Powers the heater on or off
5	Mist Button	Cycles the mist function between High / Low / Auto
6	Fan Button	Cycles the Fan function between High / Medium / Low mode

OPERATING INSTRUCTIONS

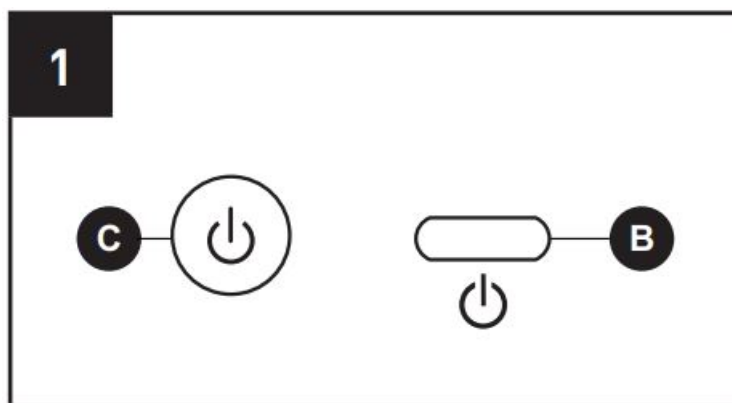

1 . Turn the unit on or off by pressing the Power button on the control panel (C) or by pressing the Power button on the remote control (B) .

Once the power is off, in heating mode, the heating elements will stop working first . The fan will continue working for up to 90 seconds to dispense residual heat inside the heater . This is a normal function .

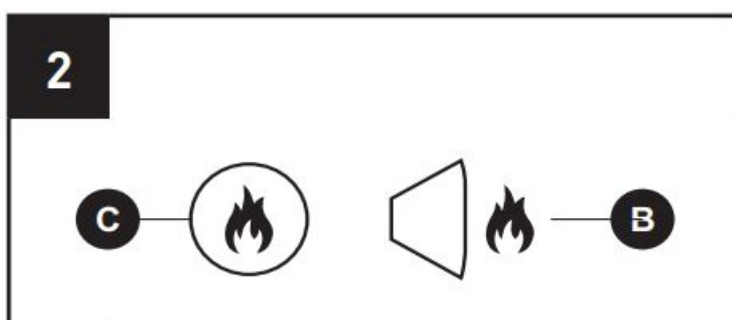

2 . Select a heat setting by pressing the heat mode button on either the control panel (C) or the remote control (B) . Power for High is 1,500 W .

**Note:** Set temp must be higher than room temp .

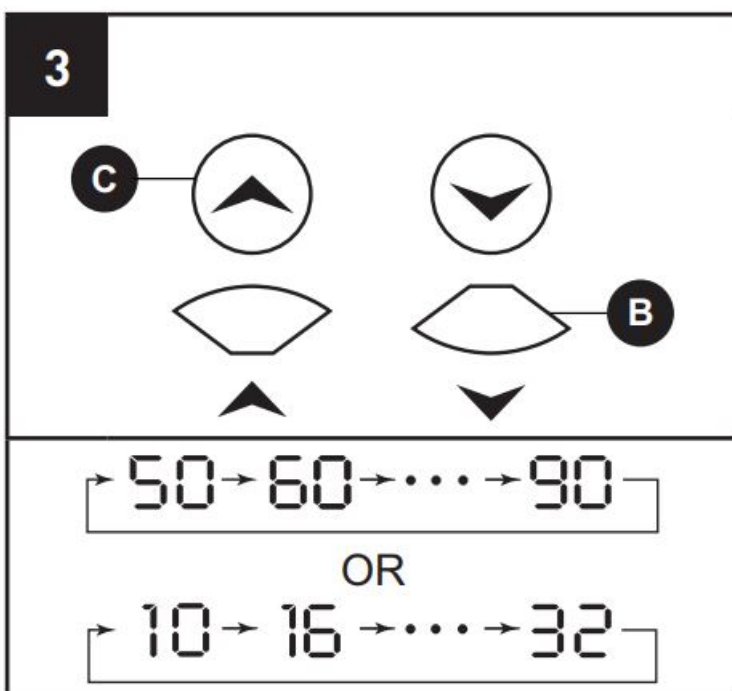

3 . Set the temperature by pressing the arrows on the control panel (C) or the remote control (B) .  
 You can set the temperature on the heater anywhere between 50°F and 90°F or between 10°C and 32°C . Once  
 you have chosen the desired temperature, the heater will remain on until the room temperature increases to the  
 temperature on the digital display . The heater will cycle on and off to maintain the desired room temperature .

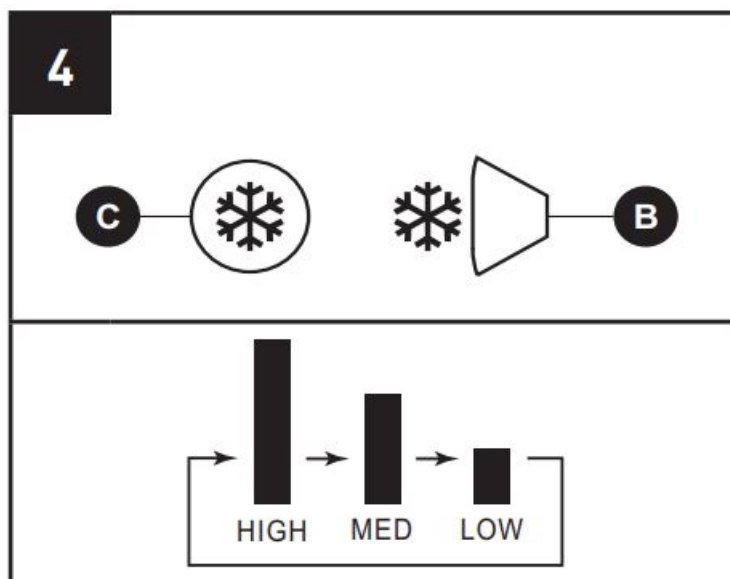

4 . To activate the Fan function press the Fan mode button on the control panel (C) or the Fan mode button on the  
 remote control (B) to toggle between the three fan settings high, medium and low .

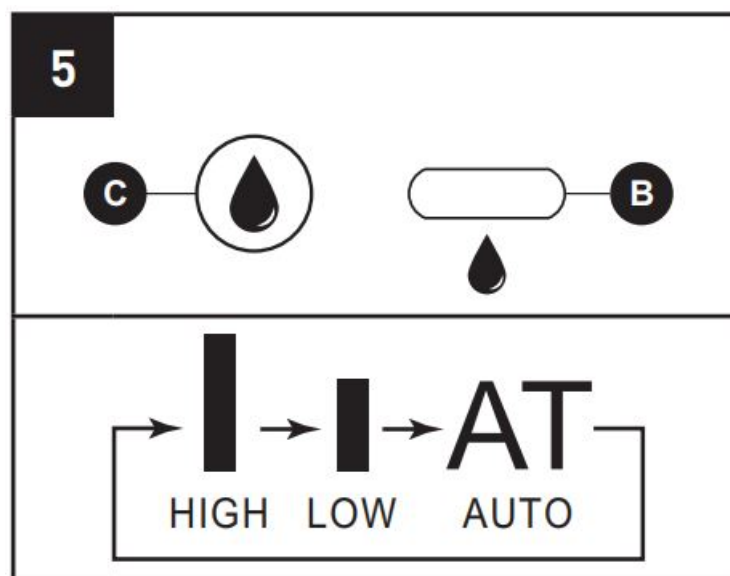

5 . To activate the Mist function press the Mist mode button on the control panel (C) or the Fan mode button on the  
 remote control (B) to toggle between the three mist settings high, low and auto which maintains a relative humidity  
 level of approximately 40%-60% .

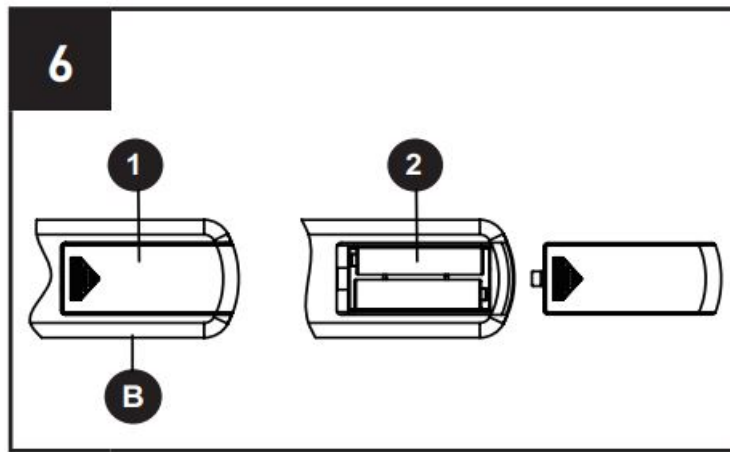

6 . To replace the batteries, remove the battery cover (1) from the remote (B) by applying pressure to the battery cover (1) and sliding it away from the remote (B) . Insert two AAA batteries (not included) (2) and close the remote by placing the battery cover (1) back on the remote (B) .

**Note:** Do not mix old and new batteries . Do not mix alkaline, standard (carbon-zinc), or rechargeable (NiCad, Ni-MH, etc.) batteries .

## CARE AND MAINTENANCE

**⚠ WARNING:** Before performing any maintenance task, unplug the unit, and allow it to cool completely .

1. To keep the unit clean, clean the outer shell with a soft, damp cloth . Use a mild detergent if necessary . After cleaning, dry the unit with a soft cloth .
2. Clean the humidifier tank using a soft-bristled brush and a mild cleanser when cleaning out the inside of your unit's water tank . Wipe down the exterior with a clean, damp cloth . Wait for all components to dry completely before filling with fresh water and turning on .

**CAUTION:** DO NOT let liquid enter any part of the unit other than inside the water tank .

3. DO NOT use alcohol, gasoline, abrasive powders, furniture polish, or rough brushes to clean the unit . This may cause damage or deterioration to the surface of the unit .
4. DO NOT immerse the unit in water .
5. Wait until the unit is completely dry before use .
6. If you will not be using the unit for a while, take the batteries out of the remote control and store for future use .
7. Before storing the unit, ensure that the water tank has been emptied .
8. Store the unit in a cool, dry location when not in use . To prevent dust and dirt build-up, use the original packaging to repack the unit .

## CLEANING THE AIR FILTER

1. Clean the air filter (2) after three months or if it appears to be blocking airflow . With the unit unplugged, remove the two filter screws (1) as illustrated below . Clean all parts of the filter assembly and allow parts to completely dry .
2. Reassemble and reinstall the filter (2) .

**WARNING:** Do not use the unit without the filter assembly in place .



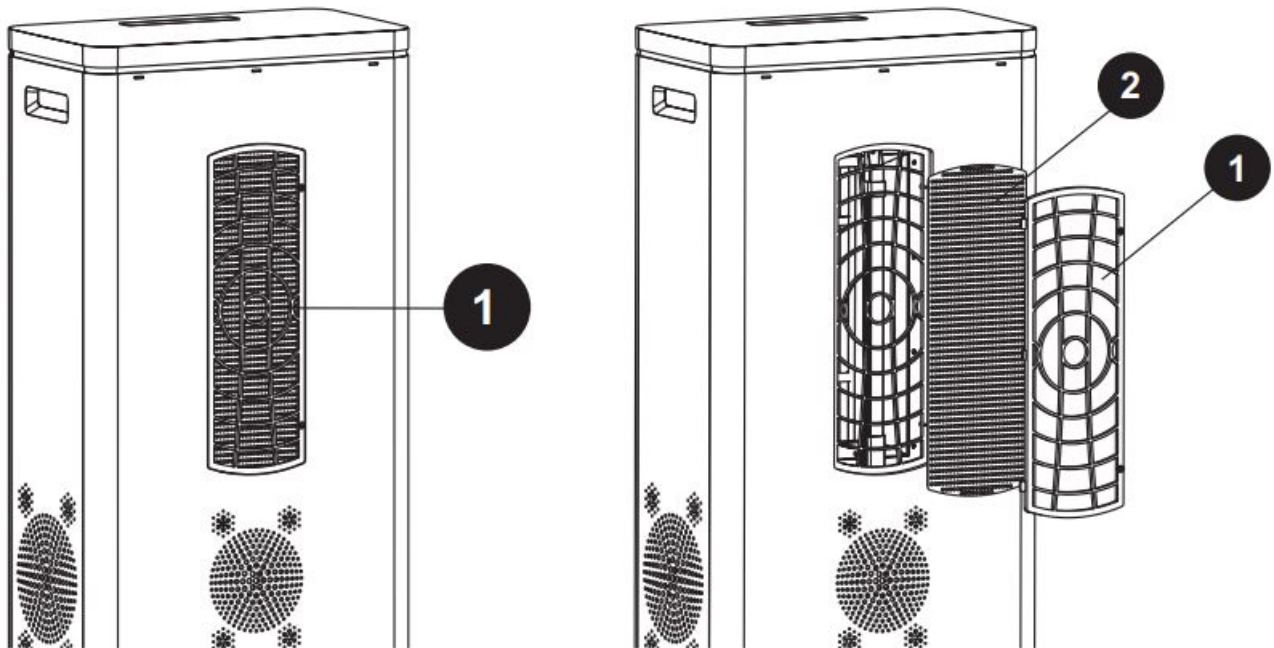

### ADDING WATER TO THE WATER TANK

1. While the unit is off and unplugged, press the level located in the handle of the water tank on the back of the unit .
2. Unscrew the top cap by turning counter-clockwise, and add 1 gallon of distilled water . DO NOT OVER FILL THE TANK . Replace the top cap and gently tighten . DO NOT OVER TIGHTEN THE CAP .
3. Carefully replace the water tank into the unit by aligning the two tabs along the bottom opening and locking it securely in place .

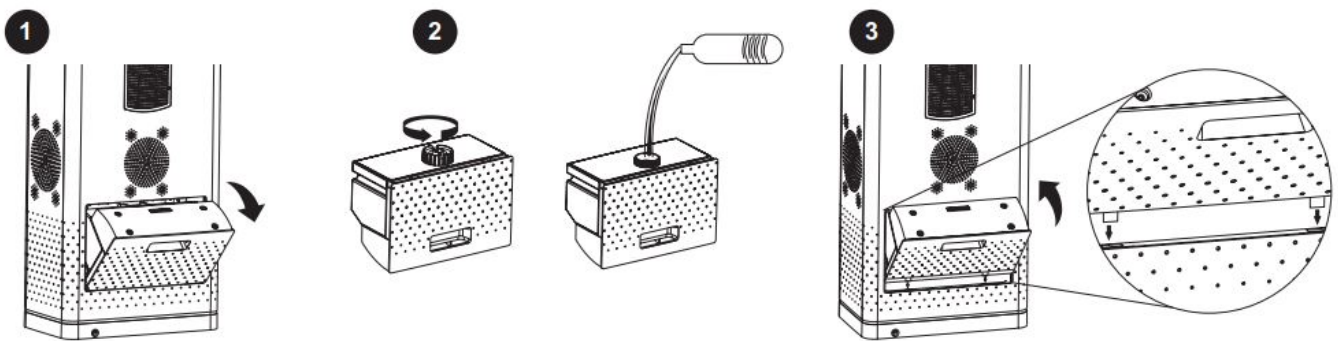

### ONE-YEAR LIMITED WARRANTY

The manufacturer warrants this heater against defects in materials and workmanship on functional parts, for a period of 1 year from the original date of purchase . Your sales receipt showing the date of purchase of the product is your proof of purchase . Keep it in a safe place for future reference . This warranty is subject to personal use only, commercial or rental applications will not be covered .

This product is made with the highest quality materials and is warranted to be free from defects in materials and workmanship at the time of purchase . This limited warranty applies to products manufactured or distributed by the manufacturer, are delivered in the continental United States or Canada and extends to the original purchaser, or gift recipient . This warranty becomes valid at the time of purchase and terminates either by the specified time



frame listed above and/or owner transfer . Any refunds or monetary compensations must be claimed through the place of purchase (retailer), and not through the manufacturer . Any extended warranties (warranties that cover above and beyond this manufacturer warranty) that are sold through a retailer or third party, are not directly correlated with this products' limited warranty, and may be redirected to said retailer or third party for coverage .

This warranty extends through the manufacturer of the product, and covers functional parts only . Cosmetics are not covered, unless unequivocally determined it is a workmanship defect . Shipping damage should be addressed with the shipping company, retailer, or place of purchase, not the manufacturer unless the manufacturer was the direct shipper .

The manufacturer's sole obligation under this warranty shall be limited to furnishing the original purchaser replacement parts for units deemed repairable by the supplier's warranty department . The purchaser is responsible for insuring any parts shipped or returned, if desired . The purchaser is responsible to prepay any shipping charges (both ways) including, but not limited to taxes and duties . All exchanged parts and products replaced under this warranty will become the property of manufacturer . The manufacturer reserves the right to change manufacturers of replacement parts or products for use, in order to cover any existing warranty .

The purchaser may be asked to provide the supplier with proof of purchase documents (including the date of purchase) if requested . Any evidence of alteration, erasing, or forgery of proof of purchase documents will be just cause to VOID this limited warranty . Products, in which the serial number has been defaced or removed are not eligible for warranty coverage .

This warranty does not apply if the unit has been subject to negligence, fabrication, misuse, abuse, or repairs, alteration by non-manufacturer authorized personnel, inappropriate installations, or any case beyond the control of the manufacturer . Examples of warranty invalidation may also include, but are not limited to:

- Use of lacquer or paints in (and around) the heaters
- Heater placed on non-approved surfaces
- Electrical requirement deficiencies (15-20 amp dedicated outlet)
- Use on extension cords/timers/surge protectors/GFCI
- Outdoor applications
- Normal wear/tear/weathering
- Pet/consumer accidents

The manufacturer shall not be liable for any loss due to use (or misuse) of the heater or other incidental or consequential costs, expense or damages without irrefutable foundations . Under no circumstances shall the manufacturer or any of its representatives be held liable for injury to any person or damage to any property, however arising . Any implied warranty shall have duration equal of the applicable warranty stated above . Specifications are subject to change without notice or obligation .

This limited warranty gives the original purchaser specific legal rights . Other rights may vary from state to state .

## **REPLACEMENT PARTS LIST**

For replacement parts, call our technical support department at 657-341-0362, 9:00 a.m. – 5 p.m., PST, Monday – Friday

PART	DESCRIPTION	PART #
A	Control panel	COPA-MCAC
B	Fan	FAN-MCAC
C	Power board	POBO-MCAC
D	Tip-over switch	TIPSW
E	Limit switch	LIMITSW
F	Infrared tube	QUAR-R750
G	Thermostat Wire	SENSOR
H	Remote control	REMO-MCAC
I	Water Atomizer	MIST-MCAC

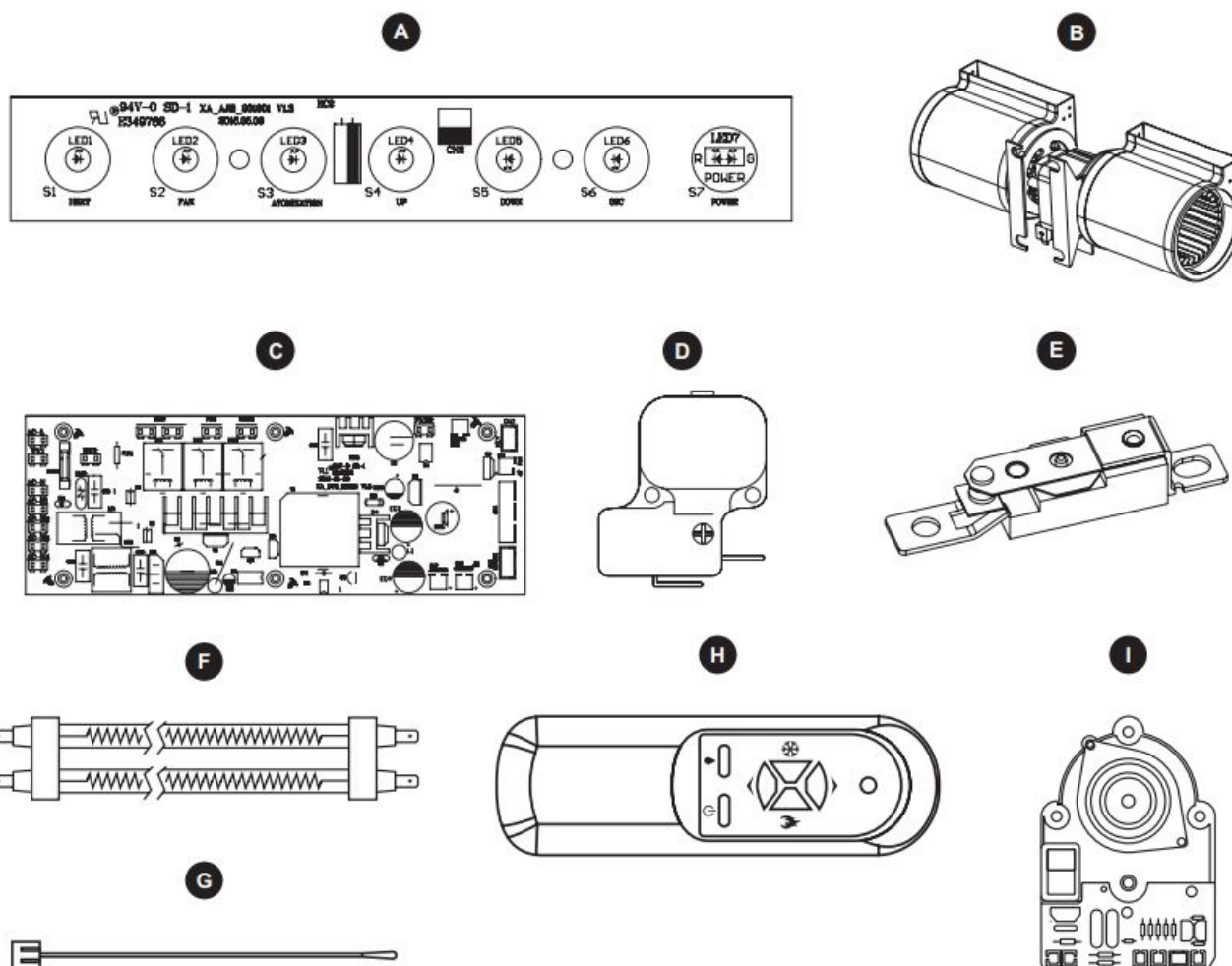

PLEASE REMEMBER TO REGISTER YOUR WARRANTY:

web: [www.lifessmartcomfort.com](http://www.lifessmartcomfort.com)

email: [cs@scsources.com](mailto:cs@scsources.com)

LifeSmart® is a registered trademark  
of Supply Chain Sources, LLC., All Rights Reserved.

## Documents / Resources

 <p>life:smart INFRARED QUARTZ HEATER &amp; MULTIFUNCTION TOWER Product Series: QF, QF1000 Series Model: QF1000, QF1000S 1000W, 1000S, 1000S2</p> <p>ATTENTION: READ CAREFULLY Please read this manual carefully before using the product. Please read this manual carefully before using the product. Please read this manual carefully before using the product.</p> <p>life:smart</p>	<p><a href="#">life smart Infrared Quartz Heater Multi Function Tower</a> [pdf] User Manual Infrared Quartz Heater Multi Function Tower, XXAC3004US, XXAC3012US</p>
---	---

## References

- [🌐 Lifesmart Products – Smart, Simple, Innovative Products for the Home](#)