



## Libratone Classic Loop Wi-Fi/PlayDirect User Manual

[Home](#) » [Support](#) » Libratone Classic Loop Wi-Fi/PlayDirect User Manual 

### Contents

- [1 Libratone Classic Loop Wi-Fi/PlayDirect](#)
- [2 QUICK GUIDE](#)
- [3 CUSTOMIZE YOUR AUDIO EXPERIENCE WITH THE LIBRATONE APP](#)
- [4 QUICK AIRPLAY SETUP](#)
- [5 QUICK BLUETOOTH SETUP](#)
- [6 QUICK DLNA SETUP](#)
- [7 DOWNLOAD](#)
- [8 References](#)
- [9 Related Posts](#)

**Libratone Classic Loop Wi-Fi/PlayDirect**



## **USER MANUAL**

### **QUICK GUIDE**

- LIBRATONE LOOP
- AIRPLAY
- BLUETOOTH
- DLNA

### **CUSTOMIZE YOUR AUDIO EXPERIENCE WITH THE LIBRATONE APP**

Download the free Libratone App to customize your FullRoom™ experience with Libratone speakers. Provide it with information on the placement of your sound system and the app automatically adjusts the settings on your Libratone speakers to match the specifications of the room.

Go get it at App Store or Google Play.

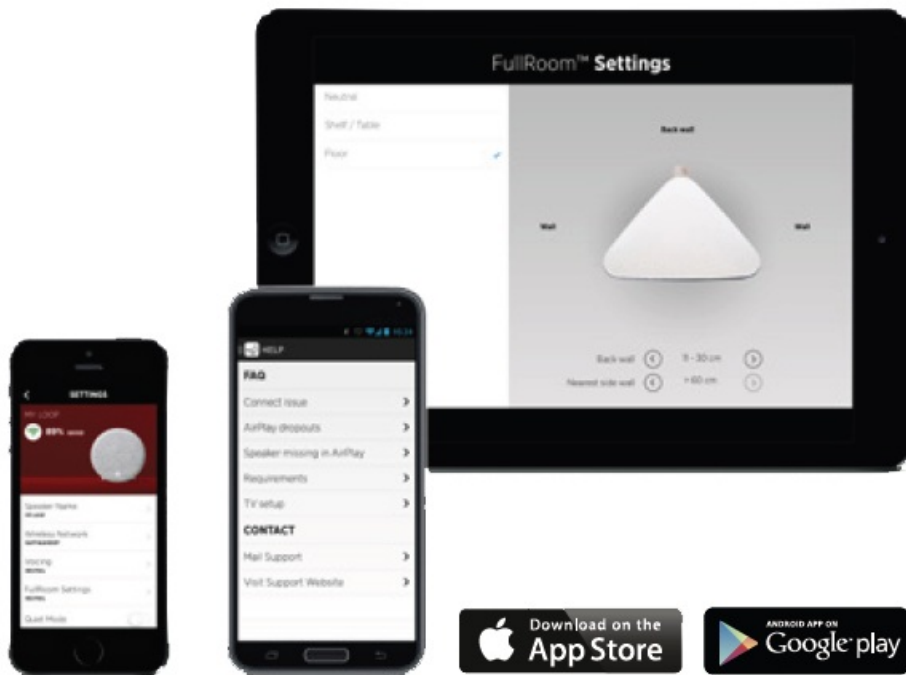

## QUICK AIRPLAY SETUP

iOS 7 or later

Full manual and warranty sheet on [libratone.com](http://libratone.com)

1. Press the Logo Button to turn speaker on.

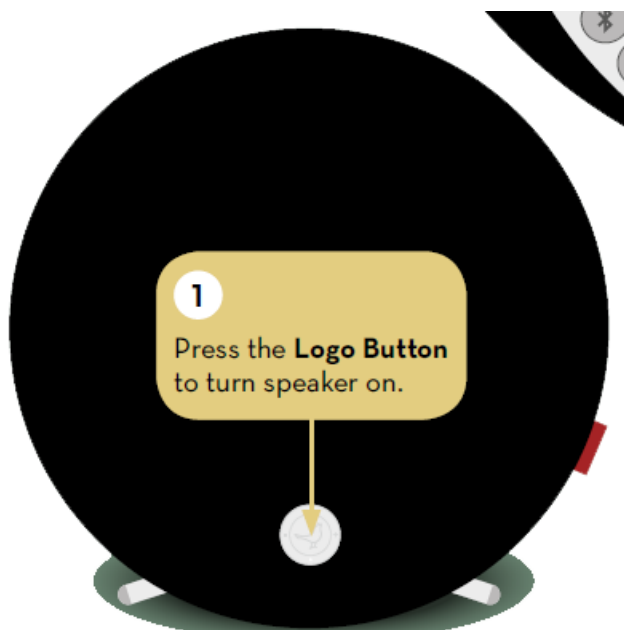

2. Connect your speaker and iOS device with a USB cable.

3. Press both buttons simultaneously for “Share Wi-Fi Settings?” to pop up.

4. Press “Allow” and wait for the speaker to restart. Remove cable afterwards.

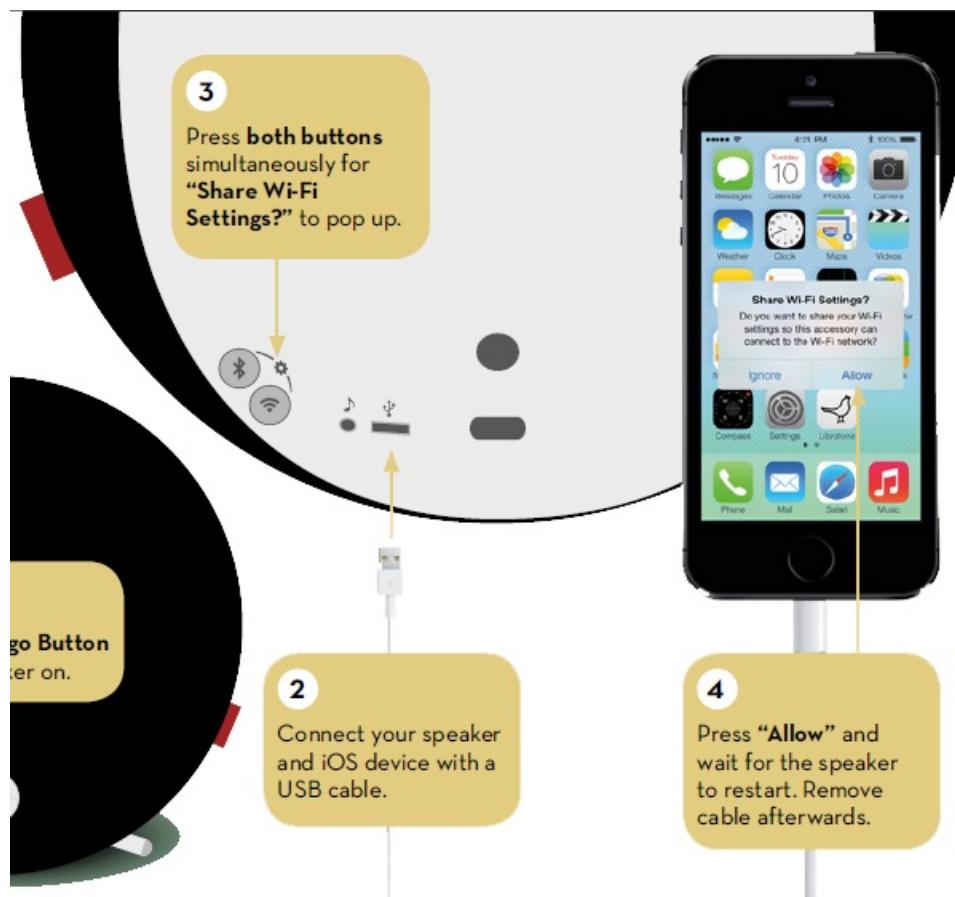

5. Swipe up from the bottom of the display to enter “Control Center” and press “AirPlay”.

6. Choose your speaker

7. Choose your favorite music player and set your music free!



5

Swipe up from the bottom of the display to enter "Control Center" and press "AirPlay".



6

Choose your speaker.



7

Choose your favorite music player and set your music free!

## FREE COVER

Register your speaker on [libratone.com/freecover](http://libratone.com/freecover) and get a free cover in your favorite color.



## FREE COVER

Register your speaker on [libratone.com/freecover](http://libratone.com/freecover) and get a **free cover** in your favorite color.

## QUICK BLUETOOTH SETUP

## Bluetooth® devices

Full manual and warranty sheet on [libratone.com](http://libratone.com)

1. Press the Logo Button to turn speaker on.
2. Press and hold the Bluetooth Button for two seconds until the Logo Button emits a blue sequence.
3. Unlock your NFC (Near Field Communication) phone or tablet and hover over the Logo Button ...



4. ... OR connect to the speaker through the "Bluetooth settings" menu.
5. Choose your favorite music player and set your music free!



4

... OR connect to the speaker through the "Bluetooth settings" menu.

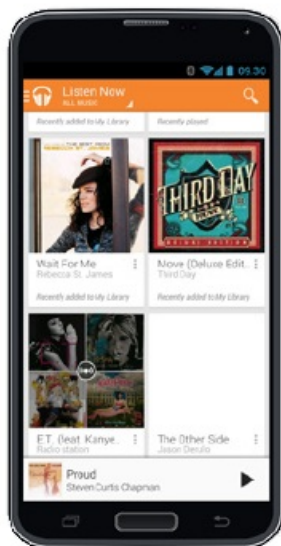

5

Choose your favorite music player and set your music free!

## FREE COVER

Register your speaker on [libratone.com/freecover](http://libratone.com/freecover) and get a free cover in your favorite color.



### FREE COVER

Register your speaker on [libratone.com/freecover](http://libratone.com/freecover) and get a **free cover** in your favorite color.

## QUICK DLNA SETUP

Full manual and warranty sheet on [libratone.com](http://libratone.com)

1. Press the Logo Button to turn the speaker on.
2. Press and hold the Wi-Fi button for two seconds until the Logo Button pulses white. When it emits a white sequence (takes up to 20 seconds) it's ready.

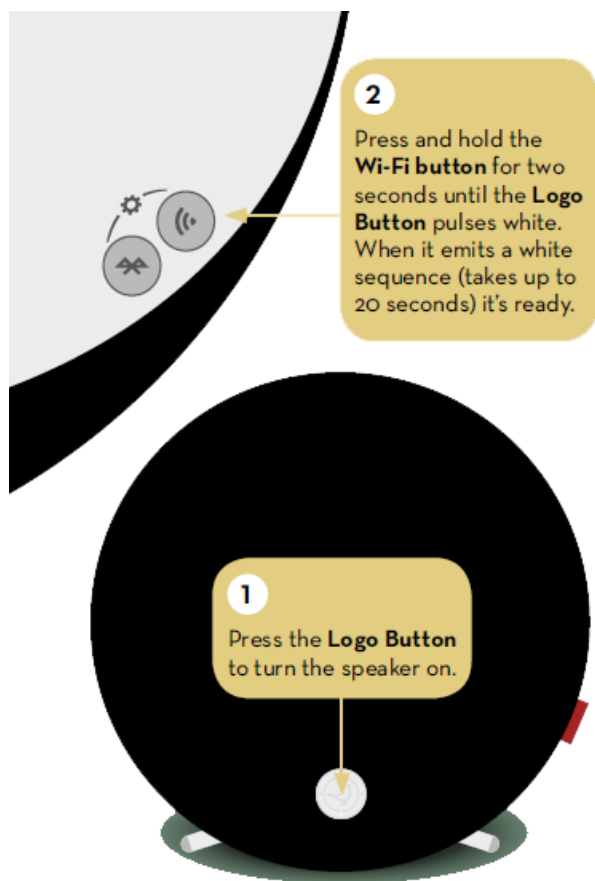

3. Open "Wi-Fi settings" and connect to the speaker's network.
4. Open a browser and type "192.168.1.1" and follow the Wi-Fi setup instructions.
5. Wait for your speaker to restart. The Logo Button breathes white when ready.
6. Open a DLNA MusicPlayer. Select your speaker and press play to set your music free.





3

Open "Wi-Fi settings" and connect to the speaker's network.



4

Open a browser and type "192.168.1.1" and follow the Wi-Fi setup instructions.

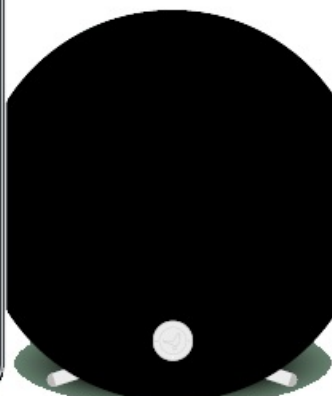

5

Wait for your speaker to restart. The **Logo Button** breathes white when ready.

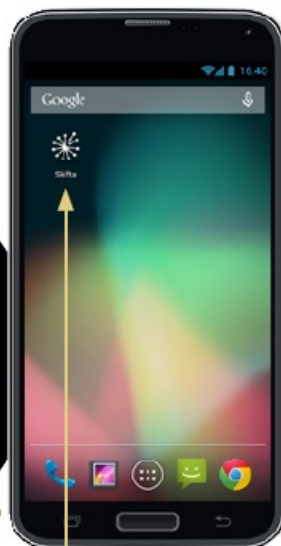

6

Open a DLNA Music Player. Select your speaker and press play to set your music free.

## FREE COVER

Register your speaker on [libratone.com/freecover](http://libratone.com/freecover) and get a free cover in your favorite color.



### FREE COVER

Register your speaker on [libratone.com/freecover](http://libratone.com/freecover) and get a **free cover** in your favorite color.

## DOWNLOAD

Libratone Classic Loop Wi-Fi/PlayDirect Quick Start Guide- [[Download PDF](#)]

Libratone Classic Loop Wi-Fi/PlayDirect User Manual – [[Download PDF](#)]

---

## References

- [User Manual](#)

[Manuals+](#), [Privacy Policy](#)

This website is an independent publication and is neither affiliated with nor endorsed by any of the trademark owners. The "Bluetooth®" word mark and logos are registered trademarks owned by Bluetooth SIG, Inc. The "Wi-Fi®" word mark and logos are registered trademarks owned by the Wi-Fi Alliance. Any use of these marks on this website does not imply any affiliation with or endorsement.