

Liberty Pumps
GR30-C
Series
Guide Rail
Systems



Liberty Pumps GR30-C Series Guide Rail Systems Installation Guide

[Home](#) » [Liberty Pumps](#) » Liberty Pumps GR30-C Series Guide Rail Systems Installation Guide 

Contents

- [1 Liberty Pumps GR30-C Series Guide Rail Systems](#)
- [2 Product Specifications](#)
- [3 Product Usage Instructions](#)
- [4 Models](#)
- [5 Features](#)
- [6 GR30-C-Series Assembly](#)
- [7 Base Mounting Template](#)
- [8 About Company](#)
- [9 Frequently Asked Questions \(FAQ\)](#)
- [10 Documents / Resources](#)
 - [10.1 References](#)
- [11 Related Posts](#)



Liberty Pumps GR30-C Series Guide Rail Systems



Product Specifications

- **Model:** GR30-C-Series 3 Pump Disconnect for Ordinary Locations
- **Manufacturer:** Liberty Pumps
- **Material:** Galvanized or stainless steel
- **Recommended Pipe Size:** 1-1/4 inches

Product Usage Instructions

Assembly

1. Insert the upper rail support bracket into the guide rail pipe and secure it at the top of the vault structure.
2. Mount the claw onto the pump discharge using the supplied bolts.
3. Insert the grommet into the mounting claw, ensuring it is tightened adequately but not over-tightened.

Installation

1. Mount the base to the floor of the tank following the Base Mounting Template measurements. Secure it with recommended bolts.
2. When mounting to a concrete surface, use appropriate thread wedge anchors for secure installation.

Maintenance

Regularly check the tightness of all connections and ensure proper lubrication of moving parts for smooth operation.

Models

GR30-C-Series 3" Pump Disconnect for Ordinary Locations

- For use with LGV/LGH03, LGV/LGH05, and LGV/LGH07-Series Grinder Pumps
- For use with LSGV/LSGH300 and LSGV/LSGH500-Series Grinder Pumps

Features

- Heavy-duty cast iron construction
- Accommodates single 1-1/4" guide pipe and 3" discharge pipe
- Auto-alignment feature
- Upper rail support bracket
- Includes sealing grommet

GR30-C-Series Assembly

The GR30-C-Series quick pump disconnect assembly is designed to allow easy installation and removal of the pump. When installed correctly, the guide rail assembly creates a tight discharge seal and provides a means to lift the pump without disconnecting any of the discharge piping. Ensure that installation is done per instructions.

The guide rail system consists of three parts: Upper Rail Support Bracket, Mounting Claw, and Base.

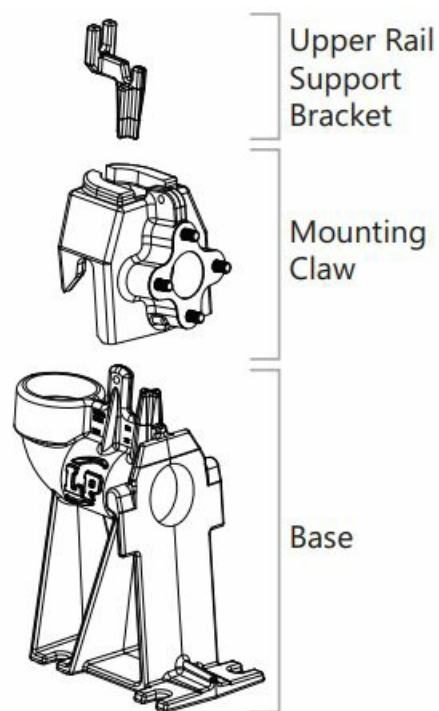

Installation

1. Mount the base to the floor of the tank, referring to the Base Mounting Template measurements. Secure the base to the basin floor at the base slots with 1/2" bolts (stainless steel recommended). When mounting to a concrete surface, use 1/2" or 5/8" (14 or 16 mm) thread wedge anchors.

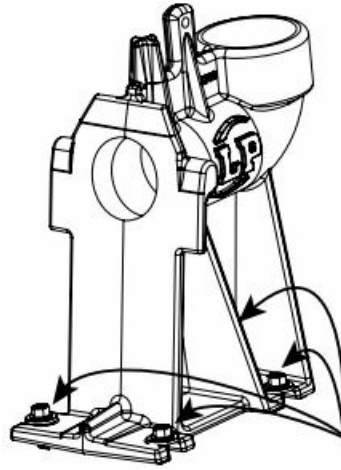

2. Using supplied bolts, mount the claw onto the pump discharge.

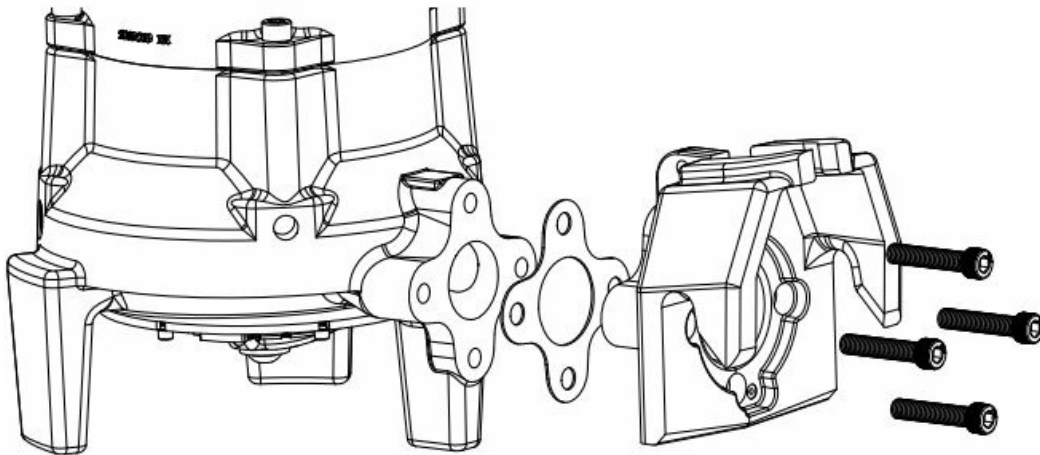

3. Insert grommet into mounting claw.

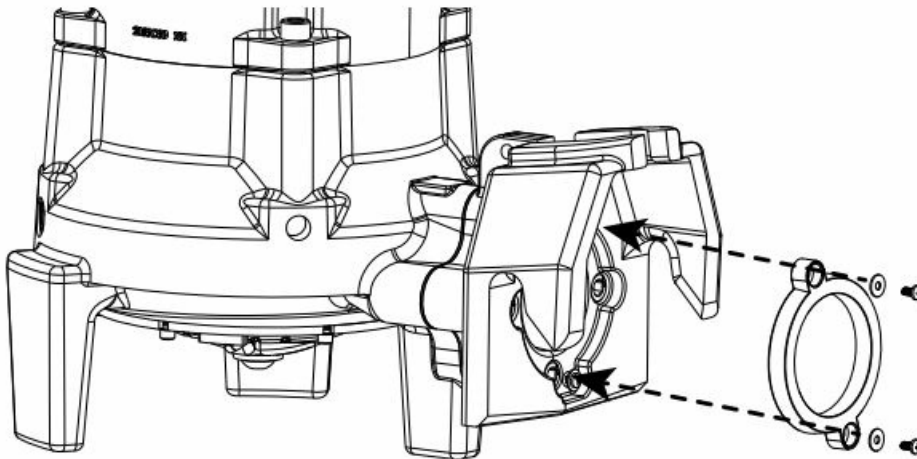

- Tighten until the washer does not spin freely. Do not over-tighten.
- Apply a light amount of sealing grease (provided) to the face of the grommet that sits on the guide rail base.

4. Insert upper rail support bracket into guide rail pipe. Place the upper rail support bracket at top of vault, mounting to secure vault structure. Once installed, tighten upper rail support top nuts.

Pipe is not included; a heavy guide rail pipe of 1-1/4" galvanized or stainless steel is recommended.

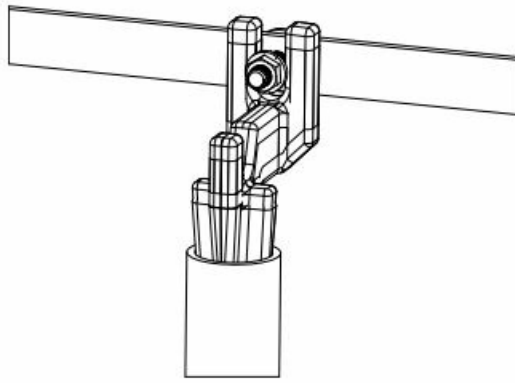

Operation

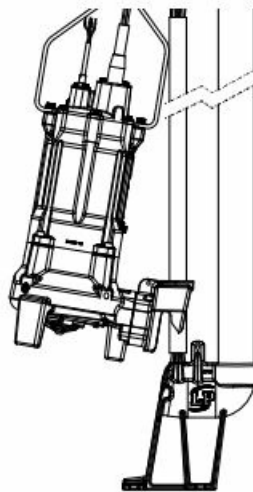

Disconnected view

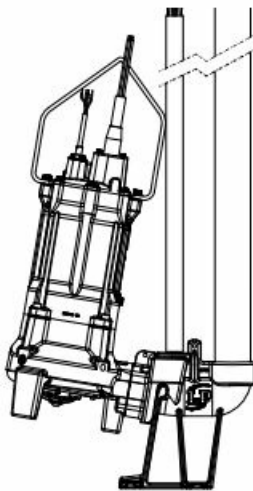

Connected view

Base Mounting Template

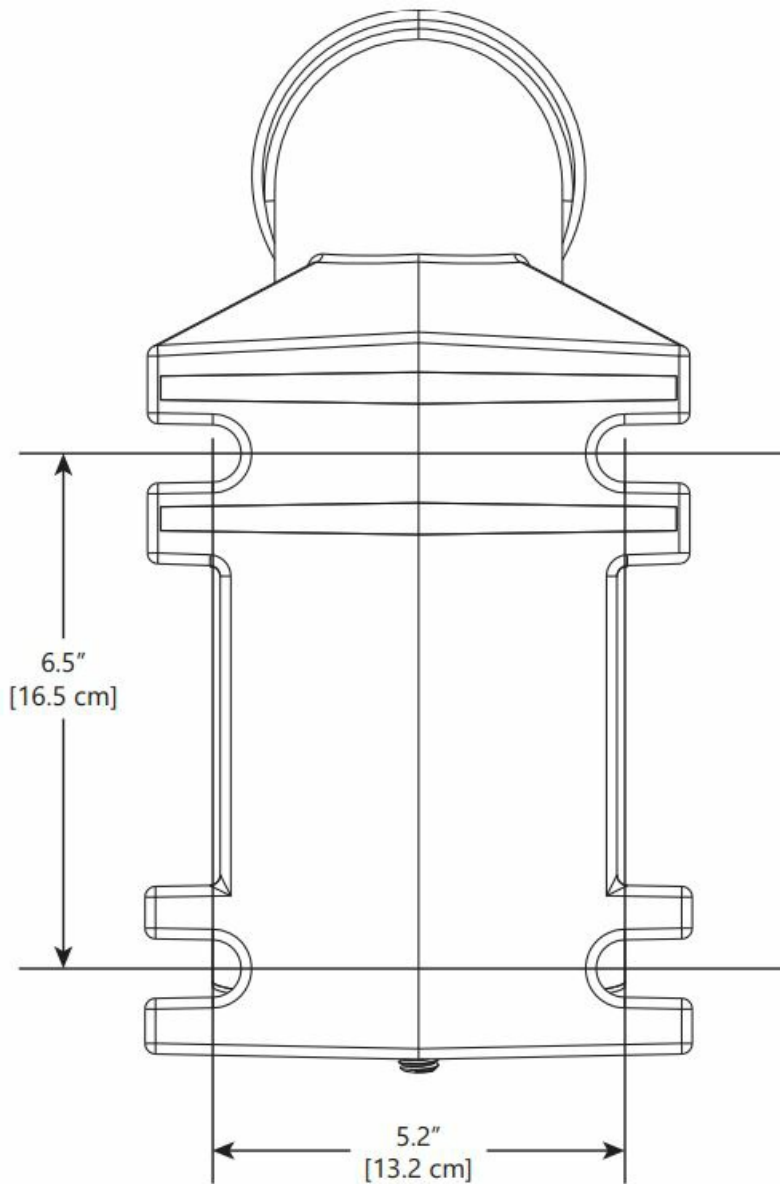

Record information:

Model: _____

Serial: _____

Mfg Date: _____

Install Date: _____

About Company

- 7000 Apple Tree Avenue Bergen, NY 14416
- **ph:** 1-[800-543-2550](tel:8005432550)
- **fax:** 1-[585-494-1839](tel:5854941839)
- www.LibertyPumps.com
- Keep this manual handy for future reference.
- For replacement manual, visit LibertyPumps.com, or contact Liberty Pumps at 1-[800-543-2550](tel:8005432550).
- Retain dated sales receipt for warranty.

Frequently Asked Questions (FAQ)

- **What type of pipe is recommended for the guide rail system?**

A heavy guide rail pipe of 1-1/4 galvanized or stainless steel is recommended for use with the system.

- **How do I obtain a replacement manual or contact customer support?**

For a replacement manual, visit LibertyPumps.com, or contact Liberty Pumps at 1-[800-543-2550](tel:800-543-2550) for customer support.

Documents / Resources

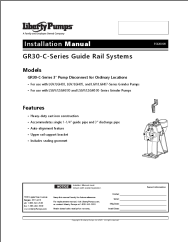
	<p>Liberty Pumps GR30-C Series Guide Rail Systems [pdf] Installation Guide GR30-C Series, GR30-C Series Guide Rail Systems, GR30-C Series, Guide Rail Systems, Rail Systems, Systems</p>
---	--

References

- [LP Landing](#)
- [LP Landing](#)
- [User Manual](#)

Manuals+, Privacy Policy

This website is an independent publication and is neither affiliated with nor endorsed by any of the trademark owners. The "Bluetooth®" word mark and logos are registered trademarks owned by Bluetooth SIG, Inc. The "Wi-Fi®" word mark and logos are registered trademarks owned by the Wi-Fi Alliance. Any use of these marks on this website does not imply any affiliation with or endorsement.