



# LIAN LI O11 Dynamic Razer Edition Tower Gaming Computer Case Installation Guide

[Home](#) » [LIAN LI](#) » LIAN LI O11 Dynamic Razer Edition Tower Gaming Computer Case Installation Guide 

## Contents

[1 LIAN LI O11 Dynamic Razer Edition Tower Gaming Computer Case](#)

[2 Product Information](#)

[3 Key Features:](#)

[3.1 Product Usage Instructions](#)

[3.2 Case components](#)

[3.3 Hardware list](#)

[3.4 Remove top panel](#)

[3.5 Remove side glass & front glass](#)

[3.6 PSU installation](#)

[3.7 Motherboard installation](#)

[3.8 2.5"/3.5" HDD installation](#)

[3.9 2.5"/3.5" HDD installation](#)

[3.10 2.5" HDD installation](#)

[3.11 Remove air filters](#)

[3.12 Cable management](#)

[3.13 Radiator & cooling support](#)

[3.14 Hardware clearance](#)

[3.15 VGA Anti-sag bracket installation](#)

[3.16 Package Content](#)

[3.17 Installation](#)

[4 Documents / Resources](#)

[5 Related Posts](#)





## Product Information

The O11 DYNAMIC is a computer case designed for high-performance systems. It features support for multiple fan sizes, removable HDD trays, and radiator cooling support. The package includes various hardware components for installation, such as screws, stand-off bolts, Velcro for cable management, and additional accessories like a VGA anti-sag bracket and an upright display card kit.

## Key Features:

- Supports 120mm or 140mm fans
- Can accommodate up to 2.5 HDDs
- Removable HDD tray for flexible storage options
- Included screws and stand-off bolts for motherboard and PSU mounting
- Velcro for cable management
- VGA anti-sag bracket for secure mounting of VGA cards
- Radiator and cooling support
- Upright display card kit for vertical GPU installation
- USB 3.0 and HD audio support

## Product Usage Instructions

- **Removing the Top Panel:**
  1. Remove the two thumb screws located on the top panel.
  2. Pull the top panel to release it from the case.
- **Removing the Side and Front Glass:**

Peel off the protective film on both sides of the glass before removing.
- **PSU Installation:**

1. Place the PSU on the removable tray.
2. Secure the PSU using the provided screws.

- **2.5 HDD Installation:**

Attach the 2.5 HDD to the top or side of the case using the provided screws.

- **Radiator & Cooling Support:**

The case supports various radiator and fan sizes:

1. 120mm x 120mm
2. 140mm x 140mm
3. 120mm x 240mm
4. 140mm x 280mm

- **VGA Anti-sag Bracket Installation:**

Use the provided tool to loosen the screw for displacement.

- **Upright Display Card Kit Installation:**

This kit allows for vertical GPU installation. Refer to the package content for detailed instructions on installation.

- **USB 3.0 and HD Audio Support:**

The case supports motherboard USB 3.0 20 Pin header and HD audio connections. Refer to the package content for cable connections.

## Case components

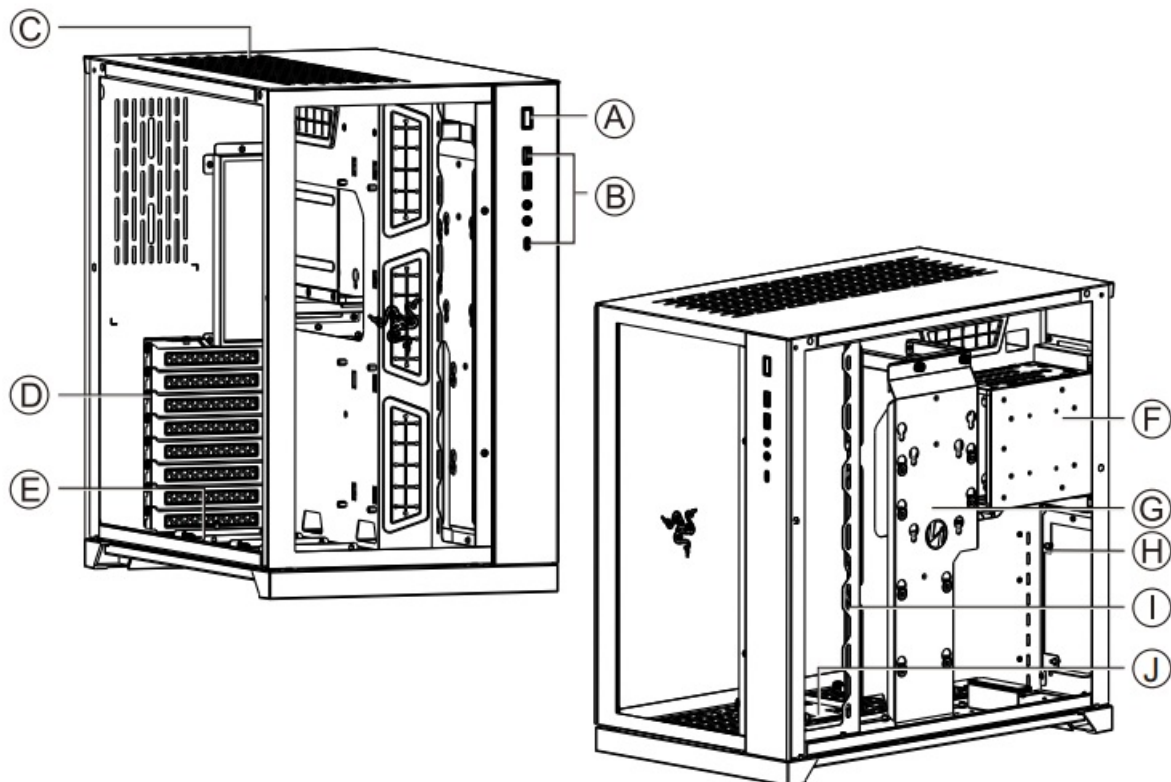

- **A.** Power switch
- **B.** Multi-media ports (USB 3.0 x 2, USB 3.1 Type-C, HD audio)
- **C.** Spare 120 mm fans x 3 or 140 mm fans x 2
- **E. D.** PCI slots with ventilation
- **F.** 2.5 " HDD x 2
- **G.** Removable HDD tray ( 3.5" HDD x 2 or 2.5" HDD x 2 or PSU x1 ) m # (HEM

- **H.** Removable HDD tray ( 3.5" HDD × 1 + 2.5" HDD × 1 or 2.5" HDD × 2)
- **I.** PSU tray
- **J.** Spare 120 mm fans × 3

## Hardware list

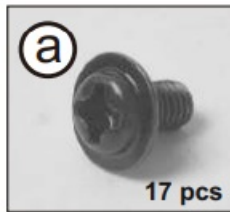

Screws  
for mother board &  
2.5" HDD mount

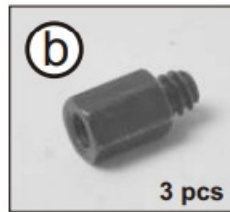

Stand-off bolt (Spare parts)  
for motherboard mount

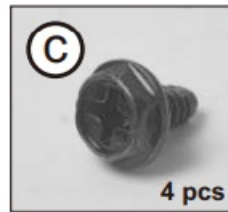

Screws  
for PSU mounting



Screws  
for 2.5" HDD mount

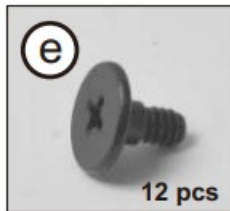

Screws  
for 3.5" HDD mount

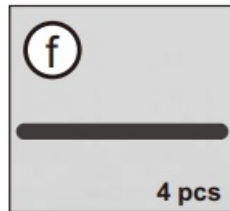

Velcro  
for cable management

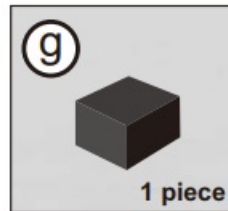

Rubber pad  
for PSU mounting

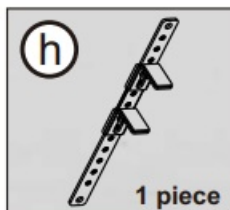

VGA anti-sag bracket  
for VGA card mount

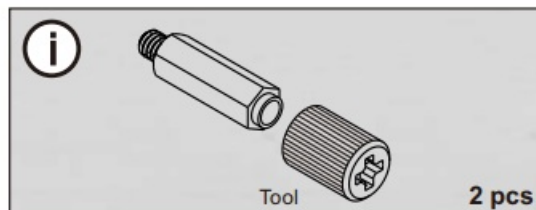

Longer stand-off bolt  
for VGA anti-sag bracket mounting

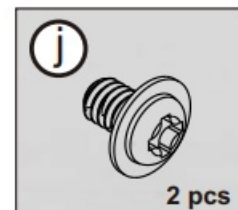

Screws  
for VGA anti-sag bracket  
mounting

## Remove top panel

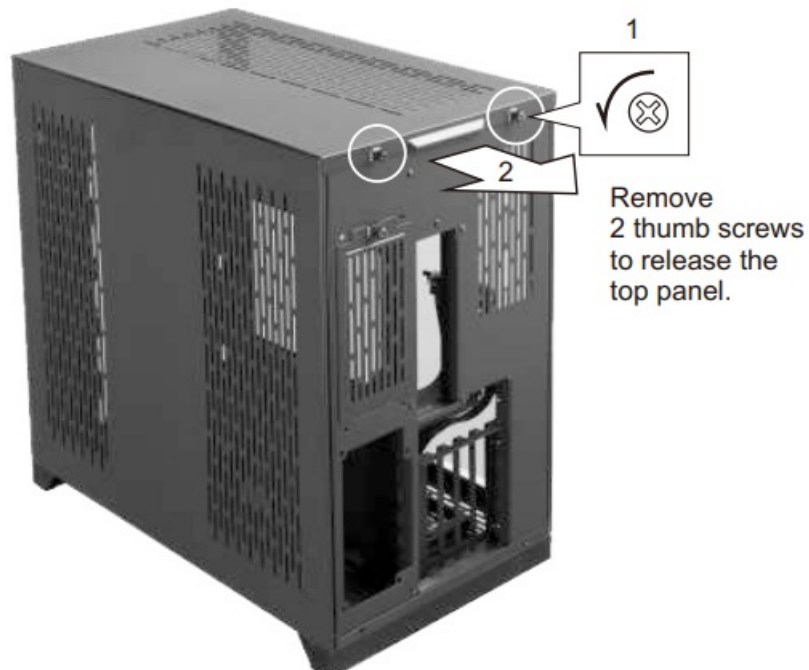

## Remove side glass & front glass

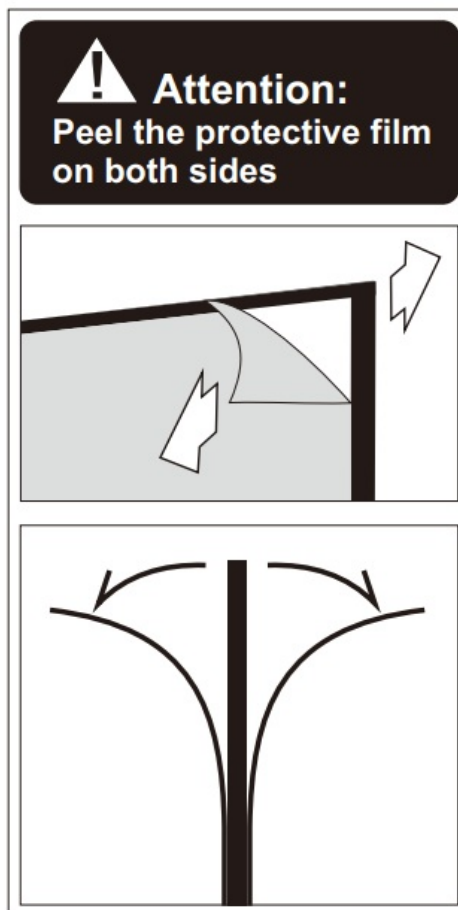
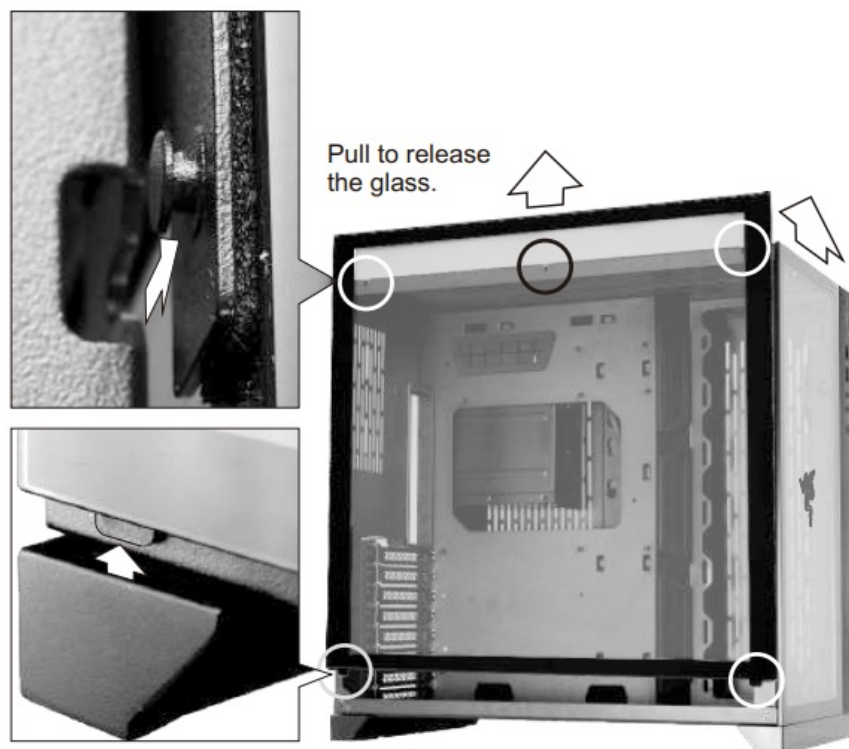

## PSU installation

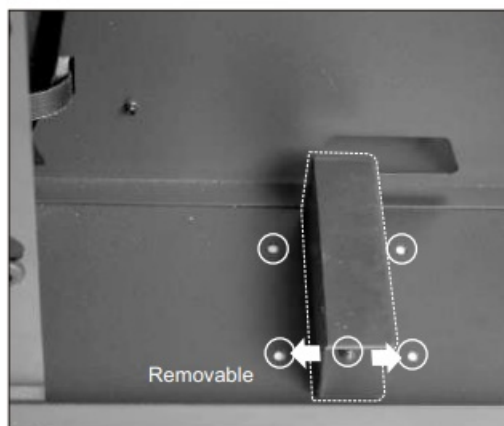
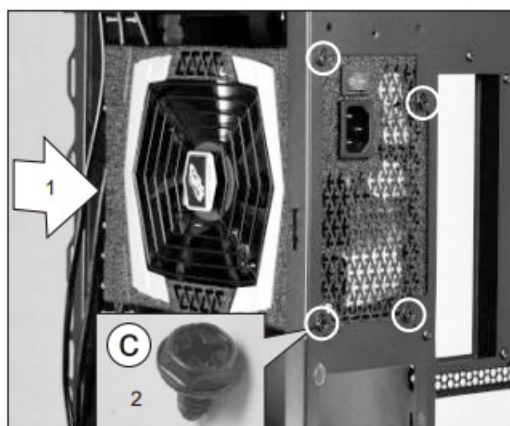
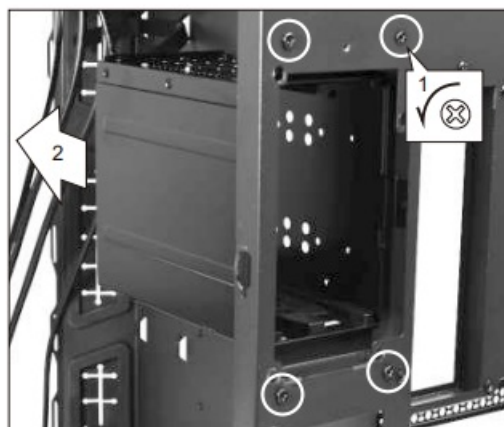
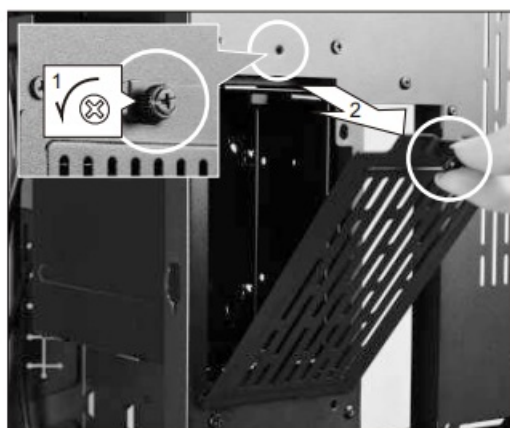



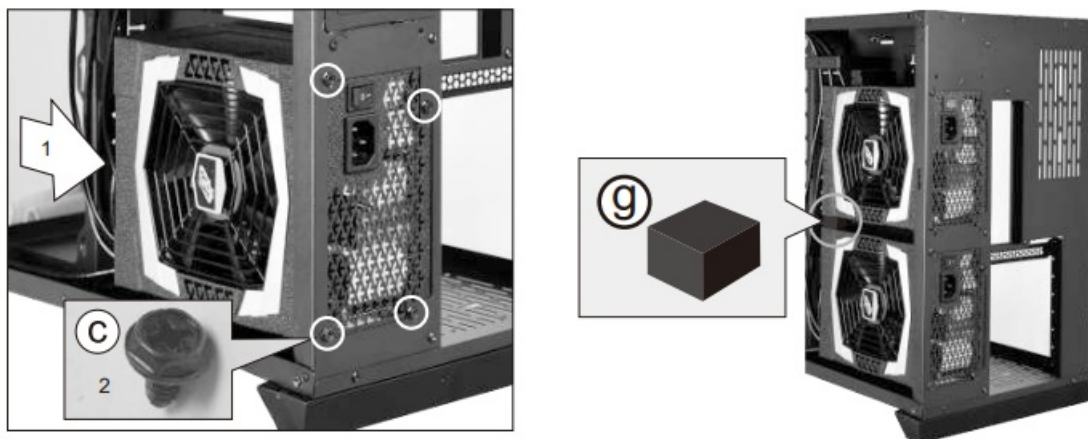

## Motherboard installation

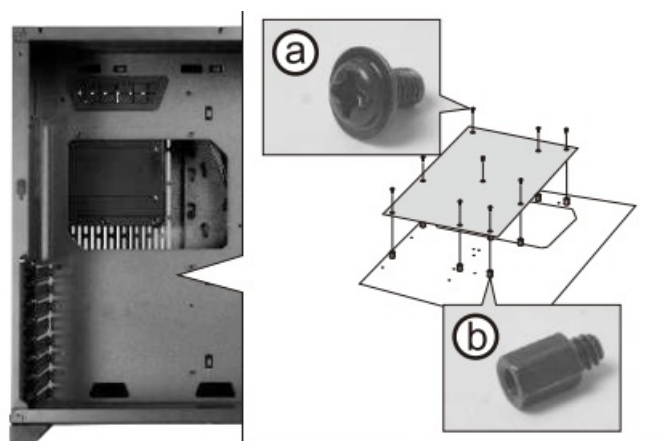

## 2.5"/3.5" HDD installation



2.5"/3.5" HDD installation

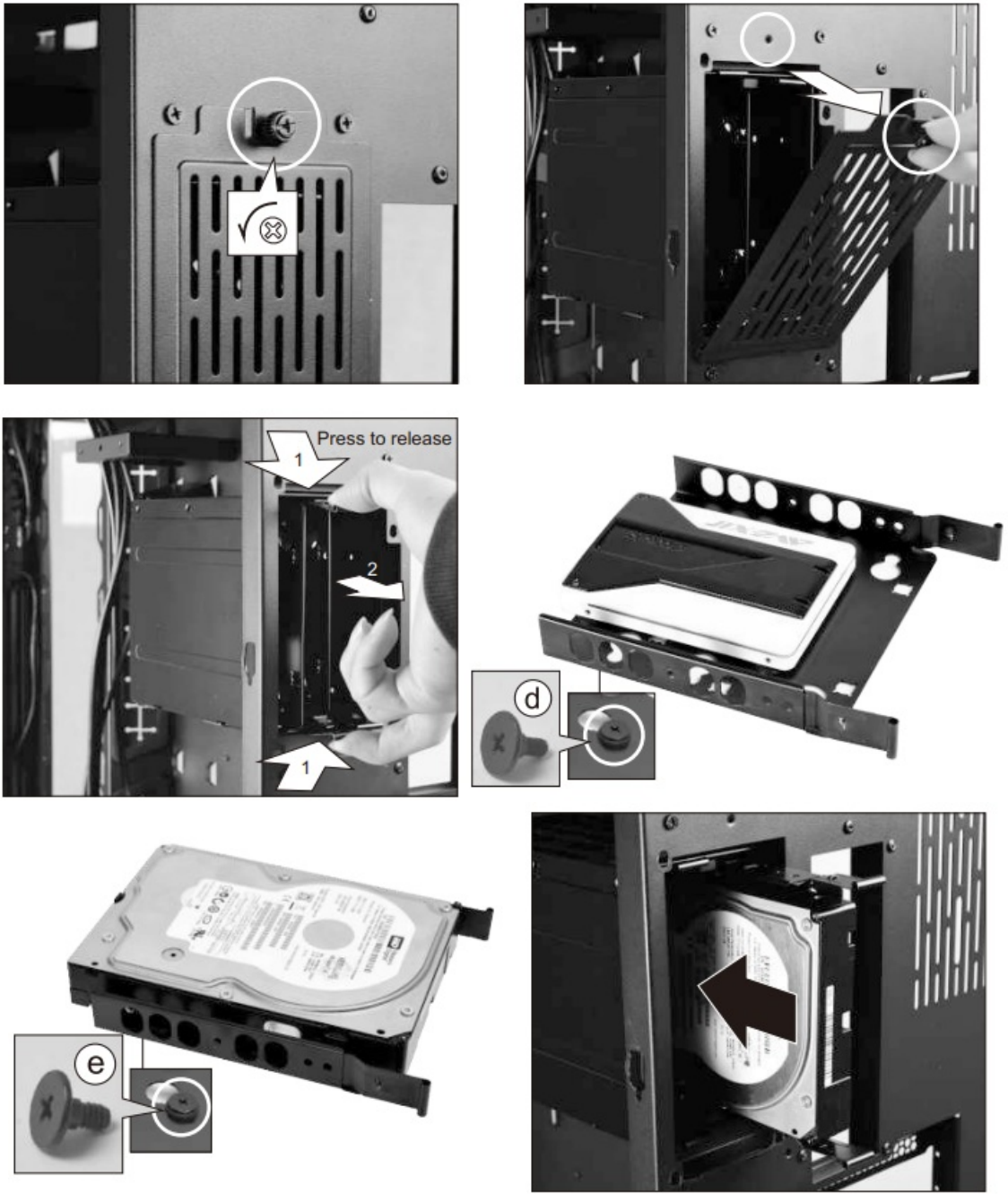

2.5" HDD installation

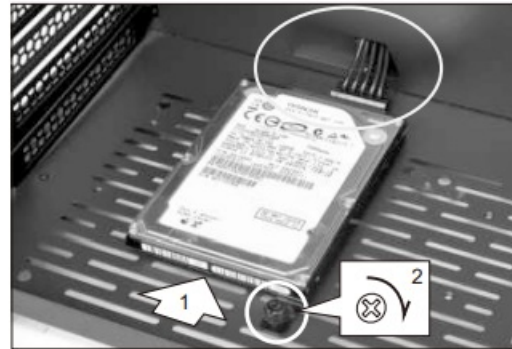
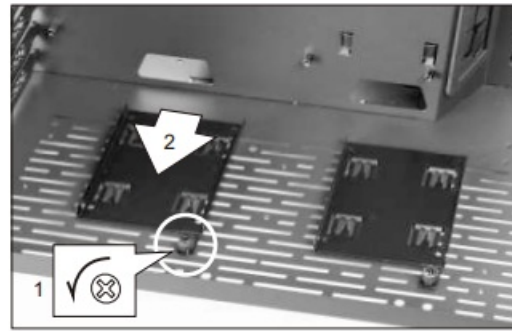
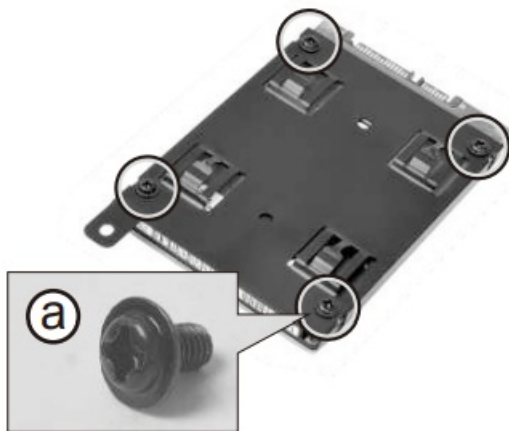

## Remove air filters

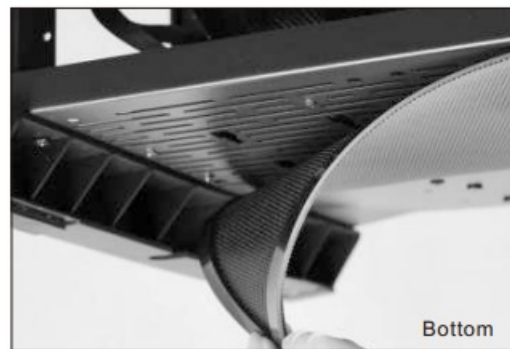
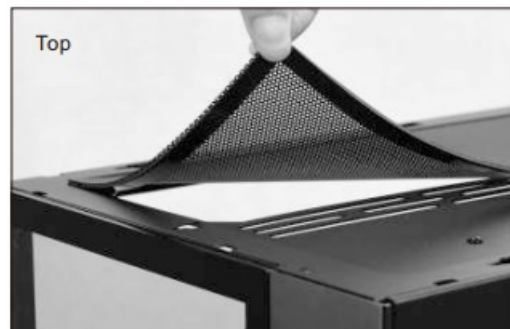

## Cable management



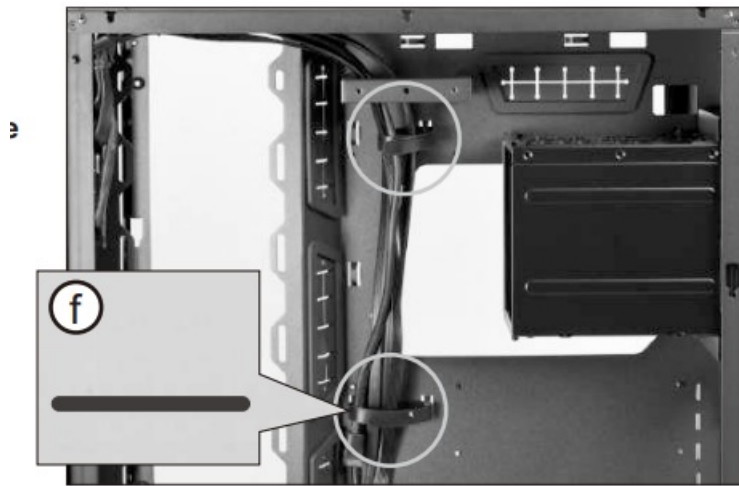

## Radiator & cooling support

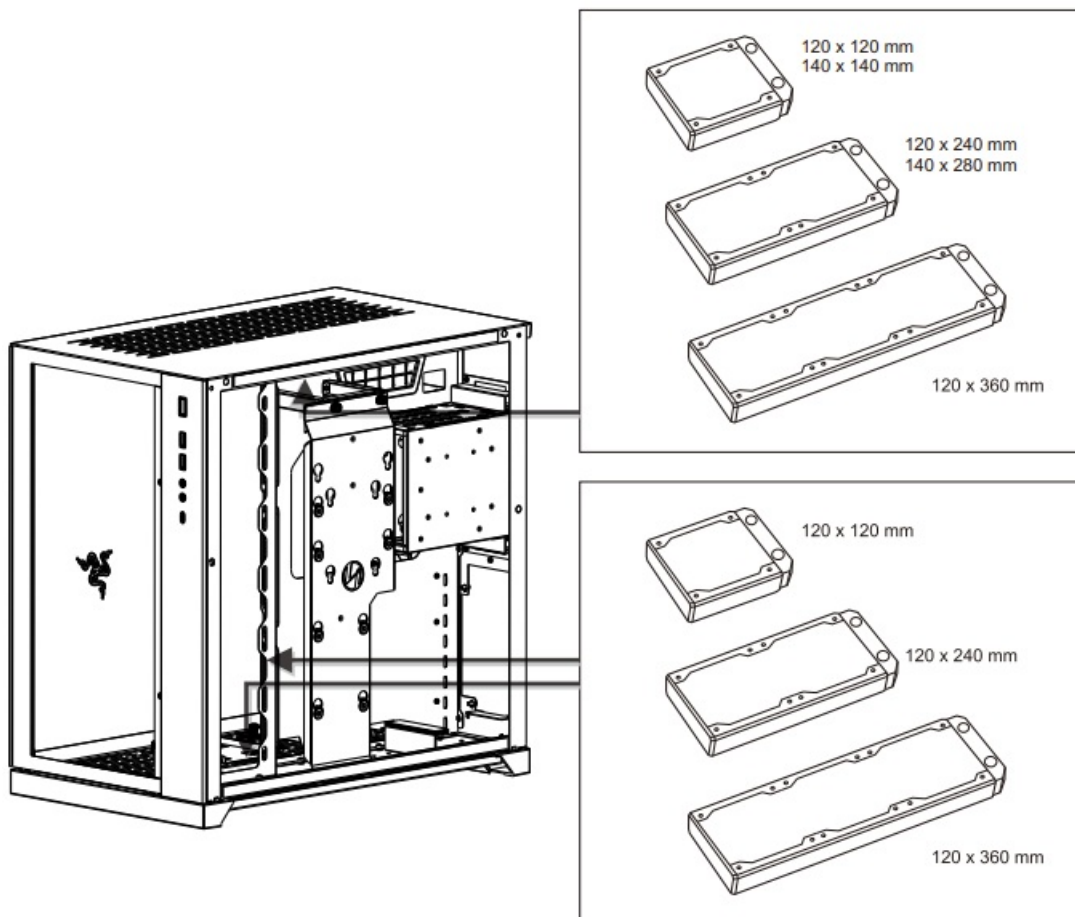

## Hardware clearance

- CPU air cooler
- GPU
- PSU w1th bracket
- PSU wthout bracket
- Radiator clearance

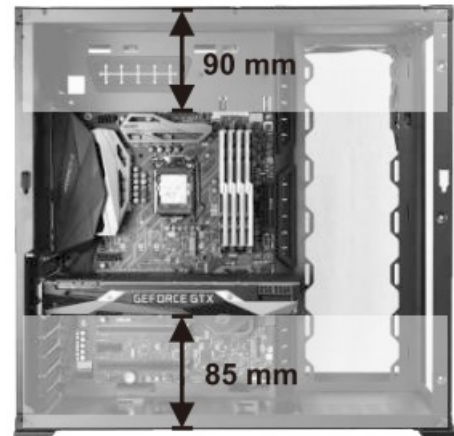
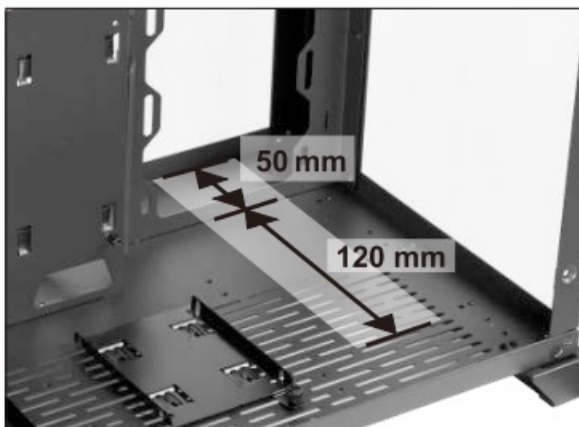
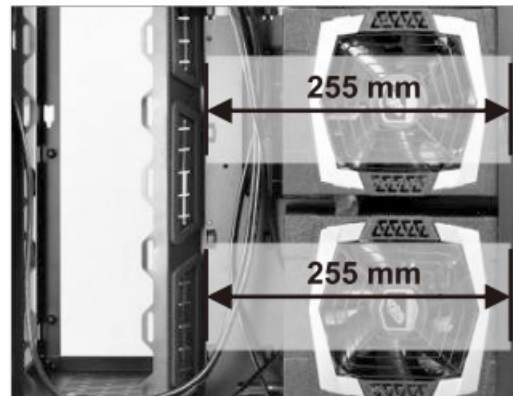
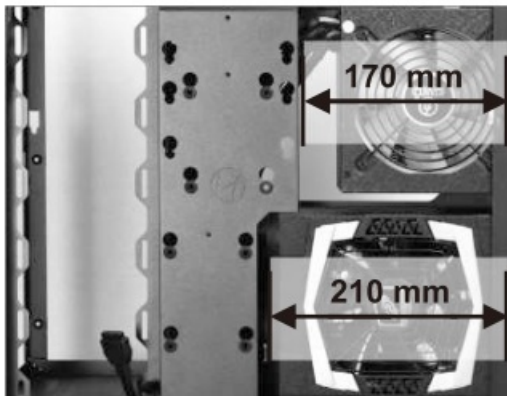
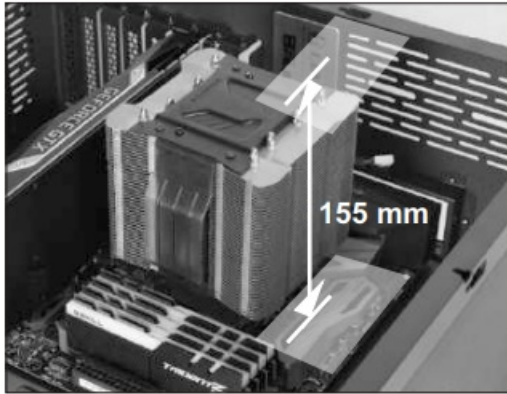

**VGA Anti-sag bracket installation**

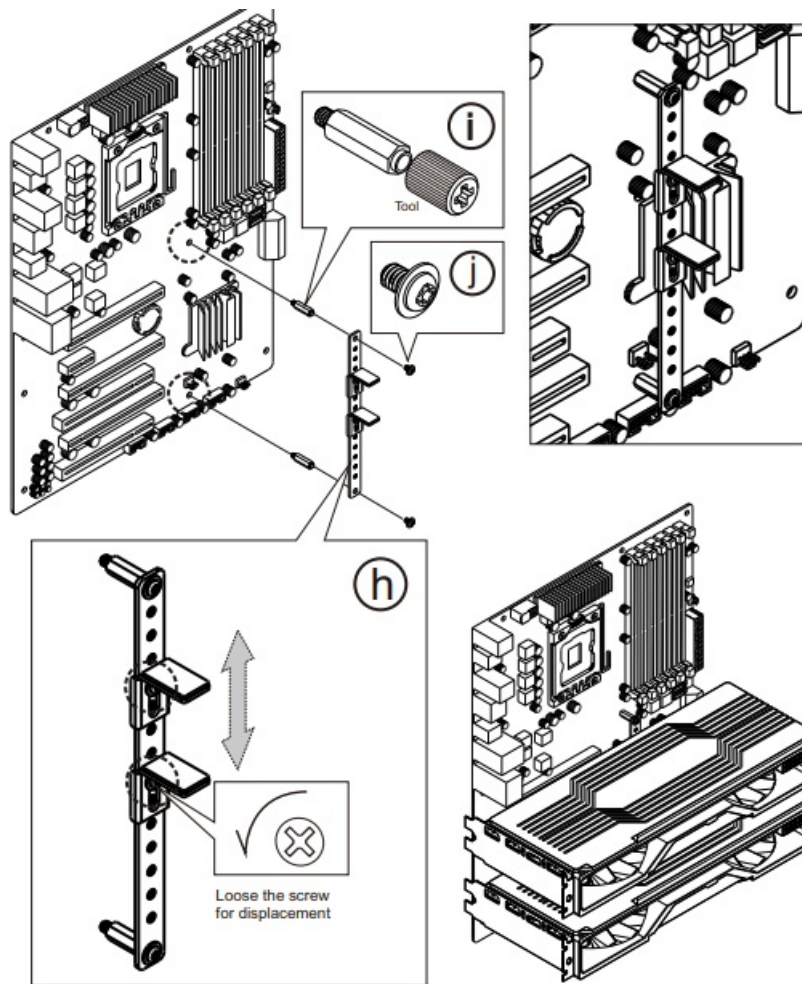

## Package Content

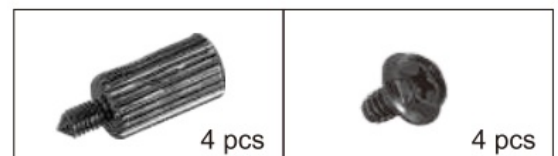
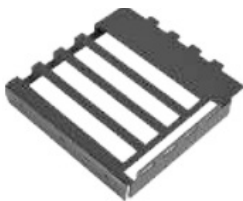

## Installation

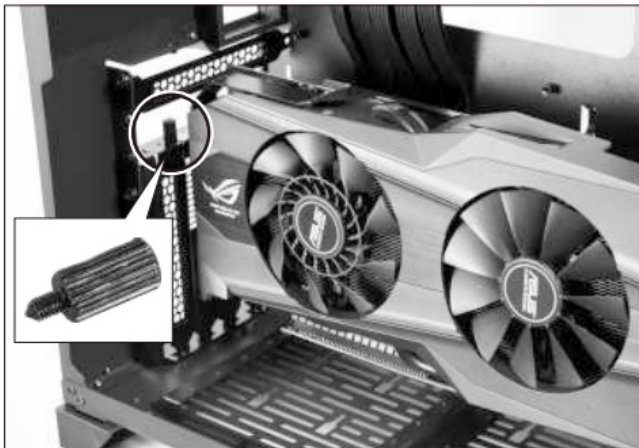
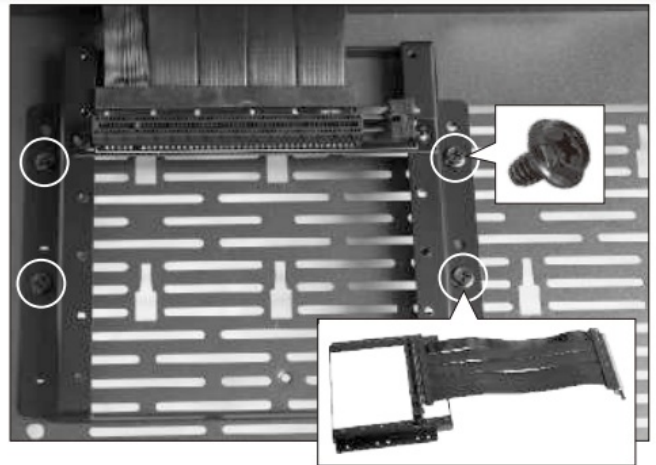
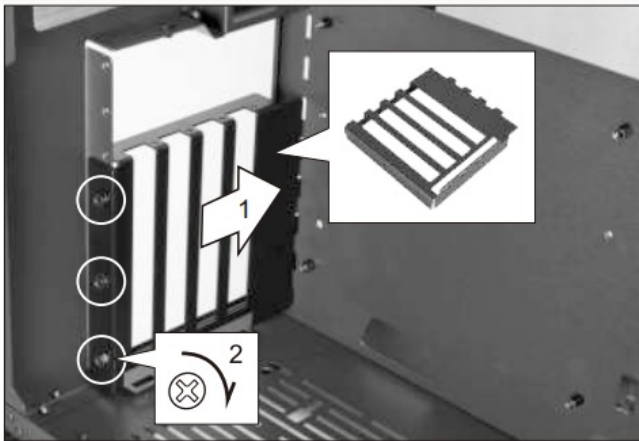

## I/O port installation

### USB 3.0

Supports motherboard  
USB 3.0 20 Pin header

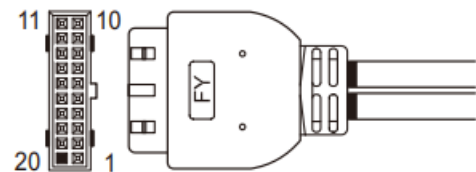

### HD AUDIO

Blue	10	9	Green
Black purple	8	7	Key
Yellow	6	5	Orange
Gray	4	3	N.C.
Red	2	1	GND+H.S. TUBE

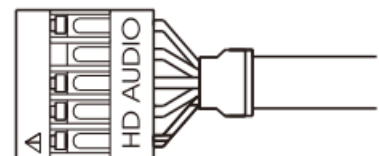

## LED Control board installation

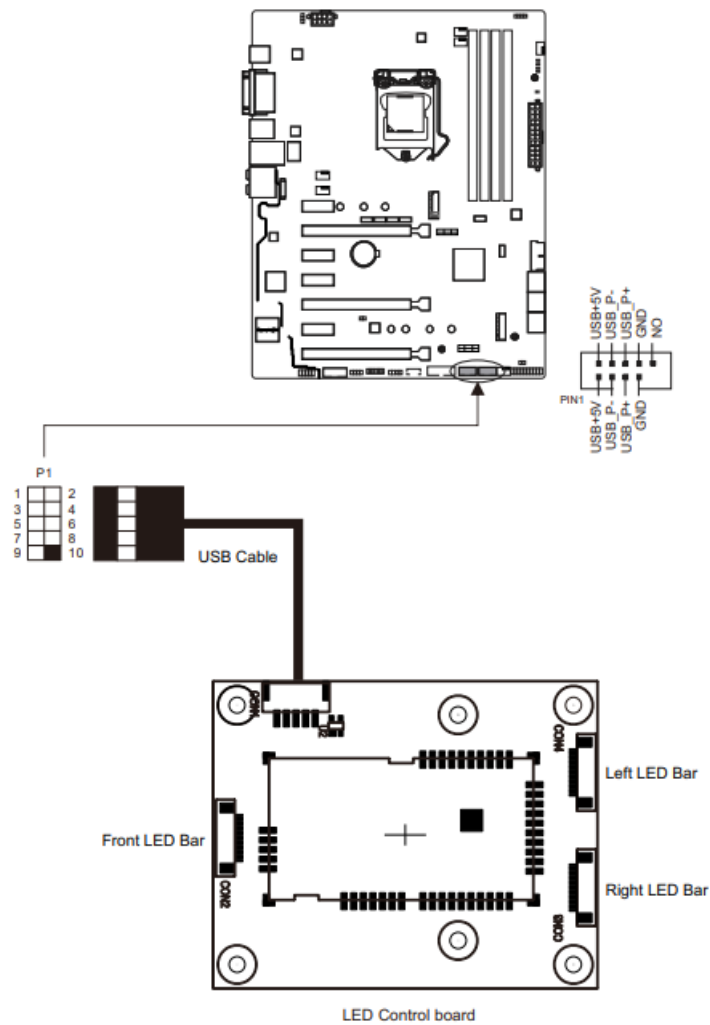

## Documents / Resources

	<p><a href="#">LIAN LI O11 Dynamic Razer Edition Tower Gaming Computer Case</a> [pdf] Installation Guide G50.O11D00.41RAZ, O11 Dynamic Razer Edition Tower Gaming Computer Case, O11 Dynamic, Razer Edition Tower Gaming Computer Case, Tower Gaming Computer Case, Gaming Computer Case, Computer Case</p>
-------------------------------------------------------------------------------------	-------------------------------------------------------------------------------------------------------------------------------------------------------------------------------------------------------------------------------------------------------------------------------------------------------------