



LG LSGL583 Series Smart Slide In Gas Range Installation Guide

[Home](#) » [LG](#) » LG LSGL583 Series Smart Slide In Gas Range Installation Guide 

LG LSGL583 Series Smart Slide In Gas Range Installation Guide



Contents

1 INSTALLATION

2 Before Installing

3 Tools Needed

4 Parts

5 In the Commonwealth of Massachusetts

6 Unpacking and Moving the Range

7 Choosing the Proper Location

8 Ventilation

9 Flooring

10 Ambient Temperature

11 Dimensions and Clearances

12 Dimensions

13 Clearances

14 Gas Pipe and Electrical Outlet Locations

15 Leveling

16 Checking Adjustments

17 Connecting Gas

18 Providing Adequate Gas Supply

19 Connecting the Range to Gas

20 Pressure Regulator Position

21 Connecting Electricity

22 Surface Burners

23 Checking Ignition of the Surface Burners

24 Adjusting the Surface Burner to the Low Flame (Simmer) Setting

25 Optional Rear Filler

26 Anti-tip Device

27 Installing the Anti-Tip Device

28 Using the Anti-Tip Bracket Template

29 Engaging the Anti-tip Device

30 Test Run

31 Checking Operation of Bake Burners

32 Checking Operation of Broil Burners

33 Documents / Resources

33.1 References

34 Related Posts

INSTALLATION

Before Installing

Tools Needed

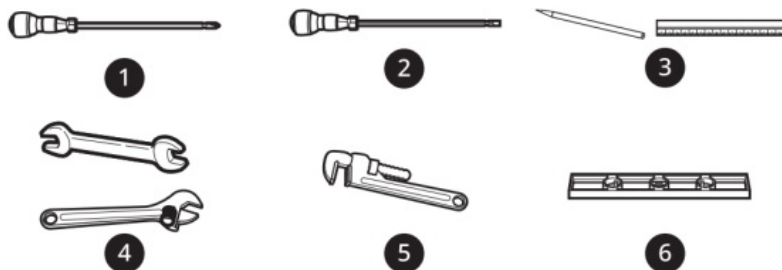

1. Phillips screwdriver
2. Flat-blade screwdriver

3. Pencil and ruler
4. Open-end or adjustable wrench
5. Pipe wrench (2) (one for support)
6. Level

Parts

Parts You May Need

- Gas line shut-off valve
- Pipe joint sealant that resists action of natural and LP gases
- Flexible metal appliance connector (3/4" or 1/2" NPT x 1/2" I.D.)
 - Never use an old connector when installing a new range.
- Flare union adapter for connection to gas supply line (3/4" or 1/2" NPT x 1/2" I.D.)
- Flare union adapter for connection to pressure regulator on range (1/2" NPT x 1/2" I.D.)
- Liquid leak detector or soapy water
- Lag bolt or 1/2" O.D. sleeve anchor (for concrete floors only)

In the Commonwealth of Massachusetts

- This product must be installed by a licensed plumber or gas fitter.
- When using ball type gas shut-off valves, they must be the T-handle type.
- When using a flexible gas connector, it must not exceed 3 feet in length.

Unpacking and Moving the Range

WARNING

- You should use two or more people to move and install the range. (Excessive Weight Hazard) Failure to do so can result in back or other injury.
- Do not use the door handles or knobs to push or pull the range during installation or when moving the range out for cleaning or service. Doing so can result in serious damage to the range.

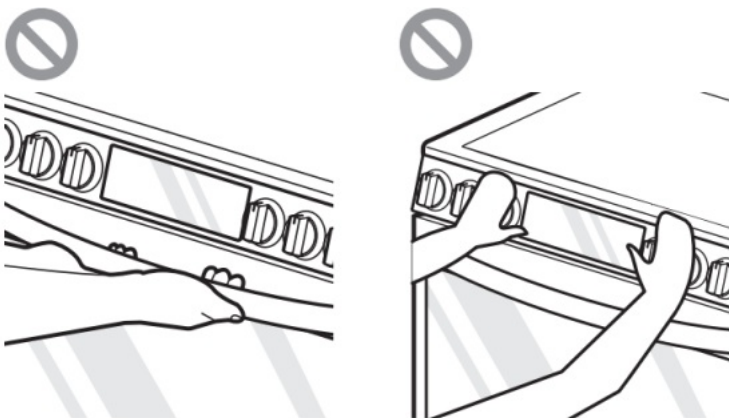

- Do not push or pull the range by grabbing the open oven door or cooktop only. Doing so can result in serious damage to the range.

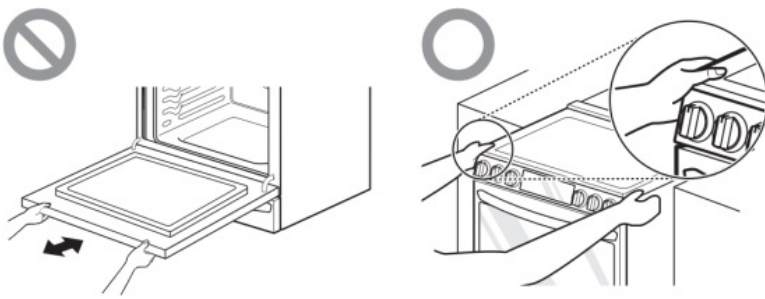

- Do not lift the range using the cooktop or door handle. Doing so can cause damage and improper operation of the range.



- To reduce the risk of burns, do not move this appliance while it is hot.

NOTE

- The image may differ from the actual model.

NOTE

- Your range is heavy and can be installed on soft floor coverings such as cushioned vinyl or carpeting. Use care when moving the range on this type of flooring. Use a belt when moving the range to prevent damaging the floor. Or slide the range onto cardboard or plywood to avoid damaging the floor covering.

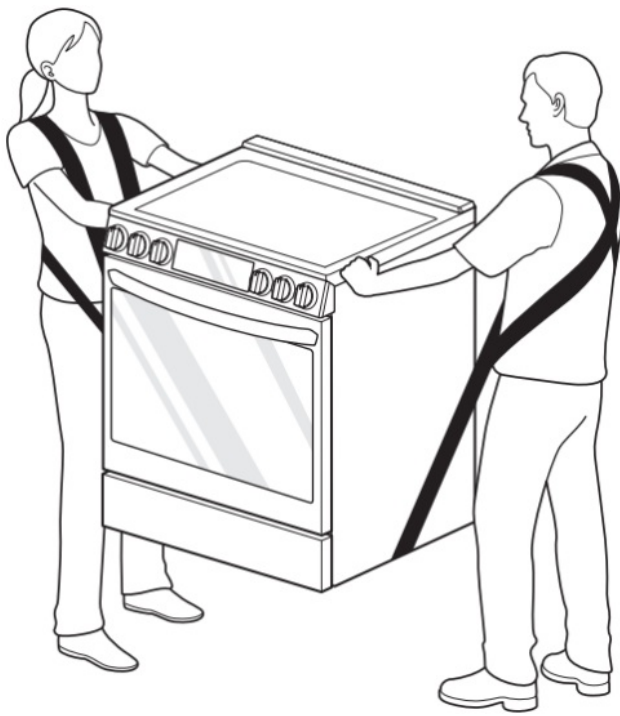

- Remove packing material, tape and any temporary labels from your range before using.
Do not remove any warning-type labels, the model and serial number label, or the Tech Sheet that is located on the back of the range.
- To remove any remaining tape or glue, rub the area briskly with your thumb. Tape or glue residue can also be easily removed by rubbing a small amount of liquid dish soap over the adhesive with your fingers. Wipe with warm water and dry.
- Do not use sharp instruments, rubbing alcohol, flammable fluids, or abrasive cleaners to remove tape or glue. These products can damage the surface of your range.

Choosing the Proper Location

Ventilation

- Do not locate your range where it may be subject to strong drafts. Any openings in the floor or wall behind the range should be sealed.
Make sure the openings around the base of the range that supply fresh air for combustion and ventilation are not blocked by carpeting or woodwork.
- This appliance must not be installed with a ventilation system that blows air downward toward the range. This type of ventilation system may cause ignition and combustion problems with the gas cooking appliance resulting in personal injury or unintended operation.

Flooring

- Your range, like many other household units, is heavy and can be installed on soft floor coverings such as cushioned vinyl or carpeting.
Use care when moving the range on this type of flooring.
- When the floor covering ends at the front of the range, the area that the range will be installed on should be built up with plywood to the same level or higher than the floor covering. This will allow the range to be moved for cleaning and servicing, as well as provide proper air flow to the range.

- Make sure the floor covering can resist temperatures of at least 167 °F (75 °C). See the Installation Safety Instructions included in this manual.

Ambient Temperature

- Make sure the wall coverings around your range can resist the heat generated up to 194 °F (90 °C) by the range. See the Installation Safety Instructions included in this manual.

Dimensions and Clearances

- Provide proper clearance between the range and adjacent combustible surfaces.
- These dimensions must be met for safe use of your range.
- The location of the electrical outlet and pipe opening (see “Gas Pipe and Electrical Outlet Locations” below) may be adjusted to meet specific requirements.
- The range may be placed with 0” clearance (flush) at the back wall.

Dimensions

Model: LSGL5833*/LSGL5831*/ LSGL583CF

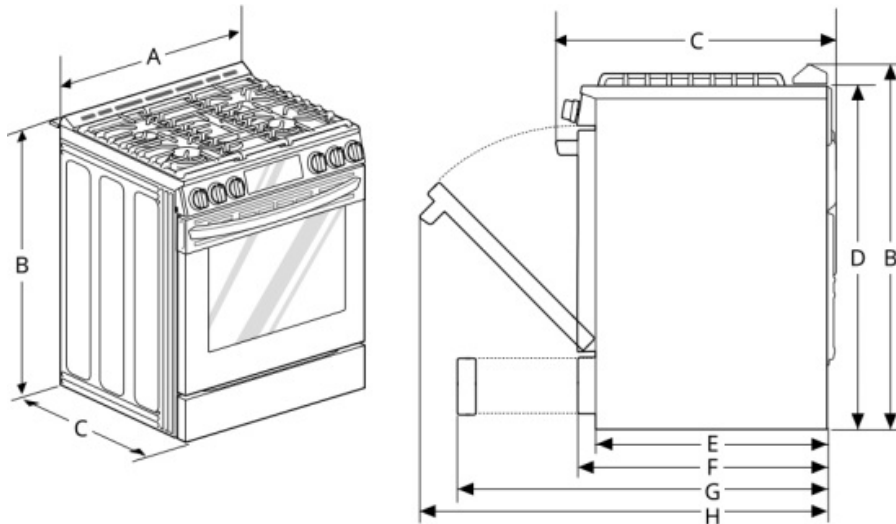

Model: LSGL5833X

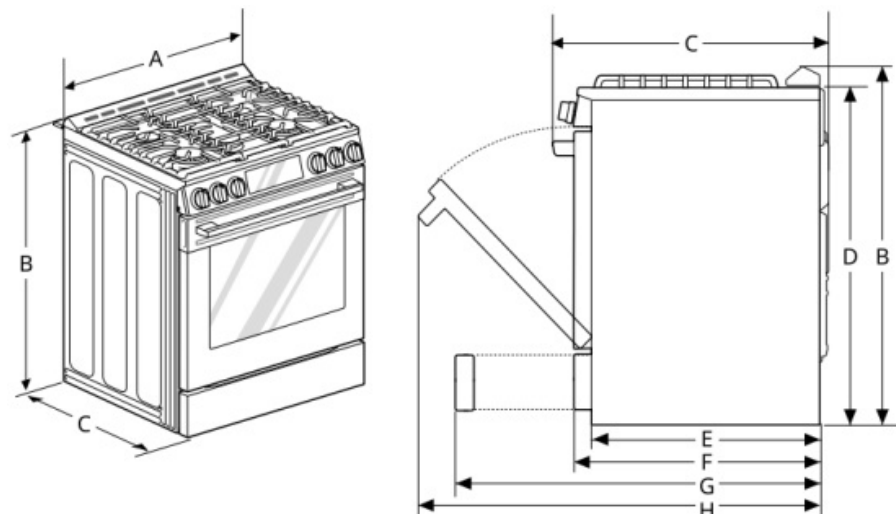

–	Dimensions	LSGL5833*, LSGL5831*, LSGL583CF, LSGL5833X
A	Width	29 7/8" (759 mm)
B	Height	37 1/4" (946mm)
C	Depth (Includes Door Handle)	29 7/32" (742 mm)
D	Height (Excludes Vent Trim)	36" (914.0 mm)
E	Depth (Includes only the product body that is loaded into the cabinet. Excludes door, drawer, and handles)	24 25/32" (628.4 mm)
F	Depth (Excludes Door Handle)	26 27/32" (682mm)
G	Depth when drawer is fully opened	36 27/32" (935.7mm)
H	Depth when door is fully opened	48 5/8" (1235.9 mm)

Clearances

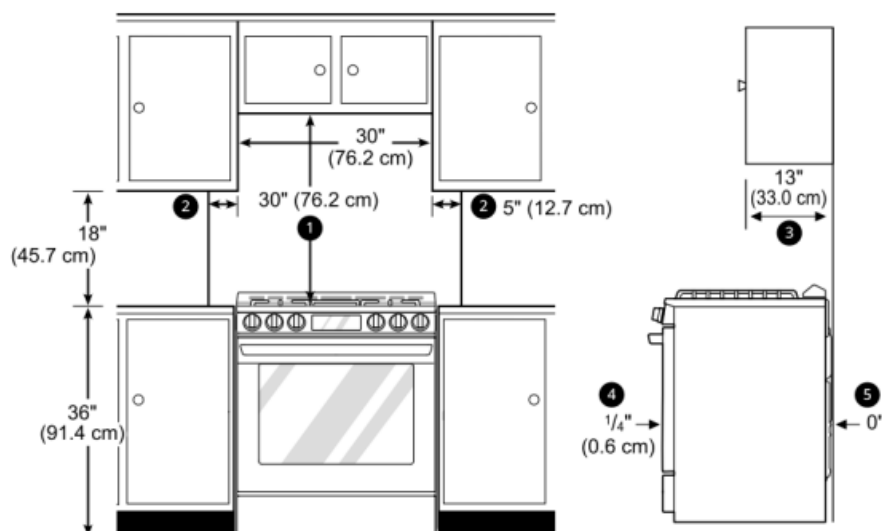

1. Minimum
2. Minimum clearance to left/right wall
3. Maximum depth for cabinets above counter tops
4. Front edge of the range side panel forward from cabinet
5. To cabinets below cooktop and at the range back

Gas Pipe and Electrical Outlet Locations

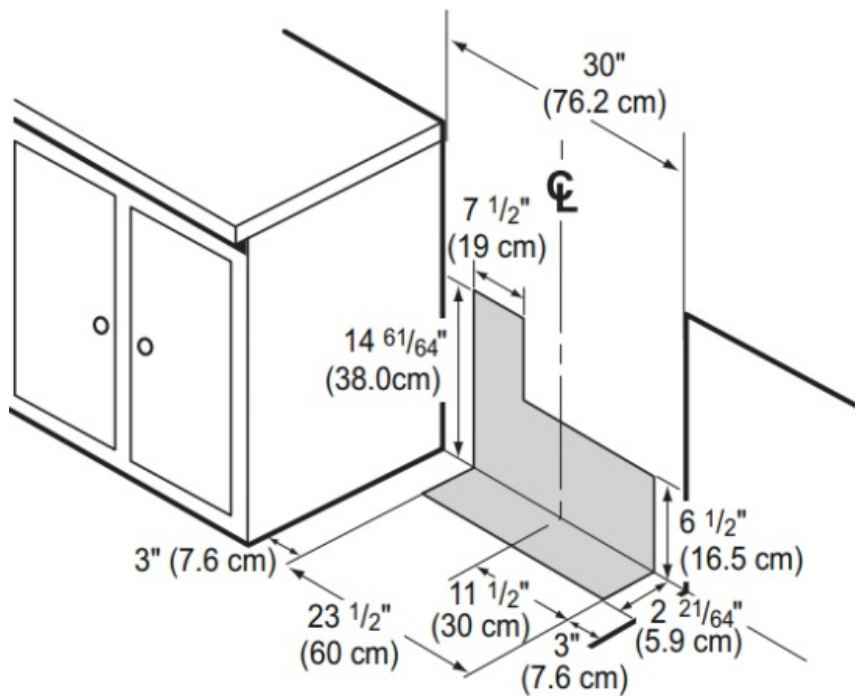

Leveling

Leveling the Range

Level the range by adjusting the levelling legs with a wrench. Extending the legs slightly may also make it easier to insert the rear leg into the anti-tip bracket.

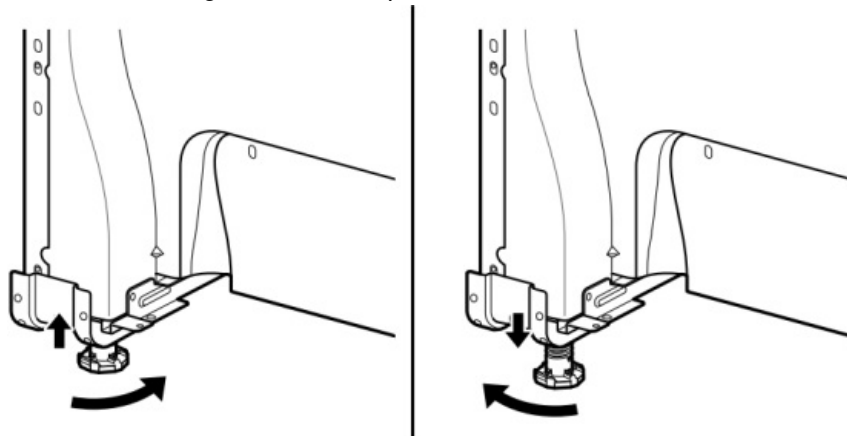

Checking Adjustments

1. Place a level diagonally on the oven rack, and check each direction for level.
 - First check direction **1**. Then check direction **2**.

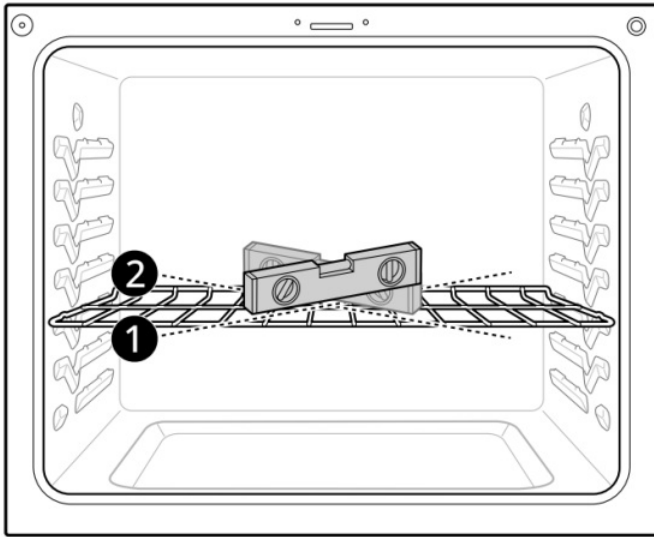

2. If the level doesn't show that the rack is level, adjust the leveling legs with a wrench.

Connecting Gas

Providing Adequate Gas Supply

- Your range is designed to operate at a pressure of 5" of water column on natural gas or 10" of water column on LP.
- Make sure you are supplying your range with the type of gas for which it is configured.
- This range is convertible for use with natural or LP gas. When using this range with LP gas, conversion must be made by a qualified LP installer before attempting to operate the range.
- For proper operation, the pressure of natural gas supplied to the regulator must be between 5" and 13" of water column.
- For LP gas, the pressure supplied to the regulator must be between 10" and 13" of water column. When checking for correct operation of the regulator, the inlet pressure must be at least 1" more than the operating (manifold) pressure as given above.
- The pressure regulator located at the inlet of the range must remain in the supply line regardless of which type of gas is being used.
- A flexible metal appliance connector used to connect the range to the gas supply line should have an I.D. of 5/8" and a maximum length of 5 feet. In Canada, flexible connectors must be single wall metal connectors less than 6 feet in length.

Connecting the Range to Gas

WARNING

- Isolate the range from the gas supply system by closing its individual shut-off valve during any pressure testing of the gas supply system at test pressures equal to or less than 1/2 psi (3.5 kPa).
- The appliance and its individual shut-off valve must be disconnected from the gas supply piping system during any pressure testing of that system at test pressures in excess of 1/2 psi (3.5 kPa).
- Shut off the range gas supply valve before removing the old range and leave it off until the new hook-up has been completed.

- Because hard piping restricts movement of the range, the use of a CSA International-certified flexible metal appliance connector should be used unless local codes require a hard-piped connection.
 - A manual valve shall be installed in an accessible location in the gas piping external to the appliance for the purpose of turning on or shutting off gas to the appliance.
 - Never reuse an old connector when installing a new range.
 - To protect against gas leaks, use a qualified pipe joint sealant on all external threads.
1. Install a male 1/2" or 3/4" flare union adapter to the NPT internal thread of the manual shutoff valve, taking care to back-up the shut-off valve to keep it from turning.
 2. Install a male 1/2" flare union adapter to the 1/2" NPT internal thread at the inlet of the pressure regulator. Use a backup wrench on the pressure regulator fitting to prevent damage.
 - Check that the gas pressure regulator valve is in the open position.

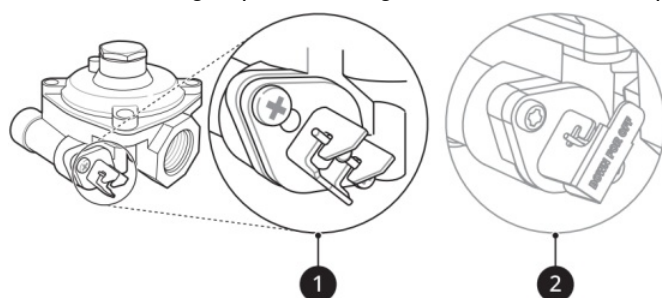

1. Lever's open position
2. Lever's closed position

NOTE

- The gas pressure regulator valve is open when shipped. If the range does not work properly after installation, make sure the regulator valve is still open.
3. Connect a flexible metal appliance connector to the adapter on the range. Position the range to permit connection at the shut-off valve.
 4. When all connections have been made, be sure all range controls are in the OFF position and the pressure regulator valve is open before turning on the main gas supply valve.
 - Gas leaks may occur in your system and create a hazard. Gas leaks may not be detected by smell alone.
 5. Check all gas connection joints and fittings for leaks with a non-corrosive leak detection fluid, then wipe off.
 - Gas suppliers recommend you purchase and install a UL approved gas detector. Install and use in accordance with the installation instructions.

WARNING

- Do not use a flame to check for gas leaks.

Flexible Connector Hookup

Have the installer show you the location of the range gas shut-off valve and how to shut it off if necessary.

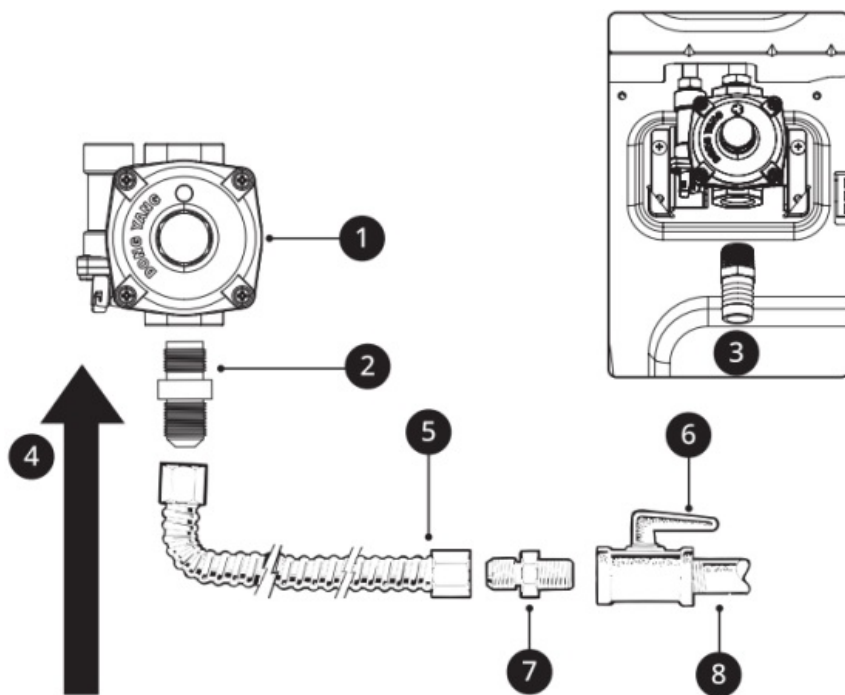

1. Pressure regulator
2. 1/2" adapter
3. 1/2" adapter
4. Gas flow into range
5. Flex connector (6 ft. max.)
6. Gas shut-off valve
7. 1/2" adapter
8. 1/2" or 3/4" gas pipe

Pressure Regulator Position

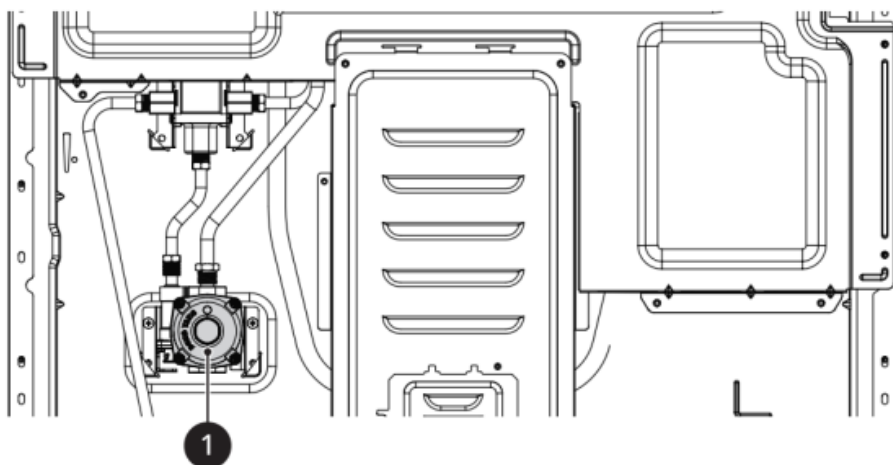

1. Pressure regulator

Adjusting Air Shutters (for LP Conversions)

The range comes from the factory with the air shutters adjusted for proper air flow for natural gas. If converted to LP, follow the instructions provided in the conversion kit to properly adjust the air shutters. LP conversion must be performed by a qualified technician.

Connecting Electricity

Electrical Requirements

120 Volt, 60 Hz, properly grounded dedicated circuit protected by a 15 or 20 Amp circuit breaker, or slow blow fuse.

If an external electrical source is utilized, the appliance, when installed, must be electrically grounded in accordance with local codes or, in the absence of local codes, with the National Electrical Code, NFPA70 or the Canadian Electric Code, CSA C22.1-02.

Grounding

WARNING

- For personal safety, this appliance must be properly grounded.
- Do not, under any circumstances, cut or remove the third (ground) prong from the power cord.
- The customer should have the wall receptacle and circuit checked by a qualified electrician to make sure the receptacle is properly grounded.
- The power cord of this appliance is equipped with a 3-prong (grounding) plug which mates with a standard 3-prong grounding wall receptacle to minimize the possibility of electric shock hazard from this appliance.
- Where a standard two-prong wall receptacle is encountered, it is the personal responsibility and obligation of the customer to have it replaced with a properly grounded three-prong wall receptacle.
- Ensure proper ground 1 exists before use.

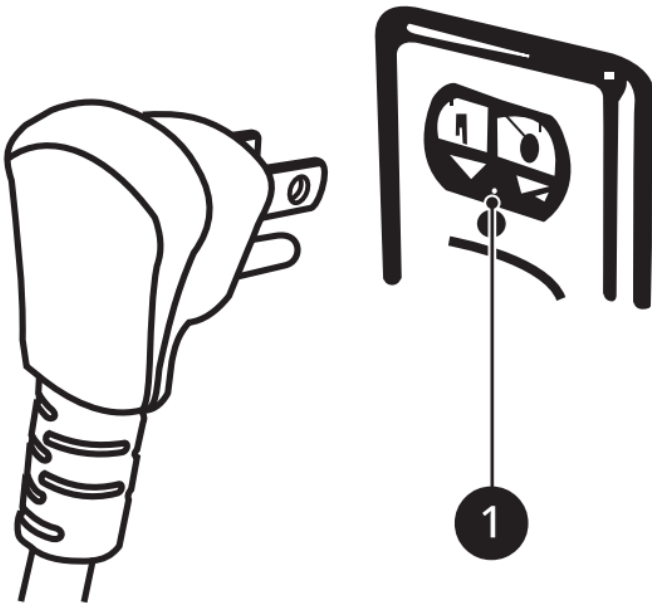

- Do not use an adapter plug. Disconnecting of the power cord places undue strain on the adapter and leads to eventual failure of the adapter ground terminal.
- Installation must conform with local codes or, in the absence of local codes, with the National Fuel Gas Code, ANSI Z223.1/NFPA 54 or, in Canada, the Natural Gas and Propane Installation Code, CSA B149.1.

Surface Burners

Assembling the Surface Burners

CAUTION

- Do not operate the burners without all parts in place.

1. Place the burner caps and heads on the cooktop.

- There is one small, one medium, one large, one oval (center), and one extra large burner head and cap.

2. Make sure that the caps and heads are placed in the correct locations.

3. Make sure the hole in the burner head is positioned over the electrode.

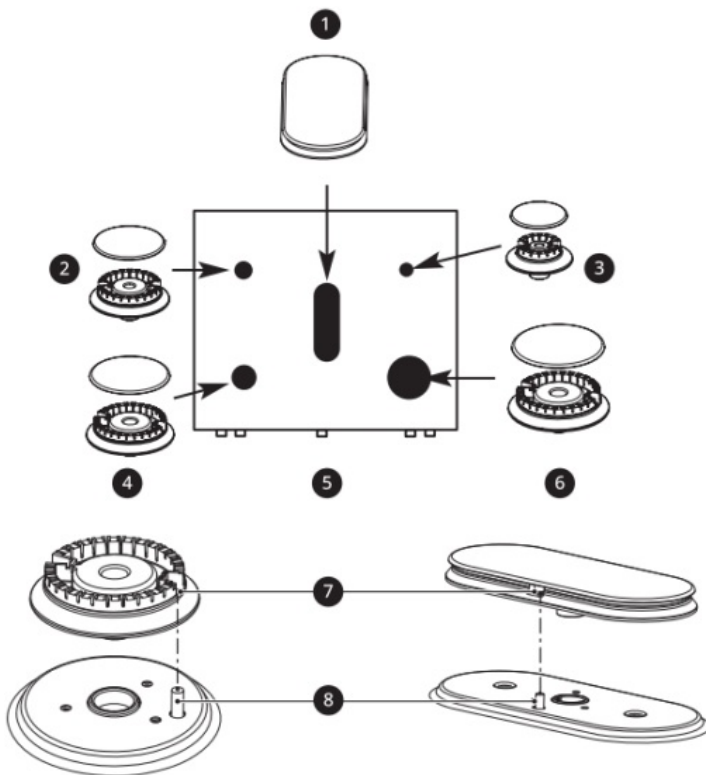

1. Oval (center) burner head/cap assembly
2. Medium burner head and cap
3. Small burner head and cap
4. Large burner head and cap
5. Front of range
6. Extra large burner head and cap
7. Hole
8. Electrode

Checking Ignition of the Surface Burners

Electric Ignition

Select a surface burner knob and simultaneously push in and turn to the Lite position. You will hear a clicking sound indicating proper operation of the spark module.

Once the air has been purged from the supply lines the burner should ignite within 4 seconds.

After the burner ignites, rotate the knob out of the Lite position. Try each burner in succession until all burners have been checked.

Quality of Flames

The combustion quality of the burner flames needs to be confirmed visually

Yellow flames

Call for service.

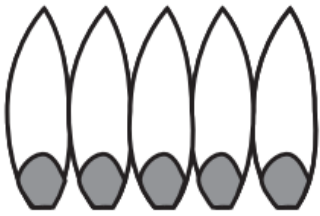

Yellow tips on outer cones

This is normal for LP gas.

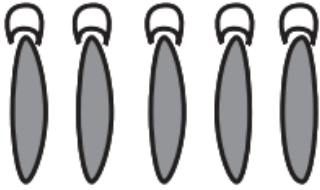

Soft blue flames

This is normal for natural gas.

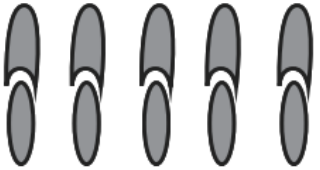

NOTE

- With LP gas, some yellow tipping on outer cones is normal.

Adjusting the Surface Burner to the Low Flame (Simmer) Setting

1. Light all surface burners.
2. Turn the knob on the burner being adjusted to Lo.
3. Remove the knob
4. Insert a small, flat-blade screwdriver into the valve shaft.

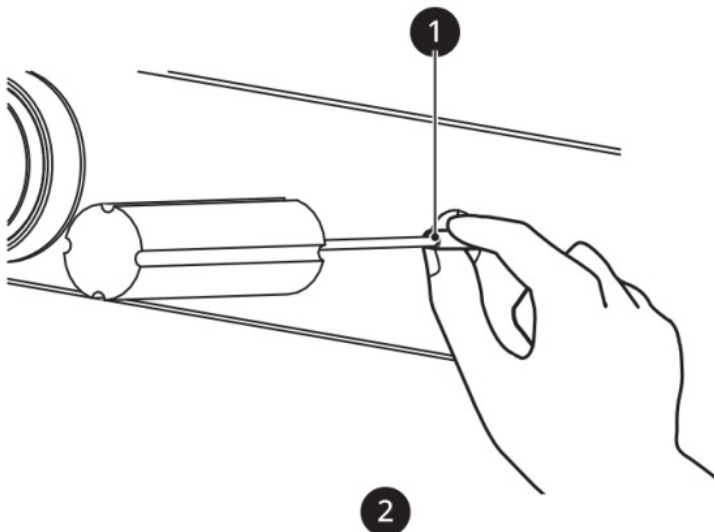

1. Valve shaft
 2. Center adjustment screw
5. Turn the screw to adjust.
 - Hold the valve shaft with one hand while turning the screw to adjust with the other.
 6. Replace the knob.
 7. Test the flame stability.
 - **Test 1:** Turn the knob from Hi to Lo quickly. If the flame goes out, increase the flame size and test again.

- **Test 2:** With the burner on a Lo setting, open and close the oven door quickly. If the flame is extinguished by the air currents created by the door movement, increase the flame height and test again.

8. Repeat steps 1-7 for each surface burner.

Optional Rear Filler

Installing the Rear Filler

If the counter does not bridge the opening at the rear wall, the rear filler kit that is provided with the slide-in range will be needed.

NOTE

- If the countertop depth is greater than 25 3/8" there will be a gap between the filler kit and the back wall.
- If the countertop depth is less than 24 3/4", the control panel will not sit flush with the countertop.

1. Using a screwdriver, remove the 3 screws holding the rear top plate in place.

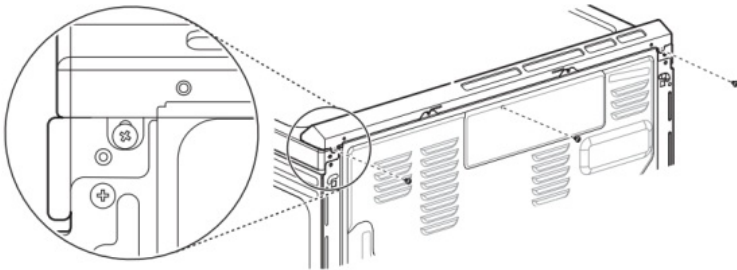

2. Attach the rear top plate and filler assembly as shown, using the 3 screws removed in step 1.

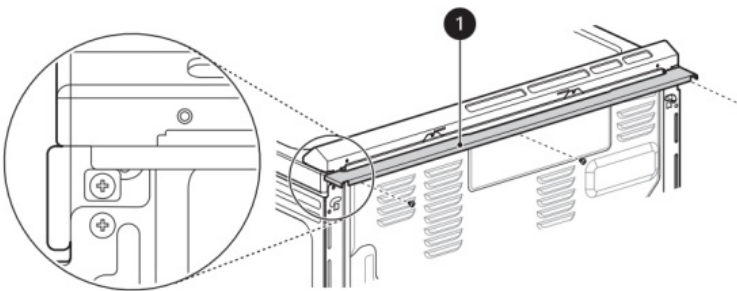

1. Rear filler

Anti-tip Device

Installing the Anti-Tip Device

Tip Hazard



- A child or adult can tip the range and be killed.



- Install the anti-tip device to the structure and/or the range. Verify the anti-tip device has been properly installed

and engaged by following the guide on the anti-tip bracket template.

- Engage the range to the anti-tip device by following the guide on the anti-tip bracket template. Ensure the anti-tip device is reengaged when the range is moved by following the guide on the anti-tip bracket template.
- Re-engage the anti-tip device if the range is moved. Do not operate the range without the anti-tip device in place and engaged.
- See installation instructions for details.
- Failure to follow these instructions can result in death or serious burns to children or adults.
- Range must be secured with an approved antitip device.
- The range could be tipped by standing, sitting or leaning on an open door if the range or anti-tip device is not properly installed.
- The use of this device does not preclude tipping of the range when not properly installed.
- After installing the anti-tip device, verify that it is in place by carefully attempting to tilt the range forward.
- This range has been designed to meet all recognized industry tip standards for all normal conditions.
- The installation of the anti-tip device must meet all local codes for securing the appliance.

Using the Anti-Tip Bracket Template

- The anti-tip bracket is packaged with an installation template. The instructions include necessary information to complete the installation. Read and follow the range installation instruction sheet.
- Screws c must enter wood or concrete.

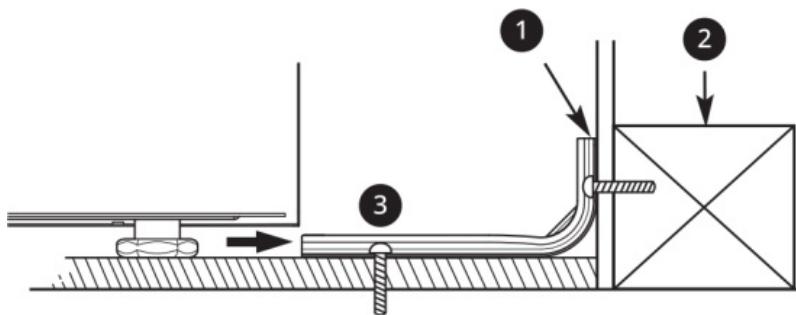

1. Anti-tip bracket
2. Wall plate

Engaging the Anti-tip Device

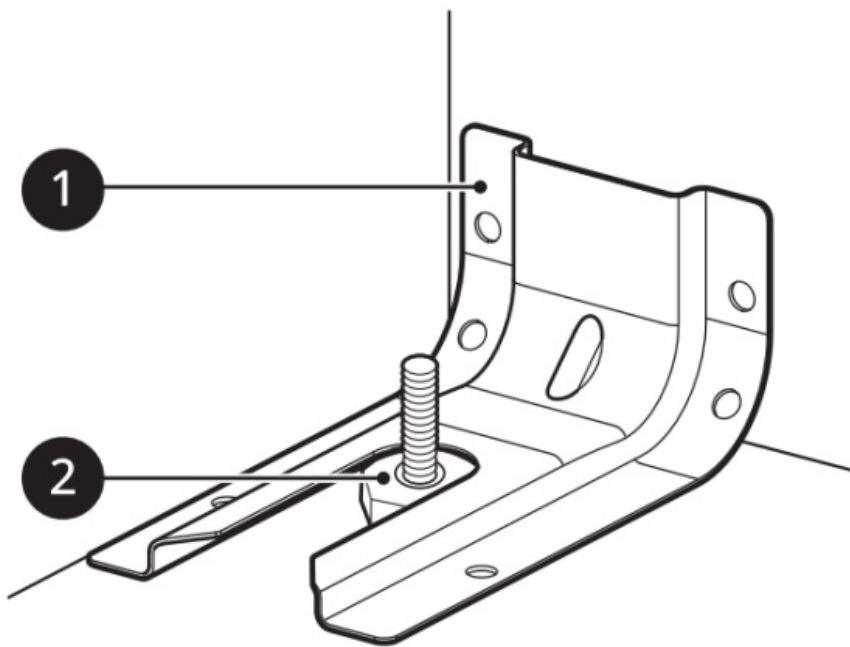

1. Anti-tip bracket

2. Leveling leg

1. Slide the range against the wall, making sure the back leg slides into and engages the anti tip bracket.
 - Make sure the back leg slides into and engages the anti-tip bracket.
2. Check for proper installation by grasping the front edge of the cooktop and carefully attempting to tilt the range forward.

Test Run

Test the Range Before Use

NOTE

- Do not try to light either the Bake or Broil burners during a power outage. The range has an electrical ignition system and cannot be used without power.

Checking Operation of Bake Burners

To check ignition of the Bake burner, follow the steps below:

Model LSGL5833*, LSGL583CF, LSGL5833X

1. Remove all packing materials from inside the oven cavity.
2. Turn oven mode knob to select Bake. 350 °F appears in the display.
 - Make sure the door is closed.
3. Press START.

Model LSGL5831*

1. Remove all packing materials from inside the oven cavity.

2. Press **Bake**. 350°F appears in the display.

(Make sure the door is closed.)

3. Press **START**.

NOTE

- It may take between 30 and 90 seconds for the burner to start heating.

Checking Operation of Broil Burners

To check ignition of the Broil burner, follow the steps below:

Model LSG5833*, LSG583CF, LSG5833X

1. Remove all packing materials from inside the oven cavity.
2. Turn oven mode knob to select Broil. Hi appears in the display.
 - Make sure the door is closed.
3. Press START.

Model LSG5831*

1. Remove all packing materials from inside the oven cavity
2. Press Broil. Hi appears in the display. Make sure the door is closed.
3. Press START.

NOTE

- It may take between 30 and 90 seconds for the burner to start heating.



Documents / Resources

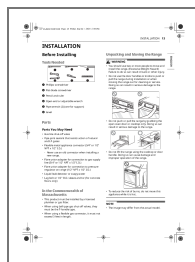

[LG LSG583 Series Smart Slide In Gas Range](#) [pdf] Installation Guide
LSGL5833XSS, LSG5833X, LSG5831, LSG583CF, LSG583 Series Smart Slide In Gas Range, LSG583 Series, Smart Slide In Gas Range, Slide In Gas Range, Gas Range, Range

References

- [User Manual](#)

Manuals+. Privacy Policy

This website is an independent publication and is neither affiliated with nor endorsed by any of the trademark owners. The "Bluetooth®" word mark and logos are registered trademarks owned by Bluetooth SIG, Inc. The "Wi-Fi®" word mark and logos are registered trademarks owned by the Wi-Fi Alliance. Any use of these marks on this website does not imply any affiliation with or endorsement.