



**KNMLB241A R32 Multi
F Multi Position Air
Handling Unit**



LG KNMLB241A R32 Multi F Multi Position Air Handling Unit Owner's Manual

[Home](#) » [LG](#) » LG KNMLB241A R32 Multi F Multi Position Air Handling Unit Owner's Manual 

Contents

- [1 LG KNMLB241A R32 Multi F Multi Position Air Handling Unit](#)
- [2 Product Information](#)
- [3 Product Usage Instructions](#)
- [4 Maintenance](#)
- [5 Performance](#)
- [6 Standard Features](#)
- [7 Optional Accessories](#)
- [8 Controller Options](#)
- [9 Installation Instructions](#)
- [10 Dimension](#)
- [11 FAQ](#)
- [12 Documents / Resources](#)
 - [12.1 References](#)



LG KNMLB241A R32 Multi F Multi Position Air Handling Unit



Product Information

Specifications

- **Model:** KNM LB241A
- **Product Name:** R32 Multi-Position Air Handling Unit
- **Cooling Capacity:** 24,000 Btu/h
- **Heating Capacity:** 27,000 Btu/h
- **Electrical:** 208-230V / 60Hz / 1 Phase, 2.8A
- **Refrigerant Type:** R32
- **Fan Type:** Sirocco
- **Fan Quantity:** 1
- **Air Flow:** 800 CFM (High), 700 CFM (Medium), 580 CFM (Low)
- **External Static Pressure:** 0.1-1.0 in wg
- **Dehumidification Rate:** 4.23 pts/hr

Product Usage Instructions

- Ensure the unit is placed in a well-ventilated area with proper clearance for airflow.
- Connect the liquid and vapor pipes as per the specified sizes and connections.
- Install the temperature sensor in the designated location.
- Use the provided controller options to adjust settings according to your preference.

- Monitor the temperature and adjust fan settings for optimal comfort.
- Refer to the user manual for detailed operating instructions.

Maintenance

- Regularly clean the air filters to ensure efficient operation.
- Schedule professional maintenance checks to keep the unit running smoothly.

Job Name/Location

- Date:.....
- PO No.:.....
- Architect:.....
- Engr:.....
- Rep:.....
- For:..... File Resubmit Approval Other
- GC:.....
- Mech:.....

KNMLB241A

- R32 Multi F Multi-Position Air Handling Unit 24,000 Btu/h Indoor Unit

Performance

- Nominal Cooling Capacity (Btu/h): 24,000
- Nominal Heating Capacity (Btu/h): 27,000
 - Cooling Nominal Test Conditions:
 - Indoor: 80°F DB / 67°F WB
 - Outdoor: 95°F DB / 75°F WB
 - Heating Nominal Test Conditions:
 - Indoor: 70°F DB / 60°F WB
 - Outdoor: 47°F DB / 43°F WB

Electrical

- Power Supply (V/Hz/Ø)^{1,2}: 208-230 / 60 / 1
- Rated Amps (A): 2.8

Piping

- Installed Liquid Pipe (in., O.D.): 1/4 Flare
- Installed Vapor Pipe (in., O.D.): 1/2 Flare
- Liquid Connection (in., O.D.): 1/4 Flare

- Vapor Connection (in., O.D.): 1/2 Flare
- Drain (in., O.D. / I.D.): 3/4 FPT
- Temperature Sensor: Thermistor

Standard Features

- Access Panel for Field Supplied Air Filter

Controls Features

- Inverter (variable speed fan)
- Hot start
- Self-diagnosis
- Soft dry operation
- Auto operation
- Auto restart
- Sleep mode
- Timer (on/off/weekly)
- R32 leak detection sensor
- Integrated connections for 3rd third-party thermostat
- ECM fan provides constant airflow regardless of the permitted ESP

Optional Accessories

- Single-Port Shutoff Valve – PRHPZ010A
- Auxiliary Heater Kit – PRARH14
- Electric Heater Kits – ANEHxx3Cx⁵
- Downflow Conversion Kit – PNDFA0
- Wi-Fi Module – PWFMDD200

Controller Options

- MultiSITE™ CRC* Controllers
- Simple Remote Controllers
- Standard III Remote Controllers
- Deluxe Remote Controller
- Wireless Remote Controller⁶
- Remote Temperature Button Sensor
- Dry Contacts

Entering Mixed Air

- Cooling (°F WB): 57 ~ 77
- Heating (°F DB): 59 ~ 81

Unit Data

- Refrigerant Type: R32
- Refrigerant Control: EEV
- Sound Pressure (H/M/L) dB(A)³: 36 / 33 / 29
- Filter Dimensions⁷ (in): 16 x 20 x 1
- Net Weight (lbs.): 115.3
- Shipping Weight (lbs.): 127.4

Fan

- Type: Sirocco
- Quantity: 1
- Motor/Drive: Brushless Digitally Controlled / Direct
- Air Flow H/M/L (CFM): 800 / 700 / 580
- Minimum~Maximum External Static Pressure⁸ (in wg): 0.1~1.0
- Fan Setting Value: N/A – Constant Flow
- Dehumidification (pts./hr.): 4.23

Notes

1. Acceptable operating voltage: 187V-253V.
2. The power wiring and the communication wiring from the outdoor unit to the indoor unit, or from the branch distribution unit to the indoor unit, is field supplied and must be stranded, shielded or unshielded (if shielded, it must be grounded to the chassis of the outdoor unit only). All wiring must comply with applicable local and national codes.
 - a. Power wiring and communication wiring from outdoor unit to indoor unit (No. x AWG) 3 x 14 / 2 x 18.
 - b. Power wiring and communication wiring from the branch distribution unit to the indoor unit (No. x AWG) 3 x 14 / 2 x 18.
3. Sound Pressure levels are tested in an anechoic chamber under ISO Standard 3745.
4. If a Third-Party Dry Contact and an LG internal heater or an LG Auxiliary Heater Kit is installed, supplemental heat capability cannot be controlled by the Third-Party Thermostat.
5. Electric heater accessory is available in 3/5/8kW capacities for the 12MBH AHU, 3/5/8/10kW capacities for 18-30MBH AHUs, and 3/5/8/10/15kW capacities for the 36MBH AHU. Refer to the engineering manual for details.
6. Requires an LG wall controller because Multi-Position Air Handling Units do not have an infrared receiver.
7. Actual filter sizes may vary.
8. Maximum static pressure may result in reduced airflow (CFM).
9. See the Engineering Manual for sensible and latent capacities.
10. The indoor unit comes with a dry helium charge.
11. Corresponding refrigerant piping length is in accordance with the standard length of each outdoor unit and the level difference is 0 ft. All capacities are net with a combination ratio between 95% and 105%.
12. Must follow the installation instructions in the applicable LG installation manual.



For a complete list of available accessories, contact your LG representative.

For continual product development, LG reserves the right to change specifications without notice.

© LG Electronics U.S.A., Inc., Englewood Cliffs, NJ. All rights reserved. "LG Life's Good" is a registered trademark of LG Corp. /www.lghvac.com

Installation Instructions

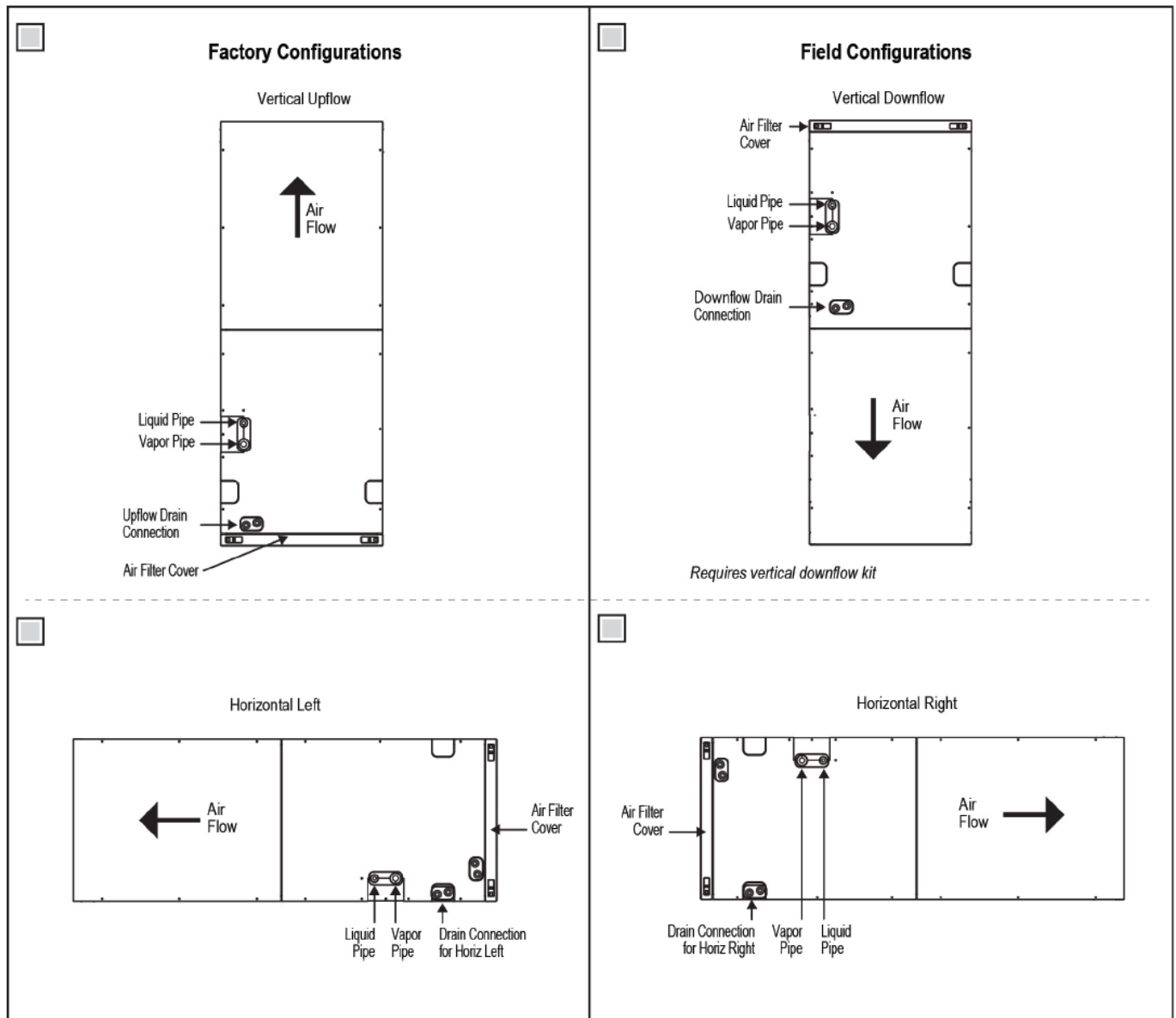

Dimension

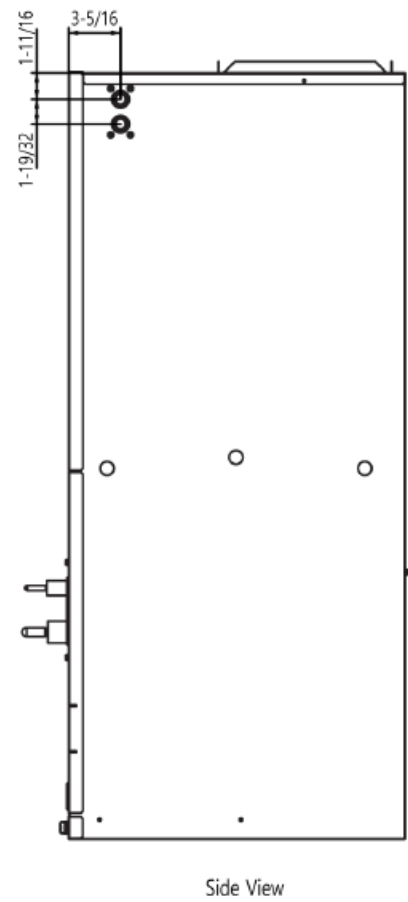
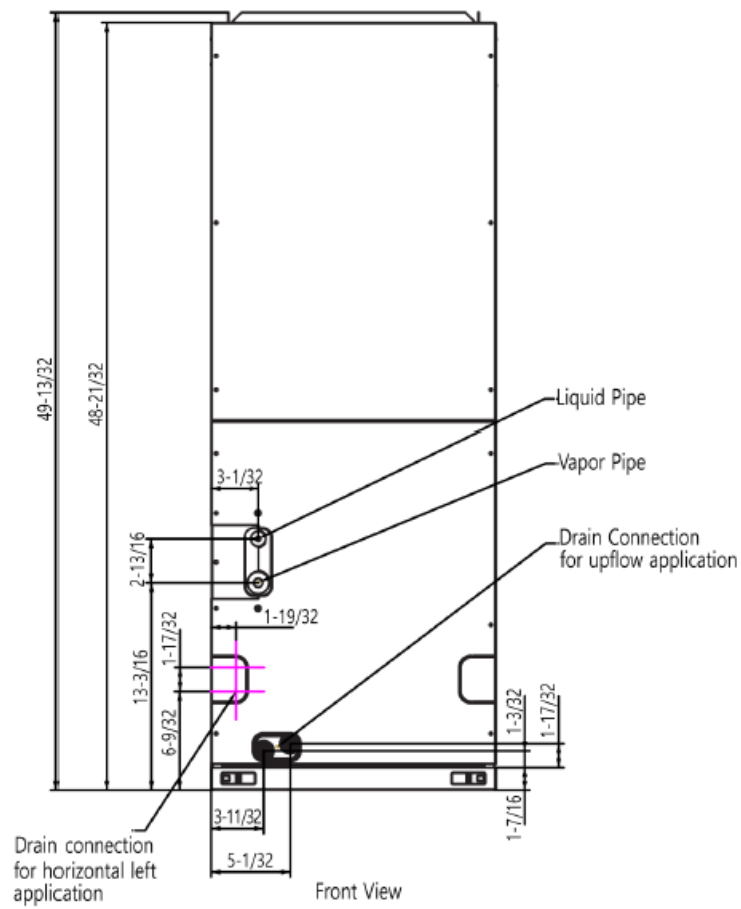
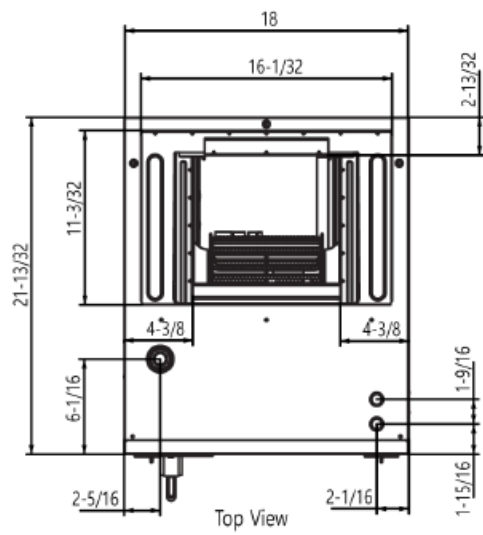

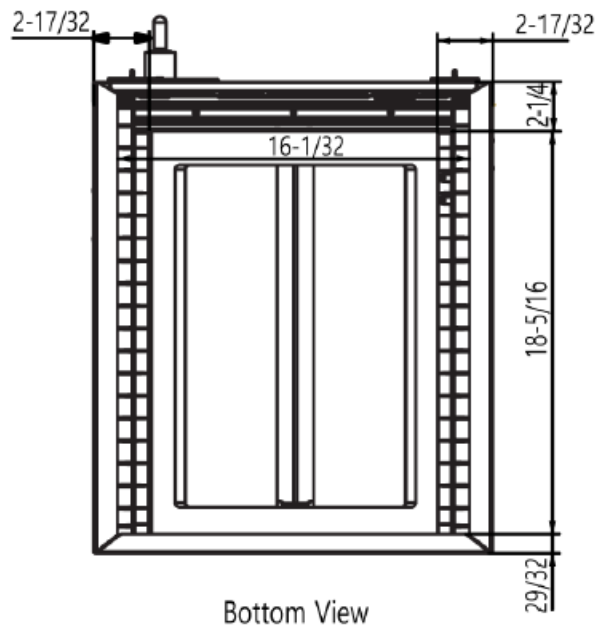

For continual product development, LG reserves the right to change specifications without notice.
 © LG Electronics U.S.A., Inc., Englewood Cliffs, NJ. All rights reserved. "LG Life's Good" is a registered trademark of LG Corp. /www.lghvac.com

FAQ

- **Q: Can I install additional accessories to this unit?**
 - **A:** Yes, you can add optional accessories like Single-Port Shutoff Valve, Auxiliary Heater Kit, Electric Heater Kits, Downflow Conversion Kit, and Wi-Fi Module for added functionalities.
- **Q: What should I do if the unit malfunctions?**
 - **A:** If you encounter any issues with the unit, refer to the troubleshooting section in the manual or contact customer support for assistance.

Documents / Resources

	<p>LG KNMLB241A R32 Multi F Multi Position Air Handling Unit [pdf] Owner's Manual KNMLB241A, KNMLB241A R32 Multi F Multi Position Air Handling Unit, R32 Multi F Multi Position Air Handling Unit, Multi F Multi Position Air Handling Unit, Multi Position Air Handling Unit, Air Handling Unit</p>
---	---

References

- [User Manual](#)

[Manuals+](#), [Privacy Policy](#)

This website is an independent publication and is neither affiliated with nor endorsed by any of the trademark owners. The "Bluetooth®" word mark and logos are registered trademarks owned by Bluetooth SIG, Inc. The "Wi-Fi®" word mark and logos are registered trademarks owned by the Wi-Fi Alliance. Any use of these marks on this website does not imply any affiliation with or endorsement.