



LEXIN GTX Motorcycle Bluetooth Intercom User Guide

[Home](#) » [LEXIN](#) » LEXIN GTX Motorcycle Bluetooth Intercom User Guide

Contents [[hide](#)]

- [1 LEXIN GTX Motorcycle Bluetooth Intercom](#)
- [2 Download User Manual Online](#)
- [3 Watch Instruction Video Online](#)
- [4 Features](#)
- [5 The GTX is compliant with Bluetooth Specification VS.O supporting the following profiles:](#)
- [6 Package Contents](#)
- [7 Installation Instructions](#)
- [8 Mounting the GTX Unit](#)
- [9 Documents / Resources](#)
- [10 Related Posts](#)

LEXIN[®]

LEXIN GTX Motorcycle Bluetooth Intercom



[Download User Manual Online](#)

For Online User Manual in English, Spanish, German, Italian, French, and Japanese ... Visit www.lexinmotorcycle.com, Go to Support- User Manual, and select "GTX".

Watch Instruction Video Online

Subscribe to our YouTube channel@lexinmoto, and find "GD<" Instruction videos

Features

Thank you for choosing the GD< Motorcycle Bluetooth Intercom

- Bluetooth 5.0
- Connect to GPS Navigation
- Siri and other voice assistants
- USB-C quick charge equipped
- Universal pairing with most Bluetooth Intercom
- 10 ways Bluetooth intercom conference, Up to 2 kilometers/1.2 miles range
- Optional pattern shell
- Play music
- Hands-free calling
- Built-in CVC/DSP noise reduction

The GTX is compliant with Bluetooth Specification VS.O supporting the following profiles:

Headset Profile (HSP), Hands-Free Profile (HFP), and Advanced Audio Distribution Profile (A2DP). It supports universal pairing with almost all Bluetooth headsets on the market.

Headset

The GTX has a high-definition 36MM stereo headset and an outstanding built-in CVC/DSP intelligent noise reduction microphone. These designs are suitable for most open, face-off, full-face, and off-road helmets.

Battery

The GTX features an 800 mAh battery which can provide the intercom device with 18 hours of music or 13 hours of intercom conference with over one week of standby time. Function Priority: (The GD< operates in the following order of priority)

1. Mobile phone
2. intercom Talk
3. Music/GPS

Note:

A lower-priority function is always interrupted by a higher-priority function. For example, stereo music can be interrupted by an intercom call, intercom talk can be interrupted by an incoming phone call.

WARNING

PLEASE CHECK ALL LOCAL LAWS AND REGULATIONS REGARDING THE USE OF IN-HELMET SPEAKERS WHILE OPERATING MOTORIZED VEHICLES.

Package Contents

- GD< Main Unit
- Package
- Speaker Pad
- Mounting Bracket
- Boom/Button Microphones
- 36MM HD Ultra-Slim Speakers
- Boom Microphone Holder
- USB-C Cable
- 3M Tape Bracket
- User Manual
- Quick Guide
- Pattern Shell

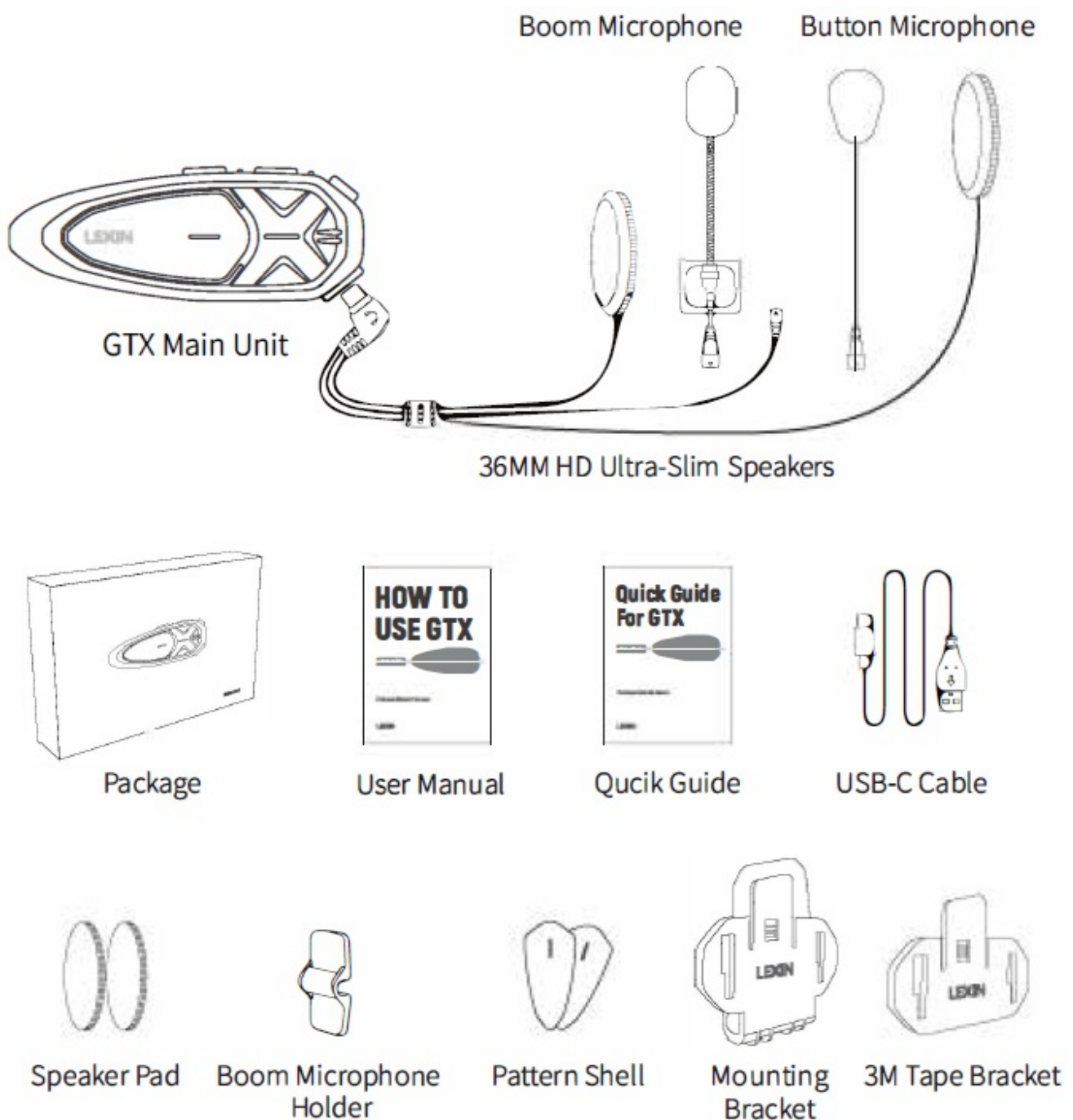

Installation Instructions

Installing Bracket for GTX to Helmet

1. Clamp installation: Open the clamp and insert it into the helmet wall. (As shown on the right)

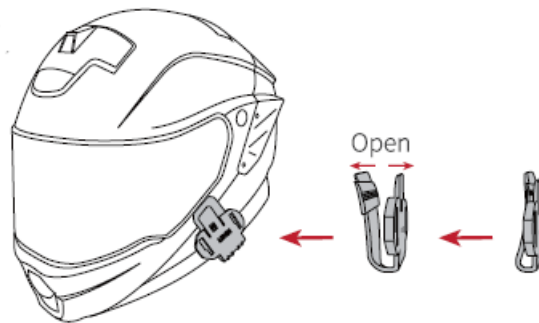

2. Install by 3M Tape mounting bracket: Except for using the clamp mounting bracket, you can also use the 3M mounting bracket instead. First, tear off the protective paper on the back of the 3M tape, then stick the 3M mounting bracket to a suitable position on the left side of the helmet. Press for 15 seconds to allow the glue 24 hours to dry. (As shown on the left).

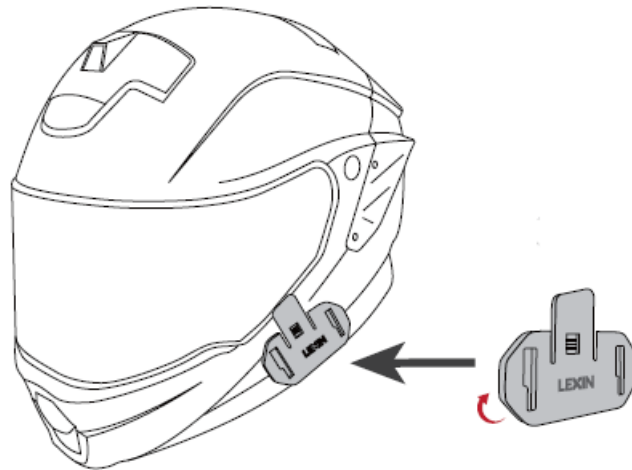

Note:

Even though the 3M Tape bracket is provided for convenience, LEXIN recommends using the bracket mounting. The 3M Tape bracket is an option that you may use at your own risk and responsibility. LEXIN does not assume any responsibility for its use.

Mounting the GTX Unit

Align the square column on the back of the main unit with the square hole of the base. Slide the main unit down onto the bracket until it clicks firmly into the bottom portion of the bracket. (As shown on the right).

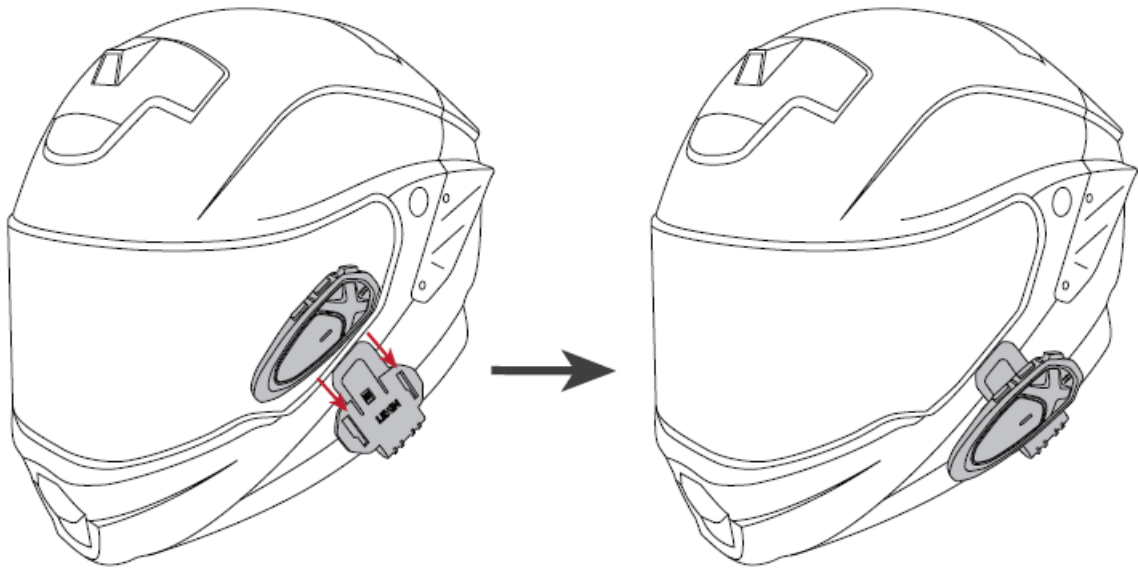

Documents / Resources

	<p>LEXIN GTX Motorcycle Bluetooth Intercom [pdf] User Guide GTX, 2ARGO-GTX, 2ARGOGTX, Motorcycle Bluetooth Intercom, GTX Motorcycle Bluetooth Intercom</p>
	<p>LEXIN GTX Motorcycle Bluetooth Intercom [pdf] User Manual GTX, 2ARGO-GTX, 2ARGOGTX, Motorcycle Bluetooth Intercom, GTX Motorcycle Bluetooth Intercom</p>