



# Lexibook NTL2000 Instant Voice Translator Instruction Manual

[Home](#) » [Lexibook](#) » Lexibook NTL2000 Instant Voice Translator Instruction Manual 

## Contents

- [1 Lexibook NTL2000 Instant Voice Translator](#)
- [2 Precautions of use](#)
- [3 PRODUCT DESCRIPTION](#)
- [4 POWER SOURCES](#)
- [5 SETTINGS MENU](#)
- [6 TRANSLATE MODE](#)
- [7 CONFERENCE MODE](#)
- [8 SPECIFICATIONS](#)
- [9 WARRANTY](#)
- [10 WIFI CONNECTION](#)
- [11 MOBILE NETWORK CONNECTION \(Wi-Fi hotspot\)](#)
- [12 FREQUENTLY ASKED QUESTIONS](#)
- [13 VIDEO – PRODUCT OVERVIEW](#)
- [14 References](#)
- [15 Related Posts](#)



**Lexibook NTL2000 Instant Voice Translator**



**WARNING:** All packaging materials, such as tape, plastic sheets, wire ties, and tags are not part of this product and should be discarded.

### Precautions of use

- Keep a minimum distance around the device for sufficient ventilation;
- The ventilation should not be impeded by covering the ventilation openings with items, such as newspapers, table-cloths, curtains, etc.;
- No naked flame sources, such as lighted candles, should be placed on the apparatus;
- Use the apparatus in tropical and/or moderate climates.
- Batteries should be disposed of properly. Take them to the collection container in order to protect the environment.

### PRODUCT DESCRIPTION

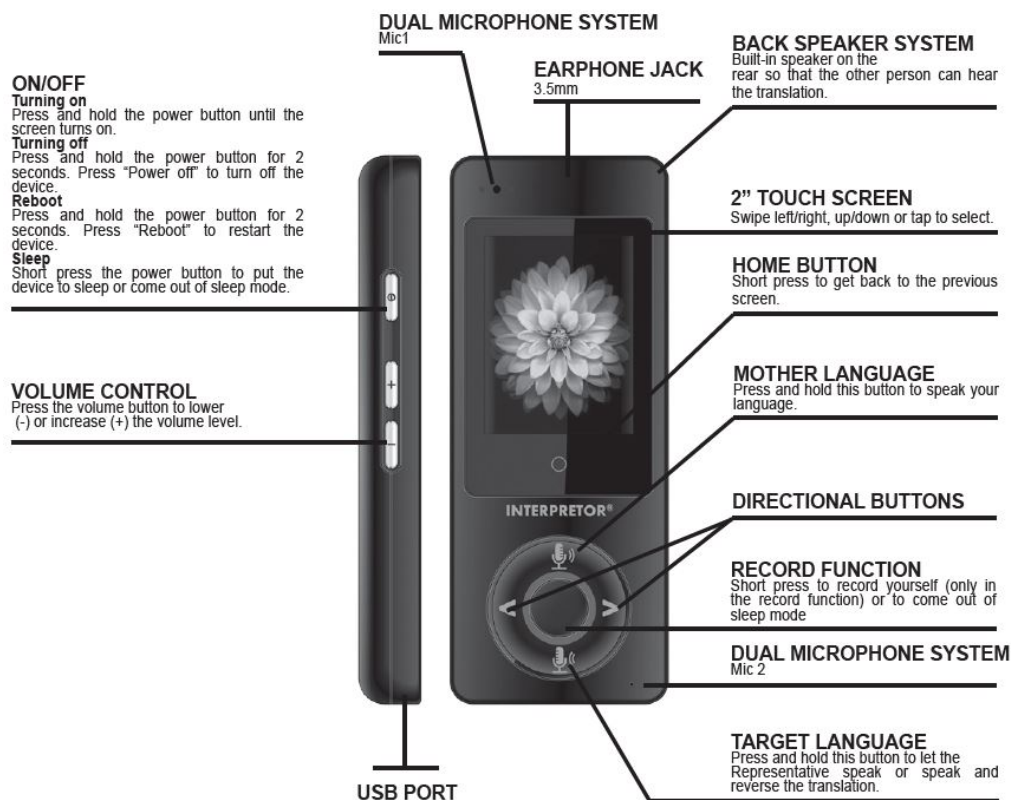

## LANGUAGE LIST

**List of available languages:** ARABIC (SAUDI ARABIA, EGYPT), BULGARIAN, CANTONESE, CATALAN, CHINESE, CHINESE (Taiwan), CROATIAN, CZECH, DANISH, DUTCH, ENGLISH (AUSTRALIA/CANADA/INDIA/IRELAND/UNITED KINGDOM/UNITED STATES), FINNISH, FRENCH (FRANCE/CANADA), GERMAN, GREEK, HEBREW, HINDI, HUNGARIAN, ICELANDIC, ITALIAN, JAPANESE, KOREAN, NORWEGIAN, POLISH, PORTUGUESE (PORTUGUAL/BRASIL), RUMANIAN, RUSSIAN, SERBIAN, SINHARA (TAMIL), SLOVAKIAN, SLOVENIAN, SPANISH (SPAIN/MEXICO), SWEDISH, THAI, TURKISH and UKRAINIAN.

**Note:** Languages and data are continuously improved and added to the database. Updates are delivered over the air directly to your device to provide more languages and translations.

## POWER SOURCES

Please charge the battery before using your Interpreter® for the first time or when the battery is low. Insert one end of the micro USB charging cable (included) into the USB port and the other end to a powered computer or a USB adapter (not included) connected to a power outlet.

## WARNING

- Risk of explosion if the battery is incorrectly replaced. Please only replace it with the same or equivalent battery (Instructions for repair service only; battery is not intended to be replaced by the user).
- The battery should not be exposed to high temperatures, such as sunlight, fire, or anything similar.
- Significant electromagnetic interference or electrostatic discharges may cause the device to malfunction or lose data. If the device is not functioning correctly, switch it off and then on again, or unplug the USB cable.

## SETTINGS MENU

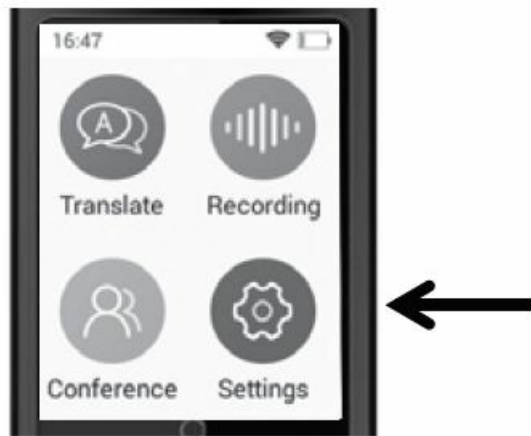

Select the Settings mode in the menu to control the parameters. The following settings are available:

1. Wifi
2. Mode (Auto/operation)
3. Bluetooth
4. Languages: Arabic, Chinese, Dutch, English, French, German, Italian, Portuguese, Russian, Spanish.
5. Display
6. Date and time
7. Reset
8. Firmware upgrade
9. Storage
10. About us

## TRANSLATE MODE

Translation is possible online through Wi-Fi as well as offline (Offline translation in 7 languages: French, English, German, Italian, Spanish, Portuguese and Chinese).



1. In the top bar, select the source language (on the left) and target language (on the right).
2. Mother language: Press and hold the Mother language button. Talk when the mic icon appears on the screen. Release the button when you are done talking. The device displays the written translation on the screen simultaneously. To listen to the audio translation again, press the translation on the screen. Press on the translation for 2 seconds to show the different options: you can save the translation as favorite, delete the

translation or clear all translation history.

3. Proceed the same way for the Target language.

## CONFERENCE MODE

**NOTE :** A minimum of 2 devices (in online mode) are required for the conference mode.

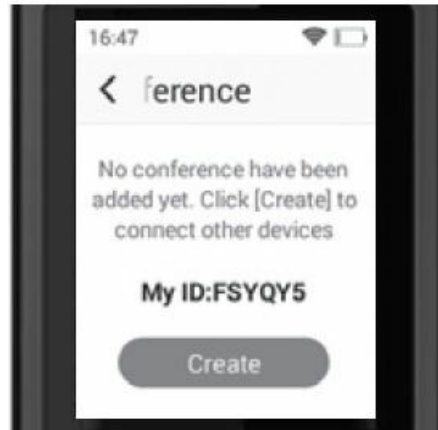

### Creating a conference

1. From the Home screen, select the « Conference » mode. The device will generate a code to share with the other participants.
2. To create a new conference, press Create and input the code of the other members in the user field. The device will generate a new conversation.

### Settings of the conference

Once the conference is created, press the 3 points on the upper right of the screen to open the settings.

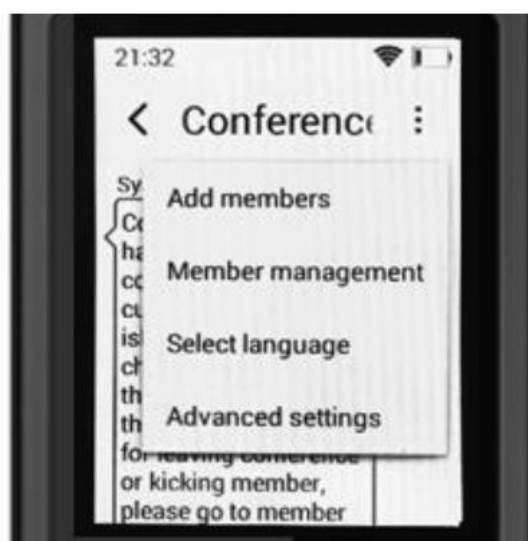

### Note:

- Only the administrator can lock the group, remove participants or change the Administrator.
- Participants can back up the conversation or leave the group.

## Group conversation

Press and hold the “Mother language” button and start talking. Interpreter® will translate your words and send the voice translation to the connected devices into the languages set by the representatives. The representatives will hear the voice translation and see the written translation on the screen. Use the earphone jack to keep your conversations private!



## SPECIFICATIONS

- **Battery:** Lithium battery 3.7V  $\equiv$  1000mAh
- **Input power:** USB DC 5V  $\equiv$  1A
- **Unit dimensions:** 113 x 43 x 12 mm
- **System:** Android 4.4
- **USB port:** Micro USB port
- **Memory:** 1.8 Gb Wifi
- **Frequency range:** 2.4G
- **single frequency** 2412 – 2472 MHz 802.11 b/g/n Bluetooth®
- **Frequency range:** 2402 – 2480 MHz
- **Power Transmission:** WiFi: -6 – 0dBm
- **Bluetooth:**  $\leq$  20dBm

We, Lexibook® S.A. Bât 11., 6 avenue des Andes 91940 Les Ulis – France

- **Kind of product:** Voice translator
- **Type designation:** NTL2000

Hereby, Lexibook Limited declares that the radio equipment type NTL2000 is in compliance with Directive 2014/53/EU. The full text of the EU declaration of conformity is available at the following internet address:  
[http://www.lexibook.com/doc/ntl2000/ntl2000\\_1.pdf](http://www.lexibook.com/doc/ntl2000/ntl2000_1.pdf)



Yiu Wai Man Product Development Manager Hong Kong

## WARRANTY

To prevent fire or shock hazard, disconnect your unit from the power source when cleaning. Use a soft, clean cloth moistened with plain, lukewarm water to clean the exterior of the unit.

This product is covered by our 2 years warranty program.

**NOTE:** Please keep this instruction manual, it contains important information. Reference: NTL2000 Designed and developed in Europe – Made in China

© Lexibook® Lexibook S.A. 6 avenue des Andes, Bâtiment 11 91940 Les Ulis- France United Kingdom & Ireland For after-sales service, please contact us at [savcomfr@lexibook.com](mailto:savcomfr@lexibook.com).

## Environmental Protection

Unwanted electrical appliances can be recycled and should not be discarded along with regular household waste! Please actively support the conservation of resources and help protect the environment by returning this

appliance to a collection centre (if available).



Correct disposal of batteries in this product (Applicable in countries with separate collection systems) This symbol means that the product contains a built-in rechargeable battery covered by European Directive 2013/56/EU which cannot be disposed of with normal household waste. All batteries should be disposed separately from the municipal waste stream via designated collection facilities appointed by the government or the local authorities. The correct disposal of your old batteries will help to prevent potential negative consequences for the environment, animal and human health. We strongly advise you to take your product to an official collection point or service center to have a professional remove the rechargeable battery. Inform yourself about the local separate collection system for electrical and electronic products and rechargeable batteries. Follow local rules and never dispose of the product and rechargeable batteries with normal household waste. For more detailed information about disposal of your old batteries, please contact your city office or waste disposal service centre.

## WIFI CONNECTION

We recommend that you use the Wi-Fi connection in order to have access to all 45 languages of this device and for better quality of translation.

1. From your Home screen, press the “Settings” key.

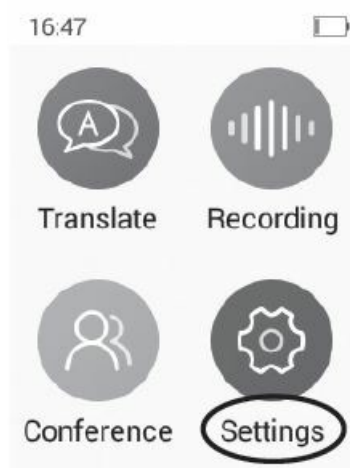

2. Select “WIFI”.

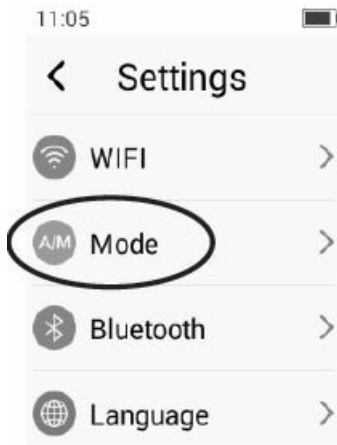

3. Turn on Wi-Fi. Interpretor® will automatically search for available Wi-Fi networks. Tap the name of the Wi-Fi network that you want to join.



4. If necessary, enter the password and confirm.

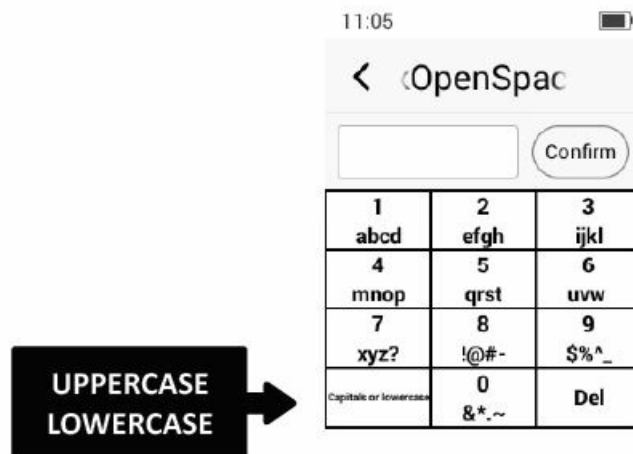

**Notes:**

- It is important to take into account the uppercase and lowercase letters when entering the password.
- The password needs to be entered once; the device will retain the name of the network and will connect to it automatically the following times.



5. Your device is connected when the WIFI icon appears at the top of your screen.





**Note:** You can go back to the main menu at any time using the arrow at the top of the screen or the button  below the screen.

## MOBILE NETWORK CONNECTION (Wi-Fi hotspot)

### Turn on connection sharing on your mobile phone

Activate the connection sharing function (or Wifi Hotspot, mobile hotspot) from your mobile settings. It will become a Wi-Fi network that will be detectable by other devices.

**Note:** Some devices do not have the Connection Sharing feature. Contact your carrier for more information.

### Personal hotspot with iOS (iPhone)

- Go to Settings> Cellular > Personal hotspot or Settings> Personal Hotspot and make sure that it's on.
- Verify the Wi-Fi password and name of the phone.
- Stay on this screen until you've connected your other device to the Wi-Fi network. Share a mobile connection with Android (other models)
- Open your phone's Settings app.
- Tap Network & internet > Hotspot & tethering > Wi-Fi hotspot.
- Turn on Wi-Fi hotspot.

**Note:** Other devices' interfaces and processes may differ depending on who made them.

### Log in from your INTERPRETOR®

Follow the steps in the "WI-FI CONNECTION" section by choosing your phone's name as the Wi-Fi network.

**Note:** In Android, by default the name of your mobile network will be "AndroidAP".



Some mobile carriers limit or charge extra for tethering. We recommend checking with your carrier.

## **OFFLINE MODE**

This mode allows you to access certain translations without connection (Translation in 7 languages: German, English, Chinese, Spanish, French, Italian and Portuguese). We advise you to use it for words only or simple sentences.

## **FREQUENTLY ASKED QUESTIONS**

What is the Lexibook NTL2000 Instant Voice Translator?

The Lexibook NTL2000 Instant Voice Translator is a device designed to provide instant translation of spoken language. It uses voice recognition and translation technology to assist users in communicating across different languages in real-time.

How does the NTL2000 Voice Translator work?

The Lexibook NTL2000 Instant Voice Translator works by capturing spoken words using its microphone, processing the audio through speech recognition algorithms, and then translating the recognized speech into the selected target language. The translated text or voice output helps users understand and communicate effectively in multilingual settings.

How many languages does the NTL2000 Translator support?

The number of languages supported by the Lexibook NTL2000 Instant Voice Translator can vary. It is designed to support multiple languages, including commonly spoken languages worldwide. Check the product specifications or user manual for the list of supported languages.

Can the NTL2000 Translator handle real-time conversations?

Yes, the Lexibook NTL2000 Instant Voice Translator is typically designed to handle real-time conversations. It allows users to engage in spoken conversations with individuals who speak different languages by providing instant translations for smooth communication.

Is the NTL2000 Translator suitable for travel?

Yes, the Lexibook NTL2000 Instant Voice Translator is suitable for travel. Its compact and portable design makes it convenient for use in various travel scenarios, such as navigating unfamiliar locations, interacting with locals, and overcoming language barriers during trips.

Does the NTL2000 Translator require an internet connection?

The Lexibook NTL2000 Instant Voice Translator may or may not require an internet connection, depending on the specific model and features. Some voice translators operate offline, while others rely on an internet connection for real-time translation and access to language databases. Check the product specifications for information on connectivity.

What is the battery life of the NTL2000 Voice Translator?

The battery life of the Lexibook NTL2000 Instant Voice Translator can vary based on usage patterns and features. It is typically powered by a rechargeable battery. Refer to the product specifications for information on the estimated battery life and charging options.

Can the NTL2000 Translator translate written text?

The primary function of the Lexibook NTL2000 Instant Voice Translator is to translate spoken language. While some models may have additional features for translating written text, the main focus is on providing instant translations for spoken words and phrases.

Is the NTL2000 Translator suitable for business meetings?

Yes, the Lexibook NTL2000 Instant Voice Translator can be suitable for business meetings where participants speak different languages. It enables effective communication by providing instant translations, facilitating smoother discussions and collaborations in multilingual settings.

What is the translation accuracy of the NTL2000 Translator?

The translation accuracy of the Lexibook NTL2000 Instant Voice Translator can depend on various factors, including the quality of the speech recognition algorithms, the number of supported languages, and the context of the conversation. While these devices aim for high accuracy, users may experience variations in different scenarios.

Can the NTL2000 Translator be customized for specific phrases?

The extent to which the Lexibook NTL2000 Instant Voice Translator can be customized for specific phrases may vary. Some models may allow users to input and save custom phrases for quick translation, while others may have predefined phrase databases. Check the product specifications for information on customization features.

Is the NTL2000 Translator suitable for language learning?

Yes, the Lexibook NTL2000 Instant Voice Translator can be used for language learning purposes. It provides real-time translations, allowing users to hear and practice correct pronunciations. The device's multilingual capabilities make it a useful tool for language learners looking to improve their conversational skills.

What is the storage capacity of the NTL2000 Translator?

The storage capacity of the Lexibook NTL2000 Instant Voice Translator may vary, and it is typically associated with the device's ability to store custom phrases, settings, or usage history. Check the product specifications for information on the storage capacity and any available storage expansion options.

Can the NTL2000 Translator be used in noisy environments?

The performance of the Lexibook NTL2000 Instant Voice Translator in noisy environments can depend on its microphone quality and noise-canceling features. Some models are equipped with advanced microphones to enhance voice capture and translation accuracy in challenging acoustic environments.

Is the NTL2000 Translator compatible with smartphones?

The Lexibook NTL2000 Instant Voice Translator may or may not be compatible with smartphones, depending on the model and connectivity options. Some voice translators offer smartphone integration through dedicated apps or Bluetooth connectivity. Check the product specifications for details on smartphone compatibility.

What is the warranty coverage for the NTL2000 Voice Translator?

The warranty typically range from 1 year to 2 years.

## VIDEO – PRODUCT OVERVIEW



[Download the PDF link Lexibook NTL2000 Instant Voice Translator Instruction Manual Voice-Translator-Instruction-Manual.mp4](#)

---

## References

- [User Manual](#)