



# Lexco LXEL05-RCM Fixed Recessed Non Maintained Emergency LED Down Light Instruction Manual

[Home](#) » [Lexco](#) » Lexco LXEL05-RCM Fixed Recessed Non Maintained Emergency LED Down Light Instruction Manual 

# LEXCO

LXEL05-RCM Fixed Recessed Non Maintained  
Emergency LED Down Light  
Instruction Manual

## Contents

- [1 Emergency LED Downlight](#)
- [2 Parts](#)
- [3 You will need](#)
- [4 Care & maintenance](#)
- [5 Safety](#)
- [6 Technical Data](#)
- [7 Guarantee](#)
- [8 Installation](#)
- [9 Testing Record](#)
- [10 Self Test](#)
- [11 Lens Replacement](#)
- [12 Documents / Resources](#)
  - [12.1 References](#)

**Emergency LED Downlight**

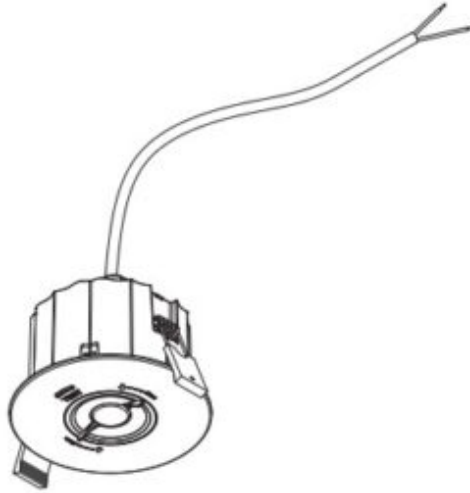
**A****B**

**IMPORTANT** – These instructions are for your safety. Please read through them thoroughly prior to handling the product and retain them for future reference.

**SFOC300/ST**

5059340964379

V20724\_5059340964379\_MAND2\_2324

## Parts

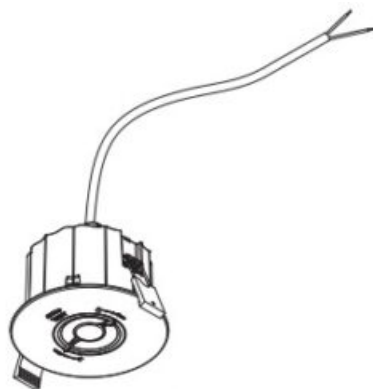

**01. x1**

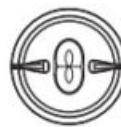

**02. x1**



**04. x1**



**03. x2**



**05. x2**

**You will need**

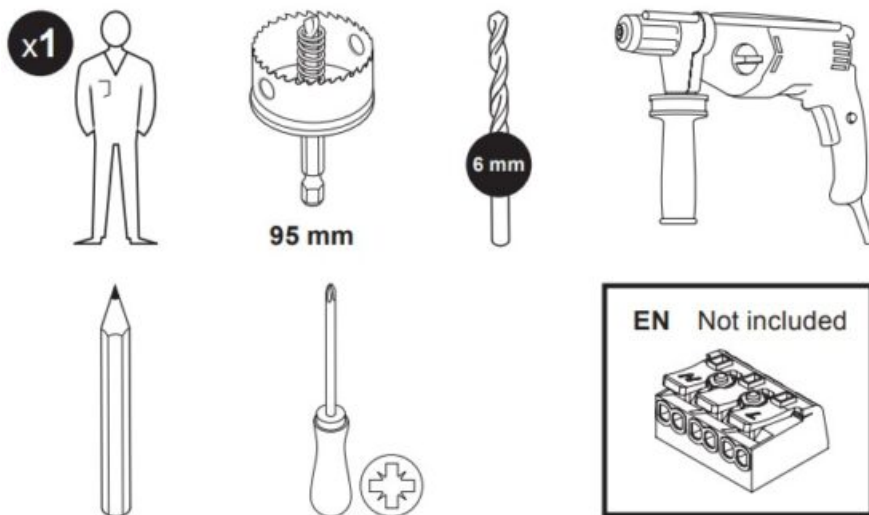

## Care & maintenance

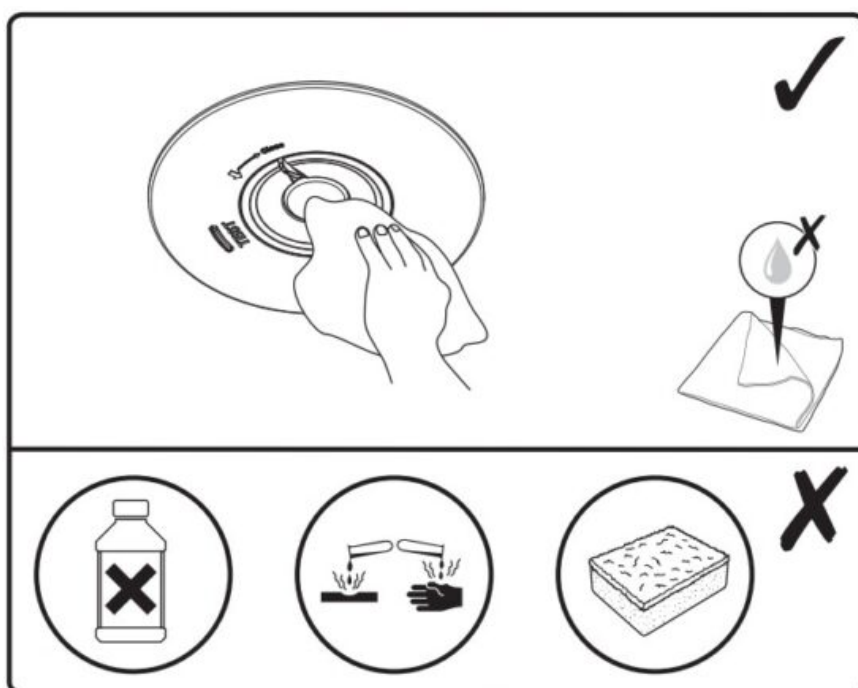







## Safety



- **IMPORTANT** Do not use with a dimmer switch.
- **IMPORTANT**, Retain for future reference: read carefully.
- These instructions are for your safety. Please read through them thoroughly prior to installation and retain them for future reference.
- All fittings must be installed by a competent person in accordance with local regulations (IET wiring regulation BS7671).
- Check the pack and make sure you have all of the parts listed.
- Remove all packaging, wrap etc from the product.
- Decide on the appropriate location for your product.
- Always avoid the product to be located at corrosive environment.

- **IMPORTANT:** The fixing point(s) selected must be capable of supporting the full weight of the light fitting.
- Always refer to the installation drawing for the orientation of the product.
- Take care not to drill into any pipes or mains cables beneath the surface during mounting holes preparation.
- Wiring diagram is for reference only. Always refer to the terminal marking for wiring. Ensure that all electrical connections are tight and that no loose strands are left out of the terminal block.
- Never put anything on the product or hang anything on any part of this product.
- It is always recommended to cut the hole slightly smaller than the size specified, and then file the hole until the recessed unit fits snugly.
- Never use the terminal cables to bear the product weight.
- When the product does not light after installation:
  - > Ensure there is no electricity failure
  - > Ensure all the connections are secured
- If you have any doubt about installation/use of this product, consult a qualified electrician.
- Always disconnect the product from mains at least 10 minutes allowing to cool down before any maintenance or adjustment.
- It is recommended to have a regular schedule of care and maintenance to keep the surface condition well.
- Terminal block not included. Installation must be performed by a qualified person.

## Technical Data

Supply voltage:	220-240 V~, 50 Hz
Bulb Type:	LED (1.6 W) The light source of this luminaire is not replaceable; when the light source reaches its end of life the whole luminaire shall be replaced. Do not stare at the operating light source.
Operation ambient temperature (ta):	0 °C to 45 °C
Battery:	Charging time: 24 hours Type: 1 x 3.2 V 3300 mAh 26650 LiFePO4 0-60°C. Replace only with the same or equivalent type.
	This product complies with conformity requirements of the applicable European Regulations or Directives.
	This product complies with conformity requirements of the applicable UK Regulations.
	Class II product – Double Insulated – No earth required.
	For indoor use only.
IP20	Protected against access with a finger.
	Waste electrical products should not be disposed of with household waste. Please recycle where facilities exist. Check with your Local Authority or local store for recycling advice.
	Do not use with a dimmer switch.
xxWyy:	xx-year; yy-week of the year.

## Guarantee

We take special care to select high quality materials and use manufacturing techniques that allow us to create products incorporating design and durability. This product has a manufacturer's guarantee of 7 years (4 years for battery pack) against manufacturing defects, from the date of purchase (if bought in store) or date of delivery (if bought online), at no additional cost for normal use.

To make a claim under this guarantee, you must present your proof of purchase (such as a sales receipt, purchase invoice or other evidence admissible under applicable law), please keep your proof of purchase in a safe place. For this guarantee to apply, the product you purchased must be new, it will not apply to second hand or display products. Unless stated otherwise by applicable law, any replacement product issued under this guarantee will only be guaranteed until expiry of the original period guarantee period.

This guarantee covers product failures and malfunctions provided the product was used for the purpose for which it is intended and subject to installation, cleaning, care and maintenance in accordance with the information contained in these terms and conditions, in the user manual and standard practice, provided that standard practice does not conflict with the user manual.

This guarantee does not cover defects and damage caused by normal wear and tear or damage that could be the

result of improper use, faulty installation or assembly, neglect, accident, misuse, or modification of the product. Unless stated otherwise by applicable law, this guarantee will not cover, in any case, ancillary costs (shipping, movement, costs of uninstalling and reinstalling, labour etc), or direct and indirect damage.

If the product is defective, we will replace or refund, within a reasonable time.

Rights under this guarantee are enforceable in the country in which you purchased this product. Guarantee related queries should be addressed to the store you purchased this product from.

The guarantee is in addition to and does not affect your statutory rights.

**Manufacturer:**

**UK Manufacturer:**

Kingfisher International Products Limited,  
1 Paddington Square, London, W2 1GG,  
United Kingdom

**EU Manufacturer:**

Kingfisher International Products B.V.,  
Rapenburgerstraat 175E,  
1011 VM Amsterdam,  
The Netherlands

**EN** [www.diy.com](http://www.diy.com)

[www.screwfix.com](http://www.screwfix.com)

[www.screwfix.ie](http://www.screwfix.ie)

To view instruction manuals online, visit [www.kingfisher.com/products](http://www.kingfisher.com/products)

Made in China

**Installation**

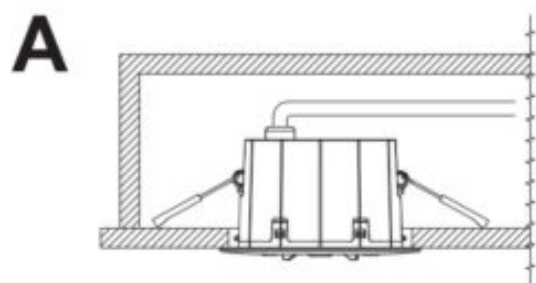

---

## 1A



---

## 2A

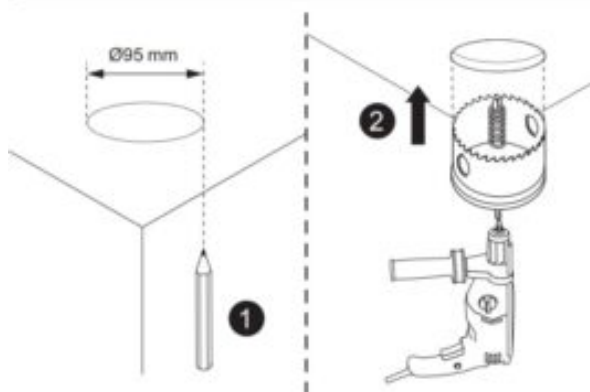

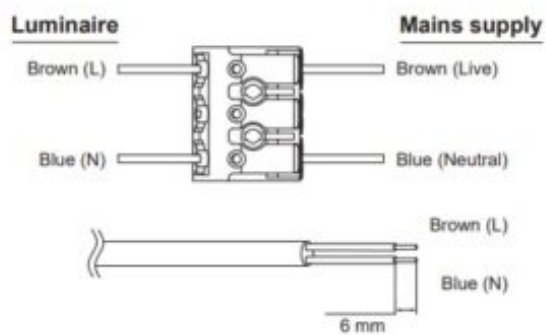
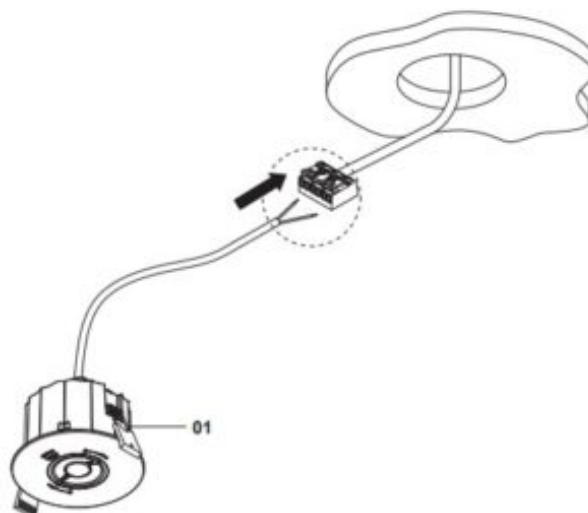

Terminal block not included. Installation must be performed by a qualified person.



# 4A

---

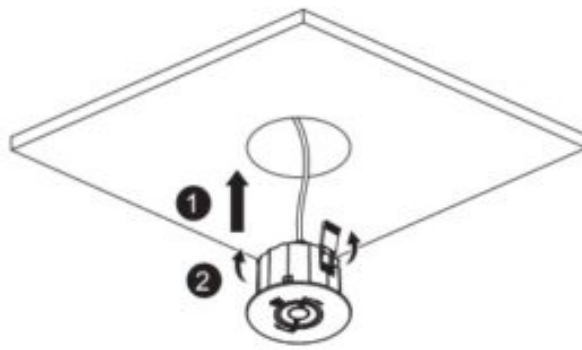

---

# 5A

---

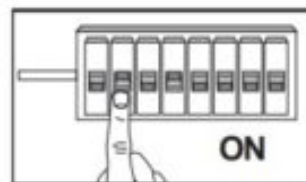
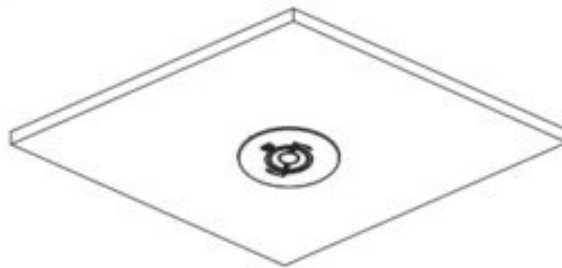

# B



## 1B



## 2B

05. x1

06. x2

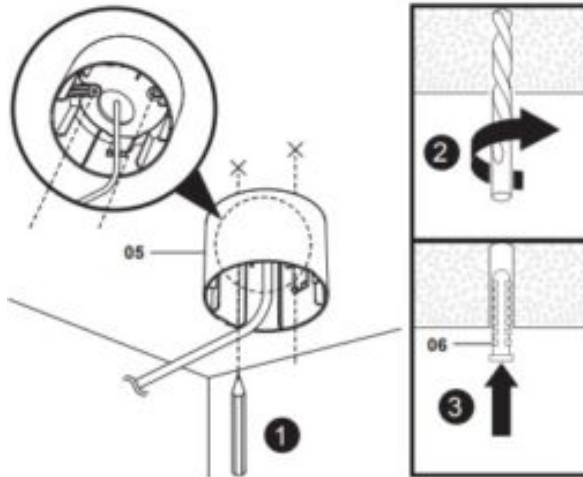

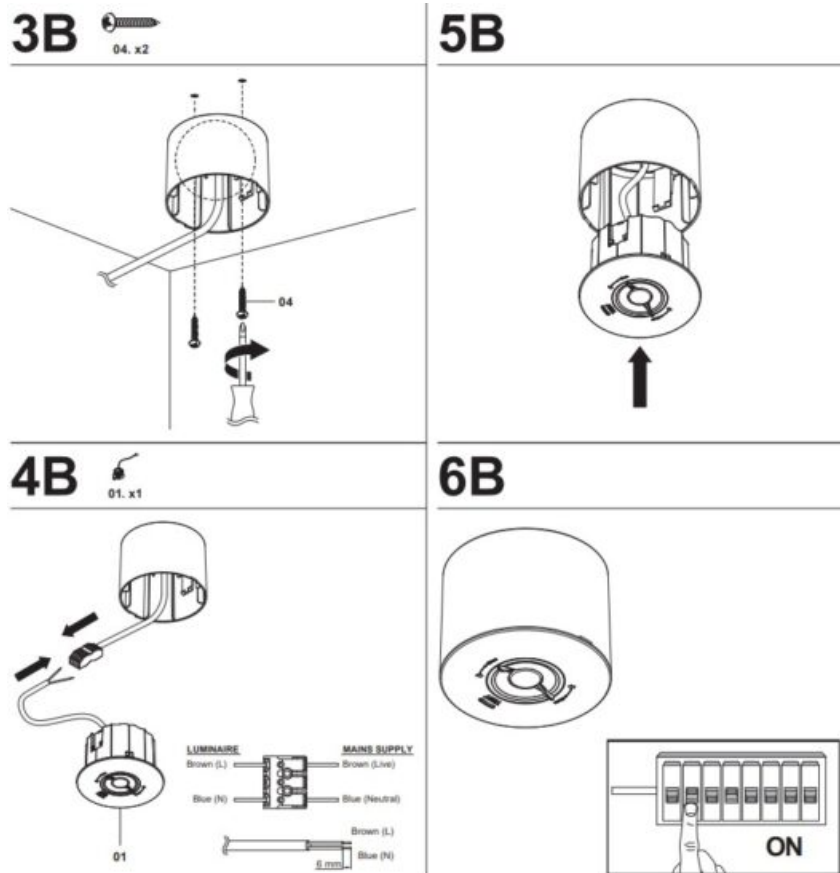

## Testing Record



1. For indoor use only.
2. The luminaire must be installed by a qualified electrician and wired in accordance with the latest IEE Electrical regulations or the national requirements.
3. Turn off the power supply before checking, installation, maintenance or moving.
4. Do not switch on before complete installation.
5. The light source of this luminaire is not replaceable; when the light source reaches its end of life the whole luminaire shall be replaced.
6. Batteries shall only be replaced by the manufacturer or his service agent or a similar qualified person.
7. Batteries should be replaced when the luminaire no longer meets the 3 hours duration performance.

Product: \_\_\_\_\_ Location: \_\_\_\_\_  
 Installation Date: \_\_\_\_\_

Month	Functional /Duration	Year 1	Year 2	Year 3	Year 4	Year 5
1						
2						
3						
4						
5						
6						
7						
8						
9						
10						
11						
12						

## Self Test

### Function test









The function test is conducted every week for 1 minute to check whether the battery connection is abnormal and discharge the battery and the connection of LED module.

### Duration test

An initial duration test is conducted when the battery is connected to the controller for the first time and connected to mains, but after 24 hours charging.

The yearly duration test is conducted for 3 hours on one day within the 300th day to the 365th day every year. It will also check the connection of battery and LED module.

Description corresponding to the color and status of the charge indicator

Charge Indicator Color	Status		On Time (Seconds)	Off Time (Seconds)	Description
Green		Permanent on		/	Normal status when mains connected (See remark in below Note <sup>***</sup> )
		Slow flash	is	is	Duration test running
		Fast flash	0.2s	0.2s	Function test running
		Normal flash three times only	0.5s	0.5s	Time reset
Red		Permanent on	/	/	Battery failure in normal and function test
		Slow flash	is	is	Lamp failure in test and function duration test
		Fast flash	0.2s	0.2s	Battery incapacity issue in duration test
Both Off		Off	/	/	Emergency mode

<sup>\*\*\*</sup> Remark – Lamp failure when non-maintained mode, the indicator will remain green color, the lamp failure will be detected during weekly functional test and the indicator light will turn red.

Failure indication status should be checked and rectified as soon as possible.

Test button for manual inspection on function test or duration test mode of operation

Duration	Description
Press for <2s	Simulate emergency mode.
Press for 3-5s	Start duration test manually. The test can be aborted by pressing off (1-2s). * Must be conducted when the initial duration test finished and after another 24 hours battery charging.
Press for 5-8s	Start Function test manually for 60s. The test can be aborted by pressing off (1-2s).
Press for >10s	Time Reset.

#### NOTE:

When the fitting first-time power on, press manual test button (if have) to perform initial test.

When the mains is on, the green indicator will be permanent on. It will check the connection of battery and the connection of LED module.

The luminaries on which we want to perform the function and duration tests must be connected to the mains supply for at least 24 uninterrupted hours.

If the mains is switched off during the test performance, the test will be postponed for 3 days, and the duration test will be initiated automatically after 24 hours of charging.

When the fault is corrected, the indicator will only be reset to its normal status after mains reconnected or test switch pressed.

An accuracy of the timing of the test interval is ensured that it has an accuracy of  $\pm 75$  s per week. The timing function will be retained through periods of mains supply failure or interruption for up to 7 days.

## Use

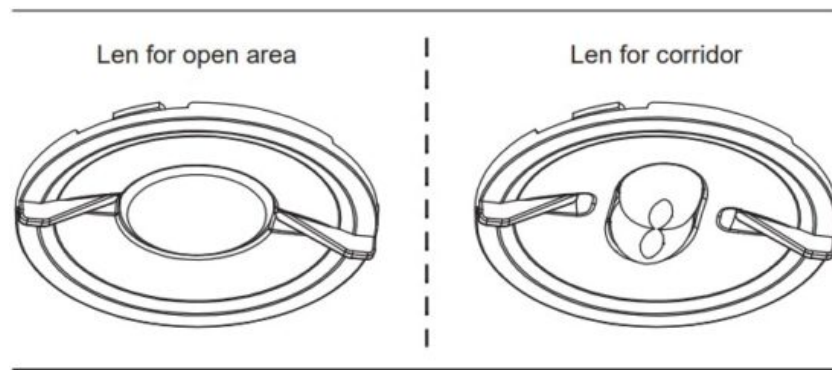

## Lens Replacement

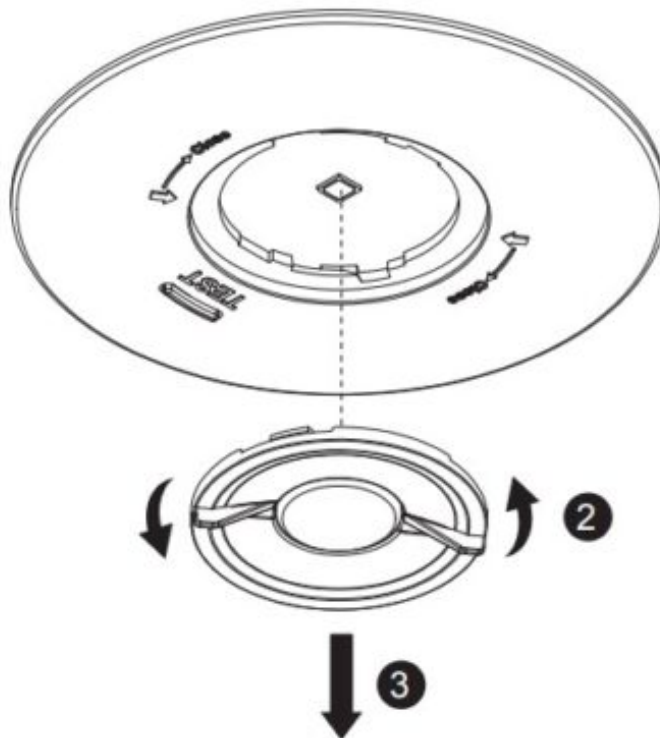
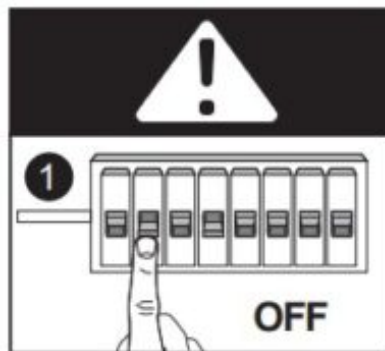

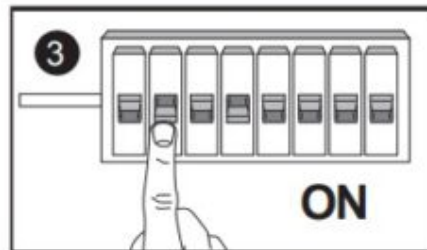
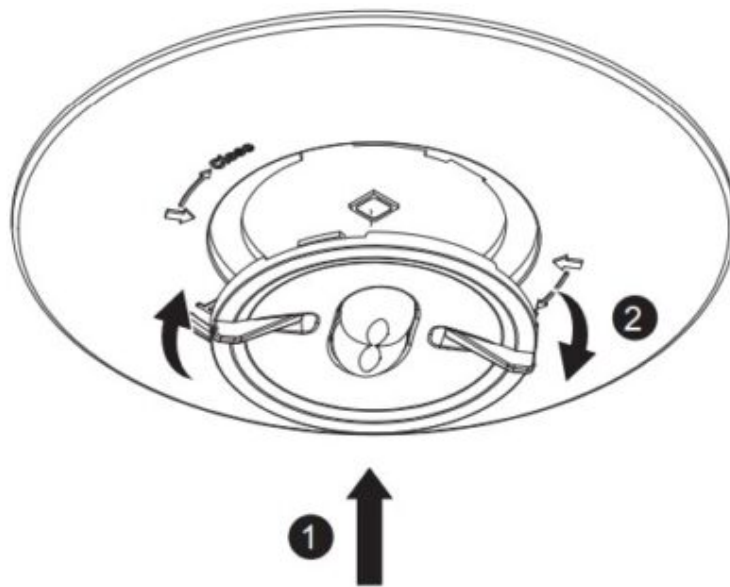

### Care & maintenance

**Battery replacement:** 1 x 3.2 V 3300 mAh 26650 LiFePO4.  
Replace only with the same or equivalent type.

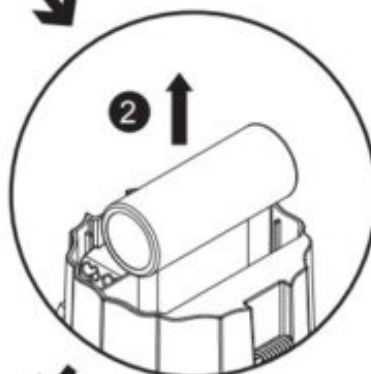
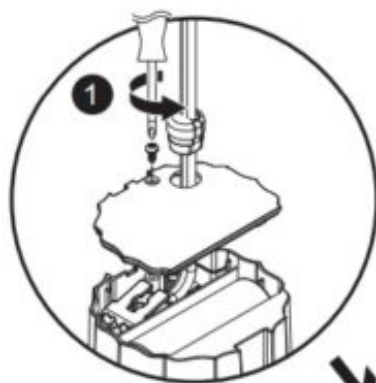

Remove the battery

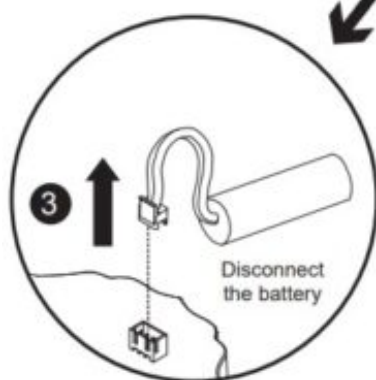



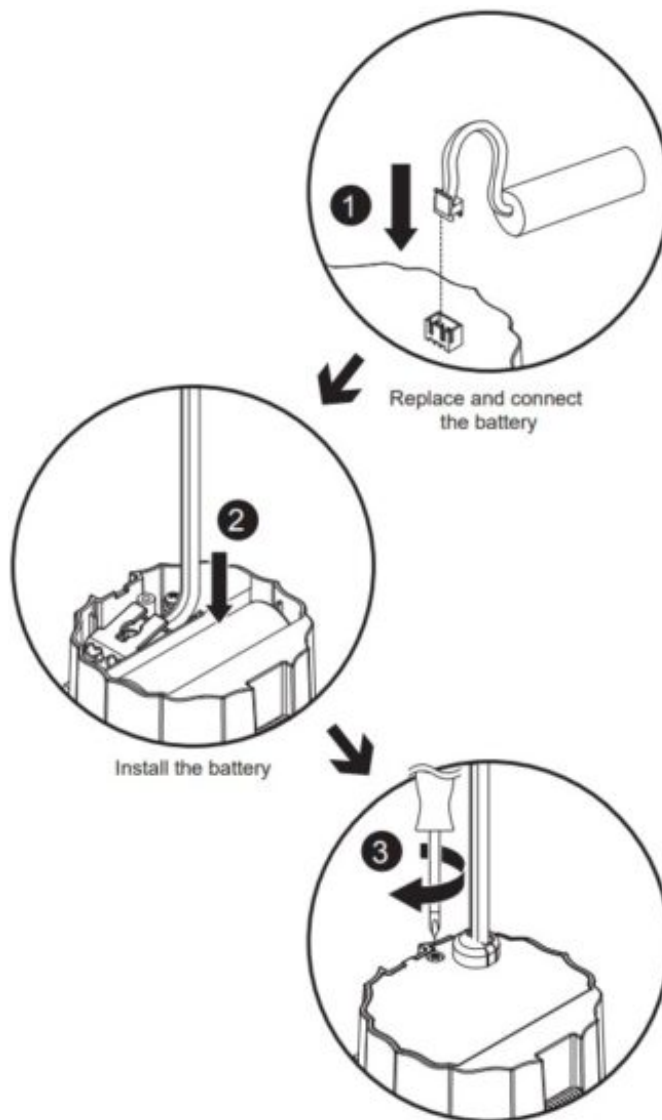

# LEXCO

## Documents / Resources

	<p><a href="#">Lexco LXEL05-RCM Fixed Recessed Non Maintained Emergency LED Down Light [pdf] In struction Manual</a></p> <p>LXEL05-RCM Fixed Recessed Non Maintained Emergency LED Down Light, LXEL05-RCM, Fix ed Recessed Non Maintained Emergency LED Down Light, Non Maintained Emergency LED D own Light, Maintained Emergency LED Down Light, Emergency LED Down Light, LED Down Li ght, Down Light, Light</p>
--	---

## References

- [B&Q | DIY Products at Everyday Low Prices | DIY at B&Q](#)
- [User Manual](#)

[Manuals+](#). [Privacy Policy](#)

This website is an independent publication and is neither affiliated with nor endorsed by any of the trademark owners. The "Bluetooth®" word mark and logos are registered trademarks owned by Bluetooth SIG, Inc. The "Wi-Fi®" word mark and logos are registered trademarks owned by the Wi-Fi Alliance. Any use of these marks on this website does not imply any affiliation with or endorsement.