

**Lexco  
LXEL01-BH  
Emergency  
Rectangular  
LED  
Bulkhead**



# Lexco LXEL01-BH Emergency Rectangular LED Bulkhead Installation Guide

[Home](#) » [Lexco](#) » Lexco LXEL01-BH Emergency Rectangular LED Bulkhead Installation Guide 

## Contents

- [1 Lexco LXEL01-BH Emergency Rectangular LED Bulkhead](#)
- [2 Specifications](#)
- [3 FAQs](#)
- [4 Parts](#)
- [5 TOOLS REQUIRED](#)
- [6 Care & maintenance](#)
- [7 Safety](#)
- [8 Technical Data](#)
- [9 Guarantee](#)
- [10 Installation](#)
- [11 CONTACT INFORMATION](#)
- [12 Documents / Resources](#)
  - [12.1 References](#)
- [13 Related Posts](#)

# Lexco

**Lexco LXEL01-BH Emergency Rectangular LED Bulkhead**



## Specifications

- **EAN:** 5059340964287
- **Impala Ref:** PRJ31756
- **Page Size:** A4
- **Emergency Bulkhead Exit**
- **Bulb Type:** LED (3.5 W)
- **Supply Voltage:** 220-240 V~ 50 Hz (5059340964287), 110 V~ 50 Hz (5059340964034)
- **Charging Time:** 24 hours
- **Energy Efficiency Class:** Not specified
- **Control Gear:** Replaceable by a professional
- **Class II Product** – Double Insulated, No earth required
- **IP66 Rated** – Powerful water jet-proof

## FAQs

- **What is the warranty period for this product?**
  - The product comes with a manufacturer's guarantee of 7 years (4 years for the battery pack) against manufacturing defects from the date of purchase or delivery.
- **Can I replace the light source myself?**
  - No, the light source contained in the luminaire should only be replaced by the manufacturer, their service agent, or a qualified person.

## Parts

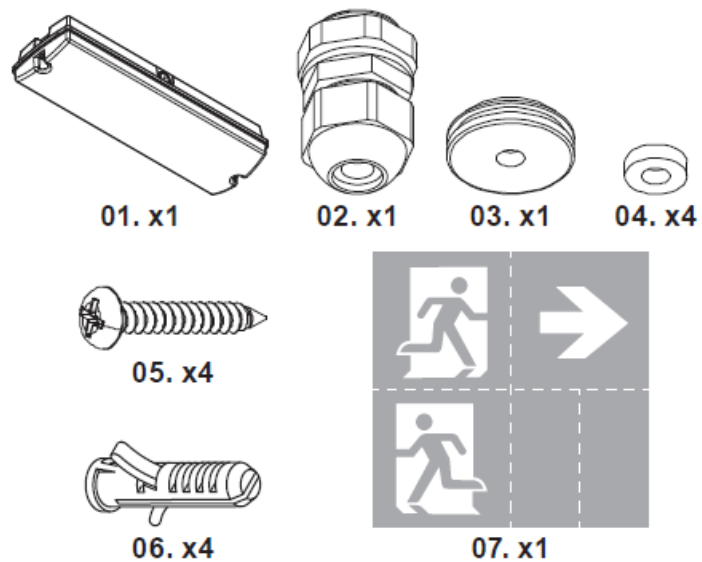

## TOOLS REQUIRED

You will need

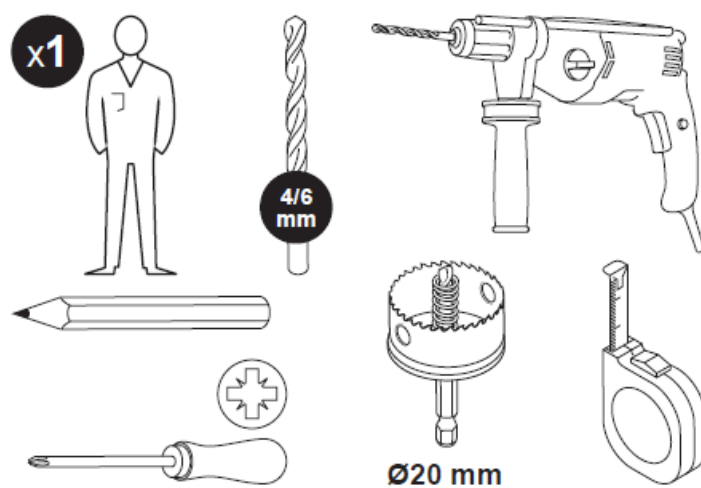

## Care & maintenance

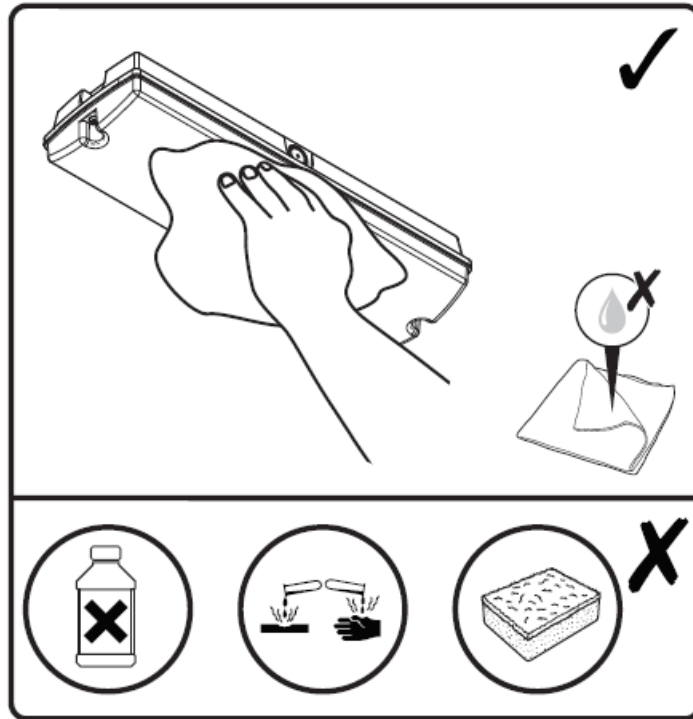







## Safety



- **IMPORTANT** Do not use with a dimmer switch.
- **IMPORTANT**, Retain for future reference: read carefully.
- These instructions are for your safety. Please read through them thoroughly before installation and retain them for future reference.
- All fittings must be installed by a competent person according to local regulations (IET wiring regulation BS7671).
- Check the pack and make sure you have all of the parts listed.
- Remove all packaging, wrap, etc from the product.
- Decide on the appropriate location for your product.
- **CAUTION:** IP66 is guaranteed when the product is properly installed and sealed.
- Always avoid the product being located in at corrosive environment.
- Always refer to the installation drawing for the orientation of the product.
- The product must be securely fixed to the mounting surface using the screws and wall plugs supplied. The screws and wall plugs supplied are suitable for “masonry” only. Other fixings are not supplied and must be purchased.
- Take care not to drill into any pipes or main cables beneath the surface during mounting hole preparation.
- **IMPORTANT:** The fixing point(s) selected must be capable of supporting the full weight of the light fitting.
- A wiring diagram is for reference only. Always refer to the terminal marking for wiring. Ensure that all electrical connections are tight and that no loose strands are left out of the terminal block.
- Never put anything on the product or hang anything on any part of this product.
- Never use the terminal cables to bear the product weight.
- When the product does not light after installation:
  - Ensure there is no electricity failure

- Ensure all the connections are secured
- If you have any doubt about the installation/use of this product, consult a qualified electrician.
- Always disconnect the product from the mains for at least 10 minutes allowing it to cool down before any maintenance or adjustment.
- It is recommended to have a regular schedule of care and maintenance to keep the surface condition well.

## Technical Data

Supply voltage:	5059340964287: 220-240 V~ 50 Hz 5059340964034: 110 V~ 50 Hz
Bulb Type:	LED (3.5 W) The light source contained in this luminaire shall only be replaced by the manufacturer or his service agent or a similar qualified person. Do not stare at the operating light source.
Operation ambient temperature (ta):	0 °C to 45 °C
Battery:	Charging time: 24 hours Type: 1 x 3.2 V 1500 mAh 18650 LiFePO4 0-60°C. Replace only with the same or equivalent type.
	This product complies with conformity requirements of the applicable European Regulations or Directives.
	This product complies with conformity requirements of the applicable UK Regulations.
Energy efficiency class:	This product contains a light source of energy efficiency class <D>.
Control gear:	Replaceable control gear by a professional.
	Class II product - Double Insulated - No earth required.
<b>IP66</b>	Powerful water jet-proof
	Waste electrical products should not be disposed of with household waste. Please recycle where facilities exist. Check with your Local Authority or local store for recycling advice.
	Caution! Risk of electric shock!
	Do not use with a dimmer switch.
xxWyy	xx-year; yy-week of the year.

## Guarantee

- We take special care in selecting high-quality materials and use manufacturing techniques that allow us to create products incorporating design and durability.
- This product has a manufacturer's guarantee of 7 years (4 years for battery pack) against manufacturing defects, from the date of purchase (if bought in-store) or date of delivery (if bought online), at no additional cost for normal use.

- To claim this guarantee, you must present your proof of purchase (such as a sales receipt, purchase invoice, or other evidence admissible under applicable law), please keep your proof of purchase in a safe place. For this guarantee to apply, the product you purchased must be new, it will not apply to second-hand or display products.
- Unless stated otherwise by applicable law, any replacement product issued under this guarantee will only be guaranteed until expiry of the original period guarantee period.
- This guarantee covers product failures and malfunctions provided the product was used for the purpose for which it is intended and subject to installation, cleaning, care, and maintenance by the information contained in these terms and conditions, in the user manual, and standard practice, provided that standard practice does not conflict with the user manual.
- This guarantee does not cover defects and damage caused by normal wear and tear or damage that could be the result of improper use, faulty installation or assembly, neglect, accident, misuse, or modification of the product. Unless stated otherwise by applicable law, this guarantee will not cover, in any case, ancillary costs (shipping, movement, costs of uninstalling and reinstalling, labor, etc), or direct and indirect damage.
- If the product is defective, we will replace or refund, it within a reasonable time.
- Rights under this guarantee are enforceable in the country in which you purchased this product. Guarantee-related queries should be addressed to the store you purchased this product from.
- The guarantee is in addition to and does not affect your statutory rights.

## **Installation**

# 01

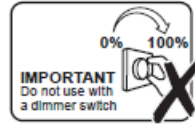
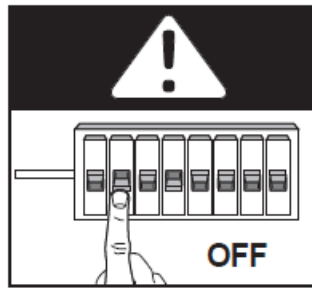

# 02



01. x1

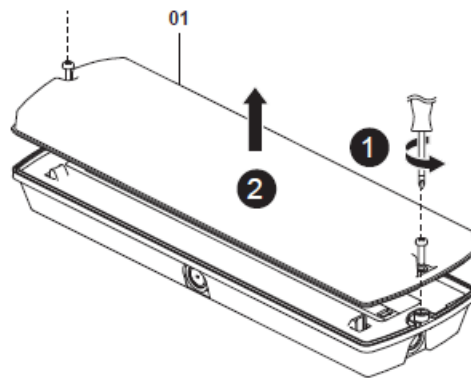

# 03

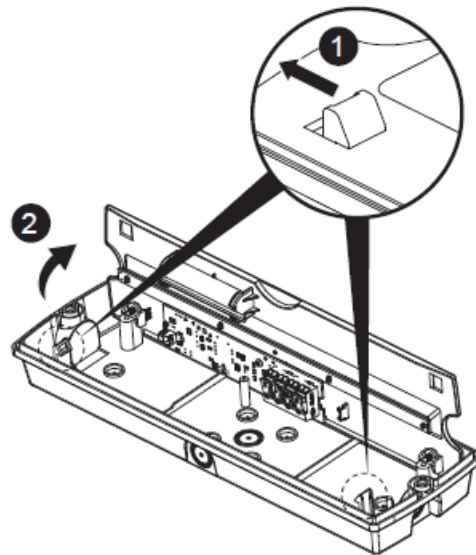

# 04

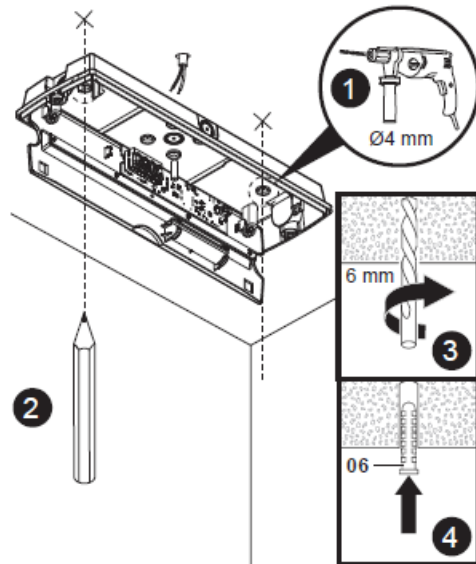
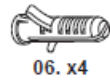



# 5A



03. x1

## EN Back Entry

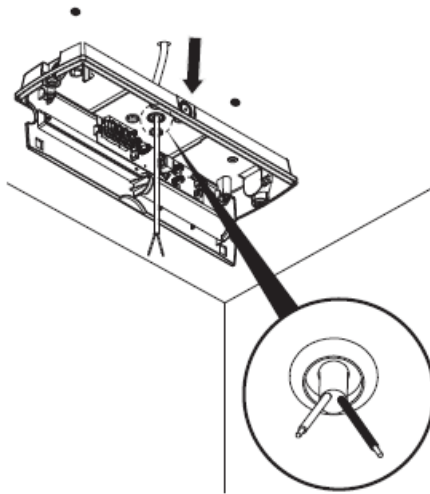
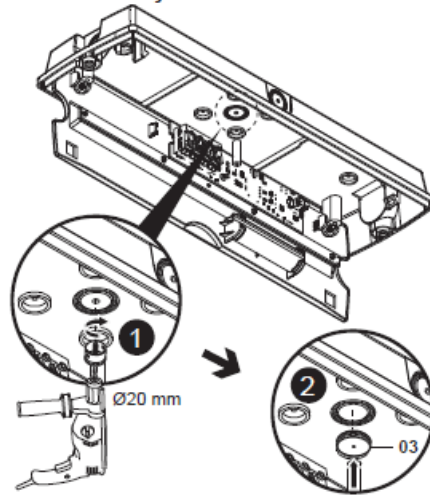

# 5B

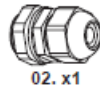

02. x1

## EN Side Entry

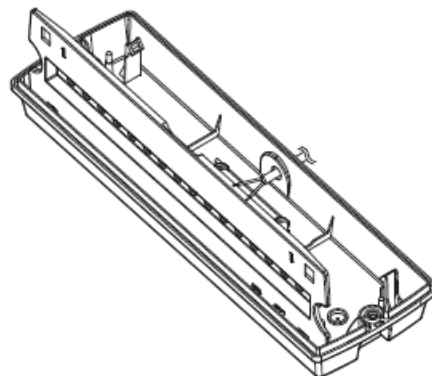
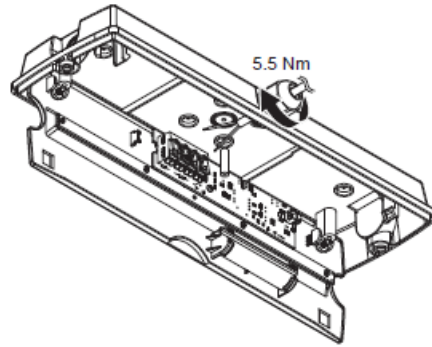
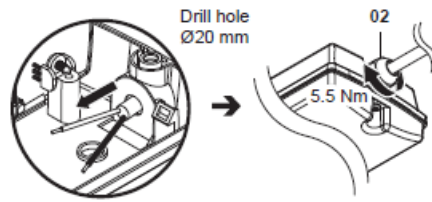

# 5C

## EN Besa Box

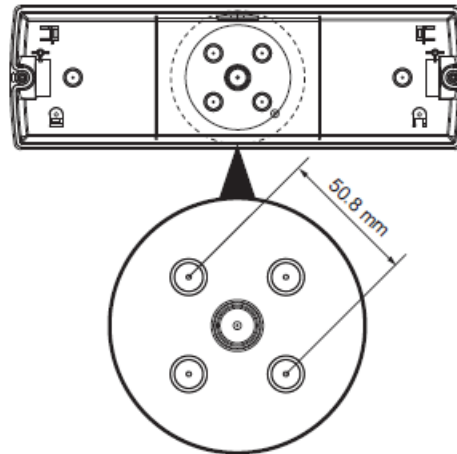

# 06

### EMERGENCY TERMINATIONS NON-MAINTAINED

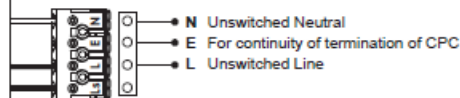

### EMERGENCY TERMINATIONS MAINTAINED

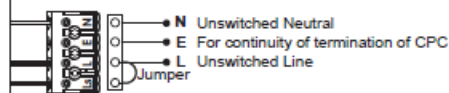

### EMERGENCY TERMINATIONS MAINTAINED (SWITCHABLE)

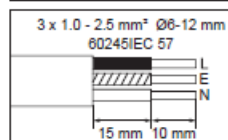
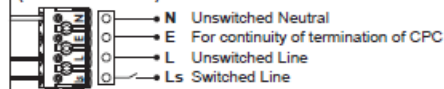

EN L = Brown or Red  
N = Blue or Black  
E = Green / Yellow

# 07

04. x2

05. x2

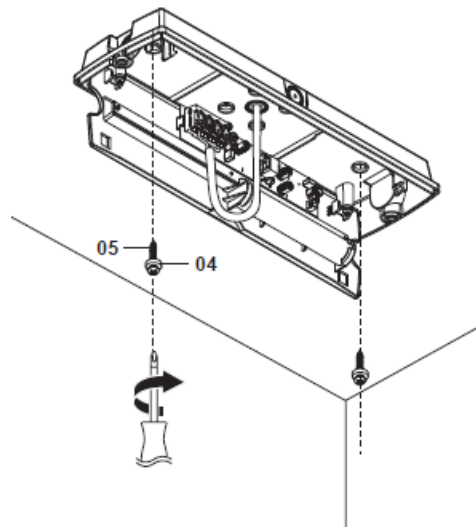

# 08

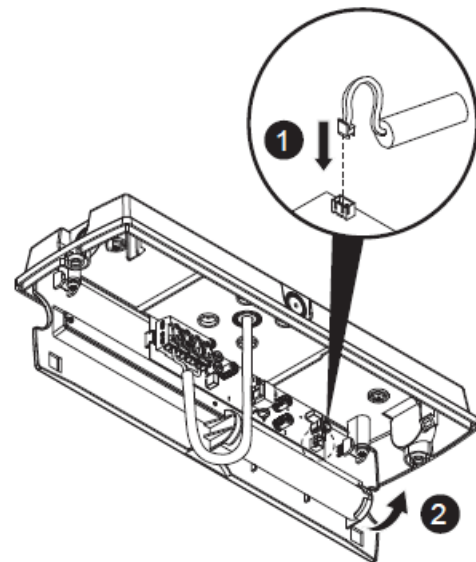

# 09

---

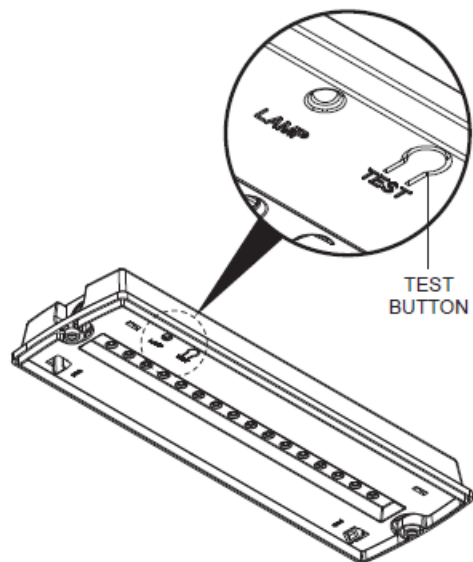

# 10

---

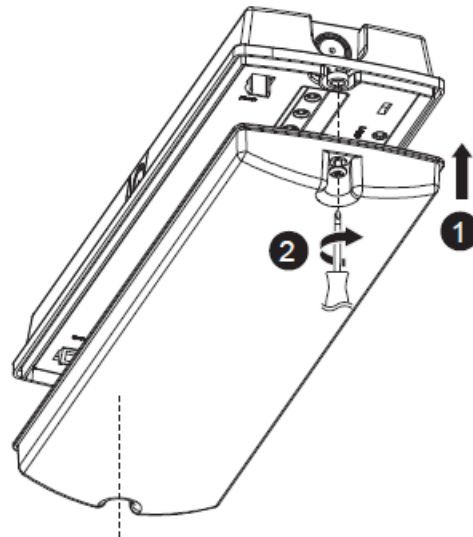

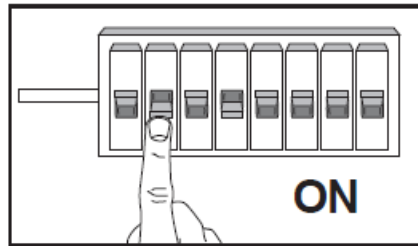
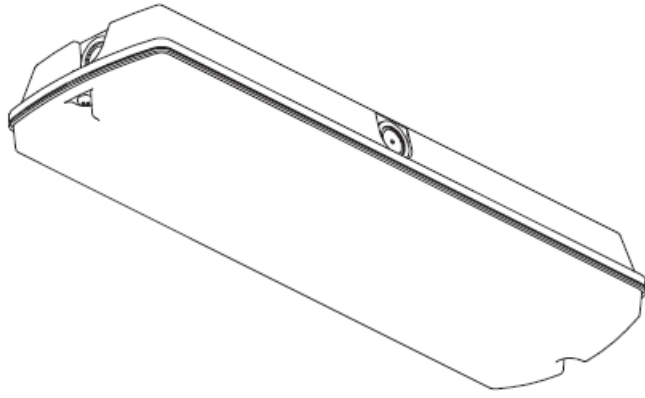

# 12



## EN Emergency Exit Light (For Wall Mounted)

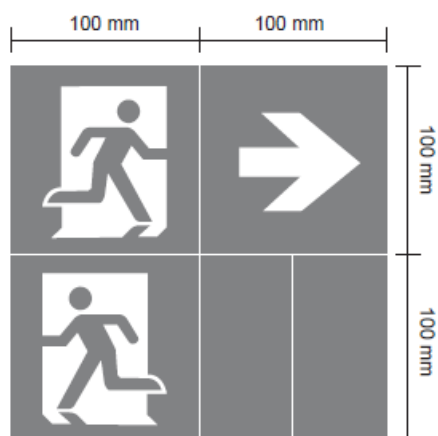

### Care & maintenance

**Battery replacement:** 1 x 3.2 V 1500 mAh 18650 LiFePO4. Replace only with the same or equivalent type.

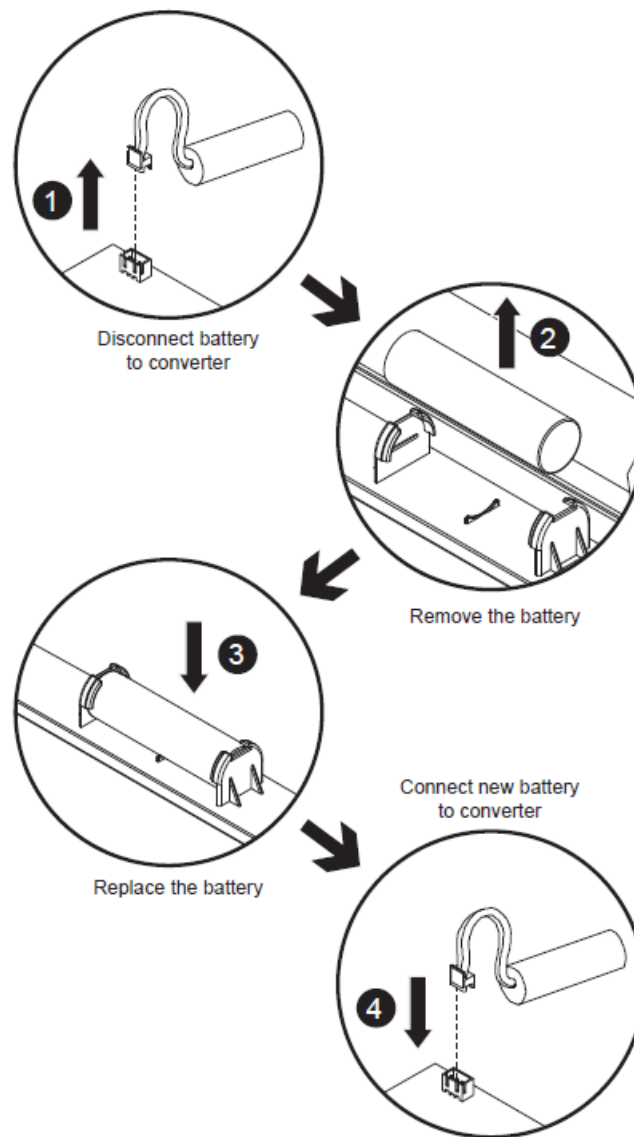

## Testing Record

1. The luminaire must be installed by a qualified electrician and wired according to the latest IEE Electrical regulations or the national requirements.
2. Turn off the power supply before checking, installing, maintaining, or moving.
3. Do not switch on before completing installation.
4. The light source contained in this luminaire shall only be replaced by the manufacturer his service agent or a similar qualified person.
5. Batteries shall only be replaced by the manufacturer his service agent or a similar qualified person.
6. Batteries should be replaced when the luminaire no longer meets the 3-hour duration performance.
  - Product: \_\_\_\_\_
  - Location: \_\_\_\_\_
  - Installation Date: \_\_\_\_\_



Month	Functional / Duration	Year 1	Year 2	Year 3	Year 4	Year 5
1						
2						
3						
4						
5						
6						
7						
8						
9						
10						
11						
12						

## Self Test









- **Function test**

- The function test is conducted every week for 1 minute to check whether the battery connection is abnormal and discharge the battery and the connection of the LED module.

- **Duration test**

- An initial duration test is conducted when the battery is connected to the controller for the first time and connected to mains but after 24 hours of charging.
- The yearly duration test is conducted for 3 hours on one day from the 300th day to the 365th day every year. It will also check the connection of the battery and LED module.

## Description corresponding to the color and status of the charge indicator

Charge Indicator Color	Status		On Time (Seconds)	Off Time (Seconds)	Description
Green		Permanent on	/	/	Normal status when mains connected (See remark in below Note*** )
		Slow flash	1s	1s	Duration test running
		Fast flash	0.2s	0.2s	Function test running
		Normal flash three times only	0.5s	0.5s	Time reset
Red		Permanent on	/	/	Battery failure in normal and function test
		Slow flash	1s	1s	Lamp failure in function test and duration test
		Fast flash	0.2s	0.2s	Battery incapacity issue in duration test
Both Off		Off	/	/	Emergency mode

- **Remark** – Lamp failure when non-maintained mode, the indicator will remain green color, the lamp failure will be detected during the weekly functional test and the indicator light will turn red.
- Failure indication status should be checked and rectified as soon as possible.

#### Test button for manual inspection on function test or duration test mode of operation

Duration	Description
Press for <2s	Simulate emergency mode.
Press for 3-5s	Start duration test manually. The test can be aborted by pressing off (1-2s). Must be conducted when the initial duration test is finished and after another 24 hours of battery charging.
Press for 5-8s	Start Function test manually for the 60s. The test can be aborted by pressing off (1-2s).
Press for >10s	Time Reset.

#### NOTE:

- When the fitting first power on, press the manual test button (if have one) to perform the initial test. When the mains is on, the green indicator will be permanently on. It will check the connection of the battery and the

connection of the LED module.

- The luminaries on which we want to perform the function and duration tests must be connected to the mains supply for at least 24 uninterrupted hours.
- If the mains are switched off during the test performance, the test will be postponed for 3 days, and the duration test will be initiated automatically after 24 hours of charging.
- When the fault is corrected, the indicator will only be reset to its normal status after the mains are reconnected or the test switch is pressed.
- Accuracy of the timing of the test interval is ensured that it has an accuracy of  $\pm 75$  s per week. The timing function will be retained through periods of mains supply failure or interruption for up to 7 days.

## CONTACT INFORMATION

### Manufacturer:

- **UK Manufacturer:**

- Kingfisher International Products Limited,
- 1 Paddington Square, London, W2 1GG,
- United Kingdom

- **EU Manufacturer:**

- Kingfisher International Products B.V.,
- Rapenburgerstraat 175E,
- 1011 VM Amsterdam,

- **The Netherlands**

- [www.diy.com](http://www.diy.com)
- [www.screwfix.com](http://www.screwfix.com)
- [www.screwfix.ie](http://www.screwfix.ie)
- To view instruction manuals online, visit [www.kingfisher.com/products](http://www.kingfisher.com/products)
- Made in China

## Documents / Resources



[Lexco LXEL01-BH Emergency Rectangular LED Bulkhead](#) [pdf] Installation Guide  
LXEL01-BH, LXEL01-BH Emergency Rectangular LED Bulkhead, Emergency Rectangular LED Bulkhead, Rectangular LED Bulkhead, LED Bulkhead, Bulkhead

## References

-  [B&Q | DIY Products at Everyday Low Prices | DIY at B&Q](#)
- [User Manual](#)

[Manuals+](#). [Privacy Policy](#)

This website is an independent publication and is neither affiliated with nor endorsed by any of the trademark owners. The "Bluetooth®" word mark and logos are registered trademarks owned by Bluetooth SIG, Inc. The "Wi-Fi®" word mark and logos are registered trademarks owned by the Wi-Fi Alliance. Any use of these marks on this website does not imply any affiliation with or endorsement.