



# Lepmerk RENG245882 Digital Hose End Timer Instruction Manual

[Home](#) » [Lepmerk](#) » Lepmerk RENG245882 Digital Hose End Timer Instruction Manual 

Lepmerk RENG245882 Digital Hose End  
Timer Instruction Manual

## INSTRUCTION MANUAL

### DIGITAL HOSE END TIMER



## Contents

- 1 CONTROL BUTTONS
- 2 INSTALLING THE BATTERY
- 3 MAINTENANCE
- 4 HOW TO INSTALL
- 5 SETTING-TIME & DAY
- 6 SETTING-START TIMES
- 7 SETTING-WATERING DURATION
- 8 SETTING-WATERING DAY(S)
- 9 MANUAL OPERATION
- 10 Documents / Resources
  - 10.1 References

## CONTROL BUTTONS

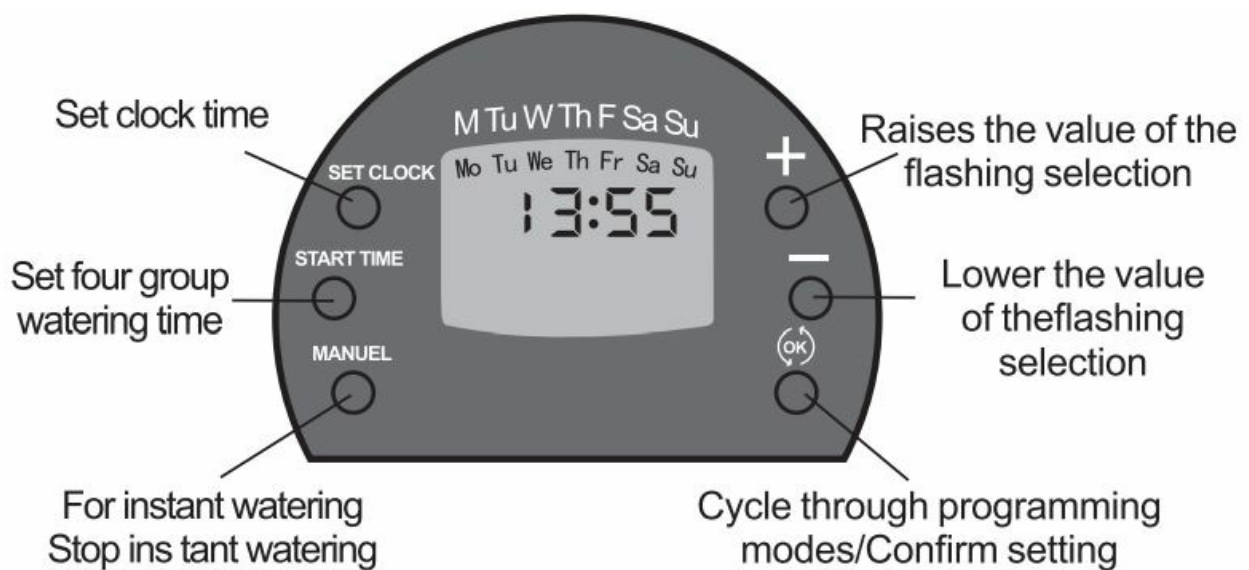

**Maximum operating pressure: 80PSI For irrigation use only**



## INSTALLING THE BATTERY

2 X AAA ALKALINE BATTERIES ARE RECOMMENDED

Remove the battery cover- keep battery compartment dry- install the 2 X AAA Battery by lining up the connections. Place the battery inside the compartment and reinstall the battery cover.

NOTE: When battery is first connected, it takes up to 1 minute for the battery indicator to assess the battery strength.

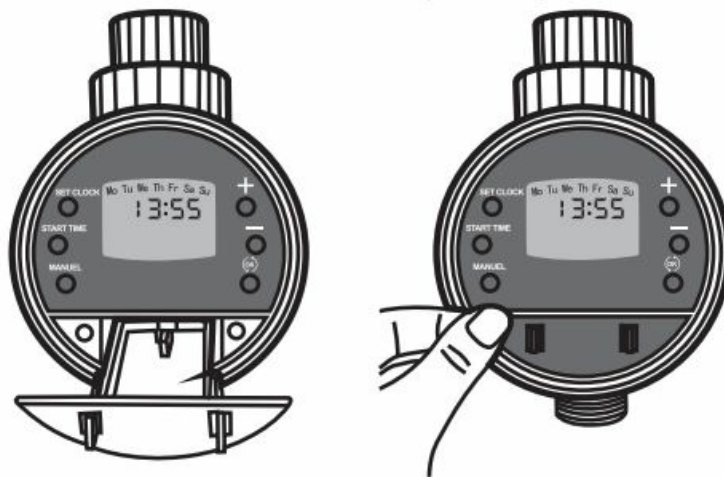

## MAINTENANCE

Remove and clean the screen washer on inlet side of the timer every few months.  
Remove battery if timer is not used for an extended time.  
In freezing conditions, un-install the timer and bring it indoors to prevent damage.

## HOW TO INSTALL

Attach the timer inlet to the outdoor faucet/spigot turning clockwise- hand tighten only. From the timer outlet connect a drip irrigation system or a garden hose.

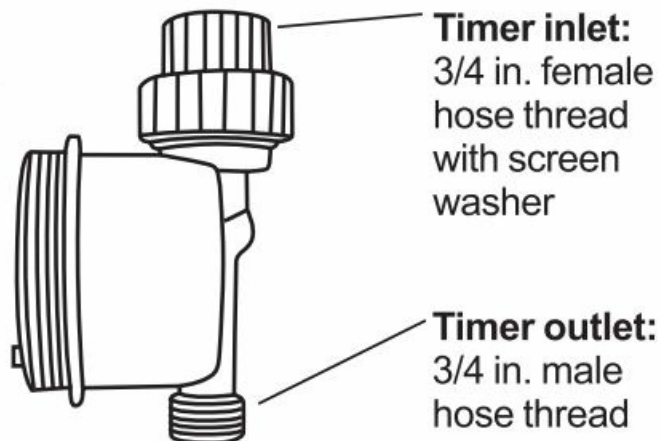

## SETTING-TIME & DAY

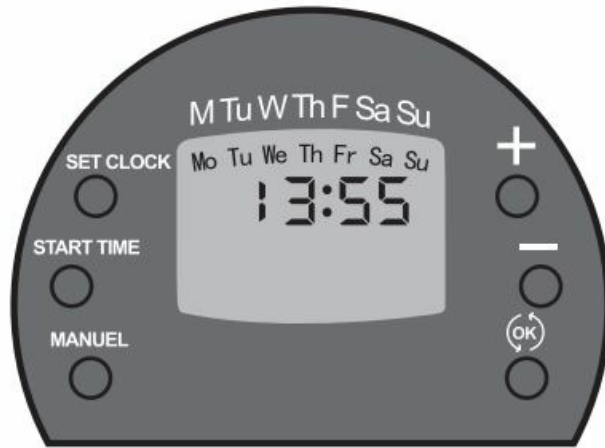

Set the current time

Push "SET CLOCK" button  
to select hours then push (OK)  
button to set minutes

Adjust using **-** **+**

AM/PM is set by increasing or  
decreasing the hour And minutes.

Set the current day

Push (OK) until the square

"Mo" or any other day  
flashes under the day of week.

Set the day of the week using **-** **+**  
After setting push (OK) to confirm



## SETTING-START TIMES



Push "START TIME" button and select Starts(start time).

Adjust hours using **-** **+** then push (OK) to adjust minutes.

You can set up to 4start times.



## SETTING-WATERING DURATION

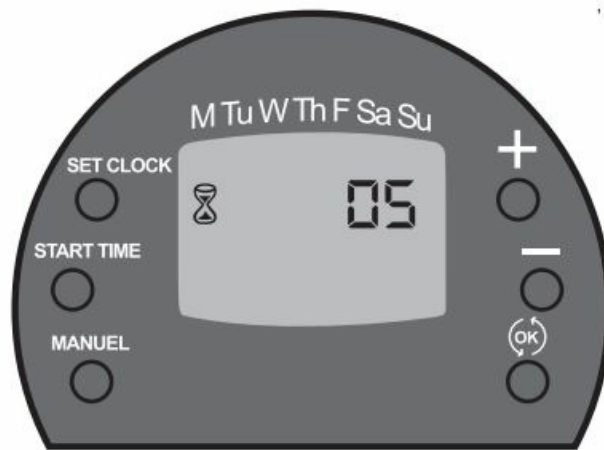

Push (OK) button and select ⌚ Duration.

Adjust watering time by - +

Attention: when "hour" appear, it is setting minutes. when there is no "hour" symbol. it is setting second

**For example:**

05	→	5 second
00:05	→	5 minutes
01:05	→	65 minutes
hour		

## SETTING-WATERING DAY(S)

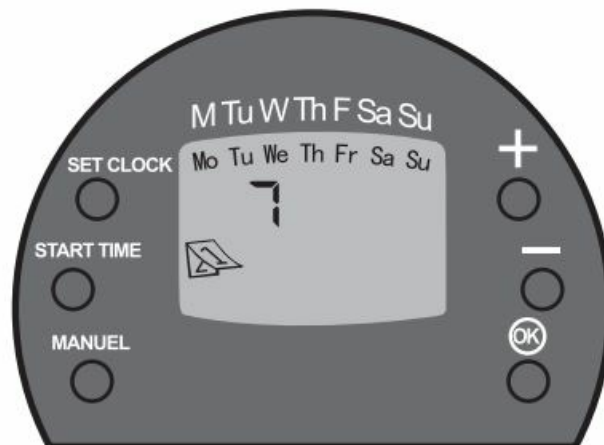

Push (OK) button and select 📅 Days.

Push + - until the square "Mo" flashes under Monday

Push (OK) to deactivate Monday or keep it active and advance to Tuesday. Do this for each day you would like to water.



## MANUAL OPERATION

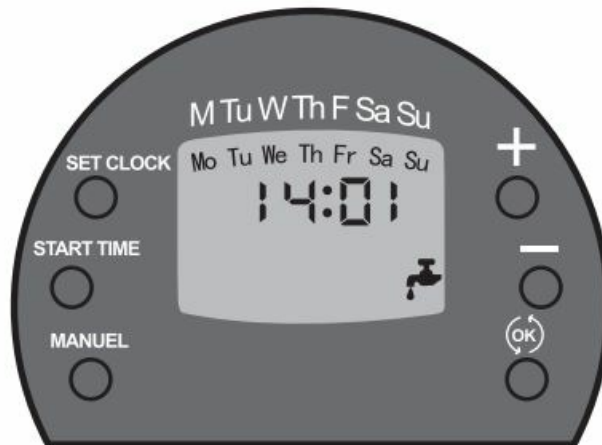

To instantly water push "MANUEL" button Push "MANUEL" button to stop

## Documents / Resources

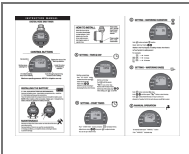

[Lepmerk RENG245882 Digital Hose End Timer](#) [pdf] Instruction Manual  
RENG245882 Digital Hose End Timer, RENG245882, Digital Hose End Timer, Hose End Timer, End Timer, Timer

## References

- [User Manual](#)

### Manuals+. Privacy Policy

This website is an independent publication and is neither affiliated with nor endorsed by any of the trademark owners. The "Bluetooth®" word mark and logos are registered trademarks owned by Bluetooth SIG, Inc. The "Wi-Fi®" word mark and logos are registered trademarks owned by the Wi-Fi Alliance. Any use of these marks on this website does not imply any affiliation with or endorsement.