



LEONX L9 Multi Function Intelligent Milk Frother Instruction Manual

[Home](#) » [LEONX](#) » LEONX L9 Multi Function Intelligent Milk Frother Instruction Manual 

LEONX L9 Multi Function Intelligent Milk Frother Instruction Manual



Contents

- 1 Important safety instructions
- 2 Preparations for use
- 3 Learn About Your Milk Foam Machine
- 4 Package Contents
- 5 Usage
- 6 Fault Alarm Handling
- 7 Tips for Use
- 8 Cleaning and Maintenance
- 9 Technical Parameters
- 10 Discard and Recycling
- 11 Documents / Resources
 - 11.1 References
- 12 Related Posts

Important safety instructions

Please read this Manual carefully before using this Milk Frother, and keep it properly for future reference. This product can be used only by those who are familiar with the following instructions.

1. Please read all the instructions.
2. Do not immerse this Milk Frother in water or any other liquid, and do not rinse it under the faucet; otherwise, it may be in danger of electric shock.
3. Do not operate this Milk Frother if it is damaged.
4. Do not touch any charged part of this Milk Frother.
5. It is only allowed to use the professionally installed power socket to operate this Milk Frother with a correct voltage.
6. Do not use an extended power cord.
7. It is forbidden to make the main cable loosely hang down, or use any wet hand to touch or move the plug, or place the plug on any heating surface, or make it contact any oily liquid.
8. It is necessary to unplug this Milk Frother after using it every time or before using or replacing its accessories or cleaning it.
9. When this Milk Frother is in use, please do not touch its metal part and shell to avoid scalding.
10. Do not use any damaged cable or plug for operating this Milk Frother. If its power cord is damaged, it is a must to entrust the manufacturer or its service agency or a similar professional for replacement in order to prevent any danger.
11. Any operator of this Milk Frother needs to be responsible for his or her own safety; therefore, only the supervised or trained people can operate this Milk Frother; the following people (including children) are forbidden to operate it: those who are disabled, suffer poor perception, mentally unsound or lack professional technical expertise.
12. Do not let children play with the whisk.
13. Do not operate this Milk Frother outdoors.
14. Do not let this Milk Frother work without milk.
15. This is an auxiliary electrical appliance.
16. When not using it, please turn off its power supply and main power supply.
17. Be sure not to touch the rotating parts, which may cause injury.

18. The liquid level shall not exceed the maximum volume mark on the inner wall of cup; otherwise, the liquid will overflow.
19. This Milk Frother can be used only with the supplied base.
20. Be sure not to operate this Milk Frother on any uneven surface.
21. Only fire blankets can be used to extinguish fires on electrical appliances.
22. This Milk Frother is most appropriate for household use and it is not recommended for commercial and industrial purposes.
23. Do not insert any object or finger into the ventilation hole on the back of this Milk Frother.
24. It is prohibited to cover or block the ventilation hole on the back of the plastic base.
25. If you intend to obsolete this Milk Frother, it is forbidden to discard it at will; please first disconnect its power supply and then send it to the officially designated garbage dump.
26. The surface of milk cup may be hot during and after operations; therefore, it is necessary to use the handle during the use (be sure not to touch any other position in order to avoid scalding).
27. In order to prevent any fire, electric shock or personal injury, please do not immerse the power cord and plug of this Milk Frother in water or any other liquid.
28. When using this Milk Frother nearby a child or children, it is a must to closely supervise its use.
29. Be sure to unplug the plug from the wall socket when not using this Milk Frother or before cleaning this Milk Frother; please cool the parts of this Milk Frother before installing or removing them.
30. Do not operate this Milk Frother when its power cord or plug is damaged; do not operate this Milk Frother after it goes wrong or is damaged, and it is necessary to send it to the nearest authorized service facility for inspection and repair.
31. The use of any accessory not recommended by the electrical appliance manufacture may cause fire, electric shock or personal injury.
32. Do not hang the power cord on the edge of table or counter, or make it contact any hot place.
33. Do not place it nearby a position with hot air or an electric stove or in a heating oven.
34. If you want to disconnect the power supply, please turn the "ON/OFF" key to the "OFF" position and then unplug the plug from the wall socket.
35. Do not use the equipment for other purposes.
36. If you remove the cup cover when this Milk Frother is working, you may be scalded.
37. Be sure not to pull the power cord when unplugging its plug from the wall socket; please always hold the plug.
38. When this Milk Frother is working, it is prohibited to place any paper or other object between the groove of the plastic base and the metal cup; otherwise, this machine will be damaged.
39. In case of any damage caused by improper use or failure to comply with these instructions, we will not undertake any responsibility.

Preparations for use

It is necessary to carefully open its packaging box, keep all the packaging materials inside it, take the Milk Foam Machine out and then carefully read its manual to check whether or not its parts are complete; after that, it is necessary to power on the Milk Foam Machine to check whether it can work normally. Before using the Milk Foam Machine for the first time, it is necessary to clean its parts and then get rid of the dust or objects left during its production.

Learn About Your Milk Foam Machine

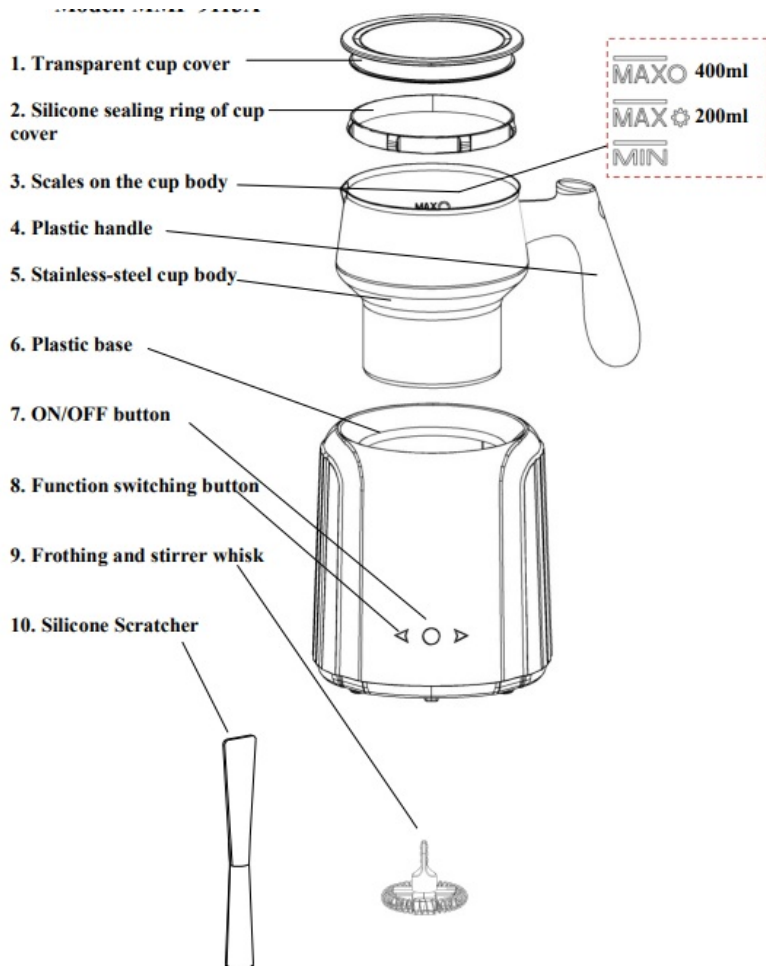

Model: MMF-9113A

Package Contents

Includes	Amount	Includes	Amount
Transparent cup cover	1	Frothing and stirrer whisk	1
Silicone sealing ring	1	Silicone scratcher	1
Stainless-steel cup body	1	Operating manual	1
Plastic base	1	Coffee instruction	1

Usage

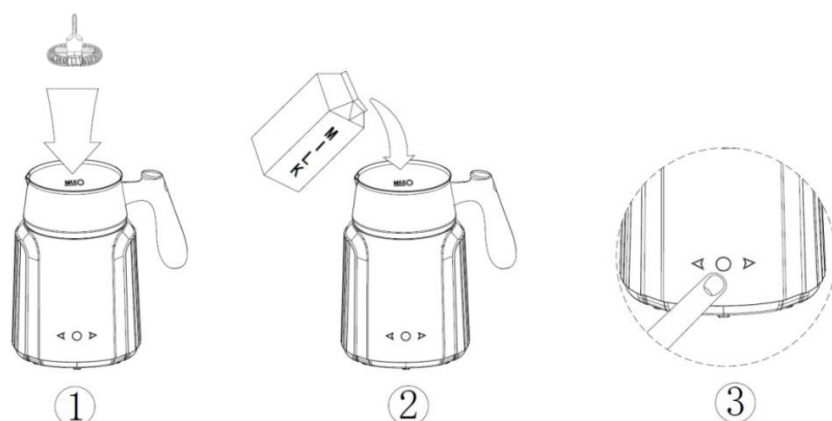

1. Correctly install the whisk onto the bulging shaft in the cup body.
2. Pour the milk into the cup of this Milk Frother and put on the cup cover. We recommend the use of frozen milk at the temperature of about 5-10°C (41-50°F); the milk with different fat content will produce different milk froth effects; we recommend the use of whole milk to make milk froth (fat content > 3.0%), which will be denser and last longer. Note that the milk volume should not exceed the mark (see the maximum volume in the figure below as a reference); if the metal cup has been cleaned, please use a dry towel to wipe the water trace at the bottom of the metal cup and then put it into the groove of the base; there should be no water or foreign matter left in the groove of the base.
3. Connect this Milk Frother to the power supply; after this Milk Frother is powered on, its buzzer will ring once (0.2S), its screen will display and scroll the word "LEONX"; the machine will enter the standby status if there is no operation within 60 seconds; at the moment, please press the button or for function selection with specific operations as shown in the following table. When the machine starts working, it will exit the function by tapping the on key

	Pour 200ml milk in the cup, press the key	
	and select the function mode "COLD	
4. COLD FROTH MILK	FROTH MILK" and then press the key again to confirm that the machine starts to work and displays the corresponding animation; its rotor will stop after turning for (120±5) seconds; at the moment, its buzzer will make a sound (for 1 second), meaning the completion of work; the milk-foam ratio is at least 70%.	The maximum milk volume is 200ml.
	Pour 400ml milk and 30g chocolate beans	
5. CHOCOLATE MILK	in the cup, press the key and select the function mode "CHOCOLATE MILK" and then press the key again to confirm that the machine starts to work and displays the corresponding animation; at the first stage, its rotor will turn for 5 seconds at the low speed and then stop for 5 seconds; at the second stage (when the milk temperature gets to 50°C), its rotor will turn for 20 seconds at the low speed and then stop for 5 seconds; at the third stage (when the milk temperature gets to 70°C), its rotor will turn for 60 seconds at the low speed and stop for 5 seconds; after the rotor turns (200~380) seconds and stops, its buzzer will make a sound (for 1 second), meaning the completion of work; the milk temperature falls in between 70°C and 80°C (158~176°F).	The maximum milk volume is 400ml.

	Pour 200ml soy milk in the cup, press the	
	key , and select the function mode “SOY MILK FROT H” and then press the	
6. SOY MILK FROTH	key again to confirm that the machine starts to work and displays the corresponding animation; the motor will stop after turning for (100~250) seconds; at the moment, its buzzer will make a sound (for 1 second), meaning the completion of work; the milk temperature falls in between 60°C and 70°C (140~158°F). The actual foaming effect depends on the soy milk used.	The maximum milk volume is 200ml.
	Pour 100ml cashew milk and 100ml pure	
	milk Ratio 1:1 in the cup, press the key	
7. CASHEW MILK FROTH	, and select the function mode “CASHEW MILK FROTH” and then press the key again to confirm that the machine starts to work and displays the corresponding animation; the motor will stop after turning for (100~250) seconds; at the moment, its buzzer will make a sound (for 1 second), meaning the completion of work; the milk temperature falls in between 60°C and 70°C (140~158°F). The actual foaming effect depends on the cashew flavored milk used.	The maximum milk volume is 200ml summation .
	Pour 200ml lactose-free milk in the cup,	
	press the key , and select the function mode “LACTOSE-FREE MILK FORTH”	
8.LACTOSE-FREE MILK FORTH	and then press the key again to confirm that the machine starts to work and displays the corresponding animation; the motor will stop after turning for (100~250) seconds; at the moment, its buzzer will make a sound (for 1 second), meaning the completion of work; the milk temperature falls in between 60°C and 70°C (140~158°F).The actual foaming effect depends on the lactose-free milk used.	The maximum milk volume is 200ml.

	Clean the inside of the cup first to prevent	
	bacteria from contaminating the finished	
	product then pour 400ml pure milk and 0.5g lactobacillus powder in the cup	
	According to personal taste, after adding	
	milk, add appropriate amount of granulated	
	sugar to sweeten , press the key and	
	select the function mode “YOGHURT	
9. YOGHURT MILK	MILK” and then press the key again to confirm that the machine starts to work and displays the corresponding animation; when the rotor works at 30% of its normal speed, the machine will heat the mixture to 40~50°C(104~122°F); after that, the machine will stop heating and its rotor will turn to make this Milk Frother continuously preserve heat to fall in between 40°C and 50°C (104~122°F) for 12 hours in the function mode “YOGHURT MILK”, and during this period, it is not allowed to disconnect the power supply or switch to any other function mode; after that, the buzzer will make one sound and the screen will display the temperature of 40~50°C(104~122°F) for 5 seconds and then this machine will return to the menu interface. Put the yogurt directly in the	The maximum milk volume is 400ml.
	refrigerator at 5-10°C 41-50°F for 2 to 3	
	hours to better taste	
Notes:1. When you effectively touch every key once, the buzzer will make a sound (for 0.2 seconds).2. When this machine works in any mode with the heating function with a minimum capacity of 120ml(MIN) pure milk, both the milk temperature values and the corresponding time values will be not within the above ranges; in such cases, the milk temperature values and the corresponding time values are not judged.		

Fault Alarm Handling

c	Possible Cause(s)	Solution(s):
E1	1. The whisk is not installed in the metal cup.2. The metal cup is not put into the base.3. The metal cup is not added with corresponding solution, meaning that this product is heated with nothing; the solution in the metal cup is insufficient.4. Take out the metal cup when the milk frother is working.	1. Please mount the whisk correctly onto the shaft of metal cup.2. Please put the metal cup correctly into the base.3. Please pour an appropriate amount of corresponding solution into the metal cup and it is not allowed to start the machine without corresponding solution; it is necessary to add more than 120ml MIN corresponding solution and it is recommended to make the mixture as per the operating instructions.4. Please put the metal cup in again and start it again and it is not allowed to take the metal cup out when the milk frother is working.
E2	The voltage is excessively low.	Please apply correct voltage as per the operating manual.
E3	The voltage is excessively high.	Please apply correct voltage as per the operating manual.
E4	1. The machine is continuously heated for a long time and thus the inside of the base is at high temperature.2. The cooling hole on the back of the base is blocked and thus the inside of the base is at high temperature.	1. Please avoid heating the machine continuously for more than 5 times; please operate the machine after it cools.2. Remove the obstacles from the cooling hole on the back of the base and then operate the machine after it cools
E5-E7	This product goes wrong.	Please contact the customer service personnel.
The user is required to read the instructions carefully and avoid any wrong operation as much as possible; if the above solutions fail to solve the problem(s), be sure not to disassemble the product by yourself and please contact professional staff to solve the problem(s).		

Tips for Use

The following tips for use can help you make better milk froth:

- Use a foaming whisk to first heat the milk and then make it into milk foam. When this Milk Frother is working, you need to immediately prepare coffee or hot chocolate.
- This Milk Frother can make frozen milk into milk froth; however, it does not mean that this machine can make frozen milk into frozen milk froth because the working Milk Frother can generate certain heat.
- The ideal milk heating temperature is 60~80°C because such temperature can increase the flavor of coffee while not reducing the taste of coffee and you will not wait too long to drink coffee.
- The whisk is relatively small, so it is necessary to place it in a safe place in order to prevent it from being lost or prevent a child from eating it by mistake.
- This Milk Frother can be used only for heating or frothing; please do not put coffee beans into this Milk Frother; please clean and dry it immediately after using it.
- It is optimal to use whole milk for making milk foam (fat content 3.0%) and the cooled milk at the temperature of 5-10 °C can take on the best effect. Using the whisk wrongly or pouring excessive whole milk may cause milk overflow

Cleaning and Maintenance

Before cleaning this machine, please separate the cup body from the base of the power supply base, take out the

cover of the cup body, and do not immerse the power-supply base in water.

1. For the cup body: Clean it with cold water and an appropriate amount of mild detergent as well as a soft towel not losing hair to gently clean it and then wipe it dry with a dry towel; it is allowed to put it in a dishwashing machine for cleaning.
2. For the cup cover: Take the cup cover away from the cup body, and then directly clean it with water; it is not allowed to put it in a dishwashing machine.
3. For the plastic base: Use a soft and wet towel to gently wipe the columniform metal part. It is not allowed to use any strong detergent or any hard cleaning tool such as a hard nylon brush or a metal brush for brushing the body of cup because such tool may scratch the surface of cup. It is not allowed to put it in a dishwashing machine.
4. For the whisk: Take it out of the cup body, clean it with water, wipe it dry and place it in a safe place; it is not allowed to put it in a dishwashing machine.

Technical Parameters

Voltage and power: 120V 60Hz 550W

Discard and Recycling



It is necessary to destroy the package of this product as per the local regulations on waste disposal. It is necessary to classify paperboards and paper as recyclable paper, and classify platinum as recyclable resource (potentially recyclable resource). After this product is discarded, it is not allowed to directly dispose it as household waste and it is a must to send it to the recycle station for recycling electronic products specially. The marks of this product in the user's manual and on the package have shown that it is not allowed to throw this product into any garbage can (see the symbol "x" on the garbage can, as shown in the above picture).

For the problem of how to dispose an old and useless milk frother, you are required to consult your local recycle station (old equipment recycle station designated by your municipal government); if the label reminds that all the materials are reusable, you will make contributions to environmental protection as long as you use the reused old equipment made from recycled materials or otherwise.

A NOTE TO YOU

Thank you for buying our appliance.

This manual contains valuable information about how to operate and maintain your milk frother properly and safely.

Need Help? Please Contact leonxcontact@foxmail.com

<div data-bbox="156 107 284 302"><p>LEONX L9 Multi Function Intelligent Milk Frother</p><p>Operating Manual</p><p>FDA CE</p></div>	<div data-bbox="319 156 1468 257"><p>LEONX L9 Multi Function Intelligent Milk Frother [pdf] Instruction Manual</p><p>L9, L9 Multi Function Intelligent Milk Frother, L9, Multi Function Intelligent Milk Frother, Function Intelligent Milk Frother, Intelligent Milk Frother, Milk Frother, Frother</p></div>
---	--

References

- [User Manual](#)