



Leo's Loo 2274286 Automatic Wi-Fi Enabled Litter Box User Manual

[Home](#) » [Leo's Loo](#) » Leo's Loo 2274286 Automatic Wi-Fi Enabled Litter Box User Manual 

Leo's Loo Too

USER MANUAL
AUTOMATIC WIFI-ENABLED LITTER BOX

Contents

- 1 2274286 Automatic Wi-Fi Enabled Litter Box
- 2 LETTER FROM OUR CEO
- 3 SAFETY INSTRUCTIONS
- 4 IN THE BOX
- 5 COMPONENTS GUIDE
- 6 POWER BUTTON AND INDICATORS
- 7 SET UP INSTRUCTIONS
- 8 NOTIFICATIONS
- 9 VOICE CONTROL
- 10 ACCLIMATING KITTY
- 11 WASTE REMOVAL
- 12 CLEANING THE LOO
- 13 CONTACT US
- 14 WARRANTY
- 15 PRODUCT SPECIFICATIONS
- 16 Documents / Resources
 - 16.1 References

2274286 Automatic Wi-Fi Enabled Litter Box



REGISTER YOUR LEO'S LOO TOO

Serial number is located on underside of the unit base, or below the drum, depending on your region. We suggest recording this information before setup.

Serial number:

Date of purchase:



<https://qrstud.io/wblymob>

LETTER FROM OUR CEO

Dear fellow cat parent,

Welcome to the Casa Leo family! It means a great deal to us that you've chosen the Leo's Loo Too automatic litter box. We are excited for you to enjoy more time with your fur baby and less time scooping (and smelling!) litter waste.

I know firsthand how unpleasant the litter box can be. After a lifetime of sharing my home with cats I knew it was time for a solution that worked better, and looked better, than anything else on the market.

Developing the Leo's Loo was a labor of love—which is why I named it after my rescue cat Leo. He was found in a dumpster, badly injured. He was nursed back to health and went on to live 18 years, and brought joy to everyone he met. I hope the Leo's Loo Too will also bring joy to your home and the special bond you share with your fur babies.

At Casa Leo we are cat parents ourselves and want you and kitty to be happy.

If you have questions or concerns please email support@casaleopet.com and we'll do whatever it takes to support you.

Here's to no more scooping!

Chris Madeiras

Founder/CEO

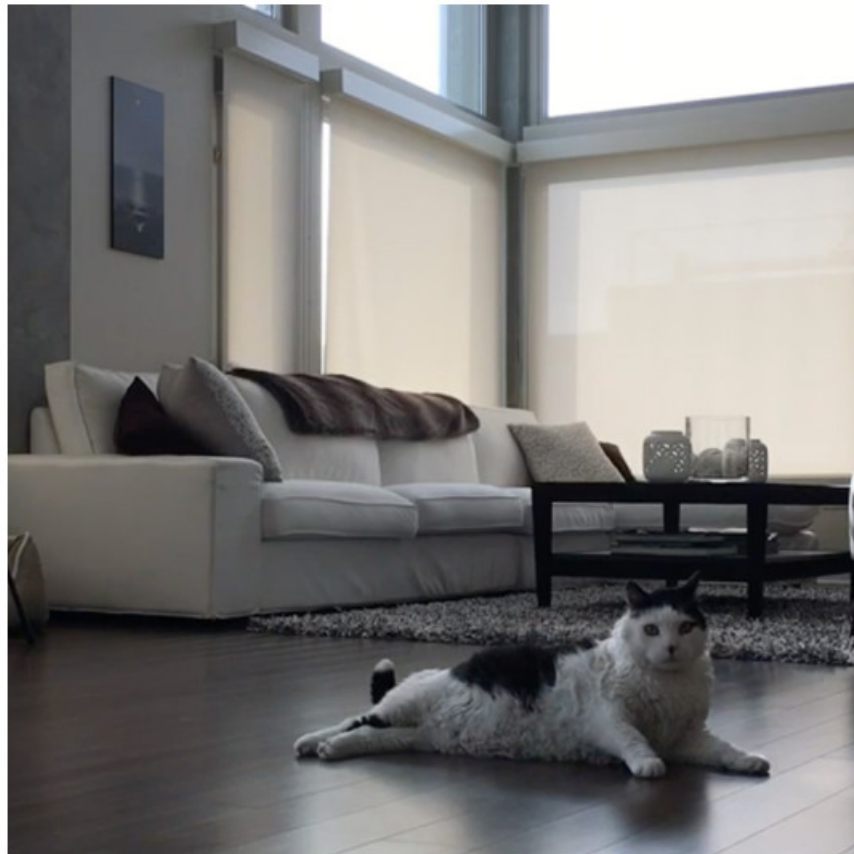

SAFETY INSTRUCTIONS

Thank you for purchasing a Leo's Loo Too by Casa Leo. Please carefully read the following safety instructions before using the machine. Using your Leo's Loo is an acknowledgement that you have read and agreed to all the safety instructions written in this user manual.

- Do not use this machine in Automatic Mode for cats weighing 1 lbs or less.
- Do not power on while your cat is inside or on top of the machine.
- When first powered on, the machine will complete a rotation to calibrate sensors. Do not allow your cat to enter the machine at this time or the calibration process will be interrupted.
- Use only clay clumping cat litter that absorbs moisture.
- Place the machine on a solid and level surface. Soft or uneven surfaces will impede weight sensors and proper operation.
- For indoor use only. Do not place in direct sunlight.
- Do not soak the base of the machine in water.
- Empty the waste drawer frequently; minimum of once per week for one cat.
- Compatible with 2.4G WiFi networks.

For safety or support related questions please contact Casa Leo customer support at support@casaleopet.com. Company reserves the right to interpret and amend this document at any time.

IN THE BOX

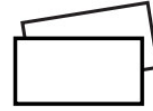
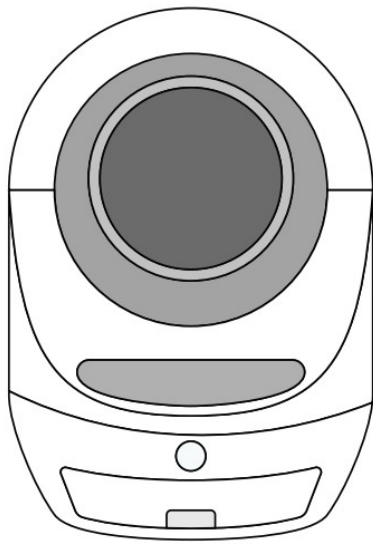

- Leo's Loo Too
- Power adapter with 6' anti-chew cord
- Drawstring waste drawer liners
- Charcoal air filters (underside of waste drawer)

Bundle boxes also include litter mat, plushies, and extra drawstring liners

COMPONENTS GUIDE

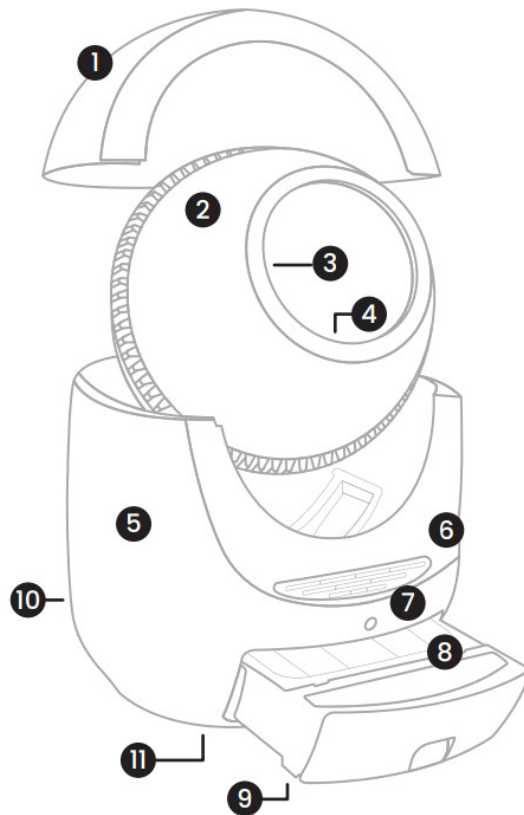

1. Top cover
2. Drum
3. Sifter
4. Drum floor

5. Base
6. Silicone step
7. Power button
8. Waste drawer
9. Carbon filters
10. Power receptacle
11. Weight sensors

POWER BUTTON AND INDICATORS

Button controls



Turn on/off: Press and hold 3 Seconds (1 Beep)

Pairing with app: Press and hold 5 Seconds (3 Beeps)

Start or pause cleaning cycle: Press briefly

Change between auto & manual mode: Press twice

Light indicators

WHITE 	Steady On: Automatic mode Blinking Slowly: Connect failure Flashing Quickly: Ready to pair with app
RED 	Steady On: Manual mode Blinking Slowly: Waste drawer full Flashing Quickly: Hardware error
BLUE 	Steady On: UV sterilization cycle running Blinking Slowly: Weight sensor calibration

SET UP INSTRUCTIONS

WATCH: Setting up your Leo's Loo Too



<https://qrstud.io/1mfej5h>

WATCH: Pairing your Leo's Loo Too with the app



<https://qrstud.io/d1nvs98>

1. PLACEMENT

Place unit on a flat even surface to ensure all sensors function properly. Do not place unit directly on carpet or rugs. If your unit must go in a carpeted area, please use a firm base underneath.

Allow at least 1 inch of distance from walls and furniture.

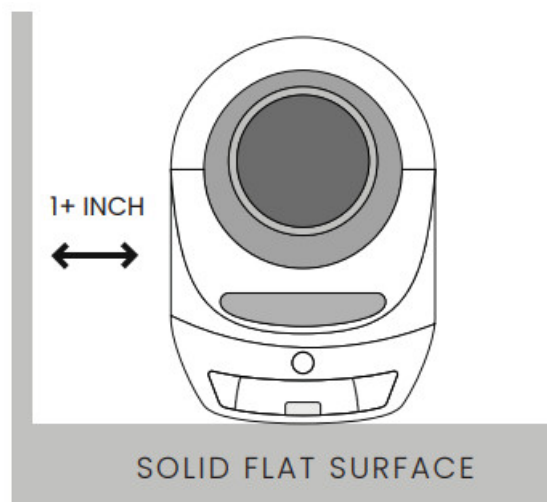

2. PREPARE THE UNIT

Verify the rotating drum is secure, as it may have shifted during shipping.

1. Detach top cover and inspect
2. Drum should be seated evenly in the gear track, with spindle aligned in holder
3. Remove to adjust if needed. Replace drum and top cover before continuing.

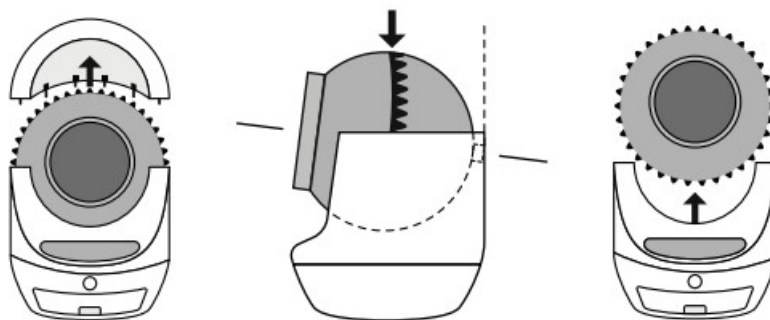

Add 10-12lbs (4.5-5.5kg) of litter. Do not fill beyond the indicator sticker.
Use only clumping clay litter.

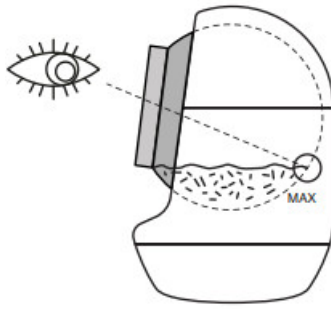

Line waste drawer with the included bags. Make sure to spread evenly along the bottom and smooth the edges.

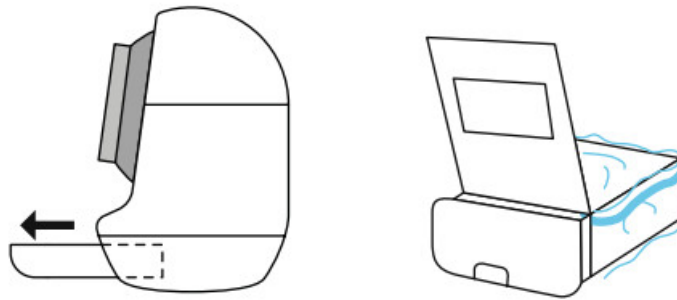

3. PAIRING

Download the Casa Leo app and create an account.



Plug power adapter into an outlet and wait for a beep. Then turn the unit on by pressing the power button for 3 seconds. The drum will rotate and light will flash.

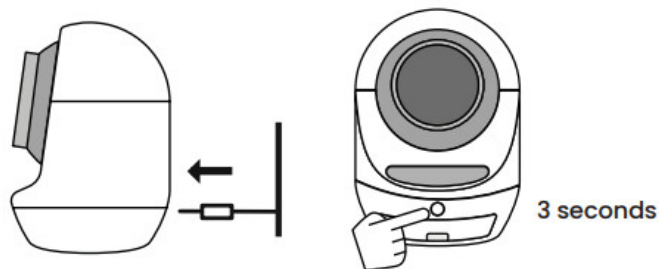

Long press the Leo's Loo Too power button for 5 seconds and wait for the light to flash quickly. The Loo is now in pairing mode.

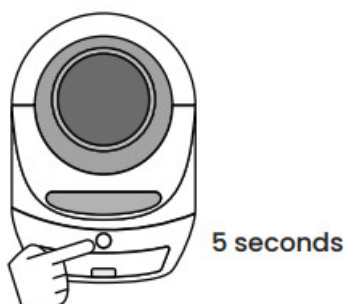

In the app, tap on "Add Device" and enter your Wi-Fi password.

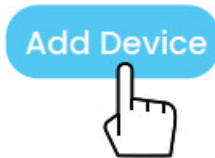

NOTIFICATIONS

“Kitty just used the Loo”

While in Automatic Mode you will receive a notification each time kitty finishes using the Loo.

“Waste drawer is full”

When the waste drawer is full your Loo will send a notification and pause future cleaning cycles until emptied and reset. After removing and replacing the liner bag, reset cleaning cycles and weight sensors by turning the unit off and on again.

“Failure to initiate cleaning”

Your Loo will send a notification if kitty is detected inside during a cleaning cycle and pause operation. Normal operation will resume after kitty has exited and is no longer detected by the triple-protection safety sensors.

“Too many cleaning cycles run”

You may receive this notification if your Loo senses an unusual number of cleaning cycles have been run in a short period of time. We recommend manually inspecting the Loo and temporarily switching to Manual mode to identify any potential issues.

“Machine is off”

Please turn the machine back on by pressing the power button for 3 seconds.

“Cleaning recommended”

For odor control and cleanliness we recommended monthly cleaning, including replacing all litter and carbon filters. To clear this notification tap Settings, navigate to the bottom, then tap the filter replacement icon.

VOICE CONTROL

Voice commands:

“Turn on (Your Loo’s Name)”

“Turn off (Your Loo’s Name)”

“Set (Your Loo’s Name) to Automatic”

“Set (Your Loo’s Name) to Manual”

WATCH: Adding your Leo’s Loo Too to Google Home



<https://qrstud.io/u1nydyd>

WATCH: Linking your Leo’s Loo Too with Alexa



<https://qrstud.io/8vt5t2c>

ACCLIMATING KITTY

Introducing kitty to a new litter box can take time. Here are a few tips we've found to help:

Create a familiar scent: Use a small amount of litter from the old litter box as a topper within the Loo.

Demonstration: Run the machine in manual mode while your cat is present to show there is no danger. If your cat tolerates being picked up, try placing kitty inside after the cycle has run.

Encouragement: Place treats or toys near the entrance of the machine to encourage kitty to get closer and explore.

Placement: Place the Loo near the location of your old litter box. Refrain from cleaning the old litter box.

This will encourage your cat to migrate to the clean environment in the Loo. After kitty begins using the Loo it is safe to remove the old litter box.

Try Dr. Elsey's Cat Attract: this unique formulation of litter is an ideal hard clumping clay style, blended with a natural herbal attractant to encourage appropriate litter box use.

WATCH: Acclimating Kitty



<https://qrstud.io/y7q3pwu>

WASTE REMOVAL

The Leo's Loo Too will tell you when the waste drawer is full with an app notification. The unit power button light will also turn red and blink slowly and pause cleaning cycles until the drawer is emptied. Remove and replace the drawer liner, then turn the unit off and on again to reset cleaning cycles and weight sensors.

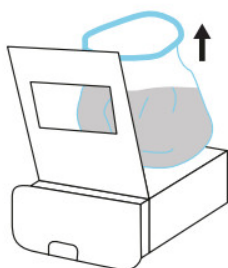

Remove and replace the drawer liner

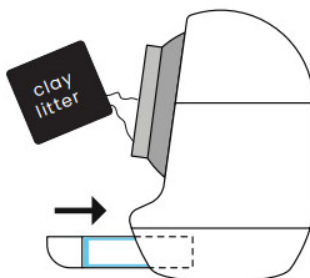

Reinsert drawer and top off litter inside the drum

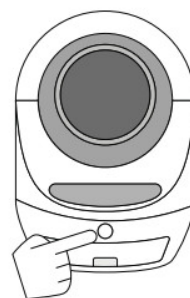

Turn off and on again to reset

CLEANING THE LOO

The Leo's Loo Too should be cleaned, and litter changed, once per month.

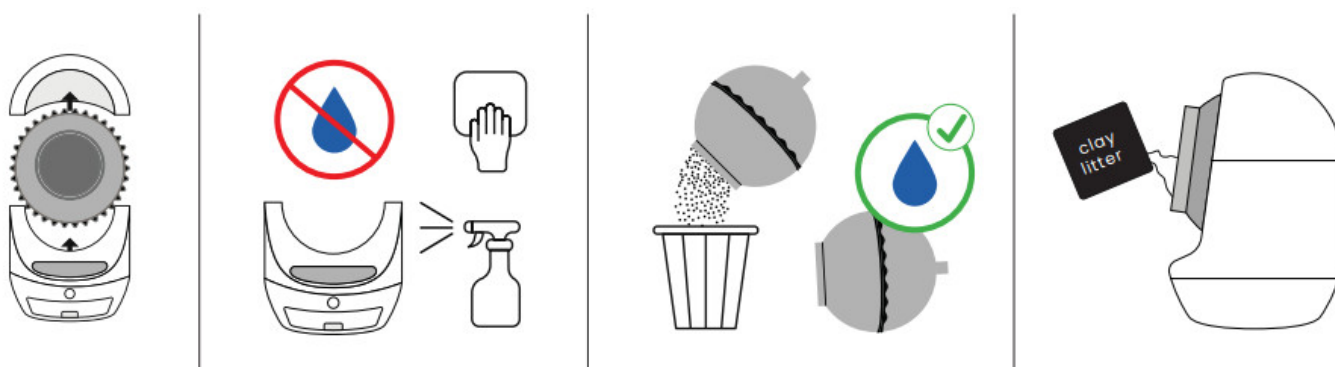

1. Detach top cover and remove drum from base.
2. Vacuum base then wipe with a cloth and cleaning solution. Do NOT use water directly on the base as it will damage electronics.
3. Empty drum then wash with soap and water. Allow to dry thoroughly.
4. Return drum to unit base, fill with fresh litter, and replace top cover.

CONTACT US

Questions? Casa Leo is based in California and offers US-based customer support staffed entirely by fellow cat parents. We use the product ourselves and would love to help with any product or kitty adjustment questions you may have.

support@casaleopet.com

WARRANTY

Your Leo's Loo Too comes with a 1-year warranty when purchased from Casa Leo or an authorized reseller, and protects against defects in materials or workmanship. For extra peace of mind you can add the Extended Warranty to cover your Loo for a full 3 years from date of purchase.

The extended warranty must be purchased within the 90day trial period.

Please note use of anything other than clumping clay litter, or any unauthorized modification or repair, will void the warranty.

For questions please contact us: support@casaleopet.com

SHOP: Extended Warranty



<https://qrstud.io/5ft1psd>

PRODUCT SPECIFICATIONS

Product Name	Leo's Loo Too
Dimensions	22 x 24 x 27.6 in (56 x 61 x 70 cm)
Input Voltage	12 V
Max Weight Capacity	55 lb (25 kg)
Max Litter Capacity	1.5 gal (6 L)
Material	PP
Product Weight – Net	27.5 lb (12.5 kg)
Product Weight – Gross	37.4 lb (17 kg)
Power – Operating	53 kWh per year
Power – Standby	9 kWh per year
Scale Accuracy	± 1 lb (0.5 kg)

Model: LLT

The complete limited warranty, warnings and cautions are available at www.casaleopet.com

© PurLife Brands Inc. / Palo Alto, CA, USA

Made in China

FCC Compliance: This device complies with Part 15 of the FCC Rules. Operation is subject to the following two conditions: (1) This device may not cause harmful interference, and (2) this device must accept any interference received, including interference that may cause undesired operation.

Documents / Resources

	Leo s Loo 2274286 Automatic Wi-Fi Enabled Litter Box [pdf] User Manual 2274286 Automatic Wi-Fi Enabled Litter Box, 2274286, Automatic Wi-Fi Enabled Litter Box, Wi-Fi Enabled Litter Box, Enabled Litter Box, Litter Box, Box
---	--

References

- [Casa Leo](#)
- [User Manual](#)