



Lemorele P10 Wireless USB C Transmitter User Manual

[Home](#) » [Lemorele](#) » Lemorele P10 Wireless USB C Transmitter User Manual 

Contents

- [1 Lemorele P10 Wireless USB C Transmitter](#)
- [2 Connection](#)
- [3 Documents / Resources](#)
 - [3.1 References](#)
- [4 Related Posts](#)



Lemorele P10 Wireless USB C Transmitter



Connection

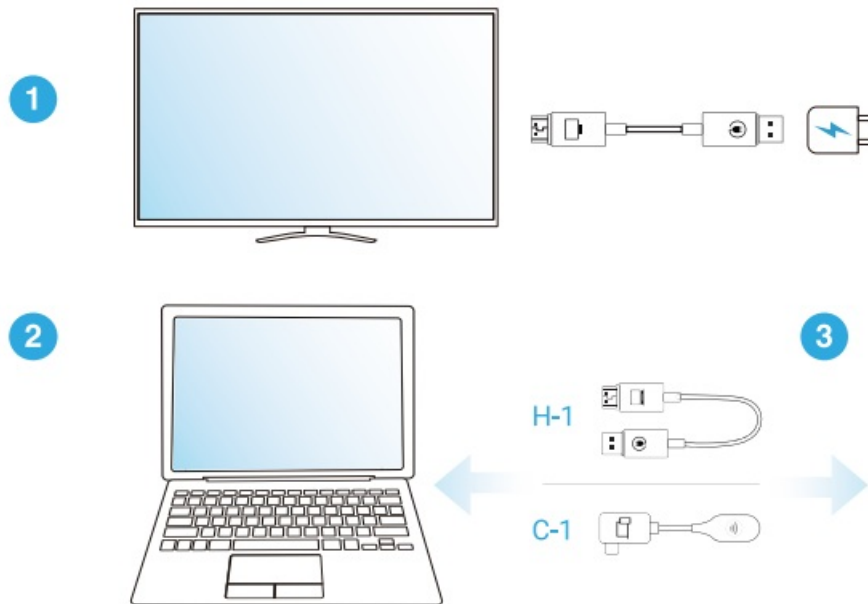

1. Install receiver:

- Connect the wireless display receiver to your screen and power it on.

2. Plug and mirror:

- Plug the transmitter H-1/C-1 into a laptop or mobile, connect it to the power supply, and wait for mirroring automatically.

3. Stop and restart:

- Remove the transmitter H-1/C-1 to stop mirroring, and plug the transmitter to restart mirroring.

If unable to mirror, please pair your transmitter to the receiver again. Scan the QRCode below and follow the steps in the full manual.

- **Distributor:** Shenzhen ShafanTechnology Co.,Ltd
- **Brand Owner:** Shenzhen Qixing Longyuan
- **Technology Co.,Ltd**
- **Address:** RM. 808, No. 1 Binhai Bay, RD. Yanxing, Dist.
- **Bao'an, Shenzhen City, Guangdong Province, China** support@lemorele.com

Documents / Resources

	<p>Lemoirele P10 Wireless USB C Transmitter [pdf] User Manual</p> <p>P10 Wireless USB C Transmitter, P10, Wireless USB C Transmitter, USB C Transmitter, Transmitter</p>
---	--

References

- [User Manual](#)

Manuals+.