



Lemokey L4 Wireless  
Mechanical Keyboard  
User



# Lemokey L4 Wireless Mechanical Keyboard User Guide

[Home](#) » [Lemokey](#) » Lemokey L4 Wireless Mechanical Keyboard User Guide 

## Contents

- 1 Lemokey L4 Wireless Mechanical Keyboard User
- 2 Quick Start Guide
- 3 L4 WIRELESS MECHANICAL KEYBOARD OVERVIEW
- 4 DEFAULT KEY LAYOUT
- 5 KEY DESCRIPTION
- 6 KEY DESCRIPTION
- 7 FUNCTION DESCRIPTION
- 8 TROUBLESHOOTING
- 9 Documents / Resources
  - 9.1 References
- 10 Related Posts



**Lemokey L4 Wireless Mechanical Keyboard User**



- Fully Assembled Version

## Keyboard

- 1x Fully Assembled Keyboard

## Including

- 1x Aluminum Case
- 1x PCB
- 1x Aluminum Plate
- 1x Sound Absorbing Foam
- 1x IXPE Foam
- 1x PET Film
- 1x EPDM Foam
- 1x Bottom Case PET Film
- 7x Gaskets Silicone Beans Installed
- 16x Gaskets Silicone Sockets (2 installed and 14 in the Box) 5 Sets x Stabilizers
- 1 Set x Keycaps (PBT Double-shot)
- 1 Set x Switches

## Cable

- 1x Type-C Cable
- 1x Type-A to Type-C Adapter
- 1x Extension Adapter For Receiver



## Receiver

- 1x Type-A 2.4GHz Receiver

## Tools

- 1x Keycap-Switch Puller
- 1x Screwdriver
- 1x Hex Key

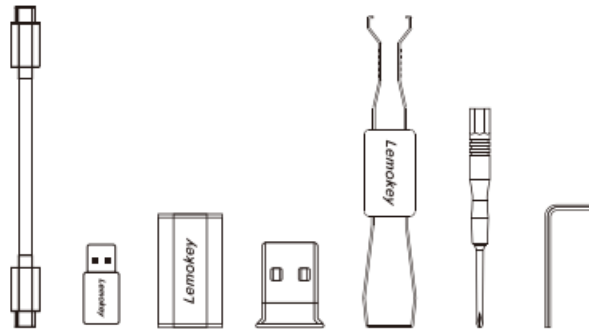

## Barebone Version

### Keyboard Kit

- 1x Keyboard Kit (Without Keycaps & Switches)

### Including

- 1x Aluminum Case
- 1x PCB
- 1x Aluminum Plate
- 1x Sound Absorbing Foam
- 1x IXPE Foam
- 1x PET Film
- 1x EPDM Foam
- 1x Bottom Case PET Film
- 7x Gaskets Silicone Beans Installed
- 16x Gaskets Silicone Sockets (2 installed and 14 in the Box) 5 Sets x Stabilizers

### Cable

- 1x Type-C Cable
- 1x Type-A to Type-C Adapter
- 1x Extension Adapter For Receiver

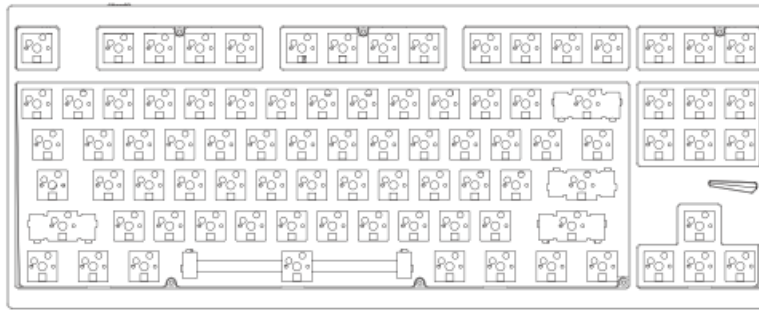

## Receiver

- 1x Type-A 2.4GHz Receiver

## Tools

- 1x Keycap-Switch Puller
- 1x Screwdriver
- 1x Hex Key

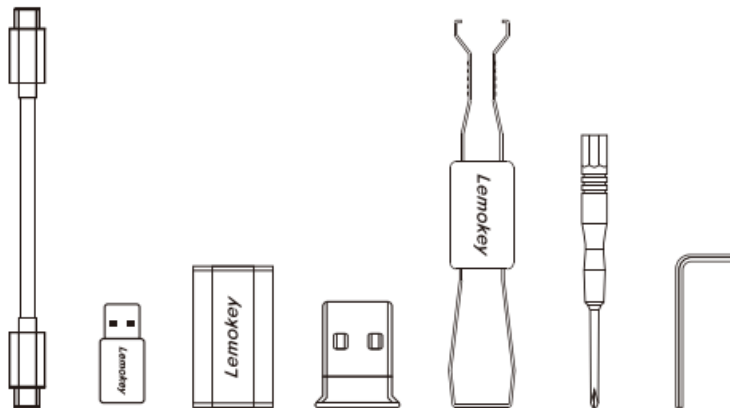

## Quick Start Guide

The default system of this product is Windows.

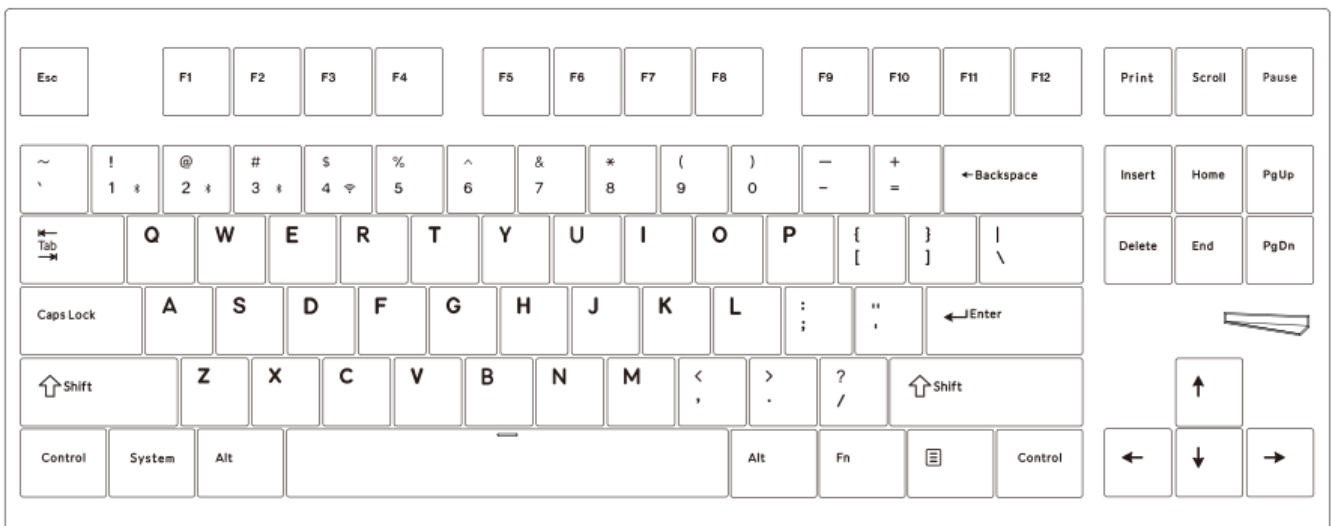

## 1. Connect 2.4GHz Receiver

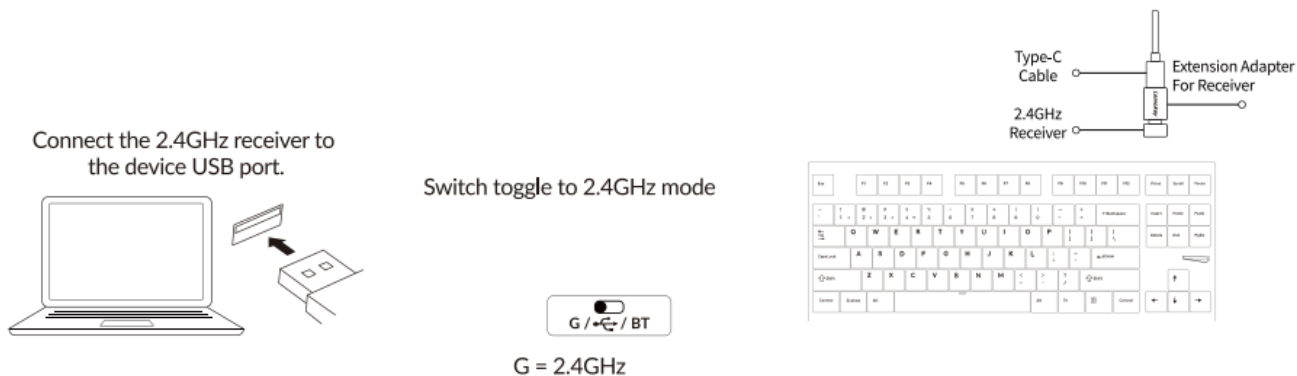

Note: For the best wireless experience, we recommend using the extension adapter for receiver and putting the 2.4GHz receiver somewhere on your desk close to your keyboard for a low rate of latency and fewer signal interferences.

## 2. Connect Bluetooth

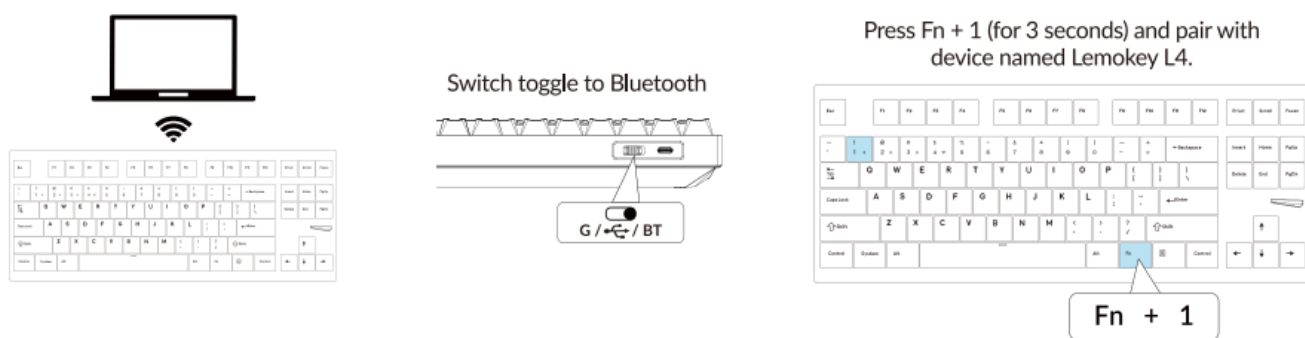

5

## 3. Connect Cable

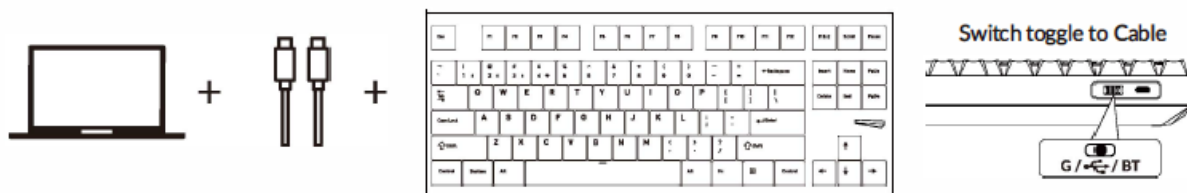

## 4. The Lemokey Launcher App

Please visit [launcher.lemokey.com](https://launcher.lemokey.com) to use the online Launcher web app to remap the keys, create macro commands, or flash the firmware. If the Launcher cannot recognize your keyboard, please reach our support to get the instructions.

'The online Launcher can only run on the latest version of Chrome, Edge, and Opera browsers. '

The Launcher only works when the keyboard is connected by wire to the computer.



## 5. Switch to Mac

Please find the Mac keycaps in the box, and follow the instructions below to find and replace the following keycaps.

Use the online launcher app to remap the Windows keys to Mac keys.



+



## 6. The Backlight

Press Fn + Q to change the lighting effect



Press Fn + Tab to turn the backlight on/off



## 7. Adjust The Backlight Brightness

Press Fn + W to increase the backlight brightness



Press Fn + S to decrease the backlight brightness



## 8. Adjust The Backlight Speed

Press Fn + T to increase the light effect speed

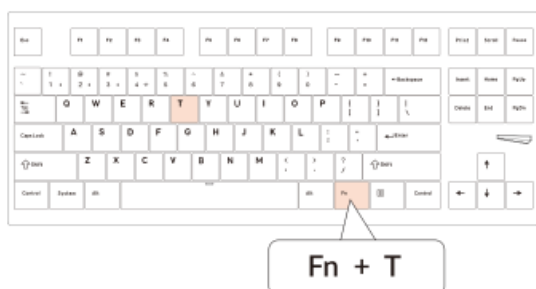

Press Fn + G to decrease the light effect speed

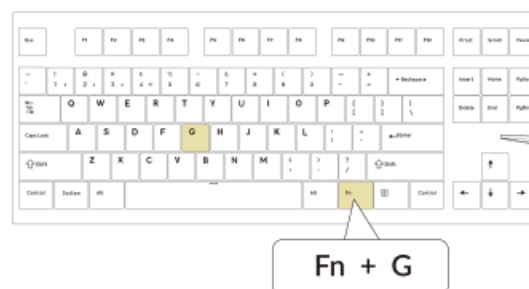

## 9. The Key Rollover

6-key rollover: the keyboard can detect up to 6 simultaneous key inputs. N-key rollover: the keyboard can detect all key inputs without limit to the number of key presses.

The keyboard turns on the 6-key rollover by default.

Press Fn + N to switch N-key rollover / 6-key rollover

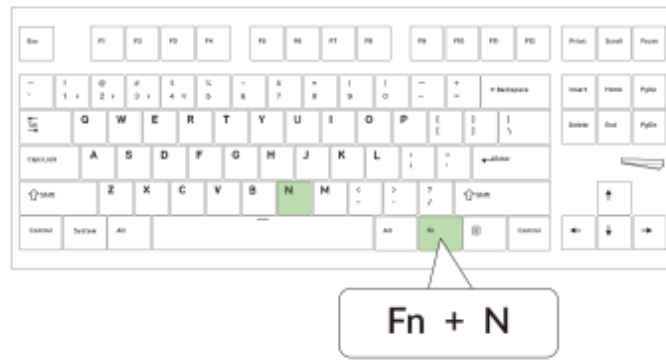

## 10. Warranty

The keyboard is highly customizable and easy to be rebuilt. If anything goes wrong with any of the keyboard components of keyboard during the warranty period, we will only replace the defective parts of the keyboard, not the whole keyboard.



## 11. Factory Reset & Firmware Update

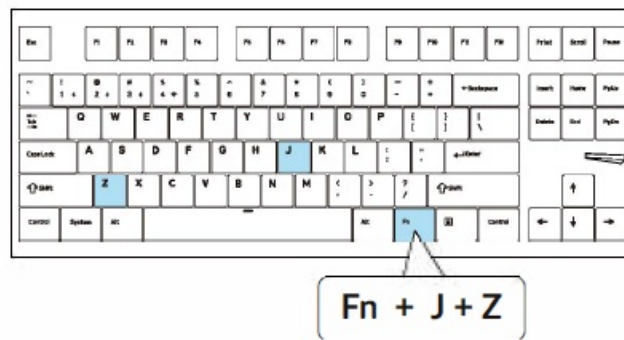

Troubleshooting? Don't know what's going on with the keyboard?

### Factory reset your keyboard

1. Power on your keyboard.
2. Press and hold Fn + J + Z (for 4 seconds). The keyboard backlight will flash in red quickly for 3 seconds, indicating that the keyboard has been reset.

### Flash your keyboard firmware

1. Visit [launcher.lemokey.com](https://launcher.lemokey.com) to open the online Launcher web app.
2. Ensure the keyboard is in Cable or Wired mode and plug in the power cable.

3. Find the 'Firmware Update' tab on the left side of the Launcher and connect your keyboard with it.
4. Follow the instructions on the Launcher and complete the firmware update.

\* Step-by-step guide, search the keyword "firmware" on [lemokey.com](http://lemokey.com)

## L4 WIRELESS MECHANICAL KEYBOARD SPECIFICATIONS

- Number of keys: 87
- Switch type: Mechanical
- Battery: 4000mAh
- Wireless working time (RGB): Up to 100 hours (Lowest brightness)
- Charging time: Around 4 hours
- Charging port: Type-C
- Mode: 2.4GHz / Bluetooth / Wired
- 2.4GHz / Bluetooth operating distance: Within 10 meters (open space)
- Name of Bluetooth device: Lemokey L4
- Operating environment: -10 to 50°C
- Technical specifications can be subjected to change without notice, we apologize for any inconvenience caused.

## L4 WIRELESS MECHANICAL KEYBOARD OVERVIEW

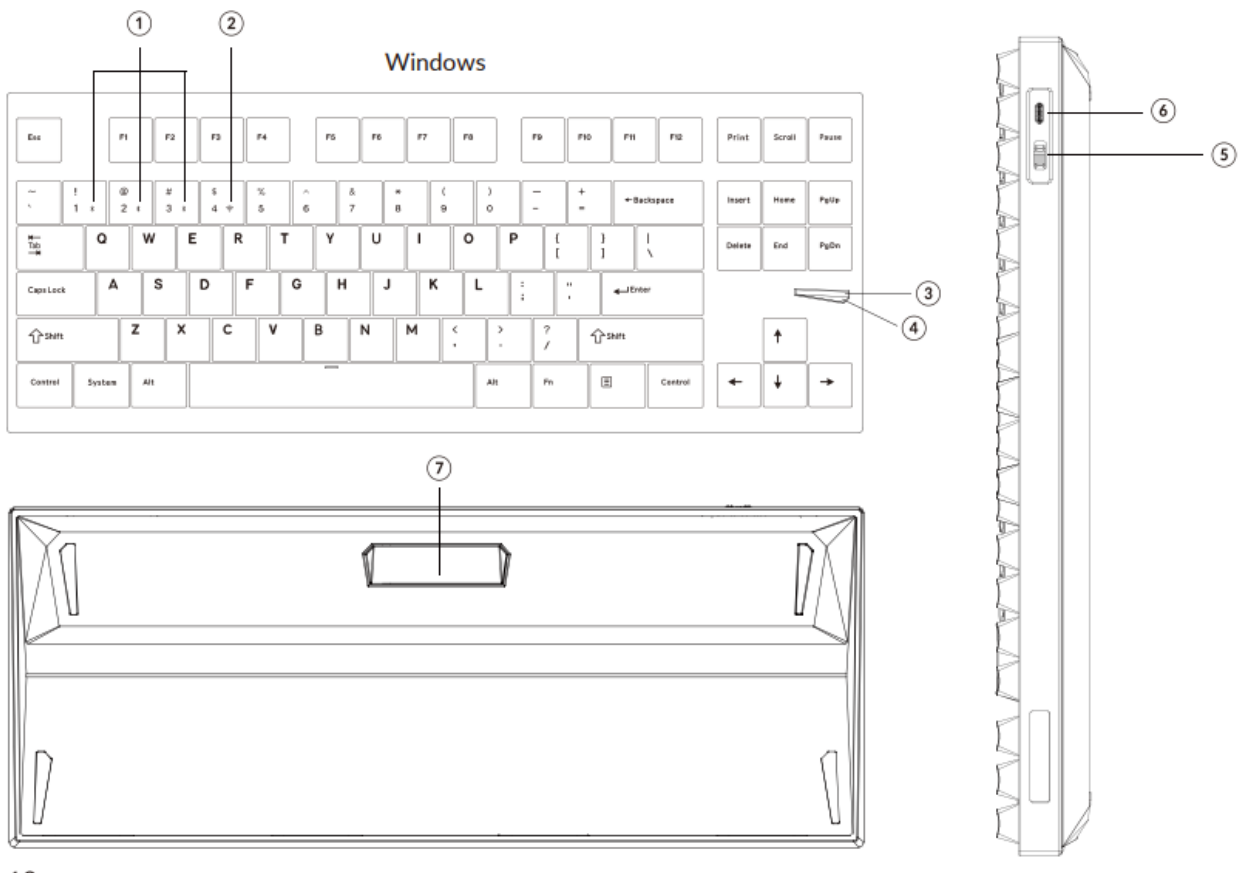

1. Bluetooth Channel Indicator
2. 2.4GHz Channel Indicator
3. Caps Lock Indicator



4. Power Indicator
5. Cable BT (Mode Toggle Switch)
6. Type-C Charging Port
7. Receiver Compartment

## DEFAULT KEY LAYOUT

LAYER 0: This is the default layer.

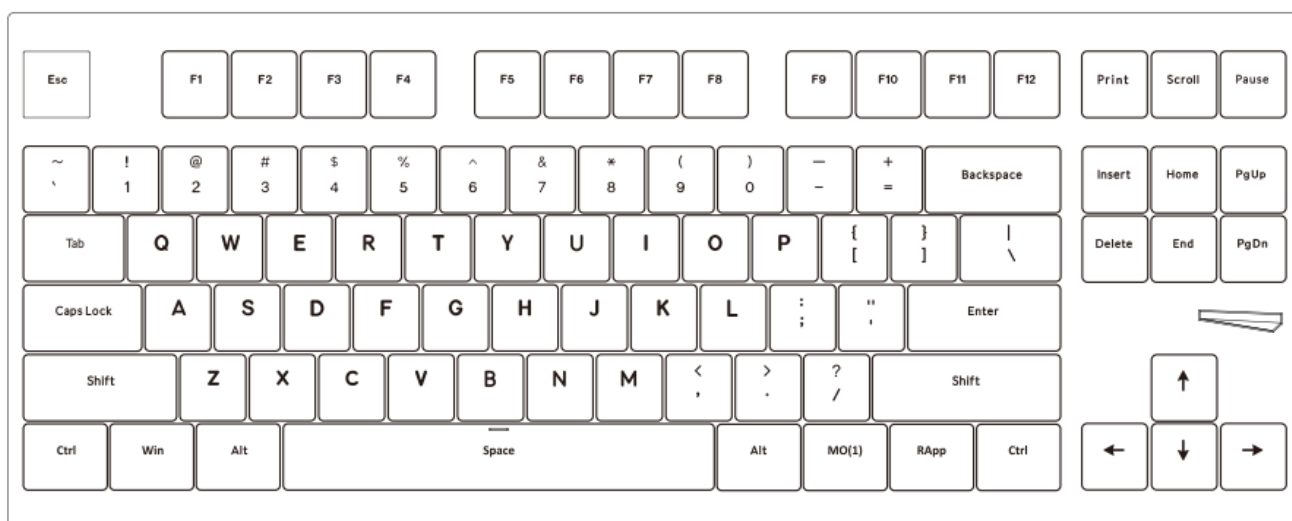

RApp = Right App

1. LAYER 1: This layer will be activated when you press the Fn/MO(1) key.

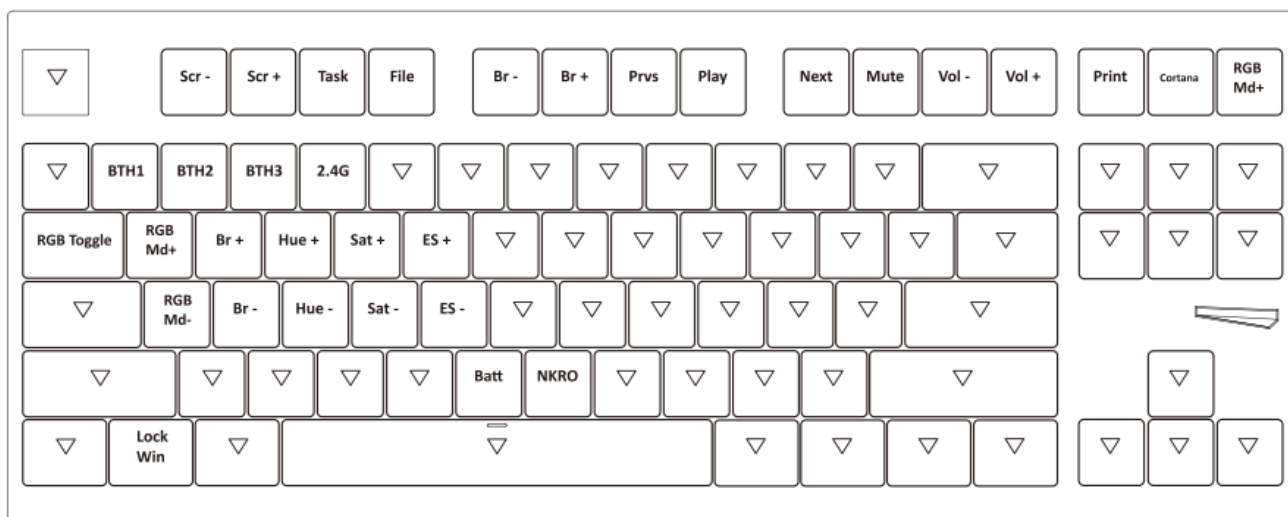

2. LAYER 2 / LAYER 3: This is a blank layer.

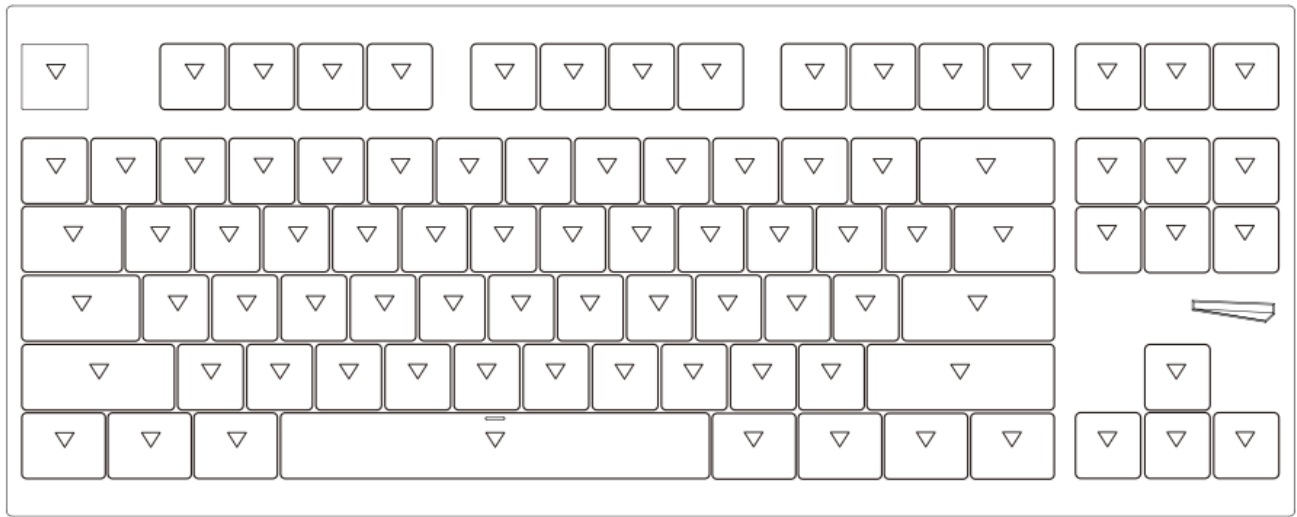

KEY DESCRIPTION

| Key Description |                            | Key Description |   | Key Description |                     |
|-----------------|----------------------------|-----------------|---|-----------------|---------------------|
| Scr -           | Screen Brightness Decrease | RGBMd-          | RGB Mode Previous                               | Sat +           | Saturation Increase |
| Scr +           | Screen Brightness Increase | Hue +           | Hue Increase                                    | Sat -           | Saturation Decrease |
| Br -            | Backlight Decrease         | Hue -           | Hue Decrease                                    | 2.4G            | 2.4GHz Host         |
| Br +            | Backlight Increase         | ES +            | RGB Speed Increase                              | Reset           | Reset the keyboard  |
| Prvs            | Previous                   | ES -            | RGB Speed Decrease                              | Batt            | Battery life        |
| Play            | Play/Pause                 | MO(1)           | Layer 1 will be activated when holding this key | NKRO            | N-key rollover      |
| Next            | Next                       | MO(2)           | Layer 2 will be activated when holding this key | Task            | Task View           |
| Mute            | Mute                       | MO(3)           | Layer 3 will be activated when holding this key | File            | File Explore        |
| Vol -           | Volume Decrease            | MO(4)           | Layer 4 will be activated when holding this key |                 |                     |
| Vol +           | Volume Increase            | BTH1            | Bluetooth Host 1                                |                 |                     |
| RGB Toggle      | Turn Backlight on/off      | BTH2            | Bluetooth Host 2                                |                 |                     |
| RGBMd+          | RGB Mode Next              | BTH3            | Bluetooth Host 3                                |                 |                     |

KEY DESCRIPTION

| LED Location                 | Function           | Status   |
|------------------------------|--------------------|--|
| Power Indicator              | Charging           | Charging - Static Red<br>Fully charged - Static Green                      |
| Bluetooth / 2.4GHz Indicator | Bluetooth / 2.4GHz | Pairing - Slow Blinking<br>Paired - Light Off<br>Switching - Fast Blinking |
| Caps Lock Indicator          | Caps Lock          | Enable Caps Lock - Static Blue<br>Disable Caps Lock - Light Off            |

## FUNCTION DESCRIPTION

### CHARGING

- Plug the cable into a USB port and plug the other end into the keyboard port. Power Indicator:
- A red light will stay on while charging; Fully charged in around 4 hours, a green power indicator will appear.
- \*The Lemokey keyboard is compatible with all USB ports. Please use a SY 1.5A adapter or USB 3.0 for the best performance. The Lemokey L4 can be charged in 2.4 GHz/Cable/Bluetooth mode.
- \*\*This product supports up to 5V charging voltage and 1.5A charging current. We are not responsible for any problems caused by improper charging.

### 2.4GHz | CABLE/ BLUETOOTH MODE (MODE TOGGLE)

#### 2.4GHZMODE

1. Connect the 2.4GHz receiver to your device's USB / Type-C Port.
2. Switch the toggle to the 2.4GHz option. The keyboard will automatically connect to your device.

#### BLUETOOTH MODE

1. Switch the toggle to the Bluetooth option.
  2. Backlighting will be turned on.
  3. Hold "Fn+1" key for 3 seconds to activate Bluetooth pairing (the Bluetooth indicator fast flashes for 3 minutes to detect pairing).
  4. Search for the Bluetooth device "Lemokey L4" on your device and connect it (the Bluetooth indicator goes off after successful pairing).
- Note: This keyboard supports pairing up to 3 devices simultaneously via key combination "Fn" + "1" | "Fn" + "2" | "Fn" + "3".
  - \*The Bluetooth indicator will continue to flash for 3 minutes.
  - \*\*Slow or failed connections may exist due to different Bluetooth versions, please make sure all the settings are correct.

### SWITCH BLUETOOTH DEVICES

Short press key combination “Fn” + “1” / “Fn” + “2” / “Fn” + “3” to switch to other device.

## **RECONNECT**

1. Switch the keyboard to the Bluetooth option to activate the keyboard.
2. The Bluetooth indicator flashes for 3 seconds and automatically pairs with the last paired device.
3. If the Bluetooth indicator is off, press any button to enter the connection again.

\* The keyboard must have been paired with the device to perform this function.

## **WIRED MODE**

1. Switch the toggle to the Cable option (it only works when a USB cable is plugged in).
2. Connect our cable with your PC and keyboard.
3. Backlighting will be turned on.

\*Under Wired Mode, keyboard will not enter into Battery Saver Mode.

## **TURN OFF THE KEYBOARD**

Switch the keyboard to the Cable option and unplug the power cable.

## **BACKLIGHT SETTING**

- Short press key combination “Fn” + “Tab” to turn the backlight on/off.
- Short press key combination “Fn” + “Q” / “Fn” + “A” to switch between different types of lighting effects.

## **TROUBLESHOOTING**

- If unable to pair keyboard to device, confirm that the device you’re trying to pair with is Bluetooth-capable. If so, restart the device and try pairing it with the keyboard again.
- Note: On a Windows computer, a new Bluetooth connection will sometimes require additional software updates-a process that may still be ongoing after a message appears indicating a successful completion. Wait at least 20 minutes after pairing to make sure all updates are completed before restarting the computer.
- Confirm that the device is configured to accept Bluetooth connections (Windows) and supports an external keyboard (HID profile).

**Go to Bluetooth Devices > Open Settings and select the following:**

- Allow Bluetooth devices to find this computer
- Allow Bluetooth devices to connect to this computer
- Alert me when a Bluetooth device wants to connect
- My keyboard isn’t working in Bluetooth mode.

**For the computer/smartphone:**

- Go to your device Bluetooth settings>Select the keyboard and remove/delete/unpair it.
- Then restart your device.

## For the keyboard:

- Turn the keyboard off and back on. Then reconnect it to your device.

## My keyboard isn't working in 2.4 GHz mode.

- Ensure the toggle is set to 2.4 GHz, remove the receiver from your device, and press “Fn” + “4” for 3 seconds to force pair, then reinsert the receiver into the device, keeping the keyboard within 20 cm of the receiver for optimal pairing.

## Wireless connection is interrupted even within 10 meters.

- Check if the keyboard is resting on a metal surface that can interfere with the wireless signal.

## Third-party input tools are not compatible with the keyboard.

- Due to compatibility, versions, brands and drivers of Windows/Android OS, functions of third-party input tools may be affected while using the keyboard. Please make sure your operating system and drivers are up to date.

## Certain function keys or multimedia keys do not work.

- Functions of certain multimedia keys may be disabled due to compatibility, versions, brands, and drivers of devices.

- \*Function keys:

F1 / F2 / F3 / F4 / F5 / F6 / F7 / F8 / F9 / F10 / F11 / F12

- Multimedia keys:

🔊 / 🔇 / 🔊 / 🔇 / 🔊 / 🔇 / 🔊 / 🔇 / 🔊 / 🔇 / 🔊 / 🔇 / 🔊 / 🔇 / 🔊 / 🔇

## Safety Precaution

Keep the product, accessories and packaging parts out of the reach of children to prevent any accidents and choking hazards.

Always keep the product dry to avoid corrosion.

Do not expose the product to extreme temperatures below -10°C(5°F) or above 50°C(122°F) to preserve the lifespan of the keyboard.

Find us at: <https://www.lemokey.com>

[Support@lemokey.com](mailto:Support@lemokey.com)

ll@lemokey @ @lemokey.keyboard }# @lemokey \_com Designed by Lemokey Made in China

## Documents / Resources

|   |  |
|---|--|
| <br>Lemokey<br>L4 Wireless Mechanical Keyboard | <a href="#">Lemokey L4 Wireless Mechanical Keyboard</a> [pdf] User Guide<br>L4 Wireless Mechanical Keyboard, L4, Wireless Mechanical Keyboard, Mechanical Keyboard, Keyboard |
|---|--|

## References

- [User Manual](#)

[Manuals+](#), [Privacy Policy](#)

This website is an independent publication and is neither affiliated with nor endorsed by any of the trademark owners. The "Bluetooth®" word mark and logos are registered trademarks owned by Bluetooth SIG, Inc. The "Wi-Fi®" word mark and logos are registered trademarks owned by the Wi-Fi Alliance. Any use of these marks on this website does not imply any affiliation with or endorsement.