

LEITNER
LEITNER 00-GCLBA-1759
Grenadier Chase Light
Bracket

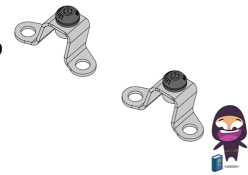

LEITNER 00-GCLBA-1759 Grenadier Chase Light Bracket Instruction Manual

[Home](#) » [LEITNER](#) » LEITNER 00-GCLBA-1759 Grenadier Chase Light Bracket Instruction Manual 

Contents

- [1 LEITNER 00-GCLBA-1759 Grenadier Chase Light Bracket](#)
- [2 Product Usage Instructions](#)
- [3 ASSEMBLY / INSTALLATION INSTRUCTIONS](#)
- [4 TOOLS REQUIRED](#)
- [5 Hardware](#)
- [6 use guidelines](#)
- [7 Warranty](#)
- [8 Documents / Resources](#)
 - [8.1 References](#)
- [9 Related Posts](#)



LEITNER 00-GCLBA-1759 Grenadier Chase Light Bracket

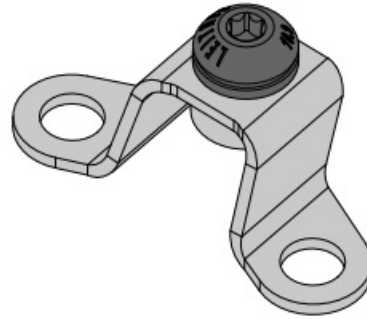

Product Specifications:

- Product Name: Grenadier Chase Light Bracket
- Part Number: 00-GCLBA-1759
- Installation Time: 15-20 minutes
- Tools Required: Basic hand tools

Product Usage Instructions

Tools Required for Installation:

Basic hand tools are required for the installation of the Grenadier Chase Light Bracket.

Installation Steps:

1. Remove M6 bolts from under tow hooks.
2. Install the Chase Light Bracket.
3. Install the light bracket.

Use Guidelines:

When using Leitner Designs carriers and accessories, it is important to follow these guidelines:

- Understand the precautions before using the rack system.
- Ensure safety by following the listed points.

Warranty Information:

The warranty period for the Grenadier Chase Light Bracket is two years from the date of purchase. Please note the following warranty details:

- Damage caused by high-speed off-road driving and abuse is not covered under warranty.
- Gear pods are water-resistant, not waterproof. Store items that can be damaged by water in an airtight container before placing them in the gear pod.

- Limitations and exclusions apply to implied warranties and incidental or consequential damages. Contact Leitner Designs Customer Service for warranty issues.

Frequently Asked Questions (FAQ):

- **Q: What should I do if I encounter issues with the product during installation?**

A: If you encounter any issues during installation, please contact Leitner Designs Customer Service at [949-395-3049](tel:949-395-3049) or email Sales@leitnerdesigns.com for assistance.

Grenadier chase light bracket

LEITNERDESIGNS.COM | SALES@LEITNERDESIGNS.COM | [949-395-3049](tel:949-395-3049)

ASSEMBLY / INSTALLATION INSTRUCTIONS

PART NUMBER:

00-GCLBA-1759

TOOLS REQUIRED

- t30 torx
- t40 torx

INSTALLATION TIME

15-20 minutes

Basic knowledge of hand tools required

SKILL LEVEL



Hardware



Remove: M6 bolts from under tow hooks

- Remove the two M6 bolts that are situated directly under the rear tow hooks using a T30 torx wrench.
- Repeat for other side if you are installing both light brackets.



Install: Chase light bracket

- using the bolts removed in previous step install chase light bracket as shown.



Install: light bracket

- install light bracket first using supplied M8 screw. Then attach light.
- We recommend the following lights for this kit. however most lights that are 2" X 3" will work in this location.
- Baja designs S2 Sport with the work/scene clear lens part # 547806
- Baja designs S2 Sport with the work/scene amber lens part # 547816





use guidelines

When using Leitner Designs carriers and accessories, the user must understand the precautions. The points listed below will assist you in using the rack system and will encourage safety.

- For quality fits and safety, use only the recommended rack or accessories. Do not assume a rack will fit, always check the current Fit Guide when obtaining a new vehicle.
- The maximum load is not to be exceeded. (250# off road – 500# on road). However, this limit is always subordinate to the maximum load recommended by the manufacturer of the vehicle itself. It is always the lower maximum recommended load that applies. $\text{Max truck load} = \text{load carrier weight} + \text{any fitted carrier accessories} + \text{the weight of the load itself}$.
- high-speed off-road driving even with a light load can cause damage to the rack, accessories and vehicle body. Damage caused by high speed driving and abuse is not covered under warranty.
- Make sure all knobs, bolts, screws, straps, and locks are firmly attached, tightened and locked before every trip. Knobs, bolts, screws, straps and locks must be periodically inspected for signs of wear, corrosion, and fatigue. Check your load at stops during the trip to ensure continued fastening security.
- Check local and state laws governing projection of objects beyond the perimeter of a vehicle. Be aware of the width and height of your cargo since low-clearance branches, bridges, and parking garages can affect the load. All cargo will affect the vehicle's driving behavior. Never drive with any lock, knob or rack in an open or unlocked position. All long loads such as, but not limited to, sailboards, surfboards, kayaks, canoes, and lumber must be tied down front and rear to the bumpers or tow hooks of the vehicle.
- All locks must be turned and moved periodically to ensure smooth operation. Use graphite or dry lubricant to help this. Leitner designs locks are designed to deter vandalism and theft but should not be considered theft-proof. Remove valuable gear if your vehicle is unattended for an extended period. Place at least one key in the glove compartment.
- For safety to your vehicle and rack system, obey all posted speed limits and traffic cautions. Adapt your speed to the conditions of the road and the load being carried.

- Do not use Leitner Designs load carriers and accessories for purposes other than those for which they were designed. Do not exceed their carrying capacity. Failure to follow these guidelines or the product's instructions will void the warranty.

Warranty

Leitner Designs warrants product to be free from defects in material and workmanship, for terms specified below, provided there has been normal use and proper maintenance. All remedies under this warranty are limited to the repair or replacement of any item found by the factory to be defective within the time period specified. If you have a warranty claim, first you must call our factory at the number below for instructions. You must retain proof of purchase and submit a copy with any items returned for warranty work.

Upon completion of warranty work, if any, we will return the repaired or replaced item or items to you freight prepaid. Damage to our products caused by accidents, Fire, vandalism, negligence, mis-installation, misuse, Acts of God, or by defective parts not manufactured by us, is not covered under this warranty.

THE WARRANTY TIME PERIOD IS AS FOLLOWS: (2) TWO YEARS FROM DATE OF PURCHASE.

high speed off road driving even with a light load can cause damage to the rack, accessories and vehicle body. Damage caused by high speed off road driving and abuse is not covered under warranty. gear pods are water resistant and not waterproof. Items that can be damaged by water should be stored inside there own air tight container before being placed in the gear pod.

ANY IMPLIED WARRANTIES OF MERCHANTABILITY AND/OR FITNESS FOR A PARTICULAR PURPOSE CREATED HEREBY ARE LIMITED IN DURATION TO THE SAME DURATION AND SCOPE AS THE EXPRESS WRITTEN WARRANTY. OUR COMPANY SHALL NOT BE LIABLE FOR ANY INCIDENTAL OR CONSEQUENTIAL DAMAGE.

Some states do not allow limitations on how long an implied warranty lasts, or the exclusion or limitation of incidental or consequential damages, so the above limitations or exclusions may not apply to you. This warranty gives you specific legal rights, and you may also have other rights that vary from state to state. FOR WARRANTY ISSUES WITH THIS PRODUCT PLEASE CALL LEITNER DESIGNS CUSTOMER SERVICE [949-395-3049](tel:949-395-3049) or email us at Sales@leitnerdesigns.com

V1 | Page 7

Documents / Resources

	<p>LEITNER 00-GCLBA-1759 Grenadier Chase Light Bracket [pdf] Instruction Manual 00-GCLBA-1759 Grenadier Chase Light Bracket, 00-GCLBA-1759, Grenadier Chase Light Bracket, Chase Light Bracket, Light Bracket, Bracket</p>
---	--

References

- [Truck Bed Rack Systems | Rack Systems for Trucks | LEITNER Designs ACS](#)
- [User Manual](#)

