

# legrand WZ3ACB40 Wireless Smart Scene Controller with Zigbee 3.0 Instruction Manual

[Home](#) » [Legrand](#) » legrand WZ3ACB40 Wireless Smart Scene Controller with Zigbee 3.0 Instruction Manual 

Contents

1 legrand WZ3ACB40 Wireless Smart Scene Controller with Zigbee 3.0

2 INSTALLATION INSTRUCTIONS

2.1 One-Gang Electrical Box Installation

3 Electrical box installation

4 Multi-Gang Electrical Box Installation

5 Wall Surface Installation

6 Getting to Know Your Battery-Powered Device

7 Technical Assistance

8 LIMITED TWO-YEAR WARRANTY

9 Documents / Resources

9.1 References

10 Related Posts



legrand WZ3ACB40 Wireless Smart Scene Controller with Zigbee 3.0

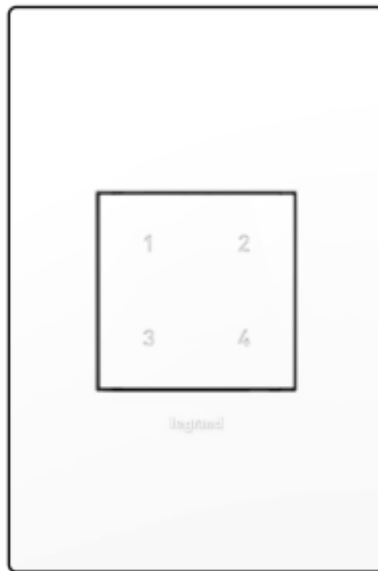

**Wall plate sold separately**

#### **Wireless Smart Scene Controller**

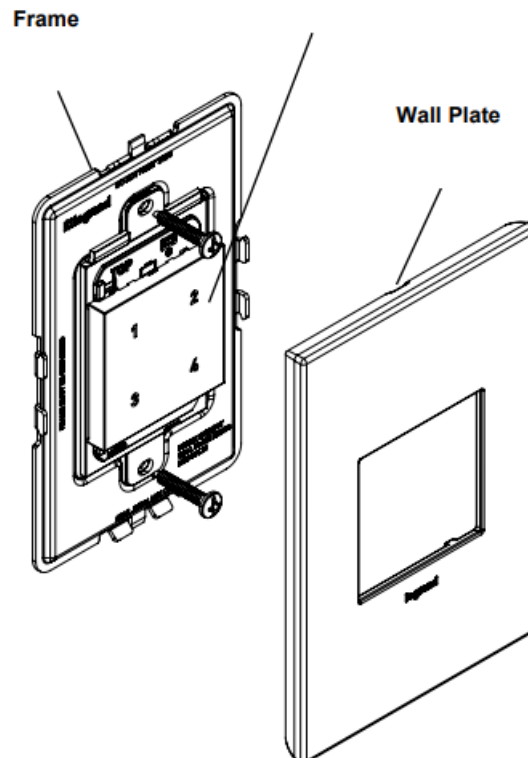

## **INSTALLATION INSTRUCTIONS**

Please read these instructions completely before you begin. This adorne® wireless smart scene remote is designed for installation in standard electrical boxes or directly on a wall surface. However, some of the installation methods vary slightly from traditional methods. If you do not understand these instructions or are unsure of your abilities, seek the assistance of a qualified electrician.

1. Choose a place to install the Device For indoor installation only. This device can be installed in any standard electrical wall box of any gang size, or on any flat wall surface.

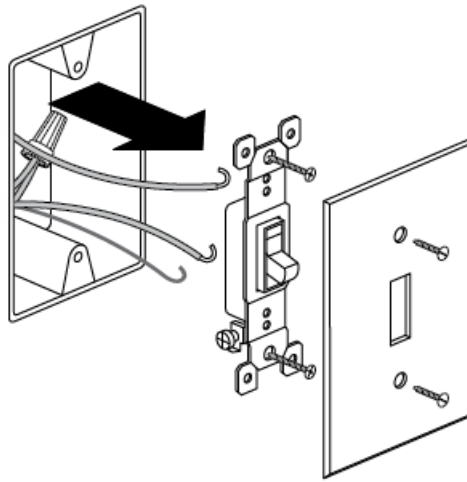

## WARNING

- To prevent severe shock or electrocution, always disconnect power at the service panel before beginning work.
- Failure to connect the ground wire will result in an unsafe installation that could lead to personal injury.

## One-Gang Electrical Box Installation

**Note:** Skip Section 2, if installing on a wall surface.

## Electrical box installation

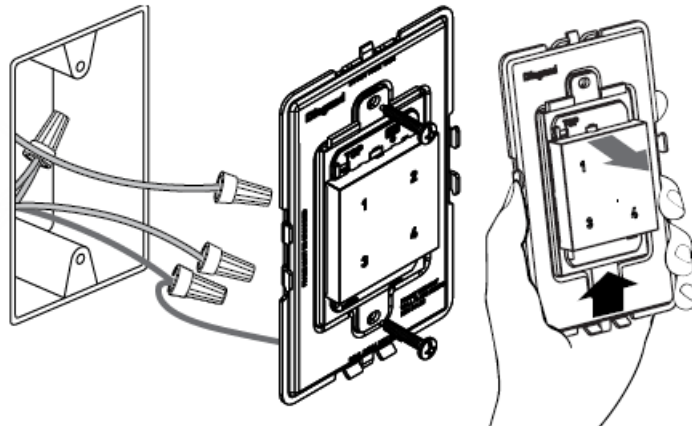

Remove the grounding wire label from the back of the device to access the ground wire. Connect it to the box ground using provided wire nut. Terminate and cap with wire nuts any] other wires in the box. Mount devise to wall box with screws provided. Tighten screws just enough to hold the frame in place. Do NOT overtighten.

## Multi-Gang Electrical Box Installation

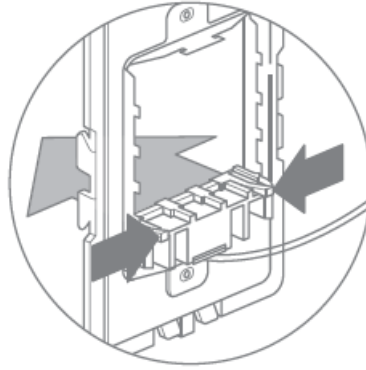

**NOTE:** Skip section 2 if installing on a wall surface.

In case of multi-gang installation, replace the provided frame with an **adorne®** multi-gang frame. While holding the frame with one hand, push the device up slightly until it snaps out, and then pull it out of the frame. Secure the device to the multi-gang frame using frame mounting screws.

**Remove spacers from the frame:** Since this device fills the frame completely, you will not need the spacers. From the back of the frame, pinch the tabs on the spacer to release.

## Wall Surface Installation

**NOTE:** See Section 2, if installing in a box.

Use provided double-sided stickers to install on a tiled or another smooth surface. Markings on the back of the device indicate location for the stickers. If the wall surface is uneven or rough, where the adhesive may not work, use drywall screws to attach to wall stud. If a wall stud is not present, use drywall anchors to secure it.

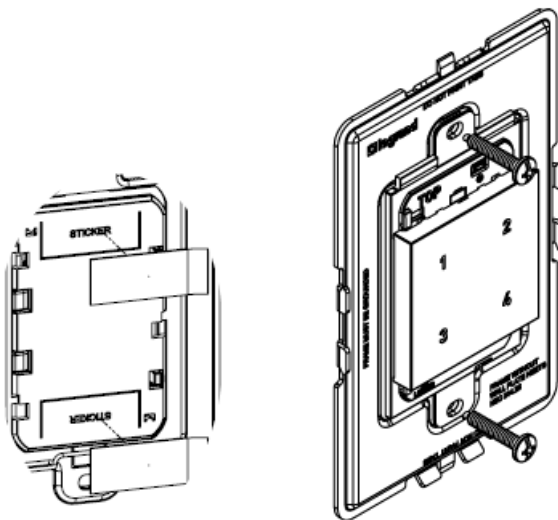

- Using Adhesive
- Using Screws

## Set Up Your System (connect to your network)

- This device is designed to work with an approved Zigbee Hub. Please see the onboarding instructions for the Zigbee Hub before removing the battery tab.

## Getting to Know Your Battery-Powered Device

Item	Name	Description
1	LED Indicator Light	Indicates the current state of device during setup.
2	EZ Button	Used to setup or reset your device.
3	Battery	CR2032 3V battery - Replaceable.

### LED Indicator Light Explanations

State of Light	Explanation
Blinking Green	Device is attempting to connect to the network.

### Reset To Factory Default (Figure D)



To manually reset the device to factory defaults, press and hold the EZ Button for 10 seconds until you see the

LED blink red, then release. The LED will turn off when the reset is complete. Due to ongoing product improvements, Legrand reserves the right to change specifications without notice. For the most recent instruction sheets or more information on this product, please see this link or scan the QR code:

<https://www.legrand.us/markets/hospitality/smart-hospitality>

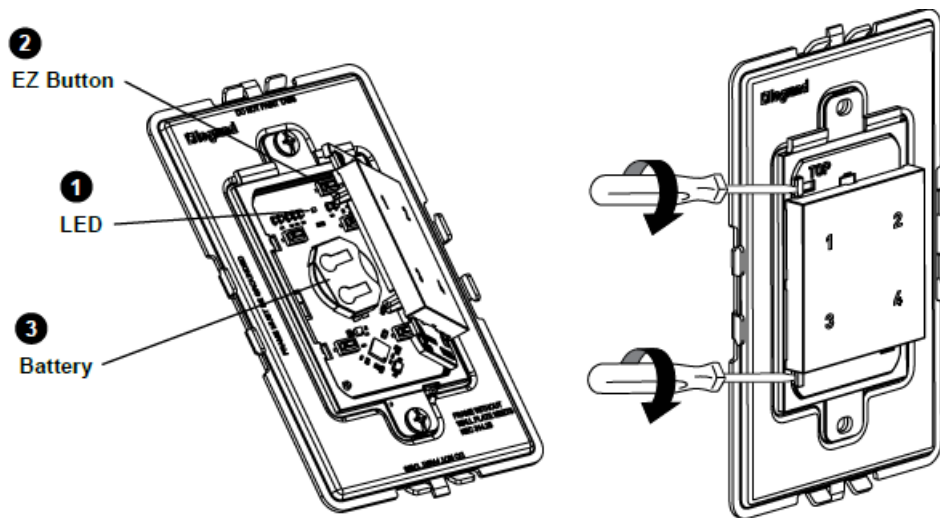

### Battery Replacement

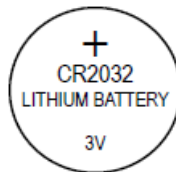

- The device includes a CR2032 battery. To replace the battery, Remove the cover as shown.

### Snap wall plate to the frame

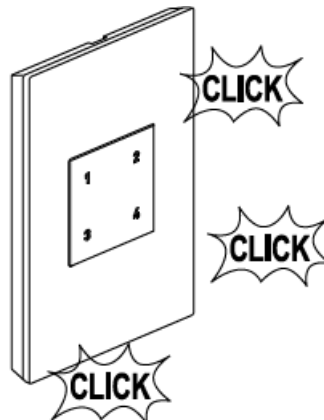

- There are three click-stops to adjust the fit of the wall plate to the device and the wall.

**NOTE:** To remove the wall plate, insert a small, flat screwdriver in notches on the wall plate and twist gently to pry from the frame.

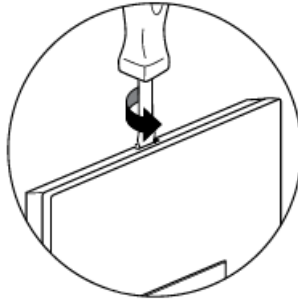

- Never apply cleaner directly to the device or wall plate. Apply to a soft cloth and use a cloth to remove any smudges from the product.

## Technical Assistance

- TEL: (877) 295-3472
- [www.adornemyhome.com/install](http://www.adornemyhome.com/install)

## LIMITED TWO-YEAR WARRANTY

Limited two-year warranty information for adorne® products is available at [www.adornemyhome.com/warranty](http://www.adornemyhome.com/warranty). Limited warranty information for adorne® products may also be obtained free of charge by sending a written request, along with your proof of purchase (including purchase date), to:

- Legrand
- **Attn:** adorne Customer Service/Warranty Department
- 50 Boyd Avenue
- Syracuse, NY 13209
- 60 Woodlawn Street
- West Hartford, CT 06110
- 1.877.BY.LEGRAND
- (295.3472)
- [www.legrand.us](http://www.legrand.us)





## CANADA

- 905.738.9195
- [www.legrand.ca](http://www.legrand.ca)

## Documents / Resources

	<p><a href="#">legrand WZ3ACB40 Wireless Smart Scene Controller with Zigbee 3.0</a> [pdf] Instruction Manual WACB4, 2AU5D-WACB4, 2AU5DWACB4, WZ3ACB40 Wireless Smart Scene Controller with Zigbee 3.0, WZ3ACB40, Wireless Smart Scene Controller with Zigbee 3.0</p>
---	--

## References

-  [Search Results Page](#)
-  [adorne® Warranty Legrand](#)
-  [Legrand US | Delivering and Managing Power, Light, and Data](#)
-  [The adorne® Collection | Legrand](#)
-  [adorne® Warranty Legrand](#)

Manuals+.