



legrand WNRL23 Radiant Wireless Smart Switch with Netatmo Instruction Manual

[Home](#) » [Legrand](#) » legrand WNRL23 Radiant Wireless Smart Switch with Netatmo Instruction Manual 

Contents

- [1 legrand WNRL23 Radiant Wireless Smart Switch with Netatmo](#)
- [2 INSTALLATION](#)
- [3 SETUP](#)
- [4 Documents / Resources](#)
 - [4.1 References](#)
- [5 Related Posts](#)



legrand WNRL23 Radiant Wireless Smart Switch with Netatmo



BEFORE YOU START

Review this guide in its entirety. Consult an electrician with any questions or if you are unsure of your abilities.

WARNING: Incorrect installation could result in death, serious injury, and/or damage to your home or devices.

CAUTION: To reduce the risk of injury and/or overheating and damage to other equipment:

- For dry, indoor use only.
- Do not use to power medical equipment – not suitable as a disconnecting means.

WHAT YOU NEED

Required:

- Phillips-head screwdriver
- Flat blade screwdriver

You May Also Need: Voltage tester, pliers, wire cutter, wire stripper, electrical tape, and wire nut.

INSTALLATION

1. Choose a place to install the device

This device can be installed on a flat wall surface or in any standard U.S. electrical wall box. It may also be installed over the wall next to a standard U.S. electrical wall box, if used with a multi-gang Legrand Radiant wall plate, catalog number beginning with RWP26-XXX.

INSTALLATION (on a wall surface)

2. Use provided double-sided stickers to install on a tiled or another smooth surface. Markings on the back of the device indicate location for the stickers.

3. Use provided mounting screws to install on drywall or uneven surface where the sticker may not work.
Do not remove label or pull out ground wire as device may not sit flush.

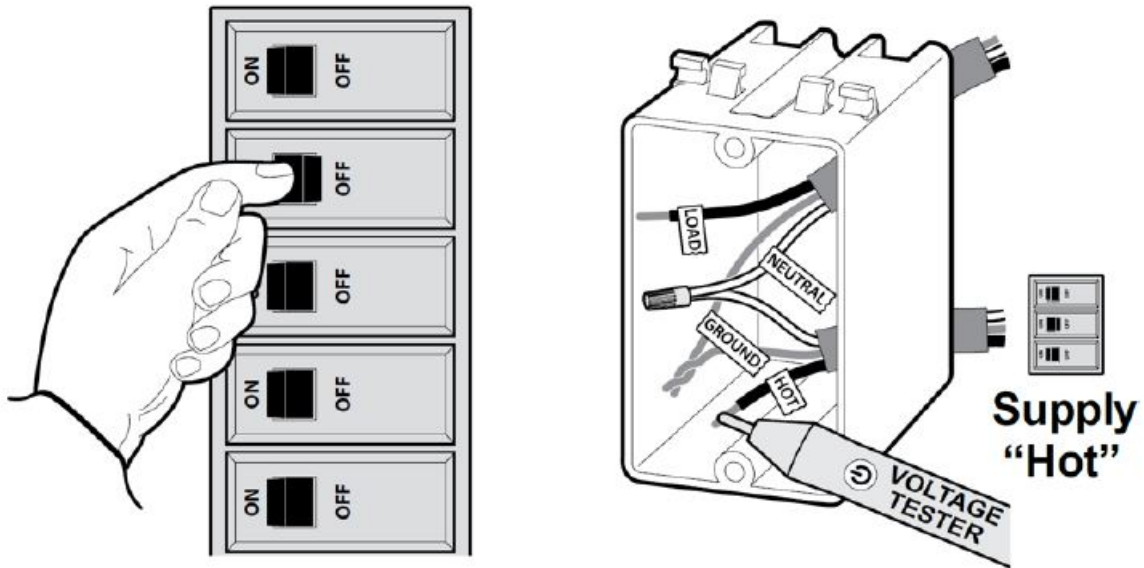

INSTALLATION (in an electrical box)

1. Turn off power to the box at circuit breaker.

Note: Ensure power is off to all devices in the electrical box. Remove old device from box. Install wire nuts to terminate all the exposed wires that were previously connected to the old device. Ensure complete electrical insulation by securing the wire nuts making sure no bare wire is exposed.

2. Install and secure the device
 1. Fold the wires into the electrical box, taking care not to pinch a wire.
 2. Remove label on back of the device to expose ground wire and connect it to the box ground.
 3. Use included mounting screws to secure the device to the electrical box.

INSTALLATION (NEXT TO AN ELECTRICAL BOX)

1. Break off the tabs on device

Break off the tabs at the top and bottom of the device using pliers as shown in image. Mark the location of the device on the wall surface to the left or right of existing device(s) installed in the electrical box by visually aligning it with existing device(s)

2. Install and secure the device

1. Fold the wires into the electrical box, taking care not to pinch a wire.
2. Remove label on back of the device to expose ground wire and connect to the box ground. Secure the connection with wire nut.
3. Use double sided stickers to install on tiled or any other smooth surface next to the electrical box.
4. Use provided mounting screws if the surface next the electrical box is dry wall or uneven surface where the sticker may not work.
5. Install the multi-gang subframe using sub-frame screws provided with the radiant wall plate.
6. Snap-on the radiant wall plate.

If installing with a non-radiant wall plate, skip steps “e” and “f” above and use screws provided with the other wall plate to secure this device.

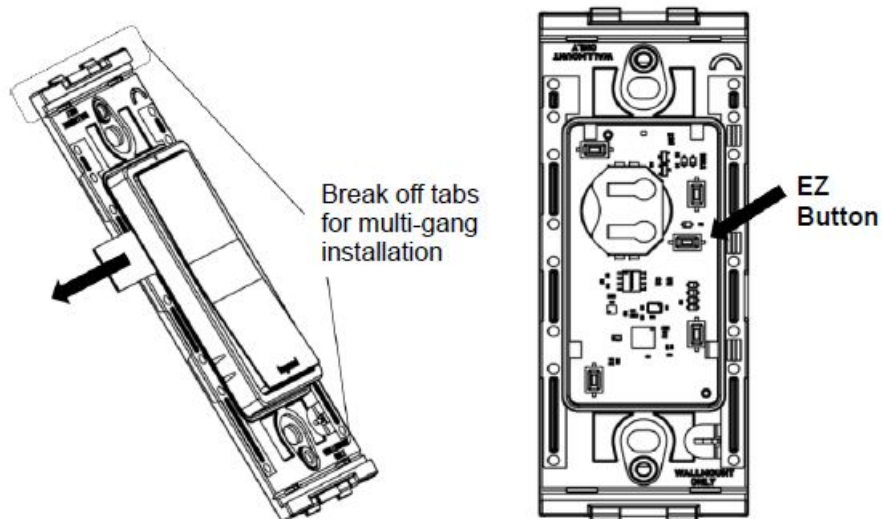

SETUP

Remove battery insulation tab as shown in the image.

1. Set Up Your System

1. Download and launch the Legrand Home + Control app. The app is available on the App Store or on Google Play.
2. Connect your smart device to your home network by following the step by step instructions in the app.
3. Use the app to control your smart device.

For the most recent instruction sheets or more information on this product, please see this link or scan the QR code: <https://www.legrand.us/p/wnr123wh>



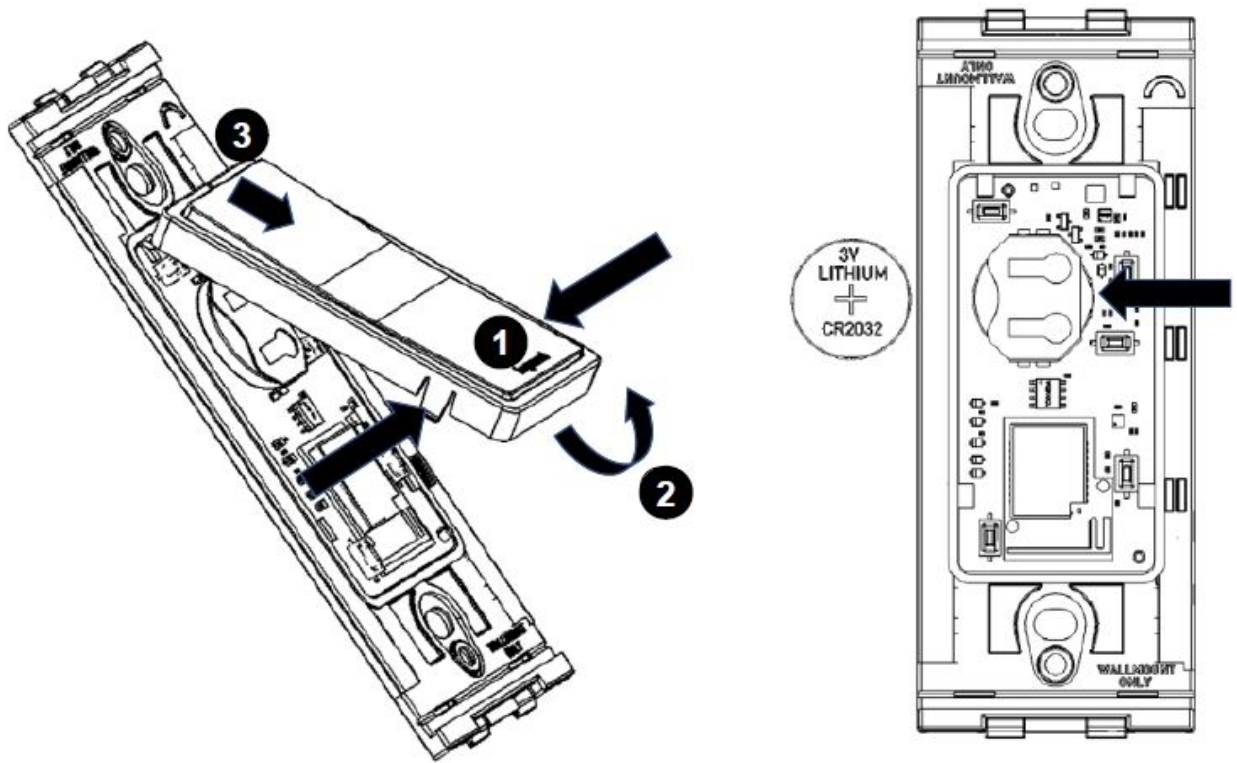

GETTING TO KNOW YOUR BATTERY POWERED SWITCH

| Item | Name | Description |
|------|---------------------|---|
| 1 | LED Indicator Light | Indicates the current state of device during setup. |
| 2 | EZ Button | Used to initiate setup. |

LED Indicator Light Explanations

| State of Light | Explanation |
|----------------|---|
| Blinking Green | Device is attempting to connect to the network. |

Reset To Factory Default

Deleting a device from the app will reset it to factory defaults. To manually reset the device to factory defaults press and hold the EZ button for 15 seconds until you see the LED blink green and red then release. The LED will turn off when the reset is complete. Legrand reserves the right to change specifications without notice.

REGULATORY INFORMATION

FCC NOTICE: This device complies with Part 15 of the FCC rules.

Operation is subject to the following two conditions:

1. this device may not cause harmful interference, and
2. this device must accept any interference received, including interference that may cause undesirable operation.

This equipment has been tested and found to comply with the limits for a Class B digital device, pursuant to Part 15 of the FCC Rules. These limits are designed to provide reasonable protection against harmful interference in a residential installation. This equipment generates, uses, and can radiate radio frequency energy and, if not installed and used in accordance with the instructions, may cause harmful interference to radio communications. However, there is no guarantee that interference will not occur in a particular installation. If this equipment does cause harmful interference to radio or television reception, which can be determined by turning the equipment off and on, the user is encouraged to try to correct the interference by one or more of the following measures:

- Reorient or relocate the receiving antenna
- Increase the separation between the equipment and receiver
- Connect the equipment into an outlet on a circuit different from that to which the receiver is connected
- Consult the dealer or an experienced radio/TV technician for help

This equipment complies with FCC radiation exposure limits set forth for an uncontrolled environment. This equipment should be installed and operated with a minimum distance of 90 mm between the transmitter's radiating structure(s) and the body of the user or nearby persons.

NOTE: Any changes or modifications to this device that are not expressly approved by the manufacturer will void the warranty and the user's authority to operate the equipment.

Contains FCC ID: 2AU5D-WNZED

IC NOTICE: This device complies with Industry Canada licenseexempt RSS standards.

Operation is subject to the following two conditions:

1. this device may not cause interference; and
2. this device must accept any interference, including interference that may cause undesired operation of the device.

RF EXPOSURE STATEMENT: This equipment meets the SAR evaluation limits given in RSS-102 Issue 5 requirements at the minimum separation distance of 90 mm to the human body. Note: Any changes or modifications to this device that are not expressly approved by the manufacturer, will void the warranty and the user's authority to operate the equipment.

IC: 25764-WNZED

HVIN: WNRL23

Documents / Resources

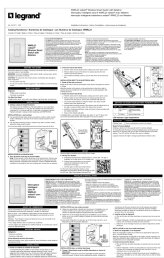
| | |
|---|--|
|  | <p>legrand WNRL23 Radiant Wireless Smart Switch with Netatmo [pdf] Instruction Manual WNRL23, Radiant Wireless Smart Switch with Netatmo</p> |
|---|--|

References

- [!\[\]\(6841ca9b0e023296428e7c9e683b9367_img.jpg\) Patents | Legrand](#)
- [!\[\]\(e258e347e7683f87061f627f84598eb5_img.jpg\) Wireless Smart Switch with Netatmo Legrand](#)
- [!\[\]\(1233990ad3f0b7475c568d7bf16af31f_img.jpg\) Smart Lighting from the radiant Collection Legrand](#)

Manuals+.