

legrand WNACB46 Smart Remote Scene Controller



legrand WNACB46 Smart Remote Scene Controller Installation Guide

[Home](#) » [Legrand](#) » legrand WNACB46 Smart Remote Scene Controller Installation Guide 

Contents

- [1 legrand WNACB46 Smart Remote Scene Controller](#)
- [2 Product Information](#)
- [3 Product Usage Instructions](#)
- [4 REGULATORY INFORMATION](#)
- [5 INSTALLATION INSTRUCTIONS](#)
- [6 Set Up Your System](#)
- [7 Snap wall plate to frame](#)
- [8 Documents / Resources](#)
 - [8.1 References](#)
- [9 Related Posts](#)



legrand WNACB46 Smart Remote Scene Controller



Product Information

Specifications:

- Model Number: WNACB46
- Compatibility: Must be used with a Netatmo gateway in conjunction with a WNAL10 or WNAL50
- Regulatory Compliance: FCC Part 15, Industry Canada license-exempt RSS standards
- FCC ID: 2AU5D-WACB4
- IC: 25764-WACB4
- Minimum Separation Distance: 20 cm from the transmitter's radiating structure(s) to the user or nearby persons

Product Usage Instructions

Installation:

This device is designed for indoor installation only. It can be installed in any standard electrical wall box of any gang size.

Before starting the installation process, always disconnect power at the service panel to prevent severe shock or electrocution.

Note: Failure to connect the ground wire will result in an unsafe installation that could lead to personal injury.

Wiring:

If necessary, cut wires and strip insulation using the stripping guide on the back of the switch.

Note: Failure to connect the ground wire will result in an unsafe installation that could lead to personal injury.

Connect the frame ground wire to the bare ground wire in the electrical box. Fold the ground wires into the back of the box.

Mounting:

Mount the frame to the wall box using the screws provided.
Tighten the screws just enough to hold the frame in place. Do not over-tighten.

FAQ:

Q: What is the model number of this device?

A: The model number of this device is WNACB46.

Q: Can this device be used without a Netatmo gateway?

A: No, this device must be used with a Netatmo gateway in conjunction with a WNAL10 or WNAL50.

Q: What are the regulatory compliance standards for this device?

A: This device complies with FCC Part 15 and Industry Canada license-exempt RSS standards.

Q: What is the minimum separation distance required for this device?

A: The minimum separation distance between the transmitter's radiating structure(s) and the user or nearby persons is 20 cm.

Catalog Number(s)

This device must be used with a Netatmo gateway in conjunction with a WNAL10 or WNAL50.

WNACB46

Smart Remote Scene Controller with Netatmo

REGULATORY INFORMATION

FCC NOTICE: This device complies with Part 15 of the FCC rules. Operation is subject to the following two conditions: (1) this device may not cause harmful interference, and (2) this device must accept any interference received, including interference that may cause undesirable operation.

This equipment has been tested and found to comply with the limits for a Class B digital device, pursuant to Part 15 of the FCC Rules. These limits are designed to provide reasonable protection against harmful interference in a residential installation. This equipment generates, uses, and can radiate radio frequency energy and, if not installed and used in accordance with the instructions, may cause harmful interference to radio communications.

However, there is

no guarantee that interference will not occur in a particular installation. If this equipment does cause harmful interference to radio or television reception, which can be determined by turning the equipment off and on, the user is encouraged to try to correct the interference by one or more of the following measures:

- Reorient or relocate the receiving antenna
- Increase the separation between the equipment and receiver
- Connect the equipment into an outlet on a circuit different from that to which the receiver is connected
- Consult the dealer or an experienced radio/TV technician for help

This equipment complies with FCC radiation exposure limits set forth for an uncontrolled environment. This equipment should be installed and operated with a minimum distance of 20 cm between the transmitter's radiating structure(s) and the body of the user or nearby persons.

NOTE: Any changes or modifications to this device that are not expressly approved by the manufacturer will void the warranty and the user's authority to operate the equipment.

Contains FCC ID: 2AU5D-WACB4

IC NOTICE: This device complies with Industry Canada license-exempt RSS standards. Operation is subject to the following two conditions: (1) this device may not cause interference; and (2) this device must accept any interference, including interference that may cause undesired operation of the device.

RF EXPOSURE STATEMENT: This equipment meets the SAR evaluation limits given in RSS-102 Issue 5 requirements at the minimum separation distance of 20 cm to the human body. Note: Any changes or modifications to this device that are not expressly approved by the manufacturer, will void the warranty and the user's authority to operate the equipment.

IC: 25764-WACB4

HVIN: WNACB46

For more information and helpful how-to videos, visit www.adornemyhome.com/install.

INSTALLATION INSTRUCTIONS

Please read these instructions completely before you begin. This adorne® smart scene controller is designed for installation in standard electrical boxes or directly on a wall surface. However, some of the installation methods vary slightly from traditional methods. If you do not understand these instructions or are unsure of your abilities, seek the assistance of a qualified electrician.

Use only with Legrand adorne® system.

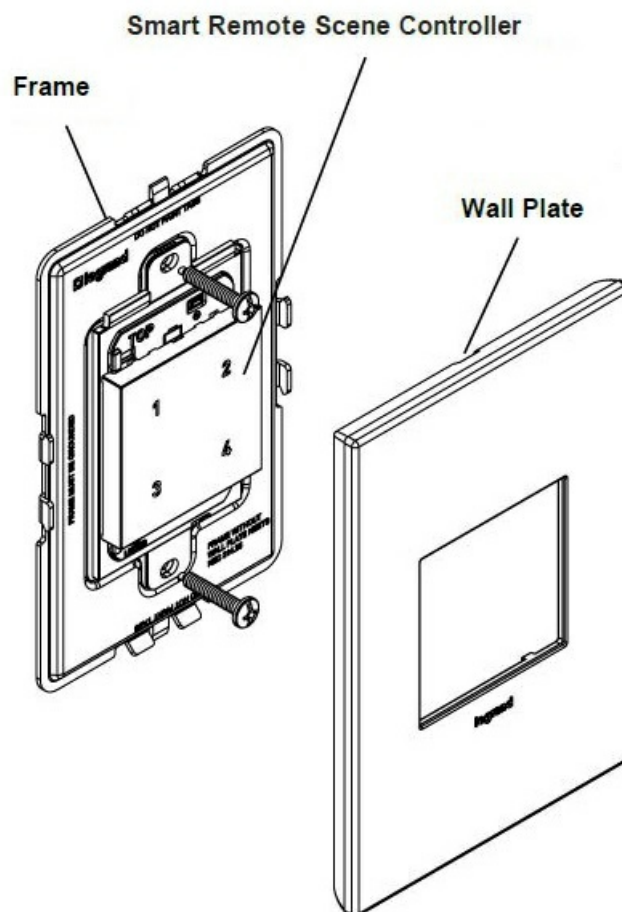

1. For indoor installation only. This device can be installed in any standard electrical wall box of any gang size. To prevent severe shock or electrocution, always disconnect power at the service panel before beginning work. Failure to connect the ground wire will result in an unsafe installation that could lead to personal injury.

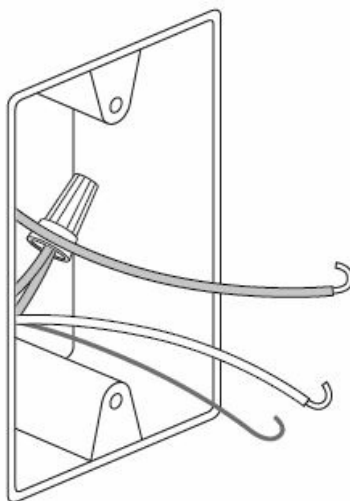

2. If necessary, cut wires and strip insulation using stripping guide on back of switch.

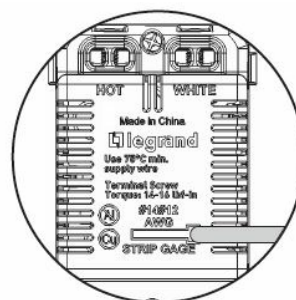
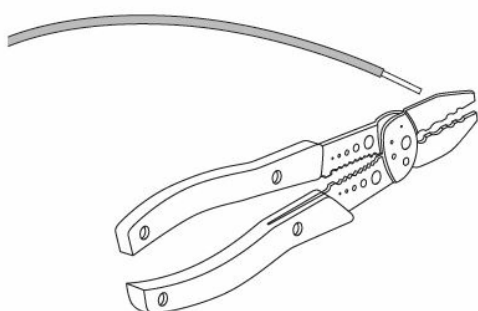

3. WARNING

Failure to connect the ground wire will result in an unsafe installation that could lead to personal injury.

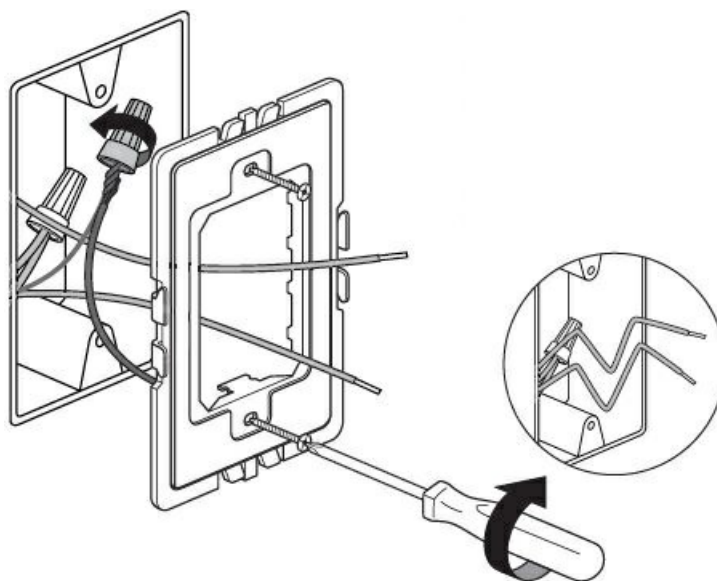

Connect frame ground wire to bare ground wire in box. Fold ground wires into back of box. Mount frame to wall box with screws provided. Tighten screws just enough to hold frame in place. Do NOT over-tighten.

TIPS

- Pre-fold wires into wall box to make it easier to fit them in the box when switch is connected.
- Use caution to avoid marring wall surface with the metal frame.

Multi-Gang Electrical Box Installation

In case of multi-gang installation, replace the provided frame with *adorne*™ multi gang frame. While holding the frame with one hand, push the device up slightly until it snaps out and then pull it out of the frame. Secure the device to the multi gang frame using frame mounting screws.

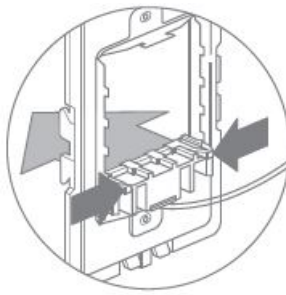

Remove spacers from the frame.

Since this device fills the frame completely, you will not need the spacers. From the back of the frame, pinch the tabs on the spacer to release.

Connect new device as shown. Make sure the terminal holes are clear. Insert wires into terminals and tighten screws securely. Do NOT over-tighten. (to 10 in. lbs.)

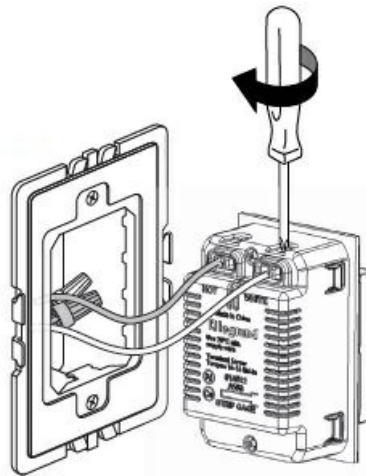

Connect Neutral (White) wire to WHITE. Connect Hot (Black) wire to HOT

NOTE – If you are installing multiple switches in the frame, wire all devices before snapping them into the frame.

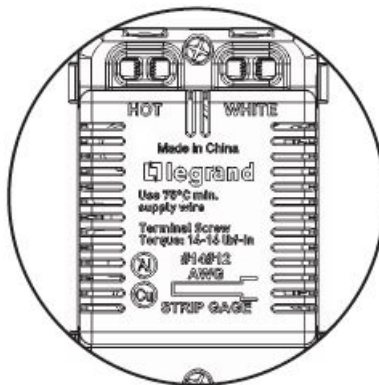

Set Up Your System

- Download and launch the Legrand Home + Control app. The app is available on the App Store or on Google Play.
- Connect your smart device to your home network by following the step by step instructions in the app.
- Use the app to control your smart device.

Getting to Know Your Remote Scene Controller

Item	Name	Description
1	LED Indicator	Indicates the current state of device during setup
2	EZ Button	Used to initiate setup

LED Indicator Light Explanations

State of Light	Explanation
Blinking Green	Device is attempting to connect to the network.

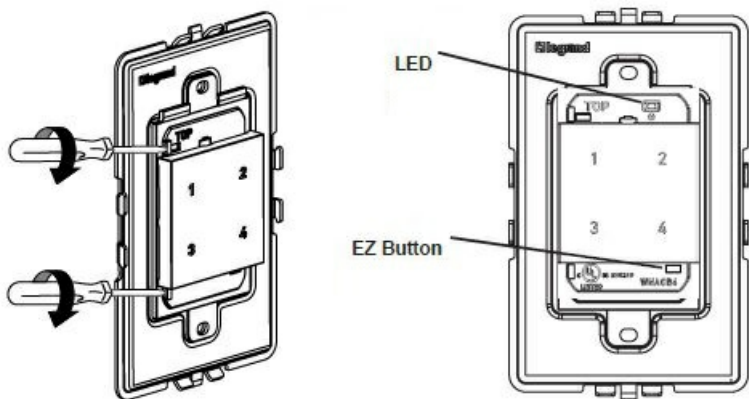

Reset to Factory Default

To manually reset the device to factory defaults press and hold the EZ button for 7 seconds until you see the LED blink red then release. The LED will turn off when the reset is complete Due to ongoing product improvements, Legrand reserves the right to change specifications without notice. For the most recent instruction sheets or more information on this product, please see this link or scan the QR code:

<https://www.legrand.us/p/wnacb46w1>



Snap wall plate to frame

There are three click-stops to adjust the fit of the wall plate to the device and the wall.

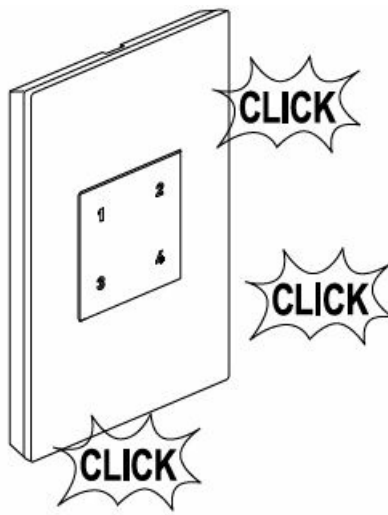

NOTE: To remove wall plate, insert a small, flat screwdriver in notches on wall plate and twist gently to pry from frame.

Never apply cleaner directly to the device or wall plate. Apply to a soft cloth and use cloth to remove any smudges from the product.

Technical Assistance:

(877) 295-3472

www.adornemyhome.com/install

LIMITED TWO-YEAR WARRANTY

Limited two-year warranty information for adorne® products is available at www.adornemyhome.com/warranty.

Limited warranty information for adorne® products may also be obtained free of charge by sending a written request, along with your proof of purchase (including purchase date), to:

Legrand

Attn: adorne Customer Service/Warranty Department 50 Boyd Avenue

Syracuse, NY 13209

No: 341400 1/24

© Copyright 2024 Legrand All Rights Reserved.

© Copyright 2024 Legrand Tous droits réservés Legrand. © Copyright 2024 Legrand Todos los derechos reservados.

60 Woodlawn Street West Hartford, CT 06110 1.877.BY.LEGRAND

(295.3472)

www.legrand.us

CANADA

905.738.9195

www.legrand.ca

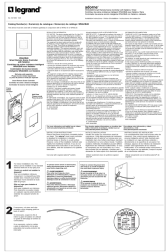

[legrand WNACB46 Smart Remote Scene Controller](#) [pdf] Installation Guide
WNACB46, 2AU5D-WACB4, 2AU5DWACB4, WNACB46 Smart Remote Scene Controller, Smart Remote Scene Controller, Remote Scene Controller, Scene Controller, Controller

References

- [Search Results Page](#)
- [adorne® Warranty Legrand](#)
- [Legrand CA | Delivering and Managing Power, Light, and Data](#)
- [Legrand US | Delivering and Managing Power, Light, and Data](#)
- [The adorne® Collection | Legrand](#)
- [adorne® Warranty Legrand](#)
- [Server Error Page](#)
- [User Manual](#)