



legrand DPX-IS 1600B Isolating Switch Instruction Manual

[Home](#) » [Legrand](#) » legrand DPX-IS 1600B Isolating Switch Instruction Manual 

Contents

- [1 legrand DPX-IS 1600B Isolating Switch](#)
- [2 Product Information](#)
- [3 Tools](#)
- [4 Dimensions](#)
- [5 Mounting](#)
- [6 Safety Instructions](#)
- [7 Product Usage Instructions](#)
- [8 FAQ](#)
- [9 Documents / Resources](#)
 - [9.1 References](#)
- [10 Related Posts](#)



legrand DPX-IS 1600B Isolating Switch



Product Information

Specifications:

- Model: Y1240C
- Expiration Date: 12/2022-02
- Country Compatibility: FR, BE, CA, LU, CH, GB, IN, IE, US, ES, CL, CO, CR, MX, PE, VE, IT, PT, GR, CY, PL, TR

Tools

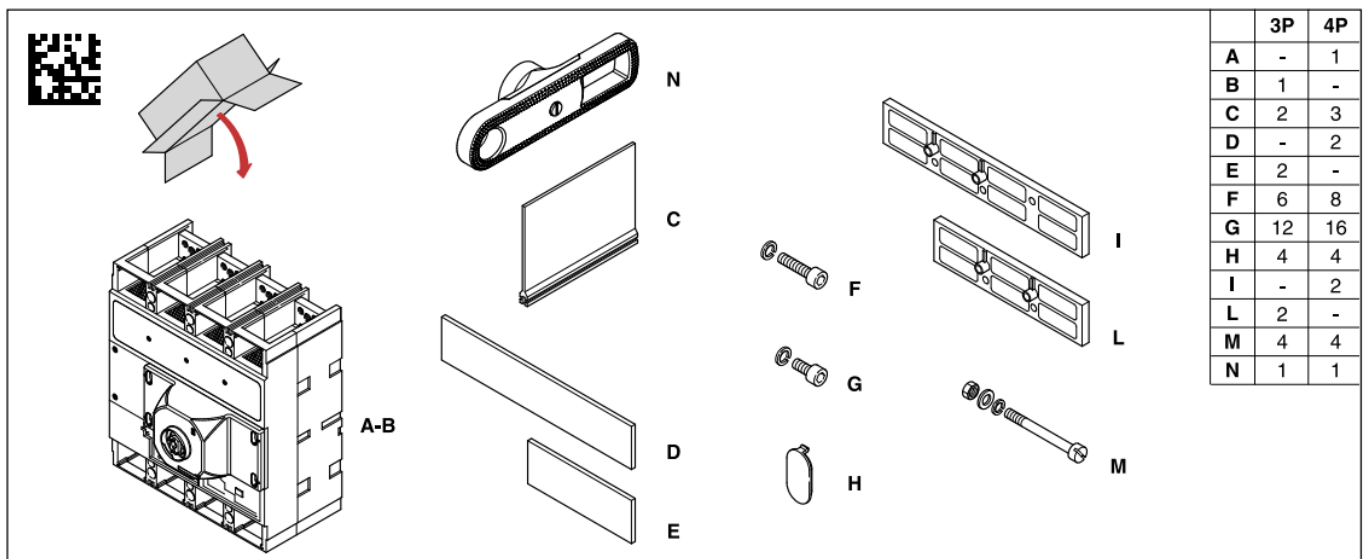

Dimensions

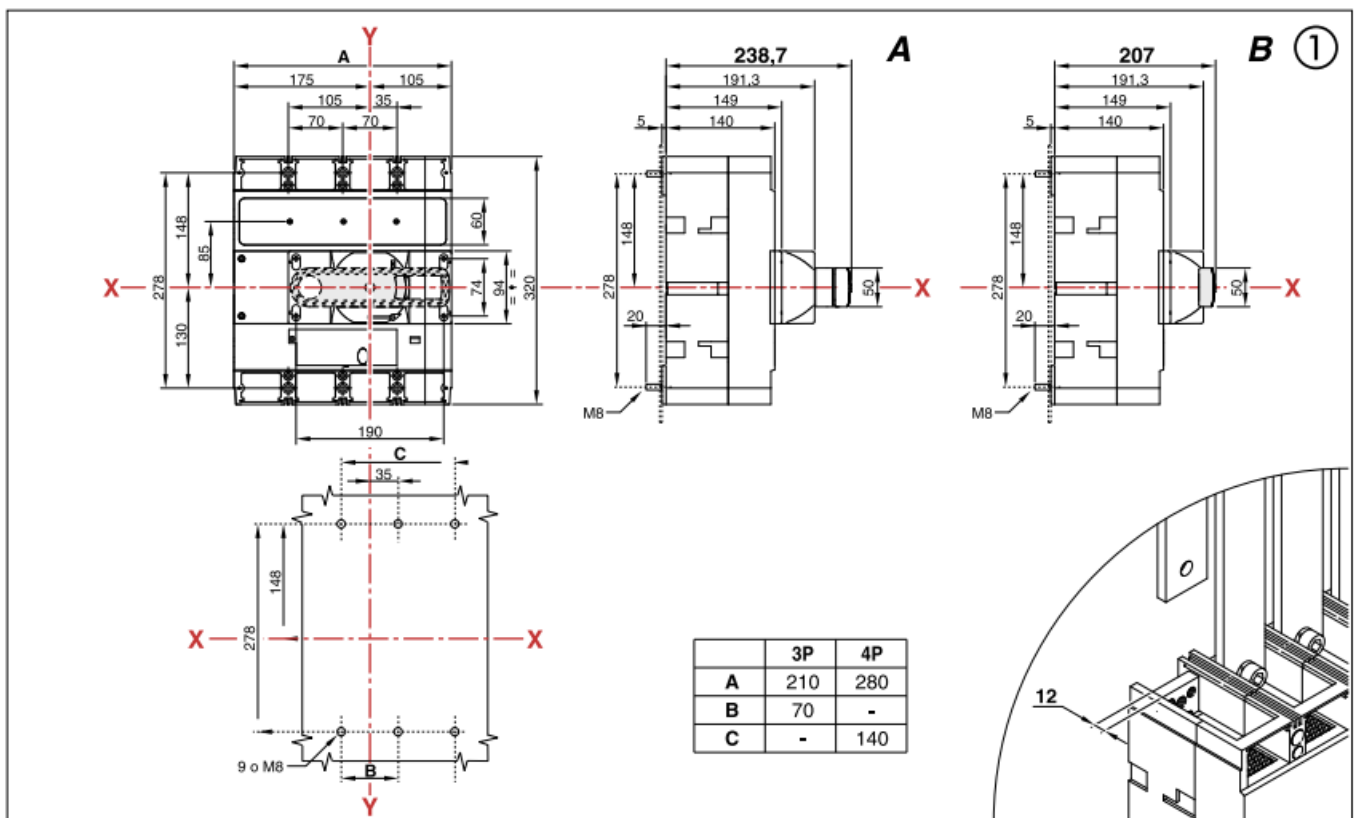

Mounting

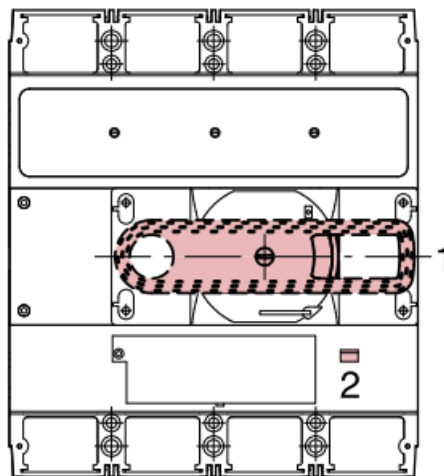

1. Rotary toggle
2. Push-to-trip button for mechanical checking

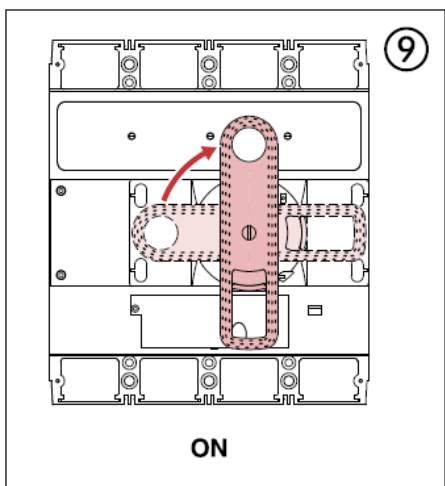
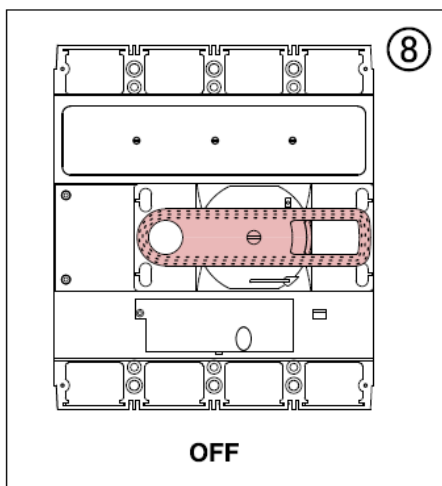
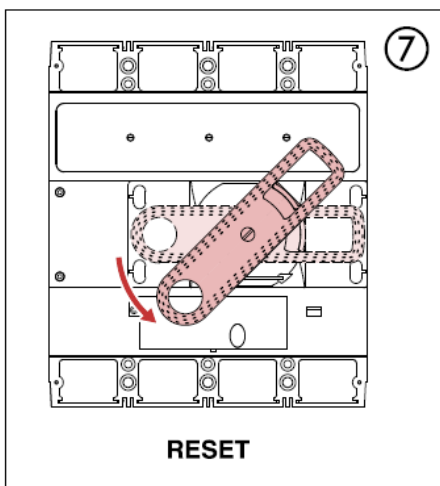
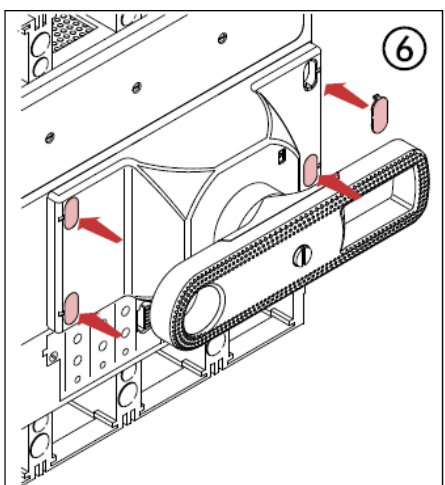
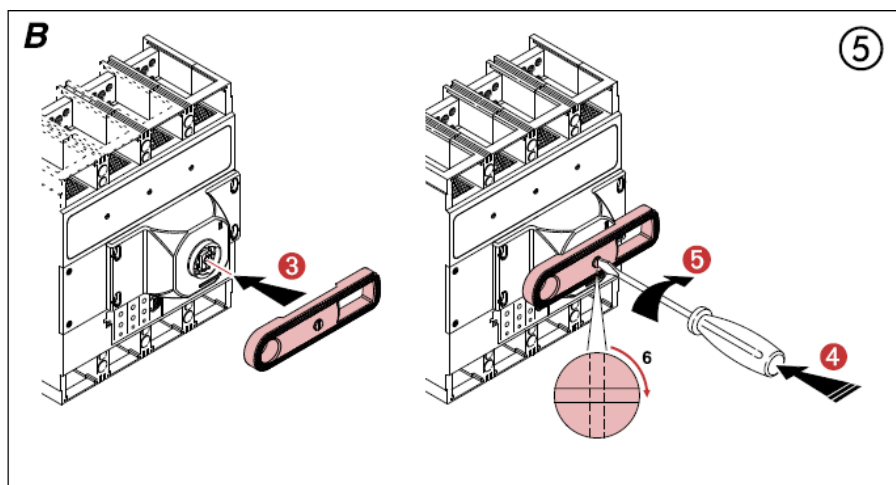
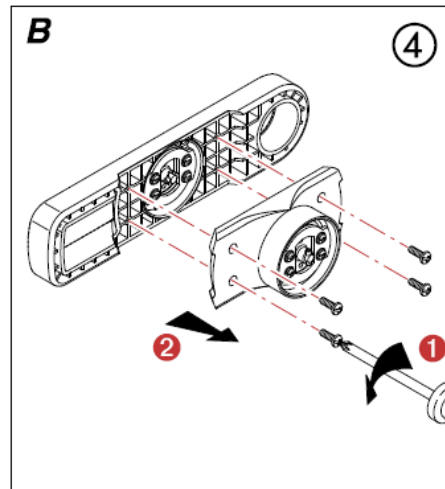
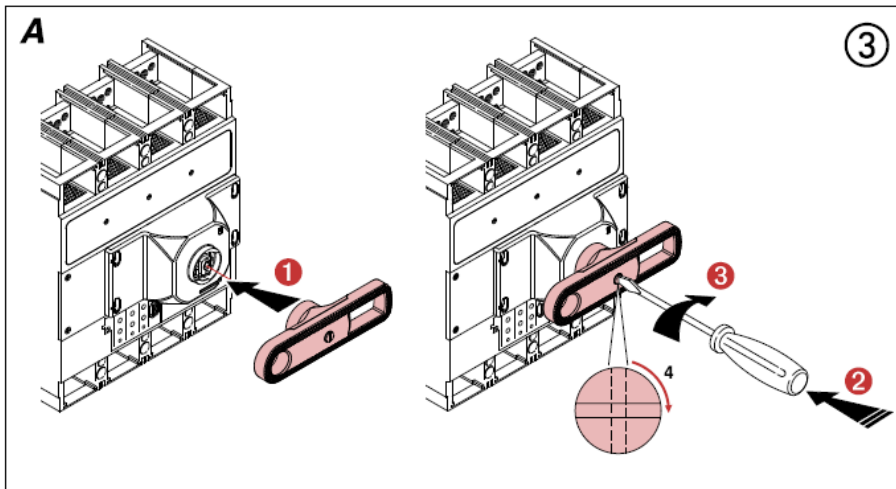

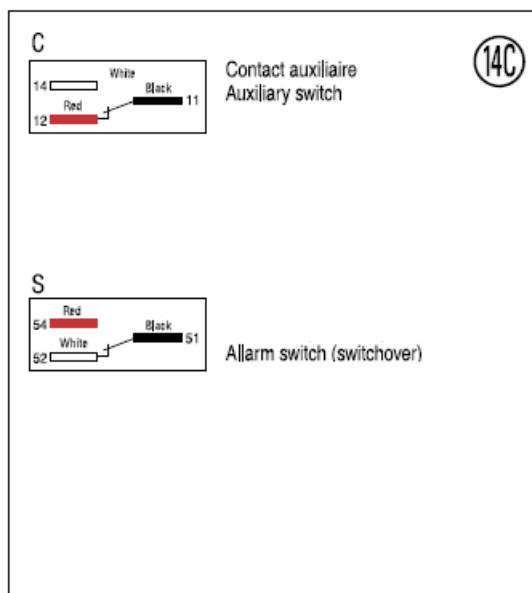
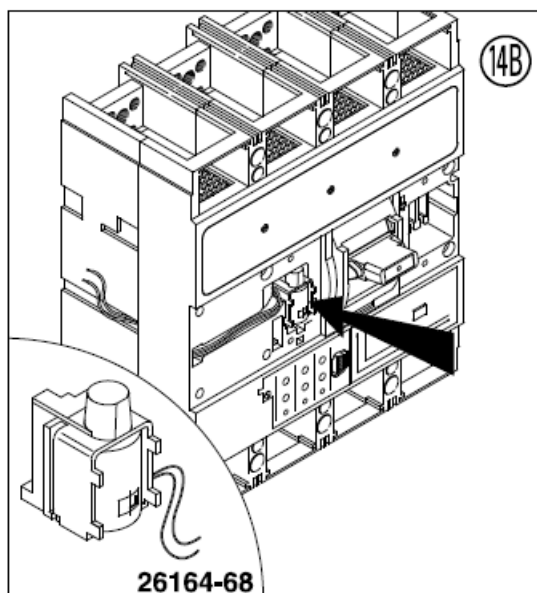
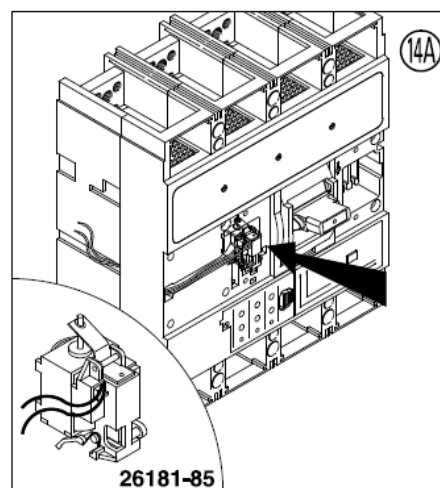
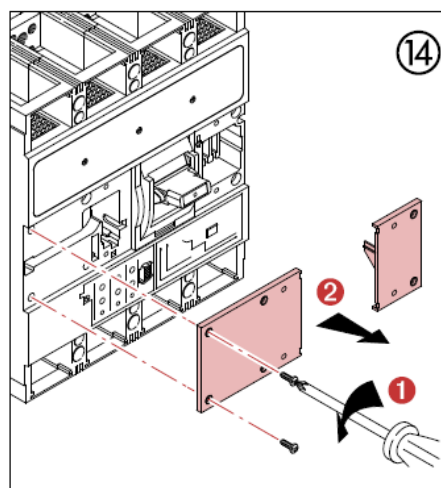
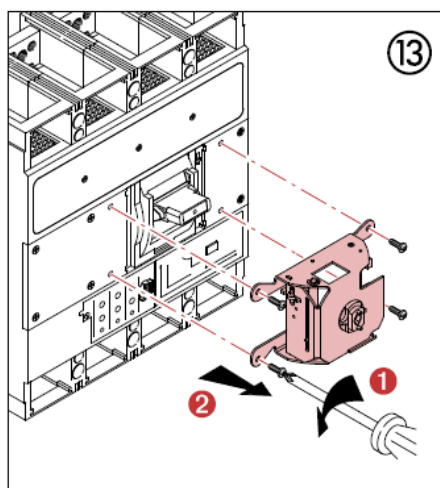
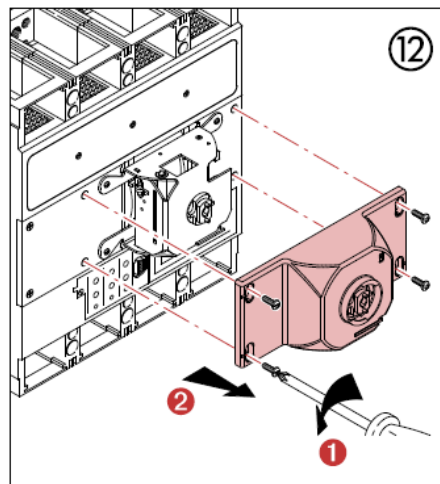
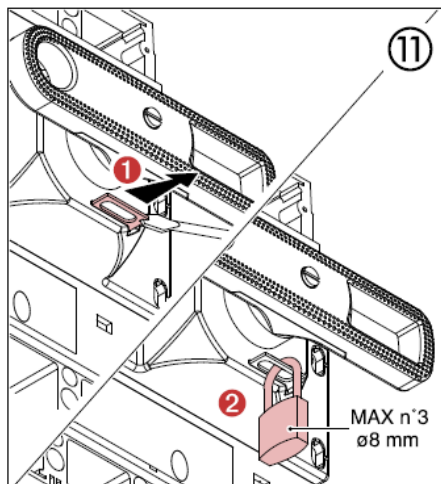
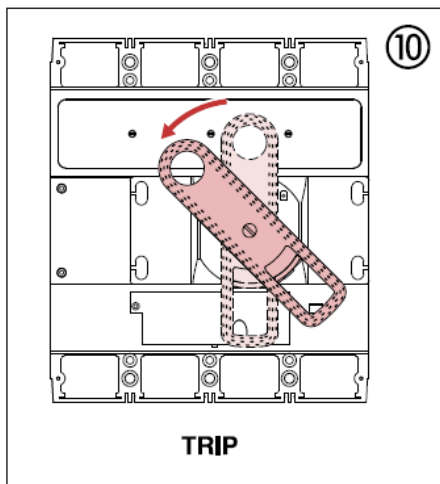

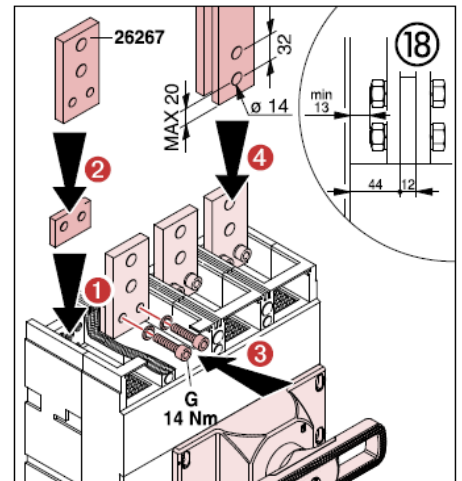
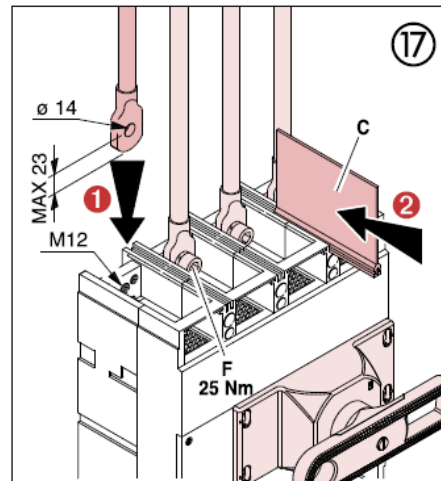
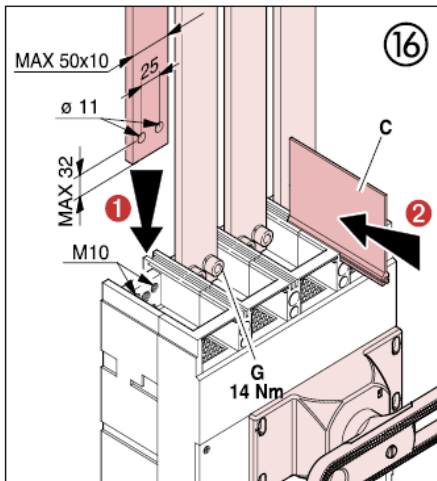
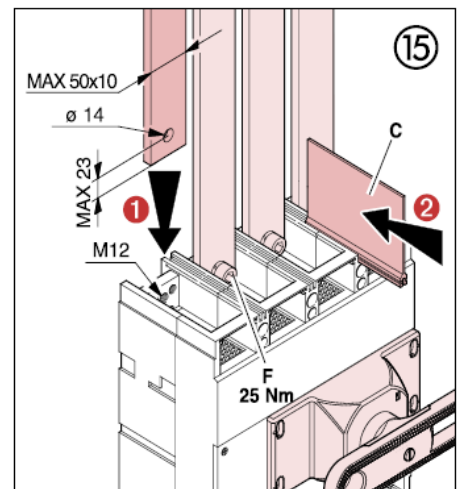
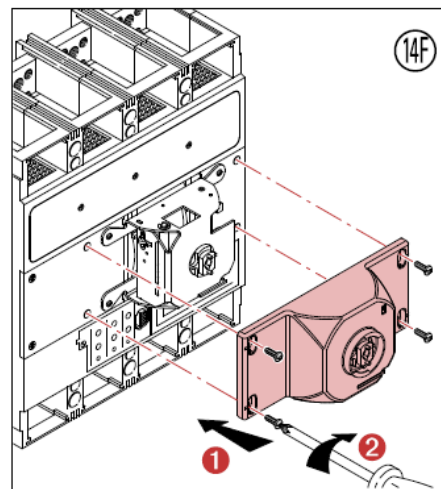
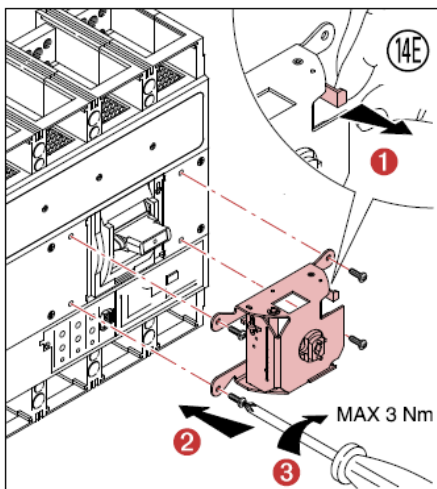
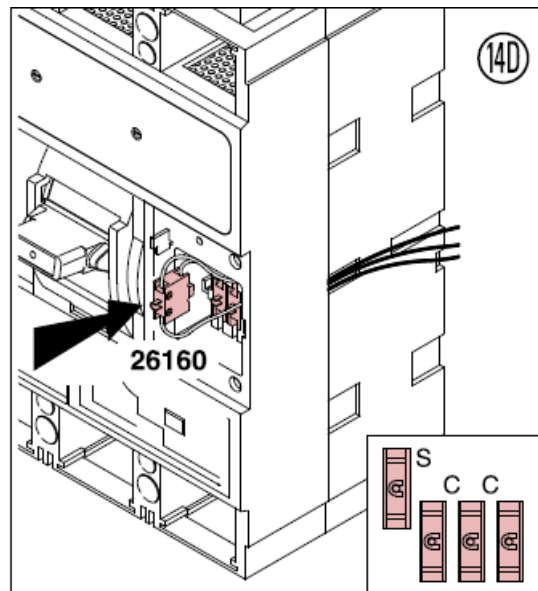

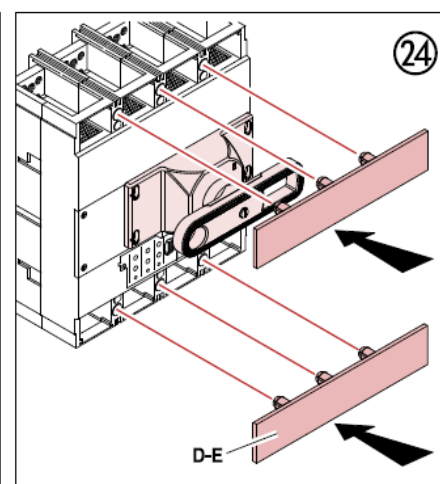
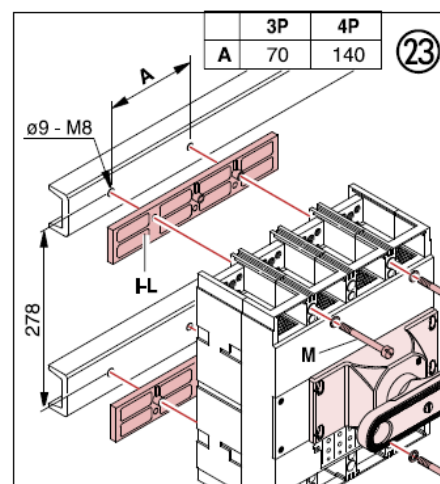
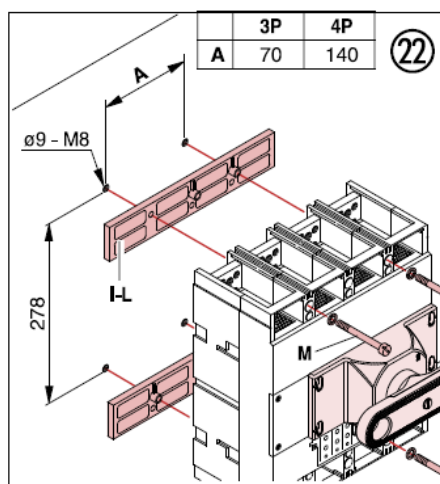
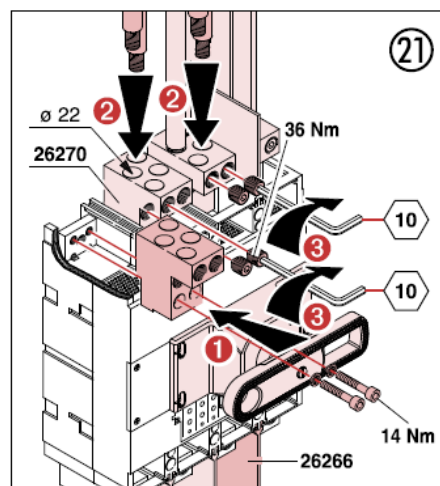
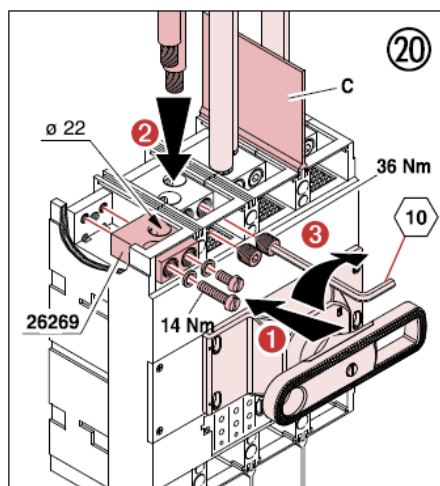
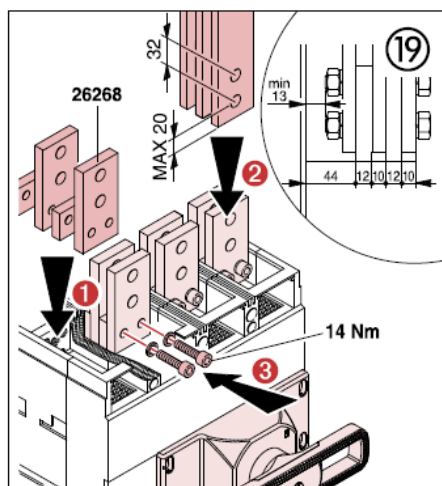

Safety Instructions

This product should be installed in compliance with installation rules, preferably by a qualified electrician. Incorrect installation and use can lead to the risk of electric shock or fire. Before carrying out the installation, read the instructions and take account of the product's specific mounting location. Do not open up, dismantle, alter or modify the device except where specifically required to do so by the instructions. All Legrand products must be opened and repaired exclusively by personnel trained and approved by Legrand. Any unauthorized opening or repair completely cancels all liabilities and the rights to replacement and guarantees. Use only Legrand brand accessories.

Product Usage Instructions

1. Ensure that the product is compatible with the country you are using it in. Refer to the list of compatible countries provided in the specifications section.
2. Before installation, carefully read the safety instructions to prevent the risk of electric shock or fire.
3. Install the product in compliance with the installation rules. It is recommended to hire a qualified electrician for proper installation.
4. Choose a suitable mounting location for the product based on the specific requirements mentioned in the instructions.
5. Do not open, dismantle, alter, or modify the device unless explicitly required by the instructions.
6. In case of any issues or repairs, contact personnel trained and approved by Legrand for assistance. Unauthorized opening or repair may void any warranties or guarantees.
7. Use only Legrand brand accessories to ensure compatibility and safety.

FAQ

1. Q: Can I install the product myself?

A: While it is possible to install the product yourself, it is recommended to hire a qualified electrician to ensure correct installation and minimize the risk of electric shock or fire.

2. Q: What should I do if I encounter any issues with the product?

A: If you encounter any issues with the product, contact personnel trained and approved by Legrand for assistance. Unauthorized repairs may void warranties and guarantees.

3. Q: Can I use accessories from other brands with this product?

A: No, it is recommended to use only Legrand brand accessories to ensure compatibility and safety.

Documents / Resources

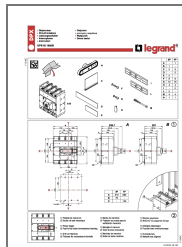

[legrand DPX-IS 1600B Isolating Switch](#) [pdf] Instruction Manual
DPX-IS 1600B Isolating Switch, DPX-IS 1600B, Isolating Switch, Switch

References

- [User Manual](#)