



LEETEL T10 Long Range Up to 5 Miles with 22 Channels 2 way radios User Manual

[Home](#) » [LEETEL](#) » LEETEL T10 Long Range Up to 5 Miles with 22 Channels 2 way radios User Manual 

Contents

- [1 LEETEL T10 Long Range Up to 5 Miles with 22 Channels 2 way radios](#)
- [2 PRODUCT OVERVIEW](#)
- [3 Specific Recommendations](#)
- [4 Before use](#)
- [5 installing the Batteries](#)
- [6 Using the device](#)
- [7 SAFETY & GENERAL INFORMATION](#)
- [8 Safety Information for Radios](#)
- [9 Documents / Resources](#)
- [10 Related Posts](#)

LEETEL

LEETEL T10 Long Range Up to 5 Miles with 22 Channels 2 way radios



PRODUCT OVERVIEW

This set includes 2 walkie-talkie units: these are communication devices that operate on mobile radio frequencies. They have 22 channels as well as a back-lit LCD screen, enabling you to communicate over several kilometers free of charge (up to 5 miles in open areas).

Note: Please read the instructions carefully before using the equipment and retain for future reference.

Specific Recommendations

- To avoid the risk of burns, do not use the device if the aerial is damaged in any way.
- Do not use the device in a potentially explosive setting (e.g. Around pumps, on the lower deck of a boat or around a fuel-storage installation or chemical products).
- Switch off the device if on an airplane or in a hospital.
- Never use the device in close proximity to a radio to avoid + Remove the batteries if the device is not used for an extended period of time. Never mix used batteries with new ones.
- Keep the transmitter and antenna at least 25mm from your face. Direct the antenna upwards and speak normally. Clean the device with a damp cloth. Avoid the use of cleaning agents and solvents.
- Do not modify the device in any way. In the event of damage occurring, ensure that the device is checked by a qualified professional.
- The device cannot be used to contact emergency services.

Functions at Glance

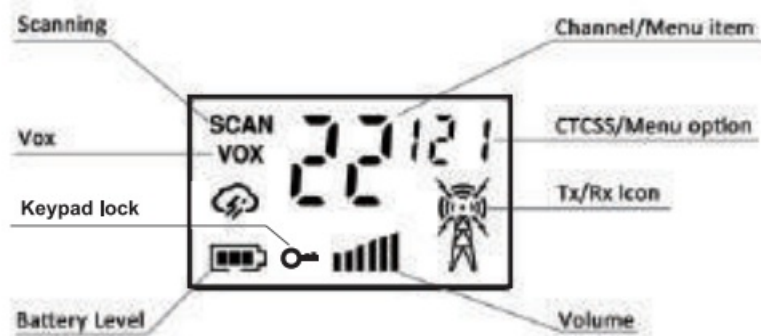

Before use

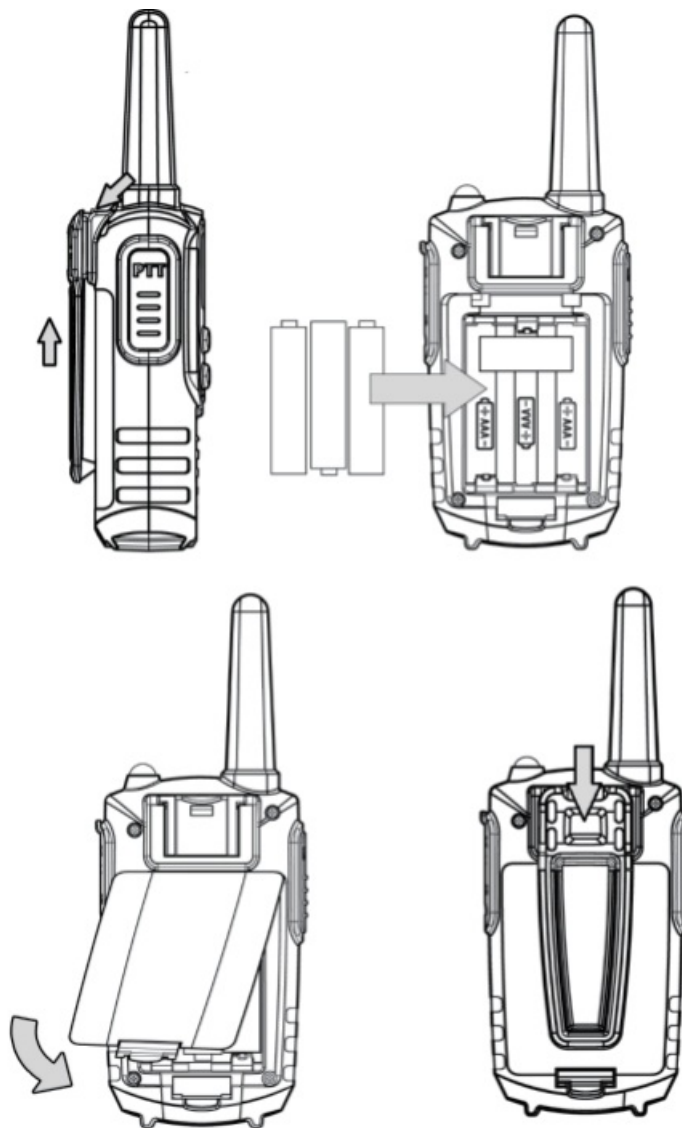

- Removing the belt clip
- Before insert batteries into the device, first pull the belt clip latch away from the device.

installing the Batteries

A. For use of non-rechargeable batteries :

1. Slid down the battery compartment cover.
2. Insert 3 x AAA Alkaline Battery (Not included)
3. Position the batteries according to the polarity marking on the battery compartment.
4. After placing batteries into correct positions, put the battery cover back on.

B. For use of rechargeable batteries

If your walkie talkie comes with rechargeable batteries, you should only put the power cable into USB charging port which inside the rubber cover.

Using the device

1. Turning the device on/off

Switch on the device: Press and hold on the [C] button 3 seconds then you will hear a beep sound. Switch off the

device: Press and hold on the [C)]button
3 seconds then you will hear a beep sound.

2. Adjusting the volume

To increase the volume, press the Up[A]button. And press the Down[T]button to decrease the volume.

3. Battery Charge Level/Low Battery Indication

The battery charge level is indicated by the number of squares present inside the battery icon on the LCD Screen.

- Battery Full
- E Battery 213 charged

SAFETY & GENERAL INFORMATION

FCC Warning

Any Changes or modifications not expressly approved by the party responsible for compliance could void the user's authority to operate the equipment.

This device complies with part 15 of the FCC Rules.

Operation is subject to the following two conditions:

- (1) This device may not cause harmful interference, and
- (2) this device must accept any interference received, including interference that may cause undesired operation.

Note:

This equipment has been tested and found to comply with the limits for a Class B digital device, pursuant to part 15 of the FCC Rules. These limits are designed to provide reasonable protection against harmful interference in a residential installation. This equipment generates, uses and can radiate radio frequency energy and, if not installed and used in accordance with the instructions, may cause harmful interference to radio communications. However, there is no guarantee that interference will not occur in a particular installation. If this equipment does cause harmful interference to radio or television reception, which can be determined by turning the equipment off and on, the user is encouraged to try to correct the interference by one or more of the following measures:

- Reorient or relocate the receiving antenna.
- Increase the separation between the equipment and receiver.
- Connect the equipment into an outlet on a circuit different from that to which the receiver is connected.
- Consult the dealer or an experienced radio/TV technician for help.

Safety Information for Radios

Your wireless handheld portable transceiver contains a low power transmitter. When the talk button is pushed, it sends out radio frequency (RF) signals. The device is authorized to operate at a duty factor not to exceed 50%. In August 1996, the Federal Communications Commissions (FCC) adopted RF exposure guidelines with safety levels for handheld wireless devices.

Important

FCC RF Exposure Requirements: For body-worn operation, this radio has been tested and meets the FCC RF exposure guidelines when used with accessories supplied or designated for this product. Use of other accessories may not ensure compliance with FCC RF exposure guidelines. Use only the supplied antenna. Unauthorized antennas, modifications or attachments could damage the transmitter and may violate FCC regulations.

Normal Position

Hold the transmitter approximately 25 mm from your face and speak in a normal voice, with the antenna pointed up and away.

Documents / Resources



[LEETEL T10 Long Range Up to 5 Miles with 22 Channels 2 way radios](#) [pdf] User Manual
T10, 2ASV6-T10, 2ASV6T10, T10, Long Range Up to 5 Miles with 22 Channels 2 way radios

[Manuals+](#)