



LEDVANCE SMARTplus WiFi Installation Guide

[Home](#) » [LEDVANCE](#) » LEDVANCE SMARTplus WiFi Installation Guide 

Contents

- [1 LEDVANCE SMARTplus WiFi Installation](#)
- [2 SMART+ WIFI Installation Guide](#)
- [3 Installation](#)
- [4 Troubleshooting](#)
- [5 Product SMART+ WIFI INSTALLATION GUIDE](#)
- [6 OPTIONAL](#)
- [7 Documents / Resources](#)
 - [7.1 References](#)
- [8 Related Posts](#)



LEDVANCE SMARTplus WiFi Installation



SMART+ WIFI Installation Guide

The SMART+ WIFI is a smart lighting system that can be controlled through a mobile app or voice commands via Amazon Alexa or Google Home devices. Here are the steps to install and use the SMART+ WIFI:

Installation

1. Download the SMART+ WIFI app from the App Store or Google Play.
2. Register an account on the app and log in.
3. Tap on the “Add Device” button and follow the instructions to connect the SMART+ WIFI device to your home network.
4. Optional: Connect the SMART+ WIFI device to your Google Home or Amazon Alexa device for voice control.
5. Activate the LEDVANCE SMART+ WIFI action on your Google Home device or activate the LEDVANCE SMART+ WIFI skill on your Amazon Alexa device.
6. You can now control your SMART+ WIFI lights through the app or voice commands.

Troubleshooting

If you are experiencing issues with your SMART+ WIFI, you can try resetting the device by pressing and holding the reset button for 5 seconds. For further assistance, please visit our customer support page at <https://smartplus.ledvance.com/support> or contact us at smarthome-support@ledvance.com.

Product Information:

- Model number: C10449057
- Manufacture date: G11143572 16.05.2022
- Manufacturer: LEDVANCE GmbH
- Address: Steinerne Furt 62, 86167 Augsburg, Germany
- Website: <https://www.ledvance.com/consumer/smart/faq/>

Product SMART+ WIFI INSTALLATION GUIDE



OPTIONAL

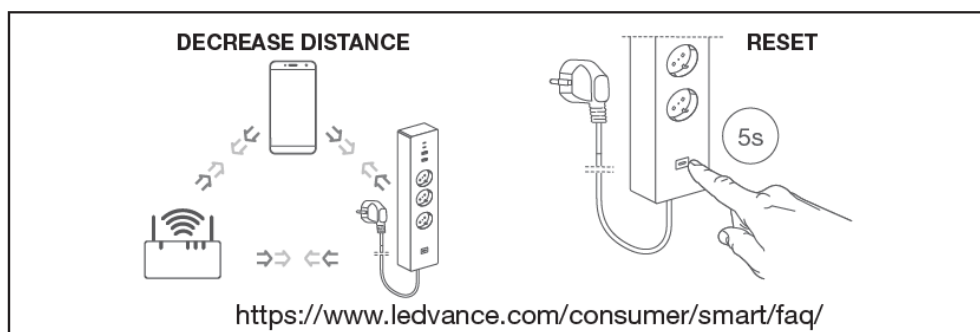
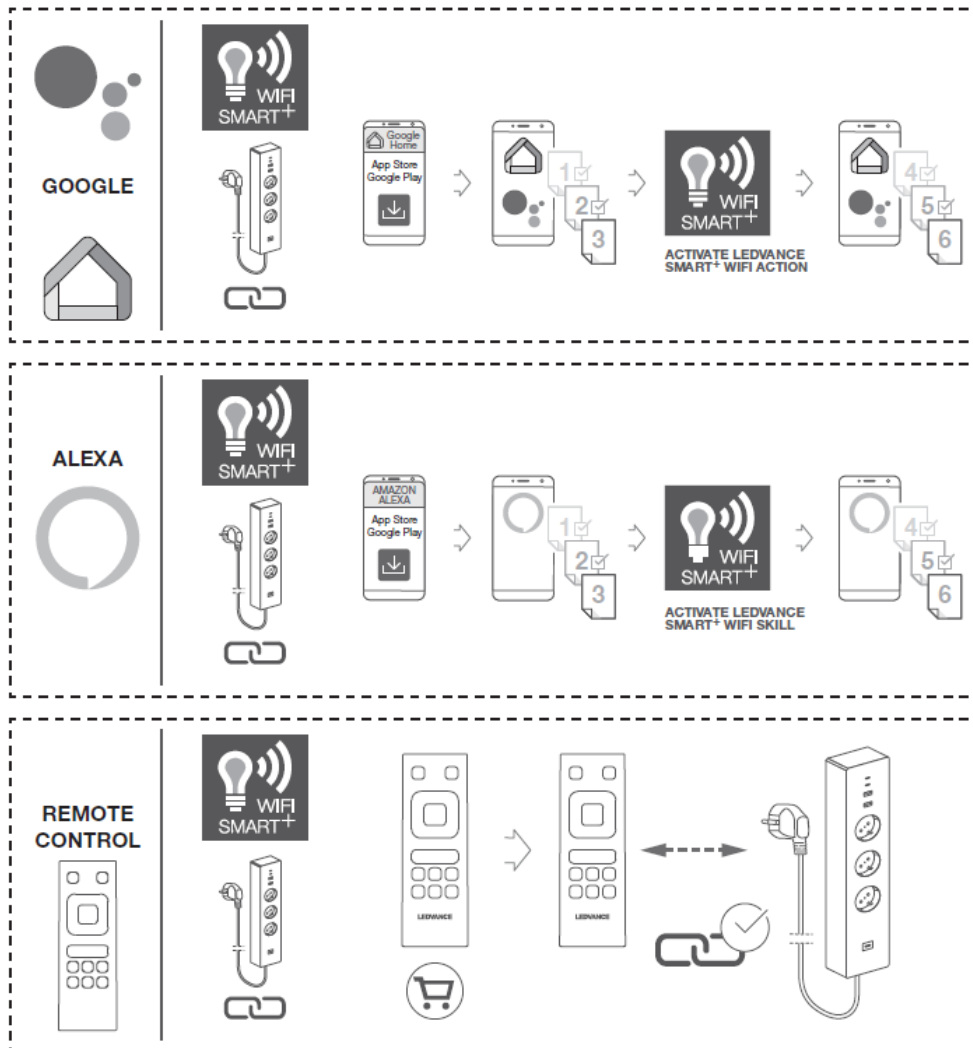

<https://www.ledvance.com/consumer/smart/faq/>

CUSTOMER SUPPORT

<https://smartplus.ledvance.com/support>

smarthome-support@ledvance.com

Hereby, LEDVANCE GmbH declares that the radio equipment type LEDVANCE SMART+ Device is in compliance with Directive 2014/53/EU. The full text of the EU declaration of conformity is available at the following internet address: smartplus.ledvance.com/declaration-of-conformity. Wireless radio used in Wifi lamps/ luminaires/components 2412–2483.5 MHz, max. RF output power 16dBm. Wireless radio used in Bluetooth lamps/ luminaires /components 2402–2480 MHz, max. RF output power 9.5dBm.

The SMART+ Plug/Plug Outdoor switches connected appliances without separating them from the mains. Under adverse conditions, very high capacitive and inductive loads may lead to the destruction of the device or may reduce the number of switching cycles. Devices building up heat must be separated from the mains, i. e. from SMART+ Plug/Plug Outdoor to avoid accidental activation. Please make sure to disconnect SMART+ Plug/Plug Outdoor from the mains voltage before undertaking any maintenance works. In case of disconnection of the mains (i. e. power outage) the SMART+ Plug/Plug Outdoor will remain in stand-by mode.

Please do not use the SMART+ Plug/Plug Outdoor together with medical devices. The plug is to be installed near the device and must be readably accessible. Intended for use in dry rooms only. De-energized only with plug disconnected. Do not operate when covered. Warning:

Do not insert in a row

Points de collecte sur www.quefairedemesdechets.fr

LEDVANCE GmbH

Steinerne Furt 62

86167 Augsburg, Germany

www.ledvance.com

Documents / Resources

	<p>LEDVANCE SMARTplus WiFi [pdf] Installation Guide C10449057, G11143572, SMARTplus WiFi, SMARTplus, WiFi</p>
---	---

References

- [Declaration of Conformity | LEDVANCE](#)
- [Corporate website | LEDVANCE](#)
- [Support | LEDVANCE](#)
- [SMART+ FAQ | LEDVANCE](#)