

Led2 LINO 90 Ceiling Linear Lamp Instruction Manual

Contents

[1 LINO 90/120/150](#)

[1.1 CONNECTION – DIMMABLE VERSION – OPTIONAL](#)

[2 Documents / Resources](#)

[2.1 References](#)

[3 Related Posts](#)



LINO 90/120/150

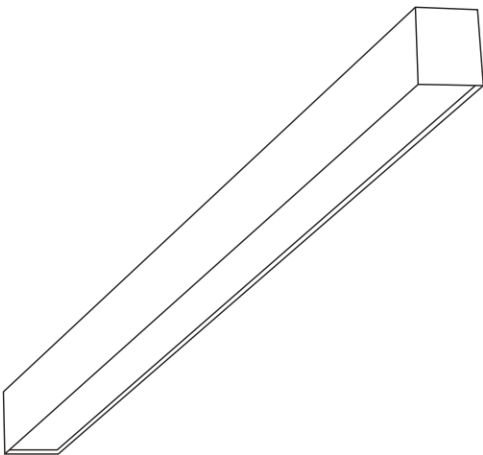

The installation may only be carried out by a technician

This product contains a light source of energy efficiency class D

A. Suspension

(1)

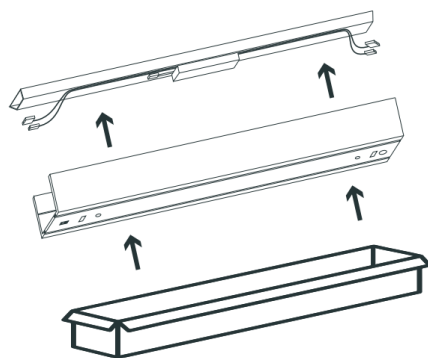

(2)

| | |
|----------|--------|
| LINO 90 | 80 cm |
| LINO 120 | 110 cm |
| LINO 150 | 140 cm |

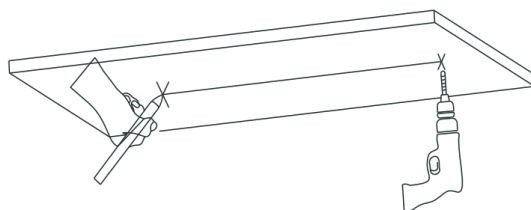

(3)

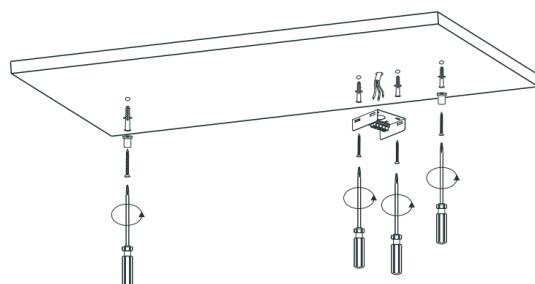

(4)

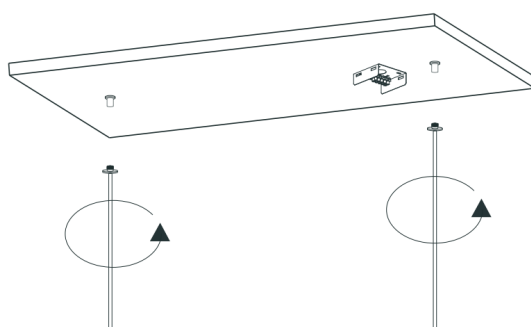

(5)

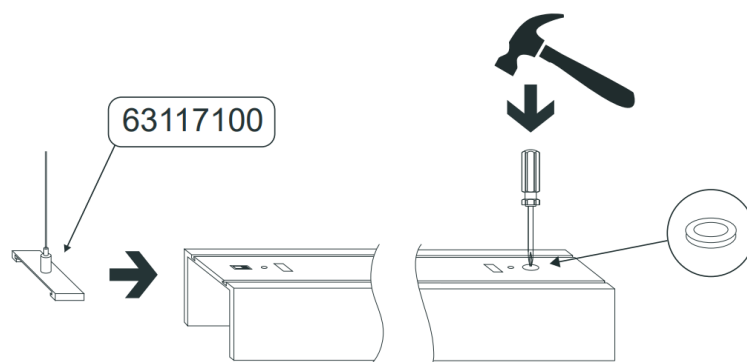

(6)

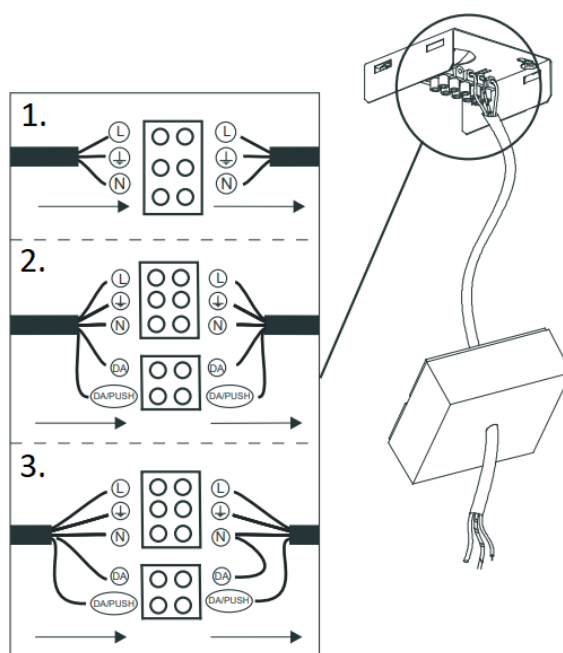

- 1. ON/OFF
- 2. DALI
- 3. PUSH DIM

(7)

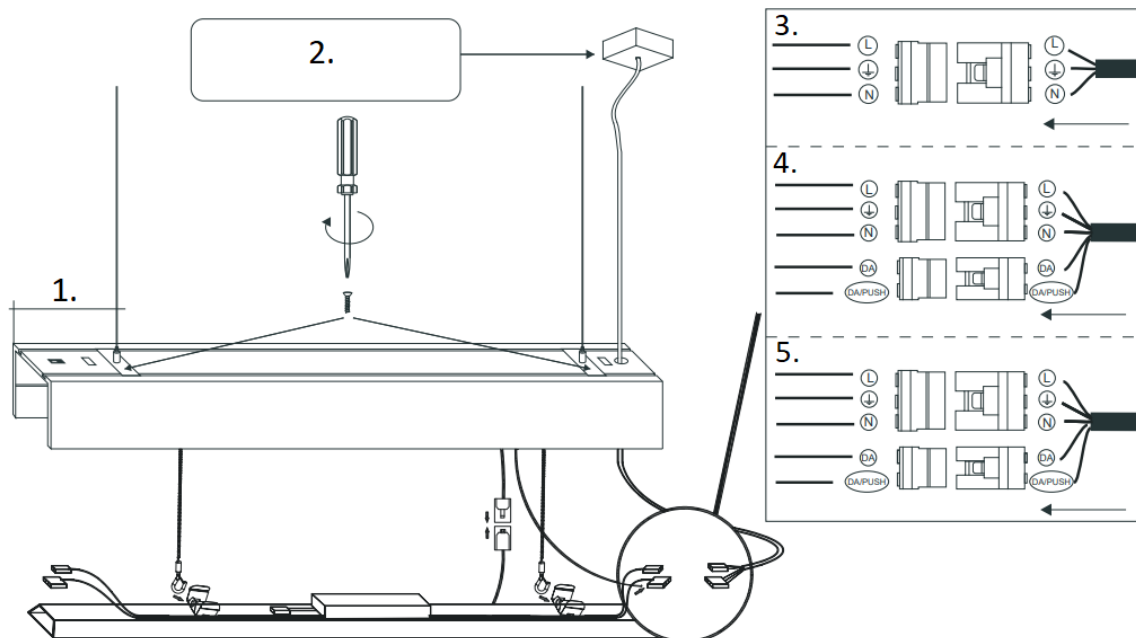

1. max 50mm
2. 6311801- WHITE
6311803 – BLACK
3. ON/OFF
4. DALI
5. PUSH DIM

(8)

Current selection by DIP-switch

LINO 90

| Pin1 | Pin2 | Pin3 | Currents (mA) | W |
|------|------|------|---------------|----|
| OFF | OFF | OFF | 450 | 18 |
| ON | OFF | OFF | 500 | 20 |
| ON | ON | OFF | 550 | 22 |
| ON | ON | ON | 600 | 24 |

LINO 120

| Pin1 | Pin2 | Currents (mA) | W |
|------|------|---------------|----|
| | | | |
| OFF | OFF | 500 | 21 |
| OFF | ON | 600 | 25 |
| ON | OFF | 700 | 29 |
| ON | ON | 800 | 33 |

LINO 150

| Pin1 | Pin2 | Currents (mA) | W |
|------|------|---------------|----|
| | | | |
| OFF | OFF | 900 | 37 |
| OFF | ON | 1050 | 43 |
| ON | OFF | 1100 | 45 |
| ON | ON | 1200 | 49 |

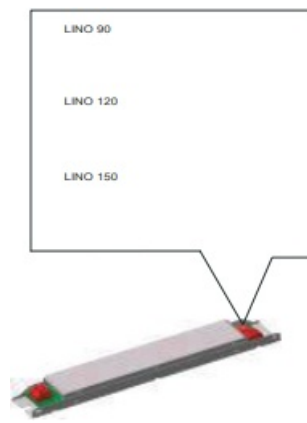

(9)

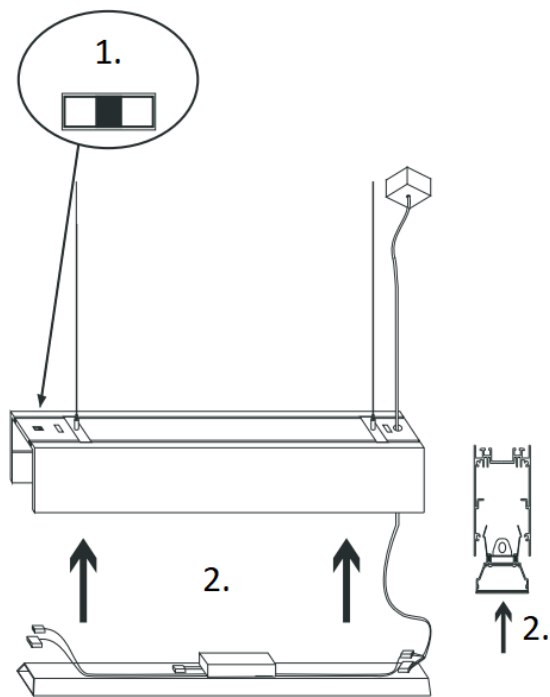

1. CCT SWITCH
3000K / 3500K / 4000K
2. CLICK

(10)

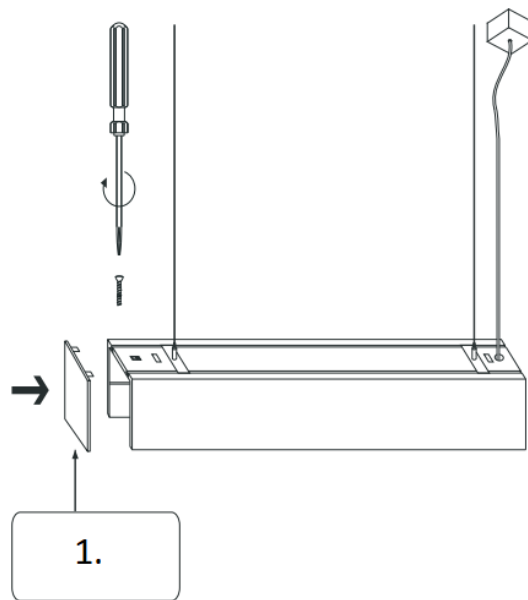

1. 6311001- WHITE
6311003 – BLACK

**! ONLY FOR P/N – DIRECT/INDIRECT VERSION !
INSTALLING INDIRECT LED BOARD**

(1)

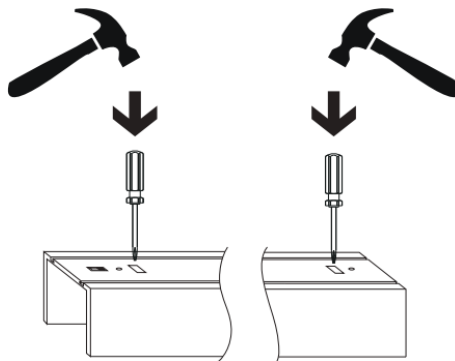

(2)

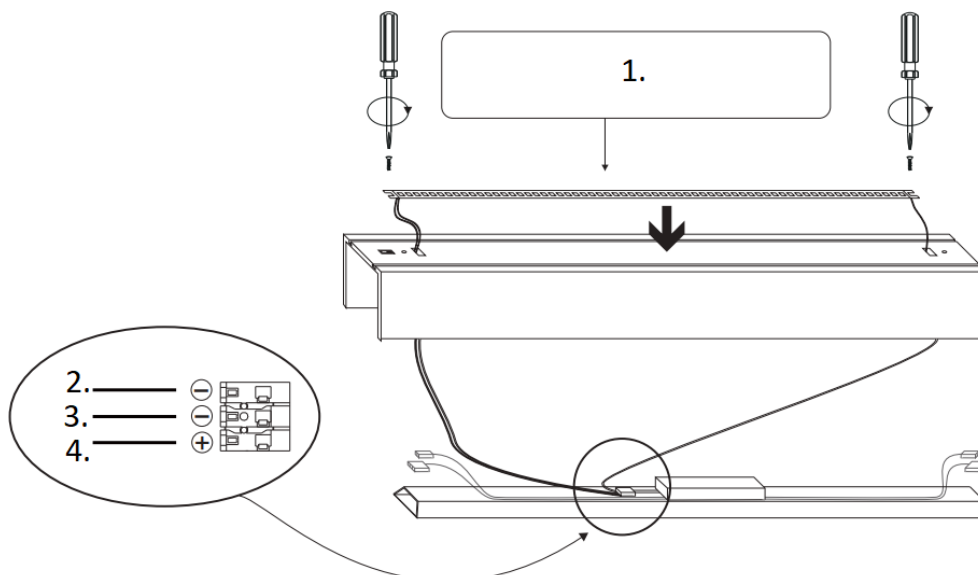

1. LINO INDIRECT LED KIT

LINO 90 – 6310751

LINO 120 – 6310851

LINO 150 – 6310951

2. BROWN

3. BLACK

4. RED

B. Surface

(1)

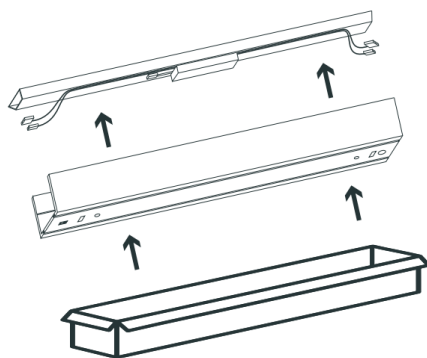

(2)

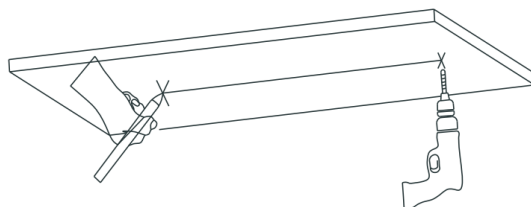

(3)

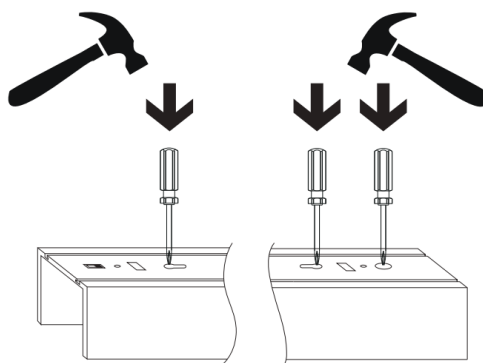

(4)

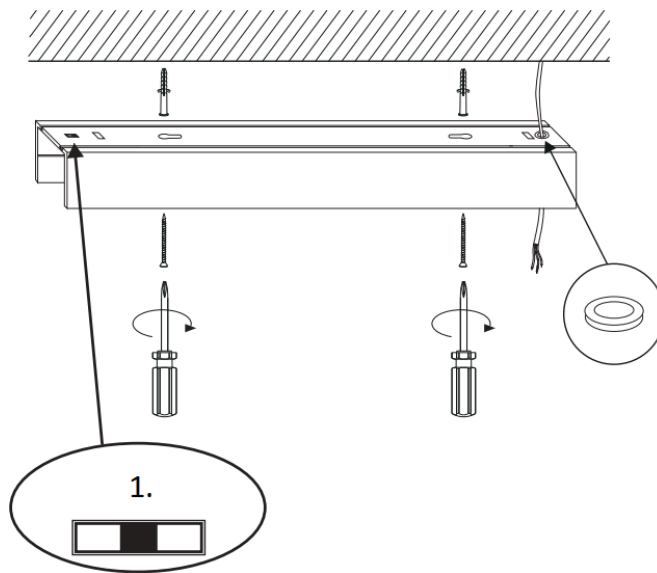

1. CCT SWITCH
3000K / 3500K / 4000K

(5)

Current selection by DIP-switch

LINO 90

| Pin1 | Pin2 | Pin3 | Currents (mA) | W |
|------|------|------|---------------|----|
| OFF | OFF | OFF | 450 | 18 |
| ON | OFF | OFF | 500 | 20 |
| ON | ON | OFF | 550 | 22 |
| ON | ON | ON | 600 | 24 |

LINO 120

| Pin1 | Pin2 | Currents (mA) | W |
|------|------|---------------|----|
| | | | |
| OFF | OFF | 500 | 21 |
| OFF | ON | 600 | 25 |
| ON | OFF | 700 | 29 |
| ON | ON | 800 | 33 |

LINO 150

| Pin1 | Pin2 | Currents (mA) | W |
|------|------|---------------|----|
| | | | |
| OFF | OFF | 900 | 37 |
| OFF | ON | 1050 | 43 |
| ON | OFF | 1100 | 45 |
| ON | ON | 1200 | 49 |

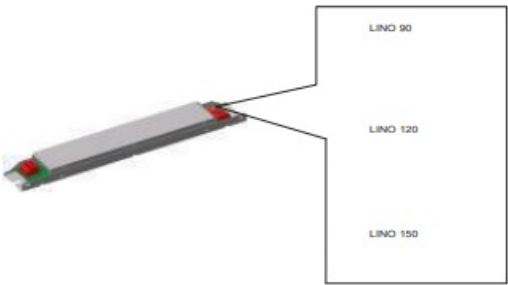

(6)

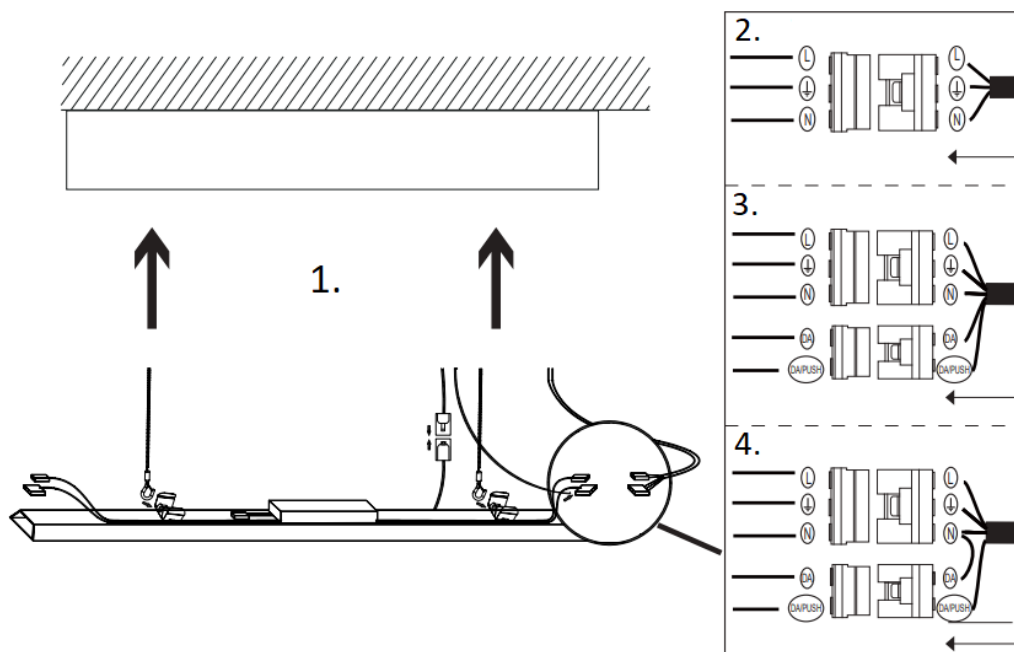

1. CLICK
2. ON/OFF
3. DALI
4. PUSH DIM

(7)

Do not use screws

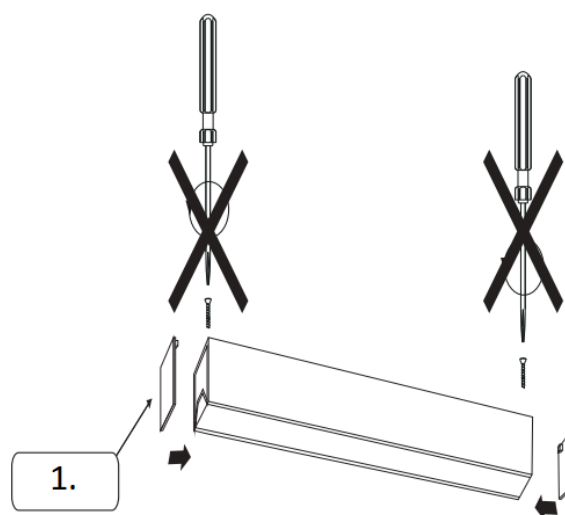

1. 6311001- WHITE
6311003 – BLACK

C. Continuous connection

(1) ! Align profile with hole in the connector

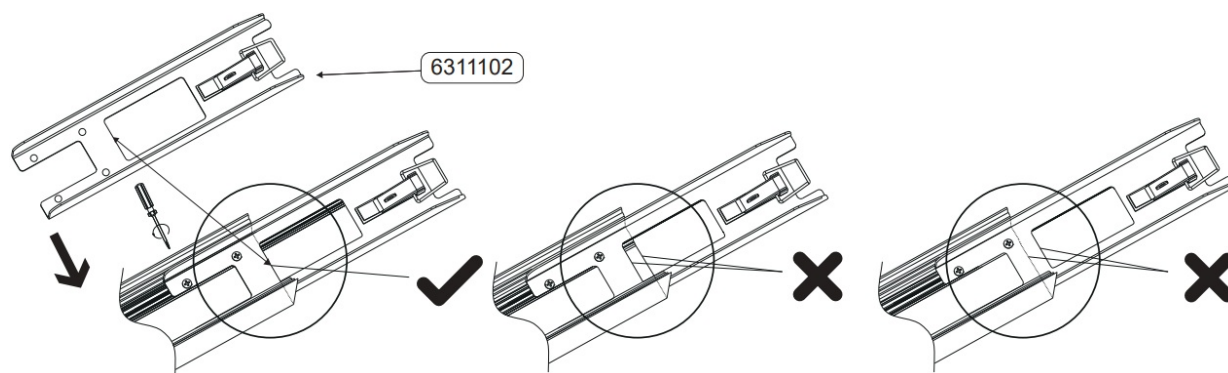

(2)

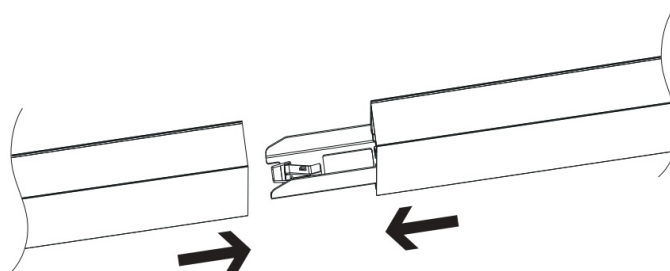

(3)

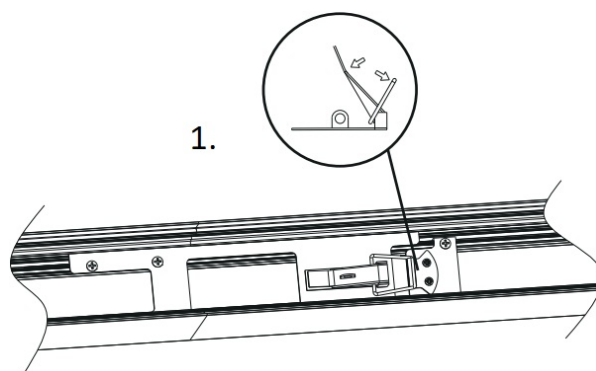

1. LOCK

(4)

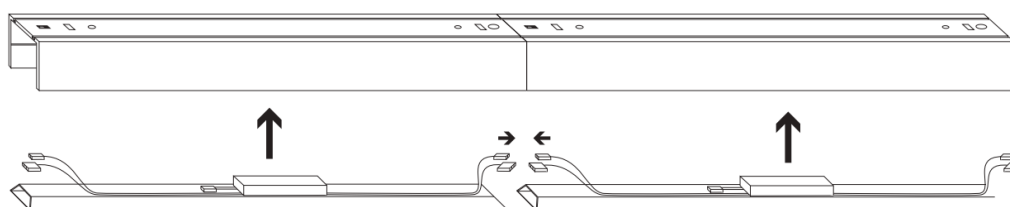

CAUTION!

Turn off the main power before proceeding with the installation in order to prevent possible shock. The installation may only be carried out by a technician or a qualified person. If the lamp has a lampshade/diffuser, handle it carefully as it is fragile. With an integrated LED light source, only a technician or a qualified person can make the replacement. The manufacturer is not responsible for the incorrect use and assembly of its products.



CONNECTION – DIMMABLE VERSION – OPTIONAL

(1) PUSH DIM

220-240 V 50/60 Hz

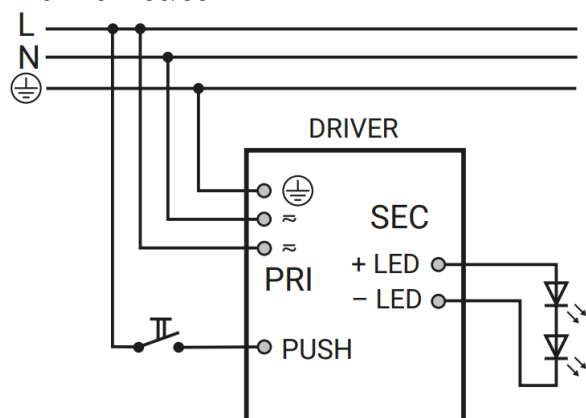

(2) DALI/PUSH DIM

220-240 V 50/60 Hz

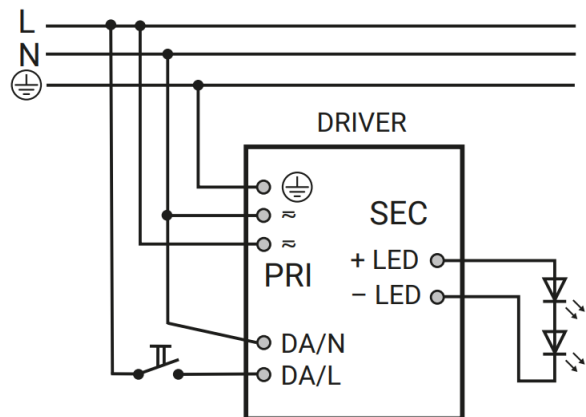

(3) DALI DIM

220-240 V 50/60 Hz

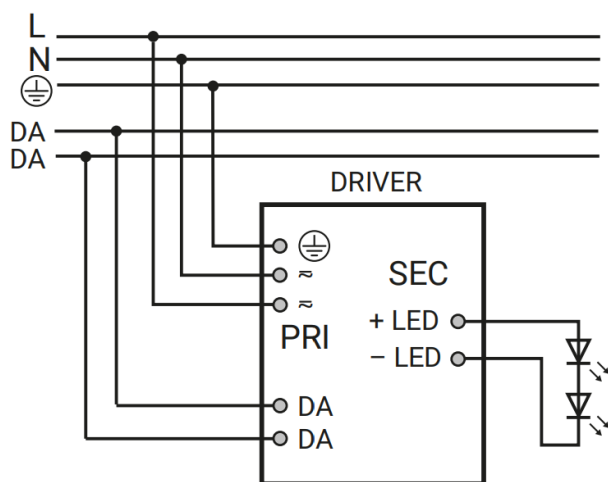

(4) TRIAC DIM

220-240 V 50/60 Hz

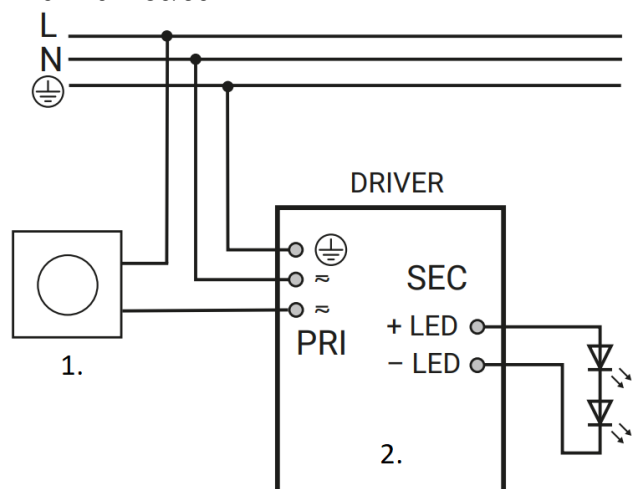

1. Phase cut
Triac dimmer
2. Trailing edge
Leading edge

CAUTION!

Turn off the main power before proceeding with the installation in order to prevent possible shock. The installation may only be carried out by a technician or a qualified person. If the lamp has a lampshade/diffuser, handle it carefully as it is fragile. With an integrated LED light source, only a technician or a qualified person can make the replacement. The manufacturer is not responsible for the incorrect use and assembly of its products.

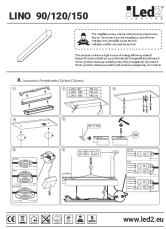
| | |
|--|--|
|  | <p>Led2 LINO 90 Ceiling Linear Lamp [pdf] Instruction Manual</p> <p>LINO 90 Ceiling Linear Lamp, LINO 90, Ceiling Linear Lamp, Linear Lamp, Lamp</p> |
|--|--|

References

- [uvod - architectural lighting](#)