



LED WORLD GLMD1XY SPI Digital Pixel Controller User Guide

[Home](#) » [LED WORLD](#) » LED WORLD GLMD1XY SPI Digital Pixel Controller User Guide 

LED WORLD GLMD1XY SPI Digital Pixel Controller



Contents

- 1 FEATURES
- 2 DOWNLOAD GOULY ANDROID/IOS APP
- 3 INITIAL STEPS
- 4 PIXEL COUNTING
- 5 CUSTOMERS SUPPORT
- 6 Documents / Resources
 - 6.1 References
- 7 Related Posts

FEATURES

- The number of supported IC types and the maximum number of controls: 15 common IC types are supported and the maximum number of lights a controller can control is 999.
- **Color control:** By controlling the four basic colors of red, green, blue and white (RGBW), W is used for dimming.
- **Mode switching:** Can switch the different display modes of LED lights, such as monochrome, gradient, flashing, breathing, chasing light and up to 24 modes.
- **Timing system:** Can be customized timing, such as sunset, sunrise mode, weekly cycle mode, annual mode.
- **Music and voice mode:** By analyzing the rhythm and frequency of music, LED lights change in sync with music; through Google Assistant, amazon alexa voice commands to control the brightness, color and mode of LEDs. The introduction of music mode and voice mode makes the LED controller more entertaining and intelligent.
- **Device sharing and group control function:** Support device sharing, allowing multiple users to access and control the same group of LED controllers at the same time. Through Internet connection, users can control multiple LED controllers in different locations at the same time.

Bring more convenience, scalability and intelligent control experience for users.

- **One key reset:** Before connecting to WIFI, it can be reset by one key through APP.

DOWNLOAD GOULY ANDROID/IOS APP



INITIAL STEPS

- Download the Gouly app from the app store.
- Sign up and create an account.

1. Click + icon to add a device.

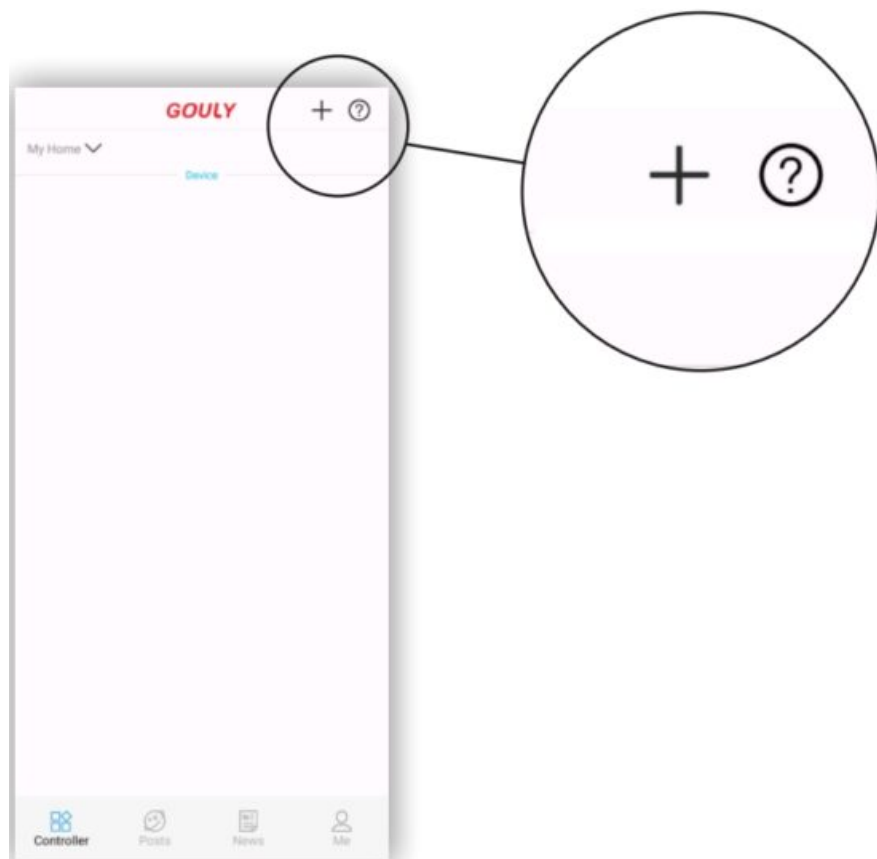

2. Click 2 icon to open a guide connecting a device using wifi or bluetooth.

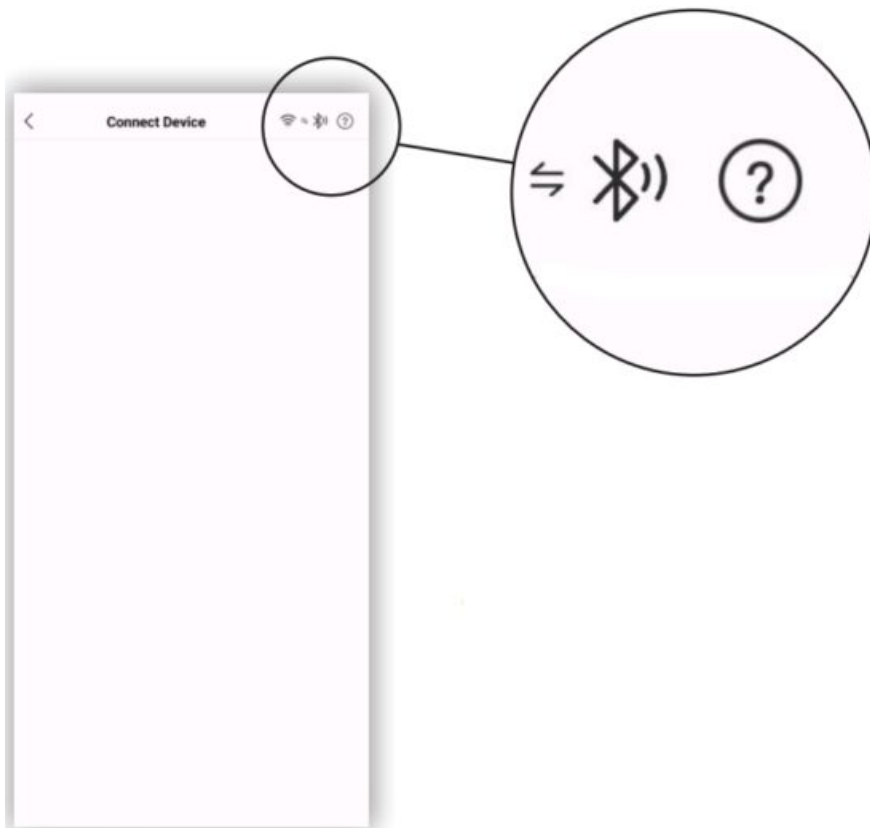

3. After connecting a device adjust the light settings. Click at bottom right settings tab to go to the settings page.

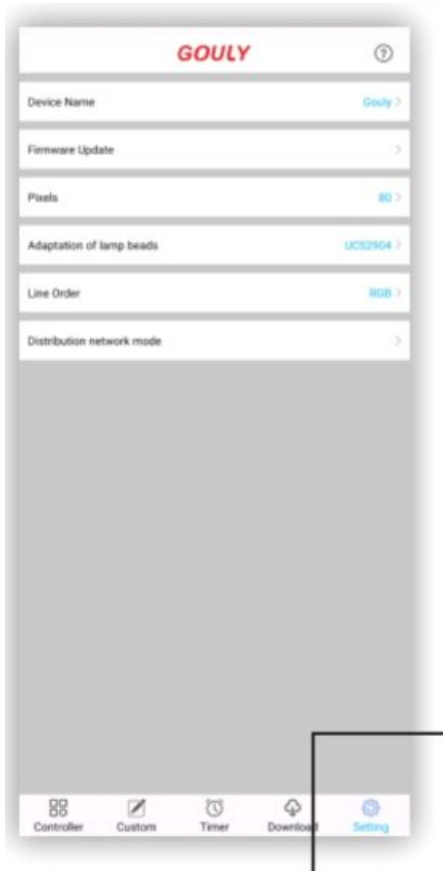

4. Select the number of pixels, chip type of digital light and Line Order.
Use UCS2904 for LED World's digital lights and RGB as Line order.
See the guide for pixel counting on the second page.

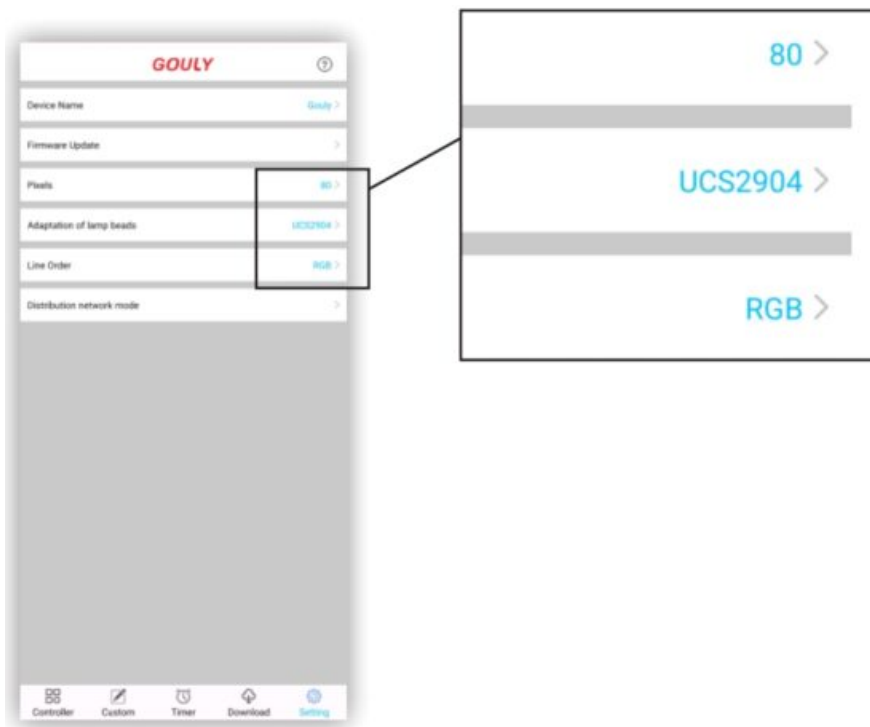

PIXEL COUNTING

- **GLMD1XY Pixel lights**

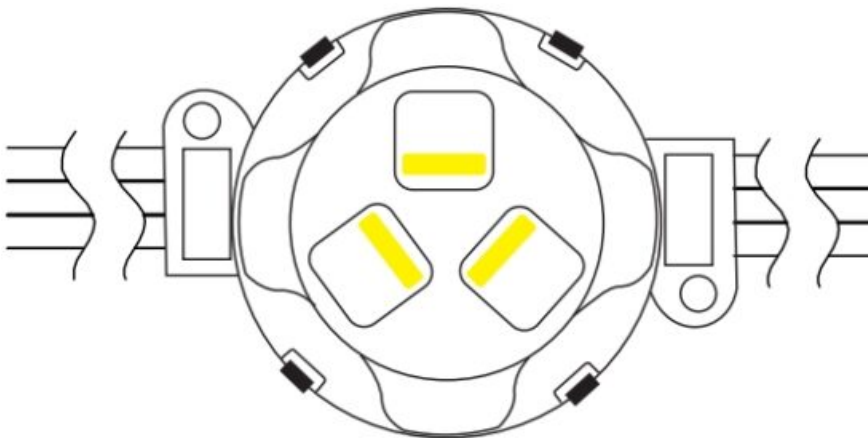

Each light module count as 1 pixel

- **GLMD160 Back lights**



Each light module count as 1 pixel

- **FA48D-12V-RGBW Strip**

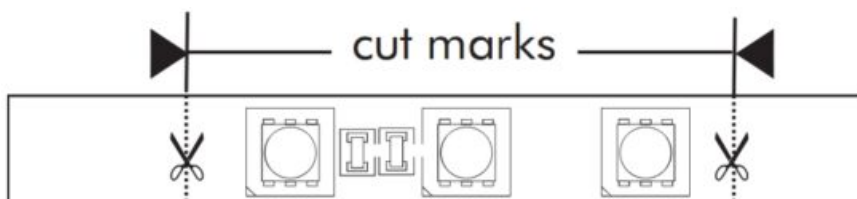

3 LEDs between cut marks count as 1 pixel

Copyright © 2024 LED WORLD INC™. All Rights Reserved. We are not responsible for errors or omissions. Product and specifications subject to change without notice. Registered trademarks are owned by their respective registers, or licensee(s).

CUSTOMERS SUPPORT

LED World Inc.

#130 10615 48 ST SE | CALGARY, AB T2C 2B7 | CANADA | Version 1.0 10/15/24

1-800-387-4081

ledworldlighting.com

ledworld.ca

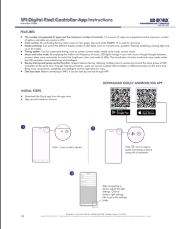

Documents / Resources

	<p>LED WORLD GLMD1XY SPI Digital Pixel Controller [pdf] User Guide GLMD1XY SPI Digital Pixel Controller, GLMD1XY SPI, Digital Pixel Controller, Pixel Controller, Controller</p>
---	--

References

- [LED World Canada - A Commercial LED lighting supplier](#)
- [LED World Lighting - A Commercial LED lighting supplier](#)
- [User Manual](#)

[Manuals+](#), [Privacy Policy](#)

This website is an independent publication and is neither affiliated with nor endorsed by any of the trademark owners. The "Bluetooth®" word mark and logos are registered trademarks owned by Bluetooth SIG, Inc. The "Wi-Fi®" word mark and logos are registered trademarks owned by the Wi-Fi Alliance. Any use of these marks on this website does not imply any affiliation with or endorsement.