



# LED Lighting Hut RT1, RT6, RT8 Dimming Touch Wheel RF Remote Controller Owner's Manual

[Home](#) » [LED LIGHTING HUT](#) » LED Lighting Hut RT1, RT6, RT8 Dimming Touch Wheel RF Remote Controller Owner's Manual 

## Contents

- [1 LED Lighting Hut RT1, RT6, RT8 Dimming Touch Wheel RF Remote Controller](#)
- [2 Product Features](#)
- [3 Product Technical Parameters](#)
- [4 Product Usage Instructions](#)
- [5 Features](#)
- [6 Technical Parameters](#)
- [7 Mechanical Structures and Installations](#)
- [8 Operation](#)
- [9 Match Remote Control \(two match ways\)](#)
- [10 Key function](#)
- [11 Safety information](#)
- [12 Documents / Resources](#)
- [13 Related Posts](#)



**LEDLIGHTINGHUT**

**LED Lighting Hut RT1, RT6, RT8 Dimming Touch Wheel RF Remote Controller**



## Dimming Touch Wheel RF Remote Controller

**Model No.:** RT1/RT6/RT8

### Product Features

- Applies to single color LED controller
- Ultra sensitive color adjustment touch wheel
- Each remote can match one or more receiver
- AAx2 battery powered
- Operate with LED indicator light
- Magnet on the back which can be stuck on back holder

### Product Technical Parameters

Model	Zones
RT1	1 Zone Dimming
RT6	4 Zone Dimming
RT8	8 Zone Dimming

The remote controller uses RF (2.4GHz) signal input and output. It requires 3VDC power supply from AAx2 batteries. The standby current is low and has a long standby time. The remote controller works within a distance of up to 30 meters.

### Product Usage Instructions

To use the Dimming Touch Wheel RF Remote Controller, follow the instructions below:

1. Insert two AAA batteries into the remote controller.
2. Match the remote controller to the receiver by pressing and holding the match button on the receiver until the LED indicator light flashes. Then, press any button on the remote controller to complete the match process.  
Repeat this step for each receiver you want to pair with the remote.
3. To turn the light on or off, press the power button on the remote controller.
4. To adjust the brightness, use the touch wheel on the remote controller. Slide your finger clockwise or counterclockwise to increase or decrease the brightness respectively.
5. To change the color, use the touch wheel on the remote controller. Slide your finger up or down to cycle through different colors.

1, 4, 8 zone dimming/Touch color wheel/Wireless remote 30m distance/AAAx2 battery/Magnet stuck fix

## Features

- Apply to single color LED controller.
- Ultra sensitive color adjustment touch wheel.
- Each remote can match one or more receiver.
- AAAx2 battery powered.
- Operate with LED indicator light.
- Magnet on the back which can be stuck on back holder.



## Technical Parameters

Input and Output	
Output signal	RF(2.4GHz)
Working voltage	3VDC(AAAx2)
Working current	<5mA
Standby current	<10μA
Standby time	1 year
Remote distance	30m(Barrier-free space)

Safety and EMC	
EMC standard (EMC)	ETSI EN 301 489-1 V2.2.3
	ETSI EN 301 489-17 V3.2.4
Safety standard(LVD)	EN 62368-1:2020+A11:2020
Radio Equipment(RED)	ETSI EN 300 328 V2.2.2
Certification	CE,EMC,LVD,RED

Environment	
Operation temperature	Ta: -30 OC ~ +55 OC
Package	
Size	L140 x W60 x H26mm
Gross weight	0.088kg
Warranty	
Warranty	5 years

## Mechanical Structures and Installations

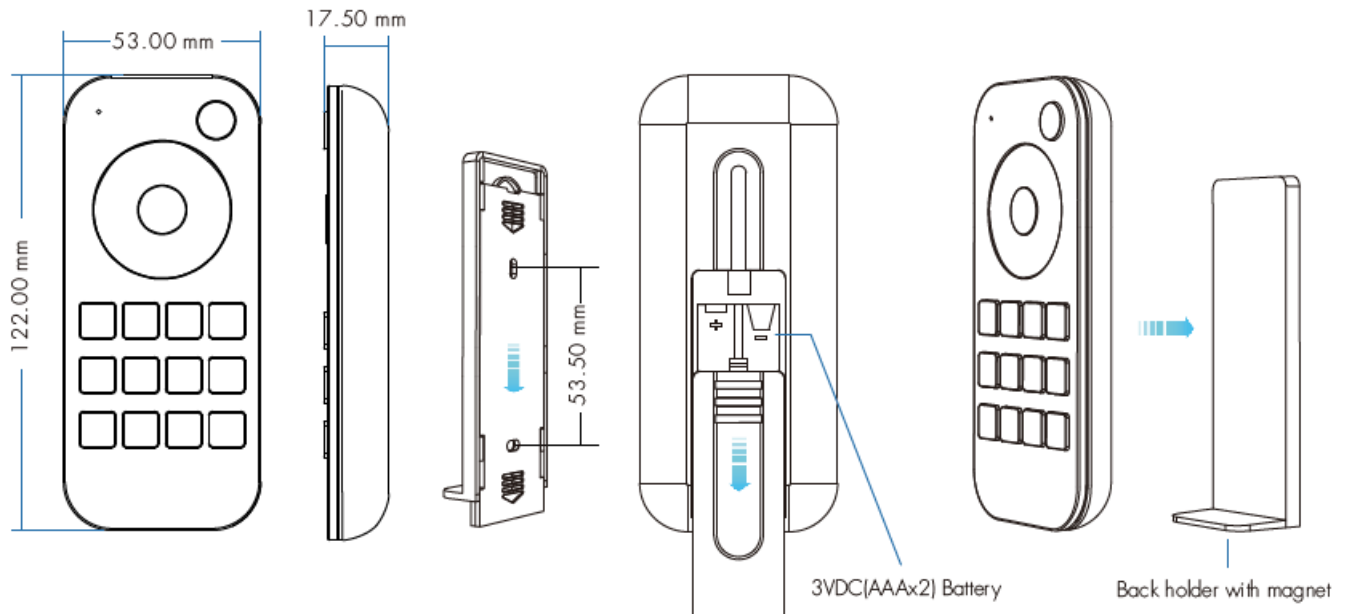

To fix the remote, three options are offered for selection:

- **Option 1:** stuck the remote on any metal surfaces directly.
- **Option 2:** fix the remote' back holder on the wall with two screws.
- **Option 3:** adhere the remote' back holder to the wall with paster.

## Operation

- When turn on light, the indicator display blue. when turn off light, the indicator display red.
- When touch the color wheel, the indicator will display the same color.
- When press or touch operation is invalid (If the light is off), the indicator display red.
- To extend battery life, no touch or press key operation after a few seconds, the touch wheel will enter sleep state, you need press any key to make touch wheel quit sleep state.

## Match Remote Control (two match ways)

End user can choose the suitable match/delete ways. Two options are offered for selection

### Use the controller's Match key

#### Match:

Short press match key, immediately press on/off key (single zone remote) or zone key (multiple zone remote) of the remote.

The LED indicator fast flash a few times means match is successful.

#### Delete:

Press and hold match key for 5s to delete all match,

The LED indicator fast flash a few times means all matched remotes were deleted.

### Use Power Restart

#### Match:

Switch off the power, then switch on power, repeat again. Immediately short press on/off key (single zone remote) or zone key (multiple zone remote) 3 times on the remote.  
The light blinks 3 times means match is successful.

#### Delete:

Switch off the power, then switch on power, repeat again. Immediately short press on/off key (single zone remote) or zone key (multiple zone remote) 5 times on the remote.  
The light blinks 5 times means all matched remotes were deleted.

### Key function

- RT1 1 zone dimming remote



: Turn on/off light.



: Touch to change brightness.



: Adjust brightness, short press 10 levels, long press 1-6s for continuous 256 levels adjustment. : Small night brightness (10%).



: Turn off light after 30s, long press 2s will turn off light after 60s.



: 25%, 50%, 75%, 100% brightness.



: Short press recall the scene, long press 2s save current brightness into S1/2/3/4. the LED indicator display green when save OK.

- RT6 4 zone dimming remote





: Short press turn on/off all zone light.



: Touch to change current zone brightness.

: Short press select and turn on zone light, long press 2s turn off zone light.

Short press multiple zone key fastly, will select multiple zone synchronously.

: 25%, 50%, 75%, 100% brightness for current selected zone.

: Short press recall the scene, long press 2s save current state into S1/2/3/4.

the LED indicator display green when save OK. 4 zone recall or save synchronously.



**The remote can be used as 4 zone dimming remote or single zone 4 channel dimming remote.**



**On/Off + 4:** Long press 2s set as 4 channel dimming remote, only match with one or multiple receiver of 4 channel, such as V4 or C4 controller.

**On/Off + 1:** Long press 2s set as 4 zone dimming remote, each zone match with one or multiple receivers. When set ok, the red indicator will light on longer.

#### • RT8 8 zone dimming remote



: Short press turn on/off all zone light.

: Touch to change current zone brightness.

: Short press select and turn on zone light, long press 2s turn off zone light.

Short press multiple zone key fastly, will select multiple zone synchronously.

: Short press recall the scene, long press 2s save current state into S1/2/3/4.

the LED indicator display green when save OK. 8 zone recall or save synchronously.



#### Safety information

1. Read all instructions carefully before you begin this installation.
2. When installing battery, pay attention to the battery positive and negative polarity. A long time without the remote control, remove the battery.  
When remote distance becomes smaller and insensitive, replace the battery.
3. If no response from the receiver, please re-match the remote.
4. Gently handle remote, beware of falling.
5. For indoor and dry location use only.

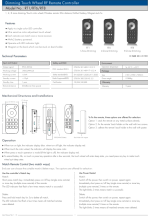

[LED Lighting Hut RT1, RT6, RT8 Dimming Touch Wheel RF Remote Controller](#) [pdf] Owner's Manual

RT1, RT6, RT8, RT1 RT6 RT8 Dimming Touch Wheel RF Remote Controller, RT1 Dimming Touch Wheel RF Remote Controller, RT6 Dimming Touch Wheel RF Remote Controller, RT8 Dimming Touch Wheel RF Remote Controller, Dimming Touch Wheel RF Remote Controller, Dimming Touch Wheel Remote Controller, RF Remote Controller, Remote Controller, Dimming Touch Wheel