



Contents [[hide](#)]

- [1 LECTRON CCS1 Vortex Plug Supercharger Adapter](#)
- [2 INTRODUCTION TO THE NACS TO](#)
- [3 IMPORTANT SAFETY INSTRUCTIONS](#)
- [4 WHAT'S INCLUDED](#)
- [5 PARTS OVERVIEW](#)
- [6 CHARGING TIME](#)
- [7 CONNECTING THE VORTEX PLUG](#)
- [8 DISCONNECTING THE VORTEX PLUG](#)
- [9 TROUBLESHOOTING](#)
- [10 SPECIFICATIONS](#)
- [11 GET MORE SUPPORT](#)
- [12 FAQs](#)
- [13 Documents / Resources](#)
 - [13.1 References](#)
- [14 Related Posts](#)



LECTRON

LECTRON CCS1 Vortex Plug Supercharger Adapter



INTRODUCTION TO THE NACS TO

CCS ADAPTER

The Vortex Plug NACS to CCS adapter allows CCS1-enabled electric vehicles to use the North American Charging Standard (NACS) to access NACS DC fast chargers.

WARNING

- **High Voltage** – Handle with care and ensure proper connection before use.
- **Caution** – Risk of Electric Shock and Fire. Do not use this product if there is any damage to the EV cable, the vehicle connector, or the vehicle inlet.

IMPORTANT SAFETY INSTRUCTIONS

WARNING – When using electric products, basic precautions should always be followed, including the following. This manual contains important instructions for Model LEADPTeslaCCSBLKUS that shall be followed during use and maintenance of the adapter.

- a) Read all instructions before using this product.
- b) Do not put fingers into the adapter.
- c) Do not use this product if the flexible output cable, vehicle connector, vehicle inlet,

or the adapter itself has broken insulation, broken, or cracked housings, or if internal parts are accessible including wiring.

- d) Do not use this adapter with any charger or EV that is capable of exceeding the adapter's rated voltage or current capacity. Some EVs and EVSE combinations are capable of multiple voltages or limited durations of current overloading, designed for normal EVSE to EV connections. Use of the adapter in these situations could result in unsafe conditions such as fire, burns, or exposure of high voltage.

***SAVE THESE INSTRUCTIONS FOR FUTURE REFERENCE.**

For use with NACS DC fast chargers ONLY



NOT suitable for use with:

- Wall Connectors
- Destination Chargers
- Mobile Connectors
- Any other EV chargers



Misuse may result in damage and safety hazards.

PLEASE READ INSTRUCTIONS CAREFULLY BEFORE USE:

- Intended for CCS1 vehicles within the NACS alliance only. Please check with your automaker for compatibility.
- Follow the correct connection and disconnection procedures as prescribed in the user manual.

- Do not disconnect during charging.
- Protect from water and moisture.
- Operate within the temperature range of -22°F to 122°F.
- Handle with care and store in a safe location.
- Do not clean with detergent.
- Do not open or modify the adapter.

Contact Customer Support at contact@ev-lectron.com for usage guidelines, maintenance, or repairs.

WHAT'S INCLUDED

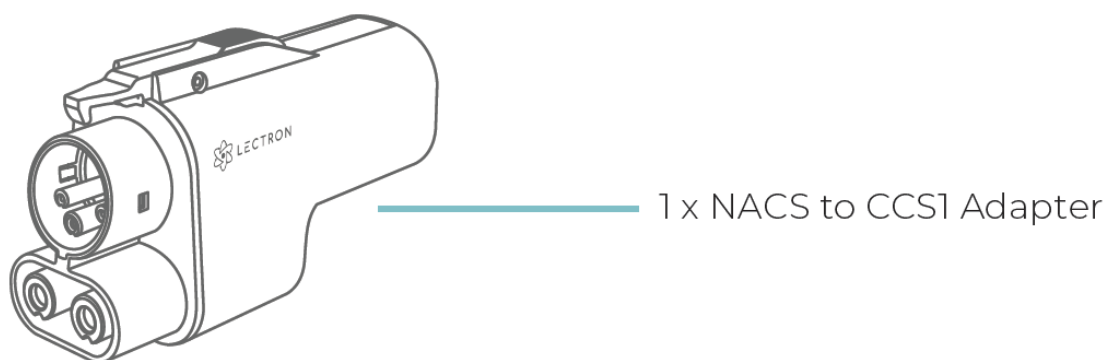

PARTS OVERVIEW

OVERVIEW

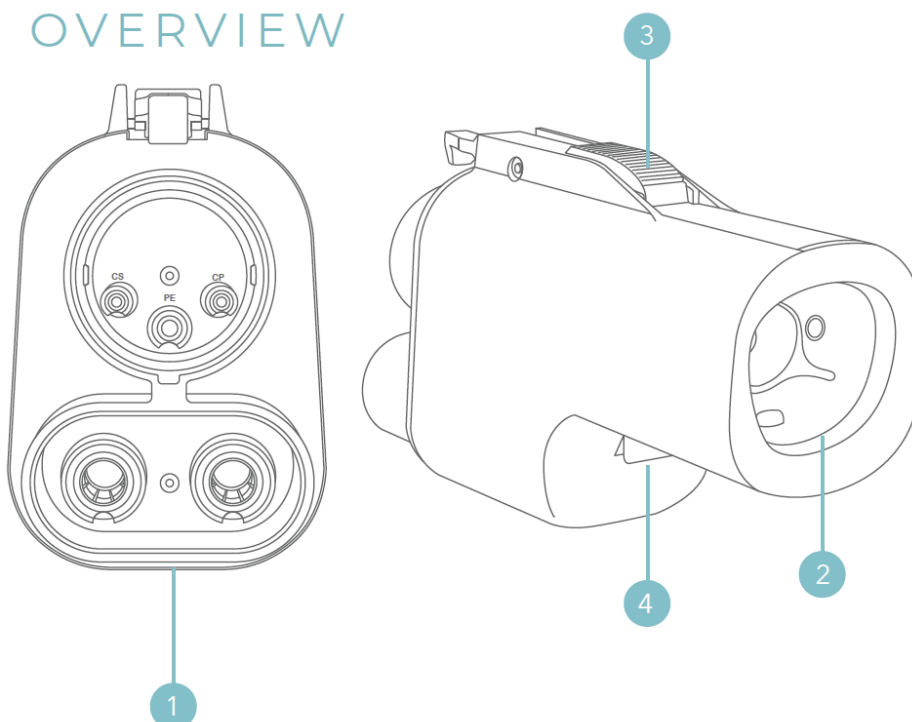

1. CCS1 Coupler

2. NACS DC Inlet
3. CCS1 Unlock Latch
4. NACS Unlock Button

BEFORE USE

NOTE: Ensure the Tesla Supercharger supports CCS1 charging.

WARNING: Do not store the NACS to CCS1 Adapter outside of the storage temperature range of -40°F to 185°F.

CHARGING TIME

Charging time varies depending on the NACS DC fast charging station, electric vehicle specifications, environmental conditions, and battery temperature. The NACS to CCS1 Adapter includes built-in temperature monitoring. Charging power will decrease if the internal components of the adapter exceed 194°F. Operation will shut off if the surface temperature of the adapter reaches 140°F.

CONNECTING THE VORTEX PLUG

1. Open your EV charging port and press the CCS1 unlock latch on the adapter, before plugging the adapter into your vehicle. Ensure a secure connection.

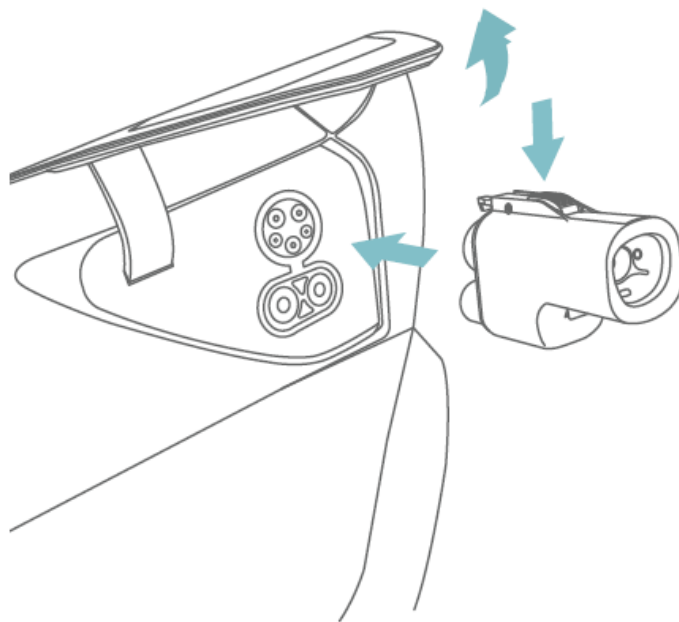

2. Press the NACS unlock button and connect the Supercharger coupler to the NACS Supercharger inlet on the adapter.

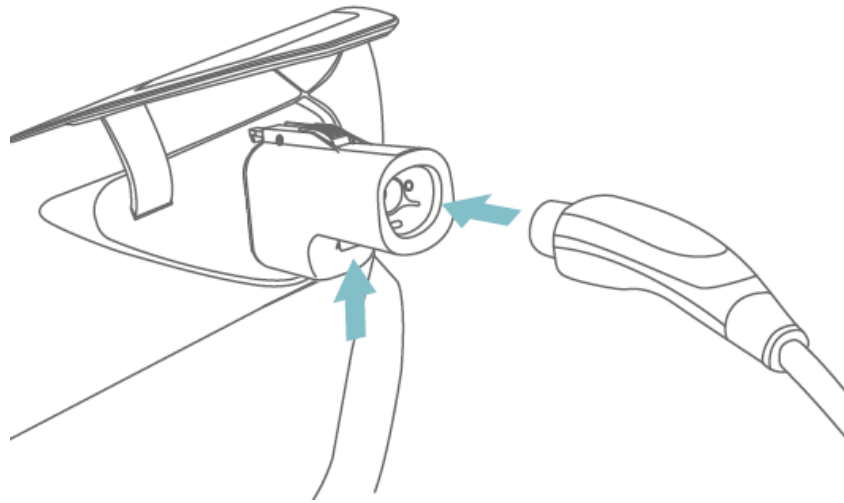

3. Allow a brief pause for the vehicle and charger to begin communicating. Check the internal EV display for a successful connection.

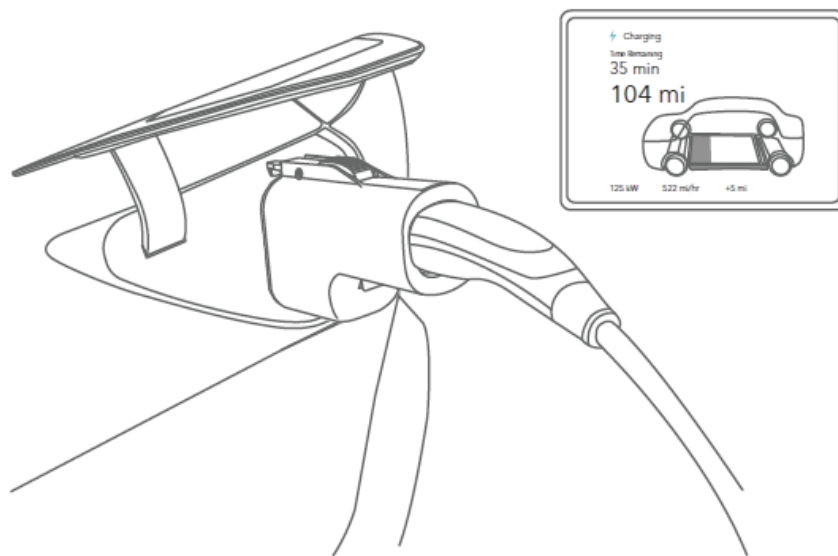

4. Begin charging following the station guidelines.

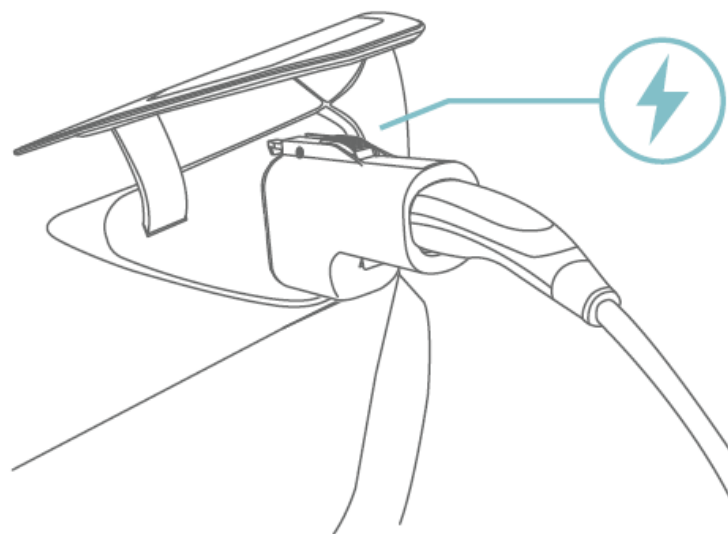

DISCONNECTING THE VORTEX PLUG

1. Only remove the Vortex Plug once charging is complete.

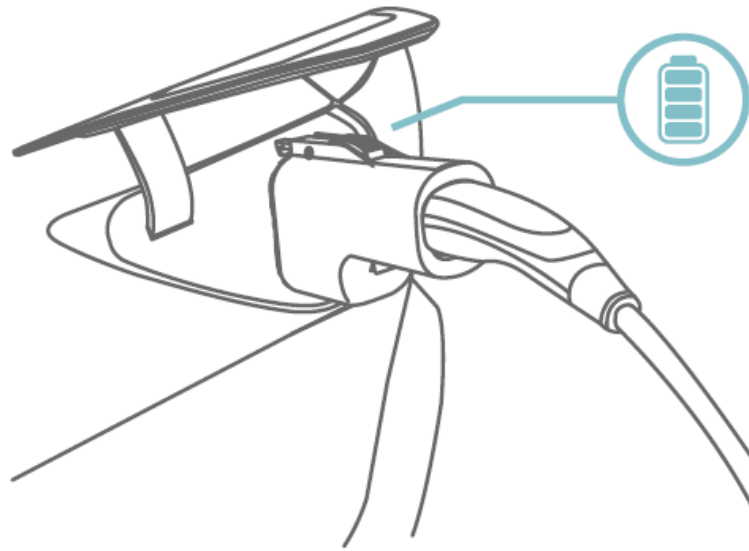

2. Press the NACS unlock button and disconnect the NACS DC coupler from the NACS inlet on the adapter.

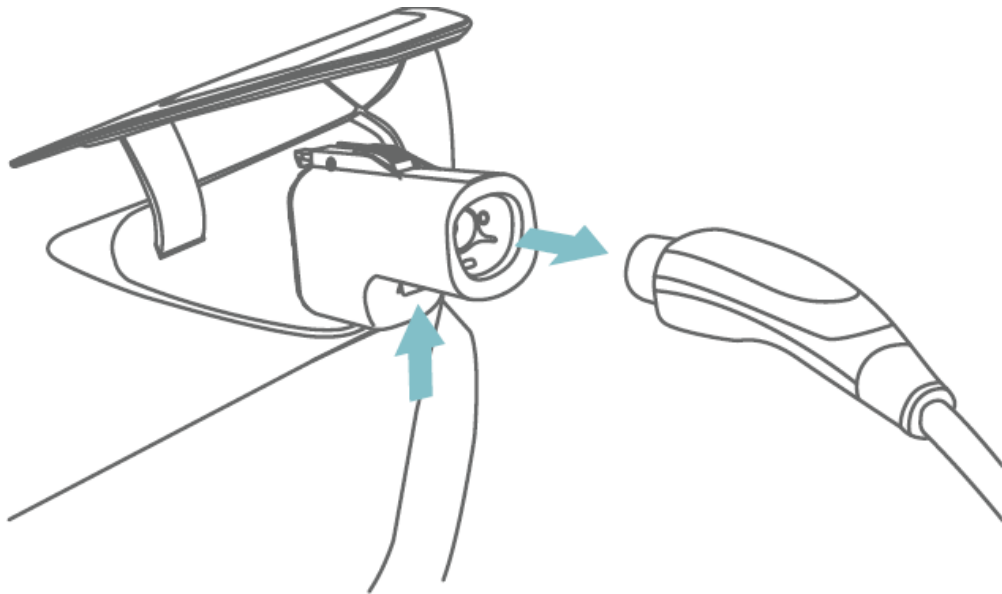

3. Press the CCS1 unlock latch on the adapter to release the connection between the adapter and the vehicle charging port.

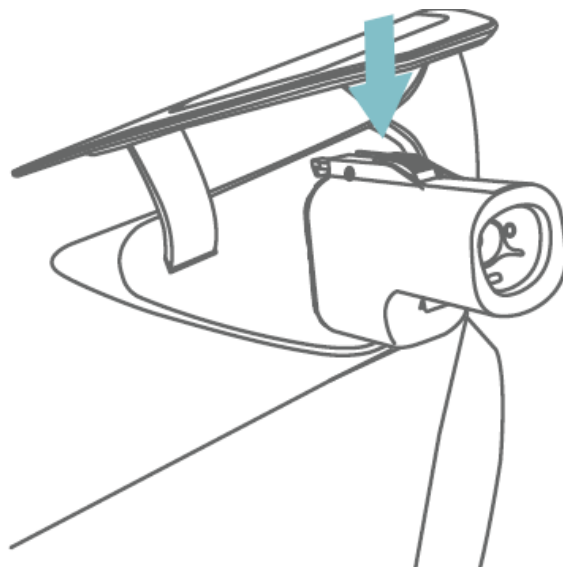

4. Remove the adapter from the vehicle charging port.

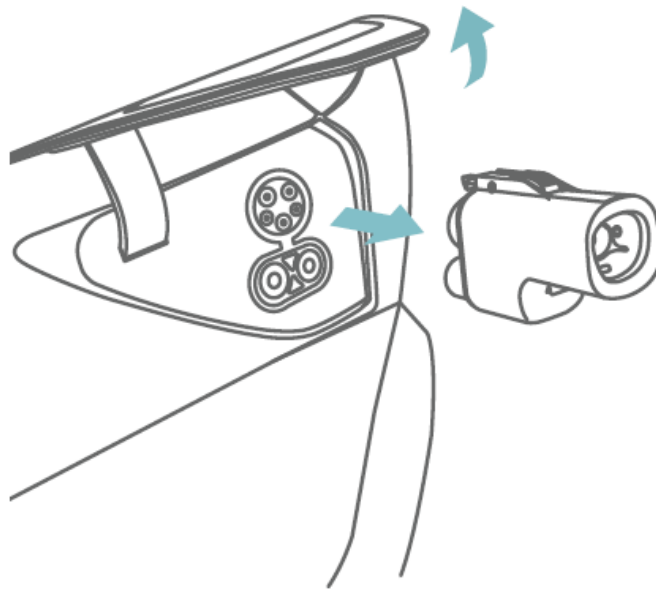

TROUBLESHOOTING

If the vehicle fails to initiate charging, please consider the following steps:

1. Ensure the DC fast charger supports CCS1 vehicles.
2. Check for firm connections at both the NACS and CCS1 ends of the adapter.
3. Safely unplug following the user manual procedure, then begin the connection process again.
4. Verify the charging status on the NACS DC fast charger and the electric vehicle display.
5. If issues persist, please contact contact@ev-lectron.com

SPECIFICATIONS

Rated current:	500A DC
Rated input/output:	1,000V DC
Weatherproof rating:	IP67
Operating temp:	-22°F – 122°F
Storage temp:	-40°F to 185°F
Connector:	CCS1

Inlet:	NACS
Weight:	2 lbs
Materials:	PC/PA66/Copper

Disclaimer: The Vortex Plug NACS to CCS adapter is exclusively intended for CCS1-enabled electric vehicles using the North American Charging Standard (NACS) to access NACS DC fast chargers.

GET MORE SUPPORT

- **Need assistance?**

- For maintenance, servicing, or replacements,
- Please contact our support team by scanning the QR code or emailing us at contact@ev-lectron.com

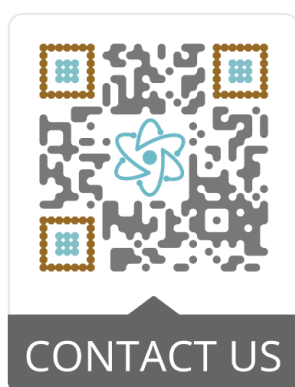

- www.ev-lectron.com
- Made in China

FAQs

Q: Where can I find a list of automakers that use the Tesla North American Charging Standard (NACS)?

A: Tesla lists the supported and coming soon automakers here. A comprehensive list of all automakers that have adopted the Tesla North American Charging Standard is also available at this link (Updated: Jan 2024).

Q: Which Supercharger sites are compatible with my vehicle?

A: To see which sites are compatible to charge your vehicle, add your vehicle details to the Tesla app or use Tesla's interactive map.

Q: What can I do if excessively warm weather causes charging faults?

A: If charging faults occur due to excessive heat, let the charger and adapter cool down for about 30 minutes before retrying. This is a built-in safety feature.

Q: Can I use the Vortex Plug at any Tesla Supercharger?

A: The Vortex Plug is compatible with V3 and V4 Tesla Superchargers, which support up to 250kW and 350kW, respectively. It may not function with older Supercharger sites unless they have received the necessary software update from Tesla. To see which sites are compatible to charge your vehicle, add your vehicle details to the Tesla app or use Tesla's interactive map.

Q: How many Supercharger ports will be accessible, and which Supercharger generations are compatible?

A: Tesla has allocated 15,000+ Supercharger stalls for NACS. To see which sites are compatible to charge your vehicle, add your vehicle details to the Tesla app or use Tesla's interactive map.

Q: How do I activate a Tesla Supercharger if plug-and-charge isn't working?

A: If you find that a Supercharger is not working with plug-and-charge, you can activate it using the Charge Assist app on your vehicle's infotainment screen.

Q: What should I do if the Tesla Supercharger cord is too short to reach my EV?

A: Chargers located at the end of the row typically provide more room. If that's not possible, be mindful that you may need to occupy two spots. We recommend charging during off-peak hours when more chargers are available.

Q: What can I do if excessively warm weather causes charging faults?

A: In very hot weather conditions, allow the charger and adapter to cool down for about 30 minutes before trying to charge again

Q: Will the Vortex Plug be available in Canada?

A: Yes, the Lectron Vortex Plug is available in Canada.

Q: What output can I expect in my EV? Do the same charge rates apply as they do for Teslas?

A: The Lectron Vortex Plug is rated for 500A and 1,000V. However, your actual charging rate depends on the Tesla Supercharger model generation output and your vehicle's onboard charging specifics. Charging rates may vary

Q: What is the voltage and current type (AC or DC) supplied from the Vortex Plug to the vehicle?

A: The Tesla Supercharger provides DC (Direct Current) power directly to the vehicle's battery. The Lectron Vortex Plug is rated for 500A and 1,000V.

Q: Does Tesla guarantee that this will work with their Superchargers?

A: We actively engage with most OEMs and automakers to ensure the compatibility and reliability of the Vortex Plug. It's important to note that Tesla does not offer

guarantees for third-party compatibility. For the most up-to-date guidance on using non-Tesla charging adapters with Superchargers, we recommend reaching out to Tesla directly.

Q: What type of locking/safety feature is there on this adapter? Is there a “lock” between the charger and adapter/adapter to the vehicle?

A: Yes, the Lectron Vortex Plug has a locking safety feature on both the NACS and CCS sides to prevent unintended disconnects.

Q: Will the Vortex Plug work with Level 2 Tesla chargers?

A: No, the Lectron Vortex Plug is a DC adapter designed exclusively for safe use with Superchargers only. To charge your EV at Level 2 Tesla Chargers, we recommend our Tesla to J1772 adapter. This adapter is compatible with Tesla High Powered Wall Connectors, Destination Chargers of all generations, and Mobile Connectors.

Q: Will I be able to use the Vortex Plug to access level 2 charging at Tesla Destination Chargers or Mobile Connectors?

A: No, it won't. The Vortex Plug is a DC adapter designed exclusively for safe use with Superchargers only. To charge your EV using Level 1 or Level 2 Tesla Chargers, we recommend our Tesla to J1772 adapter. This adapter is compatible with Tesla High Powered Wall Connectors, Destination Chargers of all generations, and Mobile Connectors

Q: Will I be able to use the Vortex Plug in conjunction with a Level 2 Charger (NEMA 14-50) or a Level 1 Charger (standard wall plug)?

A: The Vortex Plug is a DC adapter designed exclusively for safe use with Superchargers only. To charge your EV using Level 1 or Level 2 Tesla Chargers, we

recommend our Tesla to J1772 adapter. This adapter is compatible with Tesla High Powered Wall Connectors, Destination Chargers of all generations, and Mobile Connectors

- **What do I do if my vehicle fails to initiate charging?**

- If your vehicle fails to initiate charging, follow these steps:
 1. Ensure the DC fast charger supports CCS1 vehicles.
 2. Check for firm connections at both ends of the adapter.
 3. Safely unplug following the user manual procedure, then reconnect.
 4. Verify charging status on the NACS DC fast charger and EV display.
 - If issues persist, please contact customer support at contact@ev-lectron.com.

Documents / Resources

 <p>LECTRON VORTEX PLUG SUPERCHARGER TO CCS ADAPTER USER MANUAL</p>	LECTRON CCS1 Vortex Plug Supercharger Adapter [pdf] User Manual CCS1, CCS1 Vortex Plug Supercharger Adapter, Vortex Plug Supercharg er Adapter, Plug Supercharger Adapter, Supercharger Adapter, Adapter
--	--

References

- [✿ Lectron Electric Vehicle Charging — Lectron EV](#)
- ["https://manual.tools/?p=16546841#MTA0Ljl4LjIwMi4xNzk7Ozs7"](https://manual.tools/?p=16546841#MTA0Ljl4LjIwMi4xNzk7Ozs7) ref="nofollow">User Manual

Related Posts



[LECTRON CCS1 Tesla Adapter User Manual](#)

LECTRON CCS1 Tesla Adapter Product Introduction This charging adapter allows Tesla owners to access CCS1 fast chargers. In...



ass="rp4wp-related-post-image">

[LECTRON LEADPCCS500ABLKUS CCS1 To Tesla Adapter User Manual](#)

LECTRON LEADPCCS500ABLKUS CCS1 To Tesla Adapter PRODUCT

INTRODUCTION This charging adapter allows Tesla owners to access CCS1 fast...



[LECTRON V2L Adapter User Manual](#)

LECTRON V2L Adapter About the V2L Adapter The Lectron V2L (Vehicle-To-Load) Adapter converts your EV charger port into...



[Huddly USB Adapter Brings Plug User Manual](#)

USB Adapter USB plug and play for Huddly L1 USB Adapter Brings Plug The Huddly USB Adapter lets...

>

■ [LECTRON](#)

◆ [Adapter](#), [CCS1](#), [CCS1 Vortex Plug Supercharger Adapter](#), [LECTRON](#), [Plug Supercharger Adapter](#), [Supercharger Adapter](#), [Vortex Plug Supercharger Adapter](#)

—Previous Post

[LECTRON J1772 15 Amp Portable EV Charger User Manual](#)

Next Post—

[LECTRON J1772 40 AMP Charger Compatible With Tesla Portable EV Charger User Manual](#)

Leave a comment

Your email address will not be published. Required fields are marked *

Comment *

Name

Email

Website

☐ Save my name, email, and website in this browser for the next time I comment.

Post Comment

Manuals+, Privacy Policy | @manuals.plus | YouTube

This website is an independent publication and is neither affiliated with nor endorsed by any of the trademark owners. The "Bluetooth®" word mark and logos are registered trademarks owned by Bluetooth SIG, Inc. The "Wi-Fi®" word mark and logos are registered trademarks owned by the Wi-Fi Alliance. Any use of these marks on this website does not imply any affiliation with or endorsement.