



LECTRON CCS Combo 2 to Type 2 Adapter User Manual

[Home](#) » [LECTRON](#) » LECTRON CCS Combo 2 to Type 2 Adapter User Manual 



LECTRON

CCS Combo 2 to
Type 2 Adapter
USER MANUAL



Contents

- 1 In the Box
- 2 Safety Information
- 3 Introduction to Parts
- 4 Charging Your Vehicle
- 5 Troubleshooting
- 6 Specifications
- 7 Get More Support
- 8 Documents / Resources
- 8.1 References

In the Box

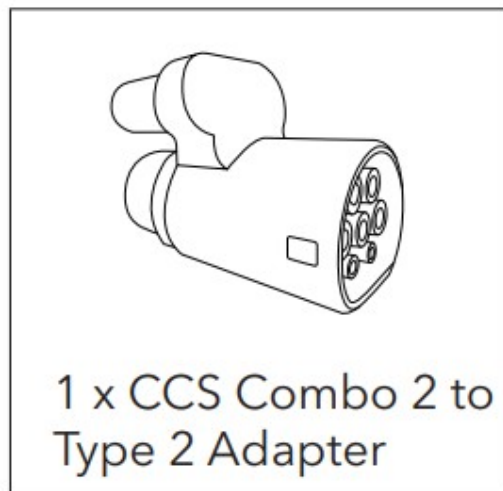

Warnings

SAVE THESE IMPORTANT SAFETY INSTRUCTIONS. This document contains important instructions and warnings that must be followed when using the CCS Combo 2 Adapter.

Only use to connect the charge cable on a CCS Combo 2 charging station to a Tesla Model S or Model X vehicle that is capable of Combo 2 DC charging.

Note: Vehicles built before May 1, 2019 are not equipped with CCS charging capability. To install this capability, please contact Tesla service.

Charging Time

Charging time varies based on the power and current available from the charging station, subject to various conditions.

Charging time also depends on ambient temperature and vehicle's Battery temperature. If the Battery is not within the optimal temperature range for charging, the vehicle will heat or cool the Battery before charging begins. For the most up-to-date information on how long it takes to charge your Tesla vehicle, go to the Tesla website for your region.

Safety Information

1. Read this document before using the CCS Combo 2 to Type 2 Adapter. Failure to follow any of the instructions or warnings in this document can result in fire, electrical shock, or serious injury.
2. Do not use it if it appears defective, cracked, frayed, broken, damaged or fails to operate.
3. Do not attempt to open, disassemble, repair, tamper with, or modify the adapter. Contact Lectron Customer Support for any repairs.
4. Do not disconnect the CCS Combo 2 Adapter while charging the vehicle.

5. Protect from moisture, water, and foreign objects at all times.
6. To prevent any damage to its components, handle with care when transporting. Do not subject to strong force or impact. Do not pull, twist, tangle, drag, or step on it.
7. Do not damage with sharp objects. Always inspect for damage before each use.
8. Do not use cleaning solvents to clean.
9. Do not operate or store in temperatures outside the ranges listed in its specifications.

Introduction to Parts



Charging Your Vehicle

1. Connect the CCS Combo 2 Adapter to the charging station cable, ensuring that the adapter is fully attached.

Note:

After connecting the adapter to the charging station, wait at least 10 seconds before plugging the adapter into your vehicle.

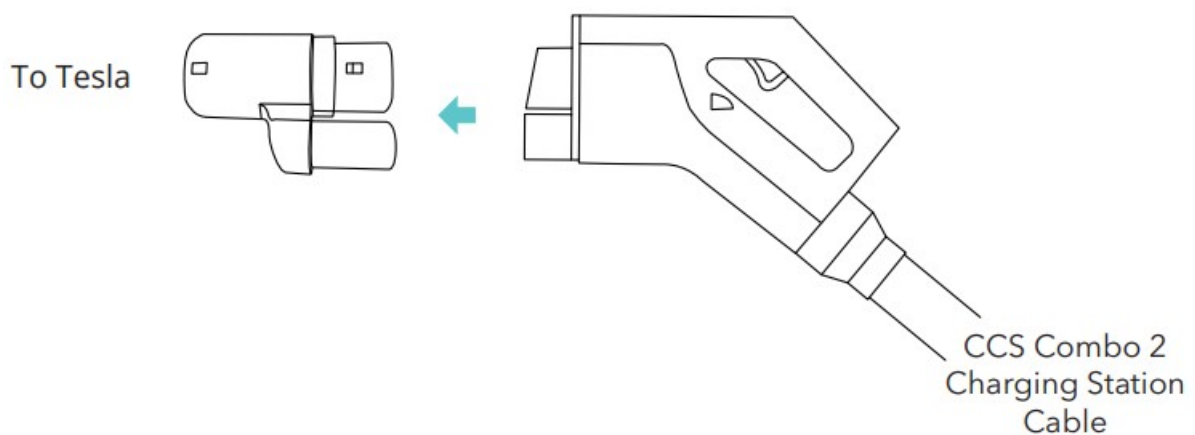

2. Open the charging port of your vehicle and plug the CCS Combo 2 Adapter into it.

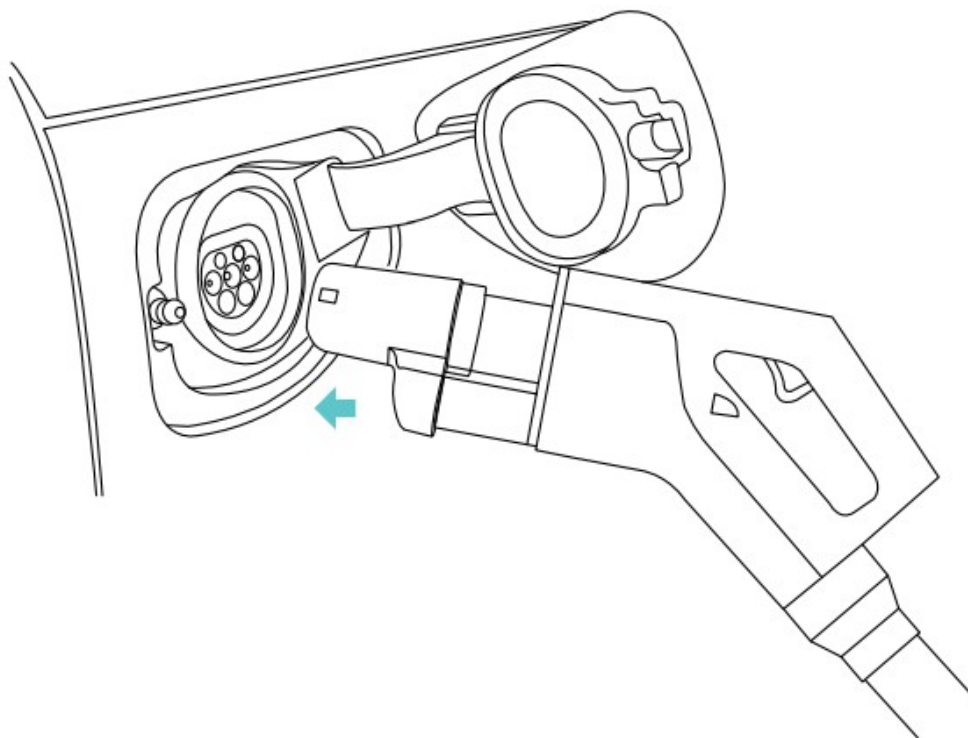

3. Follow the instructions on the charging station to start charging your vehicle.

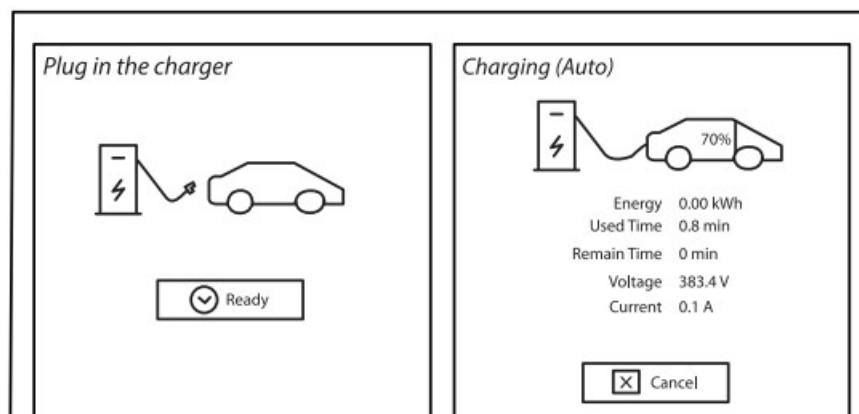

If there are instructions on the charging station asking you to unplug the charging cable and start a new session, disconnect the adapter from both the charging cable and your Type 2 inlet.

Unplugging CCS Combo 2 Adapter

1. Follow the instructions on the charging station to stop charging your vehicle.

After you finish charging, press the Power button on the CCS Combo 2 Adapter to unlock it. It is NOT recommended to interrupt the charging process by pressing the Power button while your vehicle is being charged.

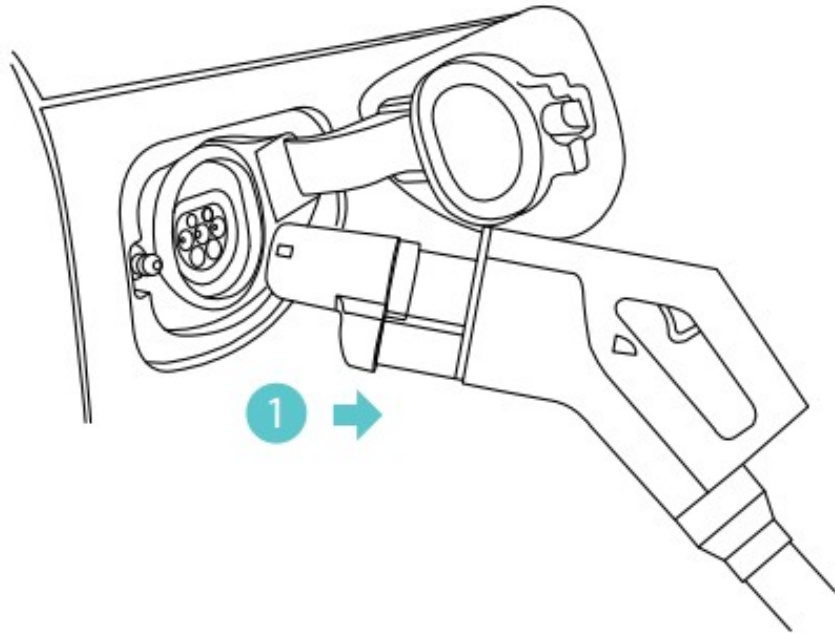

2. Unplug the CCS Combo 2 Adapter from the charging station's cable and store it in an appropriate location (i.e. glove box).

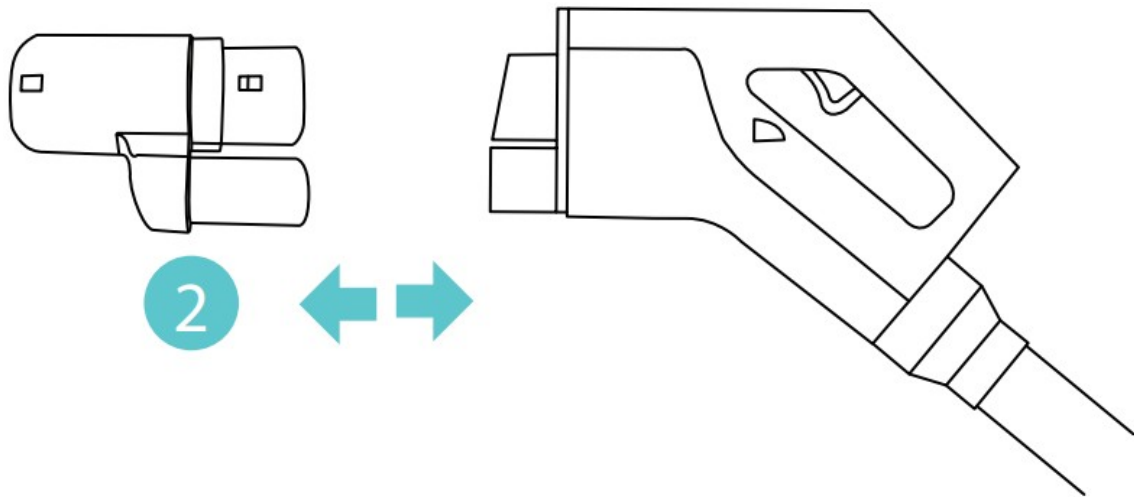

Troubleshooting

My vehicle is not charging

- Check the display on your vehicle dashboard for information about any error that may have occurred.
- Check the status of the charging station. Although the CCS Combo 2 Adapter is designed to work with all CCS Combo 2 charging stations, it may be incompatible with some models.

Specifications

Input/Output:	200A – 410V DC
Voltage:	2000V AC
Enclosure Rating:	IP54
Dimensions:	13 x 9 x 6 cm
Materials:	Copper alloy, Silver Plating, PC
Operating Temperature:	-30°C to +50°C (-22°F to +122°F)
Storage Temperature:	-40°C to +85°C (-40°F to +185°F)

Get More Support

Scan the QR code below or email us at contact@ev-lectron.com.

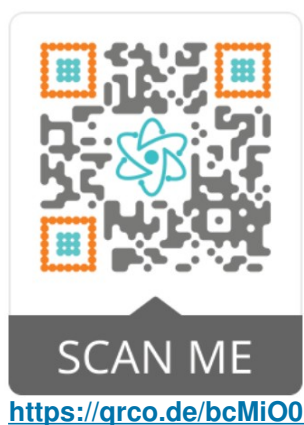

For more information, visit:

www.ev-lectron.com

Made in China

Documents / Resources

	<p>LECTRON CCS Combo 2 to Type 2 Adapter [pdf] User Manual</p> <p>CCS Combo 2 to Type 2 Adapter, CCS Combo 2, Combo 2 to Type 2 Adapter, Type 2 Adapter, Adapter</p>
--	--

References

- [Lectron Electric Vehicle Charging — Lectron EV](#)