



LECTRIC eBIKE Mirrors Pair Handlebar Mirrors User Guide

[Home](#) » [LECTRIC eBIKE](#) » LECTRIC eBIKE Mirrors Pair Handlebar Mirrors User Guide 



eBIKE Mirrors Pair Handlebar Mirrors
User Guide



Contents

[1 Mirrors Pair Handlebar](#)

[Mirrors](#)

[2 Documents / Resources](#)

[3 Related Posts](#)

Mirrors Pair Handlebar Mirrors

HANDLEBAR MIRRORS QUICK START

How to correctly install your handlebar mirrors

ABOUT

Each mirror fits handlebars with an inner diameter of 18 to 22mm.

STEP 1

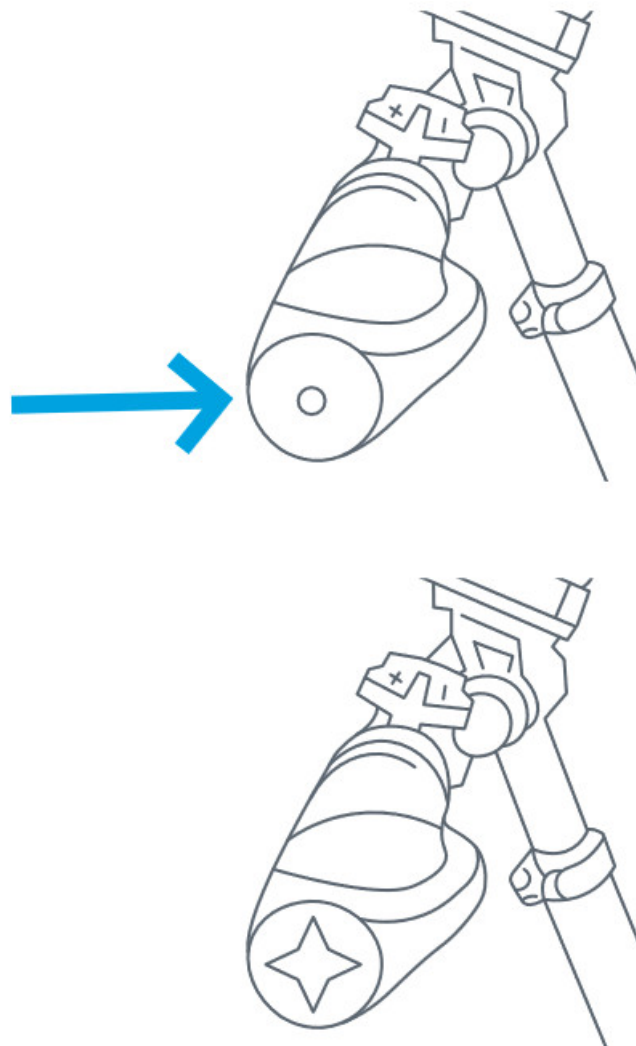

To begin, you will need to create a larger opening at the end of the rubber handlebar grip. (Behind your handlebar grip, your handlebars are hollow, this is where the collar of the mirror will fit into). Use a knife to create a larger opening for the mirror collar.

STEP 2

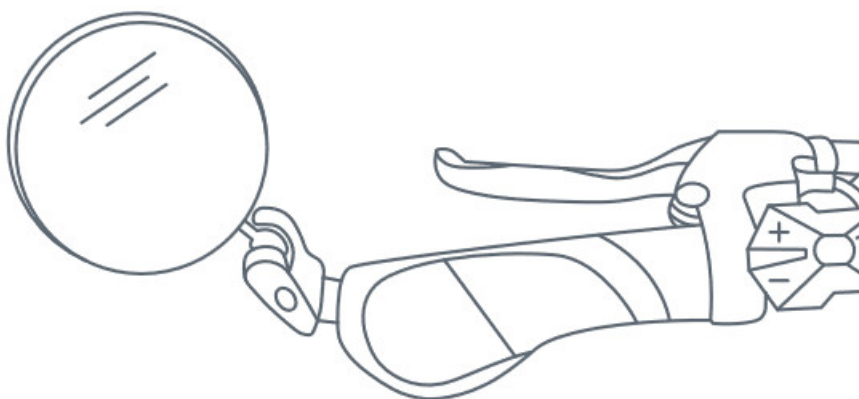
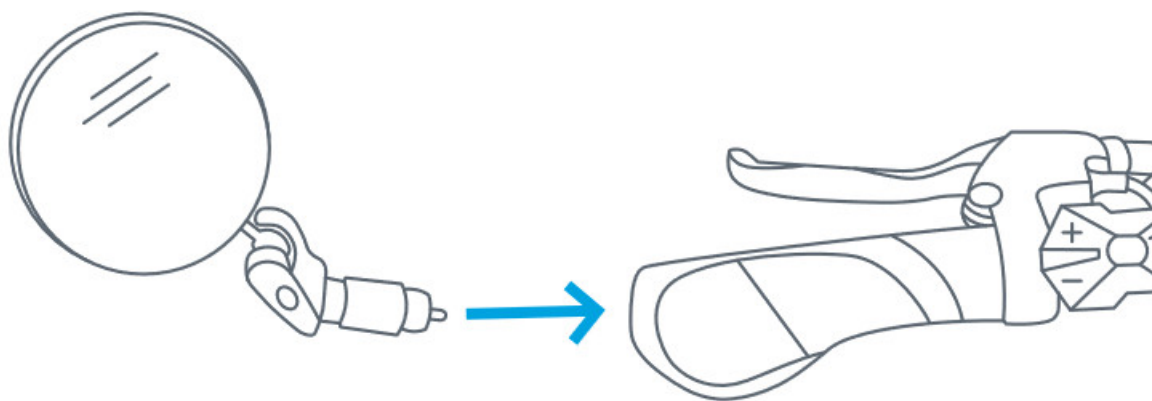

Next, you will insert the mirror collar into this opening.

STEP 3

Using your 5mm hex wrench, tighten the screw to expand the collar grip. This secures the mirror within the handlebars.

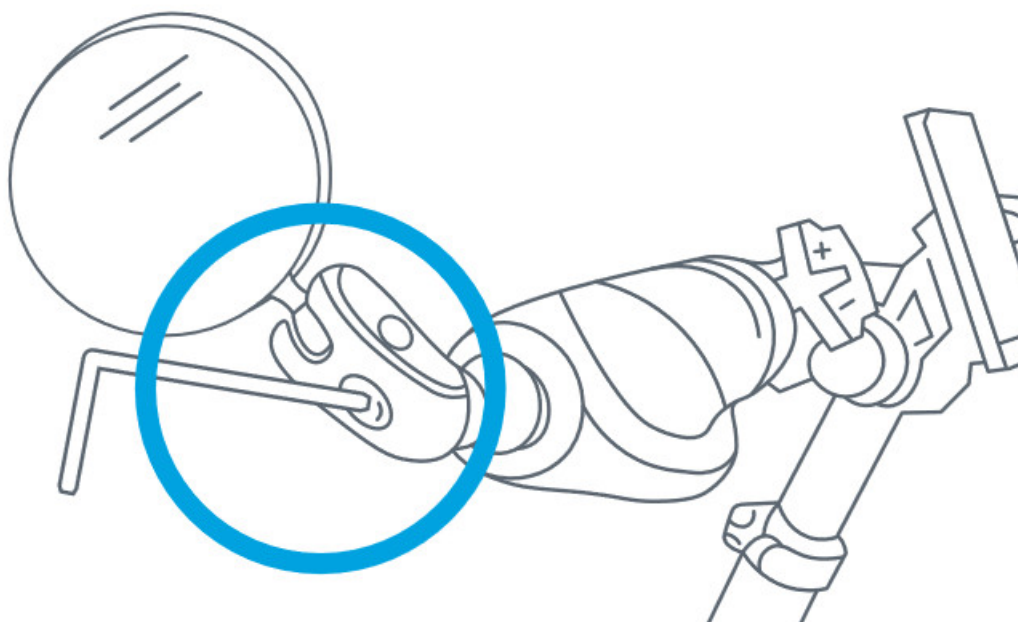

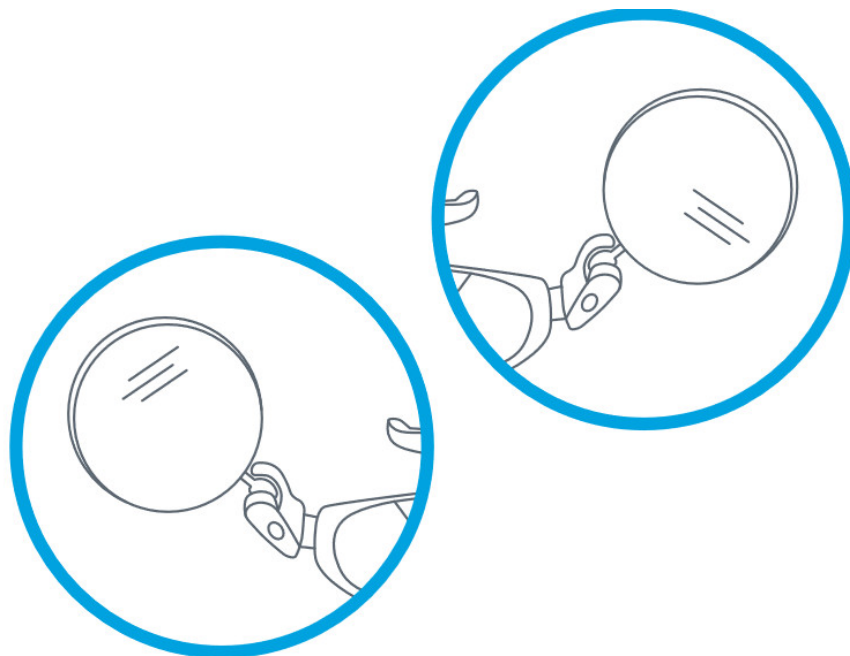

STEP 4

Once your mirrors are secure, adjust each mirror to the best position for YOU!



Documents / Resources

<p>HANDLEBAR MIRRORS QUICK START</p> <p>How to correctly install your handlebar mirrors</p> <p>ABOUT</p> <p>Read before this installation with an inner diameter of 18 to 22mm.</p> <p>STEP 1</p> <p>To begin, you will need to create a larger opening in the rim of the handlebar. Use a sharp tool to create a larger opening in the rim of the handlebar. The opening should be large enough to fit the mirror. (See image on the right.)</p> <p>Use a utility knife to create a larger opening for the mirror holder.</p> <p>STEP 2</p> <p>Now you will mount the mirror holder to the opening.</p>  <p></p>	<p>LECTRIC eBIKE Mirrors Pair Handlebar Mirrors [pdf] User Guide</p> <p>Mirrors Pair Handlebar Mirrors, Pair Handlebar Mirrors, Handlebar Mirrors, Mirrors</p>
---	--